

Register your product and get support at
www.philips.com/welcome

AUREA

Powered by Ambilight



37PFL9903H/10

42PFL9903H/10

EN LCD television

IT Televisore LCD

DE LCD-Fernsehgerät

ES Televisor LCD

FR Téléviseur LCD

PT Televisor LCD

NL LCD televisie

EL Τηλεόρασης LCD

310431527101



PHILIPS

Table of contents

1 Important 3

- 1.1 Safety 3
- 1.2 Care of the screen 3
- 1.3 Recycling 3

2 Your TV 4

- 2.1 Television overview 4
- 2.2 How to enjoy HD TV 5
- 2.3 Product highlights 5

3 Getting started 5

- 3.1 Position the TV 5
- 3.2 Wall mounting - VESA 6
- 3.3 Remote control batteries 9
- 3.4 Antenna cable 9
- 3.5 Power cable 9

4 Use your TV 10

- 4.1 Switch on or off - Standby 10
- 4.2 Watch TV 11
- 4.3 Watch channels from a digital receiver 11
- 4.4 Watch connected devices 11
- 4.5 Watch a DVD 12
- 4.6 Select a Teletext page 12
- 4.7 Change Ambilight mode 13

5 Use more of your TV 14

- 5.1 Remote Control 14
- 5.2 LightGuide brightness 17
- 5.3 TV menus 17
- 5.4 Picture and sound settings 18
- 5.5 Ambilight 21
- 5.6 Teletext 22
- 5.7 Create favourite channel lists 23
- 5.8 Electronic Programme Guide 24
- 5.9 Timers and locks 26
- 5.10 Subtitles 27
- 5.11 Watch and play photos, MP3... 27
- 5.12 Listen to digital radio channels 29
- 5.13 Software update 30

6 Channel installation 32

- 6.1 Automatic channel installation 33
- 6.2 Manual channel installation 34
- 6.3 Rearrange stored channels 34
- 6.4 Channel management 35
- 6.5 Digital reception test 35
- 6.6 Factory settings 35

7 Connections (DVD, receiver, ...) 36

- 7.1 Connections overview 36
- 7.2 About connections 37
- 7.3 Connect your devices with the Connection assistant 38
- 7.4 Connect your devices without the Connection assistant 38
- 7.5 Connection setup 44
- 7.6 Preparing for digital services 45
- 7.7 PC network 46

8 Technical data 52

9 Troubleshooting 54

10 Index 56

UK Digital TV switchover info 58

Remote control setup codes at the end of this book.



Aurea service

Call us if you need help or in case of product failure. To avoid an interruption of your Aurea Viewing Experience, we will repair the TV at your home or offer you an Aurea TV replacement during the repair at our workshops.

United Kingdom

☎ 00800 74454771 / 📞 0800 0131562

Ireland

☎ 00800 74454771 / 📞 1800 818833

Please have the Model and Serial Number ready before you call.

You can find these numbers on the packaging label or on the back and bottom of your TV.

Aurea registration

Register your product and get support at ...
www.philips.com/welcome

2008 © Koninklijke Philips Electronics N.V. All rights reserved. Specifications are subject to change without notice. Trademarks are the property of Koninklijke Philips Electronics N.V. or their respective owners.

Philips reserves the right to change products at any time without being obliged to adjust earlier supplies accordingly. The material in this manual is believed adequate for the intended use of the system. If the product, or its individual modules or procedures, are used for purposes other than those specified herein, confirmation of their validity and suitability must be obtained. Philips warrants that the material itself does not infringe any United States patents. No further warranty is expressed or implied.

Warranty

No components are user-serviceable. Do not open or remove covers and do not insert objects in the ventilation slots or insert objects not suitable for the specific connectors. Repairs may only be done by Philips Service Centres and official repairshops. Failure to do so shall void any warranty, stated or implied. Any operation expressly prohibited in this manual, any adjustments, or assembly procedures not recommended or authorised in this manual shall void the warranty.

Pixel characteristics

This LCD product has a high number of colour pixels. Although it has effective pixels of 99,999% or more, black dots or bright points of light (red, green or blue) may appear constantly on the screen. This is a structural property of the display (within common industry standards) and is not a malfunction.

Open source software

This television contains open source software. Philips hereby offers to deliver or make available, upon request, for a charge no more than the cost of physically performing source distribution, a complete machine-readable copy of the corresponding source code on a medium customarily used for software interchange. This offer is valid for a period of 3

years after the date of purchase of this product.

To obtain the source code, write to Philips Innovative Applications N.V. Ass. to the Development Manager Pathoekeweg 11 B-8000 Brugge Belgium

Compliance with EMF

Koninklijke Philips Electronics N.V. manufactures and sells many products targeted at consumers, which, like any electronic apparatus, in general have the ability to emit and receive electromagnetic signals.

One of Philips' leading Business Principles is to take all necessary health and safety measures for our products, to comply with all applicable legal requirements and to stay well within the EMF standards applicable at the time of producing the products. Philips is committed to develop, produce and market products that cause no adverse health effects. Philips confirms that if its products are handled properly for their intended use, they are safe to use according to scientific evidence available today. Philips plays an active role in the development of international EMF and safety standards, enabling Philips to anticipate further developments in standardisation for early integration in its products.

Mains fuse (UK only)

This TV is fitted with an approved moulded plug. Should it become necessary to replace the mains fuse, this must be replaced with a fuse of the **same value as indicated** on the plug (example **10A**).

1. Remove fuse cover and fuse.
2. The replacement fuse must comply with BS 1362 and have the ASTA approval mark. If the fuse is lost, contact your dealer in order to verify the correct type.
3. Refit the fuse cover.

In order to maintain conformity to the EMC directive, the mains plug on this product must not be detached from the mains cord.

Copyrights



VESA, FDMI and the VESA Mounting Compliant logo are trademarks of the Video Electronics Standards Association.



Manufactured under license from Dolby Laboratories. 'Dolby', 'Pro Logic' and the double D symbol **DD**, are trademarks of Dolby Laboratories.



Manufactured under license from BBE Sound, Inc. Licensed by BBE, Inc under one or more of the following US patents: 5510752, 5736897. BBE and BBE symbol are registered trademarks of BBE Sound Inc.

Windows Media is either a registered trademark or trademark of Microsoft Corporation in the United States and/or other countries

® Kensington and MicroSaver are registered US trademarks of ACCO World Corporation with issued registrations and pending applications in other countries throughout the world.



DLNA®, the DLNA logo and DNLA Certified™ are trademarks, service marks, or certification marks of the Digital Living Network Alliance.

All other registered and unregistered trademarks are the property of their respective owners.

1 Important

Read this user manual before you start to use this product.

Pay attention to this section and closely follow the instructions. The warranty does not apply to damage caused by not taking into account the instructions.

1.1 Safety

- To avoid short circuit, do not expose the product to rain or water.
- To avoid a risk of fire or electric shock do not place naked flame sources (e.g. lighted candles) close to the TV.
- Leave a space of at least 10cm (4 inches) all around the TV for ventilation.
- Keep away from radiators or other heat sources.
- Do not install the TV in a confined space such as a book case. Make sure that curtains, cupboards and so on cannot obstruct the air flow through the ventilation slots.
- To prevent damage, do not insert any object into the ventilation slots.
- Make sure the TV cannot fall down. Place the TV on a solid and flat surface and only use the stand provided with the TV.
- To prevent damaging the mains cord, do not place the TV, or anything else, on the cord. Damage the cord may cause a fire or electric shock.
- When mounted on a swivel stand or VESA wall bracket avoid force coming on the mains plugs. Mains plugs that are partly loosened can cause arcing or fire.

1.2 Care of the screen

- Unplug the TV before cleaning.
- Clean the surface with a soft damp cloth. Do not apply any other substance (chemical or household cleaning agent). This may damage the screen.
- Do not touch, push or rub or strike the screen with anything hard as this may scratch, mar or damage the screen permanently.
- To avoid deformations and colour fading, wipe off water drops as soon as possible.

• Stationary images

Avoid stationary images as much as possible. If you cannot, reduce screen contrast and brightness to prevent damage to the screen. Stationary images are images that remain on the screen for a long time. Examples of stationary images are: on screen menus, teletext pages, black bars, stock market information, TV channel logos, time displays, and so on.

1.3 Recycling

- Take the packaging to your local recycling centre.
- Dispose old batteries safely according local regulations.
- This product is designed and manufactured for material recycling and re-use.
- Do not dispose this product with other household waste. Inform yourself or ask your dealer about local environmentally safe recycling and local regulations. Uncontrolled waste disposal harms the environment and human health. (EEC 2002/96/EC)



2 Your TV

This section gives you an overview of the controls and functions of this TV.

2.1 Television overview

Controls

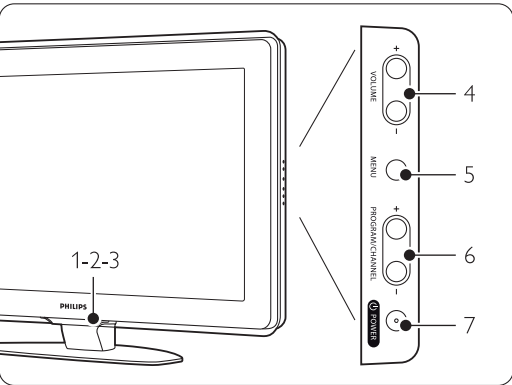

- 1 LightGuide
- 2 Indicator light
- 3 Remote control sensor
- 4 Volume up and down
- 5 Menu
- 6 Program/Channel up and down
- 7 Power switch

Connectors

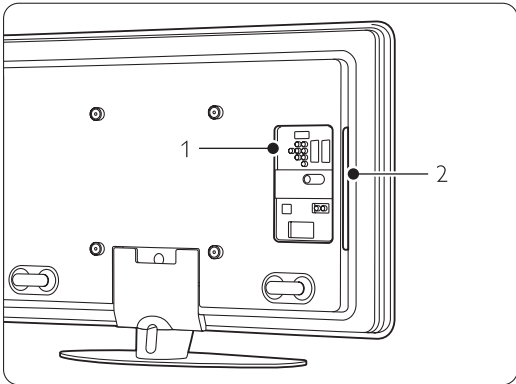

- 1 Back connectors
 - 2 Side connectors
- For more info see section 7 Connections.

Remote control

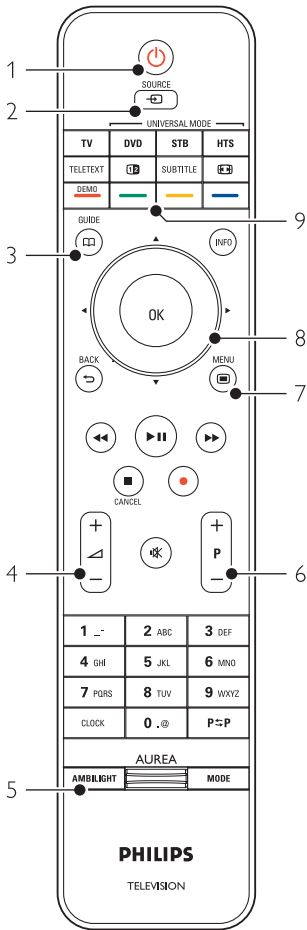

- 1 Switch On or switch to Standby
- 2 Watch a connected device - DVD,VCR ...
- 3 Programme guide
- 4 Volume up + or down -
- 5 Ambilight On or Off
- 6 Program/Channel up + and down -
- 7 Menu On or Off
- 8 Navigation and Rotary key
- 9 Colour keys

For more info see section 5.1 Remote control overview.

2.2 How to enjoy HD TV ?

This TV can display High Definition TV programmes. But to enjoy HD TV you need to get programmes in HD first. The picture quality of this TV without HD programmes is just normal TV.

You can receive HD programmes from ...

- a Blu-ray Disc player; connected to HDMI, with a HD Movie
- a digital HD receiver; connected to HDMI, with a subscription to HD channels from a Cable or Satellite company
- an Over-the-air HD broadcaster (DVB-T MPEG4)
- a HD channel on your DVB-c network
- a Game console (Xbox 360 / PlayStation 3), connected to HDMI, with a HD game.

Contact your dealer for more information. Go to www.philips.com/support FAQ's to find the list of HD channels or providers in your country.

2.3 Product highlights

Your new TV is equipped with some of the most modern audio or video innovations. Your TV offers the following advantages ...

Full High Definition LCD display

A full HD resolution of 1920x1080p, the highest resolution of HD sources. It offers a brilliant flicker-free progressive scan picture with optimum brightness and superb colours.

Ambilight

For a more relaxed viewing experience and improved perceived picture quality.

DVB-T and DVB-C integrated tuner

Next to normal analogue TV broadcast your TV receives digital terrestrial and in certain countries also digital cable TV and radio broadcasts.

Electronic Programme Guide - EPG

The EPG shows the scheduled digital TV programmes on screen. The guide can remind you when programmes start, switch the TV on, etc.

USB connection / PC network connection

Multimedia connection for instantly view or play your photos or music.

3 Get started

This section helps you with the positioning and the first time installation of the TV.

3.1 Position the TV

Carefully read the safety precautions in section 1.1 Safety before you position the TV.

- Large screen TVs are heavy. Carry and handle the TV with at least two persons.
- The ideal distance from which to watch TV is three times its diagonal screen size.
- Position the TV where light does not fall directly on the screen.
- Dim lighting conditions in the room for best Ambilight effect.
- Position the TV 10 to 20cm away from the wall for the best Ambilight effect.
- Your TV is equipped with a Kensington Security Slot at the back of the TV for an anti-theft lock (not supplied).

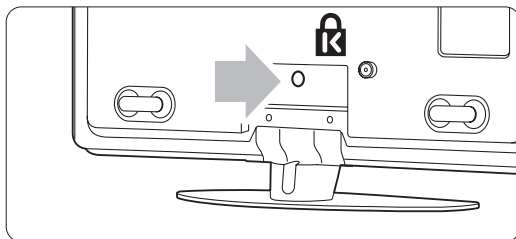

3.2 Wall mounting

You can wall mount the TV with the supplied wall mount bracket.

3.2.1 Unmounting the TV stand

The TV stand should be unmounted from the TV to allow the TV to be wall mounted.

- 1 Unscrew the 4 screws that secure the stand to the TV.

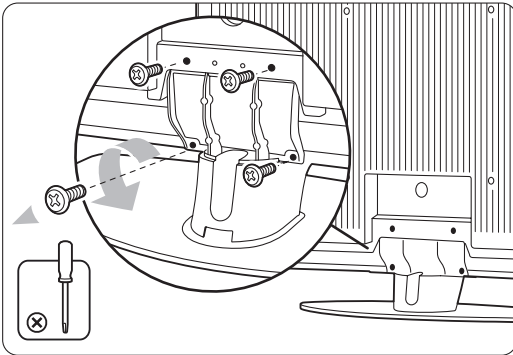

- 2 Lift the TV from the stand.

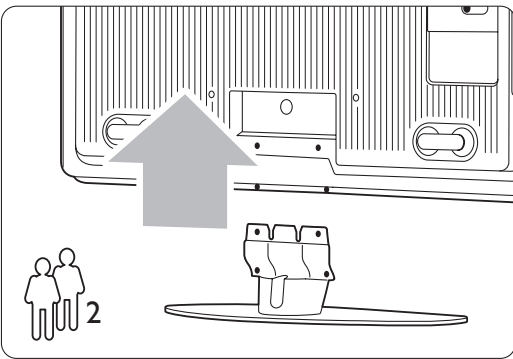

3.2.2 Mounting the wall mount bracket

⚠ Caution

Wall mounting the TV requires special skills that should only be performed by qualified personnel. Wall mounting the TV should meet safety standards according to the TV's weight.

Koninklijke Philips Electronics N.V. bears no responsibility for improper mounting or mounting that results in accident or injury.

Read also the safety precautions in section **1.1 Safety** before you position the TV.

- 1 Collect the parts for wall mounting.

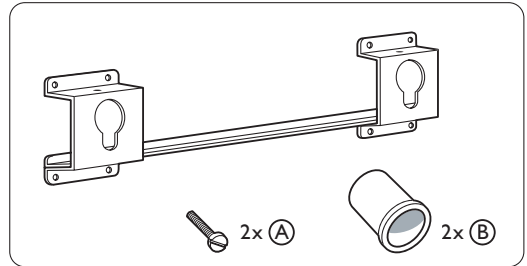

- 2 Insert just a little bit both security screws in the wall mount bracket.

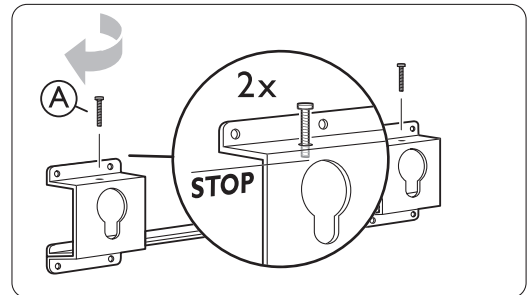

- 3 Verify the presence of the 4 plastic discs at the back of the TV.

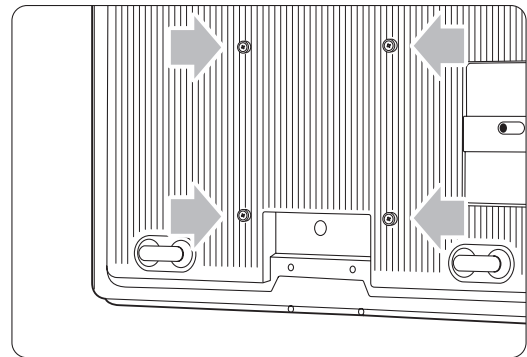

- 4** Mount the 2 spacers **(B)** on the 2 lower discs at the back of the TV.

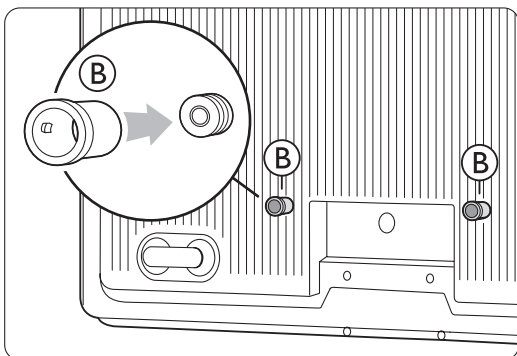

- 7** Connect all cables.
See section **7 Connections**.

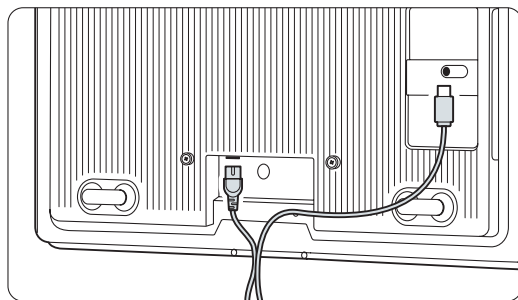

- 5** Calculate your TV's ideal position.

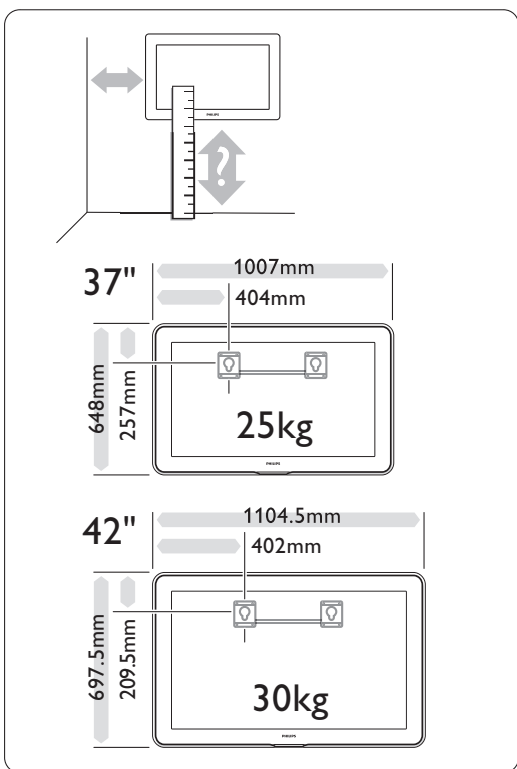

- 8** Lift the TV into the wall mount bracket.

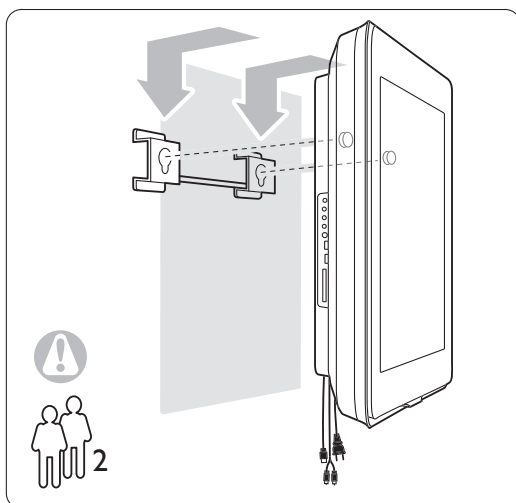

- 9** Secure the TV in the bracket by screwing in the 2 already fitted screws **(A)**.

- 6** Position and level the wall mount bracket and fix the bracket firmly to the wall.

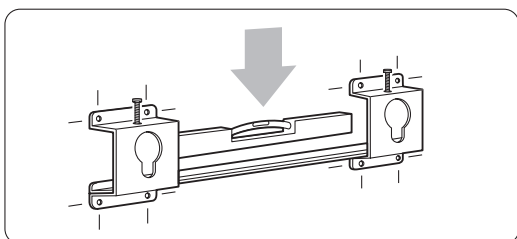

3.2.3 VESA compliant mounting

⚠ Caution

Consider the TV's weight when you wall mount it. Improper mounting can result in severe injury or damage. Koninklijke Philips Electronics N.V. bears no responsibility for improper mounting or mounting that results in accident or injury.

Your TV is prepared for VESA compliant wall mounting. This bracket is not included. You need one of the VESA codes hereunder to purchase the bracket that fits your TV.

- 37" / 94cm VESA MIS-F 200, 200, 8
- 42" / 107cm VESA MIS-F 300, 300, 8

Prepare the TV for VESA compliant mounting.

- 1** Locate the VESA screwholes on the back of the TV.

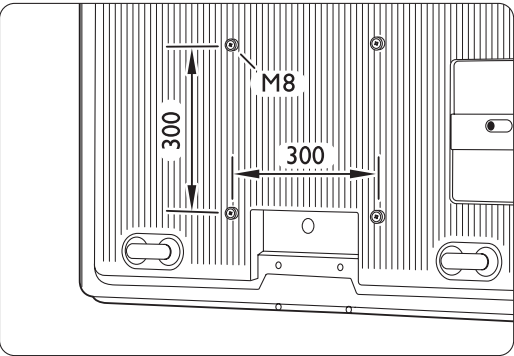

- 2** Should the plastic discs obstruct the VESA bracket, you can unscrew these 4 discs.

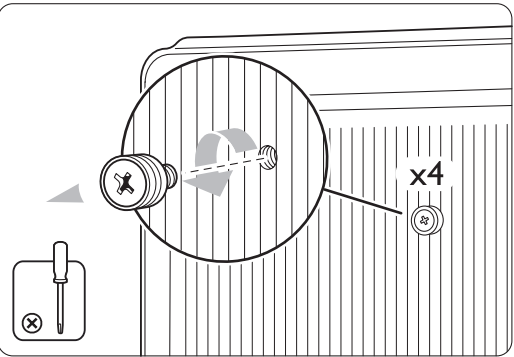

3.3 Remote control batteries

- 1** Open the battery cover on the back of the remote control.
- 2** Insert the 3 batteries supplied (Type AAA-LR03-1,5V). Make sure the + and - ends of the batteries line up correctly (inside of case is marked.)
- 3** Close the cover.

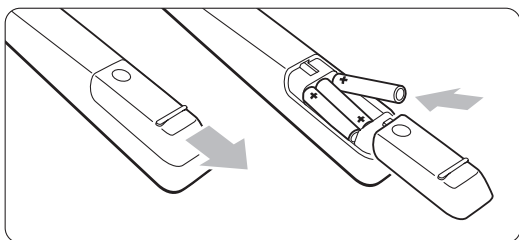

Note

Remove the batteries if not using the remote control for an extended period of time.

3.4 Antenna cable

- 1** Locate the antenna connection at the back of the TV.
- 2** Insert the antenna cable tightly into the **Antenna**  socket.

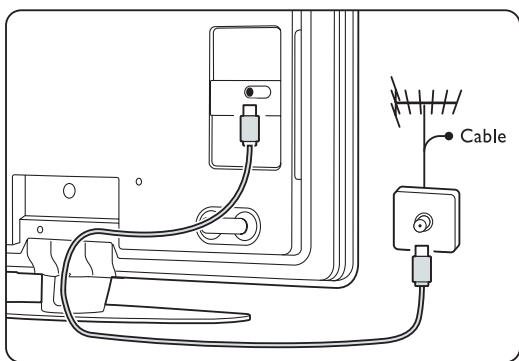

3.5 Power cable

Keep the mains plug at the wall socket accessible at all time.

The TV is never powered off completely and consumes energy unless the mains cord is physically unplugged.

Although this TV has a very low standby power consumption, unplug the mains cord if you do not use the TV for a long time to save energy.

- 1** Verify that your mains voltage corresponds with the voltage printed on the sticker at the back of the TV. Do not insert the mains cord if the voltage is different.
- 2** Insert the mains cord tightly.

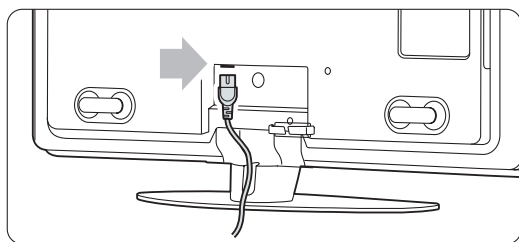

4 Use your TV



Learn how to operate your TV for daily use.

4.1 Turn on or off - Standby

Note

The TV may take up to 15 seconds to turn on.

To turn on the TV:

- Press  **Power** at the right of the TV if the standby indicator is off.
- Press  on the remote control if the standby indicator is on.

The LightGuide flashes during start up and turns on completely when the TV is ready for use.

To switch to standby:

- Press  on the remote control.
The LightGuide turns off and the standby indicator is on.

To turn off:

- Press  **Power** at the side of the TV.
Both the LightGuide and the standby indicator turn off.

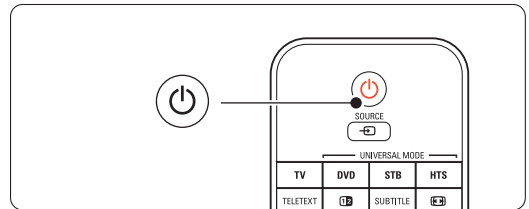
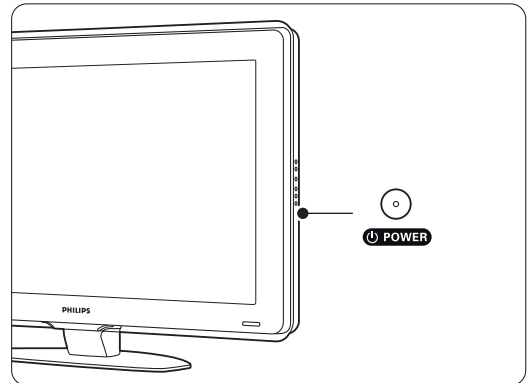

4.2 Watch TV

4.2.1 Switch channels

- 1 To switch TV channels:
 - Press a number (1 to 999) or press **P+** or **P-** on your remote control.
 - Press **Program/Channel -** or **+** on the side controls of the TV.
- 2 Press **P=P** to return to the previously viewed TV channel or connected device.

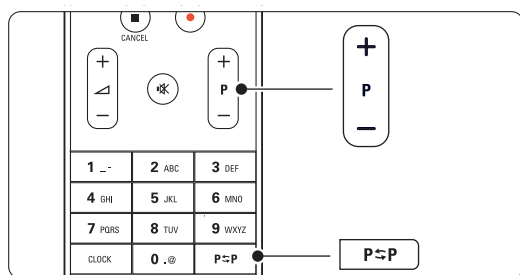

4.2.2 Adjust volume

- 1 To adjust the volume:
 - Press **△** or **-** on the remote control
 - Press **Volume +** or **-** on the side controls of your TV.
- 2 To mute the sound:
 - Press **⏸**.
 - Press **⏸** again to restore the sound.

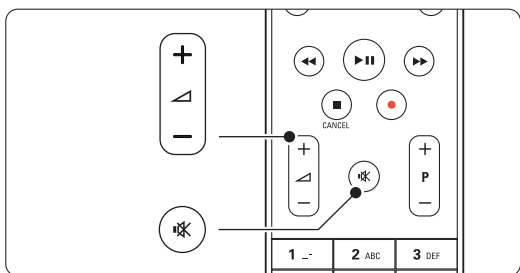

4.3 Watch channels from a digital receiver

- 1 Switch on the digital receiver.
The picture from your receiver automatically appears on the screen.
- 2 Use the remote control of your digital receiver to select TV channels.

If the picture does not appear:

- 1 Press the **Source** key.
- 2 Press **▲** or **▼** to select where you connected your digital receiver.
- 3 Press **OK**.

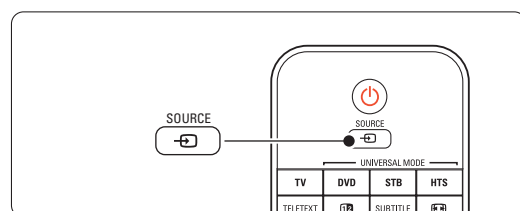

Note

When you did not connect your devices yet, go to section **7 Connections**.

4.4 Watch connected devices

- 1 Switch on the device.
The picture from your device automatically appears on the screen.

If the picture does not appear:

- 2 Press the **Source** key.
- 3 Press **▲** or **▼** to select where you connected your device.
- 4 Press **OK**.

Note

When you did not connect your devices yet, go to section **7 Connections**.

4.5 Watch a DVD

- 1 Switch on your DVD player.
- 2 Insert a DVD disc in your player.
The DVD picture automatically appears on the screen.
- 3 Press **Play ▶** on the DVD player.

If the picture does not appear:

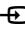
- 1 Press the **Source**  key.
- 2 Press **▲** or **▼** to select where you connected your DVD player.
- 3 Press **OK**.
Wait a few seconds until the picture appears.
- 4 Press **Play ▶**.

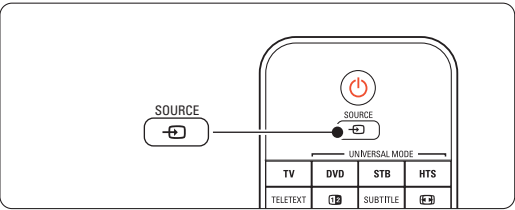



4.6 Select a Teletext page

Most TV channels broadcast information through Teletext.

To watch Teletext:

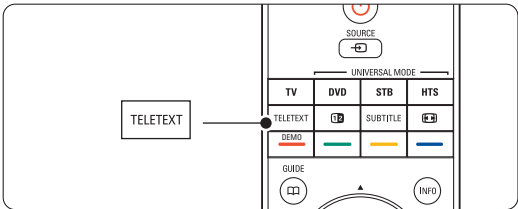
- 1 Press **Teletext**.
The main index page appears.
- 2 To select a page of your choice:
 - Enter the page number with the number keys.
 - Press **P-** or **P+** or **▲** or **▼** or the **↔** key to view the next or the previous page.
 - Press a colour key to select one of the colour coded items at the bottom of the screen.
 - Press **P↔P** to return to the previously viewed page.
- 3 Press **Teletext** again to switch Teletext off.



 **Note**
Only for UK: some digital TV channels offer dedicated digital text services (for example BBC1).

For more information on teletext, see section **5.6 Teletext**.

4.7 Change Ambilight mode

You can adjust the speed at which Ambilight responds to the on-screen images.

Adjust the Ambilight mode:

- 1** Press **Ambilight** to switch on.
- 2** Press **Mode** to change the light intensity of Ambilight.
- 3** Slide the **AUREA Ambilight** switch up or down to change the light intensity.

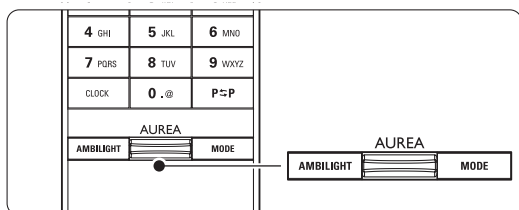

LoungeLight mode

When the TV is in standby, you can switch Ambilight on.

- 1** Press **Ambilight**. Wait until Ambilight lights up.
- 2** Press **Mode** repeatedly to toggle through the available Ambilight effects.

For more information on Ambilight, see section **5.5 Ambilight**.

⊕ Tip

Dim lighting conditions in the room for best Ambilight effect.

5 Use more of your TV

This section helps you perform advanced TV operations including how to:

- use the menus
- adjust picture, sound and Ambilight settings
- make use of Teletext
- create favourite channel lists



- make advantage of Electronic Programme Guide
- set locks and timers
- set subtitles and select a subtitle language
- view your photos or play your favourite music from a USB memory device or from your PC or Home network.

5.1 Remote control

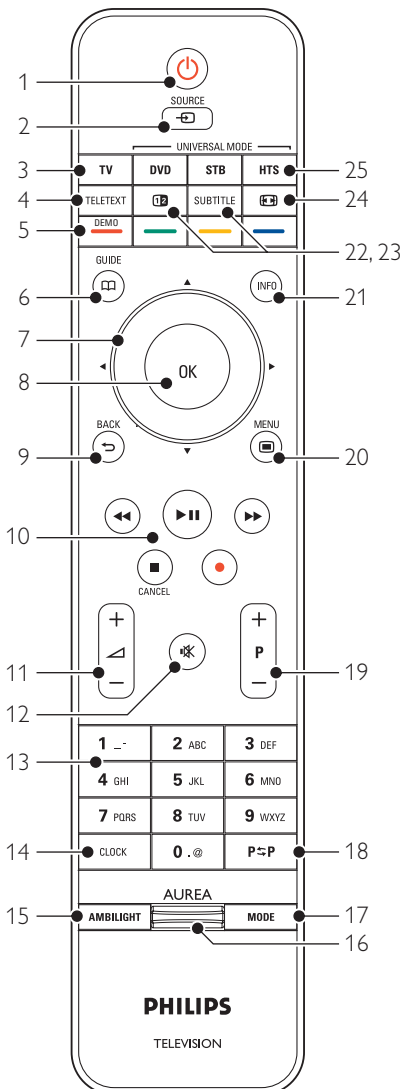
5.1.1 Remote control overview

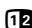

- Standby** To switch the TV on or back to standby.
- Source**
 - To switch the Source menu on or off.
 - To select a connected device or to return to TV.
- TV** Sets the remote control in TV mode.
- Teletext** To switch teletext on or off.
- Colour keys**
 - Easy selection of teletext pages.
 - Easy selection of tasks.
- Demo** To switch the Demo menu on and to get a demonstration of the features of the TV.
- Guide** To switch on or off the Electronic Programme Guide.
- Navigation and rotary key** To navigate (, , ,) or turn left or right to go through lists or settings.
- OK**
 - To display the channel list.
 - To activate a setting.
- Back key** To select the previous programme or the previous TXT page.
To remove the channel list.
- Audio and video keys** , , , , To operate a DVD player or recorder, Blu-ray Disc player or VCR.
Cancel (only for UK) To cancel only Digital text or Interactive services.
- Volume** To adjust the volume.
- Mute** To mute the sound or restore it.

- 13 **Number keys**
To select a TV channel.
- 14 **Clock**
To display the time on screen.
- 15 **Ambilight**
To switch Ambilight on or off.
- 16 **Ambilight AUREA**
To change the light intensity of Ambilight
- 17 **Mode**
To adjust the dynamic effect of Ambilight
- 18 **Previous channel P \Leftarrow P**
To return to the previously viewed channel
- 19 **+P- Channel up or down**
To switch to the next or previous channel in the channel list.
- 20 **Menu** 
To switch the menu on or off
- 21 **On screen information i**
To show channel or programme information if available.
- 22 **Dual screen** 
To show teletext on the right and the picture on the left of the screen.
- 23 **Subtitle**
To activate or deactivate the subtitle mode.
- 24 **Widescreen Picture format** 
To select a picture format.
- 25 **DVD STB HTS**
To control connected devices.

See section **10 Index** to find the section in the manual about a specific remote control key.

5.1.2 Universal remote control

Your TV remote control is a universal remote control that can operate other devices such as DVD players and recorders, digital receivers (Set-top boxes – STB) or Home Theatre Systems (HTS) of Philips and many other brands.

- 1** Press **DVD**, **STB** or **HTS** to select a DVD, a cable receiver (STB) or a Home Theatre (HTS) device. The key blinks as long as you are in this control.

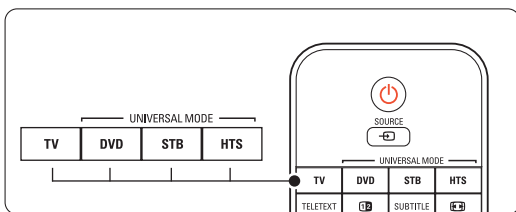

- 2** Use the relevant keys on the TV remote control to operate the device.

If the device does not react or operates incorrectly, you need to set up your remote control for your particular device.
See section **5.1.3 Set to operate a particular device**.

- 3** Press the **TV** key to return to normal TV mode. When no key is pressed for 30 seconds the remote control switches back to normal TV.

5.1.3 Set to operate a particular device

You can choose from three ways to programme the remote control for a device of a particular brand. You can:

- use the Universal remote control assistant to help you
- enter a brand's setup code or
- start an auto search.

Note

Possibly the remote control is not compatible with all types of DVD, cable receivers and Home Theatre Systems.

Method 1: Use the Universal remote control assistant

- 1** Turn on your device.
- 2** Press the **DVD**, **STB** or **HTS** universal mode key for 4 seconds to select the universal mode you need or press **Menu**  and select **Setup > Installation > Remote control assistant** and press \blacktriangleright to enter:
- **DVD** stands for DVD, DVD-R, HDD and Blu-ray Disc
 - **STB** stands for digital receiver and set-top-boxes (cable, satellite)
 - **HTS** for Home Theatre Systems, Audio/Video systems

The remote control is now in the selected programming mode. Follow the instructions on screen.

Note

Ensure that the TV and the device are within reach of the remote control.

Method 2: Enter the setup code directly



Instead of using the Universal remote control assistant, you can also enter a setup code directly. Find a list of these codes per brand and device at the end of this manual.

- 1** Press the **DVD**, **STB** or **HTS** key and **OK** at the same time for 4 seconds to select the universal mode you need.



- 2 Enter the three-number code for the type and brand of your device. Some brands have several setup codes available and you need to select the known one. You can try them one by one. If you entered a known code, all universal mode keys will blink to confirm the selection. If you entered an unknown code, all universal mode keys will light up for 2 seconds. Repeat Step 2 with a different code.
- 3 Point the remote control at the device, and press  to test if the code is known for your device.
If successful try whether you can operate all functions. If not successful, or if you cannot operate all functions, repeat Step 1 and 2 with one of the other setup codes for your brand.

Method 3: Automatic search of all codes

If you are not successful to find the known brand or code, try an automatic search of all codes. The automatic search can take several minutes. If after the automatic search no code is successful, it is not possible to operate your particular device with the remote control. In such case, use the device's own remote control.

- 1 Turn on the device you want the TV remote control to set up for.
- 2 Point the remote control to the device during the automatic search.
- 3 To select the universal mode you need, press the **DVD**, **STB** or **HTS** key and the **OK** key at the same time for 4 seconds. The selected universal mode lights up constantly.
- 4 Press **OK** to start the automatic search. Every two seconds, when a new code is sent, the  key will blink. Keep pointing the remote control to the device.
- 5 When the device switches off, press **OK** to stop the search.
- 6 Press  to switch on your device.
- 7 Press the remote control keys to try if you can operate all functions. If you cannot operate all functions, press **OK** again to continue the automatic search for a correct code.
- 8 If you can operate all functions, press the currently selected universal mode key to confirm and to quit the automatic search.

Note:

To pause the automatic search, press **OK**. Press  or  to search for the codes one by one backward or forward to locate the known code for your device or press **OK** again to continue the automatic search.

5.1.4 Keep the remote control in the chosen universal mode permanently

If you press the DVD, STB or HTS key the remote control can operate other devices. When no key is pressed for 30 seconds the remote control switches back to normal TV.

You can set the remote control to hold a universal mode as long as no other universal mode is pressed. This disables the 30 seconds switch back to normal TV.

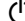
- 1 Press the **TV** key.
- 2 Press **OK** and  at the same time for 4 seconds. The  key lights up for 2 seconds.

From now on the remote control will not switch back to normal TV mode.

To return to the 30 seconds switch back to normal TV mode, follow the same steps 1 and 2.

5.1.5 Device functions overview

When the remote control is set for a particular device all keys have the same function except the keys mentioned here.

- **DVD player**
Menu key = DVD Disc menu
P+/- = DVD Next/Previous track
- **DVD Recorder**
◀◀ key = DVD-R previous track
▶▶ key = DVD-R next track
- **DVD recorder with Hard Disc Drive**
Menu key = DVD-R HDD browser
◀◀ key = DVD-R HDD previous track
▶▶ key = DVD-R HDD next track
- **Blu-ray Disc player**
 key = BD Content menu
Menu key = BD Disc menu

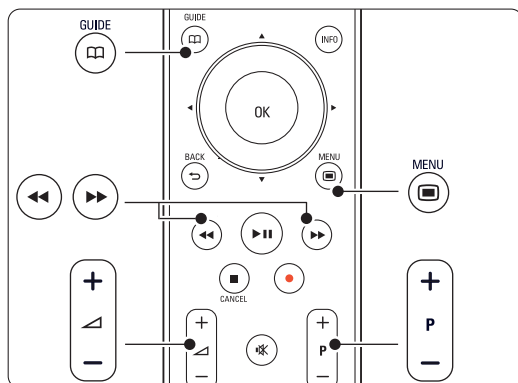

- **Digital or Satellite receiver**
No change of functions.
- **Home Theatre System**
Menu key = HTS Disc menu
↖ key = HTS volume
P+/- = HTS Next/Previous

5.1.6 Remote control setup codes

See the end of this manual.

5.2 LightGuide brightness

The LightGuide at the front of the TV indicates the start up of the TV.

After start up the LightGuide is lit constantly. You can set the light intensity or let it switch off after start up.

- 1 Press Menu  > Setup > Installation > Preferences > **LightGuide brightness**.
- 2 Press ▶ to enter the list.
- 3 Press ▲ or ▼ to select the brightness level from 0 (off) to 4.

5.3 TV menus

With the on screen menus you install your TV, adjust picture, sound and Ambilight settings and access features. This section gives an overview of the menus and describes how to navigate.

5.3.1 The menu

- 1 Press Menu  to show the TV menu.
- 2 Press Menu  to quit the TV menu.

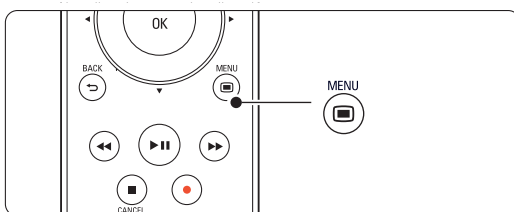

The TV menu offers the following items:

TV menu
Smart settings
Picture
Sound
Ambilight
Settings assistant
Features
Setup

- **Smart settings**
Select this item to set the TV to one of the predefined settings. Each setting combines picture, sound and Ambilight.
- **Picture**
Select this menu item to adjust all picture settings.
- **Sound**
Select this menu item to adjust all sound settings.
- **Ambilight**
Select this menu item to adjust all Ambilight settings.
- **Settings assistant**
Use the Settings assistant to guide you through basic picture, sound and Ambilight settings in an easy way.
- **Features**
Select this item for other feature settings.
- **Setup**
Select this item
 - for installation and to update the TV software;
 - to make use of the Remote control assistant which will help you to setup your remote control to operate other devices;

- to use the connection assistant which will help you to connect your devices to the TV.

5.3.2 Use of the menu

Learn to use the menus with this example.

- 1 Press **Menu** .

The TV menu appears on the screen.

TV menu
Smart settings
Picture
Sound
Ambilight
Settings assistant
Features
Setup

- 2 Press **▲** or **▼** to select **Picture**.
- 3 Press **▶** to enter the picture settings.

Picture	Contrast
Contrast	90
Brightness	47
Colour	52
Hue	0
Sharpness	4
Noise reduction	
Tint	
...	

- 4 Press **▼** to select **Brightness**.

Picture	Brightness
Contrast	98
Brightness	47
Colour	52
Hue	0
Sharpness	4
Noise reduction	
Tint	
...	

- 5 Press **▶** to enter the brightness setting.

Brightness

- 6 Press **▲** or **▼** to adjust the setting.
- 7 Press **◀** to return to the Picture settings or press **Menu**  to quit the TV menu.

Note:



More choices come available when digital channels are installed and broadcasted.

5.4 Picture and Sound settings

The first time you switched on the TV you have selected your preferred settings for picture, sound and Ambilight. The following sections describe how to modify or read just those settings.

5.4.1 Smart settings

Sets the TV to one of the predefined settings. Each setting combines picture, sound and Ambilight.

- 1 Press **Menu**  and select **Smart settings**.
- 2 Press **▶** to enter the list.
- 3 Press **▲** or **▼** to select a setting.
- 4 Press **OK**.
- 5 Press **Menu**  to quit the TV menu.

Smart settings: Personal, Vivid, Standard, Movie, Energy saving, Game.

5.4.2 Settings assistant

Use the Settings assistant to guide you through basic picture and sound settings in an easy way.

- 1 Press **Menu**.
- 2 Select **Settings assistant** and press **▶** to enter.
- 3 Press the green key to start the assistant.
- 4 Press **◀** or **▶** to select the left or right side to make your choice.
- 5 Press the green key to go to the next setting. Go through several settings.
- 6 When finished, press the green key to store all your settings.

5.4.3 Picture settings

This section describes how to adjust all picture settings individually.

- 1 Press **Menu** .
- 2 Select **Picture** and press **►** to enter the list.
- 3 Press **▲** or **▼** to select a setting.

TV menu	Picture
Smart settings	Contrast
Picture	Brightness
Sound	Colour
Ambilight	Hue
Settings assistant	Sharpness
Features	Noise reduction
Setup	Tint
	Perfect Pixel HD
	Active control
	Light sensor
	Picture format
	Auto format mode

- **Contrast**
Changes the level of bright parts in the picture but keeps the dark parts unchanged.
- **Brightness**
Changes the level of light of the total picture.
- **Colour**
Changes the level of saturation.
- **Hue**
If NTSC is broadcasted, this level compensates the colour variations.
- **Sharpness**
Changes the level of sharpness of fine details.
- **Noise reduction**
Filters out and reduces the noise in the picture. Set the level to Minimum, Medium, Maximum or Off.
- **Tint**
Sets the colours to Normal, Warm (reddish) or Cool (bluish). Select Custom to make a setting of your own in the Custom menu.
 - **Custom**
Press the green key to select each bar to change the value of:
 - R-WP red whitepoint
 - G-WP green whitepoint
 - B-WP blue whitepoint
 - R-BL red blacklevel
 - G-BL green blacklevel
- **Perfect Pixel HD**
Controls the advanced settings of the Perfect Pixel HD Engine, resulting in best sharpness, contrast, colour and motion.

Picture	Perfect Pixel HD
...	HD Natural Motion
Noise reduction	100 Hz Clear LCD
Tint	Advanced sharpn...
Perfect Pixel HD	Dynamic contrast
Active control	Dynamic backlight
Light sensor	MPEG artefact red...
Picture format	Colour enhance...
Auto format mode	

- **HD Natural Motion**
Removes motion judder and reproduces smooth movement especially in movies.
- **100 Hz Clear LCD**
Gives a superior motion sharpness, better black level, high contrast with a flicker-free, quiet image and a larger viewing angle.
- **Advanced sharpness**
Enables superior sharpness, especially on lines and contours in the picture.
- **Dynamic contrast**
Sets the level at which the TV automatically enhances the details in dark, middle and light areas of the picture.
- **Dynamic backlight**
Sets the level at which power consumption can be reduced by dimming the brightness intensity of the screen.
Choose for the best power consumption or for the picture with the best brightness intensity.
- **MPEG artefact reduction**
Smooths the digital transitions in the picture.
- **Colour enhancement**
Makes the colours more vivid and improves the resolution of details in bright colours
- **Active control**
Corrects all incoming signals in order to provide the best picture possible.
Switches Active control on or off.
- **Light sensor**
Adjusts the picture and Ambilight settings on the lighting conditions of the room. Switches Light sensor on or off.
- **Picture format / Auto format mode**
See section 5.4.4 Widescreen picture format.

5.4.4 Widescreen picture format

Avoid black bars on the sides or on top and bottom of the picture. Change the picture format to a format that fills the screen.

- 1 Press to switch on the Picture format menu.

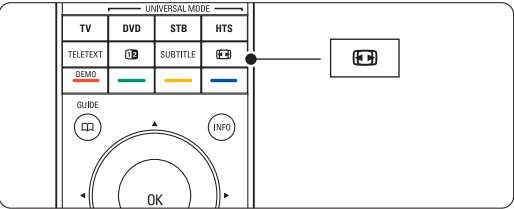

- 2 Press or to select an available picture format.
- 3 Press .
- 4 Press to shift the picture upwards if subtitles are hidden.

Tip

For minimal distortion, select the Auto format setting.

- **Auto format** (Not for PC.)
Enlarges the picture automatically to fill the screen. Subtitles remain visible. You can set Auto format in two different modes.

- 1 In the TV menu, select Picture > **Auto format mode**.

- 2 Select **Auto-fill** to fill the screen as much as possible. Select **Auto-zoom** to keep the original picture format but black bars may be visible.

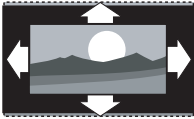

- **Super zoom** (Not for HD.)
Removes the black bars on the side of 4:3 broadcasts. There is a minimal distortion.

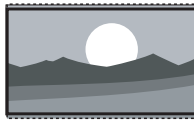

- **4:3** (Not for HD.)
Shows the classical 4:3 format.

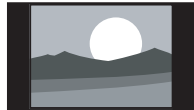

- **Movie expand 14:9** (Not for HD.)
Scales the format to 14:9.



- **Movie expand 16:9** (Not for HD.)
Scales the format to 16:9.
- **Wide screen**
Stretches the format to 16:9.
- **Unscaled** (Only for HD and PC.)
Maximum sharpness. Distortion may appear on borders. Black bars may appear with pictures from your PC.

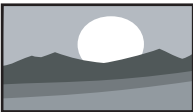
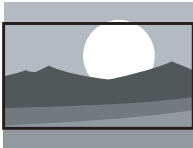

Note

Do not forget to name the connection in the Connection menu. See section 7.5.1 Naming your devices.

5.4.5 Sound settings

This section describes how to adjust all sound settings.

- 1 Press **Menu** and select **Sound**.
- 2 Press to enter the list.
- 3 Press or to select a setting.

TV menu	Sound
Smart settings	Equalizer
Picture	Volume
Sound	Volume - Visually...
Ambilight	Balance
Settings assistant	Audio language
Features	Dual I/II
Setup	Mono/Stereo
	TV speakers
	Surround mode
	Headphone volume
	Auto volume level...
	Delta volume
	Auto surround

- **Equalizer**
Changes the bass and treble of the sound. Select each bar to change the setting.
- **Volume**
Changes the volume. When adjusting the volume with a volume bar appears. If you do not want it to appear go to Menu > Setup > Installation > **Preferences** and press to enter the list and select Volume bar off.

- **Volume – Visually impaired (UK only)**
Changes the volume of the selected Visually impaired audio language in the Setup, Installation menu. See section **6.1 Automatic installation**.
- **Balance**
Sets the balance of the left and right loudspeakers to fit best your listening position.
- **Audio language**
A list of audio languages for the current programme may be available when digital channels are installed and broadcasted.
To permanently change the audio language, see section **6 Channel installation**.
- **Dual I/II**
If broadcasted, you can choose between two different languages.
- **Mono/stereo**
If stereo broadcasting is available, you can select Mono or Stereo per TV channel.
- **TV speakers**
If you have connected an audio system to your TV, you can switch off the TV speakers.
If your audio system supports Easylink, see section **7.2.2 Easylink**.
Select **Automatic** to have the sound from your TV automatically reproduced by your audio system.
- **Surround mode**
To select a more spatial sound if broadcasted or if available from a connected device.
- **Headphone volume**
Changes the volume of the headphone.
You can mute the TV speakers with  on the remote control.
- **Auto volume levelling**
Reduces sudden volume differences like at the beginning of commercials or when switching from one channel to another.
Select on or off.
- **Delta volume**
Levels out volume differences between channels or connected devices.
1 Switch to the channel or device you want to level out the volume difference.
2 Select **Delta volume** in the Sound menu and change the volume level.
- **Auto surround**
Switches the TV automatically to the best surround sound mode dependant on the broadcast.
Select on or off.

5.5 Ambilight

You can adjust Ambilight settings.

- 1** Press **Menu**  and select **Ambilight**.
- 2** Press **►** to enter the list.
- 3** Press **▲** or **▼** to select a setting.

TV menu	Ambilight
Smart settings	Ambilight
Picture	Active mode
Sound	Brightness
Ambilight	Separation
Settings assistant	
Features	
Setup	

- **Ambilight**
Switches Ambilight on or off.
- **Active mode**
Adjusts the speed at which Ambilight responds to the on-screen images..
Relaxed sets Ambilight to change soft and smoothly with the images on screen.
Dynamic sets Ambilight to change quick and responsive.
- **Brightness**
Changes the light output of Ambilight.
- **Separation**
Sets the difference in colour level between the Ambilights at the sides of the TV.
Separation off gives a dynamic but uniform colour Ambilight.

⚠ Caution

To avoid bad infrared remote control reception, place your devices out of sight of Ambilight.

5.6 Teletext

Your TV has a 1200 pages memory that stores broadcasted teletext pages and subpages to reduce waiting time.

To select a teletext page see section 4.6 Select a Teletext page.

5.6.1 Select a teletext language

Some digital TV broadcasters offer the possibility to select your preferred teletext language. See section 6.1 Automatic installation.

5.6.2 Select pagenumber subpages

A teletext page number can hold several subpages. The pages are shown on a bar next to the main pagenumber.

- 1 Press **Teletext**.
- 2 Select a teletext page.
- 3 Press **◀** or **▶** to select a subpage.

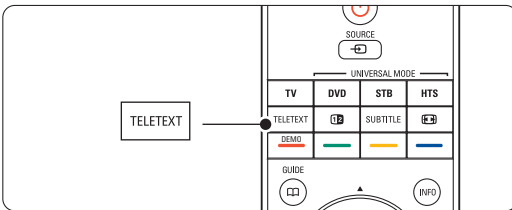

5.6.3 Select T.O.P. teletext broadcasts

T.O.P. teletext (Table of Pages) is not broadcast by all TV channels. You can easily jump from one subject to another without using pagenumbers.

- 1 Press **Teletext**.
- 2 Press **i**.
The T.O.P. overview appears.
- 3 Use **◀** or **▶**, **▲** or **▼** to select a subject.
- 4 Press **OK** to view the page.

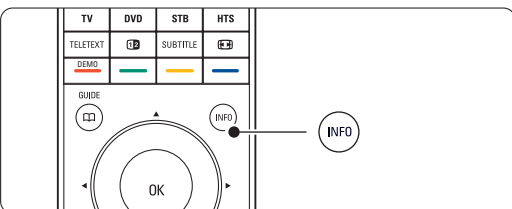

5.6.4 Dual screen teletext (not available for channels with Digital Text services)

View the TV channel and teletext next to each other.

- 1 Press **12** for Dual screen teletext.
- 2 Press **Teletext** again to show normal teletext.
- 3 Press **Teletext** to switch off teletext.

5.6.5 Search teletext

Quickly jump to a subject linked to a series of pagenumbers or search for specific words in teletext pages.

- 1 Press **Teletext**.
- 2 Press **OK** to highlight the first word or number.
- 3 Press **◀** or **▶**, **▲** or **▼** to jump to the next word or number on the page.
- 4 Press **OK** to search a page which holds the highlighted word or number.
- 5 Press **▲** until no word or number is highlighted to quit Search.

5.6.6 Enlarge teletext pages

For a more comfortable reading, you can enlarge the teletext page.

- 1 Press **Teletext** and select a teletext page.
- 2 Press **⌂** to enlarge the top part of the page.
- 3 Press **⌂** again to view the enlarged lower part of the page.
- 4 Press **▲** or **▼** to scroll through the enlarged page.
- 5 Press **⌂** again to return to the normal page size.

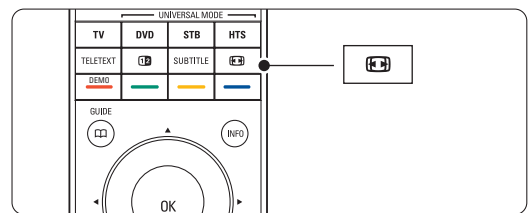

5.6.7 Teletext menu

With the options in the teletext menu you can reveal hidden info, let cycle subpages automatically and change the character setting.

- **Reveal**
Hide or unhide hidden information on a page, such as solutions to riddles or puzzles.
- **Cycle subpages**
If subpages are available for the selected page, you can make subpages cycle automatically.

- **Language**

Some languages use a different set of characters. Switch to the other group to show the text correctly.

- 1 Press **Teletext**.
- 2 Press **Menu** .

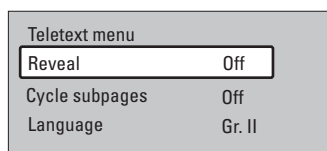

- 3 Press **▲** or **▼** to select an option.
- 4 Press **OK** to change a setting.
- 5 Press **Menu**  to quit the teletext menu.
- 6 Press **Teletext** to switch off teletext.

5.6.8 Digital text services (UK only)

Some digital TV broadcasters offer dedicated digital text or interactive services (for example BBC1) on their digital TV channels. These services work as normal Teletext with the number, colour and navigation keys to select and navigate.

- 1 Press **Teletext**.
- 2 Press **◀** or **▶**, **▲** or **▼** to select or highlight items.
- 3 Press one of the colour keys to select an option.
- 4 Press **OK** to confirm or activate.
- 5 Press **■ Cancel** to cancel Digital text or interactive services.

⚠ Caution

Digital text services are blocked when subtitles are broadcasted and Subtitle On is set in the Features menu. See section **5.10 Subtitles**.

5.6.9 Teletext 2.5

If broadcasted by the TV channel this teletext offers more colours and better graphics.

Teletext 2.5 is switched on as a factory setting.

- 1 Press **Menu**  on the remote control and select Setup > Installation > Preferences > **Teletext 2.5** and press **▶** to enter the list.
- 2 Select on or off.

5.7 Create favourite channel lists

View the All channels list or set up a Favourite list of your own with your preferred TV channels and radio stations.

5.7.1 Select a favourite list

You can select one of the favourite channel lists.

- 1 Press **OK**.

The first time after you have finished the installation, the All channels list is shown. In other situations, it brings up the last selected favourite list.

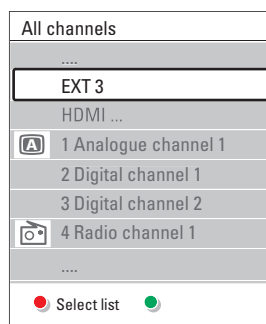

- 2 Press the red key to show all favourite lists.
- 3 Press **▲** or **▼** to select a list.
- 4 Press **OK**.
The selected favourite list appears.
- 5 Press **OK** again to quit.

5.7.2 To set up a favourite list

Create or modify your own favourite list.

- 1 Press **OK**.
The last selected list appears.
- 2 Press the red key to show all favourite lists.
- 3 Press **▲** or **▼** to select a list.
- 4 Press **OK**.
- 5 Press the green key to enter the Edit mode.
The selected list brings up a full channel list.
- 6 Press **▲** or **▼** to highlight a channel.
- 7 Press **OK** to mark (or unmark) the highlighted channel. The channel is added to (or removed from) the selected list.
- 8 Press the green key again to leave the Edit mode.
The modified channel list appears again.

5.7.3 Select a channel from a favourite list

- 1 Press OK.
The last selected channel list appears.
- 2 Use ▲ or ▼ to highlight a channel.
- 3 Press OK.
The TV tunes to that channel.

Tip

- Use -P+ to go through the TV channels of the selected favourite list.
- With the number keys you can still select channels which are not marked as favourite.

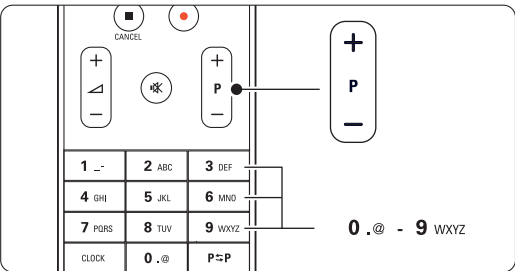

5.8 Electronic Programme Guide - EPG -

The Electronic Programme guide is an on screen guide to scheduled digital TV programmes. You can navigate, select and view programmes by time, title or genre. There are two types of EPG, 'Now and Next' and '7 or 8 day' EPG.

When digital channels are installed and broadcasted, EPG is available. 'Now and Next' is always available but the '7 or 8 day' EPG is only available in some countries.

With the EPG menu you can...

- see a list of current broadcasted programmes
- see the next programme
- group programmes by genre
- set reminders when programmes will start
- set up preferred EPG channels
- etc.

5.8.1 Switch on EPG

- 1 Press .

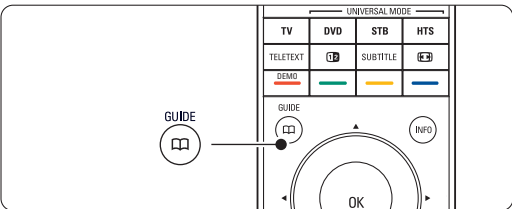

The following type of EPG appears:
'Now and Next' EPG
Detailed information about the current programme is shown.

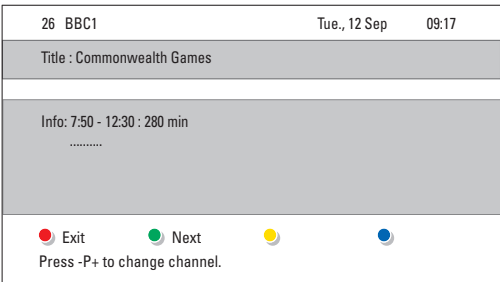

Or

'7 or 8 day' EPG

It may take some time to receive the EPG data. The list of TV programmes will show.

Programme guide			Tue., 12 Sep	
	Around	09:55	Next	
BBC ONE	07:50	Commonwealth	12:30	Commonwealth
BBC TWO	09:50	Tweenies	10:15	Something Special
five	09:00	The Wright Stuff	10:30	Trisha Goddard
BBC THREE	05:32	This is BBC THREE	12:00	This is BBC THREE
BBC FOUR	05:32	This is BBC FOUR	12:00	This is BBC FOUR
abc1	09:20	Moonlighting	10:15	Daddio
<div> ● Remind ● Watch ● Jump to ... ● Info </div>				
<div> 13:50 Anastasia 0010 - EEN </div>				

2 Use the colour keys to activate the available actions at the bottom of the screen.

- **Next:** to show information about the next programme.
- **Remind:** to mark or unmark a programme as a reminder.
- **Watch:** to watch or listen to a current programme.
- **Jump to...:** to jump to the next or previous day.
- **Info:** to display information on a selected programme (if available).

3 Press  to quit the EPG.

5.8.2 More on '7 or 8 day' EPG



Search by genre, scheduled reminders, etc. are managed in the Programme guide menu.

1 Press  on the remote control.



2 Press **Menu** .

The Programme guide menu appears.

Programme guide	What's on
What's on	12:30 South Today
Search by genre	11:50 Working Lunch
Scheduled remind...	11:55 Melrose Place
Preferred EPG ch...	13:00 In aller Freund
Acquire EPG data	

3 Press  or  to select a menu option.

4 Press  to enter.

5 Press  or  to make a selection.

6 Press **OK** to activate or press the green key to watch

7 Press  to quit the EPG.

Note

Only channels marked as Preferred EPG channels appear in the Programme guide menu.

5.9 Timers and locks

This section describes how to switch the TV on or off at a specified time and to lock or unlock the TV.

5.9.1 Automatically switch to standby



Sleeptimer switches the TV to standby after a time.

- 1 Press **Menu**  on the remote control and select **Features > Sleptimer** and press **▶** to enter the sleeptimer bar.
- 2 Press **▲** or **▼** to set the time up to 180 minutes in steps of 5 minutes. If set to 0 minutes, the Sleptimer is switched off.

You can always switch off your TV earlier or reset the time during countdown.

5.9.2 Automatically switch the TV on

On timer switches the TV on automatically to a specified channel at a specified time, from standby.

- 1 Press **Menu**  on the remote control and select **Features > On timer** and press **▶** to enter the On timer menu.
- 2 Use **◀** or **▶**, **▲** or **▼** to select and enter the menu items one by one to set a channel, a day of the week or daily, and a starting time.
- 3 Press **OK** to confirm.
- 4 Press **Menu**  to quit the menu.

⬆ Tip

To switch off the On timer, select **Off** in the On timer menu.

5.9.3 Lock TV channels and programmes

Lock TV channels and/or programmes from connected devices to prevent children from watching them. Lock and unlock with a four number code.

Set or change your code

- 1 Press **Menu**  on the remote control and select **Features > Set or Change code** and press **▶** to enter your code.
- 2 Enter your code with the number keys.
The **Features** menu reappears with a message confirming that your code has been created or changed.

Did you forget your code ?

- 1 Select **Change code**.
- 2 Press **▶**.

- 3 Enter the overriding code 8-8-8-8.
- 4 Enter a new personal code.
- 5 Confirm your new entered code.
The previous code is erased and the new code is stored.

5.9.4 Activate or deactivate Child lock

Set your code and you can:

- Lock all channels and devices,
- Lock specific channels and devices,
- Set a time after which all channels and devices are locked,
- Set the maximum allowed parental rating for digital channels that are installed and broadcast.

- 1 Press **Menu** .
- 2 Select **Features > Child lock** and press **▶**.
- 3 Enter your code with the number keys.
- 4 Select one of the options.
- 5 Press **▶**.

Lock or unlock all channels and connected devices

- 1 Select **Lock** or **Unlock**.

Lock a certain programme or all channels from a certain time

Child lock	Custom lock
Lock	Lock after
Custom lock	Channel lock
Unlock	Parental rating

- 1 Select **Custom lock**.
- 2 Press **▶** to enter the Custom lock menu.
- 3 Press **▶** again to enter the Lock after menu.
- 4 Select **On** to switch on the Timer lock.
- 5 Press **◀**.
- 6 Select **Time**.
- 7 Press **▶**.
- 8 Enter the time with **▲** or **▼** and **▶**.
- 9 Press **OK**.

Lock one or more channels and connected devices

- 1 Select **Custom lock**.
- 2 Press **▶** to enter.
- 3 Press **▲** or **▼** to select **Channel lock**.
- 4 Press **▶**.
- 5 Press **▲** or **▼** to select the channel(s) you want to lock or unlock.
- 6 Each time press **OK** to lock or unlock the channel.

Set an age rating to a digital programme

Some digital broadcasters have their programmes rated (depending on your country). When the rating is higher than your child's age, the programme will be locked.

- 1** Select **Custom lock**.
- 2** Press **►** to enter.
- 3** Press **▲** or **▼** to select **Parental rating**.
- 4** Press **►**.
- 5** Press **▲** or **▼** to select an age rating.
- 6** Press **Menu**  to quit the Child lock menu.

5.10 Subtitles

For each TV channel, subtitles can be set, coming from Teletext or DVB-T (digital) broadcasts. If digital channels are installed and broadcasted, you can select your preferred subtitle language.



5.10.1 Subtitling from analogue TV channels

- 1** Select an analogue TV channel.
- 2** Press **Teletext** to switch on Teletext.
- 3** Enter the three number pagenummer of the subtitle page.
- 4** Press **Teletext** to switch off Teletext.

Note

The Teletext subtitle page of analogue channels must be stored for each TV channel separately.

5.10.2 Activate or deactivate subtitling

- 1** Press **Menu**  on the remote control and select **Features** > **Subtitle** and press **►** to enter the list.
- 2** Press **▲** or **▼** to select **On** to show the subtitles always or **On during mute** to show the subtitles only when the sound is muted with the  key on the remote control.
- 3** Press **◀** to return to the Features menu.

TV menu	Features
Smart settings	Common interface
Picture	Subtitle
Sound	Subtitle language
Ambilight	Sleeptimer
Settings assistant	Child lock
Features	Set/Change code
Setup	On timer
	Demo

5.10.3 Select a digital subtitle language

If subtitle broadcasting is available with digital channels, you can select a preferred subtitle language out of a list of broadcasted languages. The preferred subtitle languages set in the Installation menu are overruled temporarily.

- 1** Press **Menu**  on the remote control and select **Features** > **Subtitle language** and press **►** to enter the list of available languages.
- 2** Press **▲** or **▼** to select a subtitle language.
- 3** Press **OK**.

5.11 Watch and play your photos and music

Watch pictures or listen to music stored on a USB device (not supplied with the TV), a camcorder (only for photos) or from your PC network. Watch your pictures as a slideshow or listen to a self made music playlist.

Note

Philips is not responsible if your USB device is not supported nor shall Philips accept any liability for damage or loss of stored data.

5.11.1 Insert the USB device

- 1** Insert a device at the side of the TV while the TV is switched on.
A message appears that a USB device has been detected.

Note

In case the USB device does not automatically break in, press **Source**  > **USB/Memory devices** and press **OK**.
Select **Side** and press **OK** to display your camcorder content.







5.11.2 Remove the USB device

- 1** Press **Source** .
- 2** Remove the USB device.
- 3** Select TV or another connected device to watch a programme.











5.11.3 Watch your pictures, start a slideshow and play music







Look up your pictures in the Picture album of your USB device.

- 1 Select the Picture folder for the picture files you have stored on your USB device.

USB	Picture
 Picture	 Afrika_2001
 Music	 Paris_2006
	 My_car.jpg
	 Jean.jpg
	 Mary.jpg

- 2 Press **▶** to enter the Picture folder.
- 3 Press **▲** or **▼** to select a picture or a picture album.

Picture	Afrika_2001
 Afrika_2001	 Kenya.jpg
 Paris_2005	 Congo.jpg
 My_car.jpg	 Victoria.jpg
 Jean.jpg	 Dakar.jpg
 Mary.jpg	 Cairo.jpg

Afrika_2001	Afrika_2001
 Kenya.jpg	
 Congo.jpg	
 Victoria.jpg	
 Dakar.jpg	
 Cairo.jpg	

- 4 Press **OK** to watch the picture or to start a slideshow of the pictures in the album.
- 5 Press **OK** to pause the slideshow. Press again to restart.
- 6 Press one of the colour keys on the remote control to perform the corresponding function shown at the bottom of the screen.
If the function bar at the bottom disappeared, press any colour key to let it reappear.
- 7 Press **◀** and select another picture or another album.

Slideshow settings







- **Details / More details**
Shows the picture name, date, size and next picture in the slideshow.
- **Transitions**
Shows the list of available transition styles of the pictures.
Press **▲** or **▼** to select and press **OK** to activate.

- **Slide time**
Sets the time lag for the picture transitions:
Short, Medium or Long.
- **Rotate**
To rotate a picture.
- **Start/Show/Pause**
To stop, pause and restart the slideshow.

Thumbnails

Watch the pictures of a selected album in an overview.

- 1 Select a picture album.
- 2 Press **▶** to enter the picture list.
- 3 Press the blue key.
- 4 Press **▲** or **▼**, **◀** or **▶** to highlight a picture.
- 5 Press **OK** to watch the picture.
- 6 Press **◀** to return to the thumbnail overview.
- 7 Press the blue key again to go back to the picture list.

USB	Afrika_2001	Kenya.jpg
		
		

Listen to music

Look up your songs in the Music album of your USB device.

- 1 Select the Music folder for the music files you have stored on your USB device.
- 2 Press **▶** to enter the Music folder.
- 3 Press **▲** or **▼** to select a song or a music album.
- 4 Press **OK** to play the selected song or to play a song followed by the next song in the same album.
- 5 Press one of the colour keys on the remote control to perform the corresponding function shown at the bottom of the screen.
If the function bar at the bottom disappeared, press any colour key to let it reappear.

Music settings

- **Details**
Shows the file name.
- **Repeat one/all**
Repeat all songs in the album until you stop a song or only repeat the one song selected until you stop the song.
- **Shuffle**
Play songs in a random sequence.

Watch a slideshow with background music

Watch a slideshow of your stored pictures accompanied with your stored background music.

- 1** Select an album of songs first and press **OK**.
- 2** Highlight the Picture folder and select an album of pictures and press **OK**.

5.11.4 Watch photos or listen to music from your PC

To watch photos and listen to music from a connected PC, make sure:

- your router and PC are switched on
- a media server software is running on your PC.

See section **7.7 PC network**.

- 1** Press the **Source**  key on the remote control.
- 2** Select **PC network** and press **►**.
Wait until the PC content comes on.
- 3** Select the content you want to watch or listen to and press **►**.
- 4** Use **◀** or **►**, **▲** or **▼** to go through the photo or music files or folders.
- 5** Press **OK** to watch or listen.
- 6** Press **◀** to go back to the previous list.

See section **9 Troubleshooting** in case of problems playing files or in case your PC does not appear in the PC network menu.

5.12 Listen to digital radio channels

If digital broadcasting is available, digital radio channels are installed during installation.

To listen to a digital radio channel:

- 1** Press **OK** on the remote control.
The **All channels** menu is displayed.
- 2** Use the number keys to select a radio channel available from channel number 400 onwards.
To reorder see section **6.3.3 Reorder the channels**.
- 3** Press **OK**.

5.13 Software update

Philips continually tries to improve its products. To benefit, update the TV software regularly. To update your TV software you need a USB Memory device (not supplied).

Verify that your USB memory device has at least 128Mb free space. Make sure the write protection is switched off. Some USB devices do not work with our TV.

5.13.1 Update assistant

The Update assistant helps you to update the TV's software.

Step 1: TV identification

The TV has to identify with your USB memory device.

- 1 Press **Menu**  > **Setup**.
- 2 Press **▶**.
- 3 Press **▲** or **▼** to select **Software update**.
- 4 Press **▶**.

Setup	Software update
Installation	Update assistant
Software update	Current software ...
	Local updates
	Announcement

- 5 Press **▲** or **▼** to select **Update assistant**.
- 6 Press **▶**.
- 7 Press **OK** to activate.
- 8 Insert a USB memory device into the USB connector at the side of the TV.
The TV menu appears.
- 9 Press the green key to proceed.
A message appears that the TV has successfully written its identification file to the USB memory device.
- 10 Press the green key again to finish.
- 11 Remove the USB memory device from the TV.

Step 2: Software download from the PC to the USB device

- 1 Insert the USB memory device into a PC linked to the internet.
- 2 Locate and open the file **update.htm** on your USB device.
- 3 Read the instructions on screen and click on the **Send ID** button.
If new software is available, the update is downloaded on the USB memory device.
- 4 Remove the USB memory device from your PC.

Step 3: Software update transfer to the TV

The downloaded software on the USB memory device must now be uploaded to your TV.

⚠ Caution

- Never remove the USB memory device from the TV during the software update.
- If a power drop occurs during the update, do not remove the USB memory device from the TV. When the power returns, the TV continues to update.

- 1 Switch on the TV.
- 2 Insert the USB memory device to the USB connector at the side of the TV.

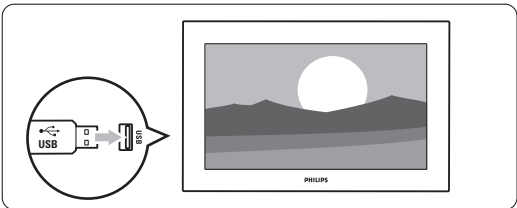

- 3 The TV switches off. The screen stays black for about 10 seconds. Wait and do not use the power switch  on the TV.

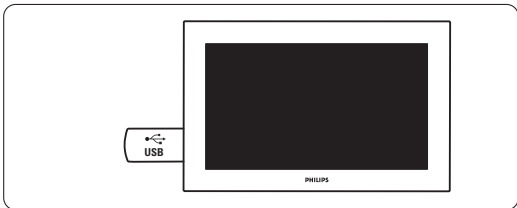

- 4** The update process starts automatically. Please wait.

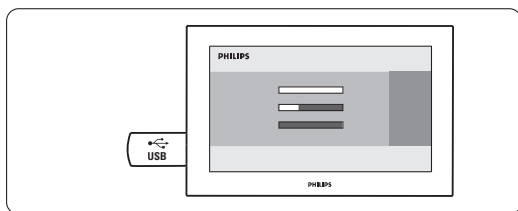

The update is finished when the message 'Operation successful' appears on the screen.

- 8** The TV switches back on again. The update is done.

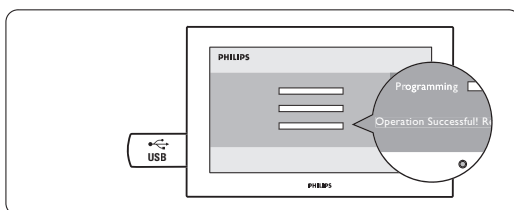
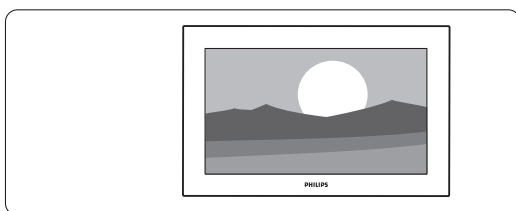

- 5** Remove the USB memory device from the TV.

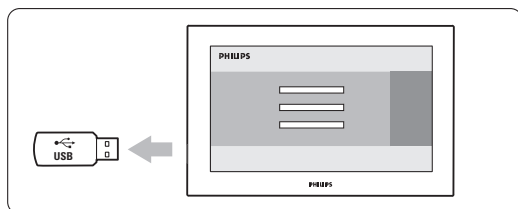

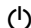
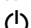
- 6** Press  on the remote control. Do not press more than once and do not use the **Power**  switch on the TV.

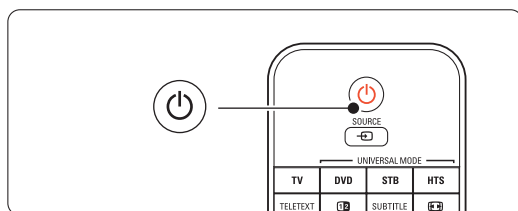

- 7** The TV switches off. The screen stays black for about 10 seconds. Please, wait.

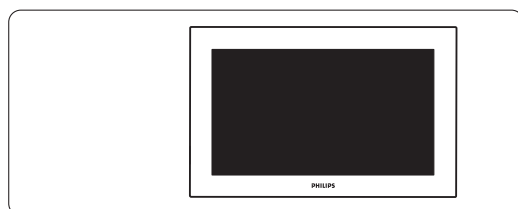

5.13.2 Software update by digital broadcast (DVB-T)

Your TV might receive new software from the digital broadcast system automatically.

If you receive an update message on screen it is strongly advised to update the software immediately - select **Now**.

If you want to be reminded later on, select **Later**.

Select **Cancel** to quit the update (not recommended). If you cancelled the update you can still update yourself from the TV menu > Setup > Software update > Local updates.

6 Channel installation

The first time you turned on your TV

- you have selected the language of the TV menus and the country where you are located
- all the available TV Channels have been installed.

This chapter provides instructions on how to reinstall channels as well as other useful channel installation features.

 **Note:**
Re-installation will modify the All channels list and new added channels will not be added to any favourite list.

6.1 Automatic installation

This section describes how to search for and store all available channels automatically.

Step 1: Menu language

Sets the language of the TV menus. Go to a next step if your language settings are correct.

- 1** Press **Menu**  on the remote control and select Setup > Installation > **Languages** and press **▶** to enter **Menu language**.
- 2** Press **▲** or **▼** to select your language.
- 3** Press **OK** to confirm.
- 4** Press **◀** to return to the Installation menu.

Installation	Languages
Languages	Menu language
Channel install...	Primary audio
Preferences	Secondary audio
Rem. contr. assist.	Primary subtitles
Connections assist.	Secondary subtitl...
Rename devices	Primary teletext
Audio setup	Secondary teletext
...	Hearing impaired
	Visually impaired
	Pref. audio format

The Languages menu also offers the following language settings when digital channels are installed and broadcasted.

- **Preferred audio language**
Select one of the available audio languages as primary preferred and secondary preferred language.
- **Preferred subtitle languages**
Select one of the available subtitle languages as primary preferred and secondary preferred language. See section **5.10 Subtitles**.

- **Preferred teletext languages**
Select one of the available teletext languages as primary referred and secondary preferred language.
- **Hearing impaired**
Select **On** to display the hearing impaired subtitle version of your preferred audio or subtitle language when available.
- **Visually impaired (UK only)**
Select to hear the additional commentary audio (if available) in your selected audio language through the loudspeakers of your TV or through the headphones or through both

 **Note:**
If both Visually impaired and Hearing impaired are enabled, the Visually impaired language will have priority for audio, the Hearing impaired for subtitles.

- **Preferred audio format**
Select your preferred and available audio format to achieve the best sound reproduction.
Select **Advanced** for the best sound reproduction if a Home theatre system is connected to your TV. Select **Standard** in all other cases.

Step 2: Select your country

Select the country where you are located. The TV will install and arrange the TV channels according to the country selected. Go to a next step if your country selection is correct.

- 1** Press **▼** to select **Channel installation**.
- 2** Press **▶** to enter the Channel installation menu.
Automatic installation is highlighted.
- 3** Press **▶** to enter.
- 4** Press **OK**.
The Country list appears.
- 5** Press **▲** or **▼** to select your country.
- 6** Press **Next**.

Channel install...	Automatic install...
Automatic install...	Start now
Installation update	
Start-up message	
Digital: Test recept...	
Analogue: Manual...	
Rearrange	

Step 3: Select Antenna or Cable

This selection is only available when this TV is prepared to receive DVB-C channels in your country.

Select **Antenna** to install all digital terrestrial (DVB-T) and analogue channels available.

Select **Cable** to install all digital cable (DVB-C) and analogue channels available.

- 1 Press ▲ or ▼ to select **Antenna** or **Cable**.
- 2 Press **Next**.
- 3 If the TV asks for it, enter the Network ID you received from your provider.

Note

You can do a Channel installation if you are both connected to a digital antenna and a cable network. Therefore do the installation twice. To watch the stored Antenna channels or the stored Cable channels, you will have to switch between Antenna or Cable in the Channel installation > Antenna or Cable menu.

Step 4: Install TV and radio channels

Your TV will search for and store all available digital and analogue TV channels and all available digital radio channels.

If you selected Cable in Step 3, a Settings menu is available. Leave these settings unchanged unless your provider supplied specific values to use for Network frequency, Network ID or Symbol rate. Follow the text on screen to change the settings. Use the digit keys to enter the numbers. You can also select to install analogue channels or not.

- 1 Select **Start**.
The installation may take a few minutes.
In case of Cable selection, the TV can ask to enter the Network ID supplied by the cable provider. Enter this ID with the digit keys.
- 2 When the installation is done, press **Finish** to return to the Channel installation menu.
- 3 Press **Menu**  to quit the menu.

Tip

When digital channels are found, the list of installed channels may show some empty channel numbers. If you want to rename, reorder or uninstall stored channels, see section **6.3 Rearrange channels**.

Step 5 Clock, time zone and daylight saving selection

Only available when the country selected supports digital broadcasts.

Go to a next step if this step is not applicable.

- 1 Press ▼ to select **Clock**.
- 2 Press ► to enter.
- 3 Press ▲ or ▼ to select **Auto clock mode**.
- 4 Press ► to enter.

Installation	Clock
...	Auto clock mode
Connections assist.	Time zone
Rename devices	Daylight saving
Audio setup	
Decoder	
Man. network inst.	
Clock	
Factory settings	

Auto clock mode

Select **Automatic** to instruct your TV to always get the time correctly. Time zone and Daylight saving correction are automatically set.

Select **Manual** when Universal Time Coordinated (UTC) is not available in your area.

Time zone/Daylight saving

When you selected Auto clock mode manually, select your local time zone and choose between **Standard** (winter) and **Daylight saving time** (summer).

6.2 Analogue: Manual installation

You can tune-in analogue TV channels channel by channel manually with Manual installation.

6.2.1 Select the system

- 1 Press **Menu**  and select Setup > Installation > Channel installation > **Analogue: Manual installation**.
- 2 Press **▶** to enter the Manual installation menu. **System** is highlighted.
- 3 Press **▶** to enter the System list.
- 4 Press **▲** or **▼** to select your country or part of the world where you are now located.
- 5 Press **◀** to return to the Manual installation menu.

Channel install...	Analogue: Manual...
Automatic install...	System
Installation update	Search
Start-up message	Fine tune
Digital: Test recept...	Store current ch...
Analogue: Manual...	Store as new ch...
Rearrange	

6.2.2 Search for and store a new channel

- 1 Press **Menu**  and select Setup > Installation > Channel installation > Analogue: manual installation > **Search**.
- 2 Press **▶** to enter the Search menu.
- 3 Press the red key to enter the frequency yourself or press the green key to search for a next channel.



Tip

If you know the frequency, enter the three numbers of the frequency with the number keys of the remote control.

- 4 Press **◀** when the new channel has been found.
- 5 Select **Store as new channel** to store the new channel under a new channel number.
- 6 Press **▶** to enter.
- 7 Press **OK**. **Done** appears.
- 8 Press **Menu**  to quit the channel installation menu.

6.2.3 Fine tune a channel

Fine tune a found channel when the reception is poor.

- 1 Press **Menu**  and select Setup > Installation > Channel installation > Analogue: manual installation > **Fine tune**.
- 2 Press **▶** to enter the Fine tune menu.
- 3 Press **▲** or **▼** to adjust the frequency
- 4 Press **◀** when you finished fine tuning.
- 5 Select **Store current channel** to store the fine tuned channel under the current channel number.
- 6 Press **▶** to enter.
- 7 Press **OK**. **Done** appears.
- 8 Press **Menu**  to quit the Channel installation menu.

6.3 Rearrange stored channels

To rename, reorder, uninstall or reinstall stored channels.

6.3.1 Rename a channel

Assign or change a channel name to a channel for which a name has not yet been entered.

- 1 Press **Menu**  and select Setup > Installation > Channel installation > **Rearrange**.
- 2 Press **▶** to enter the channel list.
- 3 Press **▲** or **▼** in the channel list to select the channel you want to rename.
- 4 Press the red key.
- 5 Press **◀** or **▶** to select a character or **▲** or **▼** to change the characters. Space, numbers and other special characters are located between **z** and **A**.
- 6 Press the green key or **OK** to finish.

Tip

To delete all characters, press the yellow key.
To delete the highlighted characters, press the blue key..

6.3.2 Uninstall or reinstall a channel

To uninstall a stored channel so that it is no longer possible to tune to.



Reinstall an earlier uninstalled channel.

- 1 Press **Menu**  and select Setup > Installation > Channel installation > **Rearrange**.
- 2 Press **▶** to enter the channel list.

- 3 Press ▲ or ▼ in the channel list to select the channel you want to uninstall or reinstall.
- 4 Press the green key to uninstall or reinstall the channel.
- 5 Press **Menu**  to quit the menu.

6.3.3 Reorder the channels

Change the order of the stored channels.

- 1 Press **Menu**  and select Setup > Installation > Channel installation > **Rearrange**.
- 2 Press ► to enter the channel list.
- 3 Press ▲ or ▼ in the channel list to select the channel you want to reorder.
- 4 Press the yellow key to move up the highlighted channel in your channel list.
- 5 Press the blue key to move down the highlighted channel in your channel list.
- 6 Press **Menu**  to quit the menu.

6.4 Channel management

6.4.1 Automatic search

Once a day, at 3 AM, the TV searches for all available TV channels automatically. Leave your TV in standby.

Earlier found channels are updated and new channels are stored. Channels not found by the search anymore are removed from the channel list. When Channel management has found or removed channels, a message at TV start up is shown. You can activate or deactivate this message.

- 1 Press **Menu**  and select Setup > Installation > Channel installation > **Startup message**.
- 2 Select On or Off.

6.4.2 Manual search

You can install the updates at any time.

- 1 Press **Menu**  and select Setup > Installation > Channel installation > **Installation update**.
- 2 Press ► to enter the Installation update menu.
- 3 Press **OK**.
- 4 Press the green key to start.
The update starts and may take a few minutes.
- 5 When the update is completed, press the red key to return to the Channel installation menu.
- 6 Press **Menu**  to quit the menu.

6.5 Digital reception test

If you receive Digital TV broadcasting you can verify the quality and signal strength of a specific channel.



- 1 Select a channel.
- 2 Press **Menu**.
- 3 Select Setup > Installation > Channel installation > **Digital: Test reception**.
- 4 Press ► to enter
- 5 Press **OK**.
- 6 Press the green key to start the test.
Information on the quality and the signal strength of this channel is shown.
- 7 Use the cursor keys to change the frequency to improve the signal or enter a new frequency directly with the digit keys.
- 8 Press the green key to store the frequency if the signal quality and strength are good.
- 9 Press the red key to return to the Channel installation menu.
- 10 Press **Menu** to quit the menu.

⚡ Tip

To achieve the best results, contact a specialised antenna installer.

6.6 Factory settings

You might want to return to the original factory settings. Only picture, sound and Ambilight settings will be reset.

- 1 Press **Menu**  and select Setup > Installation > **Factory settings**.
- 2 Press ► to enter the Factory settings menu.
- 3 Press **OK**.
- 4 Press **Menu**  to quit the menu.

7 Connections

7.1 Connection overview

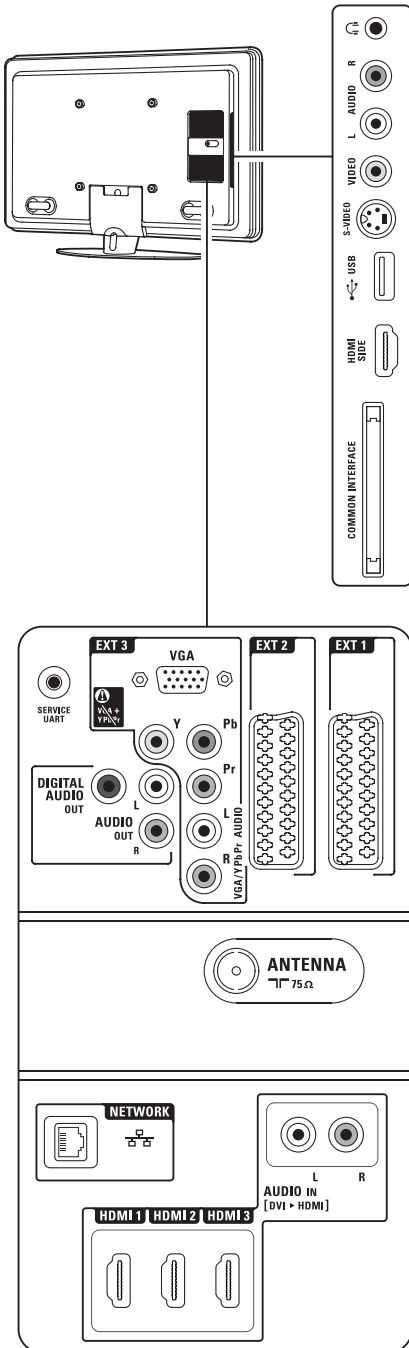

Side connectors

- 1 **Headphones**
Stereo Mini jack
- 2 **Audio L/R**
Audio L/R input to be used together with Video or S-Video on the side of the TV.
- 3 **Video**
Video input to be used together with the Audio L/R on the side of the TV.
- 4 **S-Video**
S-Video input to be used together with the Audio L/R on the side of the TV.
- 5 **USB**
USB connector.
- 6 **HDMI Side**
HDMI input
- 7 **Common interface**
Slot for Conditional Access Modules (CAM)

Back connectors

- 8 **EXT1, EXT2**
Scart connectors for DVD, VCR, Digital receiver, Game console, etc.
- 9 **EXT3**
Component Video Y Pb Pr and Audio L/R connectors for DVD, Digital receiver or Game console, etc.
VGA and Audio L/R connectors for a PC.
- 10 **Service UART**
For service only.
- 11 **Digital Audio Out**
Sound output cinch connector for a Home Theatre System, etc.
- 12 **Audio Out L/R**
Sound output cinch connectors for a Home Theatre System, etc.
- 13 **Antenna input**
- 14 **Network**
Home network connector.
- 15 **HDMI 1, HDMI 2, HDMI 3**
HDMI input connectors for Blu-ray Disc player, HD Digital receiver or HD Game console, etc.
- 16 **Audio L/R In [DVI to HDMI]**
Audio In L/R connectors to be used together with a DVI to HDMI connection.

7.2 About connections

7.2.1 What you need to know

Connect your device with the highest possible quality connection.

Look for the highest quality connection on your device. Use that connection to your TV.

HDMI - Highest quality ★★★★★

An HDMI connection has the best picture and sound quality. One cable combines video and audio signals. Use HDMI for HD (High Definition) TV signals. HDMI with EasyLink offers easy operating of your connected devices when these have the HDMI CEC standard. See section 7.2.2 EasyLink. A device connected with HDMI to the TV can only send out audio and video signals to your TV. The device cannot receive or record audio and video from your TV.

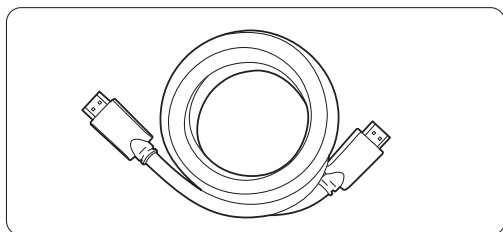

HDMI cable (max. 5m)

Tip

DVI to HDMI – Higher quality ★★★★★

Use a DVI to HDMI adaptor if your device has only a DVI connection.

Connect an Audio L/R cable to Audio In L/R (DVI to HDMI) for sound.

Assign this Audio In to the HDMI 1, 2 or 3 where the device is connected. See section 7.5.2 Audio setup (if present).

Note

HDMI supports HDCP (High-bandwidth Digital Contents Protection). HDCP is a copy protection signal that comes with HD content (DVD disc or Blu-ray Disc).

YPbPr – Higher quality ★★★★★

Use the Component Video YPbPr connections together with Audio Left and Right. Match the cable colours when you connect.

YPbPr can handle HD TV signals.

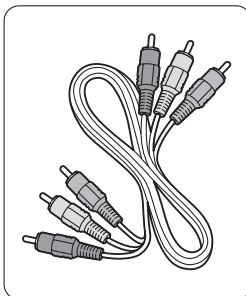

Component Video
YPbPr cable
- Red, Green, Blue

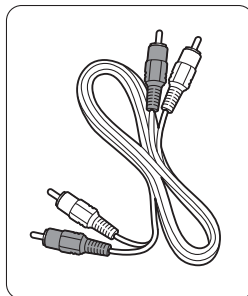

Audio L/R cable
- Red, White

Scart - Good quality ★★★

One cable combines video and audio signals.

Scart connectors can handle RGB video but no HD TV signals.

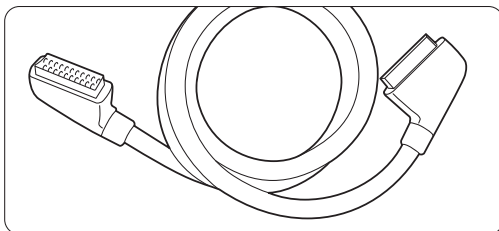

Scart cable

S-Video - Good quality ★★

Use an S-Video cable together with an Audio L/R (cinch) cable. Match the cable colours when you connect.

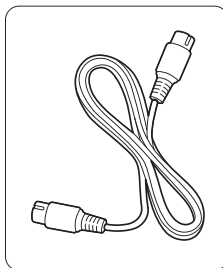

An S-Video cable

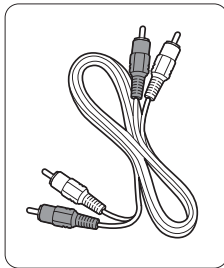

Audio L/R cable
- Red, White

Video - Basic quality ★

Use a Video (cinch) cable together with an Audio L/R (cinch) cable. Match the cable colours when you connect.

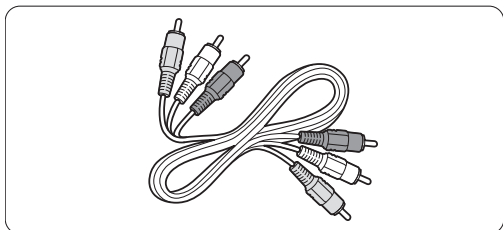

Combined Video - yellow and Audio L/R cable - red and white

7.2.2 HDMI with EasyLink

Connected devices that are compliant with the HDMI CEC standard can work together:

- 1** Press **Menu**  > Setup > Installation > Preferences and press **▶** to enter the list.
- 2** Press **▲** or **▼** to select **EasyLink**.
- 3** Press **▶** to enter.
- 4** Press **▲** or **▼** to select **On** or **Off**.
- 5** Select **On** to activate EasyLink.

EasyLink might not work with devices from other brands.

One touch play

Insert a DVD disc and press Play. The TV switches on from standby and shows the DVD programme automatically.

System standby

Press the  key on the remote control for more than 2 seconds to switch the connected devices in standby.

System audio control

When you connect an audio system you can listen to the sound from your TV through your audio system while the TV speakers are muted. See section **5.4.5 Sound settings, TV speakers**.

Note

Ensure that all HDMI-CEC features in the HDMI-CEC devices (for ex. Home Theatre System) are properly set up.

7.2.3 Display synchronised audio out

For the best match of image and sound in speech on screen, connect a Home Theatre System to Audio Out L/R or Digital Audio outputs. See diagrams **7.4.4** and **7.4.8**.

Do not connect the audio signal of a DVD player, digital receiver or other audio/video device directly to the Home Theatre System.

7.3 Connect with the Connection assistant

(if available)

Use the Connection assistant to show you how to connect your devices to your TV. It sets all necessary settings automatically.

You can also connect your devices without the use of the Connection assistant. See section **7.4**

Connect without the Connection assistant.

- 1** Press **Menu**  on the remote control and select Setup > Installation > **Connection assistant**.
- 2** Press **▶** to start the Connection assistant.
- 3** Press **OK**.

7.4 Connect without the Connection assistant

The connections shown in this section are recommendations for the most used cases. Other solutions are possible.

When a device is connected the TV needs to know what connection you made. See section **7.5**

Connection setup.

7.4.1 DVD player

Use a scart cable to connect the device to the **EXT1** input at the back of the TV.

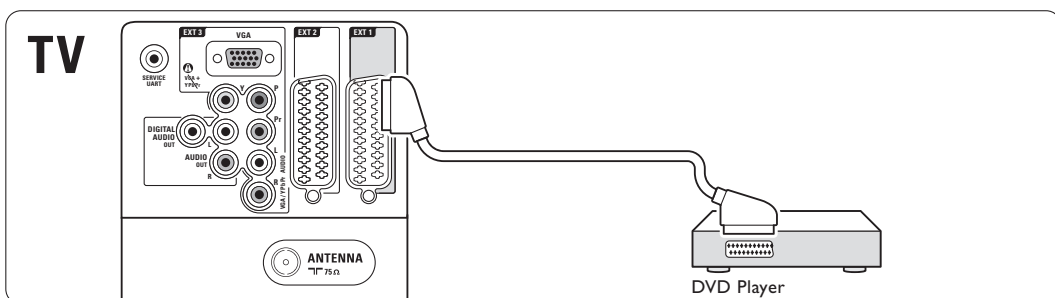

7.4.2 DVD Recorder or Digital Receiver

Use a scart cable and 2 antenna cables.

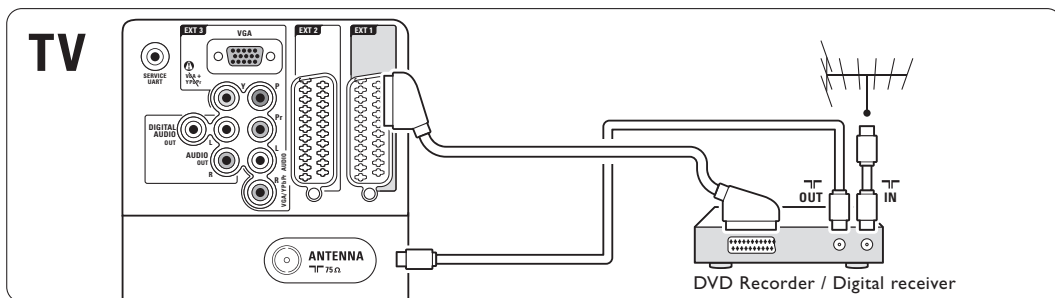

7.4.3 DVD Recorder and Digital Receiver

Use 3 scart cables and 3 antenna cables.

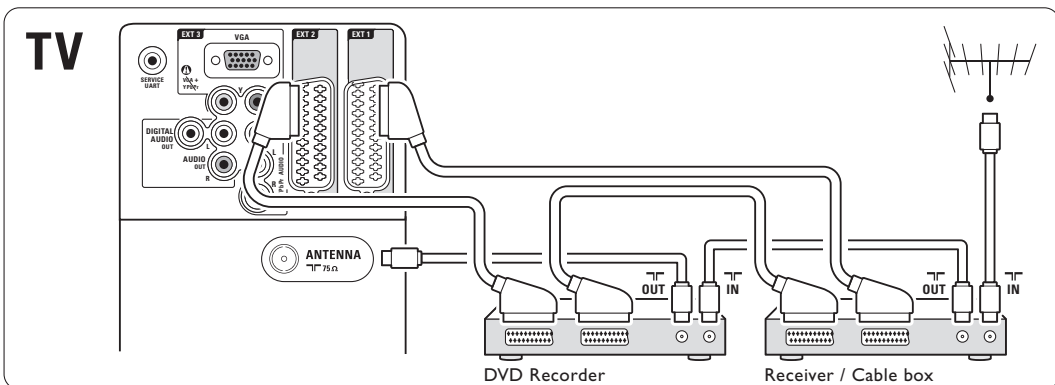

7.4.4 DVD Recorder and Home Theatre System

Use a scart cable, 2 antenna cables and 1 digital audio (cinch) cable.

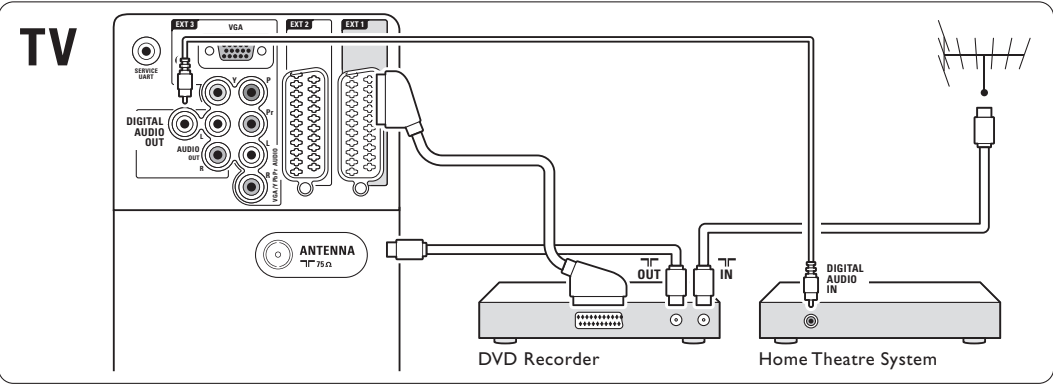

7.4.5 DVD Recorder and DVD Home Theatre System

Use 2 scart cables, 2 antenna cables and 1 digital audio (cinch) cable.

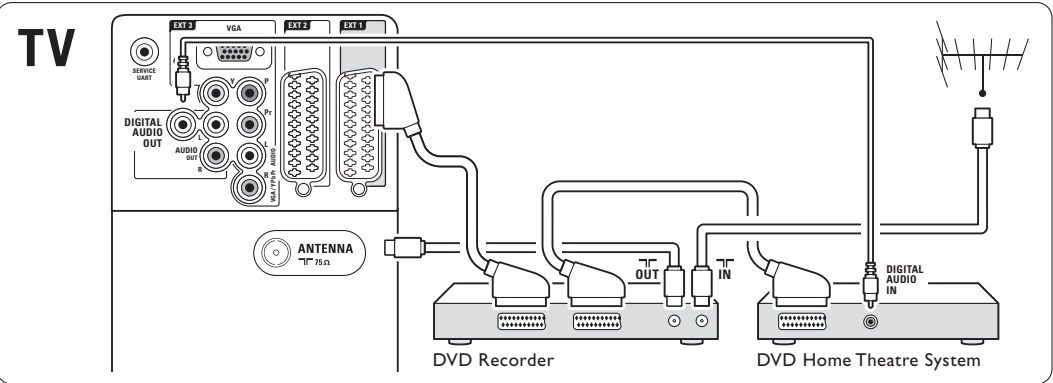

7.4.6 Satellite receiver

Use a scart cable and 2 antenna cables.

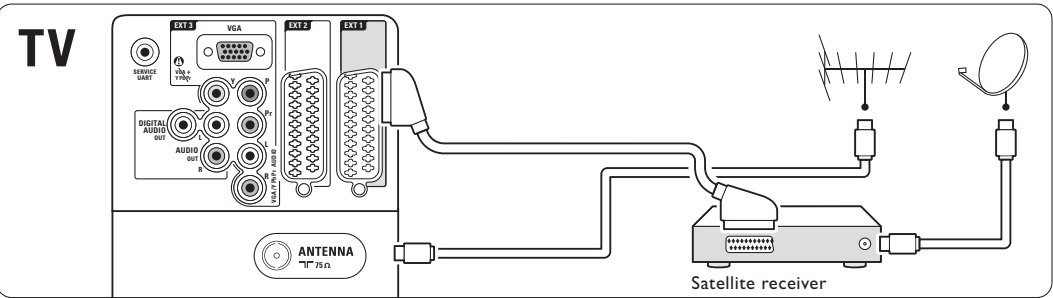

7.4.7 HD Digital receiver / HD satellite receiver

Use an HDMI cable and 2 antenna cables.

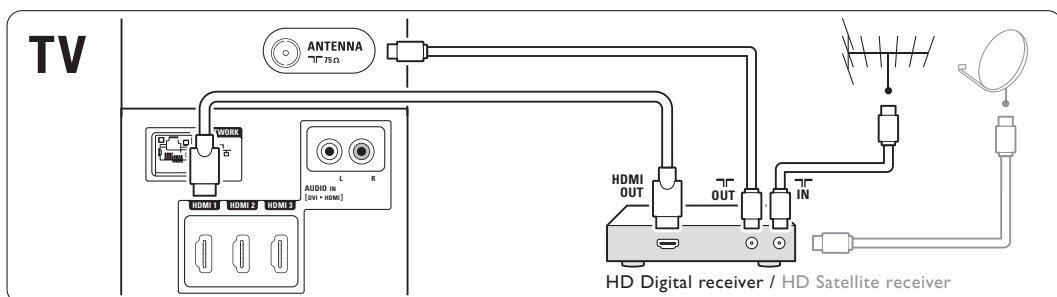

7.4.8 DVD-R, Home Theatre System and Digital receiver

Use 3 scart cables, 3 antenna cables and 1 audio (cinch) cable.

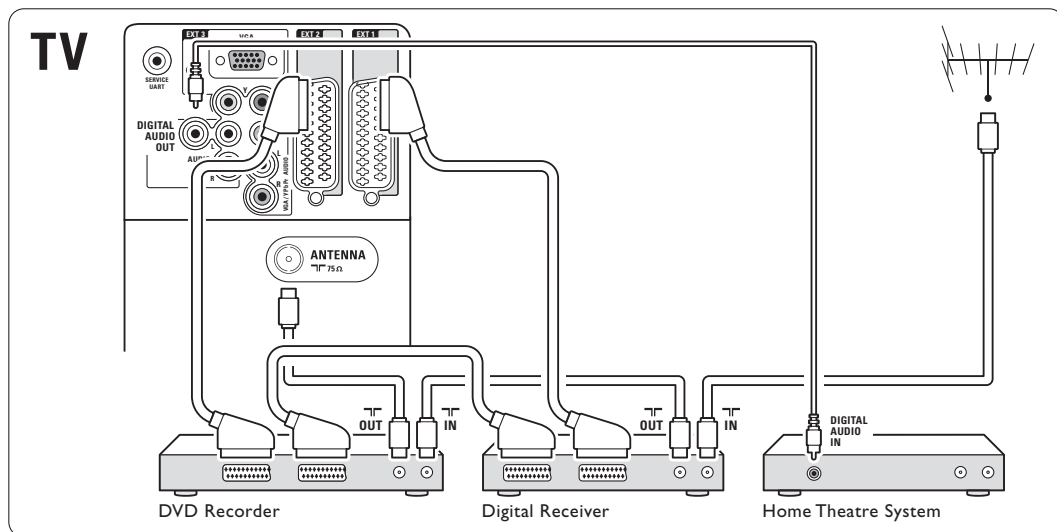

7.4.9 Blu-ray Disc player

Use an HDMI cable.

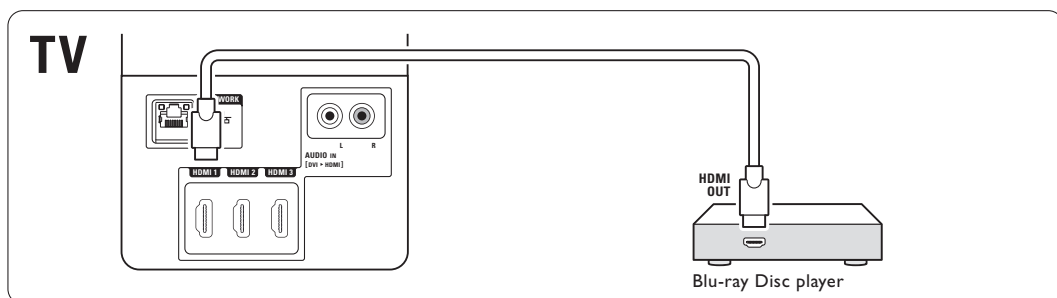

7.4.10 Game console

The most practical connections for a game console are at the side of the TV.

Note:

To prevent picture delay, set the TV in game mode. Press Menu > TV menu > Smart settings > Game.

Connected at the side of the TV

Use the HDMI connection or the S-Video and Audio L/R connections or the Video and Audio L/R connections.

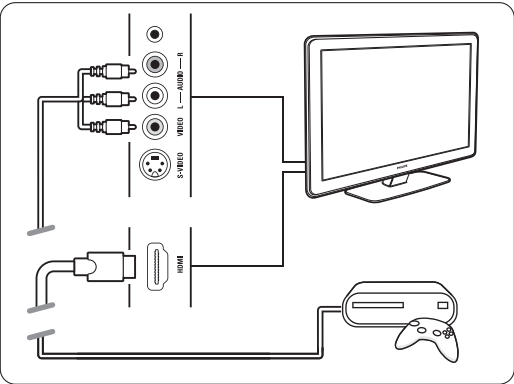

Connected at the back of the TV

Use an HDMI connection or the EXT3-YPbPr and Audio L/R connections for HD quality.

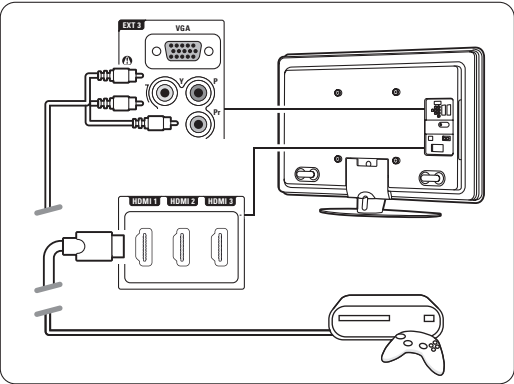

7.4.11 Camcorder

The most practical connection for a camcorder is at the side of the TV.

Connected at the side of the TV

Use the HDMI connection or the Video and Audio L/R connections or use the S-Video and Audio L/R connections.

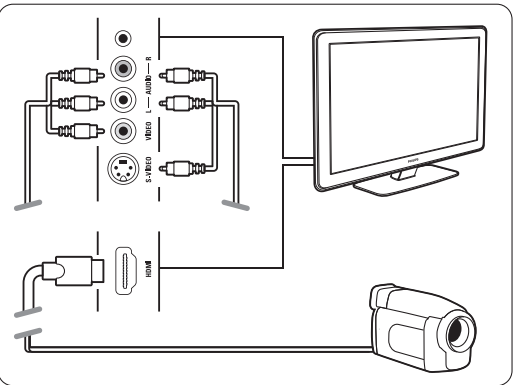

Connected at the back of the TV

Use an HDMI connection or the EXT3-YPbPr and Audio L/R connections for HD quality.

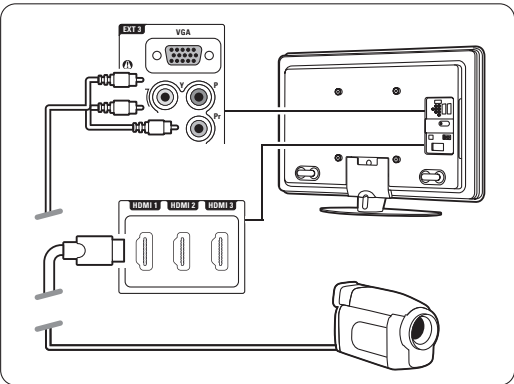

7.4.12 Personal Computer

You can connect your PC directly to the TV. The TV works as a monitor of your PC.

For more features you can connect your PC in a PC network. See section **7.7 PC network**.

As a monitor the PC can be connected at the side with a DVI to HDMI adaptor or with a PC to TV cable. Alternatively you can connect the PC at the back with the VGA connection.

⚠ Caution

Before connecting the PC, set the PC monitor refresh rate to 60Hz.

💡 Tip

Set the TV picture format to Unscaled in the Picture format menu for maximal PC picture sharpness. See section **5.4.4 Widescreen picture format**.

DVI to HDMI connection

Use a DVI to HDMI adaptor to connect to the HDMI side connection.

Connect the Audio L/R at the side for sound.

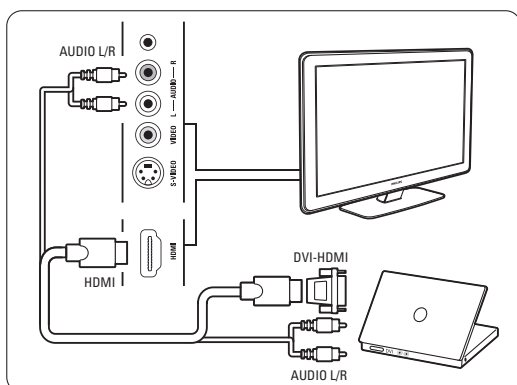

PC to TV connection

Use a PC-TV out cable to S-Video and Audio L/R cable to connect to the side of the TV.

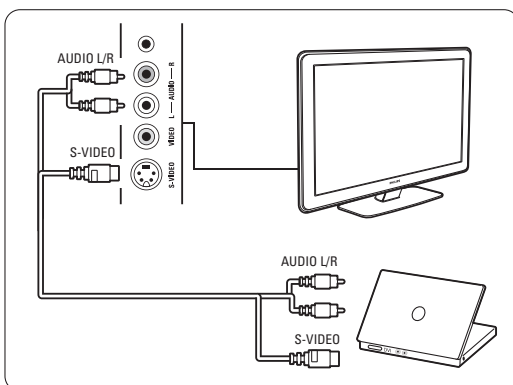

VGA connection

Use a VGA cable to connect the PC to the EXT3 connection at the back of the TV.

Connect the Audio L/R to the EXT3 Audio L/R.

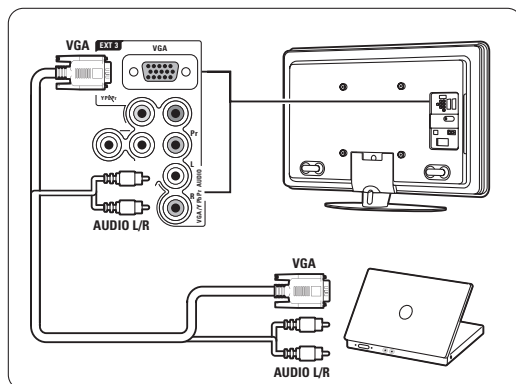

For supported PC monitor resolutions, see section **8 Technical data**.

7.5 Connection setup



The TV needs to know what connections you have made and which device is connected to which connector:

If you have used the Connection assistant the connection setup is already done.

7.5.1 Naming your devices

Name the connected devices for easy selection and best signal handling.

Assign the type of device (DVD,VCR, Game, ...) to the connector you use for that device.

- 1 Press **Menu**  on the remote control and select Setup > Installation> **Rename devices**.
- 2 Press **▶** to enter the list.
- 3 Press **▲** or **▼** to select the connector you used for the device you connected.
- 4 Press **▶**.
- 5 Press **▲** or **▼** to select the type of device.
- 6 Press **Menu**  to quit the menu.

7.5.2 Audio setup (if present)

If you use the Audio In L/R (DVI to HDMI) connector for a device connected to HDMI at the back of the TV, assign this Audio In to the HMDI 1, 2 or 3 where the device is connected.



- 1 Press **Menu**  on the remote control and select Setup > Installation > **Audio setup**.
- 2 Press **▶** twice.
- 3 Press **▲** or **▼** to select the HDMI connection to link with this Audio In.

Audio setup	Audio in L/R
Audio in L/R	None
	HDMI 1
	HDMI 2
	HDMI 3

7.5.3 Decoder channels

Decoders that decode an antenna channel are connected to **EXT1** or **EXT2** (scart).

You have to assign the TV channel as a channel to be decoded.Then assign the connection where the decoder is connected

- 1 Press **Menu**  on the remote control and select Setup > Installation > Decoder > **Channel**.
- 2 Press **▶** to enter the list.
- 3 Press **▲** or **▼** to select the channel to decode.
- 4 Press **◀** and go back to select **Status**.
- 5 Press **▲** or **▼** to select the connector used by the decoder.
- 6 Press **Menu**  to quit the menu.

Installation	Decoder
...	Channel
Connections assist.	Status
Rename devices	
Audio setup	
Decoder	
Man. network inst.	
Clock	
Factory settings	

7.6 Preparing for digital services

Scrambled digital TV channels can be decoded with a Conditional Access Module (CAM) and a Smart card provided by a digital TV service operator. The CAM may enable several services depending on the operator you choose (e.g. Pay TV).

Contact your digital TV service operator for more information and terms.

7.6.1 Insert a Conditional Access Module - CAM

Warning

Switch off the TV before inserting the CAM.

Look on the CAM for the correct inserting direction. Incorrect insertion can damage the CAM and the TV.

- 1** Gently insert the CAM into the **Common Interface** slot at the side of your TV as far as it will go.
- 2** Leave the CAM in the Common Interface slot permanently.

It can take a few minutes before a CAM is activated. Removing the CAM will deactivate the digital TV service.

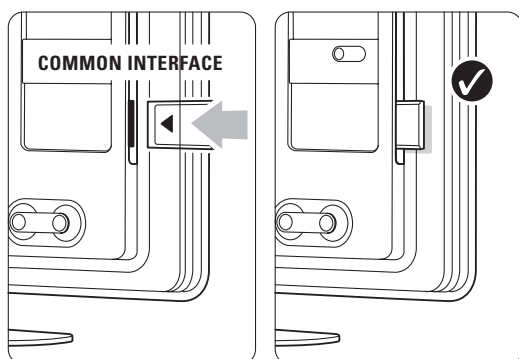

7.6.2 Common interface menu

From this menu you access the CAM service you have installed. The applications and their function, the content and the messages on screen come from the CAM service provider.

- 1** Press **Menu**  on the remote control and select **Features > Common interface**.

This menu option is available when a CAM is inserted and has made contact with the provider.

7.7 PC network

You can link up your TV on a PC network in your home. Watch your photos and listen to your music from any linked PC on the TV. The PC network feature of this TV is DLNA certified. You can use Microsoft Windows XP or Vista, Intel Mac OSX or Linux. An example of a home PC network.

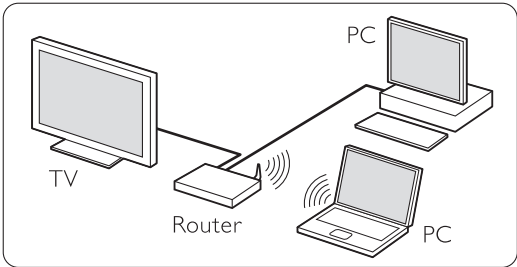

7.7.1 What you need

To set up your TV in a home PC network you need:

- a router and a computer in a home network
- a network cable
- recent media server software (Windows, media Player 11 or similar) on your computer.

For a complete list of compatible media server software see section 8 Technical data.

7.7.2 Set up a PC network connection

On the TV no special settings are necessary to connect automatically to the network.

- 1 Connect the network cable from your router to the **Network**  connector at the back of the TV.

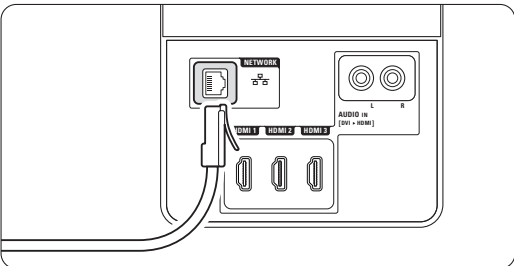

- 2 Switch on the router. Set the router to DHCP On.
- 3 Switch on the computer and start the media server software.

- 4 Some media server software needs a setting to share your files with the TV.

In the media server this TV will present itself as a number - a MAC or IP number.

Have the TV and router switched on for this number to appear in the media server.

Select the TV number in the media server and set the server to share files with this number.

For media server software marked with an * in sections 8 Technical data, a step by step setting instruction is available in the online User manual. Type in your TV model number on www.philips.com/support. In the extended User manual, see section 7.7 PC network.

A firewall, a security system on your computer, could also block the network connection.

Allow the media server software to go to the network.

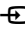
- 5 Press the **Source**  key on the remote control.
- 6 Select **PC network** and press **►**.
- 7 Use the colour and navigation/rotation keys to browse your folders or play your files.

If the TV cannot connect to the network, study the server software, router or PC manuals.

7.7.3 Manual network setup

Some expert network settings can be set on the TV. The DHCP is set to On to automatically connect to the network.

Press **Menu**  > Setup > Installation > Manual network installation.

7.7.4 Media server settings

Media servers need to be set for sharing their files and folders. Follow the instructions closely to set your specific server.

Windows Media Player v11 on Windows Vista

Set for network sharing

In **Windows Media Player** select **Library** from the menu and select **Media sharing**.

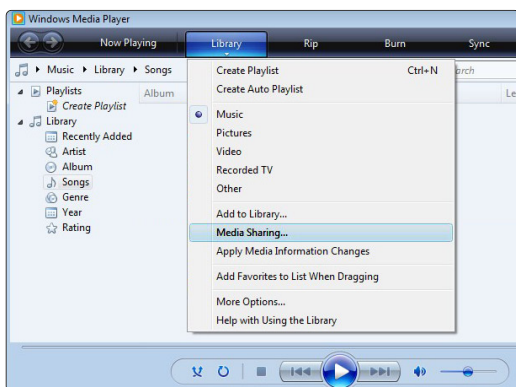

In the **Media Sharing** window, check the **Share my media** box. Click **OK**.

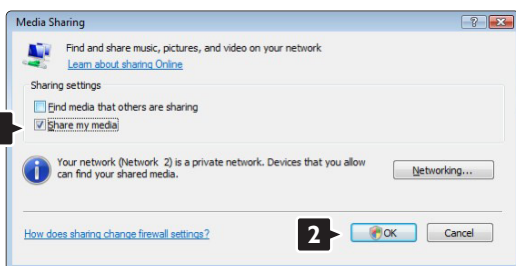

If no network connection was found, and you are unable to check this box, click the **Networking** button to show the **Network and Sharing Center** window, ...

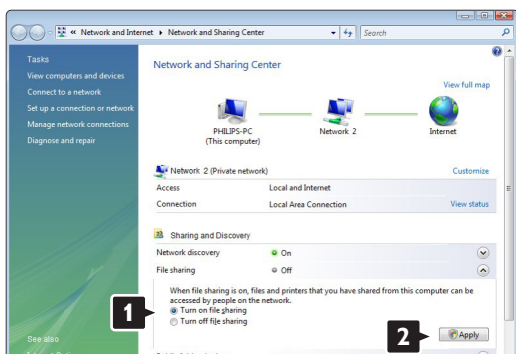

Set **Network discovery** to **On**. Set **File sharing** to **On**. Go back to the **Media Sharing** window in **Windows Media Player** and check the **Share my media** box. Click **OK**.

When the TV is connected, by the router, to the PC and everything is switched **On**, the **Media sharing** window will show the TV as an **Unknown Device**. Select the device and click **Allow**.

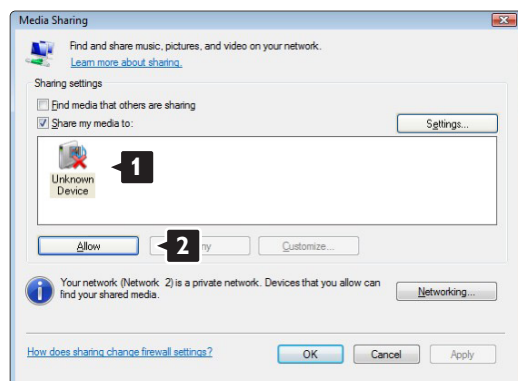

You can open the **Settings** window to change particular settings on sharing. When the device icon (the TV) is checked with a green tick, click **OK**.

Set folders for sharing

In **Windows Media Player** select **Library** from the menu and select **Add to Library**.

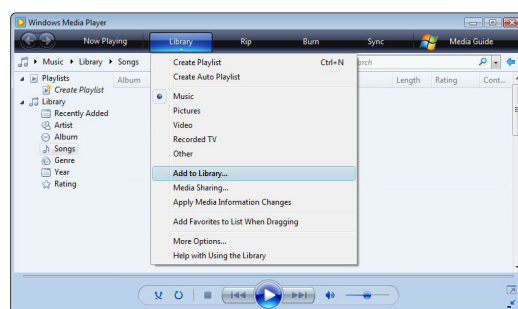

In the **Add To Library** window, select **My folders** and those of others that I can access and click the **Advanced Options** button. ...

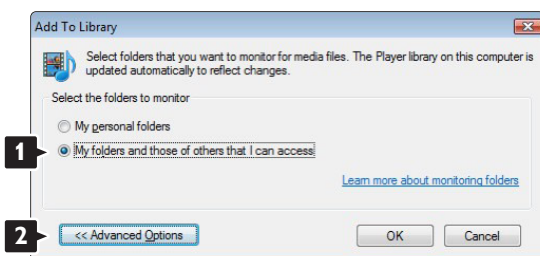

With **Advanced Options** open, you can add specific folders to the list to share. Click **Add**.

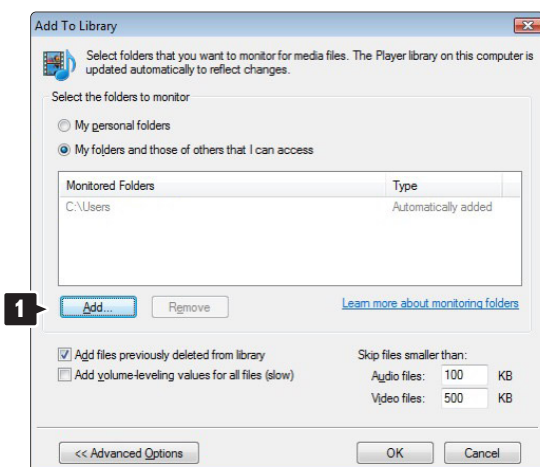

In the **Add Folder** window select a folder with music, photos or videos you want to share with other devices (your TV). Click **OK**.

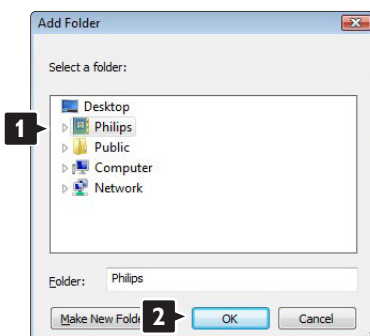

In the **Add To Library** window the newly added folder is shown. You can add more folders to share. Click the **OK** button to add the files to the library.

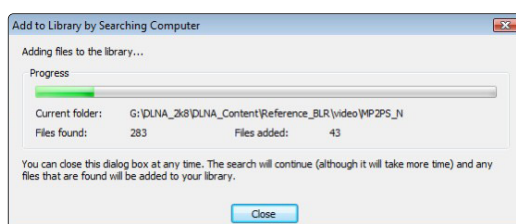
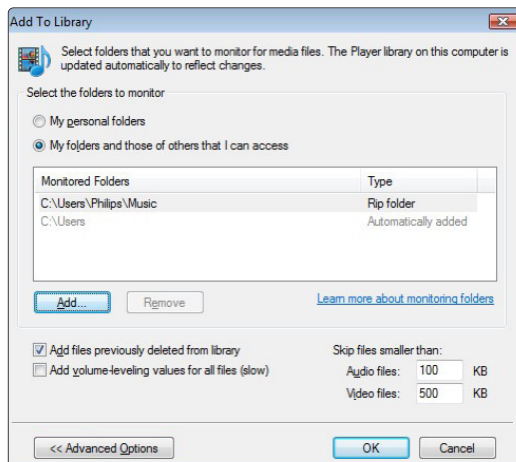

Now everything is set to enjoy music, photos and videos on your TV.

Windows Media Player v11 on Windows XP

Set for network sharing

In Windows Media Player select **Library** from the menu and select **Media sharing** ...

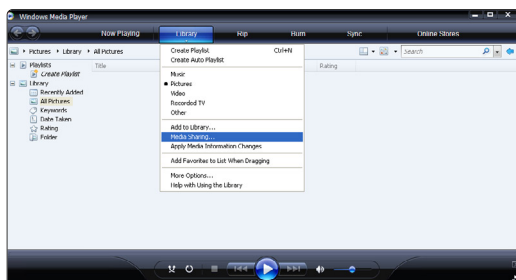

In the **Media Sharing** window, check the **Share my media** box.

When the TV is connected, by the router; to the PC and everything is switched On, the **Media sharing** window will show the TV as an **Unknown Device**. Select the device and click **Allow**.

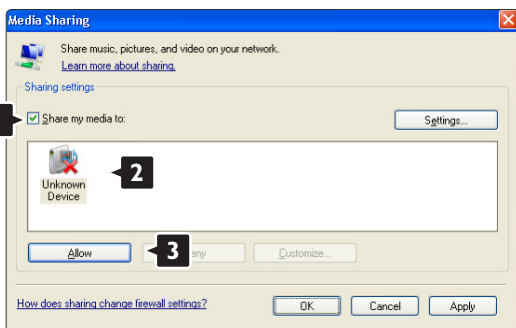

You can open the **Settings** window to change particular settings on sharing. When the device icon (the TV) is checked with a green tick, click **OK**.

Set folders for sharing

In Windows Media Player select **Library** from the menu and select **Add to Library**.

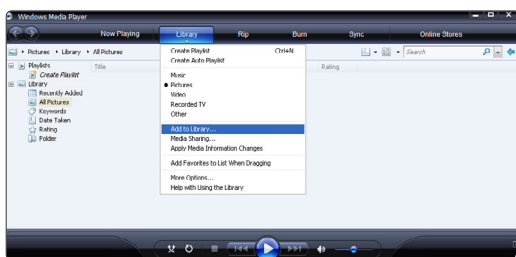

In the **Add To Library** window, select **My folders and those of others that I can access** and click the **Advanced Options** button.

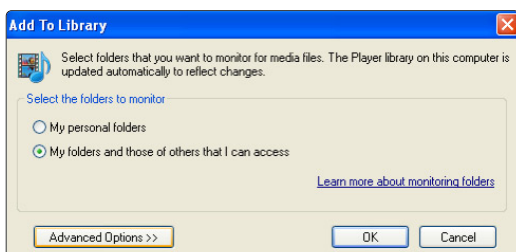

With **Advanced Options** open, you can add specific folders to the list to share. Click **Add**.

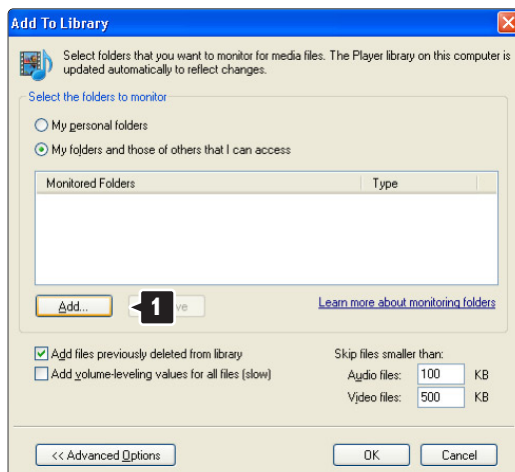

In the **Add Folder** window select a folder with music, photos or videos you want to share with other devices (your TV). Click **OK**.

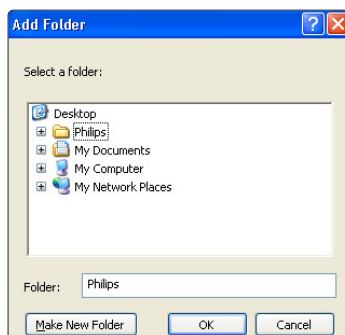

In the **Add To Library** window the newly added folder is shown. You can add more folders to share. Click the **OK** button to add the files to the library.

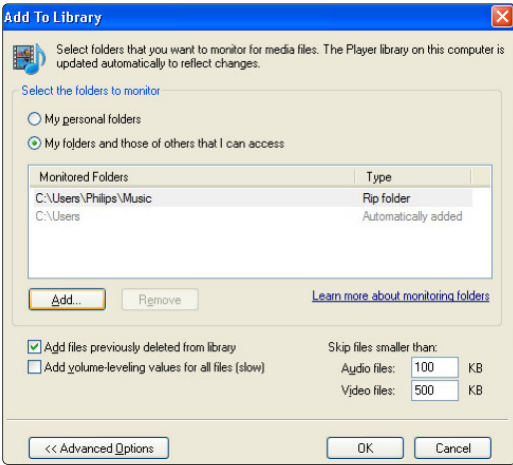

Click the **Sharing** tab.

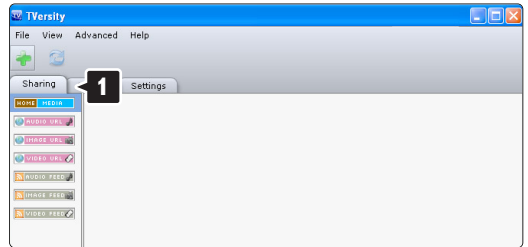

Set folders for sharing

Click the green plus icon and select **Add folder...**

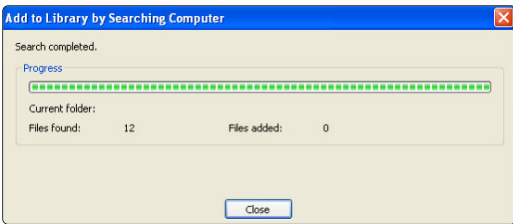

Now everything is set to enjoy music, photos and videos on your TV.

Tversity v.0.9.10.3 on Windows XP

Set for network sharing

Click the **Settings** tab and click the **Start Sharing** button.



A pop-up window tells you that the media server service is started. Click **OK**.

In the **Add media** pop-up window, click the **Browse** button.

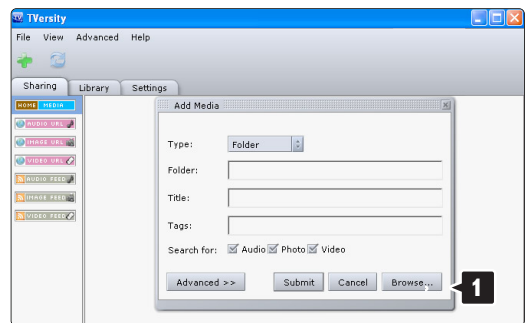

In the **Browse for Folder** window select a folder with music, photos or videos you want to share. Click **OK**.

Now everything is set to enjoy music, photos and videos on your TV.

Twonky Media v4.4.2 on Macintosh OS X

Set for network sharing

In **Twonky Media** click **Basic Setup > First steps**. In this window you can change the server name that appears on your TV.

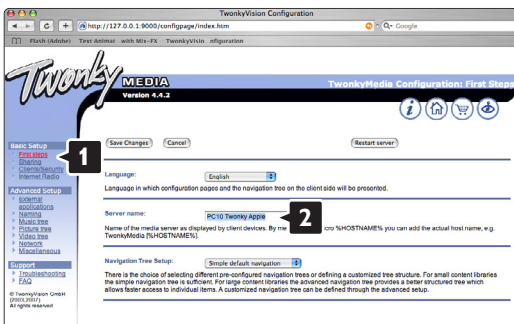

Click **Basic Setup > Clients/Security**. Check the box next to **Enable sharing for new clients automatically**.

Set folders for sharing

Click on **Basic Setup > Sharing**. Some 'Content Locations' might be set already automatically. To add a folder (a content location) to be shared on the network click the **Browse** button.

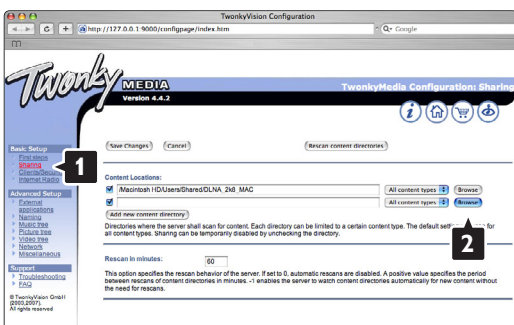

In the blue frame click the hard disk name to browse to a folder with music, photos or videos you want to share with other devices (your TV).

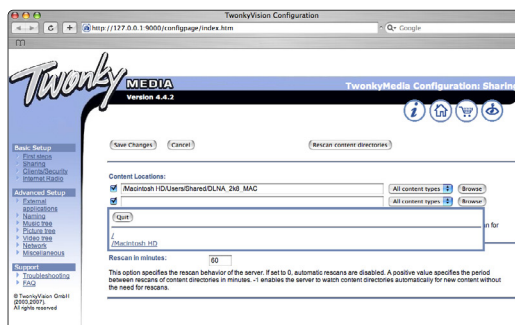

Click **Select** to select the folder for sharing. Now click **Save Changes**.

Then click **Rescan content directories**. In some cases this might not make all files and folders available.

Click **Support > Troubleshooting** and click **Rebuild database** to make sure everything works OK. This rebuild might take a while.

Now everything is set to enjoy music, photos and videos on your TV.

8 Technical data

Picture / Display

- Display type: LCD Full HD W-UXGA
- Panel resolution: 1920x1080p
- Perfect Pixel HD picture enhancement
- 1080p 24/25/30/50/60Hz processing
- 100 Hz Clear LCD

Supported display resolutions

- Computer formats

Resolution	Refresh rate
640 × 480p	60Hz (VGA/HDMI)
600 × 800p	60Hz (VGA/HDMI)
1024 × 768p	60Hz (VGA/HDMI)
1280 × 768p	60Hz (VGA/HDMI)
1360 × 765p	60Hz (VGA/HDMI)
1360 × 768p	60Hz (VGA/HDMI)
1280 × 1024p	60Hz (HDMI)
1920 × 1080i	60Hz (HDMI)
1920 × 1080p	60Hz (HDMI)

- Video formats

Resolution	Refresh rate
480i	60Hz
480p	60Hz
576i	50Hz
576p	50Hz
720p	50Hz, 60Hz
1080i	50Hz, 60Hz
1080p	24Hz, 25Hz, 30Hz
1080p	50Hz, 60Hz

Tuner / Reception / Transmission

- Antenna input: 75ohm coaxial (IEC75)
- TV system: DVD COFDM 2K/8K, (MPEG2, MPEG4 if available)
- Video playback: NTSC, SECAM, PAL
- DVD: DVB Terrestrial
(see selected countries on the TV typeplate)

Sound

- Sound system:
 - Virtual Dolby Digital
 - BBE

Multimedia

- Connections: USB
- Playback formats: MP3, Slideshow (.alb)
JPEG, MPEG1, MPEG2.

Supported media server software

- Windows Media Player 11 (on Microsoft Windows XP* or Vista*)
- PacketVideo Twonky Media 4.4.2 (on PC* & Intel Mac OSX*)
- Sony Vaio media server (on Microsoft Windows XP or Vista)
- TVeristy v.0.9.10.3 (on Windows XP*)
- Nero 8 - Nero MediaHome (on Microsoft Windows XP)
- DiXiM (on Windows XP)
- Macrovision Network Media Server (on Windows XP)
- Fuppes (on Linux)
- UShare (on Linux)
- Philips Media Manager (on Microsoft Windows XP)
- Philips NAS SPD8020

* For this media server software a step by step setting instruction is available in the online User manual on www.philips.com/support.

Supported USB/Memory device formats

- FAT 16, FAT 32, NTFS.

Remote control

- Type: RC4491
- Batteries: 3 Size AAA-LR03-1,5V type

Connectivity

Back

- EXT1 (scart): Audio L/R, CVBS in, RGB
- EXT2 (scart): Audio L/R, CVBS in, RGB,
- EXT3: Y Pb Pr or VGA, Audio L/R
- HDMI 1 in (HDMI 1.3a for all HDMI connections)
- HDMI 2 in
- HDMI 3 in
- Audio In L/R (DVI to HDMI)
- Audio Out L/R - display synchronised
- Digital Audio out (coaxial-cinch-S/PDIF) - display synchronised
- Network - (RJ45)

Side

- HDMI side in
- S-Video in (Y/C)
- Video in (CVBS)
- Audio L/R in
- Headphone (stereo mini jack)
- USB
- Common interface slot

Power

- Mains power: AC 220-240V ($\pm 10\%$)
- Power and standby power consumption:
See technical specification on www.philips.com
- Ambient temperature: 5°C - 35°C

Specifications are subject to change without notice.
For more specification details of this product see
www.philips.com/support.

Dimensions and weights (approx.)

TV model	37PFL9903	42PFL9903
- width	953mm	1054mm
- height	604mm	658mm
- depth	101mm	100mm
- weight	$\pm 25\text{kg}$	$\pm 28\text{kg}$
TV + stand		
- width	953mm	1054mm
- height	677mm	731mm
- depth	242mm	265mm
- weight	$\pm 28,5\text{kg}$	$\pm 32,5\text{kg}$

9 Troubleshooting

Television and remote control

The TV does not switch on

- Verify the mains cord connection.
- Verify if the batteries of the remote control are not empty or weak. Verify their + / - orientation.
You can use the keys on the TV to switch the TV on.
- Unplug the mains cord, wait a minute and plug it back in. Try again to switch on.

The TV does not react on the remote control

- Verify if the batteries of the remote control are not empty or weak. Verify their + / - orientation.
- Clean the remote control and TV sensor lens.

The TV switches off and the red light blinks



- Unplug the mains cord, wait a minute and plug it back in. Verify if there is enough space for ventilation. Wait until the TV has cooled down. When the TV does not restart to standby and the blinking occurs again, call our Customer Care.

You forgot your code to unlock Child lock

- See section 5.9.3 Set code / Change code.

Wrong language in the TV menu ?

Follow these steps to change the language.

- 1 Press **Menu**  on the remote control.
- 2 Use **▼** to select the last menu line.
- 3 Press **►** three times.
- 4 Press **▲** or **▼** to select your language.
- 5 Press **OK**.
- 6 Press **Menu**  to quit the menus.

TV channels

Some TV channels are gone

- Verify if the correct channel list is chosen.
- A channel could be uninstalled in the **Rearrange menu**.

No digital channels found during installation

- Verify if the TV supports DVB-T or DVB-C in your country. See the label "Digital TV Country Compatibility" on the back of the TV.

Picture

LightGuide is on but there is no picture

- Verify if the antenna is connected properly.
- Verify if the correct device is selected.

The sound is on, but there is no picture

- Verify the contrast or brightness setting in the menu.

The TV picture is poor

- Verify if the antenna is connected properly.
- Non-earthed audio devices, neon lights, high buildings or mountains can influence the picture quality. Try to improve the picture by changing the antenna direction or place devices away from the TV.
- Verify if the correct TV system is chosen in the Manual installation menu.
- If only a certain channel is poor, try to fine tune this channel in the **Fine tune** menu. See section 6.2.3.

The picture has poor colour

- Verify the colour settings in the Picture menu.
Select any of the smart settings in the **Smart settings** menu. See section 5.4.1.
- Verify the connections and cables of the connected devices.

Picture delay when a game console is connected

- To prevent picture delay, set the TV in game mode.
Press Menu > TV menu > Smart settings > **Game**.

The TV does not remember my settings when I switch back on

- Verify if the TV is set to **Home** in the TV menu > Setup > Installation > Preferences > **Location** menu.

The picture does not fit the screen, it is too big or too small

- Select a more fitting picture format in the Picture format menu.
See section 5.4.4 **Widescreen picture format**.
- Name your connected device in the Connections menu to obtain the best signal handling.
See section 7.4.1 **Naming your devices**.

The picture position on screen is not correct

- Some picture signals from some devices do not fit the screen correctly. You can shift the picture with the cursor keys on the remote control. Verify the signal output of the device.

Sound

There is a picture but no sound

- Verify the volume is not set to 0.
- Verify the sound has not been muted with the  key.
- Verify if all cables are connected properly.
- If no sound signal is detected, the TV automatically switches off the sound.
This is proper operation and is not a malfunction.

The sound is poor

- Verify if the sound is set to Stereo.
- Verify the Equalizer in the Sound menu.
- Select any of the Smart settings in the menu.

The sound comes from one speaker only

- Verify if the Balance is not set to extreme left or right.

Sound delay when A HTS-DVD device is connected

- See the user manual of the HTS-DVD device to adjust the audio sync delay.
If you cannot set A delay, switch off HD Natural MOtion in the Picture > Perfect Pixel HD menu.
See section 5.4.3 Picture settings.

HDMI connections

Trouble with devices connected with HDMI

- The HDMI - HDCP procedure might take a few seconds before the TV shows the picture from a device.
- If the TV does not recognise the device and the screen shows no picture, try switching from one device to another and back again to restart the HDCP procedure.
- If sound interruptions occur persistently, see the user manual of the device to verify the output settings. If that does not help, connect an additional audio cable.
- If a DVI to HDMI adaptor is used, verify if an additional audio connection is in place to complete the DVI connection.
- HDMI with EasyLink does not work
 - Verify if the connected device supports the HDMI CEC standard. See the user manual that comes with the device.
 - Verify if the HDMI cable is properly connected.
 - Verify if Easylink is activated in the Setup, Installation, Preferences menu.
 - Ensure that the System audio control in your HDMI CEC audio devices is properly set up. See the user manual that comes with your audio device.

USB connection

The TV does not show the USB device content

- Set your device (camera) to 'Mass Storage Class' compliant.
- The USB device may need specific driver software. Unfortunately this software cannot be downloaded to your TV.

I cannot see my files in the Multimedia menu.

- Not all audio and picture files are supported. See section 8 Technical data.

Photo and music files do not playback smoothly

- The transfer performance of the USB device limits the transfer rate.

Personal computer

The PC display on my TV is not stable or is not synchronised

- Verify if the correct resolution mode is selected on your PC. See section 8 Technical data.

I cannot find my PC files on my PC

- Verify if files have been added in the folder.
- Not all file formats are supported. See section 8 Technical data.

PC files are not shown in the PC network menu

- You have to set the PC media server to share files with the TV. See section 7.7.2 Set up a PC network connection.

PC files do not play

- See section 8 Technical data for supported file formats.

If your problem is not solved

Switch your TV off and on again, that may help. If not, call our Consumer Care or consult our website www.philips.com/support.

Find the Consumer Care telephone numbers on the back cover of this manual.

Please, have the TV Model and Product Number ready before you call.

You can find these numbers on the packaging label or on the typelabel on the back and bottom of the TV.

Warning

Never try to repair the TV yourself.

10 Index

100 Hz Clear LCD 5,19

A

Active control 19
Advanced sharpness 19
Ambilight
 active mode 21
 LoungeLight 13
 menu / settings 21
 modes 21
Analogue
 manual installation 34
 TV channels 34
Antenna
 cable 9
 connect 9
 with devices 36
Audio setup 44
Auto clock mode 33
Auto format 20
Automatic installation 32
Auto surround 21
Auto Volume levelling 21

B

Balance
 sound 21
Batteries 3,9
Blacklevel 19
Blu-ray Disc 41
Brightness 19
 ambilight 21

C

CA module 45
Cable
 HDMI 37
 Scart 37
 S-Video 38
 Video 37
 YPbPr 37
Camcorder 42
Camera (photo) 42
Care of the screen 3
Change code 26
Channel
 all channels list 23
 favourite list 23
 installation 32
 lock 26

Channel
 management 34
 up/down 15
 previous 15
 rearrange 34
 store / install 33
Child lock 26
Clock 15,33
Code 26
Colour
 enhancement 19
 menu 19
 keys 4,14
Common interface (CAM)
 menu 45
 slot 36,45
Connection
 best 37
 overview 36
 set up 44
Contrast 19
Country selection 32
Custom lock 26
Custom tint 19

D

Daylight saving 33
Decoder channel 44
Delta volume 21
Device
 connecting 38
 naming 44
 watch 11
DHCP 46
Digital
 audio out 36
 subtitle language 27
 receiver 39
 text services 23
 test reception 55
Dual I/II 21
Dual screen 15
DVB-T 5
DVD
 connect 39
 playback 12
 player 39
 recorder 39,40

Dynamic
 backlight 19
 contrast 19

E

EasyLink 38
Electronic Programme Guide 24
Energy saving 18
Equalizer 20
External 1,2,3 (EXT) 36

F

Factory settings 35
Favourite channel lists 23
Fine tune 34

G

Game console 42

H

HDCP 37
HDMI connection 37
HD digital receiver 41
HD natural motion 19
Headphone
 connect 4,36
 volume 21
Hearing impaired 32
Home theatre system 40
Hue 19

I

Installation
 automatic 32
 manual 33
 manual network setup 46
 menu 32
 update 34

K

Kensington Security Slot 5
Key(s)
 colour 14
 on TV 4
 on remote control 4,14

L

Language
 menu 32
 audio 21

Language
 subtitle 27
 LightGuide 17
 Light sensor 19
 Location 54
 Locks 26
 LoungeLight 13

M

Menu key 15
 Mono 21
 Movie expand 20
 MPEG artefact reduction 19
 Music 27
 Mute key 14

N

Naming devices 44
 Network setup 46
 Noise reduction 19

O

OK key 14
 On timer 26

P

Perfect Pixel HD 19
 Personal Computer
 connect 43
 display resolutions 52
 Photo viewer 28
 Picture
 album 28
 format 20
 menu 19
 Position the TV 5
 Power cable 9
 Preferred audio format 32

R

Radio channel 29
 Rearrange channels 34
 Recorder 39
 Recycling 3
 Remote control
 assistant 15
 batteries 9
 mode 15
 overview 14
 setup code 18
 Remote control
 universal 15
 Rename 34
 Reorder 34

S

Safety 3
 Satellite receiver 40
 Scart connection 37
 Screen cleaning 3
 Search
 channels 33
 teletext pages 22
 Set code 26
 Settings assistant 18
 Sharpness 19
 Sleptimer 26
 Smart settings 18
 Software update 30
 Sound
 menu 20
 surround mode 21
 Standby 14,26
 Super zoom 20
 Stationary images 3
 Stereo 21
 Subtitle 27
 language 27
 shift 20
 Switch on 10

T

Table of Pages T.O.P 22
 Technical data 52
 Teletext 22
 digital 23
 dual screen 22
 language 22
 menu 23
 page 22
 teletext 2.5 23
 Time zone 33
 Timers 26
 Tint 19
 Troubleshooting 54
 TV speakers 21

U

Universal mode 15
 Universal remote control 15
 Unmount the stand 6
 Unscaled 20
 USB
 connector 36
 device 27
 photo viewer 27

V

VCR
 connect 39
 VGA 43
 Video cable 38
 Video formats 52
 Visual impaired 32
 Volume
 bar 20
 key 14
 visual impaired 21

W

Whitepoint 19
 Widescreen picture format 20

Y

YPbPr 37

Information about how to re-tune your TV during the digital TV switchover.

Keep this user manual safe
- you'll need it.

.....

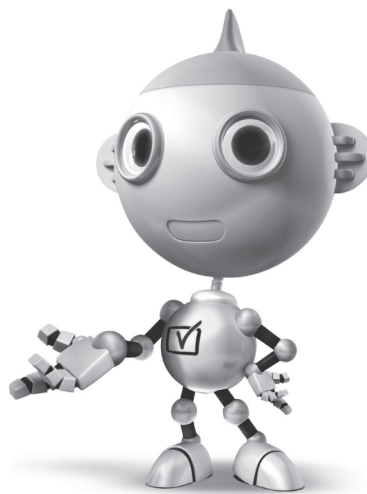

Television in the UK is going digital, bringing us all more choice and new services. Starting in late 2007 and ending in 2012, television services in the UK will go completely digital, TV region by TV region.

Please see the next page to find out when your area switches to digital.

Digital UK is the independent, non-profit organisation leading the process of digital TV switchover in the UK. Digital UK provides impartial information on what people need to do to prepare for the move to digital, and when they need to do it.

How the switch over affects your TV equipment:

Your new TV has a digital tuner built in, which means it is ready to receive the Freeview signal by simply plugging it into your aerial socket (check if you can get digital TV through your aerial now, or whether you'll have to wait until switchover; at www.digitaluk.co.uk).

When the TV switchover happens in your area, there are at least two occasions when you will need to re-tune your TV in order to continue receiving your existing TV channels, and also to pick up new ones.

get set for digital 

Digital UK, the body leading the digital TV switchover, will advise you when you need to re-tuner during the switchover.

If you choose to connect your TV to satellite or cable with a digital box then it will not be affected by switchover, and you won't need to re-tune.

If you have any questions, please contact your equipment supplier or call Digital UK on ... 0845 6 50 50 50 or visit www.digitaluk.co.uk

How to re-tune:

To find out how to re-tune your TV, check this user manual for details.

Go to section 6.1 Automatic installation and go to Step 4 Install TV and radio channels.

If you do not re-tune your channels when advised to do so by Digital UK, you may lose some or all of your channels until you do re-tune. You should re-tune your TV every few months to check for any new channels.

If you are missing any channels, it may be that they are not available in your area, or that your aerial needs upgrading.

When does switchover happen?

* Copeland switches on October 17, 2007

The exact date you switch depends on the transmitter you are served by. To check when you switch, go to Digital UK's postcode checker on www.digitaluk.co.uk. Check your ITV news service or look at Teletext page 106 to see what TV region you're in.

Visit us at **digitaluk.co.uk**
Call us on **0845 6 50 50 50***

* Calls charged at BT rate of 3p pr minute daytime and 1p per minute evenings and weekends. Rates may vary for calls from non-BT lines.



Remote control setup codes
Codeeinstellung in die Fernbedienung
Codes de la télécommande
Instelcodes voor de afstandsbediening

Codici per il telecomando
Códigos de acceso para el mando a distancia
Códigos de introdução no telecomando
Πίνακες κωδικών καταχώρισης τηλεχειριστηρίου

DVD

DVD player
 DVD recorder
 DVD-R HDD
 Blu-ray Disc

STB

Digital receiver
 - DVB-T
 Satellite receiver
 - DVB-S
 Cable receiver
 - DVB-C

HTS

Home Theatre Systems
 Amplifier

DVD Codes

PHILIPS 0000, 0001, 0002, 0003, 0013, 0021, 0030, 0049, 0100, 0105, 0107, 0111, 0123, 0127, 0131, 0135, 0145, 0150, 0153, 0154, 0155, 0156, 0161, 0163, 0164, 0177, 0193, 0197, 0204, 0221, 0225, 0226, 0231, 0232, 0233, 0258, 0260, 0271, 0273, 0275, 0288, 0289, 0295, 0301, 0310, 0311, 0312, 0318, 0320, 0325, 0333, 0341, 0342, 0343, 0354, 0355

Aiwa 0028, 0109, 0140, 0171, 0303
 Aika 0020
 Akura 0066
 Alba 0004, 0118, 0119, 0129, 0195, 0256
 Apex 0040
 Bang & Olufsen 0071
 Best Buy 0062
 Bosston 0056
 Brandt 0049, 0115, 0132, 0191
 Britannia 0053
 Bush 0004, 0032, 0050, 0052, 0060, 0064, 0119, 0120, 0134, 0141, 0147, 0183, 0185, 0189, 0256
 Cambridge Audio 0055, 0070
 CAT 0057, 0058
 Celestial 0068
 Centrex 0144
 Centrum 0058
 CGV 0055
 Cinevision 0063
 Classic 0034
 Clatronic 0060
 Conia 0050
 Crypto 0065
 C-Tech 0126
 CyberHome 0108, 0124, 0137

Daewoo 0007, 0008, 0009, 0125, 0139, 0261, 0286
 Dalton 0069
 Dansai 0054, 0188
 Daytek 0110, 0121
 DEC 0060
 Denon 0015, 0039, 0166, 0173, 0184
 Denver 0032, 0060, 0066, 0118, 0172, 0308
 Denzel 0051
 Desay 0059
 Diamond 0055, 0126
 Digitor 0067
 DK Digital 0134, 0292
 Dmtech 0005
 Dual 0051
 DVX 0126
 Easy Home 0062
 Eclipse 0055
 Elta 0015, 0033, 0136
 Eltax 0290
 Emerson 0026
 Enzer 0051
 Finlux 0055
 Fisher 0029
 Gericom 0144
 Global Solutions 0126
 Global sphere 0126
 Go Video 0018
 Goldstar 0114
 Goodmans 0004, 0060, 0064, 0119, 0144, 0147, 0169, 0179, 0187, 0236, 0256
 Graetz 0051
 Grundig 0021, 0031, 0139, 0144, 0148
 H&B 0060, 0061
 Haaz 0055, 0126
 Harman/Kardon 0045
 HiMAX 0062
 Hitachi 0018, 0037, 0051, 0062, 0196, 0209, 0284, 0302, 0317, 0330
 Humax 0157
 Innovation 0022, 0023, 0024, 0037

Jeutech 0056
 JVC 0012, 0049, 0106, 0117, 0133, 0214, 0215, 0216, 0217, 0237, 0238, 0239, 0240, 0276, 0277, 0278, 0279, 0293, 0329, 0335
 Kenwood 0015, 0043, 0138, 0181, 0186, 0300
 Kingavon 0060
 Kiss 0051, 0061
 Koda 0060
 KXD 0062
 Lawson 0126
 Lecson 0054
 Lenco 0060
 LG 0026, 0114, 0160, 0213, 0304, 0324, 0338, 0352, 0359
 Life 0022, 0023, 0024
 Lifetec 0022, 0023, 0024, 0037
 Limit 0126
 Loewe 0021, 0146, 0174
 LogicLab 0126
 Luxor 0144
 Magnavox 0049, 0060, 0100
 Magnum 0024, 0037
 Marantz 0030, 0164, 0175, 0176
 Matsui 0132, 0194
 MBO 0046
 Mediencom 0053
 Medion 0006, 0022, 0023, 0024, 0037, 0064
 Metz 0055
 MiCO 0055
 Micromaxx 0022, 0023, 0024, 0037
 Micromedia 0049
 Micromedia 0105, 0271
 Microstar 0022, 0023, 0024, 0037
 Mirror 0064
 Mitsubishi 0017, 0101
 Mizuda 0060, 0062
 Monyka 0051
 Mustek 0034, 0256, 0296
 Mx Onda 0055

NAD 0044
 Naiko 0144
 Nakamichi 0048
 Neufunk 0051
 NU-TEC 0050
 Omni 0053
 Onkyo 0025, 0049, 0100, 0182
 Optim 0054
 Optimus 0019, 0103
 Orava 0060
 Orion 0185
 Oritron 0024
 P&B 0060
 Pacific 0126
 Palsonic 0052
 Panasonic 0015, 0165, 0184, 0198, 0199,
 0200, 0243, 0244, 0245, 0246, 0247,
 0248, 0249, 0250, 0251, 0252,
 0253, 0254, 0266, 0267, 0274,
 0291, 0294, 0313, 0314, 0315,
 0319, 0336, 0347, 0348, 0349,
 0356, 0358
 Philips Magnavox 0013
 Pioneer 0019, 0103, 0112, 0113, 0116, 0128,
 0149, 0159, 0180, 0201, 0202,
 0203, 0206, 0207, 0208, 0242,
 0255, 0263, 0305, 0321, 0326,
 0327, 0328, 0337, 0344, 0345,
 0346, 0353, 0357
 Proline 0144, 0194
 Provision 0060
 Raite 0051
 RCA 0035
 REC 0052, 0053
 RedStar 0066
 Reoc 0126
 Revoy 0061
 Roadstar 0004, 0052, 0060
 Rowa 0050, 0144
 Rowsonic 0058
 Saba 0115, 0132
 Sabaki 0126
 Sampo 0036
 Samsung 0018, 0196, 0205, 0210, 0227,
 0241, 0259, 0270, 0272, 0283,
 0287, 0299, 0322, 0339, 0340
 Sansui 0055, 0126
 Sanyo 0257, 0262, 0285, 0298
 ScanMagic 0256
 Schneider 0004, 0005, 0006, 0024
 Scott 0069, 0118
 SEG 0004, 0042, 0051, 0126, 0152
 Sharp 0022, 0044, 0130, 0151, 0268, 0280,
 0350
 Sherwood 0041

Shinco 0035
 Sigmatek 0062
 Silva 0066
 Singer 0055, 0126
 Skymaster 0033, 0034, 0126
 Skyworth 0066
 SM Electronic 0126
 Sony 0014, 0104, 0109, 0122, 0171, 0178,
 0192, 0222, 0223, 0224, 0228,
 0229, 0230, 0282, 0297, 0306,
 0309, 0316, 0323, 0351
 Soundmaster 0126
 Soundmax 0126
 Standard 0126
 Star Cluster 0126
 Starmedia 0060
 Supervison 0126
 Synn 0126
 Tatung 0125
 TCM 0022, 0023, 0024, 0037, 0072, 0073,
 0074, 0075, 0076, 0077, 0078,
 0079, 0080, 0081, 0082, 0083,
 0084, 0085, 0086, 0087, 0088,
 0089, 0090, 0091, 0092, 0134,
 0210, 0269, 0272
 Teac 0019, 0050, 0126, 0168
 Tec 0066
 Technics 0170, 0184
 Telefunken 0058
 Tevion 0022, 0023, 0024, 0037, 0069, 0126
 Thomson 0010, 0011, 0093, 0094, 0095,
 0096, 0097, 0098, 0099, 0102,
 0115, 0162, 0167, 0191, 0331, 0332
 Tokai 0051, 0066
 Toshiba 0013, 0049, 0100, 0142, 0161, 0190,
 0211, 0212, 0218, 0218, 0220,
 0234, 0235, 0264, 0265, 0281
 TruVision 0062
 Vtrek 0065
 Wharfedale 0027, 0055, 0126
 Wintel 0056
 Xbox 0102, 0115
 Xenon 0334
 Xlogic 0126
 XMS 0052
 Yakumo 0144
 Yamada 0144
 Yamaha 0015, 0038, 0131, 0143, 0158, 0184,
 0271, 0307

STB Codes

**PHILIPS 0000, 0001, 0003, 0020, 0043,
 0066, 0068, 0069, 0073, 0085,
 0087, 0095, 0097, 0098, 0105,
 0109, 0113, 0114, 0117, 0122,
 0124, 0174, 0176, 0184, 0187,
 0206, 0207, 0208, 0211, 0213,
 0281, 0282, 0285, 0297, 0298,
 0301, 0304, 0325, 0331, 0358,
 0360, 0361, 0386, 0387, 0393,
 0395, 0412, 0421, 0429, 0434**
 ABC 0432
 AB Sat 0100, 0122, 0123, 0132
 AGS 0122
 Akai 0043, 0105
 Alba 0002, 0003, 0004, 0005, 0031, 0045,
 0087, 0107, 0123, 0209, 0270
 Alcatel 0430, 0431
 Aldes 0004, 0005, 0006, 0072, 0107
 Allsat 0007, 0025, 0042, 0061, 0068, 0105
 Allsonic 0005, 0010, 0072, 0108, 0115
 Alltech 0089, 0123
 Alpha 0105
 Altai 0078
 Amitronica 0123
 Ampere 0008, 0078, 0222
 Amstrad 0044, 0071, 0078, 0090, 0092, 0096,
 0101, 0106, 0123, 0127, 0128,
 0155, 0222, 0225, 0274, 0275,
 0278, 0317, 0388, 0405,
 Amstrad 0435
 Anglo 0123
 Ankaro 0005, 0010, 0069, 0072, 0108, 0115,
 0123
 Anttron 0002, 0005, 0068, 0087
 Apollo 0002
 Arcon 0008, 0009, 0026, 0094, 0222, 0280,
 0405
 Armstrong 0105, 0225
 ASA 0079
 Asat 0043, 0105
 ASLF 0123
 AST 0014, 0074
 Astacom 0095, 0122
 Aston 0053, 0271
 Astra 0012, 0013, 0037, 0064, 0076, 0082,
 0119, 0123, 0225
 Astro 0005, 0006, 0010, 0017, 0066, 0087,
 0108, 0113, 0114, 0115, 0116,
 0119, 0283, 0392
 AudioTon 0005, 0025, 0087
 Aurora 0126
 Austar 0126, 0157
 Avalon 0078

Axiel 0122	Daewoo 0123, 0188	Fidelity 0071, 0090, 0116, 0275, 0405
Axis 0010, 0013, 0021, 0077, 0082, 0108, 0115, 0405	Dansat 0007, 0061, 0068	Finlandia 0003, 0064
Barcom0009	D-Box 0103	Filmnet 0433
Best 0009, 0010, 0108, 0115	DDC 0004, 0107	Filmnet Cablecrypt 0411, 0427
Blaupunkt 0017, 0066, 0113	Decca 0023	Filmnet Comcrypt 0411
Blue Sky 0123, 0128	Delega 0004	Finlux 0003, 0030, 0064, 0080, 0084, 0292, 0363, 0413
Boca 0037, 0059, 0085, 0091, 0123, 0222, 0225, 0237, 0242, 0251	Dew 0021, 0077	Finnsat 0021, 0055
Boston 0122, 0222	Diamond 0024	Flair Mate 0123
Brain Wave 0019, 0075, 0094	Digality 0119	Foxtel 0026, 0131, 0157, 0435
Brandt 0049, 0334, 0335, 0336	Digipro 0129	Fracarro 0145, 0102
Broadcast 0018, 0076	Discoverer 0112, 0118	France Satellite/TV 0028
Broco 0082, 0123	Discovery 0122	France Telecom 0429, 0434
BSkyB 0101, 0155, 0183, 0216	Diseqc 0122	Freebox 0210
BT 0122	Diskxpress 0009, 0284	Freecom 0002, 0032, 0113, 0116
BT Satellite 0049, 0095, 0277	Distratel 0128	Freesat 0089, 0127
Bubu Sat 0123	Distrisat 0105	FTE 0008, 0034, 0085, 0091, 0108, 0277
Bush 0003, 0007, 0020, 0031, 0045, 0061, 0068, 0107, 0200, 0207	Ditristrad 0025	FTEmaximal 0115, 0123
BVV 0094	DNR 0094	Fuba 0002, 0009, 0010, 0012, 0016, 0017, 0028, 0030, 0043, 0064, 0078, 0108, 0110, 0113, 0115, 0323
Cabletime 0406, 0407, 0408, 0424, 0426, 0428	DNT 0016, 0043, 0078, 0105	Fugionkyo 0129
Cambridge 0091, 0116	Dong Woo 0036	Galaxi 0009
Canal Satellite 0073, 0109, 0114	Drake 0026, 0327	Galaxis 0005, 0010, 0013, 0021, 0025, 0031, 0050, 0072, 0077, 0082, 0108, 0110, 0115, 0126, 0157, 0293, 0295, 0346
Canal+ 0047, 0115	DStv 0126	Galaxisat 0074
Channel Master 0004, 0107	Dune 0108, 0115	Gardiner 0124
Chaparral 0040	Dynasat 0121	GEC 0409
Cherokee 0122, 0132	Echostar 0016, 0052, 0078, 0102, 0109, 0123, 0132, 0279, 0286, 0287, 0288, 0294, 0342, 0343, 0344, 0345	General Instrument 0425, 0432
Chess 0052, 0112, 0118, 0123, 0322	Einhell 0002, 0005, 0071, 0072, 0116, 0123, 0222, 0225, 0275	GMI 0225
CityCom 0003, 0022, 0098, 0110, 0119, 0124, 0157	Elap 0122, 0123	Goldbox 0073, 0109, 0114
Clatronic 0019, 0075	Elekta 0006	Goldstar 0032
Clemens Kamphus 0033	Elsat 0092, 0123	Gooding 0117, 0412
Clyde Cablevision 0409	Elta 0002, 0010, 0025, 0043, 0105, 0108, 0115	Goodmans 0003, 0031, 0186, 0195
CNT 0006	Emanon 0002	Granada 0064
Colombia 0222	Emme Esse 0010, 0020, 0033, 0102, 0108, 0115, 0121	Grandin 0062, 0111
Columbia 0222	Engel 0123	Grothusen 0002, 0032
Columbus 0028	Ep Sat 0003	Grundig 0003, 0005, 0017, 0020, 0044, 0054, 0065, 0066, 0097, 0101, 0106, 0113, 0116, 0117, 0126, 0128, 0155, 0166, 0167, 0169, 0175, 0282, 0298, 0325, 0388, 0393, 0405, 0412
Comag 0222	Eurieult 0111, 0127, 0128	G-Sat 0068
Comcrypt 0433	Eurocrypt 0064	Hanseatic 0039, 0086, 0118
Commander 0069	Eurodec 0055	Haensel & Gretel 0119, 0222
Commmlink0005, 0072	Europa 0069, 0085, 0105, 0105, 0119	Hantor 0002, 0019, 0036, 0075
Comtec 0021, 0072, 0077	Europhon 0119, 0222	Hanuri 0006
Condor 0010, 0108, 0115, 0119	Eurosat0225	Hase & Igel 0094
Connexions 0016, 0078, 0108, 0115, 0284	Eurosky 0010, 0108, 0110, 0115, 0116, 0119, 0222, 0225	Hauppage 0179, 0198
Conrad0084, 0085, 0108, 0110, 0115, 0116, 0119, 0222	Eurostar 0104, 0110, 0119, 0121, 0124, 0225	Heliocom 0008, 0119
Conrad Electronics 0119, 0123	Eutelsat 0123	Helium 0119
Contec 0021, 0022, 0077, 0085	Eutra 0089	Hinari 0004, 0068, 0107
Cosat 0025	Exator 0002, 0005, 0087	
Crown 0225	Fenner 0112, 0115, 0118, 0123	
Cryptovision 0410	Ferguson 0003, 0007, 0020, 0055, 0061, 0068, 0182, 0289, 0290, 0291, 0391	
Cybermax 0057		
Daeryung 0016		

Hirschmann 0017, 0033, 0066, 0078, 0079, 0081, 0084, 0113, 0115, 0116, 0119, 0122, 0127, 0165, 0322, 0323, 0328, 0389, 0413	Lennox 0025 Lenson 0029, 0116 Lexus 0105 LG 0032 Life 0050 Lifesat 0010, 0039, 0050, 0052, 0057, 0086, 0108, 0112, 0115, 0118, 0123, 0222, 0297, 0303, 0347, 0372 Lifetec 0010, 0039, 0050, 0052, 0057, 0297, 0303, 0347, 0372 Lorenzen 0069, 0094, 0096, 0119, 0222 Lorraine 0032 Lupus 0010, 0108, 0115 Luxor 0064, 0084, 0103, 0106, 0116, 0275, 0313, 0323, 0388 Lyonnaise 0055 M & B 0086, 0118 Macab 0055, 0434 Manata 0095, 0111, 0122, 0123, 0222 Manhattan 0003, 0006, 0020, 0025, 0095, 0122, 0269, 0383 Marantz 0043 Mascom 0006, 0081 Maspro 0003, 0020, 0040, 0063, 0066, 0089, 0094, 0113, 0117, 0123, 0289, 0328, 0393, 0412 Matsui 0049, 0066, 0095, 0107, 0113, 0117, 0122, 0412 Max 0119 MB 0039, 0086, 0118 Mediabox 0073, 0109, 0114 Mediamarkt 0225 Mediasat 0013, 0073, 0082, 0109, 0114, 0116 Medion 0010, 0039, 0050, 0052, 0057, 0108, 0115, 0123, 0222, 0297, 0303, 0335, 0347, 0372 Medison 0123 Mega 0043, 0105 Melectronic 0124 Metronic 0002, 0005, 0006, 0009, 0062, 0072, 0087, 0098, 0111, 0123, 0124, 0128, 0359, 0366, 0367, 0368, 0369, 0382 Metz 0017, 0066, 0113 Micro Electronic 0116, 0119, 0123 Micro Technology 0082, 0123 Micromaxx 0010, 0039, 0050, 0052, 0057, 0115, 0297, 0303, 0347, 0372 Microstar 0010, 0039, 0050, 0052, 0057, 0297, 0303, 0347, 0372 Microtec 0123 Minerva 0017, 0117, 0412 Mitsubishi 0003, 0017, 0049 Mitsumi 0037	Mnet 0427, 0433 Morgan Sydney 0056 Morgan's 0037, 0043, 0085, 0091, 0105, 0123, 0222, 0225 Motorola 0125 Movie Time 0419 Mr Zapp 0434 Multichoice 0054, 0126, 0433 Multistar 0034, 0036 Multitec 0052, 0112, 0347 Muratto 0015, 0032, 0074 Mysat 0123 Navex 0019, 0075 NEC 0041, 0067, 0302 Network 0068 Neuhaus 0013, 0025, 0029, 0069, 0082, 0085, 0094, 0116, 0119, 0123 Neusat 0094, 0123 NextWave 0051, 0130, 0273 Nikko 0123, 0225 Nokia 0003, 0020, 0064, 0079, 0084, 0103, 0114, 0156, 0170, 0196, 0221, 0233, 0235, 0241, 0253, 0254, 0257, 0262, 0263, 0264, 0265, 0284, 0310, 0311, 0320, 0323, 0332, 0333, 0396, 0400, 0413 Nomex 0058 Nordmende 0002, 0003, 0004, 0006, 0055, 0075, 0107, 0290, 0324, 0391 Noos 0434 Nova 0126 Novis 0019, 0075 Oceanic 0024 Octagon 0002, 0005, 0021, 0077, 0087 Okano 0033, 0034, 0225 Ondigital 0070, 0386, 0387 Optex 0022, 0025 Optus 0114, 0126, 0130 Orbit 0014 Orbitech 0002, 0083, 0085, 0112, 0114, 0116, 0390 Osat 0005, 0106, 0388 Otto Versand 0017 Pace 0003, 0007, 0017, 0020, 0031, 0044, 0061, 0068, 0070, 0101, 0122, 0132, 0155, 0183, 0199, 0201, 0202, 0203, 0205, 0289, 0301, 0307, 0329, 0394 Pacific 0024 Packsat 0122 Palcom 0004, 0012, 0028, 0029, 0107 Palladium 0116, 0117, 0225, 0412 Palsat 0112, 0116 Paltec 0012 Panasat 0120, 0126
Hyspion 0111 ID Digital 0157 Imex 0111 Imperial 0031, 0045 Ingelen 0127 Innovation 0010, 0039, 0050, 0052, 0057, 0297, 0303, 0347, 0372 Inernational 0222 Interstar 0129 Intertronic 225 Intervision 0025, 0088, 0119 ITT/Nokia 0003, 0020, 0064, 0079, 0084, 0103, 0284, 0313, 0323, 0413 Jerrold 0414, 0420, 0422, 0425, 0432 Johansson 0019, 0075 JOK 0093, 0095, 0122 JSR 0025 JVC 0117, 0186, 0412 Kamm 0123 Kathrein 0017, 0022, 0034, 0040, 0043, 0066, 0081, 0087, 0098, 0105, 0110, 0113, 0122, 0123, 0124, 0132, 0152, 0157, 0159, 0160, 0189, 0218, 0283, 0299, 0300, 0324, 0362, 0371, 0381, 0392, 0395 Kathrein Eurostar 0110 Key West 0222 Klap 0122 Konig 0119 Kosmos 0032, 0033, 0034, 0081 KR 0005, 0087, 0089 Kreiselmeier 0017, 0066, 0113 K-SAT 0123 Kyostar 0002, 0087, 0222 L&S Electronic 0115, 0222 Lasat 0006, 0010, 0035, 0036, 0037, 0077, 0091, 0108, 0110, 0112, 0115, 0119, 0222, 0334, 0335, 0336 Lemon 0094 Lenco 0002, 0032, 0038, 0069, 0082, 0094, 0108, 0110, 0115, 0119, 0123, 0277 Leng 0019		

Panasonic	0003, 0020, 0044, 0101, 0155, 0192, 0318	Sat Team	0123	Start Trak	0002
Panda	0003, 0007, 0061, 0064, 0113, 0119	Satcom	0018, 0039, 0076, 0086, 0118, 0119, 0306	Strong	0002, 0005, 0010, 0032, 0045, 0108, 0114, 0115, 0126, 0129, 0231, 0232, 0234, 0238, 0243, 0245, 0253, 0266, 0284
Patriot	0122, 0222	Satec	0020, 0068, 0123	STVO	0111
Phoenix	0021, 0031, 0068, 0077	Satelco	0108, 0115	Sumida	0225
Phonotrend	0003, 0005, 0025, 0033, 0072, 0346	Satford	0018, 0076	Sunny Sound	0108, 0115
Pioneer	0109, 0114, 0197, 0373, 0405, 0415, 0416	Satline	0088	Sunsat	0082, 0123
Polsat	0055	Satmaster	0018, 0076	Sunstar	0037, 0108, 0115, 0222, 0225, 0307
Polytron	0022	SatPartner	0002, 0005, 0006, 0019, 0032, 0033, 0075	Super Sat	0121
Predki	0019, 0075	Satplus	0112	Supermax	0130
Preisner	0078, 0085, 0091, 0222	Schacke	0087	Systec	0222
Premiere	0025, 0047, 0073, 0109, 0114, 0157, 0253, 0254, 0266	Schneider	0010, 0050, 0052, 0057, 0097, 0112, 0122, 0285, 0303, 0347, 0385	Tandberg	0055
Priesner	0225	Schwaiger	0022, 0024, 0039, 0051, 0068, 0085, 0086, 0112, 0118, 0119, 0128, 0222, 0272, 0299, 0305, 0335, 0337, 0339, 0340, 0341, 0346, 0347, 0357, 0370, 0383, 0385	Tandy	0005
Profile	0038, 0122	Scientific Atlanta	0417, 0418	Tantec	0003, 0020, 0028, 0029, 0289
Promax	0003	SCS	0110	Tatung	0023
Prosat	0004, 0005, 0031, 0045, 0072, 0088, 0107, 0270	Sedeo Electronique	0129, 0222	TCM	0010, 0039, 0050, 0052, 0057, 0133, 0134, 0135, 0136, 0137, 0138, 0139, 0140, 0141, 0142, 0143, 0144, 0145, 0146, 0147, 0148, 0297, 0303, 0347, 0372
Prosonic	0096	Seemann	0013, 0016, 0082, 0108, 0225	Techniland	0018, 0076
Protek	0024	SEG	0002, 0010, 0019, 0039, 0075, 0086, 0096, 0108, 0115, 0118, 0139, 0229, 0231, 0234, 0250, 0258, 0317, 0384	TechniSat	0016, 0029, 0060, 0083, 0105, 0112, 0114, 0116, 0150, 0151, 0164, 0185, 0194, 0213, 0214, 0220, 0224, 0226, 0236, 0239, 0240, 0260, 0267, 0308, 0309, 0390, 0398
Provision	0006	Seleco	0025, 0102	Technology	0126
PVP Stereo Visual Matrix	0422	Septimo	0128	Technosat	0130
Pye	0117	Servi Sat	0111, 0123	Technowelt	0119, 0128, 0222
Quadral	0004, 0005, 0010, 0072, 0085, 0088, 0095, 0107, 0108, 0115, 0122, 0132	Siemens	0017, 0066, 0091, 0113	Teco	0037, 0225
Quelle	0017, 0071, 0110, 0119, 0275	Silva	0032	Tele+1	0411, 0427, 0433
Quiero	0055	Skantin	0123	Telanon	0004
Radiola	0043, 0105	Skardin	0013, 0082	Telasat	0039, 0086, 0110, 0118, 0119
Radix	0016, 0078, 0089, 0127, 0191, 0247, 0256, 0380, 0397, 0399	Skinsat	0116	Teleciel	0087
Rainbow	0005, 0087, 0089	SKR	0123	Telecom	0123
Rediffusion	0041	SKY	0125	Teledirekt	0068
Redpoint	0013, 0082	Sky Digital	0044	Telefunken	0002, 0020, 0049, 0095, 0122, 0330, 0334, 0335, 0336
RedStar	0010, 0108, 0115	Skymaster	0005, 0039, 0052, 0072, 0086, 0088, 0104, 0112, 0118, 0123, 0139, 0149, 0158, 0219, 0227, 0246, 0249, 0255, 0268, 0321, 0322, 0347, 0348, 0349, 0350, 0351, 0352, 0374	Teleka	0005, 0016, 0078, 0081, 0087, 0094, 0116, 0119, 0225, 0280, 0393
RFT	0005, 0043, 0069, 0072, 0083, 0105	Skymax	0043, 0105	Telemaster	0006
Roadstar	0123	SkySat	0112, 0116, 0118, 0119, 0123	Telemax	0035
Roch	0111	Skyvision	0025	Telepiu	0427, 0433
Rover	0088, 0115, 0123	SL	0094, 0222	Telesat	0039, 0086, 0118, 0119
Ruefach	0038	SM Electronic	0112, 0123	Telestar	0029, 0112, 0114, 0116
Saba	0006, 0020, 0045, 0068, 0093, 0094, 0095, 0110, 0119, 0122, 0128, 0270, 0289, 0290, 0319, 0326, 0334, 0337, 0338, 0339, 0340, 0391	Smart	0110, 0123, 0127, 0222	Teletech	0104
Sabre	0003	Sony	0044, 0114, 0276	Televes	0003, 0056, 0222, 0365
Sagem	0055, 0099, 0434	SR	0037, 0222, 0225, 0290	Telewire	0025
Sakura	0021, 0031, 0077	Starcom	0432	Tempo	0130
Salora	0041, 0064, 0302, 0307	Starland	0052, 0123	Tevion	0010, 0039, 0050, 0052, 0057, 0123, 0297, 0303, 0347, 0372
Samsung	0002, 0153, 0154, 0162, 0193, 0204, 0280	Starring	0019, 0075		
SAT	0004, 0014, 0015, 0074, 0090, 0116, 0405				
Sat Cruiser	0130				
Sat Partner	0116				

Aureau service

Type nr. _____

Product nr. _____



GSM
Mobile
Portable

België / Belgique	_____ 00800 74454771 _____	0800 84434
Česká Republika	_____ 00800 74454771 _____	800 700013
Danmark	_____ 00800 74454771 _____	80703234
Deutschland	_____ 00800 74454771 _____	0800 0007522
Ελλάδα	_____ 0 0800 4414 3647 _____	0 0800 4414 3647
España	_____ 00800 74454771 _____	900 800819
France	_____ 00800 74454771 _____	080 5025534
Ireland	_____ 00800 74454771 _____	1800 818833
Italia	_____ 00800 74454771 _____	0800 135942
Luxembourg	_____ 00800 74454771 _____	800 27861
Magyarország	_____ 00800 74454771 _____	06800 16346
Nederland	_____ 00800 74454771 _____	0800 0201104
Norge	_____ 00800 74454771 _____	800 57534
Österreich	_____ 00800 74454771 _____	0800 880932
Polska	_____ 00800 74454771 _____	00800 4411 985
Portugal	_____ 00800 74454771 _____	800 780035
Россия	_____ 8 800 200 77 43 _____	8 800 200 77 43 - бесплатно
Türkiye Cumhuriyeti	_____ 0800 2613302 _____	0800 2613302
Schweiz	_____ 00800 74454771 _____	0800 284009
Slovenská Republika	_____ 0800 004537 _____	0800 004577
Suisse	_____ 00800 74454771 _____	0800 284009
Svenska	_____ 00800 74454771 _____	0200 159112
Svizzera	_____ 00800 74454771 _____	0800 284009
Suomi	_____ 00800 74454771 _____	0800 41974
United Kingdom	_____ 00800 74454771 _____	0800 0131562



Specifications are subject to change without notice
Trademarks are the property of Koninklijke Philips Electronics N.V.
or their respective owners
2008 © Koninklijke Philips Electronics N.V. All rights reserved

www.philips.com



Printed in Belgium