

Philips OLED+
4K UHD Android TV -
Bowers&Wilkins Sound

P5 AI dual picture engine
Sound by Bowers & Wilkins
Ambilight 4-sided
139 cm (55") Android TV

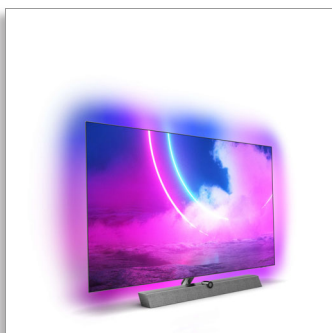

55OLED935

Breathtaking picture. Cinematic sound.

4K UHD OLED Android TV

Give your movies the TV they deserve. This stunning Philips OLED+ TV boasts up-firing Bowers & Wilkins speakers, and the latest P5 picture processing with AI. You get a lifelike picture and thrilling sound with crystal-clear dialogue.

Designed to thrill.

- The magic of Ambilight. Only from Philips.
- Philips OLED+ TV with HDR. The difference is real.
- Immersive sound. Bowers & Wilkins meets Dolby Atmos.
- Kvadrat speaker cloth. Muirhead leather-backed remote

Incredible picture. Bowers & Wilkins sound.

- Dolby Vision and Dolby Atmos. Cinematic vision and sound.
- P5 engine with AI. Whatever you watch, a picture so real.
- Integrated sub-woofer and full-range drivers.
- Separate central tweeter for pristine dialogue.
- 3.1.2 sound system. Up-firing speakers for Dolby Atmos.

Content at your command.

- Android TV. Simply smart.
- DTS Play-Fi. Multi-room audio.
- Voice control. Google Assistant built-in. Works with Alexa.

PHILIPS

4K UHD Android TV - Bowers&Wilkins Sound

P5 AI dual picture engine Sound by Bowers & Wilkins, Ambilight 4-sided, 139 cm (55") Android TV

Highlights

P5 engine with AI



Philips P5 processor with AI dual picture engine delivers a picture so real it feels like you could step right into it. A deep-learning AI algorithm processes images in a manner similar to the human brain. No matter what you're watching, you get lifelike detail and contrast, rich color, and smooth motion.

Sound by Bowers & Wilkins

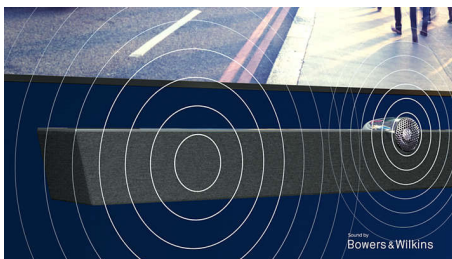

An exclusive speaker design by legendary audio engineers Bowers & Wilkins delivers thrillingly lifelike performance. Up-firing speakers let you get the most out of Dolby Atmos. A central tweeter keeps the dialogue pristine no matter how intense the drama gets.

Ambilight 4-sided

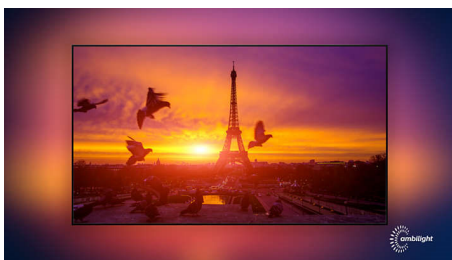

With Philips 4-sided Ambilight, every moment feels closer. Intelligent LEDs around the edge of the TV respond to the on-screen action and emit an immersive glow that's simply

captivating. Experience it once and wonder how you enjoyed TV without it.

Philips OLED+ TV

OLED+

A Philips 4K UHD OLED+ TV is compatible with all major HDR formats. Whether it's a must-watch series or the latest video game, shadows will be deeper. Bright surfaces will shine. Colors will be truer. Motion is incredibly smooth.

Dolby Vision and Dolby Atmos

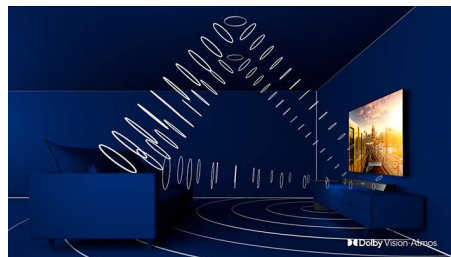

Support for Dolby's premium sound and video formats means the HDR content you watch will look-and sound-gloriously real. Whether it's the latest streaming series or a Blu-Ray disc set, you'll enjoy contrast, brightness, and color that reflect the director's original intentions. And hear spacious sound with clarity, detail, and depth.

Tactile harmony

Premium materials make all the difference to your Philips TV. Kvadrat's acoustically transparent wool-blend speaker fabric allows the sound to flow freely into the room. Responsibly sourced Muirhead leather and backlit keys add a sophisticated finish to the remote control.

55OLED935/56

Voice assistant

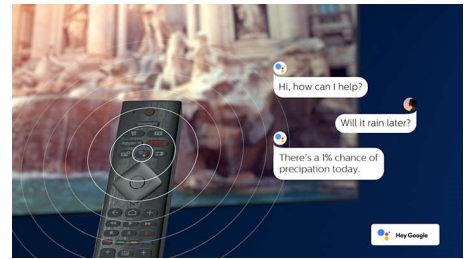

Control your Philips Android TV with your voice. Want to play a game, watch Netflix, or find content and apps in the Google Play store? Just tell your TV. You can even command all Google Assistant-compatible smart home devices, like dimming the lights and setting the thermostat on movie night. Without leaving the sofa. The days of searching for the TV remote are over. Now you can use your voice to control your Philips smart TV via Alexa-enabled devices, like Amazon Echo. Turn your TV on, change the channel, switch to your gaming console and more with Alexa.

DTS Play-Fi

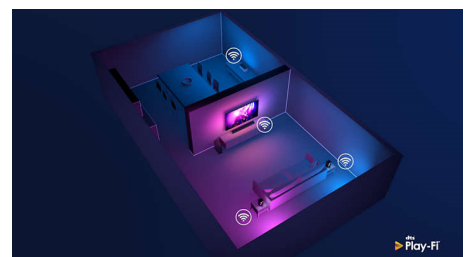

With DTS Play-Fi on your Philips TV you can connect to compatible speakers in any room. Got wireless speakers in the kitchen? Listen to the movie while you make a snack, or keep up with the sports commentary while you get everyone a drink.

Speaker configuration

Integrated sub-woofer and full-range drivers.

Specifications

Ambilight

- Ambilight Features: Built in Ambilight+hue, Ambilight Music, Game Mode, Wall colour adaptive, Lounge mode, AmbiSleep, Sunrise Alarm
- Ambilight Version: 4-sided

Picture/Display

- Aspect ratio: 16:9
- Display: 4K Ultra HD OLED
- Panel resolution: 3840x2160
- Picture engine: P5 AI Perfect Picture Engine
- Picture enhancement: Ultra Resolution, Wide Color Gamut 99% DCI/P3, Dolby Vision, Perfect Natural Motion, Super Resolution

Supported Display Resolution

- Computer inputs on all HDMI: up to 4K UHD 3840x2160 @60Hz, HDR supported, HDR10+/HLG, HDR supported, HDR10/ HLG
- Video inputs on all HDMI: up to 4K UHD 3840x2160@60Hz, HDR supported, HDR10/HLG (Hybrid Log Gamma), HDR10+/Dolby Vision

Tuner/Reception/Transmission

- Digital TV: DVB-T/T2
- Video Playback: PAL, SECAM
- MPEG Support: MPEG2, MPEG4
- TV Program guide*: 8 day Electronic Program Guide
- Signal strength indication
- Teletext: 1000 page Hypertext
- HEVC support

Android TV

- OS: Android TV™ 9 (Pie)
- Pre-installed apps: Google Play Movies*, Google Play Music*, Google Search, YouTube, BBC iplayer, Netflix, Amazon Prime Video
- Memory size(Flash): 16GB*

Smart TV Features

- User Interaction: SimplyShare
- Program: Pause TV, USB recording*
- Ease of Installation: Auto detect Philips devices, Device connection wizard, Network installation wizard, Settings assistant wizard
- Ease of Use: One-stop smart menu button, Onscreen usermanual
- Firmware upgradeable: Firmware auto upgrade

wizard, Firmware upgradeable via USB, Online firmware upgrade

- Screen Format Adjustments: Basic - Fill Screen, Fit to screen, Advance - Shift, Zoom, stretch, Wide screen
- Remote Control: with Voice, with Key light
- Voice assistant*: Google Assistant built-in, RC with Mic., Works with Alexa

Multimedia Applications

- Video Playback Formats: Containers: AVI, MKV, H264/MPEG-4 AVC, MPEG-1, MPEG-2, MPEG-4, WMV9/VC1, VP9, HEVC (H.265)
- Music Playback Formats: AAC, MP3, WAV, WMA (v2 up to v9.2), WMA-PRO (v9 and v10)
- Subtitles Formats Support: .SRT, .SUB, .TXT, .SMI
- Picture Playback Formats: JPEG, BMP, GIF, PNG, 360 photo, HEIF

Processing

- Processing Power: Quad Core

Sound

- Audio: Sound by Bowers & Wilkins, 3.1.2 Channel, Output power : 70 Watt (RMS)
- Speaker configuration: 10W x2, 5W x1, woofer 20W, height 12.5W x2
- Codec: AC-4, Dolby Atmos, Dolby Digital MS12 V2.3, DTS-HD(M6)
- Sound Enhancement: 5 Band Equalizer, A.I. Sound, Clear Dialogue, Dolby Atmos, Dolby Bass Enhancement, Dolby Volume Leveler, Night mode, Auto Volume Leveler, Bass Enhancement

Connectivity

- Number of HDMI connections: 4
- HDMI features: 4K, Audio Return Channel
- EasyLink (HDMI-CEC): Remote control pass-through, System audio control, System standby, One touch play
- Number of USBs: 2
- Wireless connection: Bluetooth 4.2, Wi-Fi 802.11ac, 2x2, Dual band
- Other connections: Digital audio out (optical), Ethernet-LAN RJ-45, Headphone out
- HDCP 2.3: Yes on all HDMI

EU Energy card

- Panel technology used: OLED

Power

- Mains power: AC 220 - 240 V 50/60Hz
- Ambient temperature: 5 °C to 35 °C
- Standby power consumption: <0.3W
- Power Saving Features: Auto switch-off timer, Light sensor, Picture mute (for radio), Eco mode

Accessories

- Included Accessories: Legal and safety brochure, Power cord, Quick start guide (x1), Stand with sound solution, 2 x AAA Batteries, Remote Control

Dimensions

- Set Width: 1227.8 mm
- Set Height: 705.6 mm
- Set Depth: 49.3 mm
- Product weight: 21.0 kg
- Set width (with stand): 1227.8 mm
- Set height (with stand): 805.5 mm
- Set depth (with stand): 260.7 mm
- Product weight (+stand): 28.1 kg
- Box width: 1400.0 mm
- Box height: 953.0 mm
- Box depth: 174.0 mm
- Weight incl. Packaging: 32.7 kg
- Wall mount compatible: 300 x 300 mm

Connections

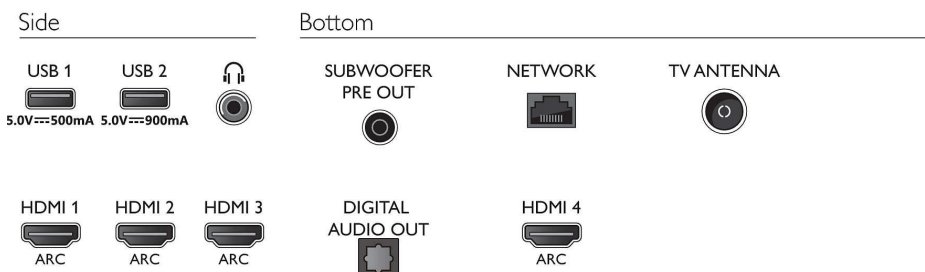

Issue date 2024-04-20

Version: 6.0.1

EAN: 87 18863 02892 6

© 2024 Koninklijke Philips N.V.
All Rights reserved.

Specifications are subject to change without notice.
Trademarks are the property of Koninklijke Philips N.V.
or their respective owners.

www.philips.com

* EPG and actual visibility (up to 8 days) is country and operator dependent.

* Android App offerings vary per country. For more details please visit your local Google Play Store.

* Philips TV Remote app and related functionalities vary per TV model, operator, and country, as well as smart device model and OS. For more details please visit: www.philips.com/TVRemoteapp.

* Smart TV app offerings vary per TV model and country. For more details please visit: www.philips.com/smarttv.

* Its functionality is subject to ChromeCast built-in apps and smart devices. For more details, please visit ChromeCast built-in product pages.

* Memory size (Flash) : 16G, the actual available disc space may differ (dependant on e.g. (pre-)installed apps, installed operating system, etc.)

* Image depicted on the website are non-contractual pictures. Please always refer to the actual TV that are sold in the retail or stores.