

LCD TV

Quick Use Guide

26PF5320
32PF5320
32PF7320

Thank you for purchasing Philips LCD Television set. You are now the proud owner of a LCD TV set which promises full value to you as a customer. This Quick Use Guide is designed to help you to do the connections to install and operate your TV. We strongly recommend you to read the instructions thoroughly.

LISTING THE ACCESSORIES

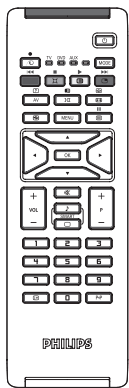

Remote Control x 1

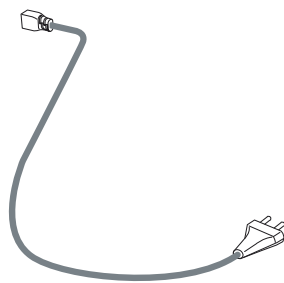

TV mains cord (two-pin) x 1

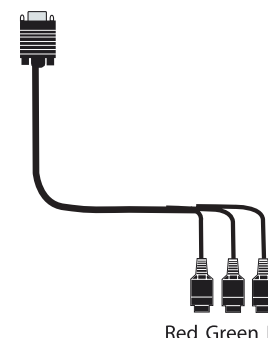

VGA socket (DB-15) to cinch x 1

LCD TV STAND ASSEMBLY

First, assemble the LCD TV using the steps below:

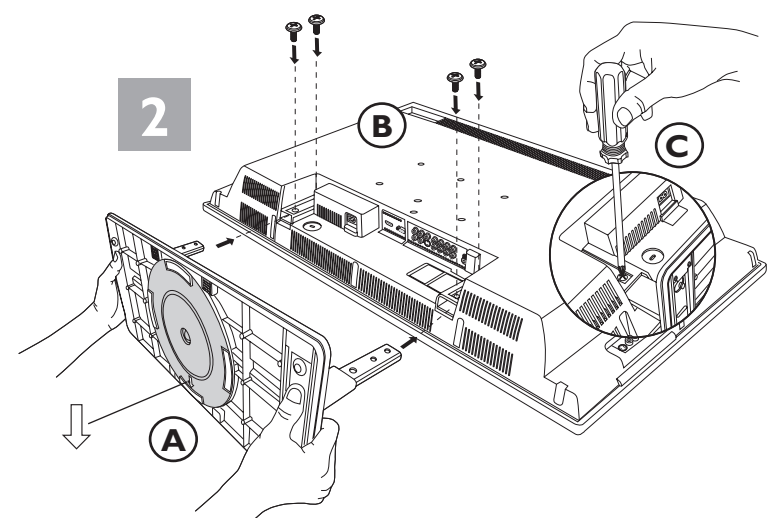
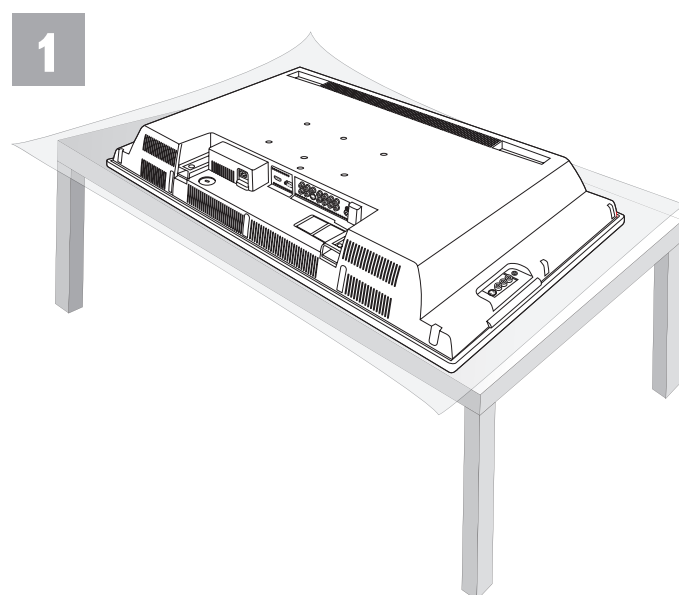
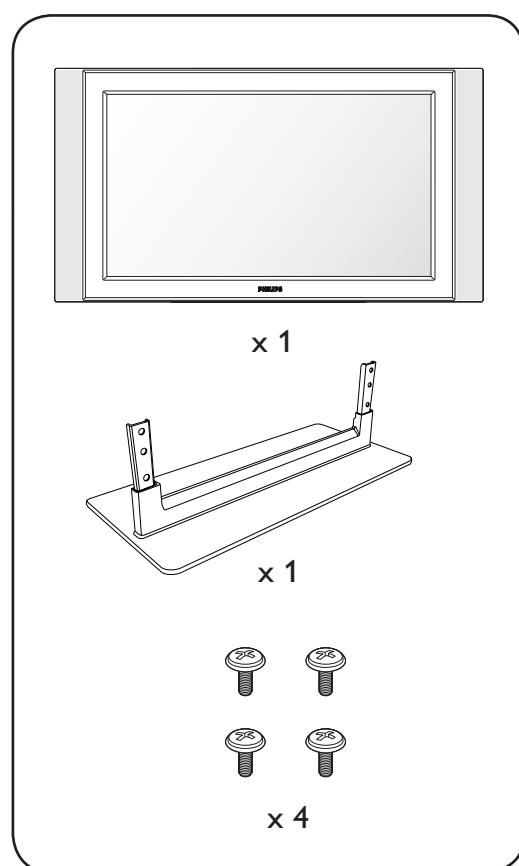

BASIC LCD TV OPERATION

Gently pull out the stand arm cover to locate all the sockets at the bottom of the set.

- 1 Connect the aerial cable (not supplied) from the aerial socket of the TV to the wall socket.
- 2 Connect the mains cord to the television power inlet and the mains plug into the wall socket.
- 3 Press the POWER button at the side of the TV set to switch to turn on the TV.
- 4 Press the VOLUME + button to increase the sound level or the decrease the VOLUME - button to lower the sound level.
- 5 Press the PROGRAM + or - button to select the TV programmes.
- 6 Press the MENU button to display the on-screen menu. Use the VOLUME and PROGRAM buttons for selection and adjustments in the on-screen menu.

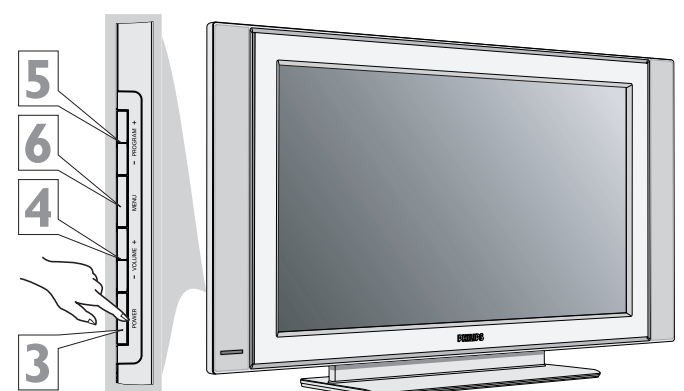
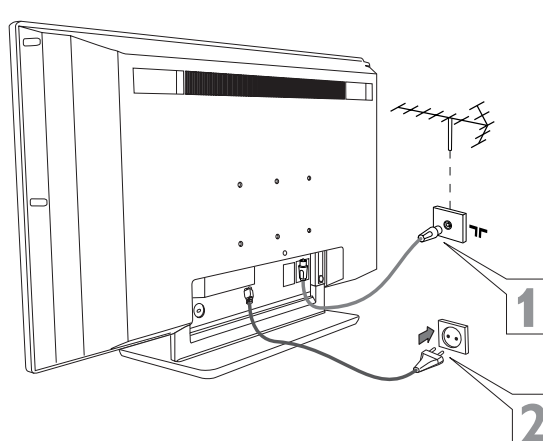

CONNECTING PERIPHERAL EQUIPMENT TO THE LCD TELEVISION

CABLE/CABLE BOX TV

Your Cable TV input into your home may be a single (75 ohm) cable or use a cable box decoder. In either case the connection is very simple. Follow the steps below to connect your cable signal to your new television.

Direct Cable Connections:

This connection will supply Stereo sound to the TV.

- 1 Connect the open end of the round Cable Company supplied cable to the 75Ω input on the bottom of the TV.

Direct Cable Connection:

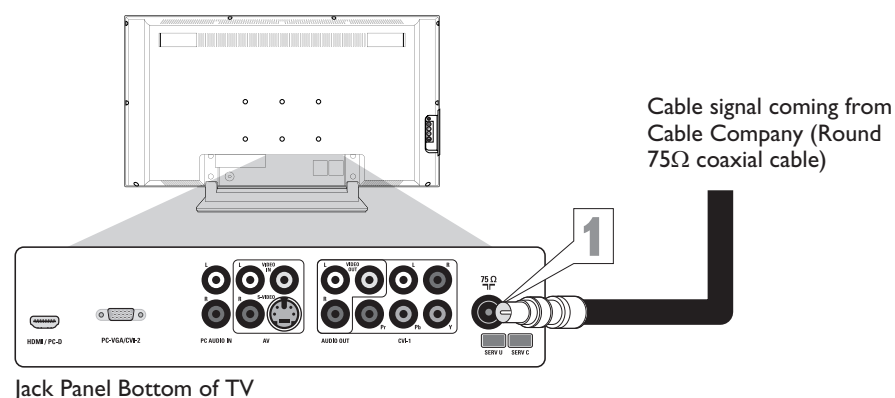

Cable Box (w/RF In/Outputs):

This connection will NOT supply Stereo sound to the TV. The sound from the cable box will be mono.

- 1 Connect the open end of the round Cable Company supplied cable to the cable signal IN(put) plug on the back of the Cable Box.
- 2 Using a separate round coaxial cable, connect one end to the OUT(put) (TO TV) plug on the back of the Cable Box.
- 3 Connect the other end of the round coaxial cable to the 75Ω input on the bottom of the television.

NOTE: Be sure to set the OUTPUT CHANNEL SWITCH on the back of the cable box to CH 3 or 4, then tune the cable box on the TV to the corresponding channel. Once tuned, change channels at the cable box, not the television.

Cable Box with RF Inputs and Outputs Connection:

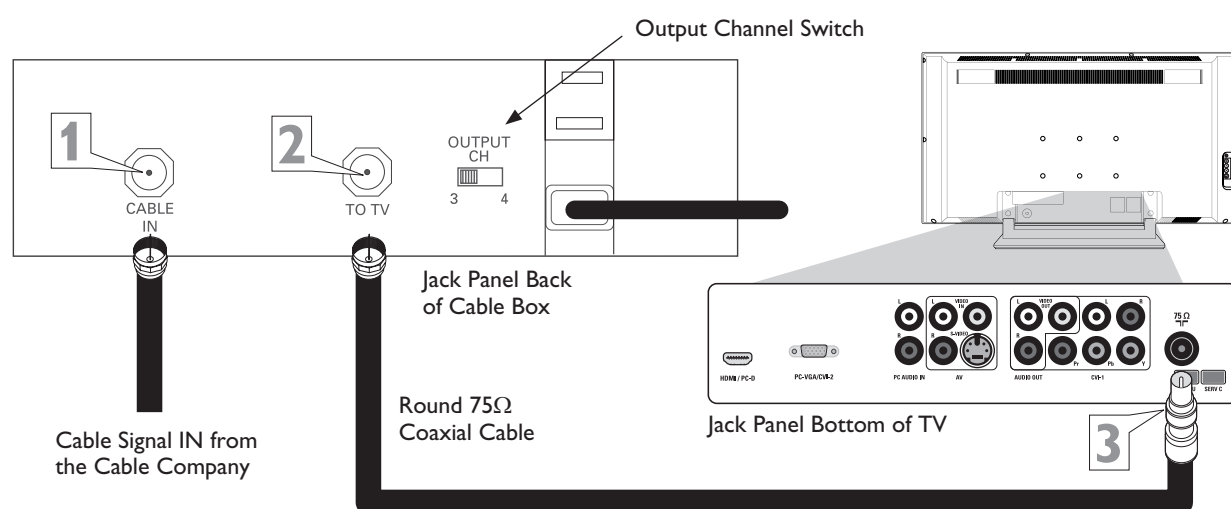

Cable Box (w/Audio/Video Outputs):

This connection will supply Stereo sound to the TV.

- 1 Connect the open end of the round Cable Company supplied cable to the cable signal IN(put) plug on the back of the Cable Box.
- 2 Using an RCA type Video Cable, connect one end of the cable to the Video (yellow) (or ANT, your cable box may be labeled differently) Out jack on the cable box and the other end to the Video In jack on the bottom of the TV.
- 3 Using an RCA type Audio Left and Right Cable, connect one end to the left and right Audio Out L & R jacks (red & white) on the cable box and the other ends to the Audio In L & R jacks on the bottom of the TV.

NOTE: Use the AV button and the CURSOR DOWN/RIGHT on the TV remote control to tune to the AV channel for the cable box signal. Once tuned, change channels at the cable box, not the television.

Cable Box with Audio/Video Outputs Connection:

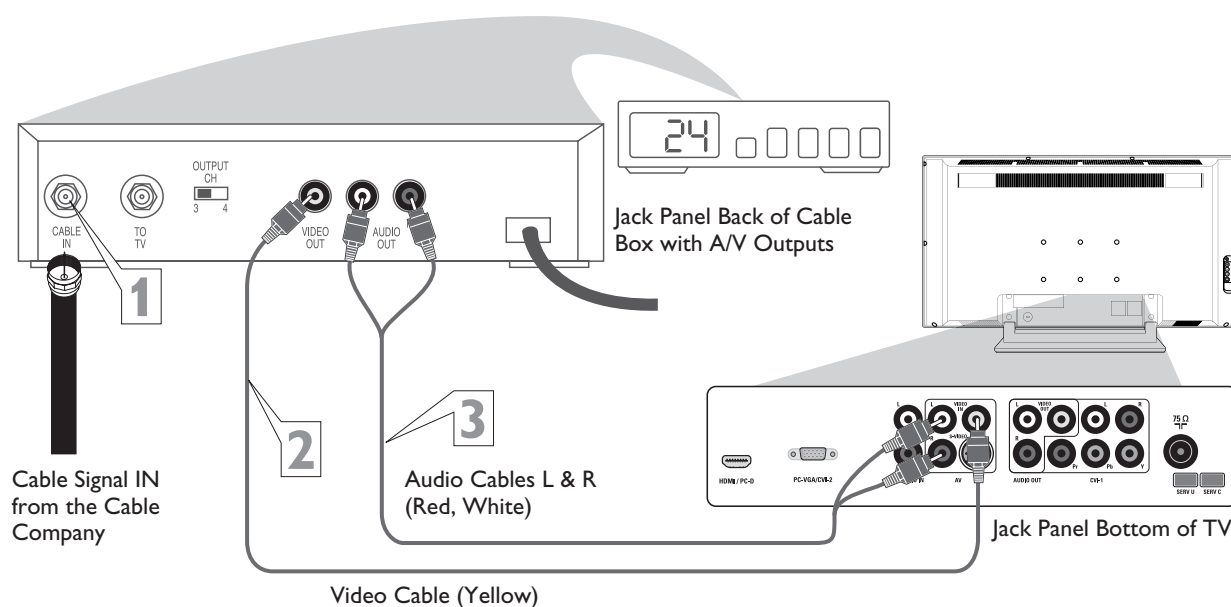

CONNECTING PERIPHERAL EQUIPMENT TO THE LCD TELEVISION

AV INPUTS

The audio/video input jacks on the bottom panel of the TV are for direct picture and sound connections between the TV and a VCR (or similar device) that has audio/video output jacks.

- 1 Using an RCA type Video Cable, connect one end of the cable to the Video (yellow) Out jack on the VCR or accessory device and the other end to the AV Video In jack on the bottom of the TV.
- 2 Using an RCA type Audio Left and Right Cable, connect one end to the left and right Audio Out L & R jacks (red & white) on the VCR or accessory device and the other ends to the AV Audio In L & R jacks on the bottom of the TV.
- 3 Turn the VCR or accessory device and the TV On.
- 4 Press the AV button on the remote control to show the Source List menu on the TV screen.
- 5 Press the ▼ button repeatedly until AV is highlighted, then press the ► button to enter the selected Mode.
- 6 With the VCR (or accessory device) ON and a prerecorded tape (CD, DVD, etc.) inserted, press the PLAY button to view the tape on the television.

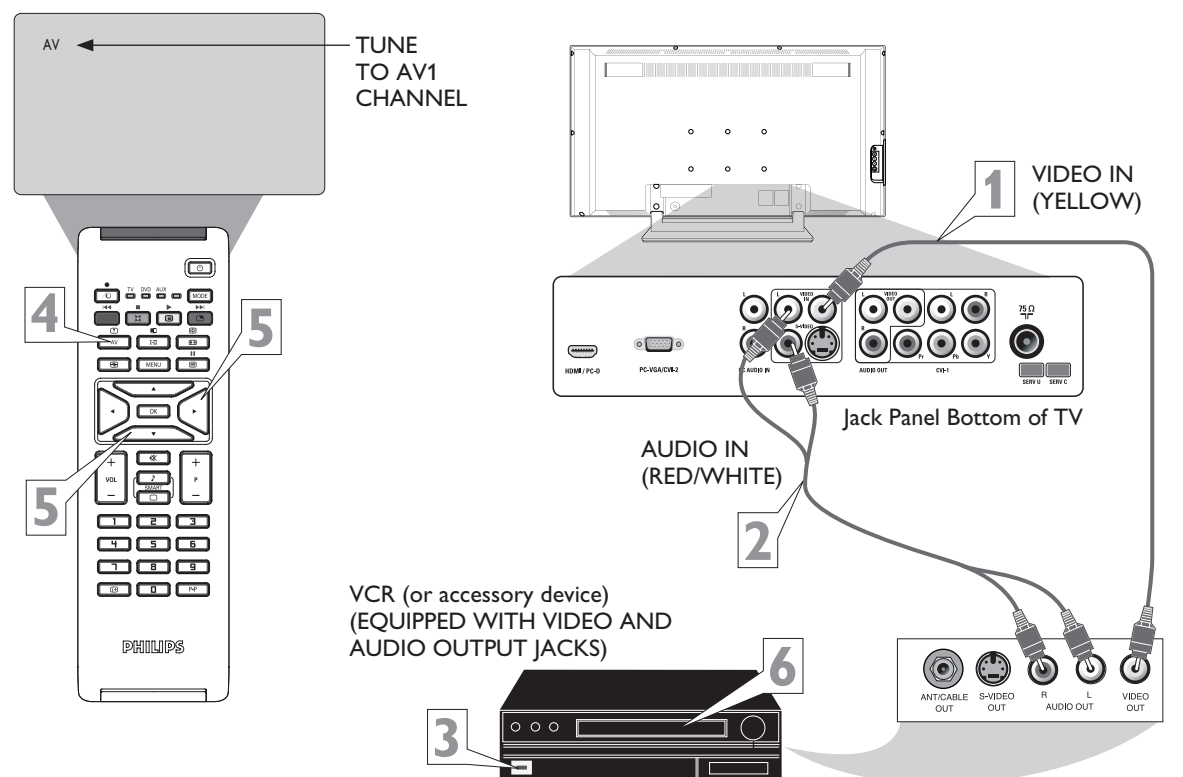

COMPONENT VIDEO INPUTS (CVI)

Component Video inputs provide the highest possible color and picture resolution in the playback of digital signal source material, such as with DVD players.

- 1 Connect the Component (Y, Pb, Pr) Video OUT jacks from the DVD player (or similar device) to the CVI-1 VIDEO Input (Y green, Pb blue, Pr red) jacks on the bottom of the TV.
- 2 Connect the red and white AUDIO CABLES to the Audio (left and right) output jacks on the rear of the accessory device to the CVI-1 Audio In L & R jacks on the bottom of the TV.
- 3 Turn the TV and the DVD player (or digital accessory device) ON.
- 4 Press the AV button on the remote control to show the Source List menu on the TV screen.
- 5 Press the ▼ button repeatedly until CVI-1 is highlighted, then press the ► button to enter the selected Mode.
- 6 Insert a DVD disc into the DVD player and press the PLAY button on the DVD Player.

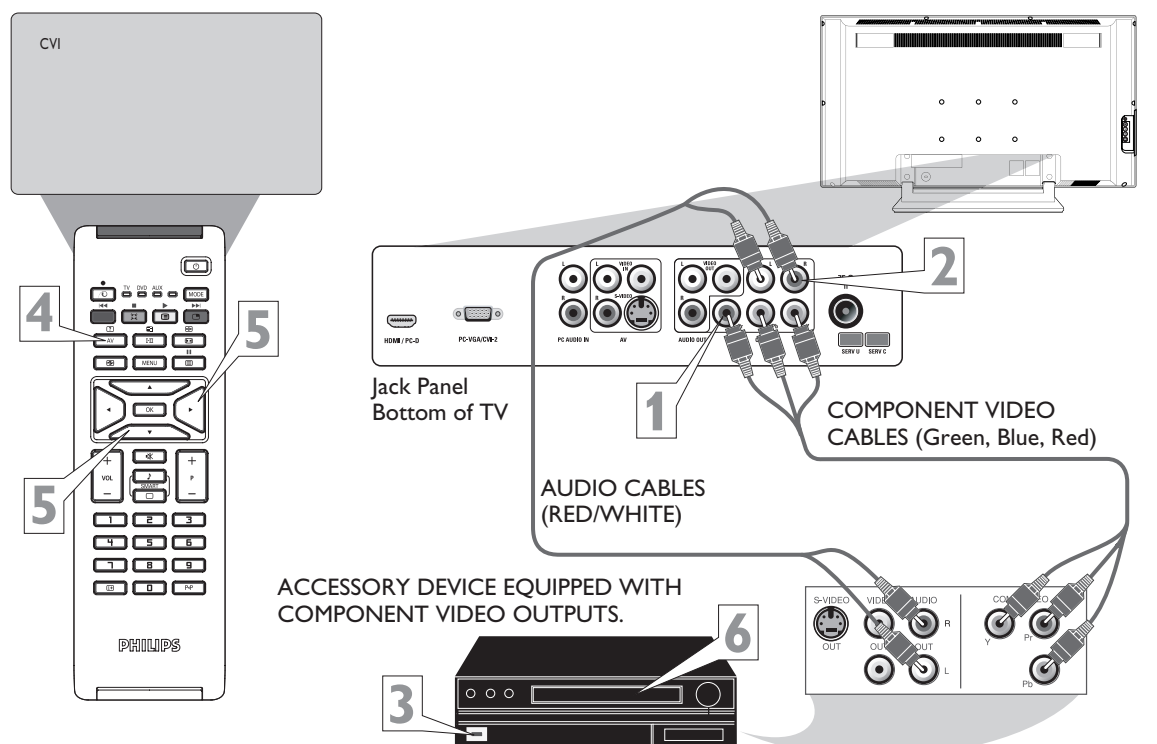

HELPFUL HINT

The description for the component video connectors may differ depending on the DVD player or accessory digital source equipment used (for example, Y, Pb, Pr; Y, B-Y, R-Y; Y, Cr, Cb). Refer to your DVD player or digital accessory owner's manual for definitions and connection details.

HD (HIGH DEFINITION) INPUTS

If you are using a High Definition receiver that can transmit high definition programming, the TV can except those signals through the HD Inputs located on the bottom of the TV.

- 1 For Digital Connection, connect the HDMI connector of the HD Receiver (or similar device) to the HDMI Input jacks on the bottom of the TV.
OR
For Analog Connection, use Component Video cables to connect the Component (Y, Pb, Pr) Video Out jacks of the HD Receiver (or similar device) to the VGA adapter (supplied with the TV). Connect the other end of the adapter to the VGA Input jacks (CVI-2) on the bottom of the TV.
- 2 Connect the red and white audio cable to RCA type Audio Cables. Connect the audio adapter to the PC Audio In L & R jacks on the bottom of the TV.
- 3 Turn the TV and the HD Receiver ON.
- 4 Press the AV button on the remote control to show the Source List menu on the TV screen.
- 5 Press the ▼ button repeatedly until HDMI or CVI-2 (SD/HD) is highlighted, then press the ► button to enter the selected Mode.

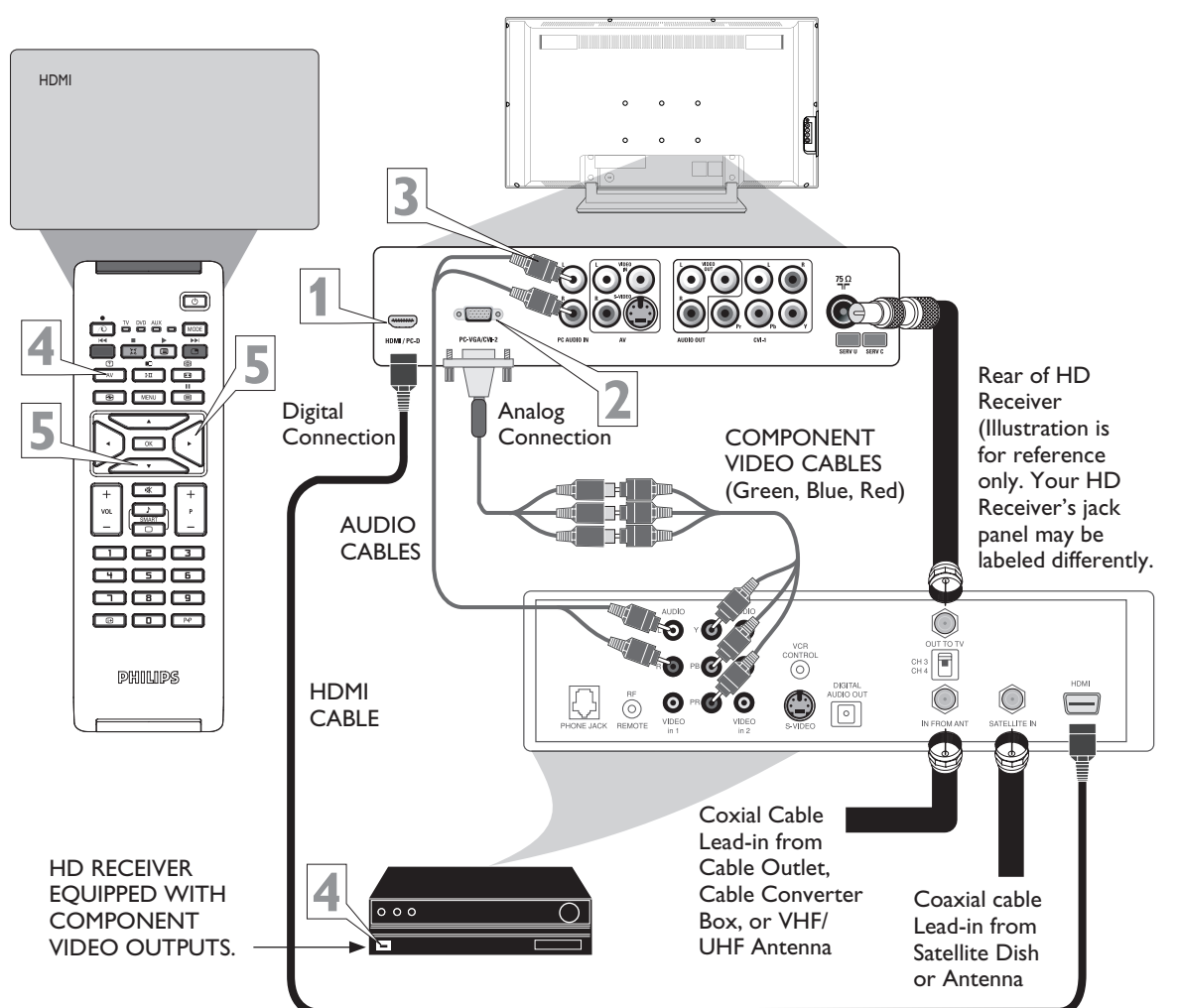

CONNECTING PERIPHERAL EQUIPMENT TO THE LCD TELEVISION

PC (MONITOR) INPUTS

This TV can be used as a PC Monitor. Your computer will have to be equipped with a VGA (or DVI type video output) and VGA cable (or a DVI to HDMI cable).

- 1 Connect one end of the VGA Video cable to the Monitor (video) output on the computer to the PC-VGA/CVI-2 jack on the bottom of the TV.
OR
if your computer comes with DVI video output, you can use a DVI to HDMI cable to connect from the computer's DVI output to the HDMI/PC-D input on the bottom of the TV.
 - 2 The TV can reproduce the computer's audio. Using a 3.5mm Stereo Plug to 2 RCA Plugs "Y" Cable, connect the Stereo plug to the Audio output jack on the computer (if available) while connecting the Left and Right RCA plugs to the Audio In L and R (PC AUDIO IN) Input Jacks on the bottom of the TV.
- Note: If you are connecting the computer using a DVI to HDMI cable and audio cable to the TV, you will need to press the **I-II** button on the remote control repeatedly until the computer's audio is reproduced.
- 3 Turn the TV and the computer ON.
 - 4 Press the AV button on the remote control to show the Source List menu.
 - 5 Press the **▼** button repeatedly until PC-VGA is highlighted if you have connected the computer to the TV using a VGA cable;
OR
until PC-D is highlighted if you have connected the computer to the TV using a DVI to HDMI cable.
 - 6 Press the **►** button to enter the selected Mode.

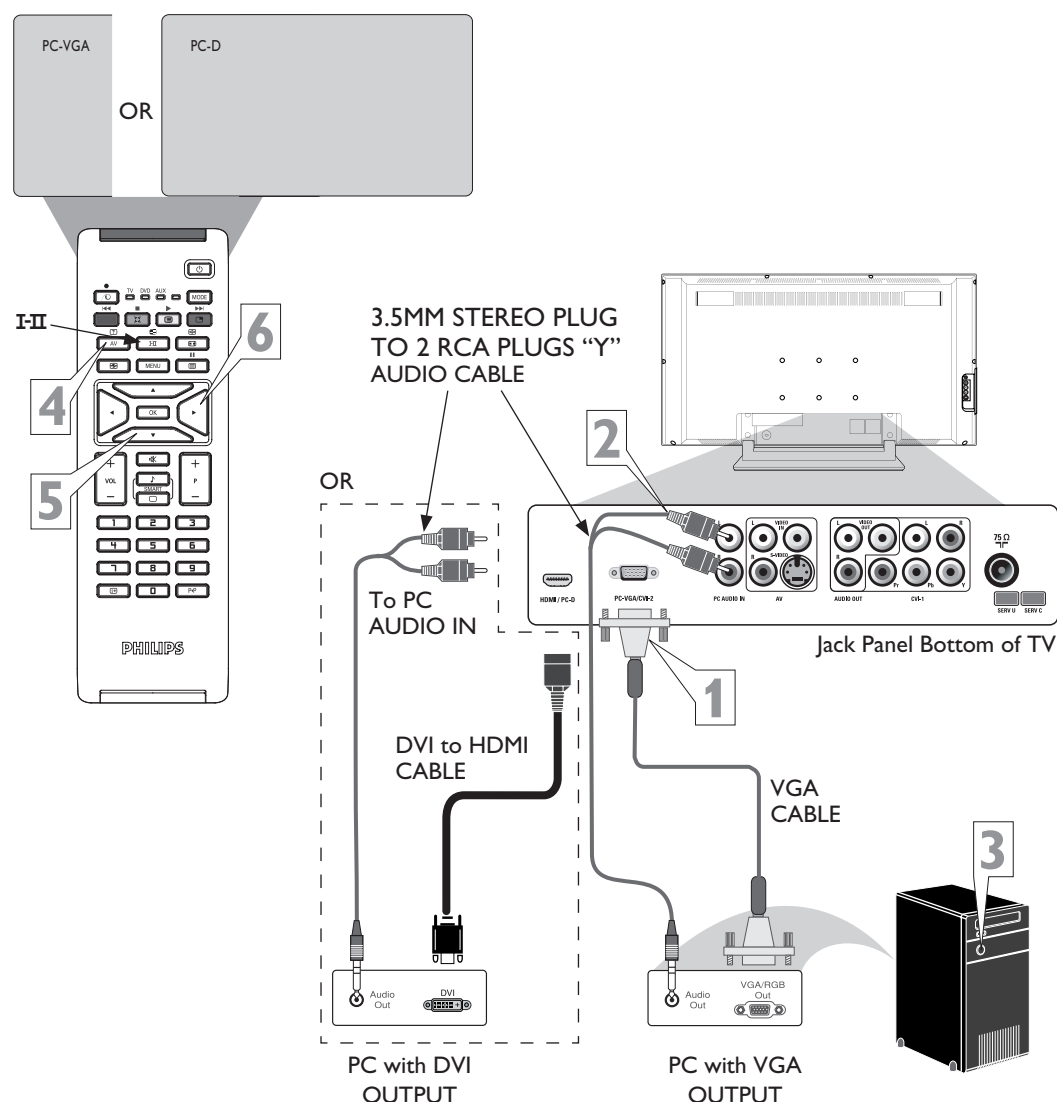

AV OUTPUTS

There are Audio/Video output jacks located on bottom of the TV that can also be used for extra accessory device connections for items such as an external audio system, a video recorder or even an additional TV.

For External Audio System Connection:

- 1 Using an RCA type Audio Left and Right Cable, connect one end to the left and right Audio In (or AUX) L & R jacks (red & white) on the external audio system and the other ends to the Audio Out L & R jacks on the bottom of the TV.
- 2 Turn the external audio system and the TV On. TV sound can be heard through the audio system.

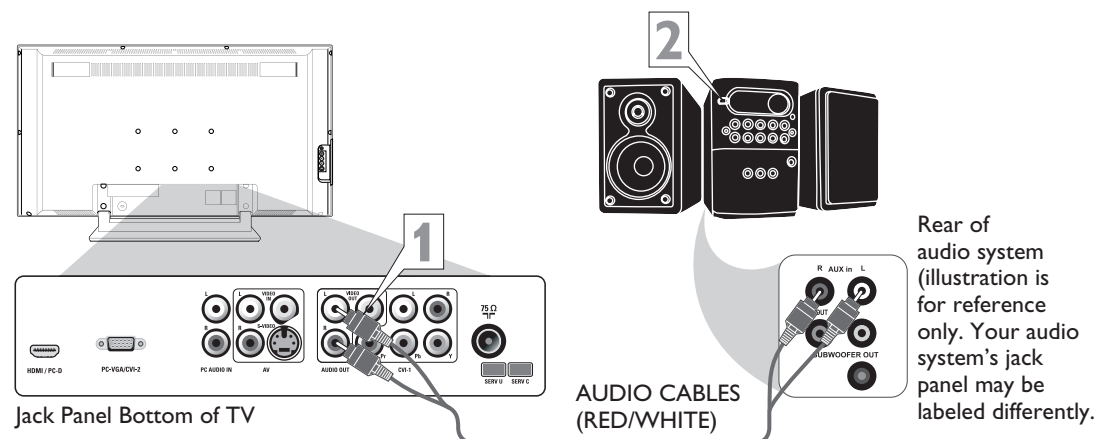

REAR/SVHS INPUTS

Much like the AV jacks, the REAR/SVHS jacks allow for extra accessory device connections. The REAR/SVHS Input Jacks are located on the rear of the TV.

- 1 Connect the VIDEO (yellow) adapter cable to the VIDEO AV3 in jack on the left rear of the TV. Connect the other end of the VIDEO (yellow) cable to an RCA type VIDEO Cable. Connect that cable to the VIDEO OUT jack on the back of the accessory device being used. Note: An S-Video cable can be used in place of the yellow Video cable if your device is equipped with an S-Video Output. S-Video provides better video playback.
- 2 Connect the AUDIO (red and white) adapter cable to an RCA type Audio Cable. Connect the other ends of the AUDIO (red and white) cables to the AUDIO (left and right) OUT jacks on the rear of the accessory device being used.
- 3 Turn the accessory device and the TV ON.
- 4 Press the AV button on the remote control to show the Source List menu on the TV screen.
- 5 Press the **▼** button repeatedly until REAR/SVHS is highlighted, then press the **►** button to enter the selected Mode.
- 6 With the accessory device ON, press the PLAY button to activate the playback on the television.

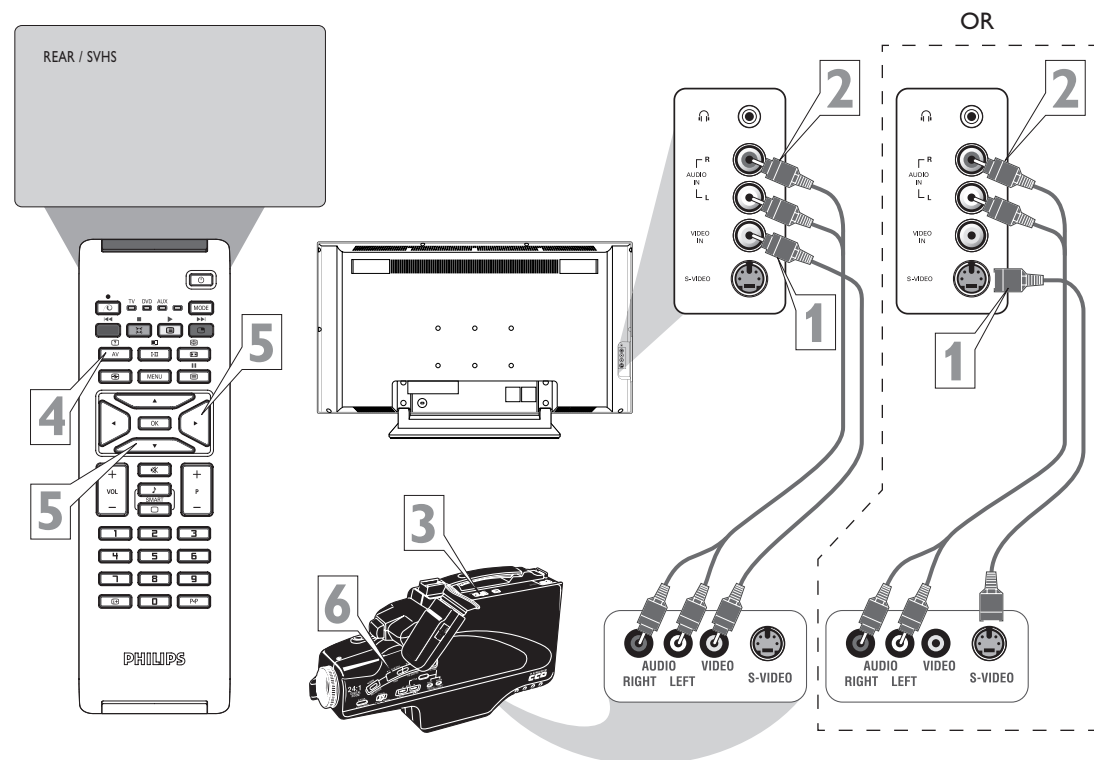

HEADPHONE CONNECTIONS

The Headphone jack can be used to connect to a headphone. If connected to a headphone, there will be no sound from the TV speakers. The sound will come from the audio system of the headphone.

- 1 Connect Headphone jack located on the right rear of the TV to your headphone set.
- 2 Turn the TV and headphone ON. TV sound can be heard through the headphone.

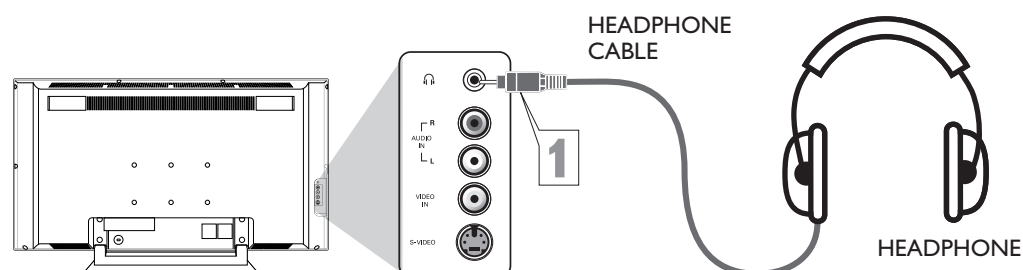

液晶电视机

快速使用指南

26PF5320
32PF5320
32PF7320

感谢您选购飞利浦液晶电视机。现在您是值得骄傲的飞利浦液晶电视机用户，这保证您拥有作为顾客所有的权益。该快捷使用与安装指南可帮助您连接安装并操作您的电视机。飞利浦强烈推荐您仔细阅读其中的使用说明。

附件列单

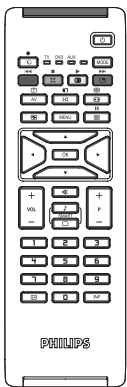

遥控器1个

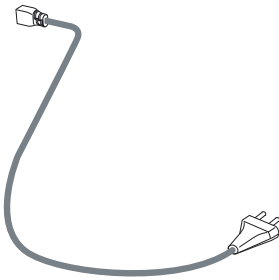

电视主电源线（双引线）1个

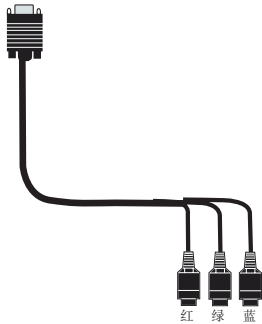

VGA插座（DB-15）1个

液晶电视机支架组装

首先，遵循以下步骤组装液晶电视机。

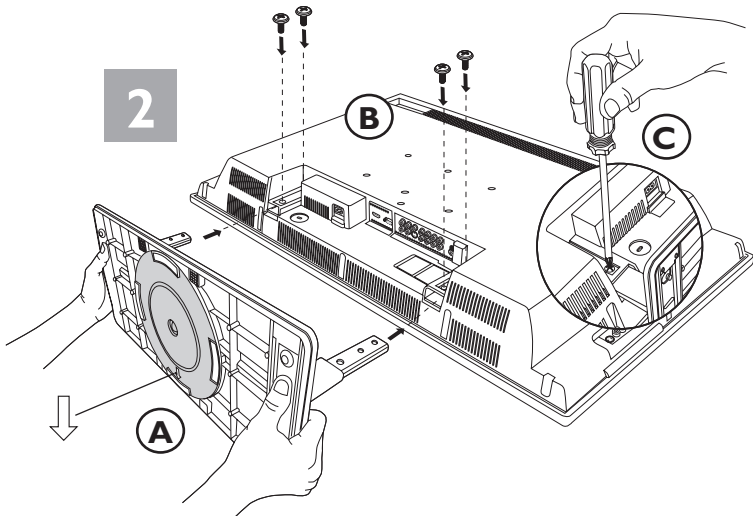
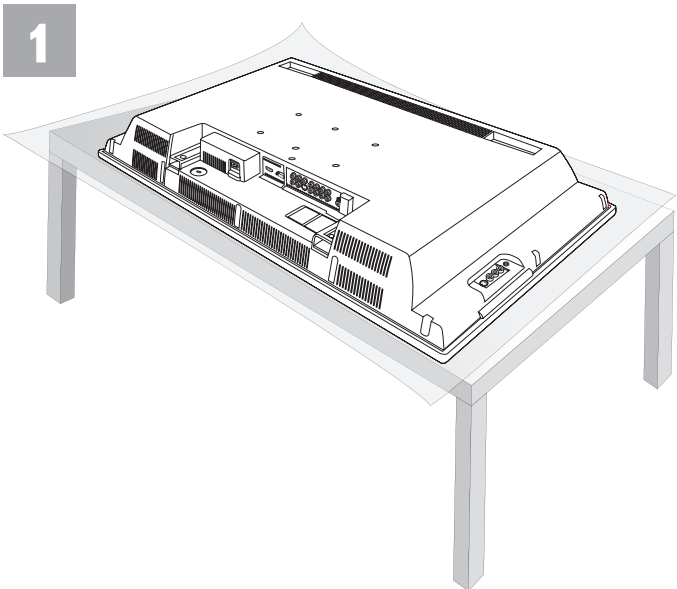
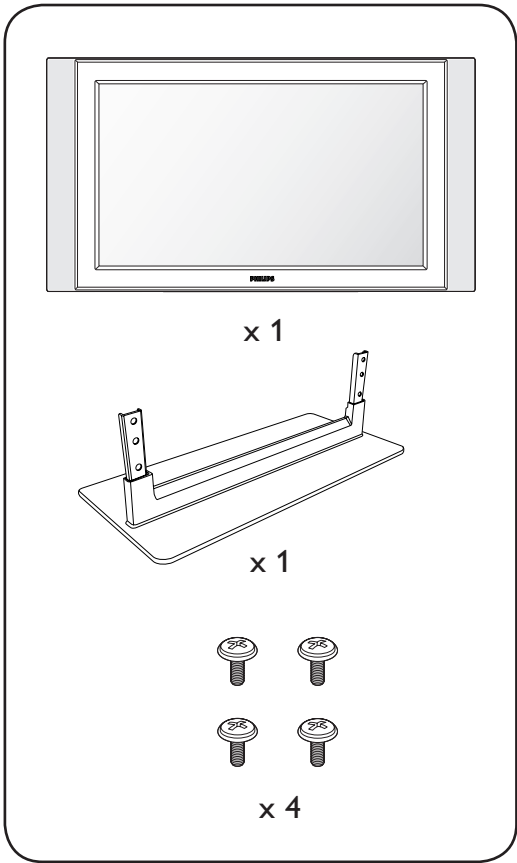

基本液晶电视操作

- 1 将电视机放置在一个坚固的，足以承受电视机重量的地方。为避免危险，不要将电视机暴露在水源或是热源（比如电灯，蜡烛，取暖器），不要阻塞电视机后面的通风口。
- 2 将电源线连接到电视机，将电源插头插入墙面插座。
- 3 按下电视机盒前方的电源键，开启电视机。
- 4 按VOLUME+键增大音量或是VOLUME-键降低音量。
- 5 按下PROGRAM +或是-键选择电视频道。
- 6 按菜单键显示屏幕菜单。使用音量键与频道键进入调整或是在屏幕菜单中进行选择。

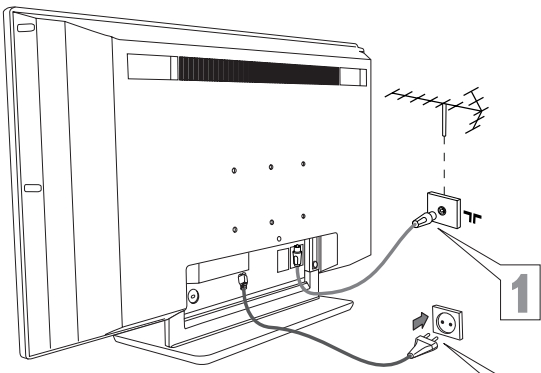

将外部设备连接到液晶电视机上

电缆/电缆盒电视

您居室的电缆电视输入端子可能是单线75（欧姆）电缆或是使用电缆盒解码器。无论哪种情况，连接都非常便捷。遵循以下步骤把电缆信号连接到您的新电视机上。

直接电缆连接：

该连接可使电视机具备立体声效果。

- 1 把电缆公司提供的圆形电缆的开口端连接到电视机底部的75欧姆输入端子上。

直接电缆连接

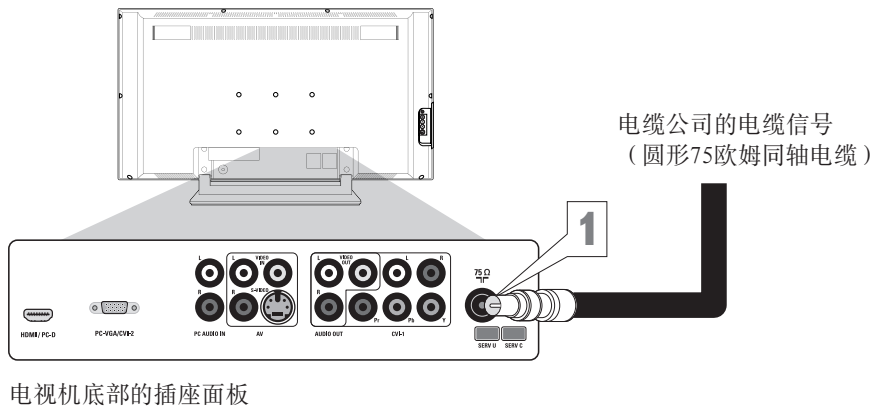

电缆盒（w/RF输入/输出端）：

该连接下，电视机不具备立体声效果。电缆盒输出的声音为单声道。

- 1 把电缆公司提供的圆形电缆的开口端连接到电缆盒后面的电缆信号输入端子上。
- 2 使用一根独立的圆形同轴电缆，把其一端连接到电缆盒后面的（TO TV）输出端子上。
- 3 把圆形同轴电缆的另一端连接到电视机底部的75欧姆输入端子上。

配有RF输入输出端的电缆盒

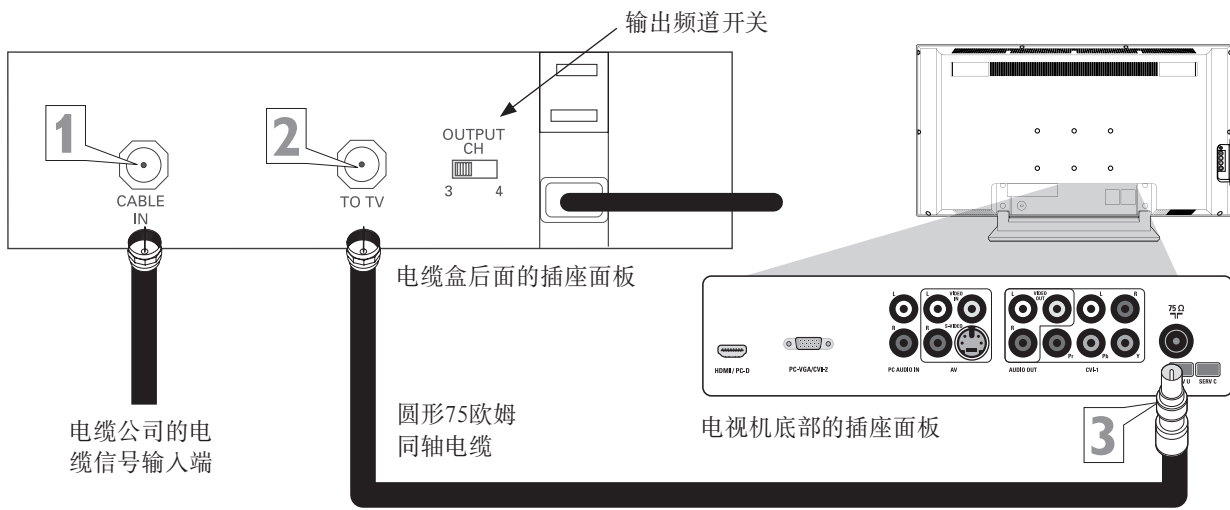

注意： 确保电缆盒后面的OUTPUT CHANNEL SWITCH设置到CH3或是CH4, 然后把电视机上的电缆盒调频至相应的频道。一旦调频结束后，改变电缆盒中的频道，而不是电视频道。

电缆盒（w/音频/视频输出）

该连接可使电视机具备立体声效果。

- 1 把电缆公司提供的圆形电缆的开口端连接到电缆盒后面的电缆信号输入端子上。
- 2 使用一根RCA型号的视频电缆，把电缆的一端连接到电缆盒上的视频（黄色）输出端子（或是ANT，您的电缆盒可能以不同颜色标注），另一端连接到电视机底部的视频输入端子上。
- 3 使用RCA型号的音频左右电缆，把其一端连接到电缆盒上的左右音频输出L&R端子（红色&白色）上，将其另一端连接到电视机底部的音频L&R输入端子上。

配有音频/视频输出连接的电缆盒

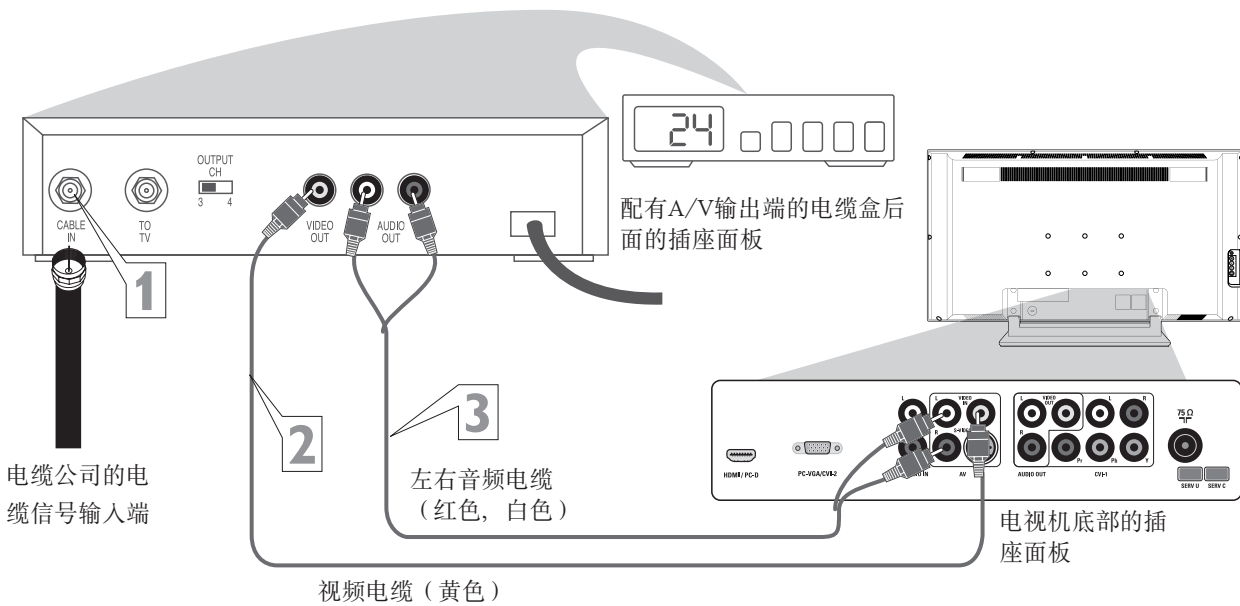

注意： 使用遥控器上的AV键与光标下移/右移键调谐到接收电缆盒信号的AV频道。一旦调频结束后，改变电缆盒中的频道，而不是电视频道。

将外部设备连接到液晶电视机上

AV输入

电视机底部面板上的音频/视频输入端子可直接用于电视与配有音频/视频输出端子的VCR（或是类似设备）的画面与声音连接。

- 1 使用RCA型号视频电缆，把其中一端连接到录像机或是其它附件设备的视频（黄色）输出插座，另一端连接到电视机底部的AV视频输入插座。
- 2 使用RCA型号的音频左右电缆，将一端连接到录像机或是其它附件设备的左右音频输出L&R插座（红色与白色），另一端连接到电视机底部的AV音频输入L&R插座中。
- 3 开启VCR或是其它附件设备与电视机。
- 4 按遥控器上的AV键在电视机屏幕上显示信源列表菜单。
- 5 连续按▼键直到AV高显亮，再按▶键进入被选择的模式。
- 6 开启VCR（或是其它附件设备），放入预先录制好的磁带（CD,DVD等等），按VCR上的PLAY键在电视机上观赏节目。

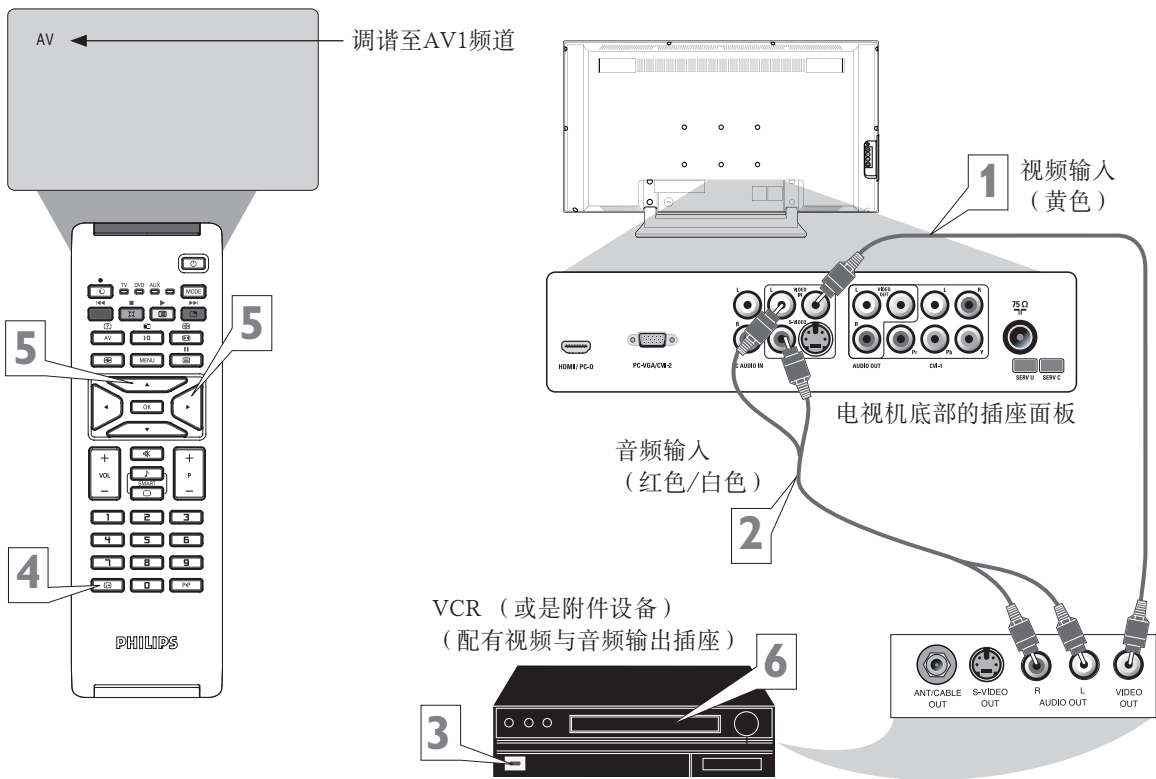

组合视频输入（CVI）

组合视频输入在回放数码信号源时，提供最佳的色彩与画面分辨率，比如DVD播放器。

- 1 把DVD播放器（或是类似设备）上的组合（Y,Pb, Pr）视频输出端子连接到电视机底部的组合视频输入端子（Y绿色， Pb蓝色， Pr红色）。
- 2 把附件设备的后面的红色与白色音频电缆分别连接到音频（左与右）输出插座与电视机底部的CVI-1音频输入左右插座。
- 3 开启电视机与DVD播放器（或是其它数码附件设备）。
- 4 按遥控器上的AV键在电视屏幕上显示信源列表菜单。
- 5 反复按▼键直到CVI-1高显亮，然后按▶键进入被选择的模式。
- 6 将DVD碟片放入DVD播放器，按DVD播放器的播放键。

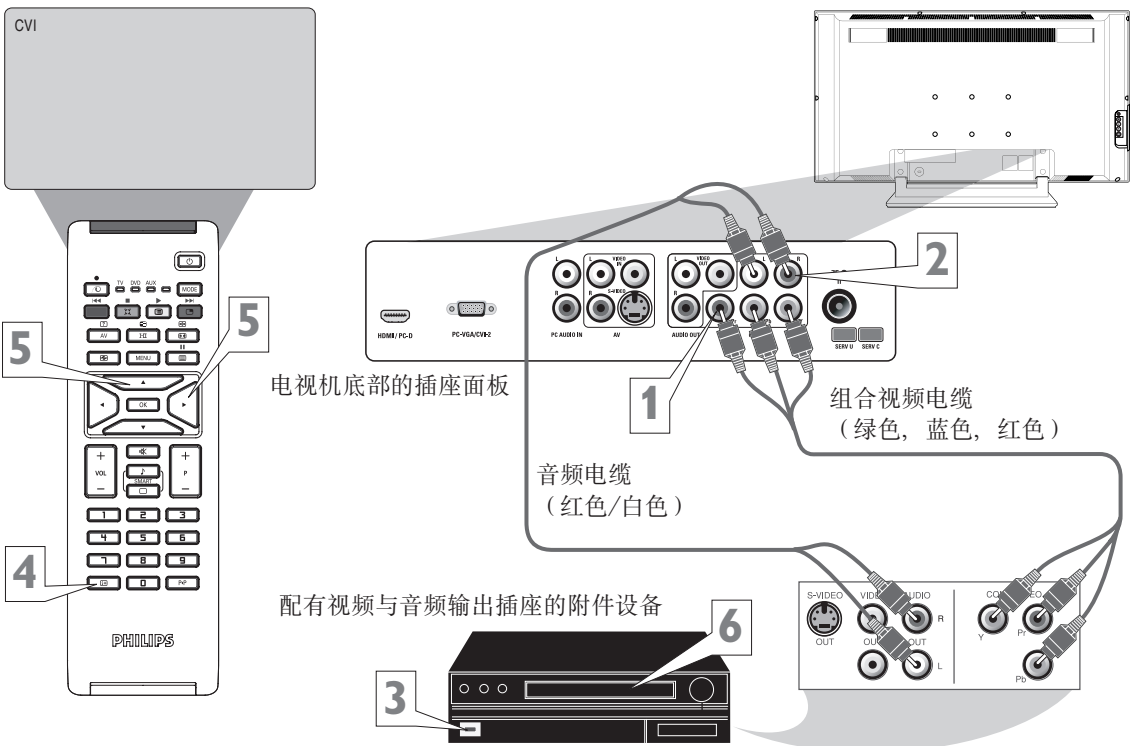

实用提示

根据使用的DVD播放器或是使用的附件数码信号设备（比如Y, Pb, Pr; Y, B-Y, R-Y; Y, Cr, Cb）不同，有关组合视频连接器介绍可能不同。请参阅使用手册有关DVD播放器或是数码附件的定义与连接内容。

HD（高清晰度）输入

如果您使用能传输高清晰度节目的高清晰度接收器，液晶电视机能通过电视机底部的HD输入端子接收这些信号。

- 1 如果是数码连接，把HD接收器（或是其它类似设备）上的HDMI连接器连接到电视机底部的HDMI连接器。
或是
如果是模拟连接，把组合视频电缆分别连接HD接收器（或是类似设备）上的组合视频输出端子（Y, Pb, Pr）与VGA适配器（随机提供）。把适配器的另一端连接到电视机底部的VGA输入插座（CVI-2）。
- 2 把红色与白色音频电缆连接到RCA型号的音频电缆。把音频适配器连接到电视机底部的PC音频输入左右插座。
- 3 开启电视机与HD接收器。
- 4 按遥控器上的AV键在屏幕上显示信源列单菜单。
- 5 连续按▼键直到HDMI或是CVI-2(SD/HD)高显亮，再按▶键进入被选择的模式。

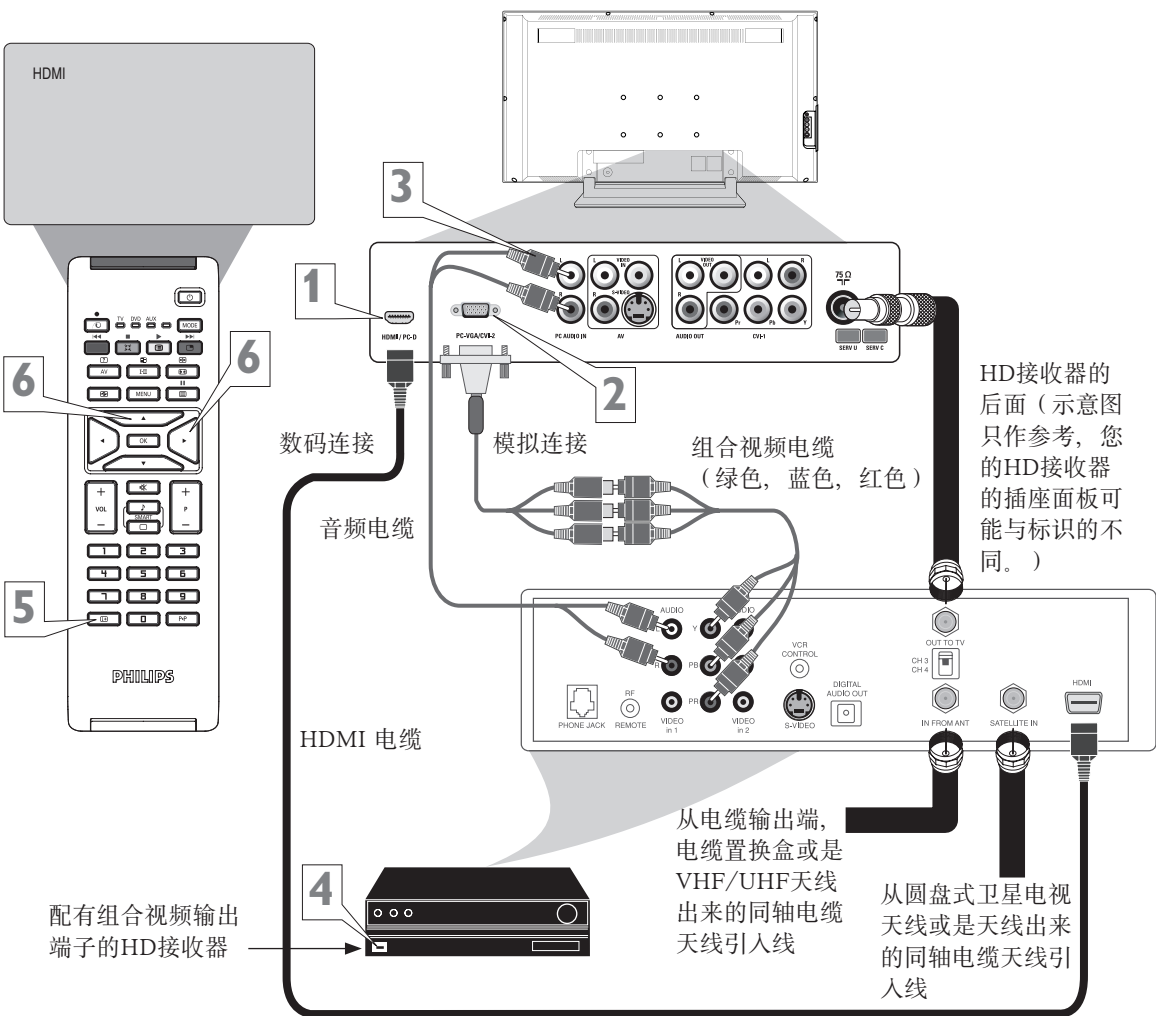

将外部设备连接到液晶电视机上

PC（显示器）输入

本电视机也可用作电脑显示器。您的电脑应配有VGA型号视频输出 (或是DVI型号视频输出)与VGA电缆（或是DVI to HDMI电缆）。

- 把VGA视频电缆的两端分别连接到电脑上显示器（视频）输出端子到电视机底部的PC-VGA/CVI-2插座上。
或是
如果您的电脑配有DVI视频输出端子，您可使用DVI to HDMI 电缆分别连接电脑的DVI输出端子与电视机底部的HDMI/PC输出端子。
- 电视机能复制电脑的音频。使用3.5毫米立体声插座连接2 RCA 插座 “Y” 电缆，当把左右RCA插座连接到电视机底部的左右音频输入端子(PC音频输入)，把立体声插头连接到电脑上的音频输出插座（如果提供）。
注意：如果您使用DVI to HDMI 电缆与音频电缆将电脑连接到电视机上，您需连续按遥控器上的 **I-II** 键直到电脑的音频被复制。
- 开启电视机与电脑。
- 按遥控器上的AV键显示信源列单菜单。
- 如果您已经使用VGA电缆将电脑连接到电视上，反复按 **√** 键直到PC-VGA高显亮；
或是
如果您使用DVI to HDMI 电缆将电脑连接到电视机上，反复按 **√** 键直到PC-D高显亮。
- 按 **>** 键进入被选择的模式。

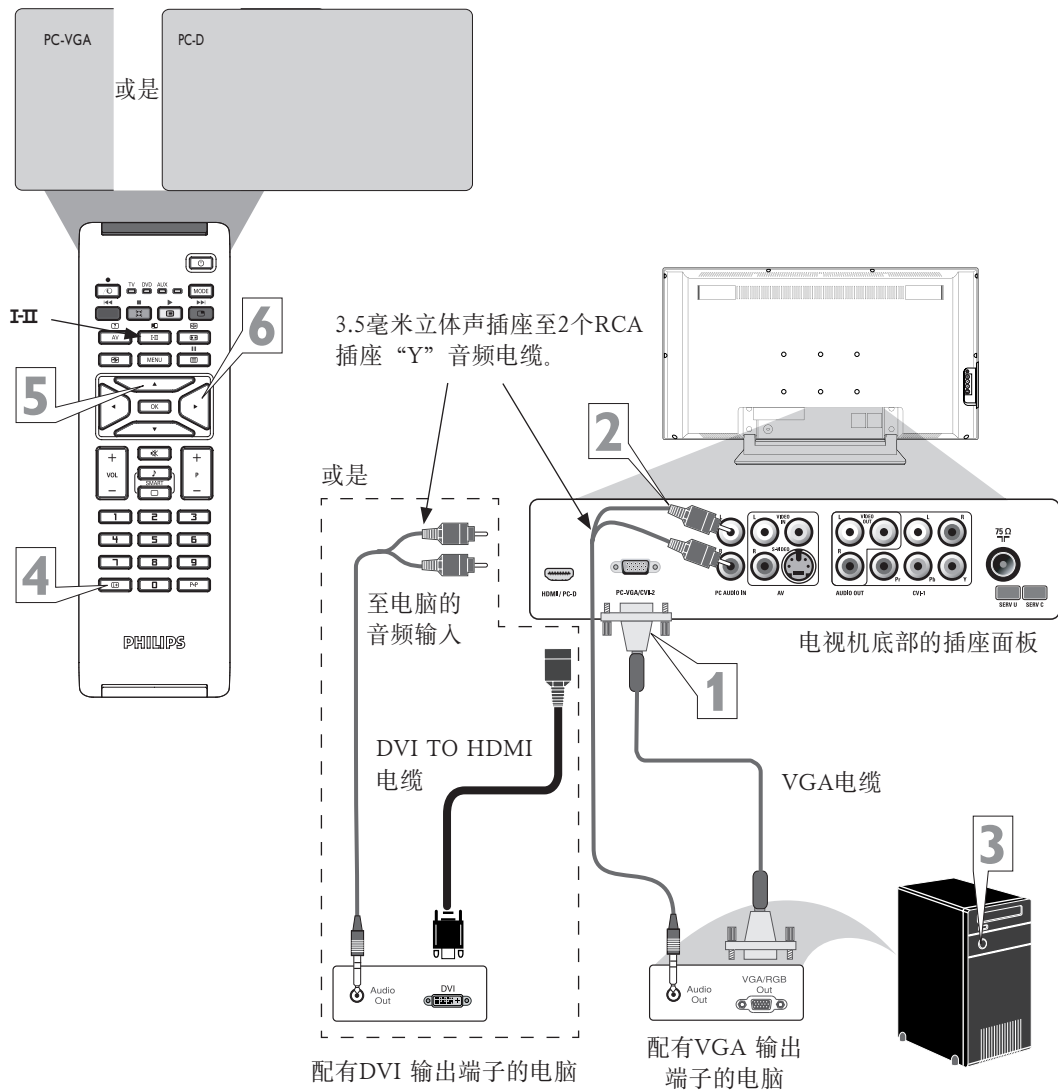

AV输出

电视机底部的音频/视频输出插座可用来连接外部附件设备如外部音频系统，录像机或是另一电视机。

外部音频系统连接：

- 使用RCA型号的左右音频电缆，将其两端分别连接到外部音频系统的左右音频输入（或是AUX）左与右插座（红色与白色）与电视机底部的音频输出左与右插座中。
- 开启外部音频系统与电视。电视声音会通过音频系统被接收到。

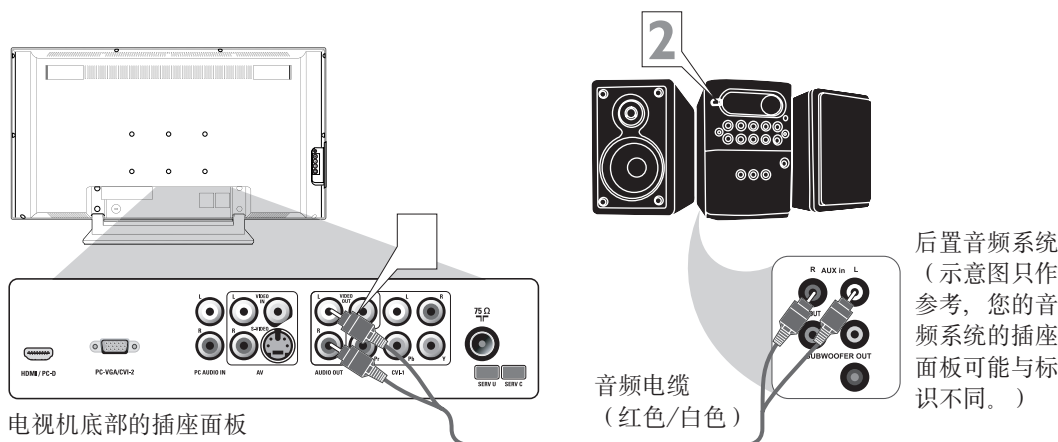

后置/SVHS输入

如同AV插座一样，后置/SVHS插座允许连接附加的附件设备如照相机或是游戏机。后置/SVHS输入插座位于电视机后面。

- 将视频（黄色）适配器电缆连接到电视机左后方的视频AV3输入插座中。将视频（黄色）电缆的另一端连接到RCA型号的视频电缆。将该电缆连接到正在使用的附件设备后面的视频输出插座。注意：如果您的设备配有S-Video输出端子，S-视频电缆可取代黄色视频电缆使用。S-视频端子能提供更好的视频回放。
- 将音频（红色与白色）适配器电缆连接到某一RCA型号的音频电缆。将音频（红色与白色）适配器电缆的另一端连接到正在使用的附件设备的后面。
- 开启附件设备与电视机。
- 按遥控器上的AV键在屏幕上显示信源列单菜单。
- 连续按 **√** 键直到后置/SVHS高显亮，在按 **>** 键进入被选择的模式。
- 开启附件设备，按播放键启动电视机上的回放。

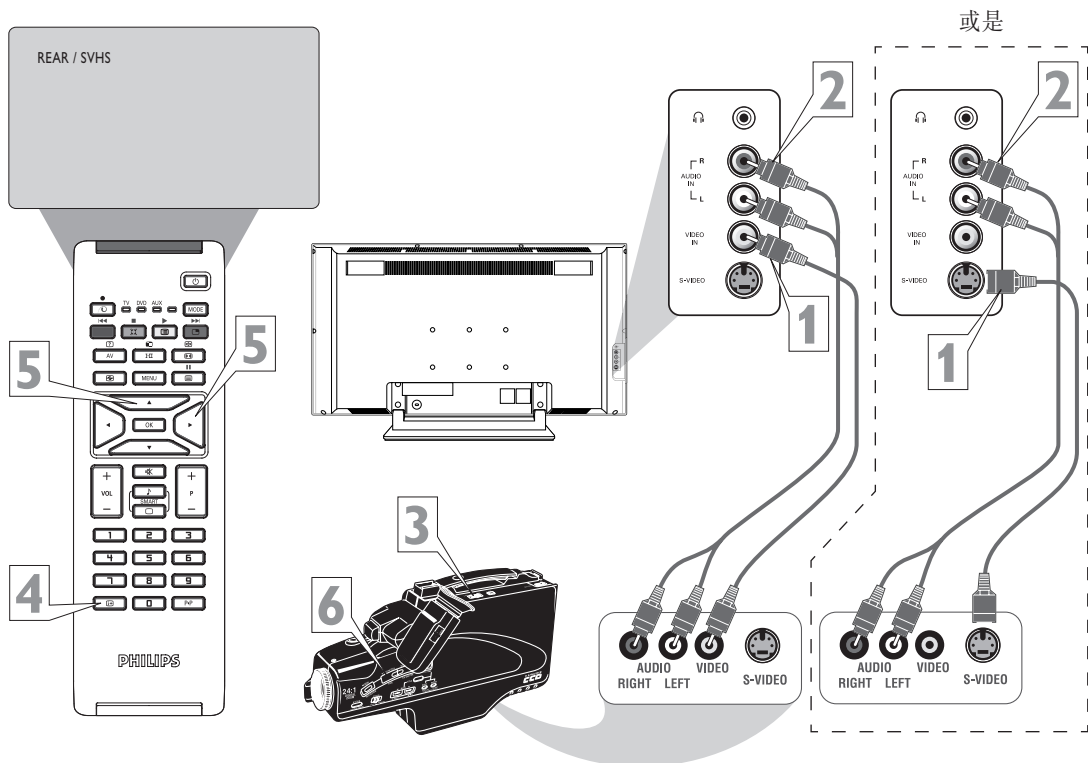

耳机连接

使用耳机插座连接耳机。如果已连接到某一音频系统或是耳机，电视机扬声器将无声音。声音会从音频系统或是耳机中接收。

- 把电视机后面的耳机输出端子连接到您的声音系统。
- 开启电视与耳机。电视机声音可通过音频系统进行接收。

