

Register your products and get support at
www.philips.com/welcome

4001 Series

Quick start guide

PHILIPS



Before using your product, read all accompanying safety information.
(The relevant parameters of instructions are variable, without prior notice, if there is any discrepancy, please in accordance with actual object.)



What's in the box

32" / 43" / 49"

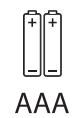
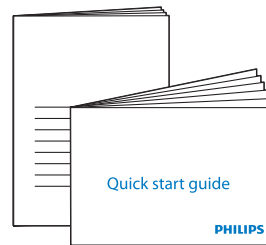
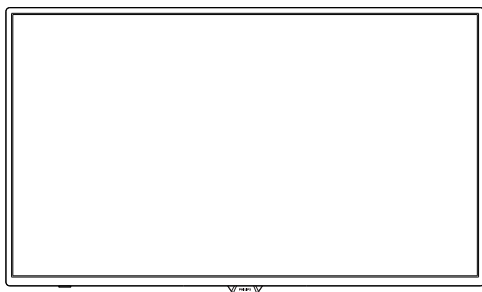

AAA

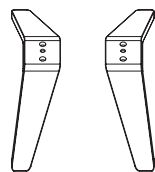

(4 pcs)





Mount the stand

32" / 43" / 49"

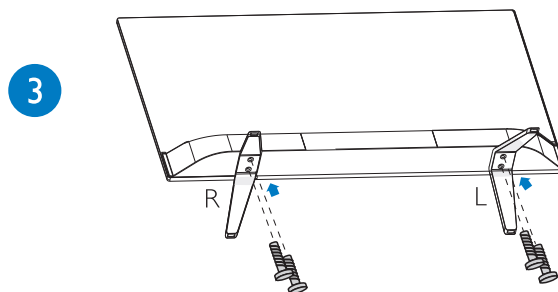
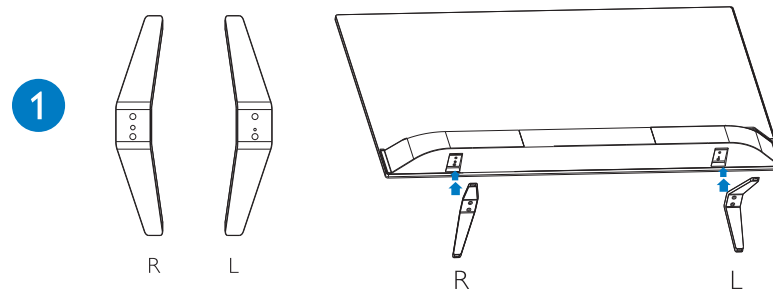

2

Connect

32"

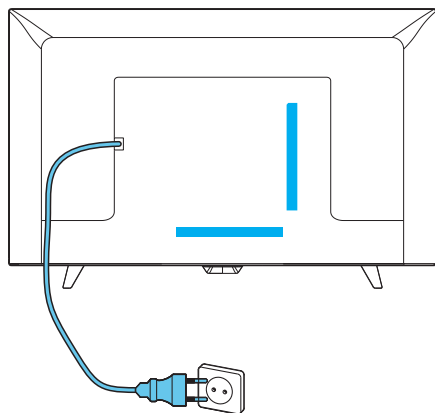

43" / 49"

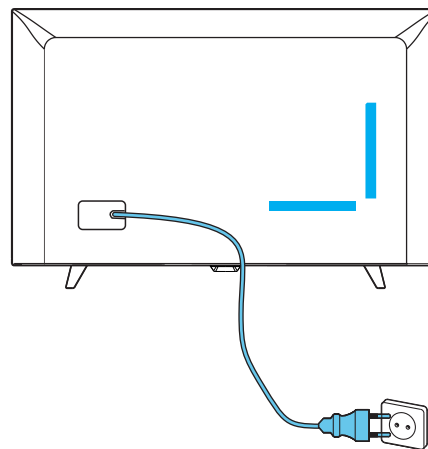

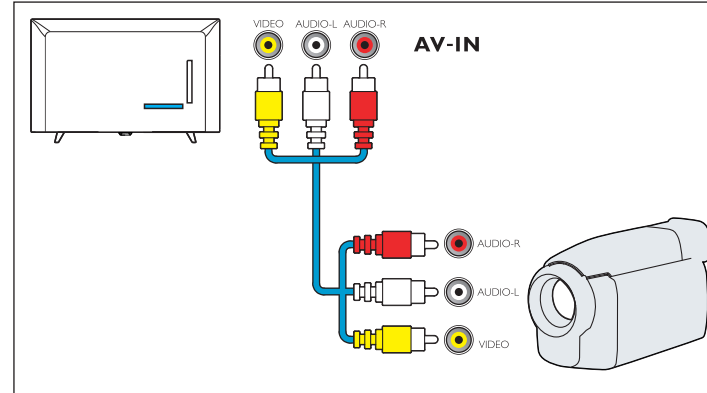
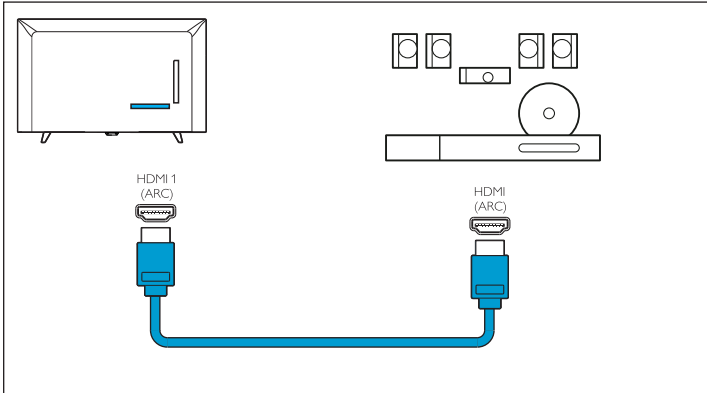
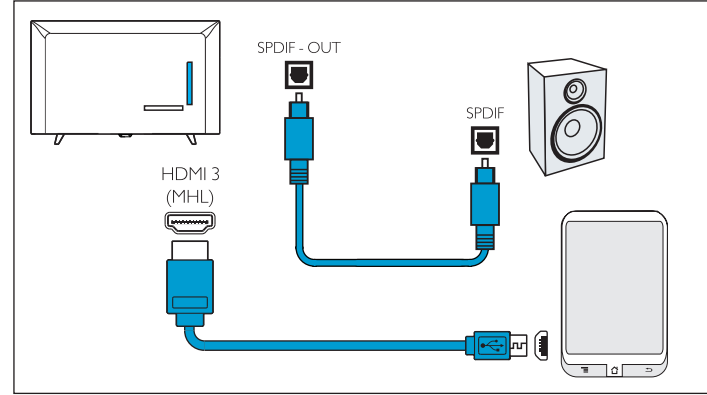
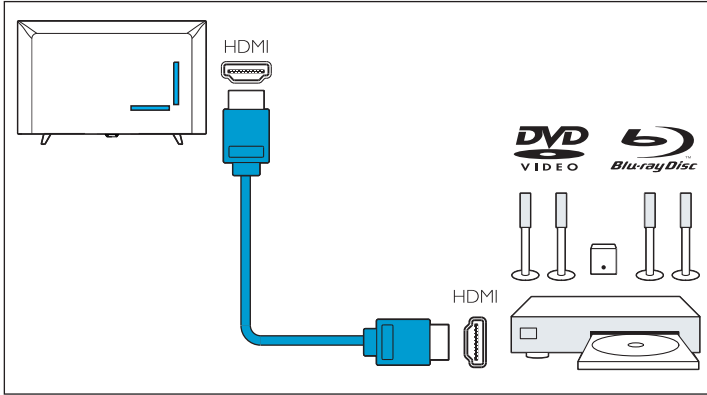

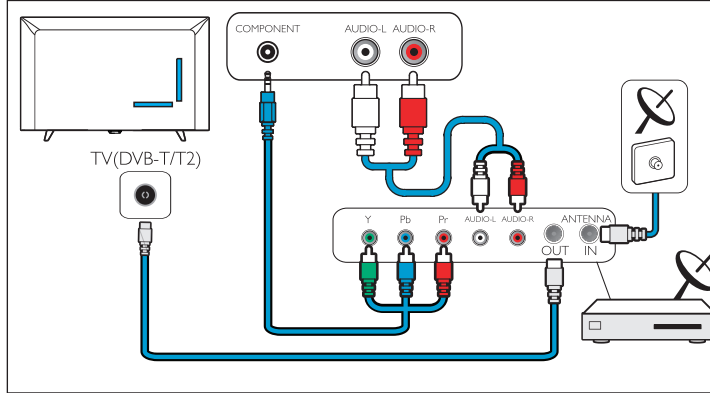
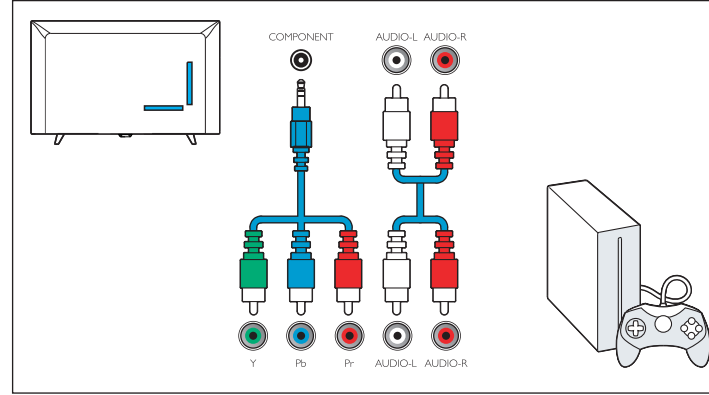
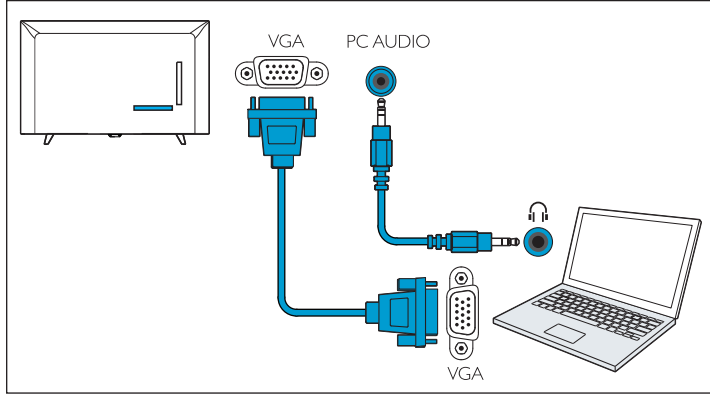

3

Insert batteries

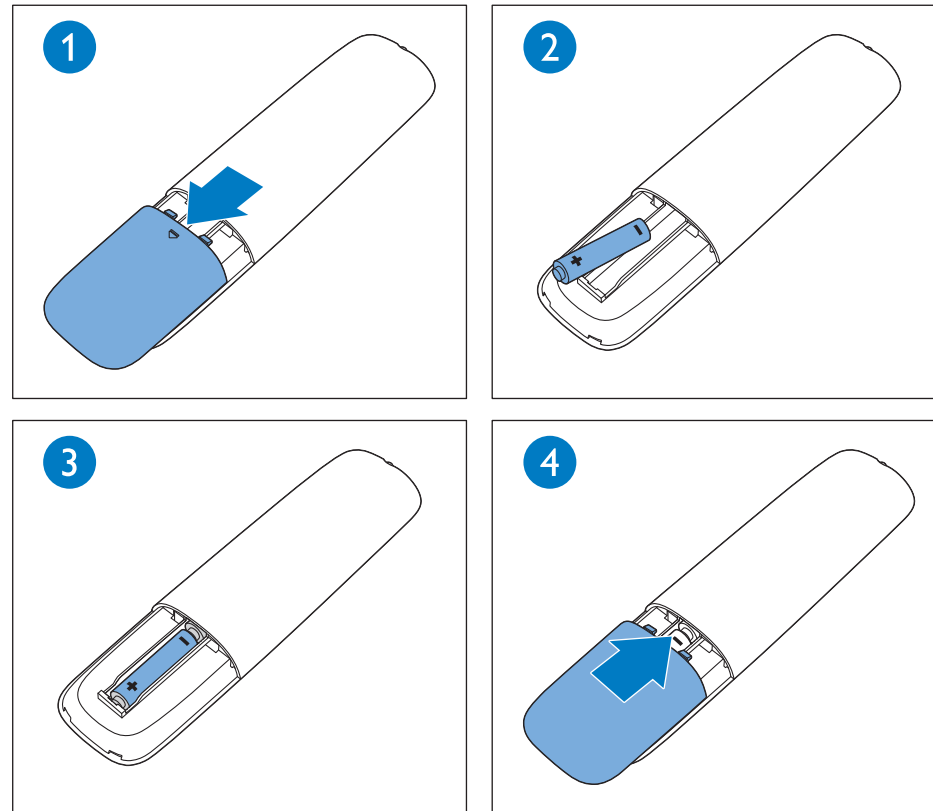



To wall mount, purchase a suitable bracket.

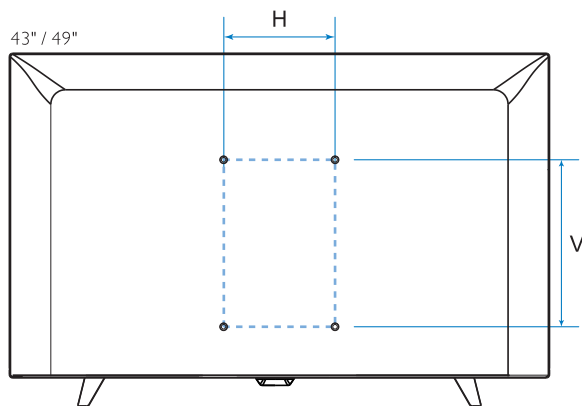
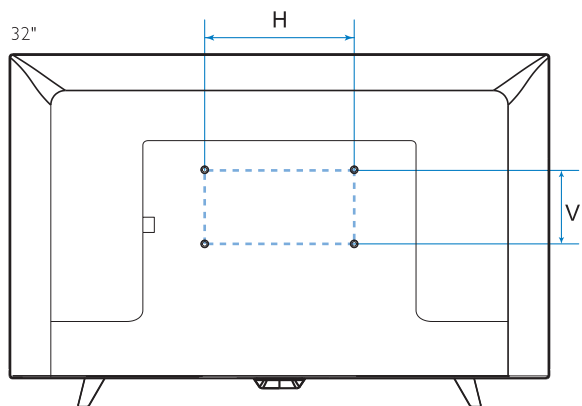

a: Depth of the top VESA screw hole

b: Depth of the bottom VESA screw hole

Note: The screw length depends on wall bracket.

TV	H	V	a-b
80 cm / 32"	200 mm	100 mm	0 mm
108 cm / 43"	200 mm	300 mm	15 mm
123 cm / 49"	200 mm	300 mm	15 mm

4

32"

Please insert the TV power cord into a power outlet. Press the  key on the side panel of the TV or on the remote control to turn on the TV.

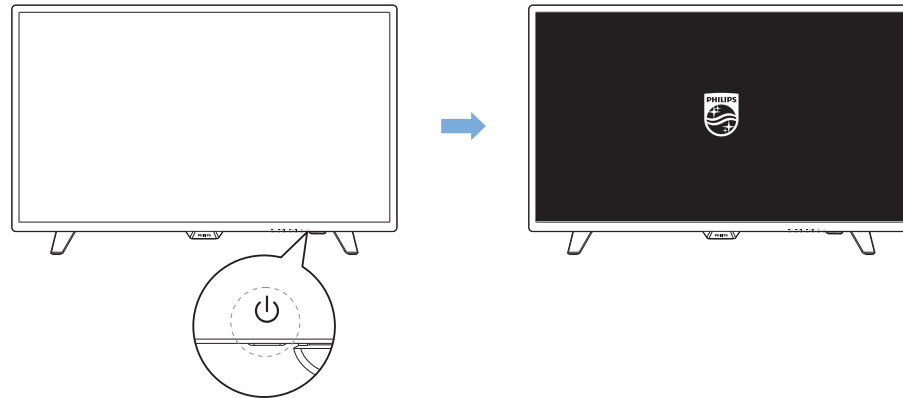

43" / 49"

If the indicator is off, please insert the TV power cord into a power outlet. Press the power switch to turn on the TV as shown in the figure. When the indicator is on, press the  key on the side panel of the TV or on the remote control to turn on the TV.

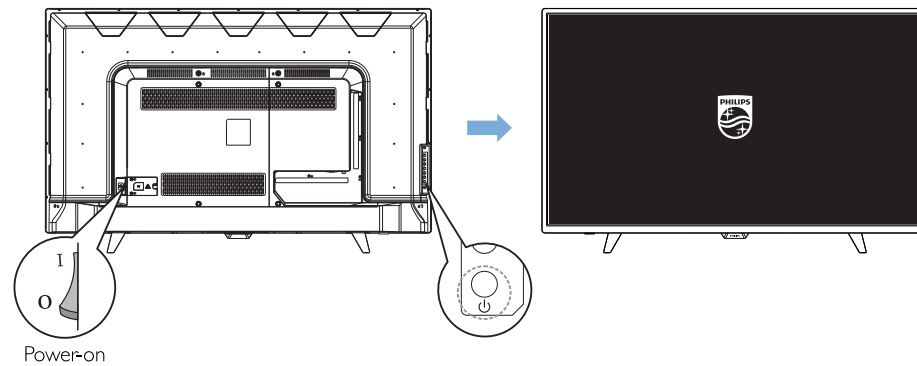



Please refer to the User's Manual and the Philips support website for more operating instructions.





All registered and unregistered trademarks are the property of their respective owners. Specifications are subject to change without notice.

Philips and the Philips' shield emblem are registered trademarks of Koninklijke Philips N.V. and are used under license from Koninklijke Philips N.V.

2016© TPVision Netherlands B.V. All rights reserved.

