



Philips
Professional TV

65" MediaSuite
powered by Android™



65HFL6014U

One step ahead

With Chromecast built-in

With this powerful Philips Professional TV, vibrant picture quality is only the beginning. Chromecast built-in and easy access to the Google Play Store give you the edge when it comes to engaging guests.

Cost-effective. With multilingual support.

- 3 years warranty, extendable to 5 years
- Low operational cost & power consumption.

Rapid installation. Total control.

- Analytics on-board. Get stats on what's being watched
- AppControl. Install and manage apps remotely and securely
- CMND & Check-in. Personalize every experience
- CMND & Control. Operate, update, maintain
- Instant Initial Cloning. Rapidly install your Pro TVs

Android-powered. Ready for anything.

- Android updates. Always the latest functionality
- Be seen. Brand the TV's UI with your logo
- Chromecast built-in . Cast content to the big screen
- Google Play Store. Find it. Watch it. Play it
- 4K UHD TV. Beautifully clear, high-contrast image

PHILIPS

Highlights

Powered by Android

Android-powered Philips Professional TVs are fast, versatile, and easy to navigate. The TVs are optimized for native Android apps, and you can install web apps directly to the display too. Automatic updates ensure apps stay up to date.

Chromecast built-in

Enable hassle-free wireless casting of movies, presentations, and more from smart devices (mobiles, laptops, tablets) to your Android-powered Philips Professional TV. Chromecast is cost-effective, requires no extra hardware, and is secure for professional use. Users simply tap the Chromecast icon on their smart device to start streaming content from thousands of cast-enabled apps-their smart device becomes the remote.

Google Play Store

With one-touch access to the Google Play Store it's easy to add apps, games, music, movies, and more to your Philips Professional TV.

UI branding

Your Philips Professional TV offers a clear, easy-to-navigate user interface (UI), which you

can customize with your own branding. Easily add your logo and colors to the search bar to increase the visibility of your brand.

Analytics

From hotel chain to sports bar, monitor how your Android-powered Philips Professional TV is used. Find out how often specific channels are watched. Test the effectiveness of your advertising. Get the information you need to manage costs effectively, with easy access to screen-time data.

AppControl

Take full, centralized control of the apps installed on your Philips Professional TVs. AppControl lets you install, delete, and manage apps on selected TVs or your entire network. Giving you the ability to offer personalized experiences to your guests and customers-no matter how many TVs you are managing.

CMND & Control

Run your display network over a local (LAN or RF) connection. CMND & Control allows you to perform vital functions like controlling inputs, updating software, and monitoring display status. Whether you're in charge of one TV or more.

CMND & Check-in

Make visitors feel welcome. CMND & Check-in lets you use individual information-such as name and language spoken-to create a personalized experience. Whether you're adding special touches for hotel guests, streamlining the billing process, or offering multiple channel packages.

3 years warranty

3 years warranty, extendable to 5 years

4K UHD TV

4K UHD TV. Beautifully clear, high-contrast image

Instant Initial Cloning

Instant Initial Cloning. Rapidly install your Pro TVs

Low operational cost

Low operational cost & power consumption.

Install your own UI

IPTV. Provide channels over IP. Install your own UI

Specifications

Picture/Display

- Diagonal screen size (inch): 65 inch
- Diagonal screen size (metric): 164 cm
- Display: 4K Ultra HD LED
- Panel resolution: 3840x2160p
- Brightness: 370 cd/m²
- Viewing angle: 178° (H) / 178° (V)

Supported Display Resolution

- Tuner: Others: up to 1920x1080p@60Hz, T2 HEVC: up to 3840x2160@60Hz
- USB, LAN: HEVC: up to 3840x2160@60Hz, Others: up to 1920x1080p@60Hz
- HDMI 1/2: Up to 3840x2160p @60Hz
- HDMI 3: Up to 3840x2160p @30Hz

Tuner/Reception/Transmission

- Digital TV: DVB-T/T2/C, HEVC UHD (up to 2160p60)
- Analog TV: PAL
- IP Playback: Multicast, Unicast, OTT App Channels

Android TV

- OS: Android™ 7.0 (Nougat)
- Memory size(Flash): 16GB*

Features

- Ease of use: Picture Style, Sound Style
- Digital services: 8d EPG, Now&Next, MHEG, Teletext, HbbTV, Subtitles
- Local control: Joystick

Hospitality Features

- Hotel mode: Joystick Control Lock, Menu lock, Installation Menu Lock, Volume limitation
- Prison mode: high security mode, TXT/MHEG/USB/EPG/Subtitle Lock
- Timer: Sleep Timer, Wake Up Alarm, Wake Up On Channel, Wake up Sounds
- Switch On control: Channel, Feature, Picture Format, Volume, Picture Style
- Power control: Quick Start Mode, Auto Power ON, WoLAN, WoWLAN
- Apps: Google Play Store, Cloud-based Apps, AppControl
- Your brand: Customizable Home Screen, Customizable Welcome App, Location Name (Geonames ID), CMND&Create, Custom Dashboard (HTML&APK)

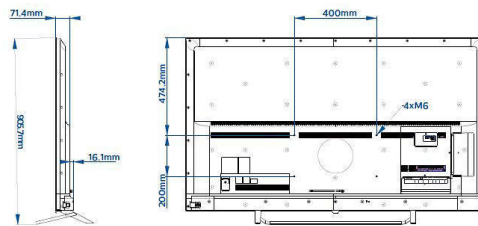
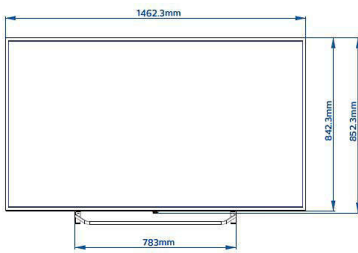

Specifications

- Clock: Clock in Standby Mode, On-screen Clock, Optional External Clock
- Cloning and Firmware update: Instant Initial Cloning, Via USB/RF/IP
- CMND&Control: Off-Line Channel Editor, Off-Line Settings Editor, Remote Management over IP/RF, CMND&Create, TV Group management
- Control: JEDI Native Android TV Control, JSON API for TV Control-JAPIT, Serial Xpress Protocol
- Integrated services: 5 Day Weather Forecast
- Interactive DRM: VSecure, Playready Smoothstreaming, Securemedia
- Revenue generation: MyChoice
- Languages: Guest language control
- Remote Control: Low Battery Detection, RC Battery Door Lock, Glow-in-the-Dark Clock button
- Channels: Combined List, Themed lists
- CMND&Check-In: Guest Name, Guest Language, Messages, Bill on TV, Express Checkout
- Sharing: Chromecast Ultra built-in, Secure Sharing, Network-managed Sharing

Healthcare features

- Control: Multi-Remote Control, Healthcare RC compatible, Nurse call system compatible
- Convenience: Headphone out, Independent main speaker mute
- Safety: Double isolation class II, Flame retardant

Multimedia

- Video playback supported: Formats: H.264/MPEG4 AVC, MPEG1, MPEG2, MPEG4, WMV9/VC1, HEVC, Containers: AVI, MKV, VP9
- Music formats supported: MP3, AAC, WAV, WMA (v2 up to v9.2), WMA-PRO (v9 and v10)
- Subtitle formats supported: SRT, SMI, TXT
- Picture formats supported: JPG, PNG, BMP, GIF

Audio

- Sound output Power: 20 (2x10) W
- Bathroom speaker out: 1.5W Mono 8Ohm
- Speakers: 2.0, Down Firing
- Sound Features: DTS-HD, Dolby Atmos Compatible, Dolby MS12D, AC-4, DTS Studio Sound

Power

- Mains power: AC 220-240V; 50-60Hz
- Ambient temperature: 0 °C to 40 °C
- Standby power consumption: $0.3W$
- Energy Label Class: G
- Eu Energy Label power: 105 W
- Power Saving Features: Eco mode
- EPREL registration number: 421974

Accessories

- Included: Remote Control 22AV1905A/12, 2x AAA batteries, Power Cord, Warranty Leaflet, Legal and Safety brochure, Edge Stand
- Optional: Remote Control 22AV1904A/12, Easy RC 22AV1601B/12, Healthcare RC 22AV1604B/12, External Clock 22AV1860A/12, DOCSIS Cable Modem 22AV1970A, Setup RC 22AV9574A/12

Wireless Connectivity

- Wireless LAN: 802.11 ac, Wifi-Direct

Connectivity Bottom

- Antenna: IEC-75
- Digital Audio out: Optical
- Ethernet (LAN): RJ-45
- VGA input: 15 pin D-sub, Audio in
- HDMI3: HDMI 2.0 with HDCP 2.2
- USB3: USB 2.0

Connectivity Side

- USB2: USB 3.0
- Common Interface Slot: CI+ 1.3.2
- HDMI1: HDMI 2.0 with HDCP 2.2
- HDMI2: HDMI 2.0 with HDCP 2.2
- Headphone out: Mini-Jack
- USB1: USB 2.0

Connectivity Rear

- Bathroom speaker out: Mini-Jack
- External power: 12V, max 1.5A
- External Control: RJ-48

Connectivity Enhancements

- RJ48: IR-In/Out, Serial Xpress interface
- EasyLink (HDMI CEC): One touch play, System Standby, RC pass through, system audio control
- LAN: Wake up on LAN
- HDMI: ARC (all ports), MHL 2.0 (HDMI1)

Design

- Colour: Silver

Dimensions

- Set Width: 1462 mm
- Set Height: 842 mm
- Set Depth: 71/87 mm
- Product weight: 24,5 kg
- Set width (with stand): 1462 mm
- Set height (with stand): 906 mm
- Set depth (with stand): 279 mm
- Product weight (+stand): 25,2 kg
- Wall mount compatible: M6, 400 x 200 mm



Issue date 2024-03-25

Version: 4.0.1

EAN: 87 18863 01851 4

© 2024 Koninklijke Philips N.V.
All Rights reserved.

Specifications are subject to change without notice.
Trademarks are the property of Koninklijke Philips N.V.
or their respective owners.

www.philips.com

- * Availability of features will depend on implementation chosen by integrator.
- * Philips does not guarantee the availability or continuity of correct functioning of apps.
- * Actual free memory may be less due to device pre-configuration
- * Typical on-mode power consumption measured according to IEC62087 Ed 2. The actual energy consumption will depend on how the television is used.
- * This television contains lead only in certain parts or components where no technology alternatives exist in accordance with existing exemption clauses under the RoHS Directive.
- * Android, Google Play and Chromecast are trademarks of Google LLC