

# PHILIPS

Professional  
Display Solutions

## Quick Start Guide

5214U series

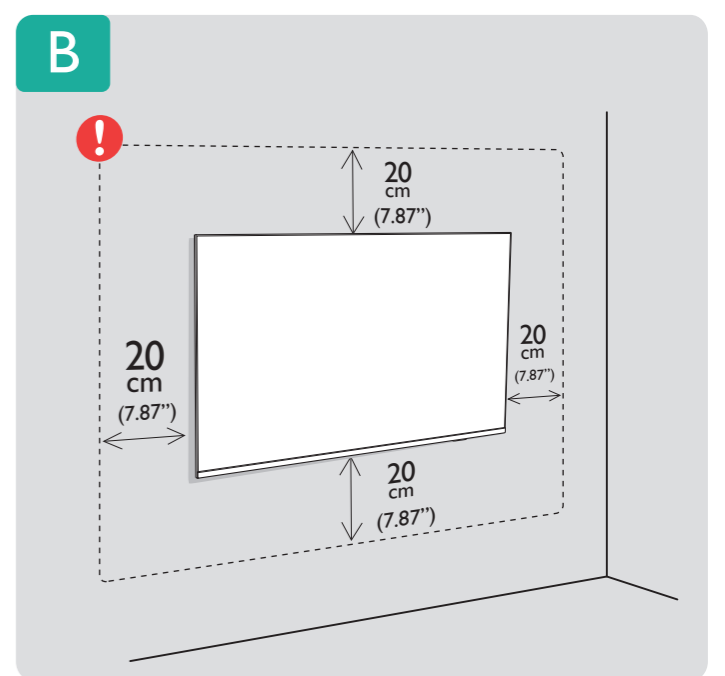
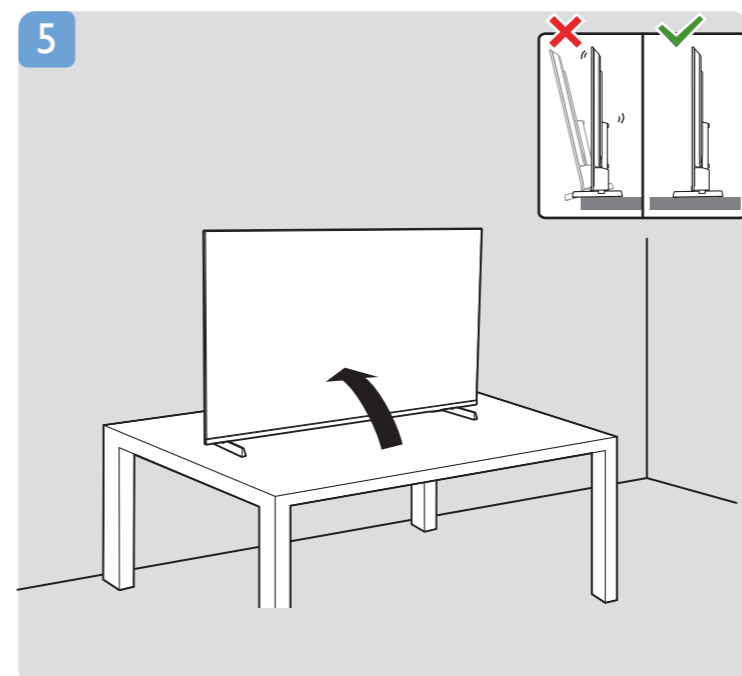
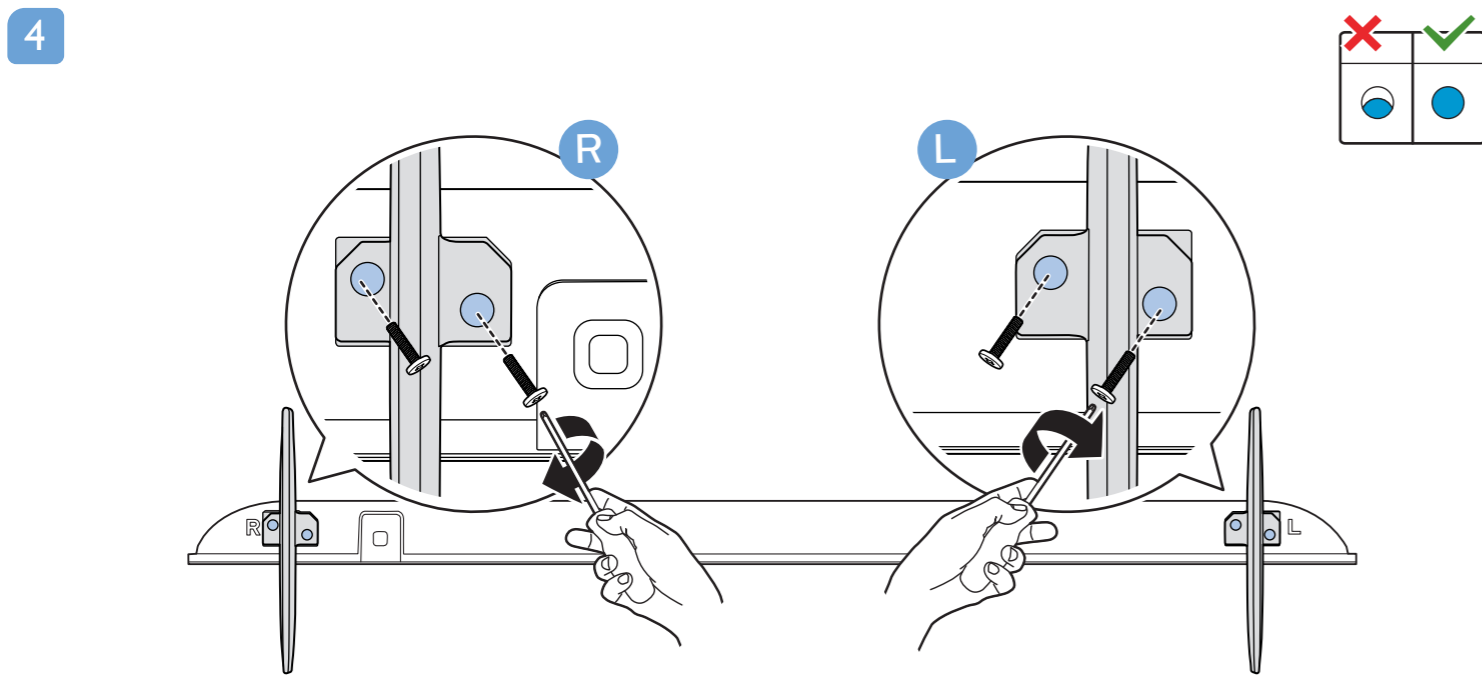
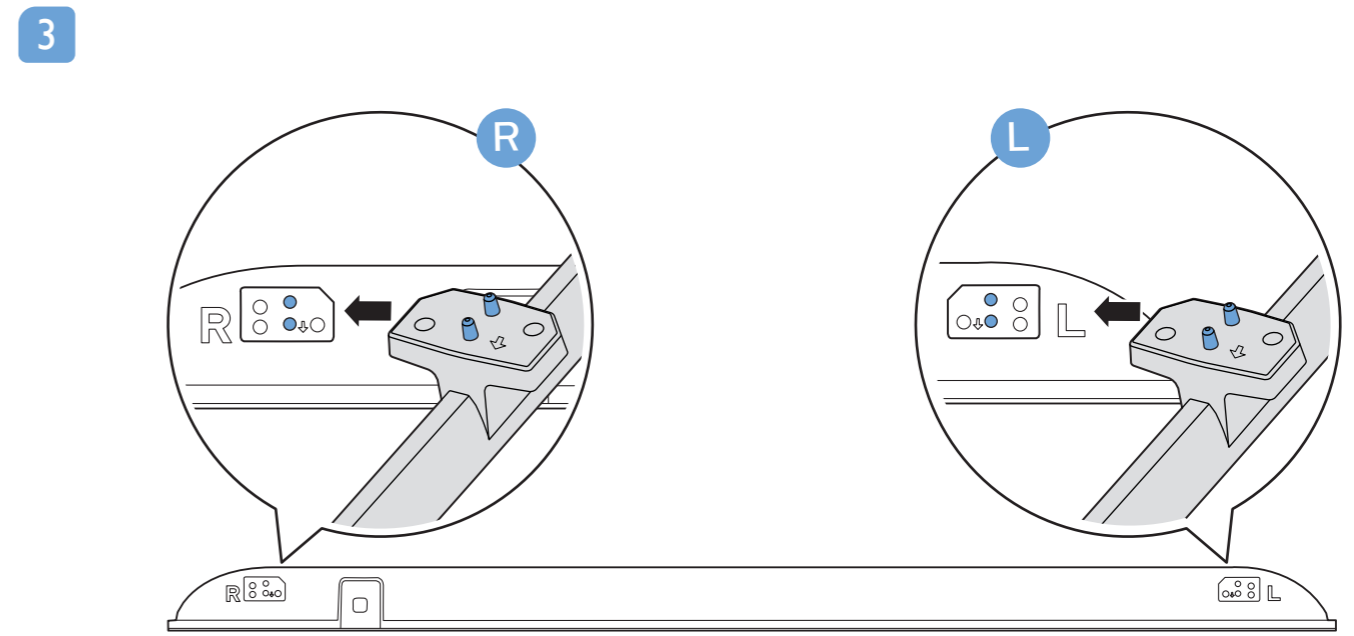
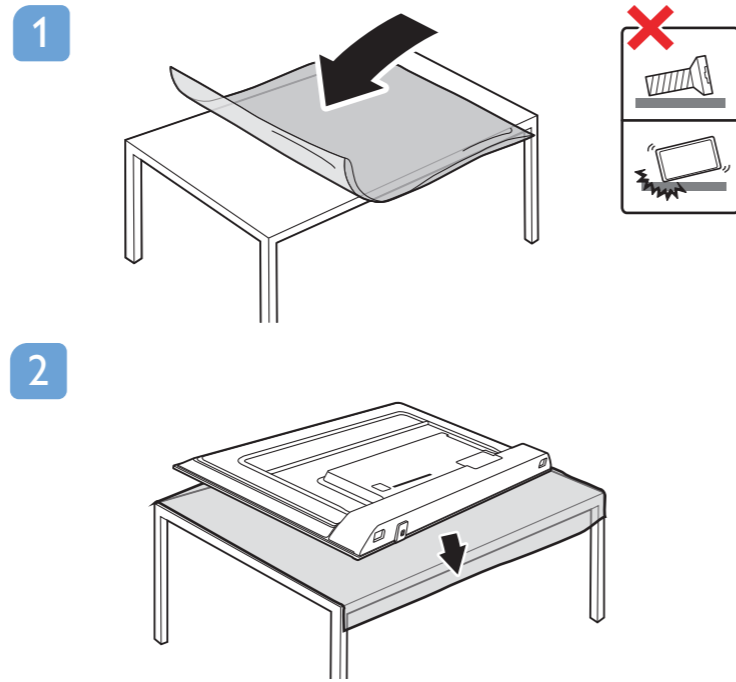
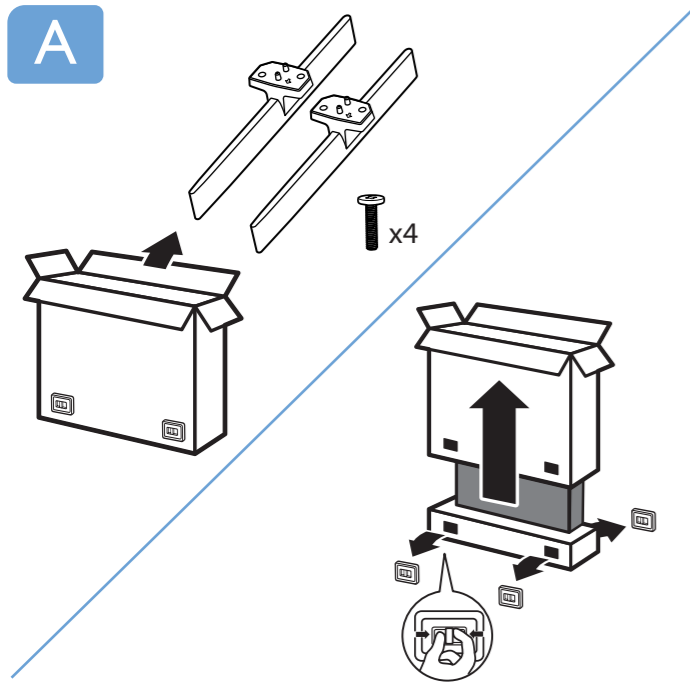
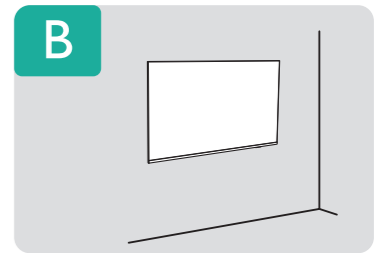
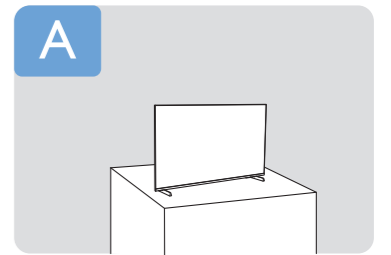
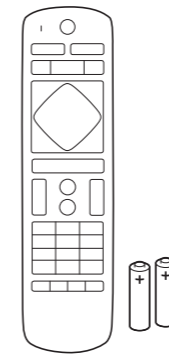
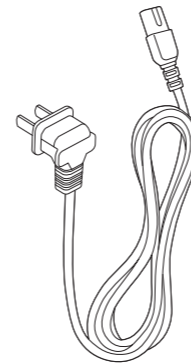
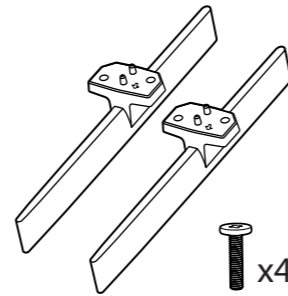
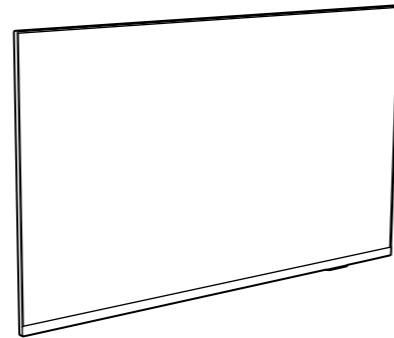



1

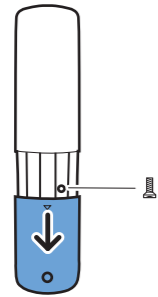

2

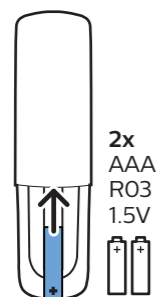

2x  
AAA  
R03  
1.5V

3

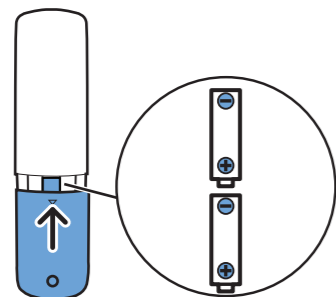

4

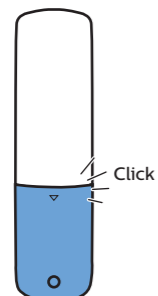

5

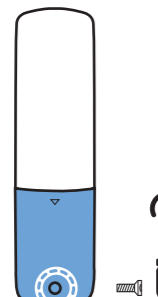

### VESA (x,y)

65" 164 cm  
300 mm x 300 mm (11.81" x 11.81") M6  
L : 18 mm ~ 22 mm (0.71" ~ 0.87")

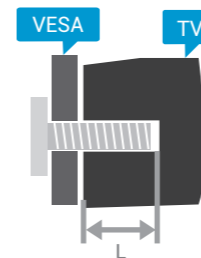
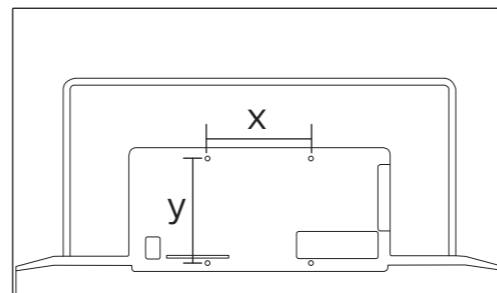

English Read the safety instructions.  
Español Lea las instrucciones de seguridad.  
Français Lisez les consignes de sécurité.

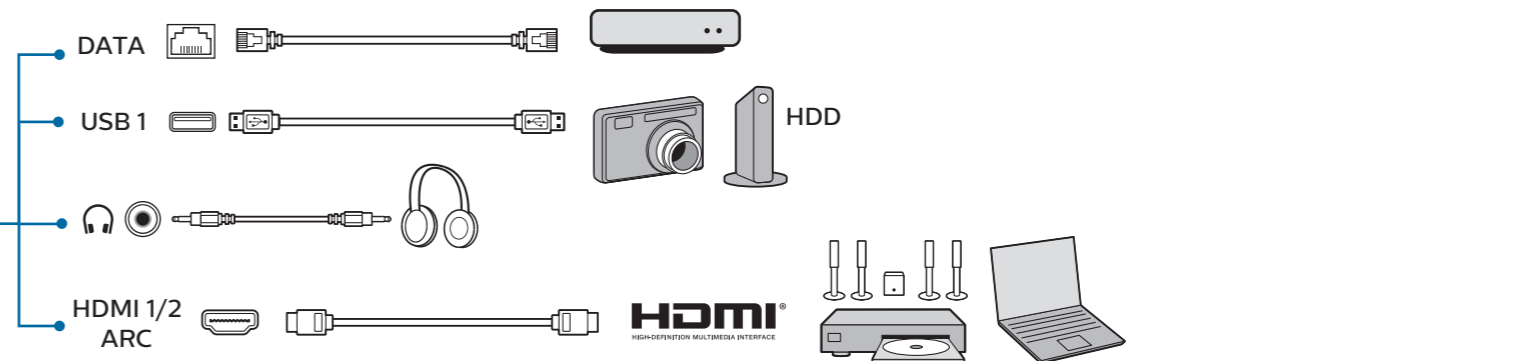
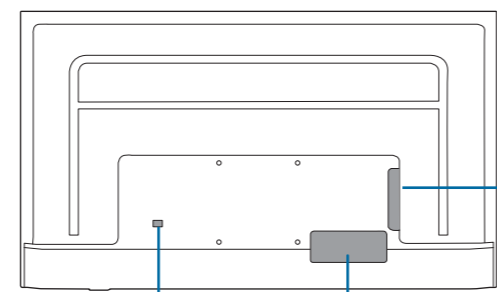
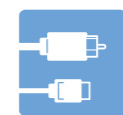

POWER

NETWORK

TV ANTENNA

12V DC OUT

DIGITAL AUDIO OUT

8 Ω AUDIO OUT

USB 2

HDMI 3/4 ARC

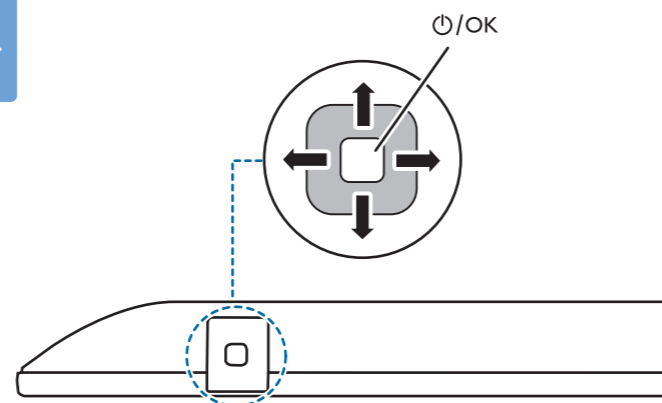
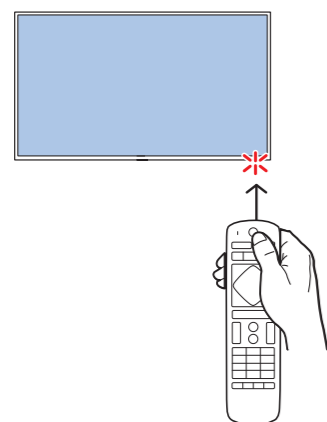
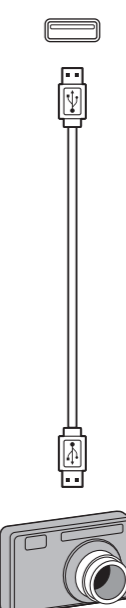
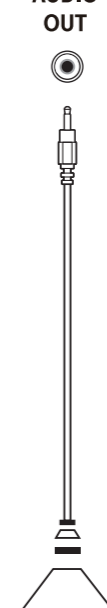
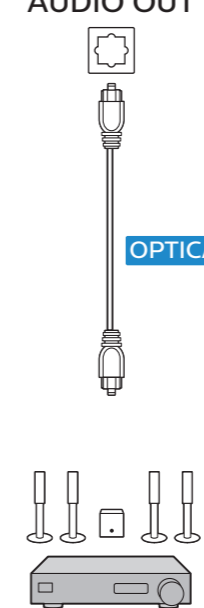
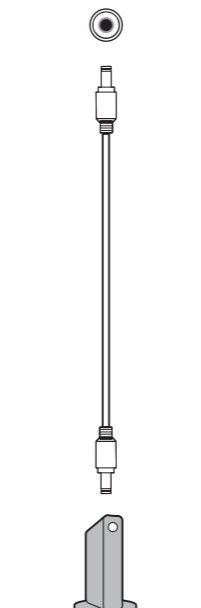
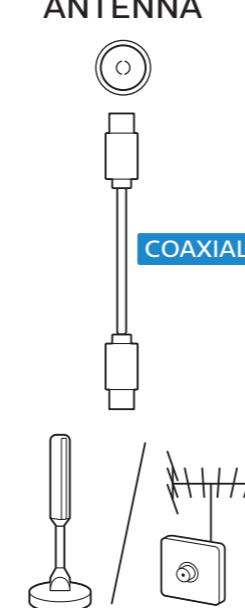
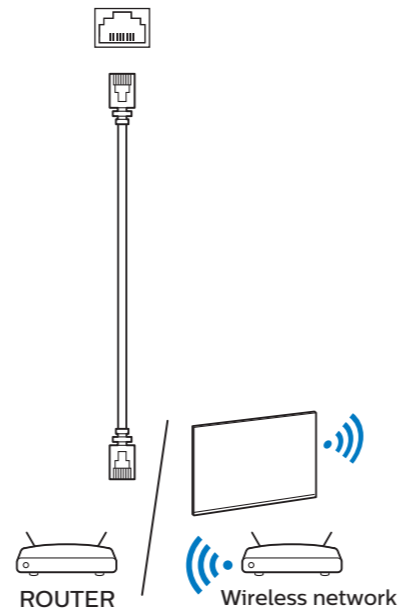
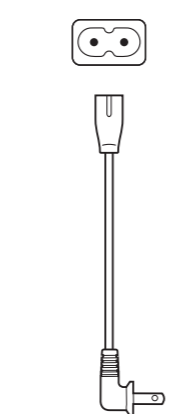

[www.philips.com/support](http://www.philips.com/support)  
5214U Series  
User Manual



Envision Peripherals Inc.  
47490 Seabridge Drive  
Fremont, CA 94538  
Tel. 510-770-9988  
© 2021 Koninklijke Philips N.V. All rights reserved.  
Philips and the Philips Shield Emblem are registered trademarks of Koninklijke Philips N.V. and are used under license from Koninklijke Philips N.V.