

Register your products and get support at
www.philips.com/welcome

32PHG5001/77
42PFG5011/77

Quick start guide

PHILIPS



English Before using your product, read all accompanying safety information.
(The relevant parameters of instructions are variable, without prior notice, if there is any discrepancy, please in accordance with actual object.)

Español Antes de usar su producto, lea toda la información de seguridad incluida.
(Los parámetros relevantes de instrucciones están sujetos a cambio sin previo aviso, si existen discrepancias, proceda en conformidad con el objeto real).



English
Español

What's in the box
Contenido de la caja

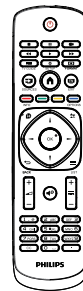
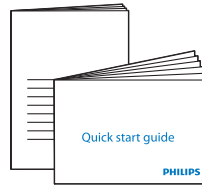
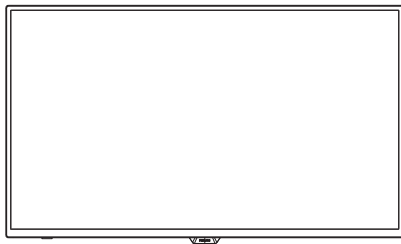

AAA

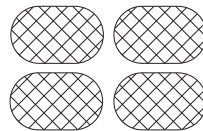
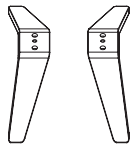

1



English
Español

Mount the stand
Monte el soporte

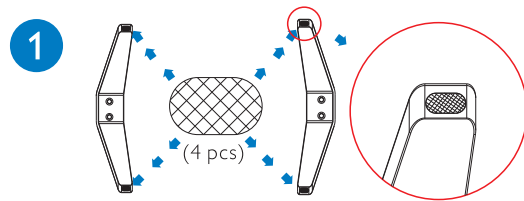

2

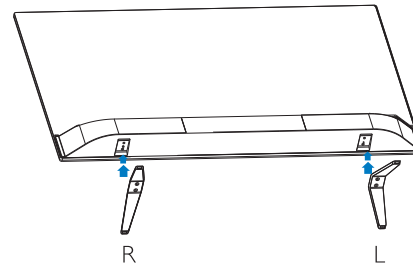

3

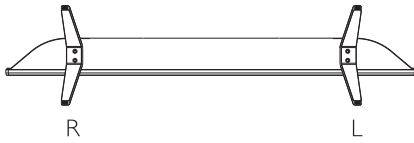

4

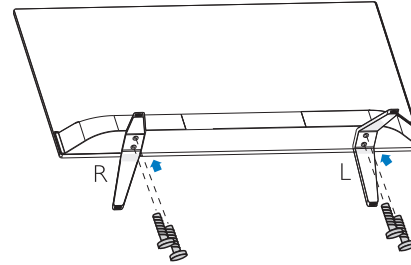

2

English Connect
Español Conexión

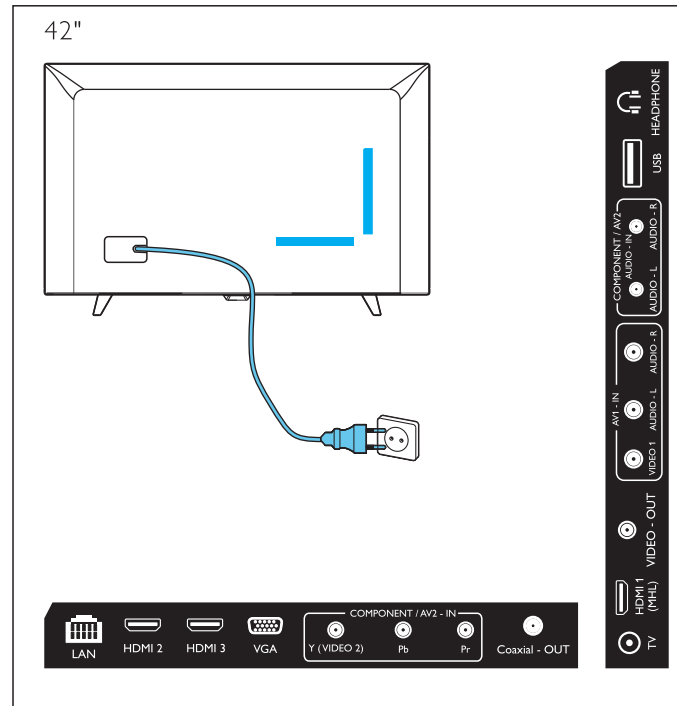
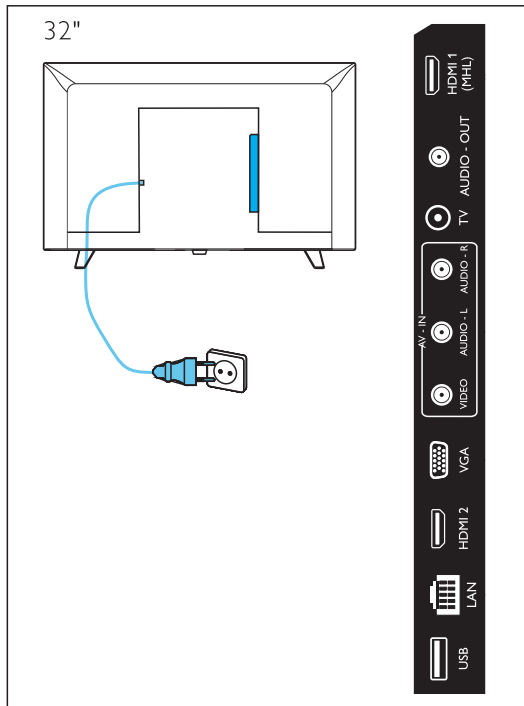

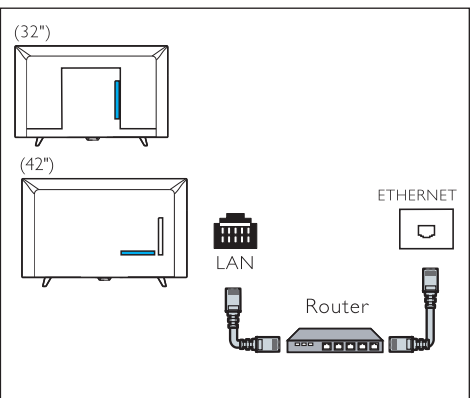
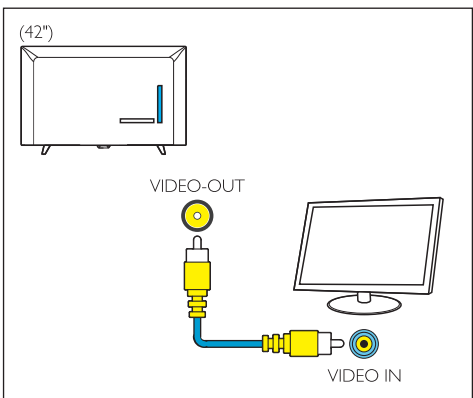
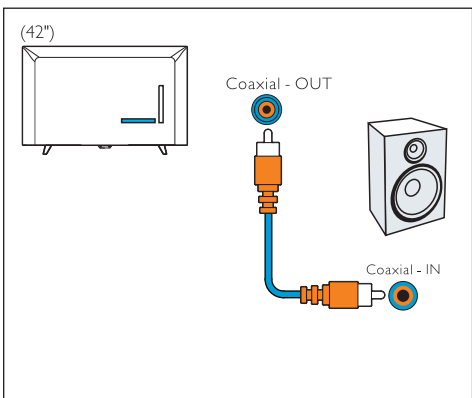
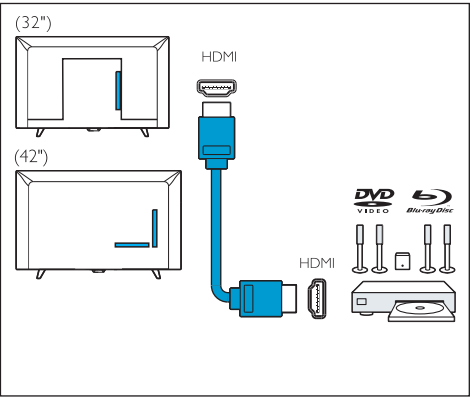
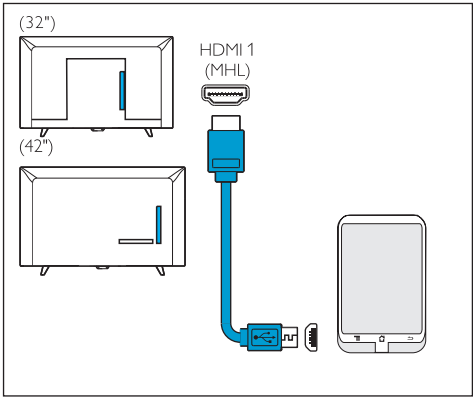
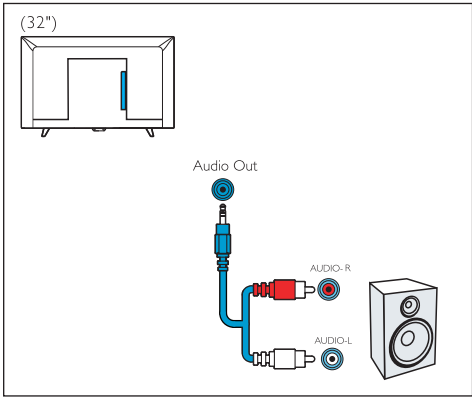

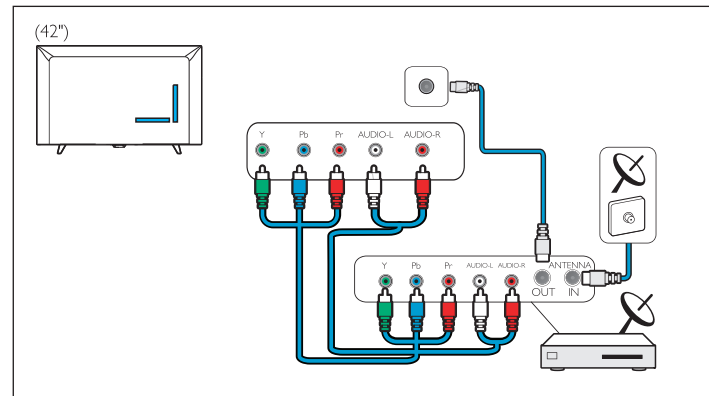
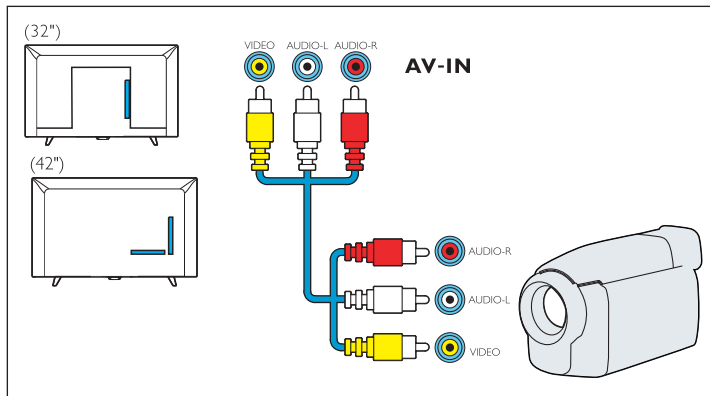
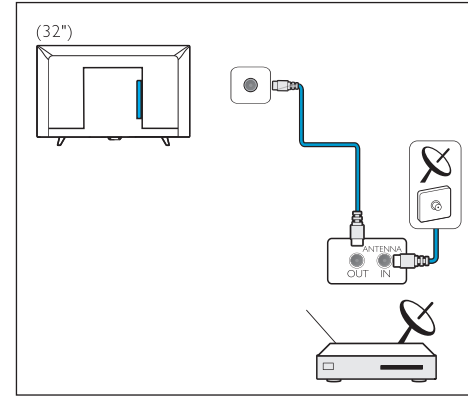
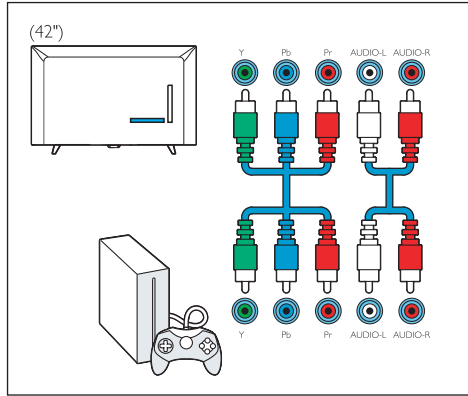
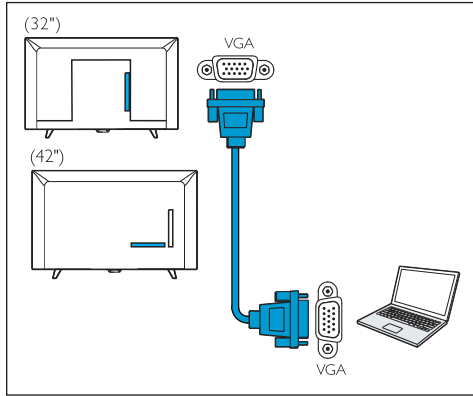

3

English Insert batteries
Español Inserte las baterías

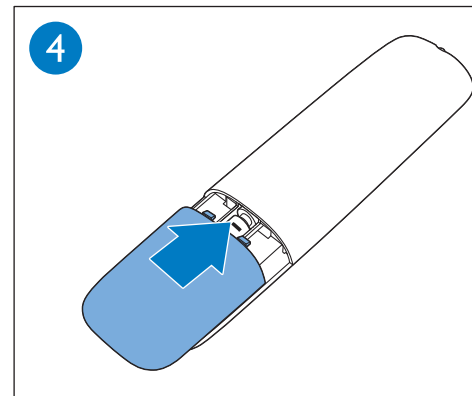
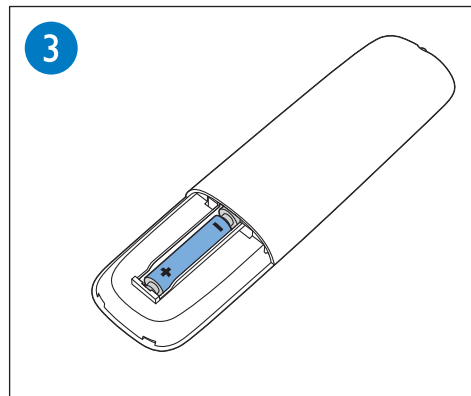
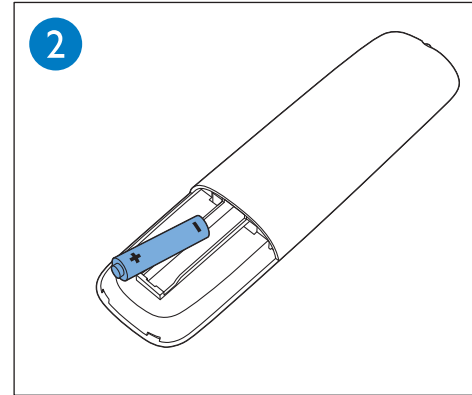
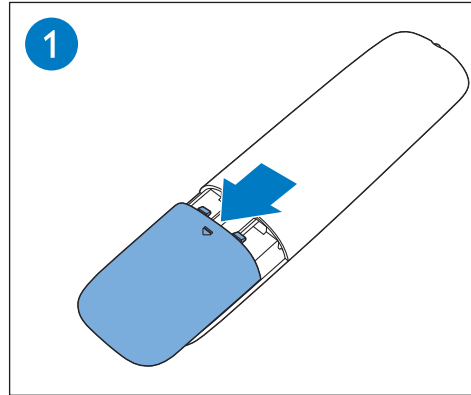





English
Español

To wall mount, purchase a suitable bracket.
Para el montaje en pared.

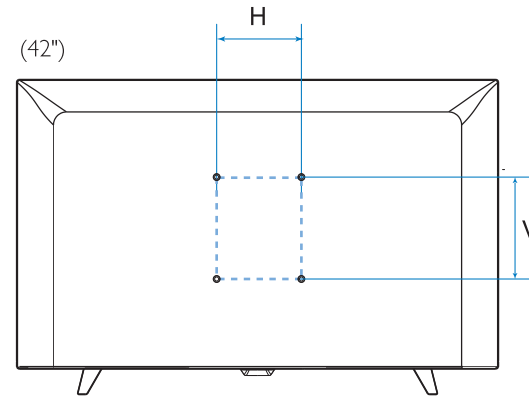
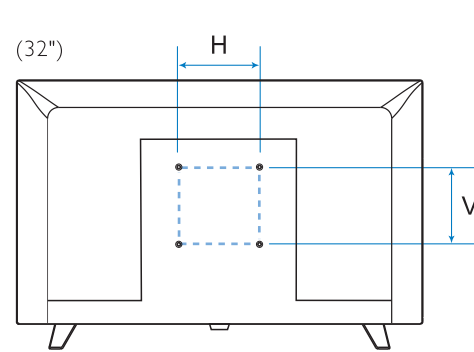
TV	H	V
80 cm / 32"	100 mm	100 mm
106 cm / 42"	200 mm	300 mm



4

English Press the  key on the side panel of the TV or on the remote control to turn on the TV.
Español Para encender el TV, presione la tecla  en el panel lateral del TV o en el control remoto.
(32")

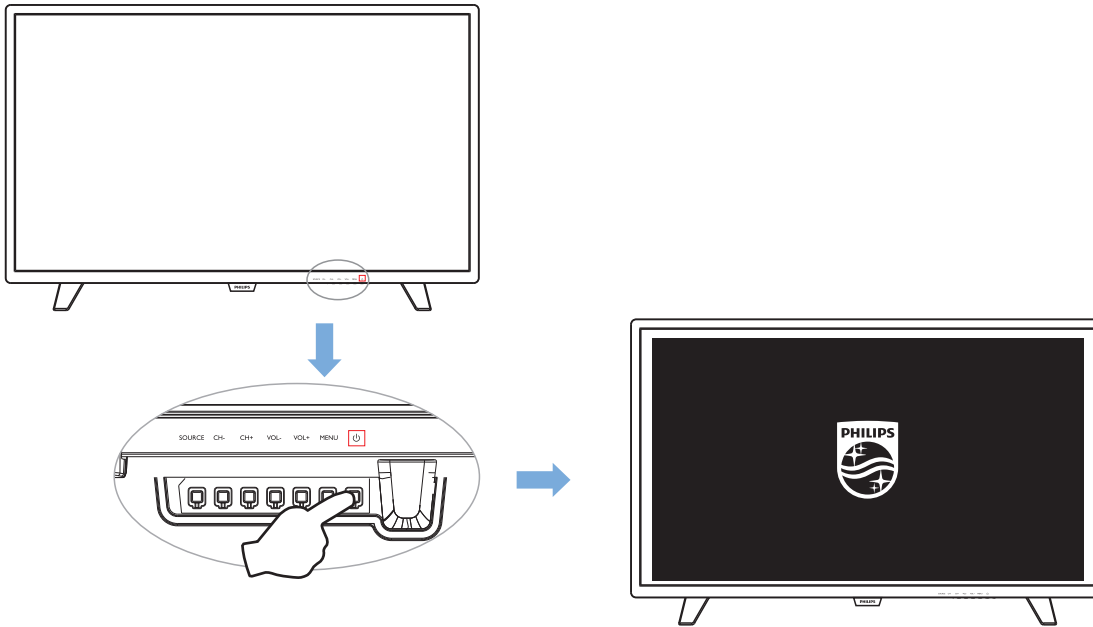

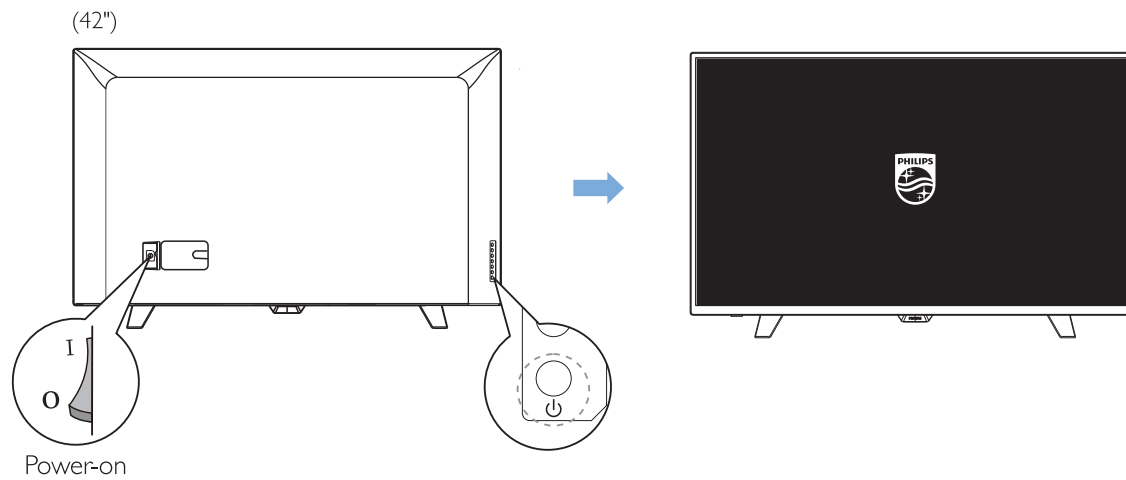

English Please refer to the User's Manual and the Philips support website for more operating instructions.
Español Consulte el Manual del usuario y el sitio web de soporte de Philips para obtener más información sobre el funcionamiento.





Todas las marcas registradas y no registradas son propiedad de sus respectivos propietarios.
Las especificaciones están sujetas a cambios sin previo aviso.
Philips y su escudo emblema de Philips son marcas registradas de Koninklijke Philips N. V. y se utilizan bajo licencia de Koninklijke Philips N.V.
2016© TP Vision Europe B. V. Todos los Derechos Reservados.

www.philips.com



310110692541

