

Philips
Professional TV

65" Studio

4K Ultra HD
DVB-T2/T/C HEVC

65HFL2879T



Delight your guests

with pure taste

Show your guests how much you care with this affordable Professional TV. You will enjoy dedicated hospitality features like a branded welcome page, installation via USB and menu and control locking.

Advanced hotel features and future proof

- USB cloning of all settings for quick installation
- One combined channel list for Analogue and Digital channels
- Advanced volume control to avoid guest disturbance
- Greet your guests with a customisable welcome page
- Installation menu locking
- Off-line channel editor to edit a channel list on a PC
- Prevent unauthorised use by local control locking

Great viewing experience and guest comfort

- USB for multimedia playback
- Low power consumption
- 4K Ultra HD: resolution like you've never seen it before

PHILIPS

Highlights

4K Ultra-HD Resolution

See TV like never before thanks to four times the resolution of a conventional Full HD TV. 3840 x 2160 pixels provide an image so refined, so lifelike, it's a window to a new world.

Welcome page



A welcome page is displayed each time the TV set is switched on. The welcome page can be branded and customised easily at the time of installation via a simple welcome image in .png format.

USB Cloning

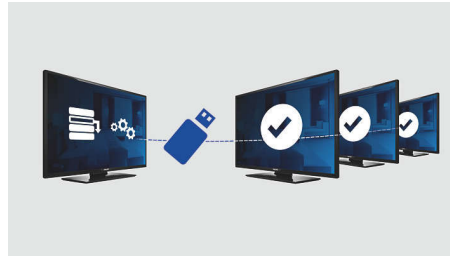

Provides the ability to easily copy all programming and channel programming settings from one TV into other TV sets in less than a minute. The feature ensures uniformity between TV sets and significantly reduces installation time and costs.

Off-line channel editor

Off-line channel editor to edit a channel list on a PC

USB (photos, music, video)



Share the fun. Connect your USB memory-stick, digital camera, mp3 player or other multimedia device to the USB port on your TV

to enjoy photos, videos and music with the easy to use onscreen content browser.

One combined channel list

One integrated channel list for digital and analogue channels. This allows the guest to flick seamlessly between Analogue and Digital channels.

Advanced volume control

With advanced volume control, you can select the start-up volume of the TV and predefine the volume range of the TV set, preventing excessive volume adjustments and avoiding the disturbance of neighbouring guests.

Local control locking

By disabling or enabling the local control locking, the administrator can prevent unauthorised use of the TV via the control buttons, saving the hotelier overheads.

Installation menu locking

Prevents unauthorised access to installation and configuration settings, to ensure maximum convenience for guests and to avoid unnecessary reinstallation costs.

Low power consumption

Philips TVs are designed to minimise power consumption. This will not only reduce environmental impact but also lower operating costs.

Specifications

Picture/Display

- Aspect ratio: 16:9
- Diagonal screen size (inch): 65 inch
- Diagonal screen size (metric): 164 cm
- Display: 4K Ultra HD LED
- Panel resolution: 3840 x 2160p
- Brightness: 350 cd/m²
- Contrast ratio (typical): 4000
- Viewing angle: 178° (H)/178° (V)

Supported Display Resolution

- HDMI: Up to 3840 x 2160p@60 Hz
- Tuner: T2 HEVC: up to 3840 x 2160@60 Hz, Others: up to 1920 x 1080p@60 Hz
- USB: HEVC: up to 3840 x 2160@60 Hz, Others: up to 1920 x 1080@60 Hz

Tuner/Reception/Transmission

- Digital TV: DVB-T/T2/C, HEVC UHD (up to 2160p60)
- Analogue TV: PAL, SECAM

Features

- Ease of use: Picture Style, Sound Style
- Digital services: Subtitles, Teletext, MHEG, Now and Next, 8d EPG
- Local control: Joystick

Hospitality Features

- Hotel mode: Menu lock, Installation Menu Lock, Volume limitation (incl. HP), Joystick Control Lock
- Prison mode: high-security mode, TXT/MHEG/USB/EPG/Subtitle Lock
- Timer: Sleep Timer, Wake Up Alarm
- Switch On control: Channel/Source, Picture Style, Volume (incl. HP)
- Anti-Theft: Kensington Lock
- Power control: Green/fast start-up
- Your brand: Welcome Logo
- Cloning and Firmware update: via USB, Instant Initial Cloning
- Control: Block Automatic Channel Update
- Remote Control: Cable Strap Ready, RC Battery Door Lock
- Channels: Combined List, Off-Line Channel Editor

Healthcare features

- Control: Multi-Remote Control
- Convenience: Headphone out

Multimedia

- Video playback supported: Containers: AVI, MKV,

- Formats: H.264/MPEG4 AVC, MPEG1, MPEG2, MPEG4, HEVC, TS
- Music formats supported: MP3, AAC, WAV, WMA (v2 up to v9.2)
- Subtitle formats supported: SRT, SSA SUB, ASS, SMI, TXT
- Picture formats supported: BMP, JPG, PNG
- Supp. Video Resolution on USB: up to 1920x1080p@30Hz
- Multimedia connections: USB

Audio

- Sound output Power: 16 (2x8) W
- Speakers: 2.0, Down Firing
- Sound Features: Equalizer, Balance, AVL, Incredible surround, Dynamic Bass, Dolby MS10

Power

- Mains power: AC 220-240 V; 50-60 Hz
- Ambient temperature: 5°C to 45°C
- Standby power consumption: $\leq 0.3\text{ W}$
- Energy Label Class: A++
- EU Energy Label power: 82 W
- Power Saving Features: Eco mode
- Annual energy consumption: 119 kWh

Accessories

- Included: Remote Control 22AV1407A/12, 2 x AAA batteries, Edge Stand, Warranty Leaflet, Legal and Safety brochure
- Optional: Setup RC 22AV9573A

Side Connectivity

- Common Interface Slot: CI+ 1.3
- Headphone out: Mini-Jack
- USB1: USB 2.0
- AV input: CVBS+L/R (Cinch)

Rear Connectivity

- Scart: CVBS, RGB, SVHS
- Antenna: IEC-75
- HDMI1: ARC, HDMI 2.0 with HDCP 2.2
- Digital Audio out: Optical
- VGA input: 15 pin D-sub
- HDMI 2: HDMI 2.0 with HDCP 2.2, ARC

Connectivity Enhancements

- EasyLink (HDMI CEC): One touch play, System Standby, RC pass through

Design

- Colour: Black

Dimensions

- Set Width: 1459 mm
- Set Height: 841 mm
- Set Depth: 73.5 mm
- Product weight: 23.5 kg
- Set width (with stand): 1459 mm
- Set height (with stand): 902 mm
- Set depth (with stand): 345 mm
- Product weight (+stand): 24.1 kg
- Wall-mount compatible: M6, 400 x 400 mm

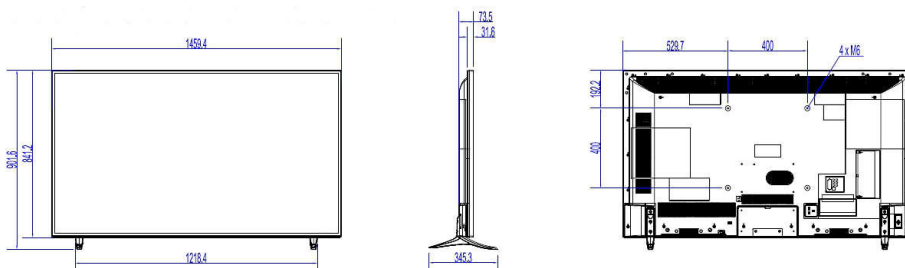

Issue date 2024-03-31

Version: 2.1.2

EAN: 87 18863 01383 0

© 2024 Koninklijke Philips N.V.
All Rights reserved.

Specifications are subject to change without notice.
Trademarks are the property of Koninklijke Philips N.V.
or their respective owners.

www.philips.com

* Availability of features will depend on implementation chosen by integrator.
* Typical on-mode power consumption measured according to IEC62087 Ed 2. The actual energy consumption will depend on how the TV is used.
* This television contains lead only in certain parts or components where no technology alternatives exist in accordance with existing exemption clauses under the RoHS Directive.