

Register your product and get support at ...  
[www.philips.com/welcome](http://www.philips.com/welcome)

AUREA

---

Powered by Ambilight

# Quick Start

**EN** Installation

---



310431574621

**PHILIPS**

# What's in the box

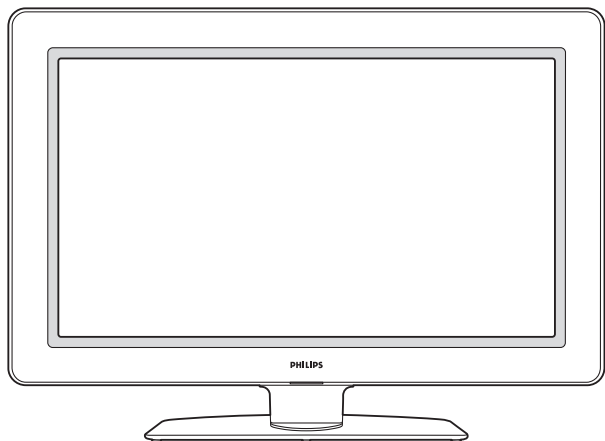

Television and stand



Remote control



Start guide

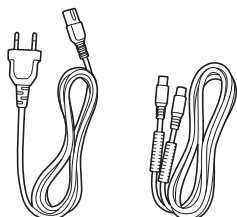

Power cord and antenna cable

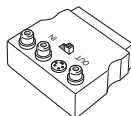

Scart - SVHS - Cinch adaptor

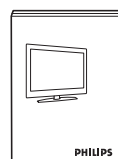

User manual

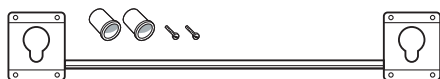

Wall mount bracket

Please find the wall mounting and / or VESA compliant mounting instructions in the User manual.

# 1 Swivel stand

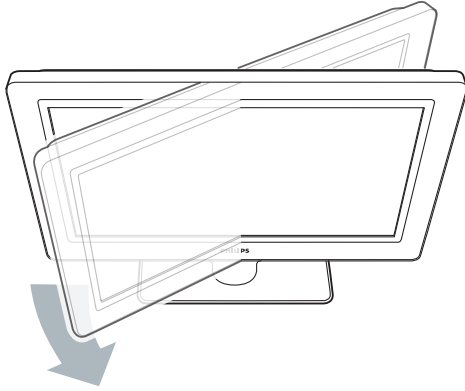

Remove the yellow brake at the back of the stand to allow the TV to swivel.

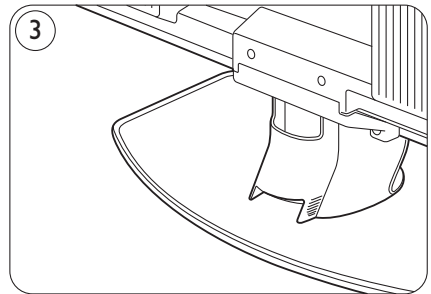
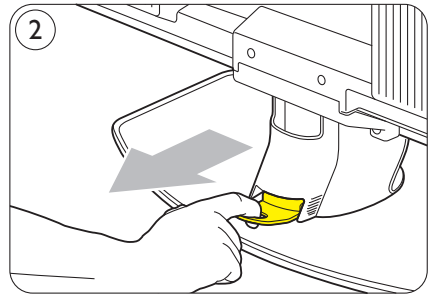
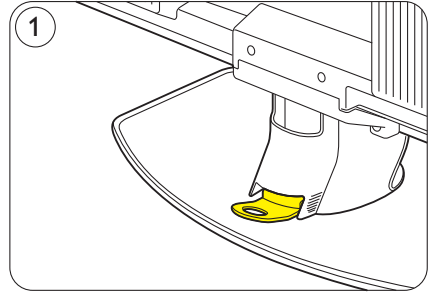

## 2 Remote control

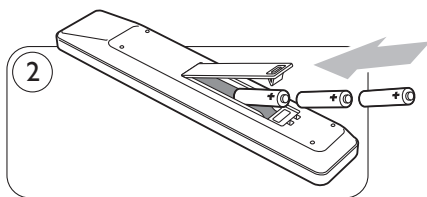
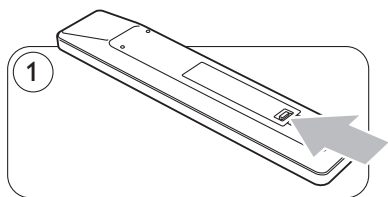

### Navigation and OK key

Press ▲, ▼ or ◀, ▶ to navigate the TV menu. Press the **OK** key to confirm your choice.

### Colour coded keys

Press a colour key to select a task or choice shown on screen.

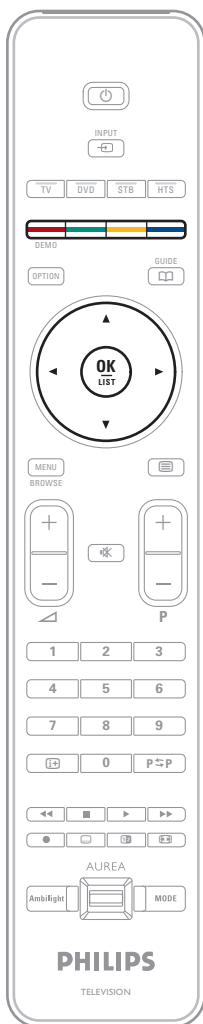

## 3 Power & antenna

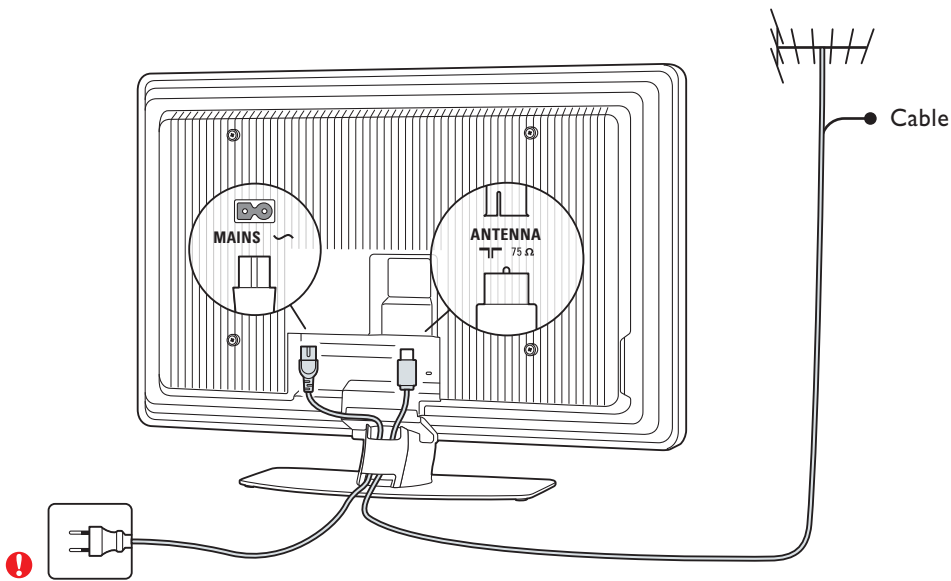

The TV will switch on automatically when you plug in the power cord.

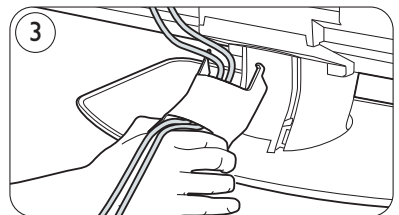
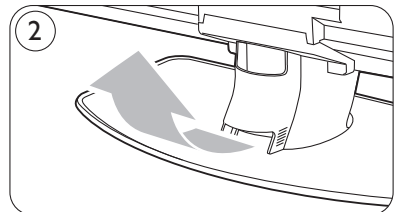
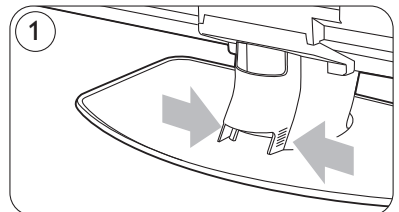

## 4 Installation

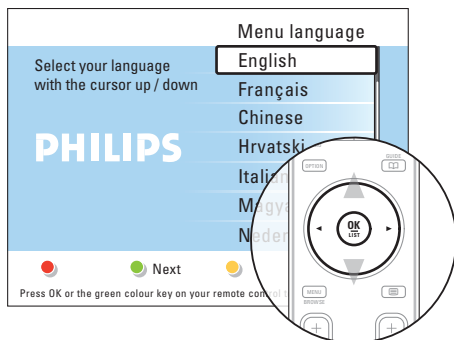

Press ▼ or ▲ to select your language.

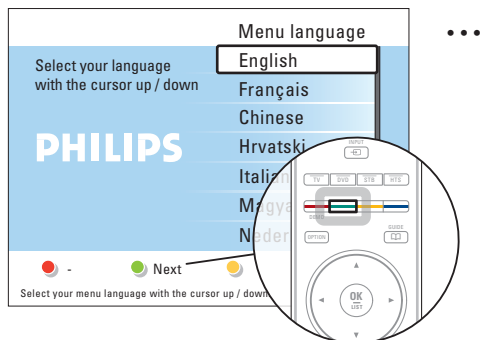

Press the green key to proceed the installation.  
**Tip** – Press the red key repeatedly to return to a previous menu in case you made a mistake.

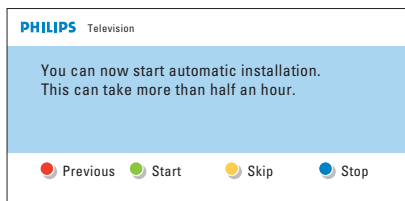

• • •

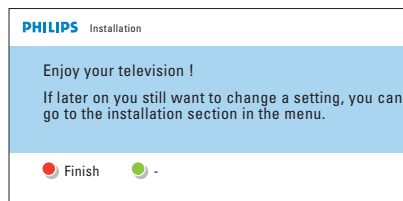

The automatic installation will search and store all available TV channels.

**Tip** – If you watch all TV channels with a cable box or digital receiver, you can skip this automatic installation.

You finished the installation successfully. Press the red key to watch TV.

If you want to change the order of the TV channels, see section **6.3.3 Reorder the channels** of the user manual.

# DVD player, HD game, Home Theatre System



**Caution**

Disconnect the TV mains power before you connect other devices.

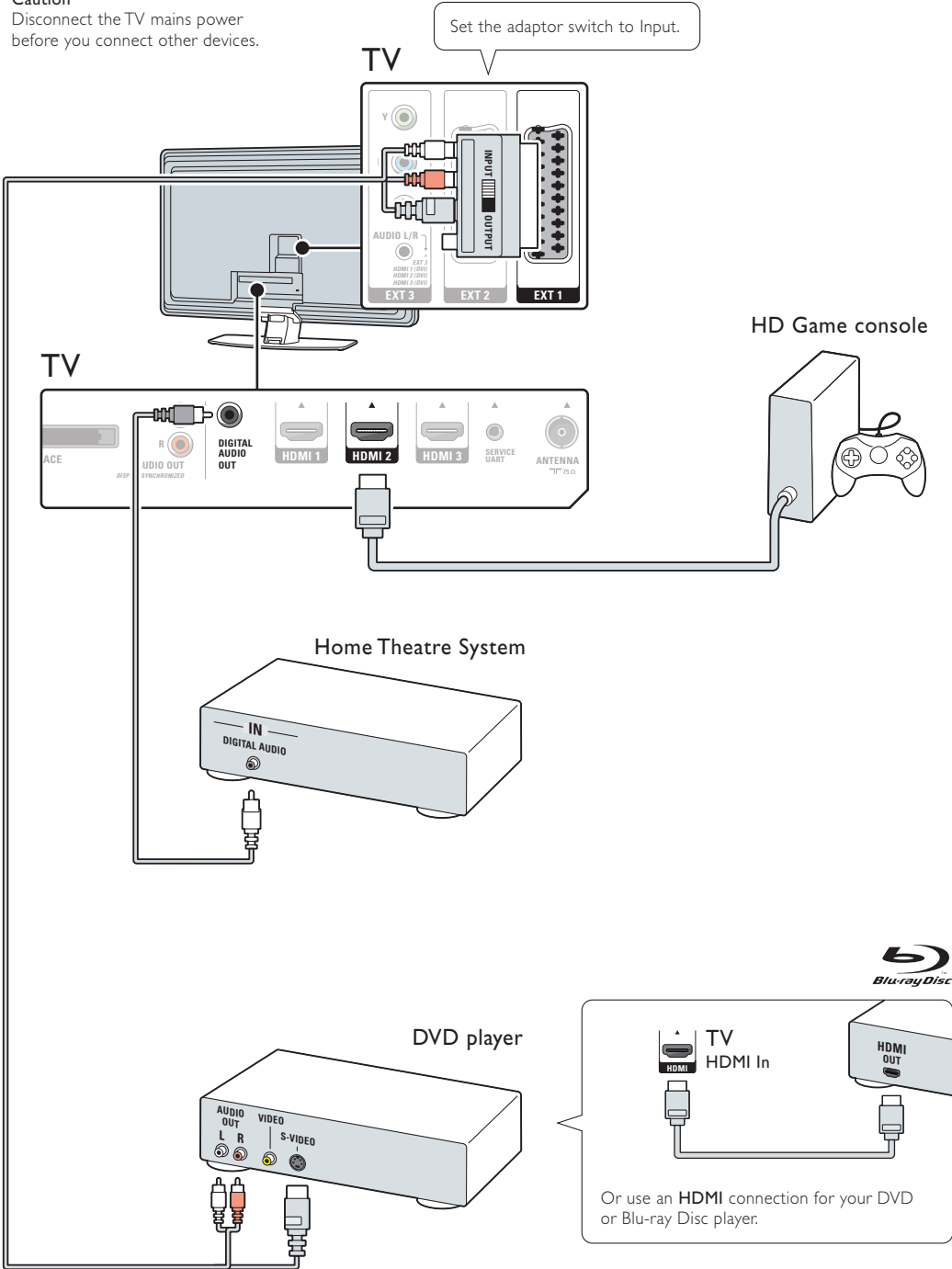



# DVD recorder and HD receiver

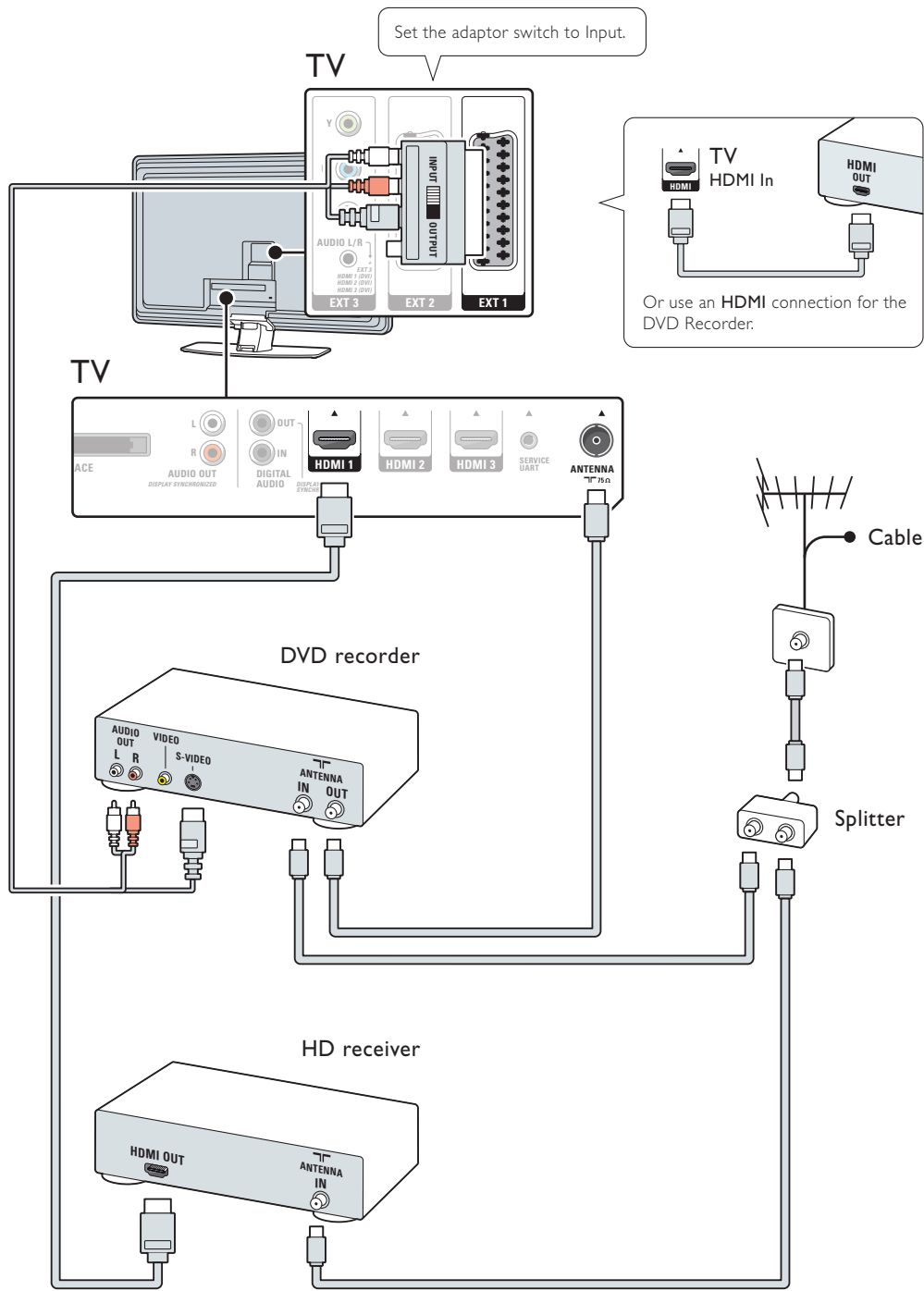

# Photo camera, game, camera, PC

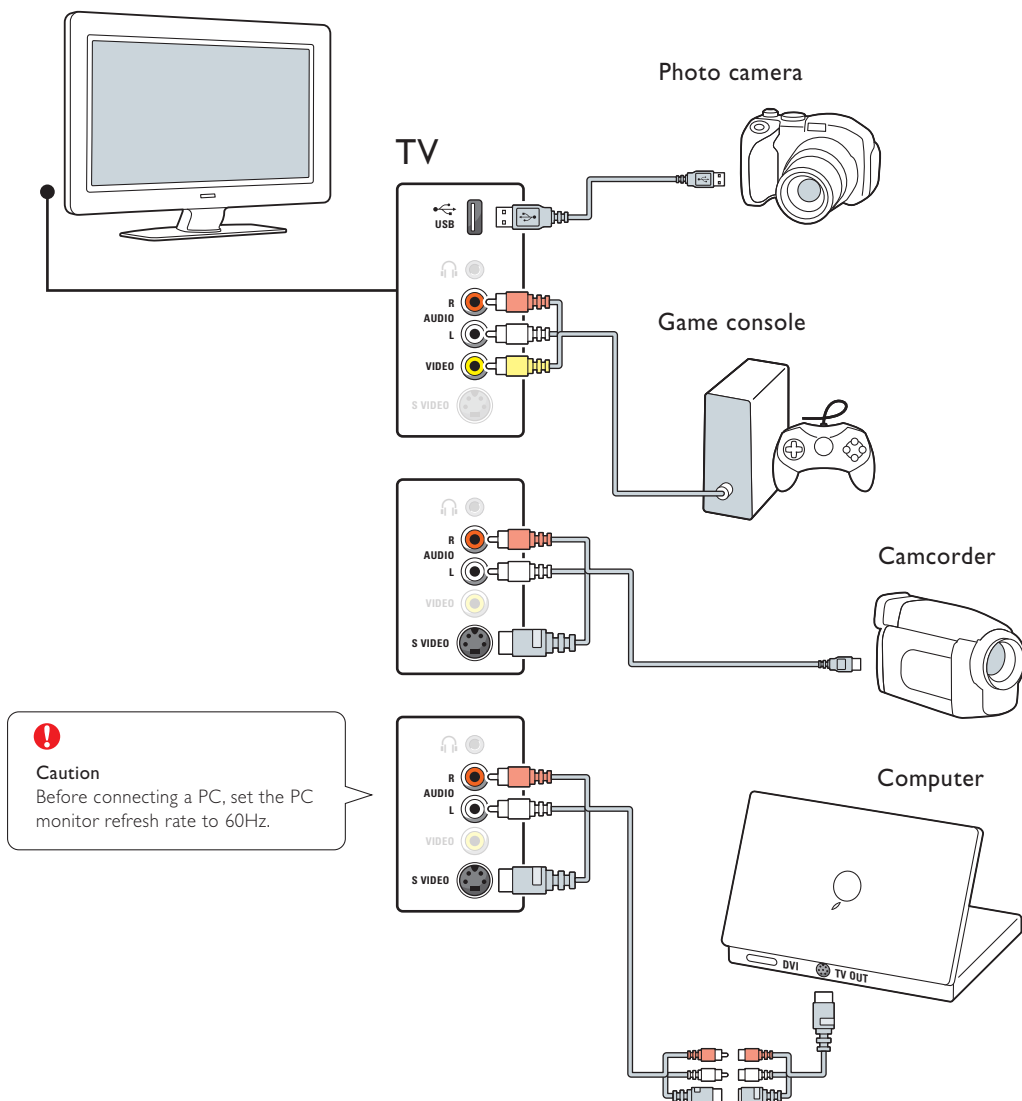

# Ambilight set up

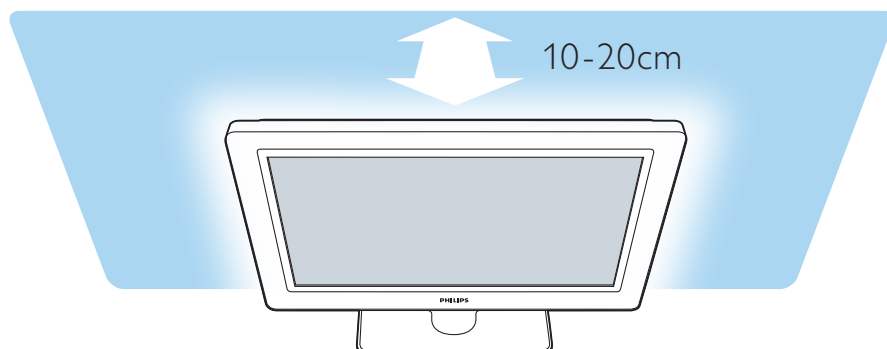

For the best Ambilight effect position the TV 10 to 20cm away from the wall. Position the TV where sunlight does not fall directly on the TV.

Also carefully read the safety precautions in section **1.1 Safety** in the user manual.

# Need help?

## User manual

See the User manual that came with your TV.

## Online help

[www.philips.com/support](http://www.philips.com/support)



## Consumer Care

Australia

1300 363 391

Please, have the Model and Serial Number ready before you call.

You can find these numbers on the packaging label or on the back of your TV.



Specifications are subject to change without notice  
Trademarks are the property of Koninklijke Philips Electronics N.V.  
or their respective owners  
2007 © Koninklijke Philips Electronics N.V. All rights reserved.

[www.philips.com](http://www.philips.com)



Printed in Belgium

3104 315 7462.1