

Philips
Professional TV

65" Studio

4K Ultra HD
DVB-T2/T/C HEVC

65HFL2859T



Delight your guests

with pure taste

Show your guests how much you care with this affordable Professional TV. You will enjoy dedicated hospitality features like a branded welcome page, installation via USB and menu and control locking.

Great viewing experience and guest comfort

- 4K Ultra HD: resolution like you've never seen it before
- Low power consumption
- USB for multimedia playback

Advanced hotel features and future proof

- Greet your guests with a customizable welcome page
- USB cloning of all settings for quick installation
- Off-line channel editor to edit a channel list on a PC
- One combined channel list for Analog and Digital channels
- Installation menu locking
- Prevent unauthorized use by local control locking
- Advanced volume control to avoid guest disturbance

PHILIPS

Highlights

4k Ultra HD Resolution

See TV like never before thanks to four times the resolution of a conventional Full HD TV. 3840 x 2160 pixels provide an image so refined, so lifelike, it's a window to a new world.

Welcome page



A welcome page is displayed each time the TV set is switched on. The welcome page can be branded and customized easily at the time of installation via a simple welcome image in .png format.

USB Cloning

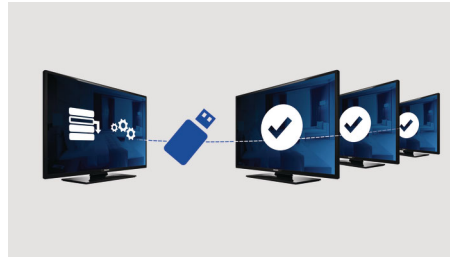

Provides the ability to easily copy all programming and channel programming settings from one TV into other TV sets in less than a minute. The feature ensures uniformity between TV sets and significantly reduces installation time and costs.

USB (photos, music, video)



Share the fun. Connect your USB memory-stick, digital camera, mp3 player or other multimedia device to the USB port on your TV to enjoy photos, videos and music with the easy to use onscreen content browser.

One combined channel list

One integrated channel list for digital and analogue channels. This allows the guest to zapp seamless between Analogue and Digital channels.

Advanced volume control

With advanced volume control you can install the start-up volume of the TV and predifine the volume range with which the TV set is allowed to operate, preventing excessive volume adjustments and avoiding disturbance of next door guests.

Local control locking

By disabling or enabling the local control locking, the administrator can prevent unauthorized use of the TV via the control buttons, saving the hotelier overheads.

Installation menu locking

Prevents unauthorized access to installation and configuration settings, to ensure maximum guest convenience and avoid unnecessary reinstalling costs.

Low power consumption

Philips TVs are desgined to minimize power consumption. This will not only reduce environmental impact but also lower operating costs.

Specifications

Picture/Display

- Display: 4K Ultra HD LED
- Diagonal screen size: 65 inch / 164 cm
- Aspect ratio: 16:9
- Panel resolution: 3840x2160p
- Brightness: 350 cd/m²
- Contrast ratio (typical): 4000
- Viewing angle: 178° (H) / 178° (V)

Audio

- Sound output Power: 16 (2x8) W
- Speakers: 2.0, Down Firing
- Sound Features: Equalizer, Balance, AVL, Incredible surround, Dynamic Bass, Dolby MS10

Design

- Colour: Black

Tuner/Reception/Transmission

- Digital TV: DVB-T/T2/C, HEVC UHD (up to 2160p60)
- Analog TV: PAL, SECAM

Connectivity Rear

- Scart: CVBS, RGB, SVHS
- Component: YPbPr + L/R cinch
- AV input: CVBS shared with YPbPr
- USB1: USB 2.0

Connectivity Side

- Common Interface Slot: CI+ 1.3
- Headphone out: Mini-Jack
- HDMI2: HDMI 2.0, HDCP 2.2, ARC
- USB2: USB 2.0

Connectivity Bottom

- Antenna: IEC-75
- HDMI1: HDMI 2.0, HDCP 2.2
- Digital Audio out: Optical
- VGA input: 15 pin D-sub

Connectivity Enhancements

- EasyLink (HDMI CEC): One touch play, System Standby, RC pass through

Features

- Digital services: Subtitles, Teletext, MHEG, Now&Next, 8d EPG
- Ease of use: Picture Style, Sound Style
- Local control: Keyboard (6 knobs)

Hospitality Features

- Hotel mode: Local Control Lock, Menu lock, Installation Menu Lock, Volume limitation (incl. HP)
- Prison mode: high security mode, TXT/MHEG/USB/EPG/Subtitle Lock
- Your brand: Welcome Logo
- Cloning and Firmware update: via USB, Instant Initial Cloning
- Switch On control: Channel/Source, Picture Style, Volume (incl. HP)
- Timer: Sleep Timer, Wake Up Alarm
- Channels: Combined List, Off-Line Channel Editor
- Control: Block Automatic Channel Update
- Power control: Green/fast startup
- Remote Control: Cable Strap Ready, RC Battery Door Lock
- Anti-Theft: Kensington Lock

Healthcare features

- Control: Multi-Remote Control
- Convenience: Headphone out

Multimedia

- Multimedia connections: USB
- Video playback supported: Containers: AVI, MKV, Formats: H.264/MPEG4 AVC, MPEG1, MPEG2, MPEG4, HEVC, TS
- Subtitle formats supported: SRT, SSA SUB, ASS, SMI, TXT
- Music formats supported: MP3, AAC, WAV, WMA (v2 up to v9.2)
- Picture formats supported: BMP, JPG, PNG
- Supp. Video Resolution on USB: up to 1920x1080p@30Hz

Supported Display Resolution

- HDMI: Up to 3840x2160p@60Hz
- Tuner: T2 HEVC: up to 3840x2160@60Hz, Others: up to 1920x1080p@60Hz
- USB: HEVC: up to 3840x2160@60Hz, Others: up to 1920x1080@60Hz

Accessories

- Included: Remote Control 22AV1407A/12, 2x AAA batteries, Edge Stand, Warranty Leaflet, Legal and Safety brochure
- Optional: Setup RC 22AV9573A

Power

- Mains power: AC 220-240V; 50-60Hz
- Energy Label Class: A+
- Eu Energy Label power: 118 W
- Annual energy consumption: 172 kWh
- Standby power consumption: <0.3 W
- Power Saving Features: Eco mode
- Ambient temperature: 5 °C to 45 °C

Dimensions

- Set dimensions (W x H x D): 1460 x 838 x 50 mm
- Set dimensions with stand (W x H x D): 1460 x 903 x 345 mm
- Product weight: 36.9 kg
- Product weight (+stand): 37.5 kg
- Wall mount compatible: M6, 400 x 400 mm

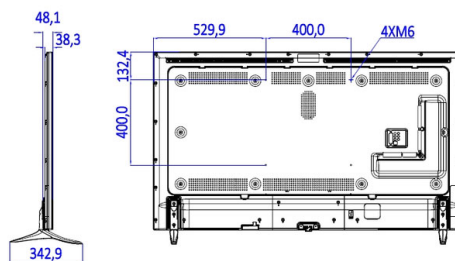
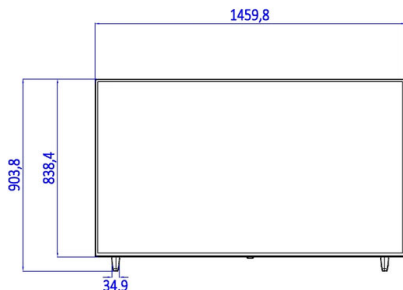

Issue date 2022-07-14

Version: 2.0.1

12 NC: 8670 001 38218
EAN: 87 18863 00945 1

© 2022 Koninklijke Philips N.V.
All Rights reserved.

Specifications are subject to change without notice.
Trademarks are the property of Koninklijke Philips N.V.
or their respective owners.

www.philips.com

* Availability of features will depend on implementation chosen by integrator.

* Typical on-mode power consumption measured according to IEC62087 Ed 2. The actual energy consumption will depend on how the television is used.

* This television contains lead only in certain parts or components where no technology alternatives exist in accordance with existing exemption clauses under the RoHS Directive.