



Philips 7300 series  
4K Ultra Slim TV powered  
by Android TV

**139 cm (55")**

4K Ultra HD LED TV  
Quad Core, 16GB  
DVB-T/T2



**55PUT7303**

## Ultra Slim 4K UHD LED Android TV

with Ambilight 3-sided

Indulge in the shows, movies, and games you love with a 4K UHD TV that makes content from any source look superb. With Android TV, wireless connectivity, and Ambilight you won't just stream your favourites. You'll get lost in them.

### **Sharp. Light. Immersive.**

- Slender bezel and metal stand.
- Ambilight. Take the emotion beyond the screen.

### **Rich colour. Sharp contrast.**

- HDR Plus. Enhanced contrast, colour, and sharpness.
- Micro Dimming Pro. Intelligent contrast for dynamic scenes.

### **Delight in the beauty of 4K**

- 4K Ultra HD. Pictures so sharp you'll think you're there.
- Philips P5 Engine. Whatever the source, always perfection.

### **Android TV-powerfully smart**

- Google Assistant built-in. Content and more at your command.
- Quad Core processor and Android. Unleash your content.
- Google Play store and Philips app gallery. More to love.

# PHILIPS

4K Ultra Slim TV powered by Android TV  
139 cm (55") 4K Ultra HD LED TV, Quad Core, 16GB, DVB-T/T2

55PUT7303/56

# Highlights

## Ambilight 3-sided

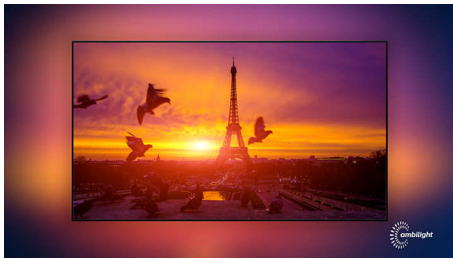

With Philips Ambilight, movies and games feel more immersive. Music gets a light show. And your screen will feel bigger than it is. Intelligent LEDs around the edges of the TV cast on-screen colours onto the walls, and into the room, in real time. You get perfectly tuned ambient lighting. And one more reason to love your TV.

## Slender Bezel

Slender bezel and metal stand.

## 4K Ultra HD



With four times the resolution of conventional Full HD, Ultra HD lights up your screen with over 8 million pixels and our unique Ultra Resolution Upscaling technology. Experience improved images regardless of the original content, and enjoy a sharper picture with superior depth, contrast, natural motion and vivid details.

## P5 Perfect Picture Engine

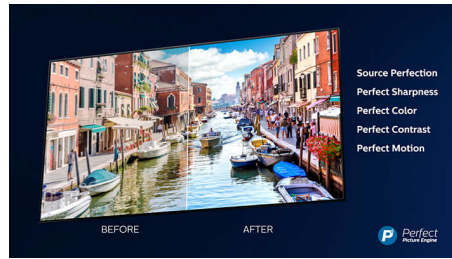

The Philips P5 engine delivers a picture as brilliant as the content you love. Details have noticeably more depth. Colors are vivid, while skin tones look natural. Contrast is so crisp you'll feel every detail. Motion is perfectly smooth.

## High Dynamic Range Plus



High Dynamic Range Plus is a new video standard. It redefines in-home entertainment through advances in contrast and color. Enjoy a sensory experience that captures the original richness and liveliness, yet accurately reflects the content creator's intent. The end result? Brighter highlights, greater contrast, a broader range of colors and detail like never before.

## Micro Dimming Pro

Micro Dimming Pro optimizes the contrast on your TV based on the lighting conditions of your room. Combined with its special software that analyzes the picture in 6400 different zones, you will enjoy incredible contrast and image quality for a truly lifelike visual experience-day or night.

## Google Assistant built-in

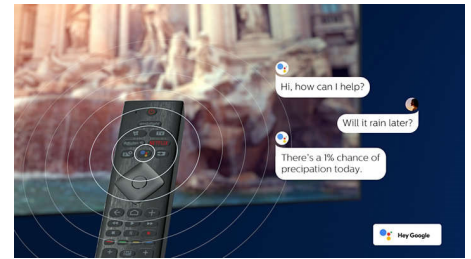

Control your Philips Android TV with your voice. Want to play a game, watch Netflix, or find content and apps in the Google Play store? Just tell your TV. You can even command all Google Assistant-compatible smart home devices-like dimming the lights and setting the thermostat on movie night. Without leaving the sofa.

## TV Content

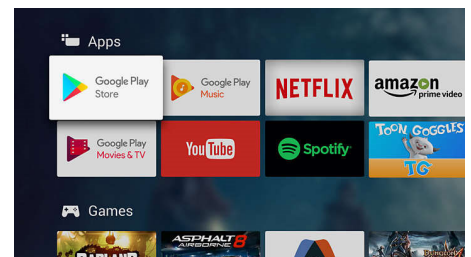

Go beyond traditional TV programming with Google Play Store and Philips App Gallery. Experience endless movies, TV, music, apps and games online. More to love.

## Quad Core + Android

Philips Quad Core processor meets the power of Android to deliver an exciting gaming experience. And with Android on your TV you'll navigate, launch apps and play videos in a way that is super fast, super intuitive, and super fun.



# Specifications

## Ambilight

- Ambilight Features: Built in Ambilight+hue, Ambilight Music, Game Mode, Wall colour adaptive, Lounge mode
- Ambilight Version: 3-sided

## Picture/Display

- Aspect ratio: 16:9
- Display: 4K Ultra HD LED
- Panel resolution: 3840x2160
- Picture engine: P5 Perfect Picture Engine
- Picture enhancement: Ultra Resolution, Micro Dimming Pro, 1600 PPI

## Supported Display Resolution

- Computer inputs on all HDMI: up to 4K UHD 3840x2160 @60Hz
- Video inputs on all HDMI: up to 4K UHD 3840x2160@60Hz

## Tuner/Reception/Transmission

- Digital TV: DVB-T/T2
- Video Playback: NTSC, PAL, SECAM
- MPEG Support: MPEG2, MPEG4
- TV Program guide\*: 8 day Electronic Program Guide
- Signal strength indication
- HEVC support

## Android TV

- OS: Android™ 7.0 (Nougat)
- Pre-installed apps: Google Play Movies\*, Google Play Music\*, Google Search, YouTube
- Memory size(Flash): 16GB\*
- Memory size to install apps: 12GB

## Smart TV Features

- User Interaction: MultiRoom client and server, SimplyShare
- Interactive TV: HbbTV
- Program: Pause TV, USB recording\*
- SmartTV apps\*: Online video stores, Open internet browser, Social TV, TV on demand, Youtube
- Ease of Installation: Auto detect Philips devices, Device connection wizard, Network installation wizard, Settings assistant wizard
- Ease of Use: One-stop smart menu button, Onscreen usermanual
- Firmware upgradeable: Firmware auto upgrade

wizard, Firmware upgradeable via USB, Online firmware upgrade

- Screen Format Adjustments: Basic - Fill Screen, Fit to screen, Advance - Shift, Zoom, stretch
- Philips TV Remote app\*: Apps, Channels, Control, NowOnTV, TV Guide, Video On Demand
- Remote Control: with Voice, with Keyboard

## Multimedia Applications

- Video Playback Formats: Containers: AVI, MKV, H264/MPEG-4 AVC, MPEG-1, MPEG-2, MPEG-4, WMV9/VC1, VP9, HEVC (H.265)
- Music Playback Formats: AAC, MP3, WAV, WMA (v2 up to v9.2), WMA-PRO (v9 and v10)
- Subtitles Formats Support: .SRT, .SUB, .TXT, .SMI
- Picture Playback Formats: JPEG, BMP, GIF, PNG

## Processing

- Processing Power: Quad Core

## Sound

- Output power (RMS): 20W
- Sound Enhancement: Smart Sound, DTS-HD Premium Sound, Clear Sound

## Connectivity

- Number of HDMI connections: 4
- HDMI features: 4K, Audio Return Channel
- Number of component in (YPbPr): 1
- EasyLink (HDMI-CEC): Remote control pass-through, System audio control, System standby, One touch play
- Number of USBs: 2
- Wireless connection: Dual Band, Wi-Fi 802.11n 2x2 integrated
- Other connections: Antenna IEC75, Ethernet-LAN RJ-45, Audio L/R in, Headphone out, Digital audio out (optical)
- HDCP 2.2: Yes on HDMI1, Yes on HDMI2

## Power

- Mains power: AC 220 - 240 V 50/60Hz
- Ambient temperature: 5 °C to 35 °C
- Power Saving Features: Auto switch-off timer, Picture mute (for radio), Light sensor

## Accessories

- Included accessories: Remote Control, 2 x AA Batteries, Quick start guide, Legal and safety brochure, Power cord, Mini-jack to L/R cable, Mini-

jack to YPbPr cable, Table top stand

## Dimensions

- Set Width: 1244.2 mm
- Set Height: 729 mm
- Set Depth: 78.2 mm
- Product weight: 15.32 kg
- Set width (with stand): 1244.2 mm
- Set height (with stand): 781.2 mm
- Set depth (with stand): 266.14 mm
- Product weight (+stand): 16.12 kg
- Box width: 1360 mm
- Box height: 860 mm
- Box depth: 160 mm
- Weight incl. Packaging: 20.7 kg
- Wall mount compatible: 300 x 200 mm

## Connections

### Side

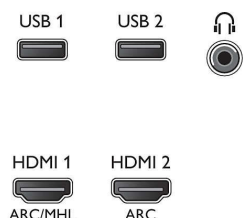

### Bottom

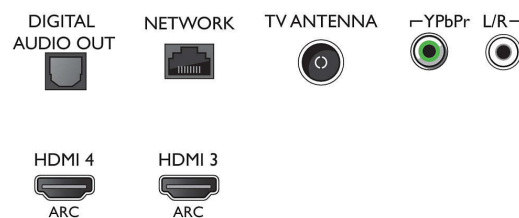

Issue date 2023-10-16

Version: 14.1.1

EAN: 87 18863 01698 5

© 2023 Koninklijke Philips N.V.  
All Rights reserved.

Specifications are subject to change without notice.  
Trademarks are the property of Koninklijke Philips N.V.  
or their respective owners.

[www.philips.com](http://www.philips.com)



\* EPG and actual visibility (up to 8 days) is country and operator dependent.

\* Android App offerings vary per country. For more details please visit your local Google Play Store.

\* Smart TV app offerings vary per TV model and country. For more details please visit: [www.philips.com/smarttv](http://www.philips.com/smarttv).

\* This television contains lead only in certain parts or components where no technology alternatives exist in accordance with existing exemption clauses under the RoHS Directive.

\* Its functionality is subject to ChromeCast built-in apps and smart devices. For more details, please visit ChromeCast built-in product pages.