

Register your product and get support at
www.philips.com/welcome

5800, 6000 & 7000
LED series

Quick start guide



PHILIPS



- EN** Before using your product, read all accompanying safety information
- ES** Antes de usar el producto, lea la información de seguridad adjunta
- PT** Antes de usar o produto, leia todas as informações de segurança em anexo.



EN What's in the box

ES Contenido de la caja

PT Conteúdo da embalagem

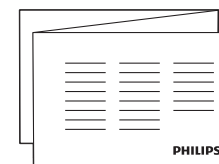
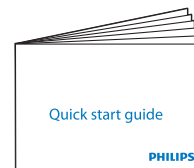
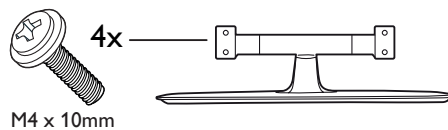
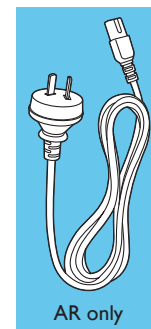
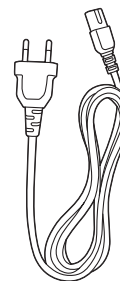
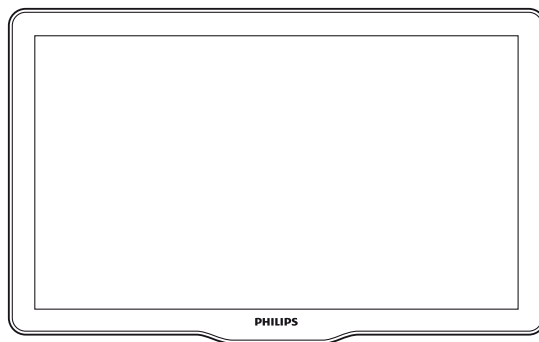

1



- EN** Mount the stand
- ES** Monte el soporte
- PT** Monte o pedestal

1

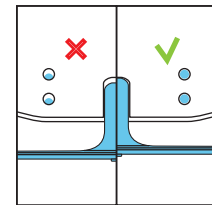
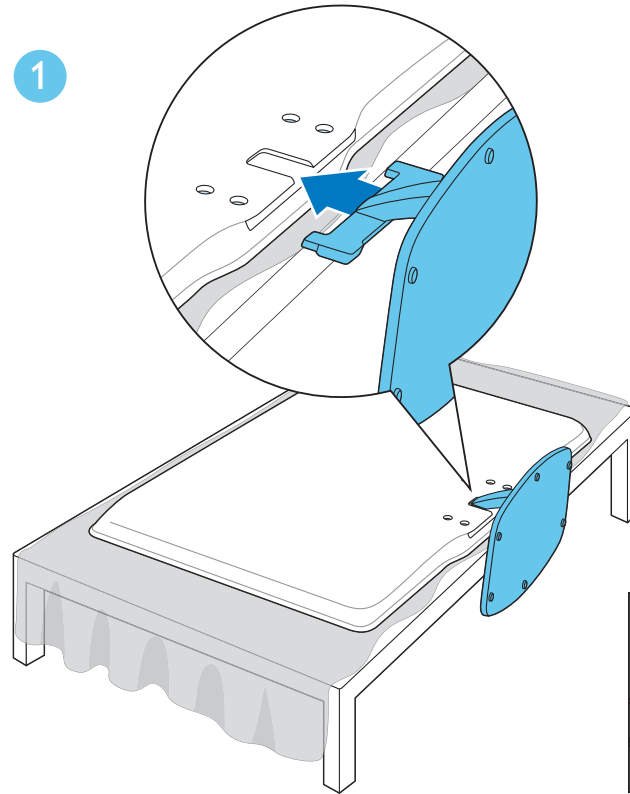

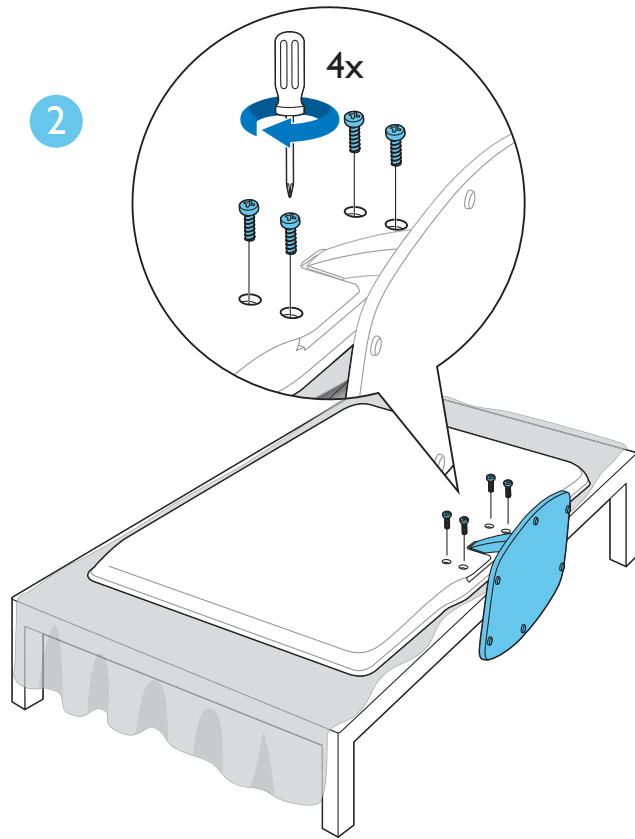

3

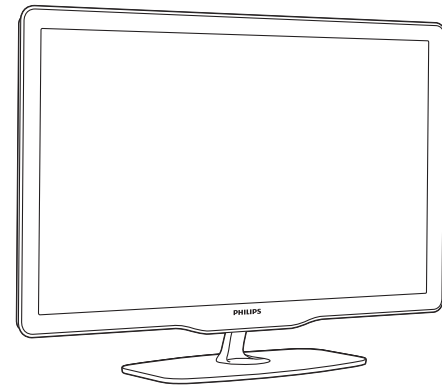

2



- EN** Connect
- ES** Conexión
- PT** Conectar

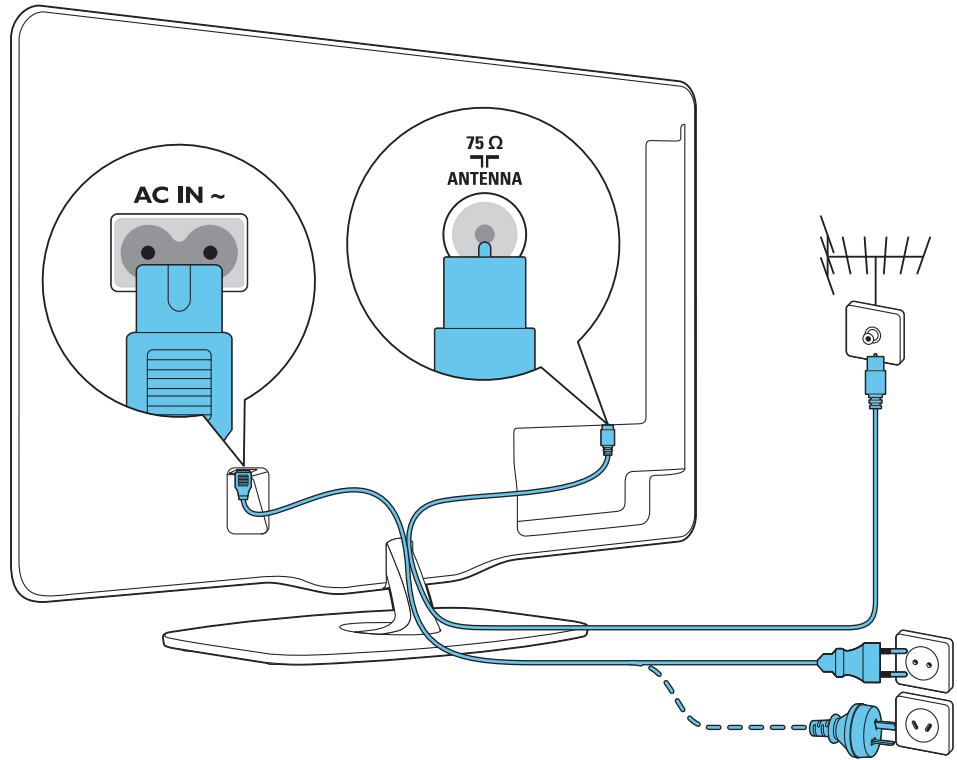

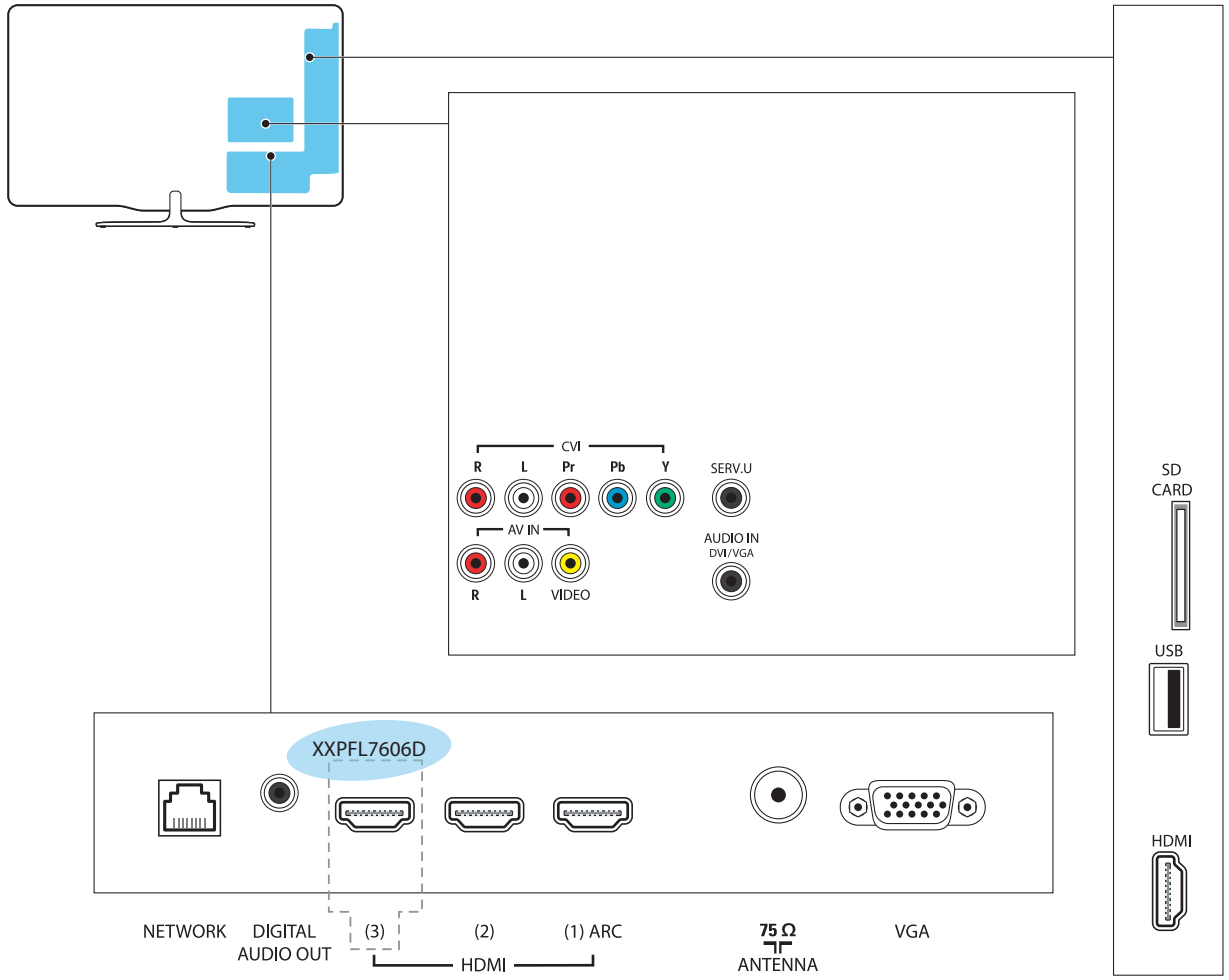

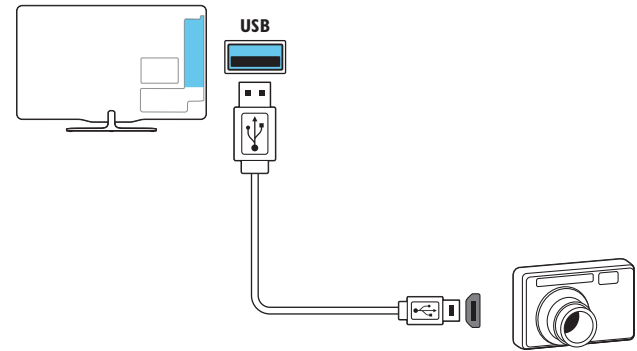
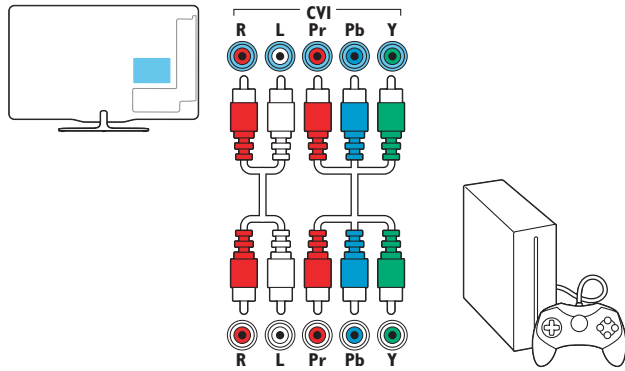
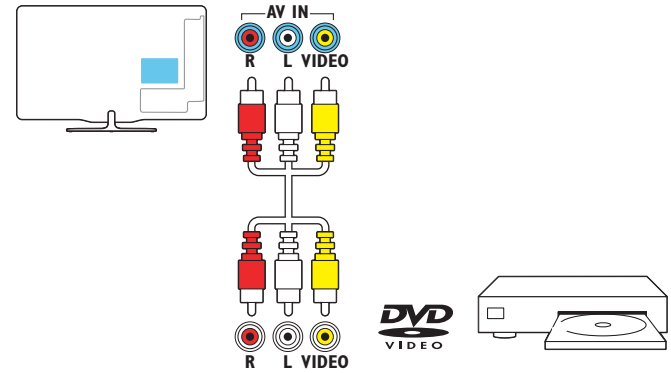
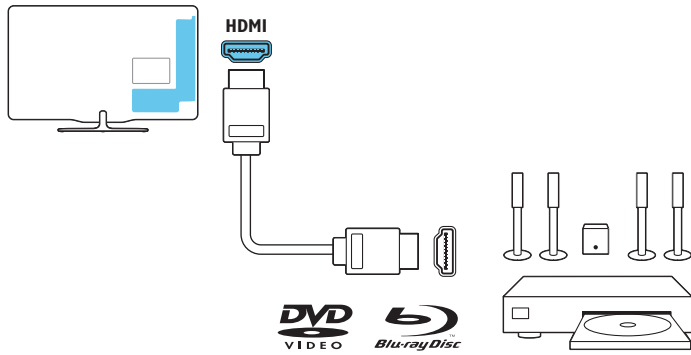

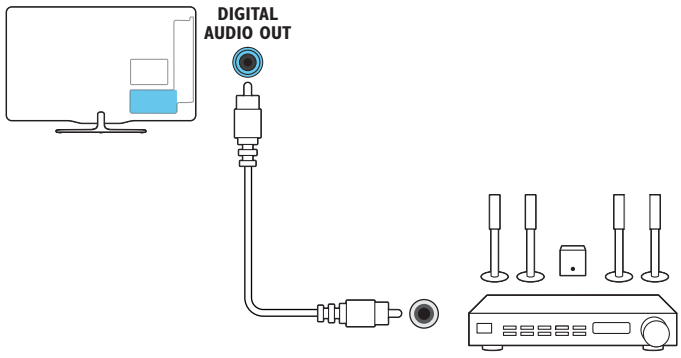
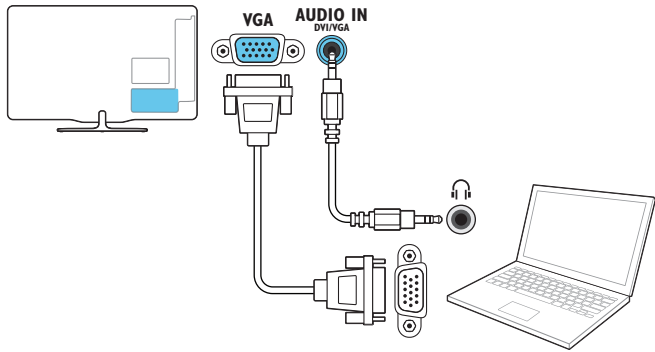

4

- EN** Check that the power switch is on
- ES** Verifique que el interruptor esté encendido
- PT** Verifique se o botão ligar está ativado

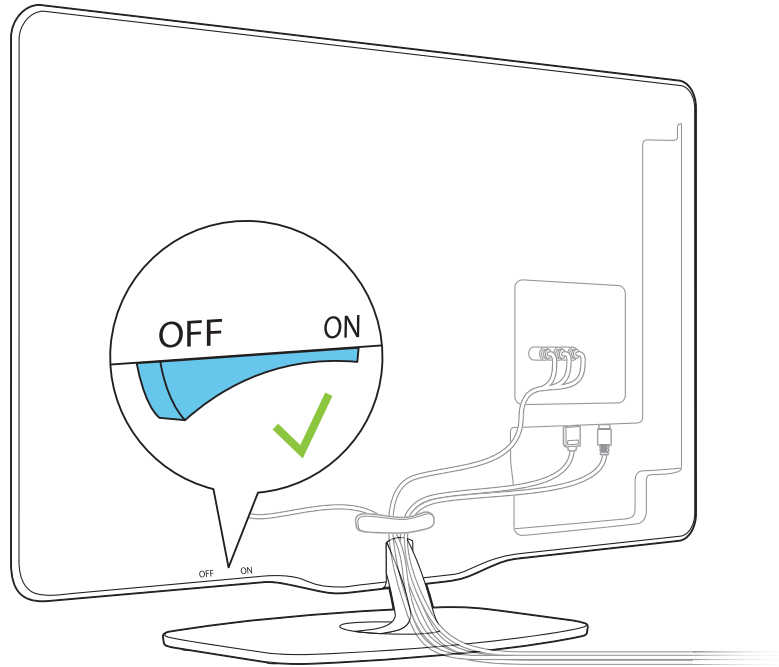

5

EN Insert batteries
ES Inserte las baterías
PT Insira as pilhas

1

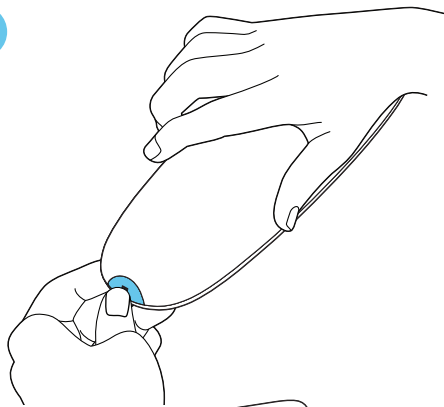

2

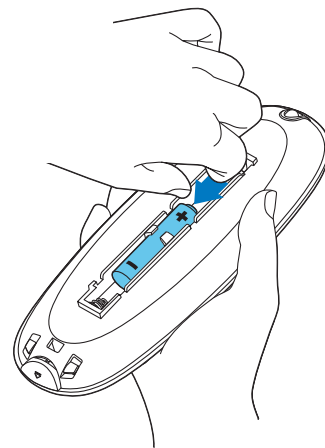

3

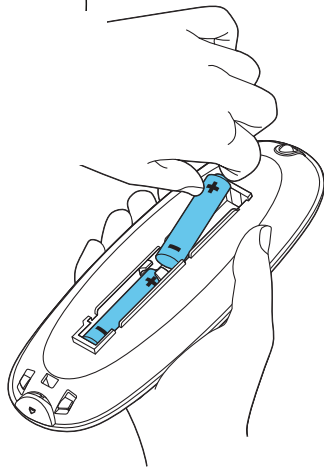

4

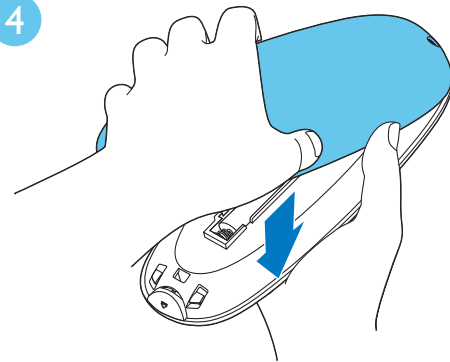

6

- EN** Select your language and follow the onscreen instructions
- ES** Seleccione el idioma y siga las instrucciones en la pantalla
- PT** Selecione o idioma e siga as instruções na tela

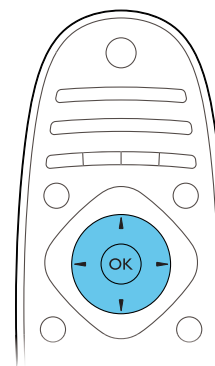

7

EN Watch TV
ES Veá TV
PT Assista a TV

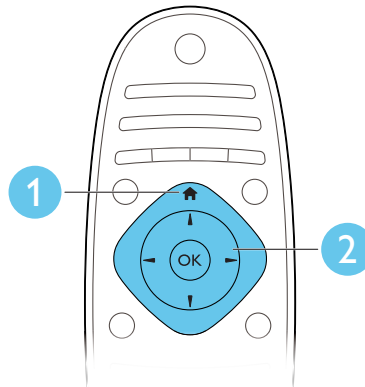



EN Add your device

ES Agregue su dispositivo

PT Adicione seu dispositivo

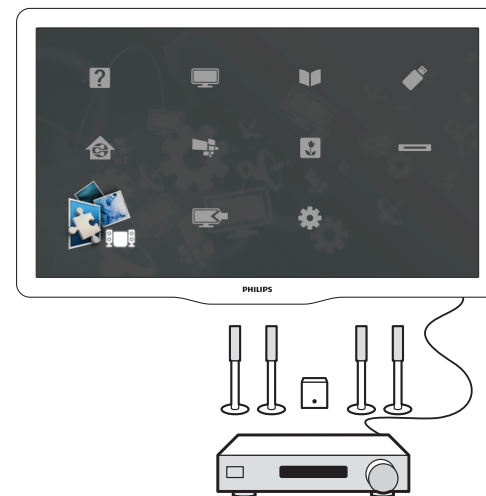
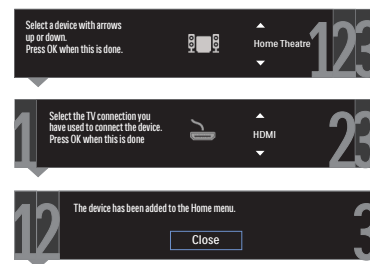
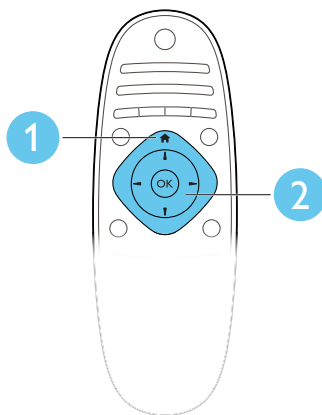

EN Select your device

ES Selección su dispositivo

PT Seleção seu dispositivo

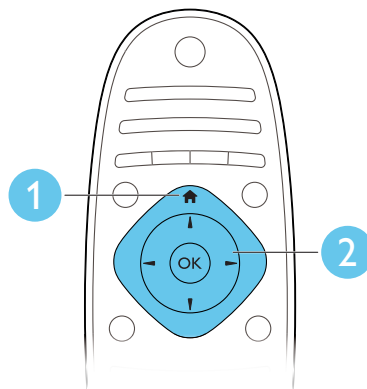



- EN** Onscreen help
- ES** Ayuda en pantalla
- PT** Ajuda na tela

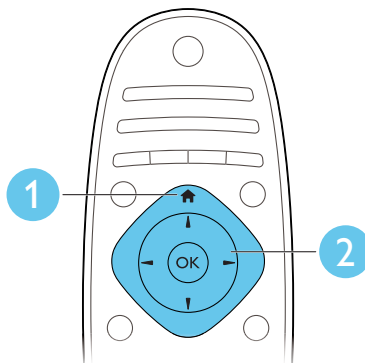

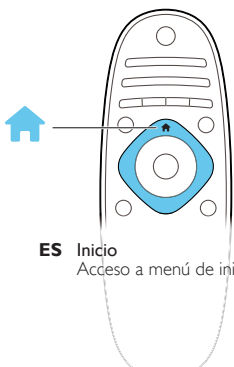

EN Home
Access Home menu

ES Inicio
Acceso a menú de inicio

PT Casa
Acessar o menu Início

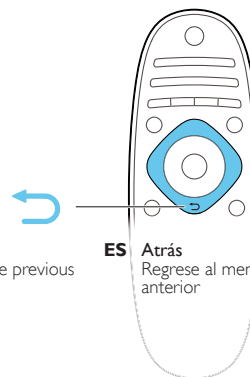

EN Back
Return to the previous page

ES Atrás
Regrese al menú anterior

PT Voltar
Retornar para a página anterior

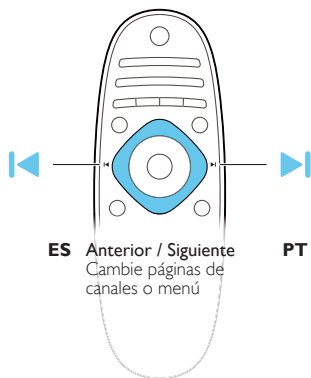

EN Previous / Next
Switch channels or menu pages

ES Anterior / Siguiente
Cambie páginas de canales o menú

PT Anterior / Próximo
Alterar canais ou páginas do menu

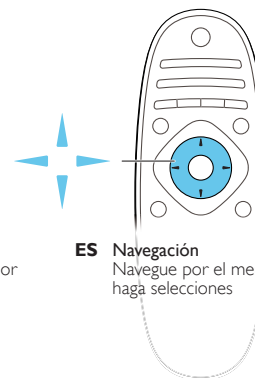

EN Navigation
Navigate menus or make selections

ES Navegación
Navegue por el menú o haga selecciones

PT Navegação
Navegar pelos menus ou fazer seleções

FIND



EN Find
Access channel list

ES Búsqueda
Acceso a channel list

PT Localizar
Acessar a lista de canais

ADJUST





EN Adjust
Adjust TV settings

ES Ajustar
Ajuste la configuración de TV

PT Ajustar
Ajustar configurações da TV

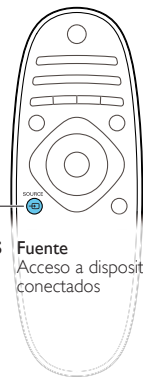
SOURCE

EN Source
Access connected devices

ES Fuente
Acceso a dispositivos conectados

PT Fonte
Acessar dispositivos conectados

OPTIONS



EN Options
Access TV options

ES Opciones
Acceda a opciones de TV

PT Opções
Acessar opções da TV

EN Play button
Control video or music
play

ES Botón de reproducción
Control de vídeo o
reproductor de música.

PT Botão play
Controlar vídeo ou
reproduzir música



EN For sustainability, the user manual is not printed and available in your product as onscreen help. A printable user manual as well as product updates is available from www.philips.com/support.

ES Por motivos de sustentabilidad este manual no se ha impreso, y se encuentra disponible en la ayuda en pantalla de su producto. En www.philips.com/support puede encontrar un manual para imprimir, además de las actualizaciones para este producto.

PT Para fins de sustentabilidade, o manual do usuário não é impresso e não está disponível no seu produto como ajuda na tela. O manual do usuário como também as atualizações do produto estão disponíveis no www.philips.com/support. tuppdateringar finns på www.philips.com/support.



www.philips.com/support



Non-contractual images. / Images non contractuelles. / Außervertragliche Bilder.

All registered and unregistered trademarks are property of their respective owners.

Specifications are subject to change without notice

Trademarks are the property of Koninklijke Philips Electronics N.V. or their respective owners
2011 © Koninklijke Philips Electronics N.V. All rights reserved

www.philips.com

