

PHILIPS

Television

Quick Start Guide

8007/8057 series

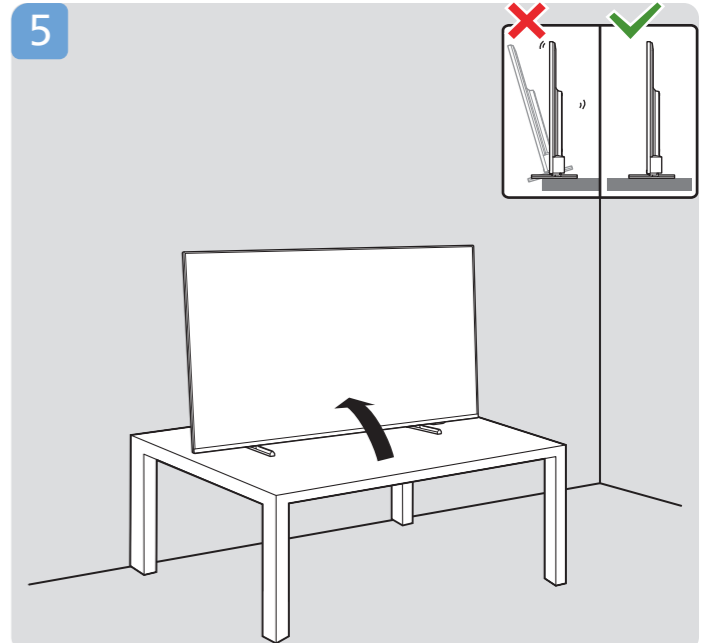
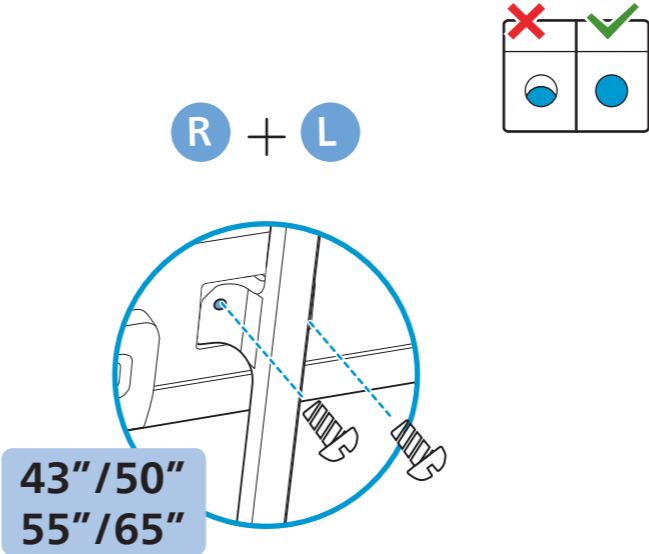
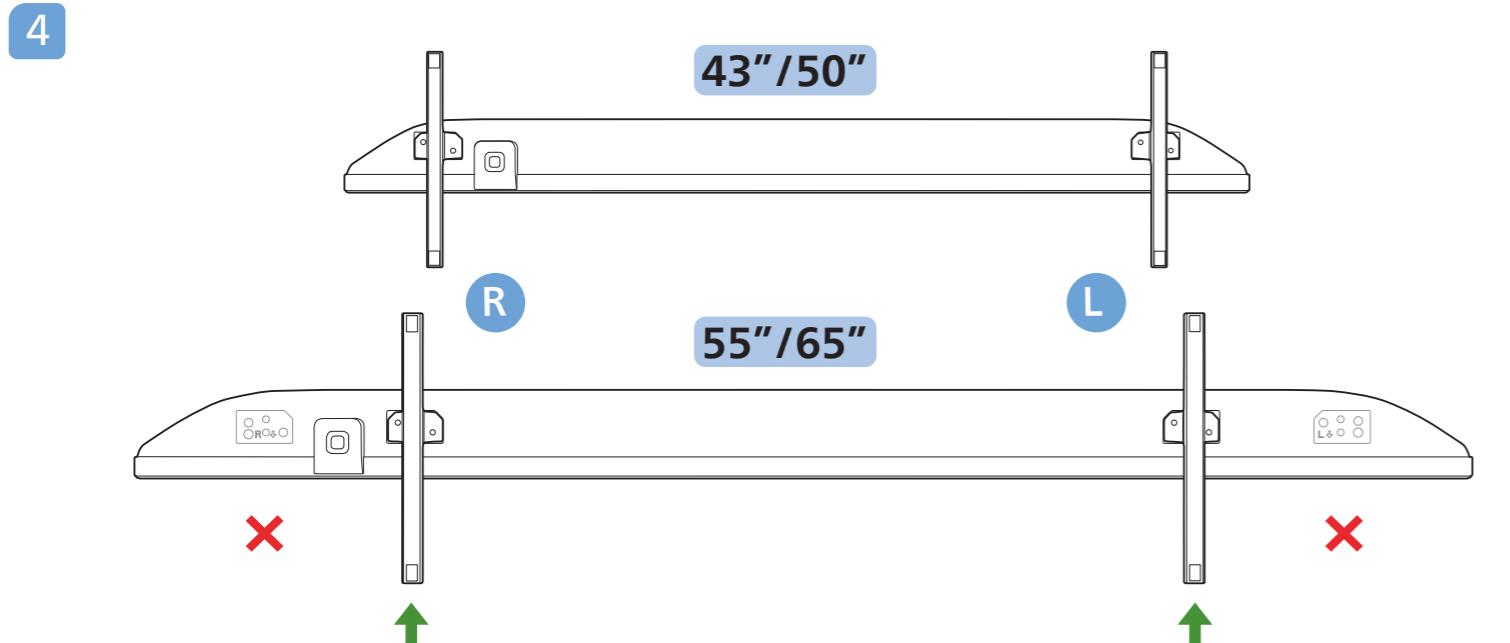
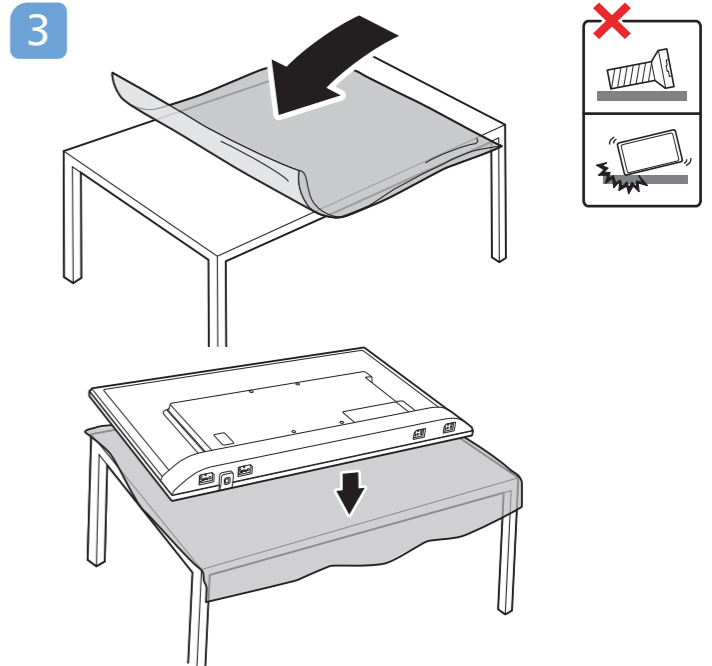
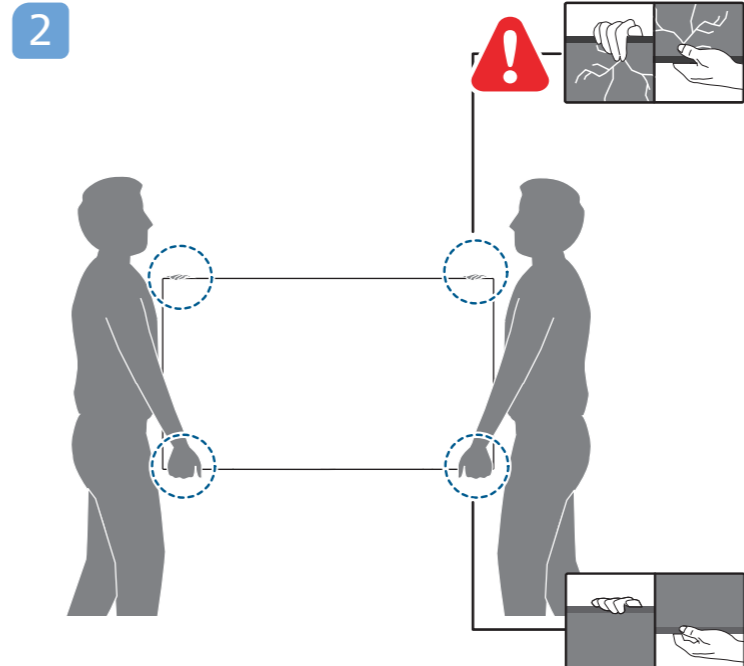
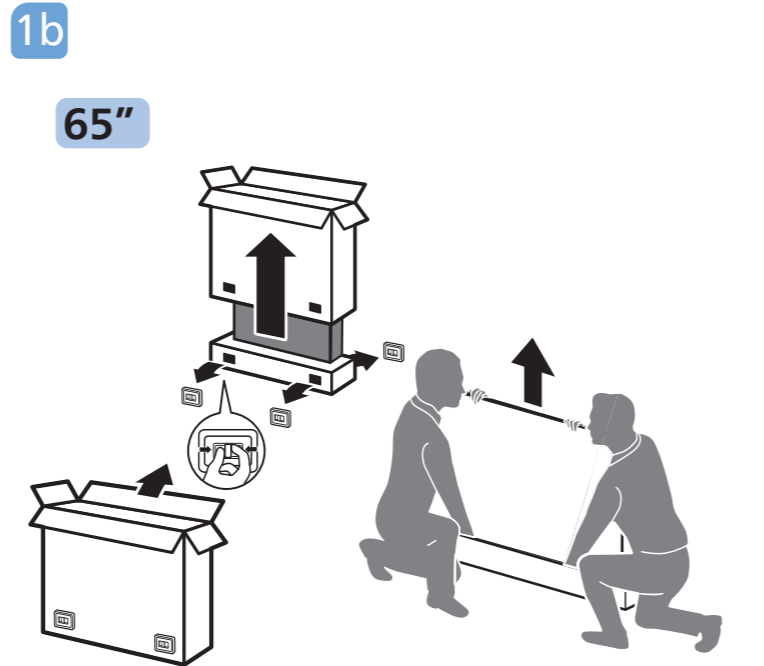
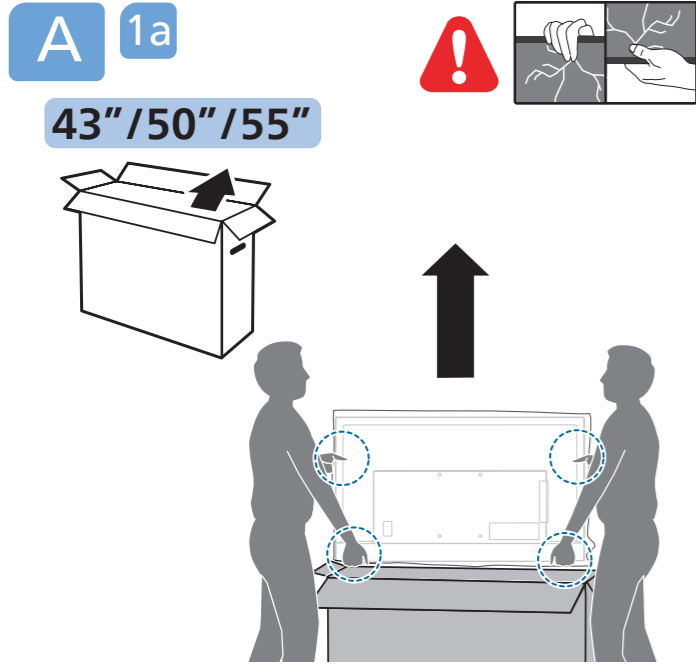
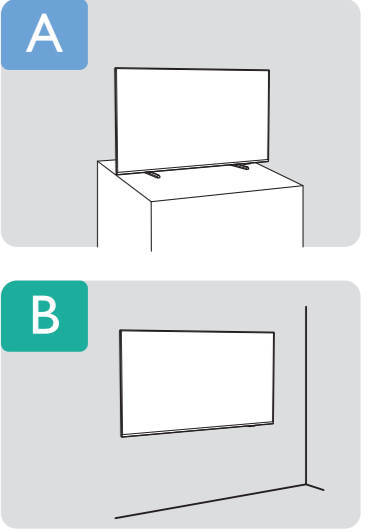
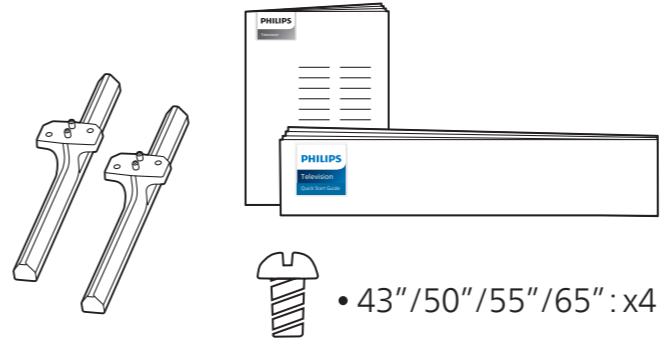
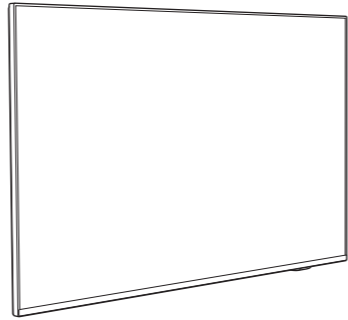



English Read the safety instructions.
Türkçe Güvenlik talimatlarını okuyun.



Register your product and get support at
www.philips.com/TVsupport

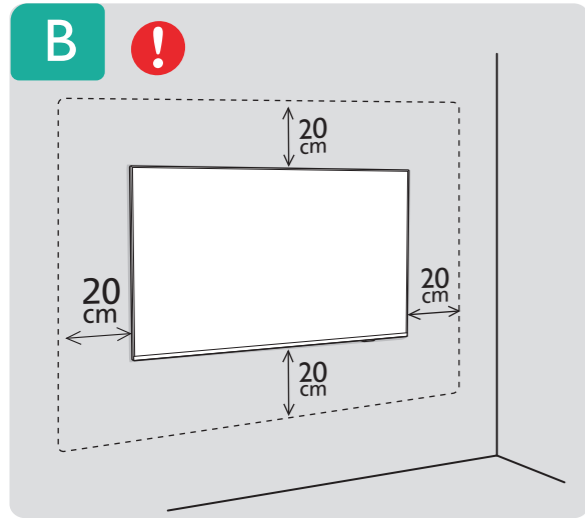
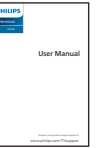
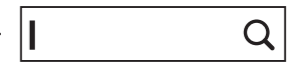

VESA (x, y)



- 43" 100x200mm M6 (L: 10mm~12mm)
108 cm
- 50" 200x300mm M6 (L: 10mm~16mm)
126 cm
- 55" 200x300mm M6 (L: 10mm~16mm)
139 cm
- 65" 300x300mm M6 (L: 12mm~20mm)
164 cm

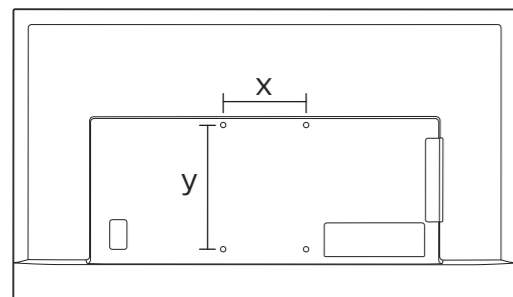
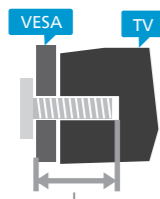

1



2

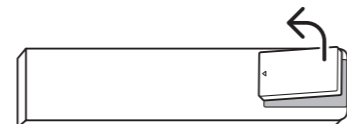

3

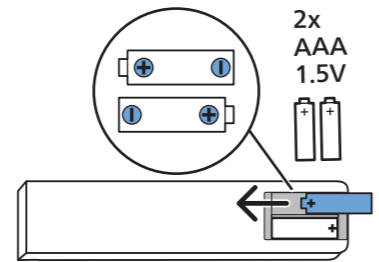

4



5

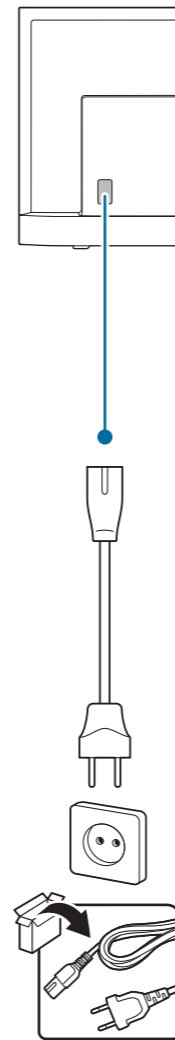
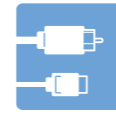
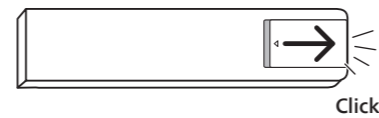

COMMON INTERFACE



USB 1



HDMI 1
ARC

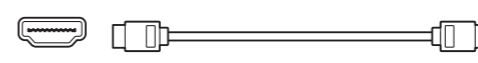

DIGITAL
AUDIO OUT



TOSLINK

USB 2



NETWORK



ROUTER

ROUTER

SAT (EU)



SATELLITE
COAXIAL

ANTENNA



COAXIAL

HDMI 2/3/4



RC Instructions



TV software upgrade
for Smart TV-
(From Internet)

HDMI®
HIGH-DEFINITION MULTIMEDIA INTERFACE

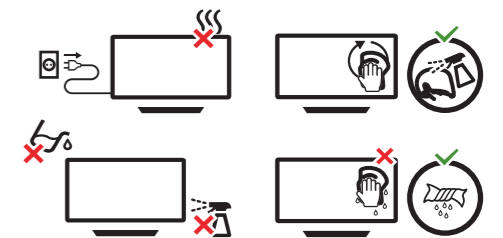
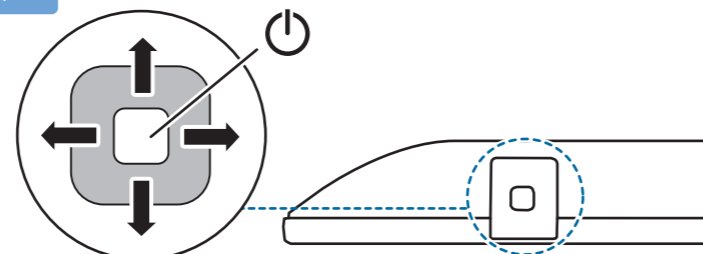

All registered and unregistered trademarks are property of their respective owners. Specifications are subject to change without notice. Philips and the Philips' shield emblem are trademarks of Koninklijke Philips N.V. and are used under license from Koninklijke Philips N.V. This product has been manufactured by and is sold under the responsibility of TP Vision Europe B.V., and TP Vision Europe B.V. is the warrantor in relation to this product. 2022 © TP Vision Europe B.V. All rights reserved. www.philips.com/welcome