

PHILIPS

Television

Quick Start Guide

6808 series

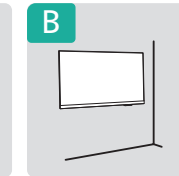
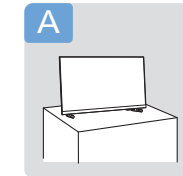
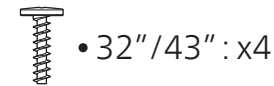
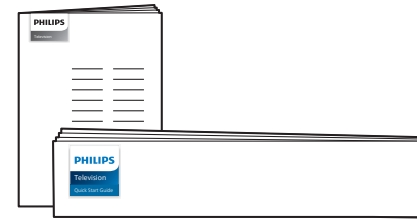
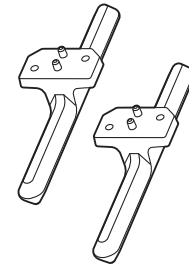
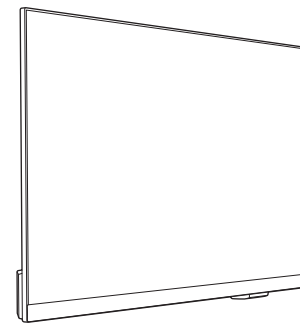

Register to find out more and get support
www.philips.com/TVsupport

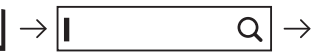

A

32"/43"

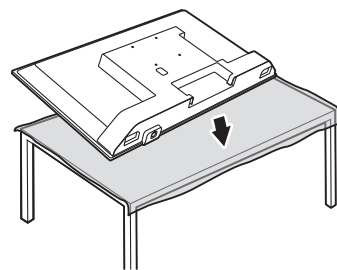
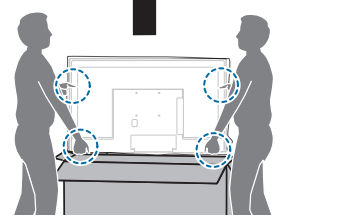
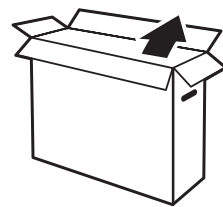

1

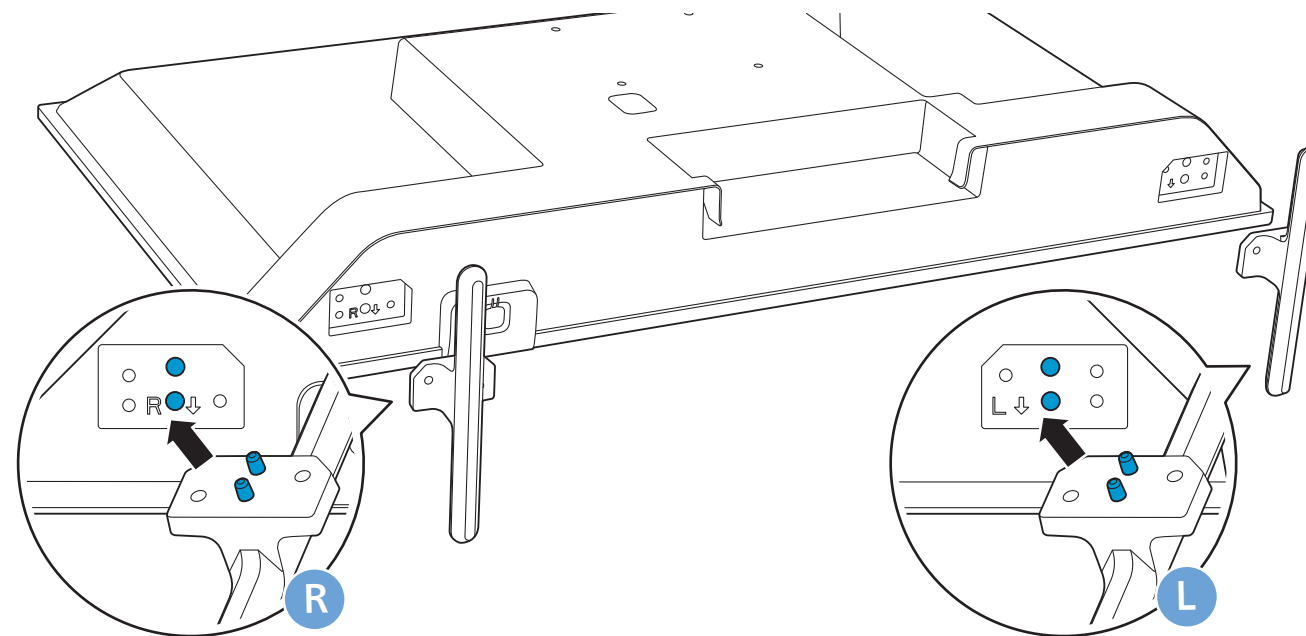

B

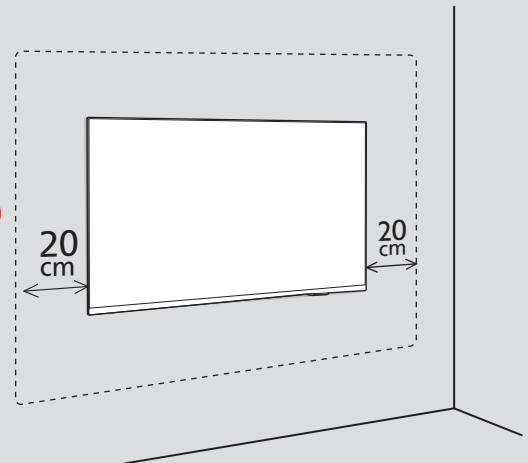

2

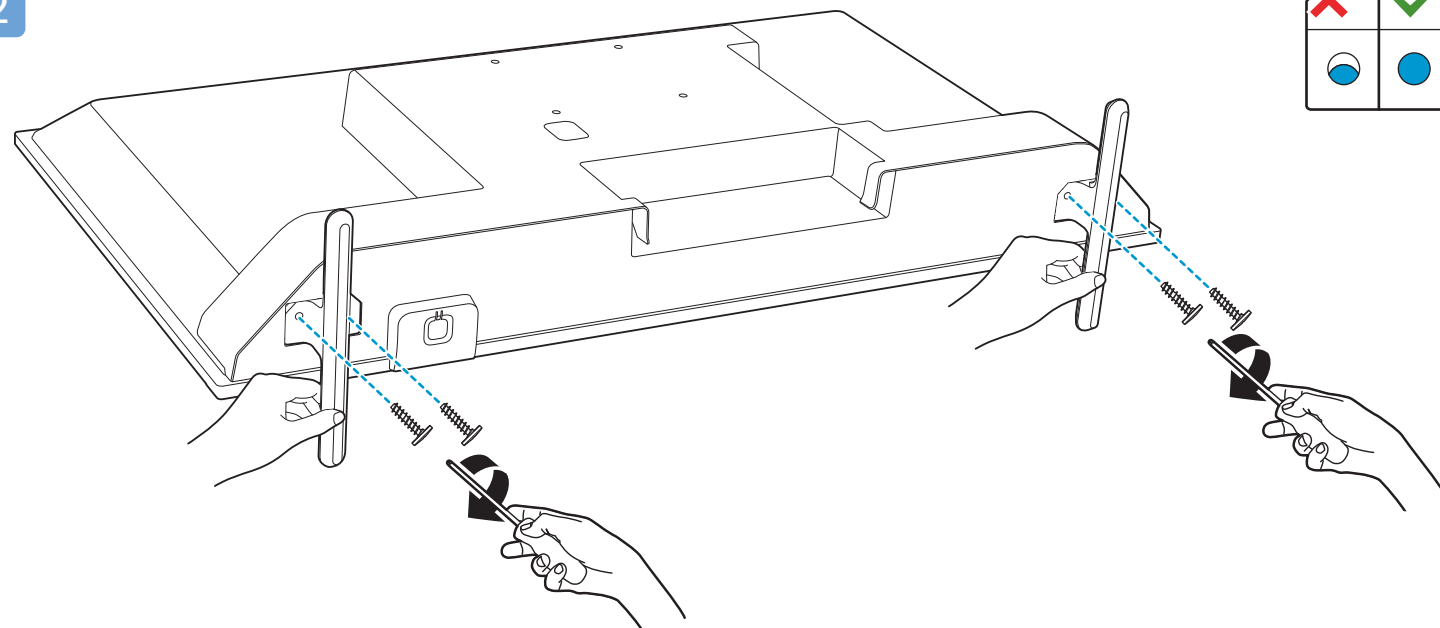

3

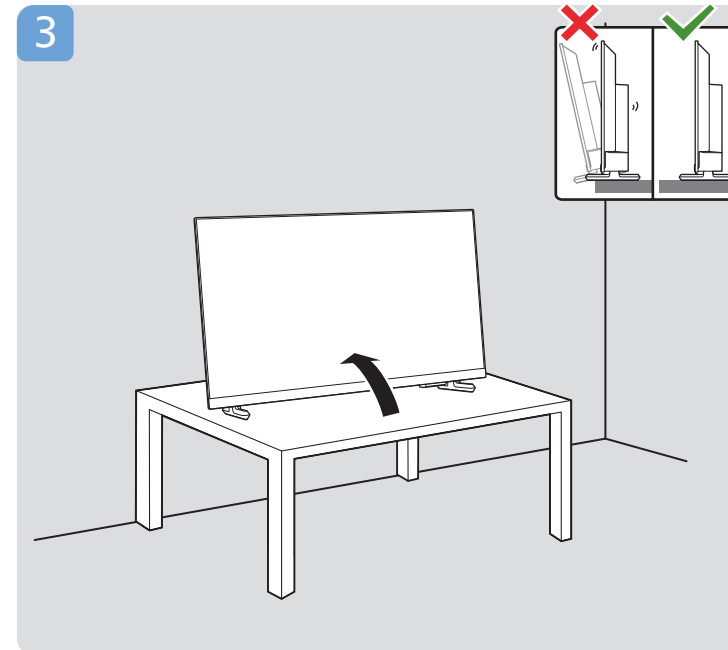

Wall Mount dimensions (x, y)



32" 100x100mm M4 (L: 8mm~10mm)



43" 100x100mm M6 (L: 8mm~10mm)

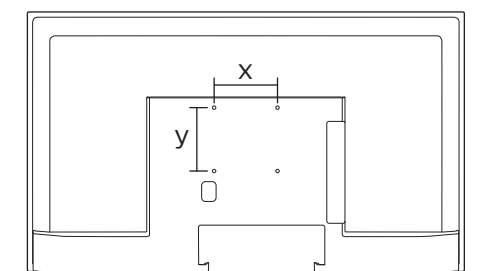



English
Türkçe

Read the safety instructions.
Güvenlik talimatlarını okuyun.

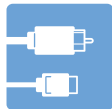
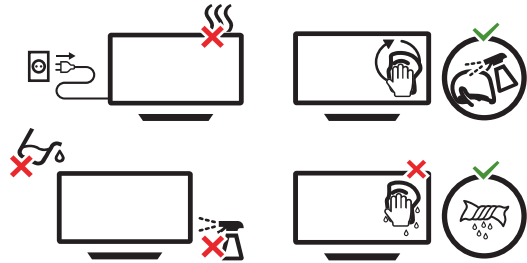

32"

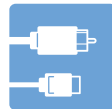
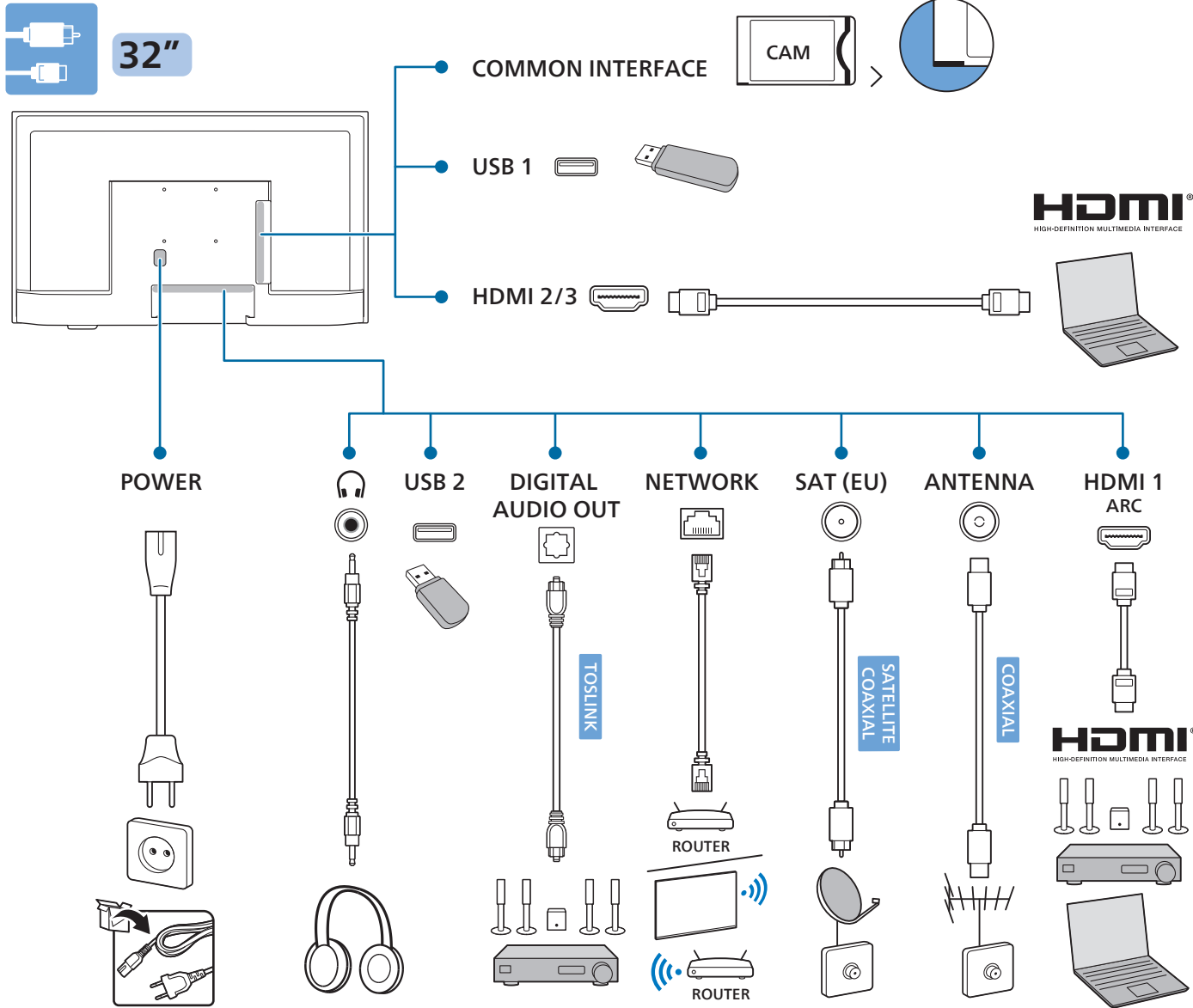

43"

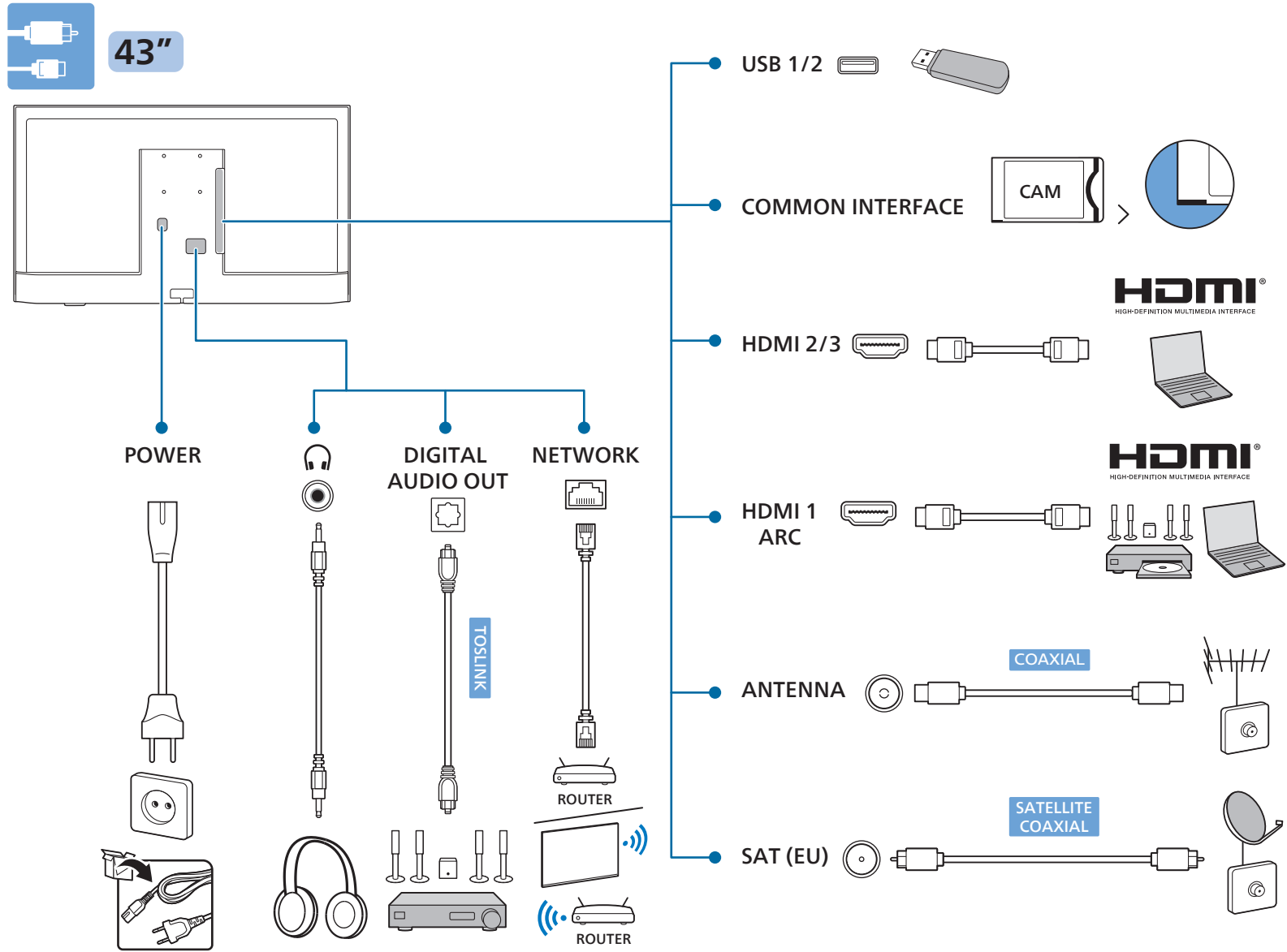

1



2

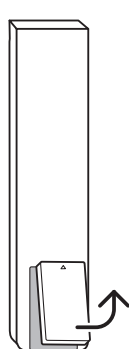

3

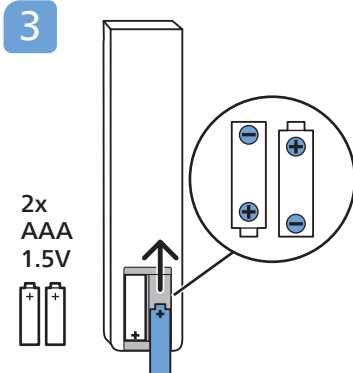

4



5

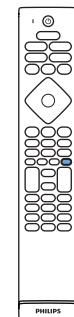

All registered and unregistered trademarks are property of their respective owners. Specifications are subject to change without notice. Philips and the Philips' shield emblem are trademarks of Koninklijke Philips N.V. and are used under license from Koninklijke Philips N.V. This product has been manufactured by and is sold under the responsibility of TP Vision Europe B.V., and TP Vision Europe B.V. is the warrantor in relation to this product. 2023 © TP Vision Europe B.V. All rights reserved. www.philips.com/welcome