

Range overview



HDL10 Penlight Professional Penlight Premium CBL10 CBL30 CBL40 CBL50



RCH6 RCH10 RCH21 RCH31UV MDLS



The Philips trademarks are used under license from Koninklijke Philips N.V.(2016)
© Lumileds Holding B.V 2016. All rights reserved
www.philips.com/automotive

3211 0082 1411

Register your product and get support at
www.philips.com/automotive

Philips LED RCH6



English	LED Inspection lamp
Dansk	LED inspektionslampe
Deutsch	LED-Inspektionslampe
Dutch	LED-inspectielamp
Français	Lampe baladeuse à LED
Italiano	Lampada di ispezione a LED
Norsk	LED-inspeksjonslampe
Polski	Lampa inspekcyjna LED
Português	Lâmpada de inspeção LED
Español	Lámpara de inspección LED
Suomi	LED-tarkastuslamppu
Svenska	Inspektionslampe med LED
Русский	Светодиодный инспекционный фонарь
中文	LED便携式工具灯
한국어	LED작업등



www.philips.com/automotive

Europe	+800 74 45 47 75
North America	+1 800 257 6054
Argentina	+54 11 4546 7777
Brazil	+80 0 979 1925
Central America, Ecuador,Venezuela	+57 1 307 8040
Chile	+56 2 730 2000
Colombia	+57 1 307 8040 01 800 011 4586
Perú	+51 1 610 6200
China	+86 21 59155104
Korea	+82 80 600 6600 +82 2 709 1200

PHILIPS

1

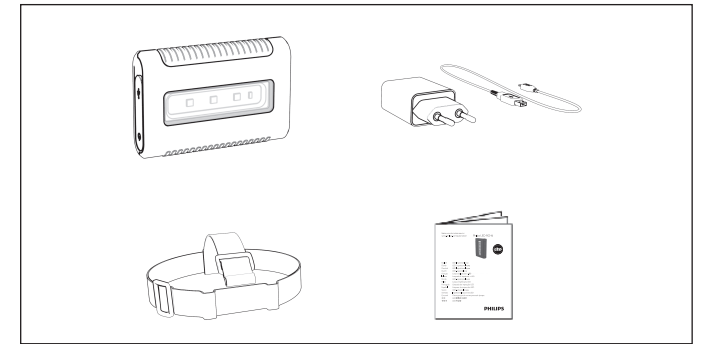

2



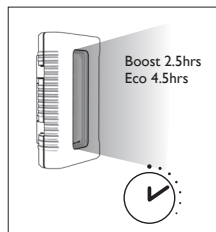
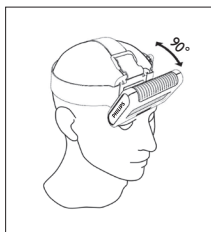
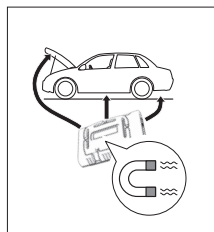
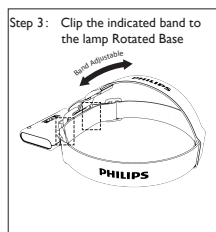
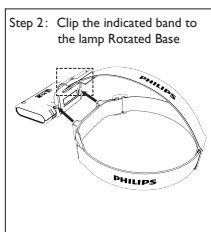
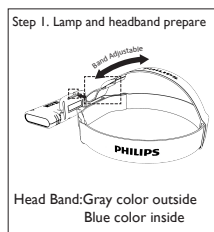
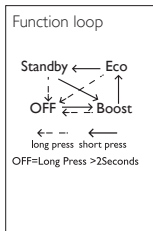
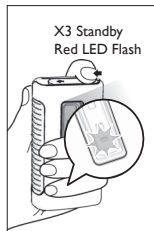
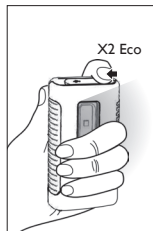
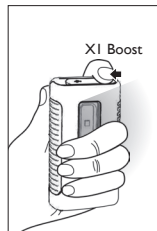
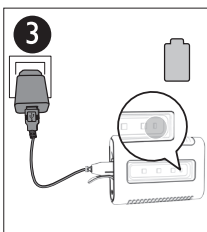
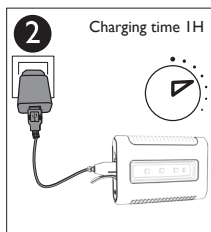
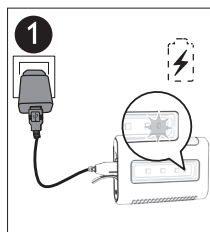
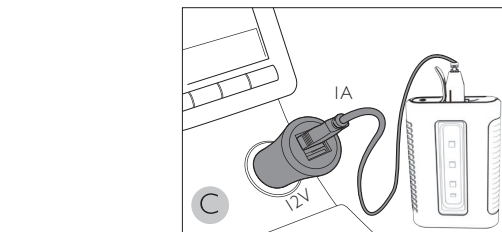
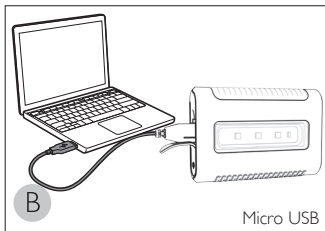
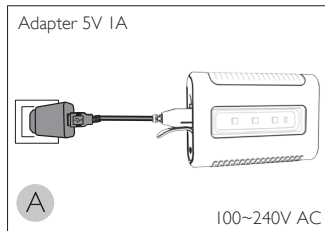
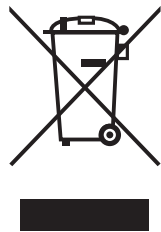
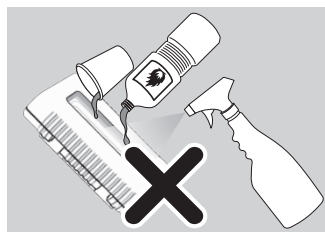
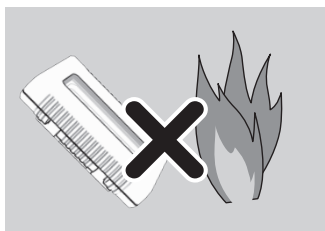
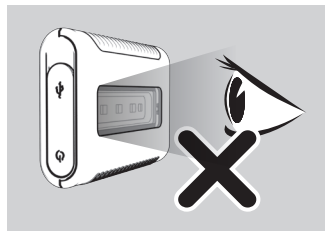

Description	
Operating line voltage	100-240V/Output 5V/1A
Charging time @25°C 60RH	1H <small>*Charge at a very low temperature such as blew 0°C, will be get a lower capacity and reduce cycle life of the battery.</small>
Light output (Lumens) @25°C 60RH (Up to)	Boost 130lm Eco 70lm
Battery performance @25°C 60RH (Up to)	Boost 2.5hrs Eco 4.5hrs
Standby	Red LED flash 10Days(Full Charged) OFF= Long press >2s
Lamp module	90°Rotating
Impact protection rating	IK07
Ingress protection rating	IP54
Operating temperature	-10°C to 50°C / -14°F to 122°F (US)
Adaptor operating temperature	0°C to 40°C / 32°F to 104°F (US)
Storage temperature	-20°C to 60°C / -4°F to 140°F (US)
Magnet	Yes
Connection	Micro USB Charging cable