

Range overview

Discover our LED Professional inspection lamps:



And also our MatchLine
LED Color Check Lamps:

MDLS

PJH20

Register your product and get support at
www.philips.com/automotive

Philips LED PJH20



English	LED Inspection lamp
Dansk	LED inspektionslampe
Deutsch	LED-Inspektionslampe
Dutch	LED-inspectielamp
Français	Lampe baladeuse à LED
Italiano	Lampada di ispezione a LED
Norsk	LED-inspeksjonslampe
Polski	Lampa inspekcyjna LED
Português	Lâmpada de inspeção LED
Español	Lámpara de inspección LED
Suomi	LED-tarkastuslamppu
Svenska	Inspektionslampe med LED
Русский	Светодиодный инспекционный фонарь
中文	LED便携式工具灯
한국어	LED작업등

PHILIPS



www.philips.com/automotive

Europe	+800 74 45 47 75
North America	+1 800 257 6054
Argentina	+54 11 4546 7777
Brazil	+80 0 979 1925
Central America, Ecuador,Venezuela	+57 1 307 8040
Chile	+56 2 730 2000
Colombia	+57 1 307 8040 01 800 011 4586
Perú	+51 1 610 6200
China	+86 21 59155104
Korea	+82 80 600 6600 +82 2 709 1200

1



2

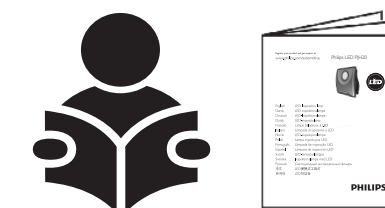

3

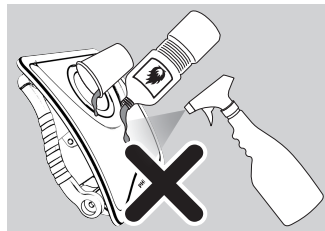
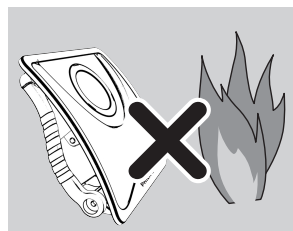
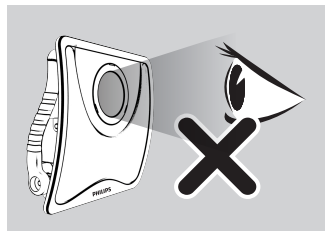

4

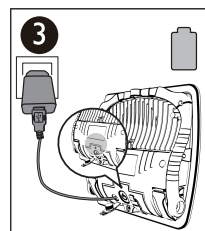
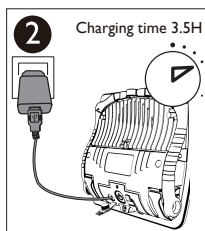
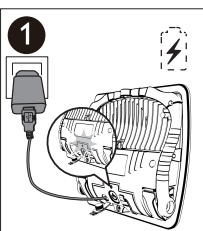
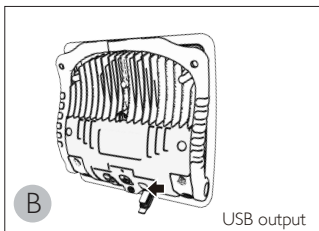
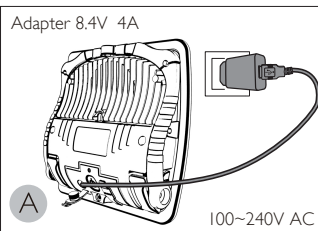

5

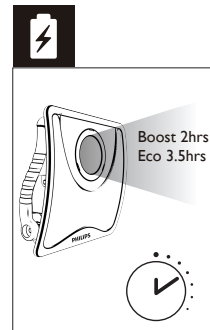
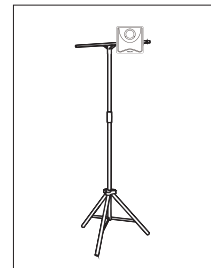
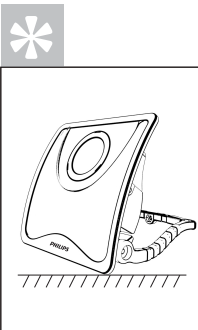
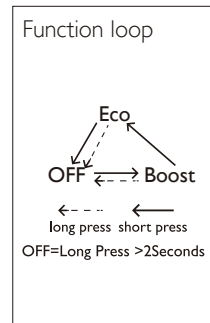
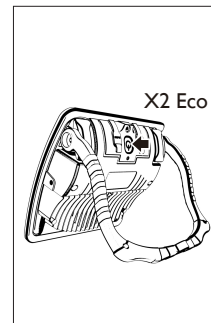
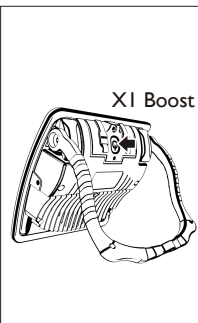

6

Description		
Operating line voltage	100-240V/Output 8.4V/4A	
Charging time @25°C 60RH	3.5H±10% <small>*Charge at a very low temperature such as blew 0°C, will be get a lower capacity and reduce cycle life of the battery.</small>	
Light output (Lumens) @25°C 60RH (Up to)	Boost 2300lm	Eco 1200lm
Battery performance @25°C 60RH (Up to)	Boost 2hrs	Eco 3.5hrs
USB output	5V/1A	
Lamp module	170°Rotating	
Impact protection rating	IK09	
Ingress protection rating	IP67	
Operating temperature	-10°C to 40°C / -14°F to 104°F (US)	
Adaptor operating temperature	0°C to 40°C / 32°F to 104°F (US)	
Storage temperature	-20°C to 30°C / -4°F to 86°F (US)	
Magnet	No	
Connection	DC Charging cable	