

Philips Shaver series 9000
and SP900
Replacement shaving heads

Precision blades*

Fits S9000 (S9xxx)

Fits S9000 Prestige (SP98xx)

SH91/53



Reset your shaver to new

Change heads every 12 months for 100% performance

Within one year, your shaver heads cut 4.5 million hairs on your face. Replace the shaver heads and get back to 100% performance.

Easy to use

- Reset your shaver very simply
- Replace the shaver heads and get back to 100% performance

Compatibility

- Compatible with S9000 and S9000 Prestige

Powerful shaver, gentle on skin

- Advanced precision for a closer shave*

PHILIPS

Replacement shaving heads
Precision blades* Fits S9000 (S9xxx), Fits S9000 Prestige (SP98xx)

Specifications

Shaving heads

- Fits product type: Shaver series 9000 (S9xxx), and S9000 Prestige (SP98xx)
- Shaving heads per packaging: 3

SH91/53

Highlights

Compatible with S9000

SH91 replacement heads are compatible with all Shavers Series 9000 (S9xxx) and S9000 Prestige (SP98xx).

Precision blades*



With up to 150.000 cutting actions per minute, the Precision blades* shave close. The 72 high-performance blades are self-sharpening and made in Europe.

Simple replacement

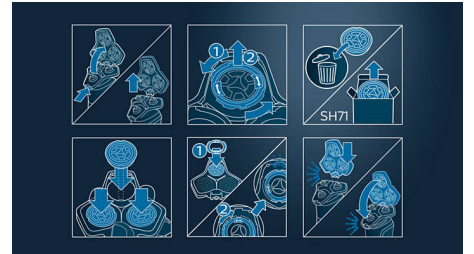

1. Press the release buttons and detach the shaving head holder.
2. Turn the retaining rings counterclockwise and remove them.
3. Remove old shaving heads and insert replacement (notches should fit exactly onto the projections).
4. Place retaining rings back and turn them clockwise until you hear a click.
5. Insert the shaving holder back and close.

Reset your shaver to new

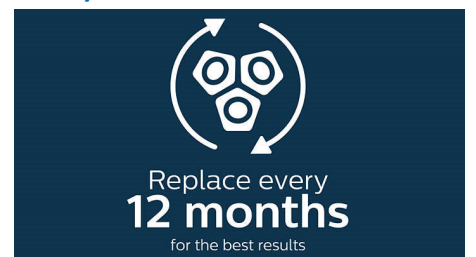

Replace the shaver heads and get back to 100% performance.



Issue date 2022-09-08

Version: 11.11.1

© 2022 Koninklijke Philips N.V.
All Rights reserved.

Specifications are subject to change without notice.
Trademarks are the property of Koninklijke Philips N.V.
or their respective owners.

www.philips.com

* versus predecessor Philips Series S9000