

PHILIPS

NORELCO

wet and dry electric
razor

TripleTrack heads

SmartPivot heads

AT920/41



TripleTrack, shaves faster

Aquatec adds power to your morning, with more minutes per charge, fully washable heads, and TripleTrack heads for a faster shave. The Aquatec seal ensures a comfortable dry shave and a refreshing wet shave.

Easy to use

- Anti-slip grip provides complete control
- Up to 60 shaving minutes, 1 hour charge
- For easy cleaning, and wet & dry use
- Perfect for trimming your sideburns and moustache

Close shaving performance

- Patented Super Lift & Cut blade raise hairs to cut closer
- Triple track heads cover 50% for more skin surface at a time

Comfort Contour Following

- Heads Pivot and Flex to follow every curve for comfort

Skin friendly

- Aquatec: refreshing wet shave with foam or an easy dry shave
- Glides smoothly over the curves of your face
- Low- friction SkinGlide for an extra smooth shave

Highlights

(Patented) Super Lift & Cut

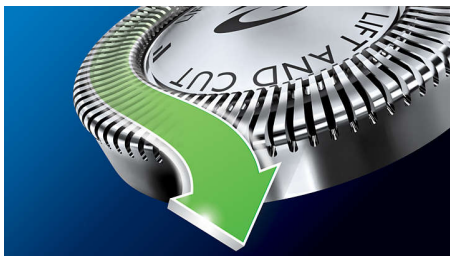

The first blade raises each hair while the second blade comfortably cuts it below skin level, for a really smooth result.

Anti-slip grip



The grip's unique, ergonomic design and anti-slip materials make it easy to shave with precision and comfort.

Aquatec wet and dry



The AquaTec seal on the Philips electric shaver makes it 100% waterproof. Use it in the shower with your favorite shaving gel or foam for extra skin comfort. Naturally you can also shave dry for convenience.

Cordless use only



An efficient, powerful lithium-ion battery gives you more shaves per charge. Charge it for an hour and you'll have up to 60 minutes of shaving time – that's around 20 shaves. The shaver automatically adjusts its power to suit the way you shave, so your actual shaving time may vary. Charge it for 3 minutes and you'll have enough power for one shave.

Skin protection system



Rounded low-friction heads adjust to the contours of your face to limit skin irritation.

SkinGlide system

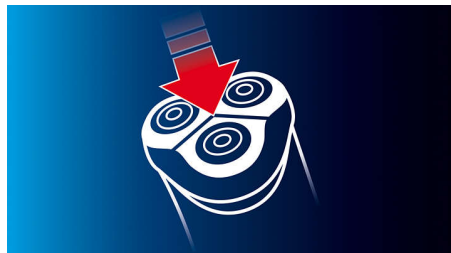

The low-friction SkinGlide shaving surface slides smoothly along your skin for a close, easy shave.

Pivoting and Flexing Heads



Flexing heads stay in close contact with your skin, while the pivoting neck adds an extra dimension of movement – all giving you a close, fast, and comfortable shave.

TripleTrack heads



TripleTrack heads with three shaving tracks cover 50% more skin surface at a time, while comfortably shaving both long hair and stubble.

Water-resistant



Simply pop the head open, and thoroughly rinse it under the tap.

Specifications

Shaving Performance

Contour following: Dynamic contour response, Pivoting and Flexing heads

Shaving system: Super Lift&Cut, TripleTrack blades

Styling: Integrated pop up trimmer

Ease of use

Display: 1 LED indication, Battery full indication, Battery low indication, Charging indication, Quick charge indication

Shaving time: Up to 21 days

Shaving minutes: 60+

Accessories

Pouch: Travel pouch

Maintenance: Cleaning brush, Protective cap

Stand: Charging stand

Service

Replacement head: Replace every yr with HQ9

