

# PHILIPS

Dry electric shaver

Shaver series 3000

Super Lift&Cut

Flexing heads

PT710



## A real close shave

The new Philips PowerTouch system adds power to your morning. Now with more minutes, full washability and proven Super Lift&Cut shaving performance, PowerTouch ensures that you are always ready to quickly finish your morning routine.

### **A comfortable and close end result**

- Super Lift & Cut system for a comfortably close shave
- Dynamic contour response adjusts to face and neck curves

### **The fastest way through your morning routine**

- Corded operation for constant power
- Washable shaver with QuickRinse system

# Highlights

# Specifications

## Efficient Power System

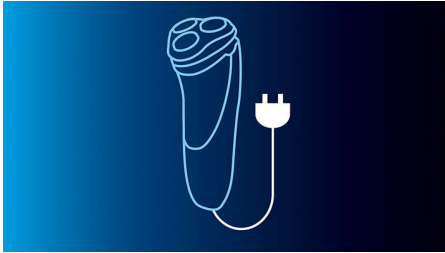

Corded operation for a reliable shave that you can always count on

## Dynamic contour response

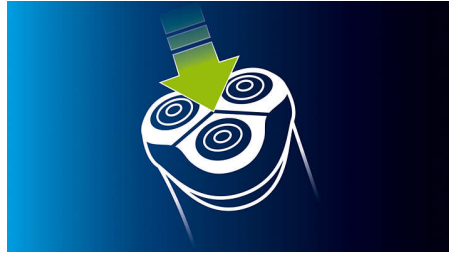

The shaver automatically adjusts to every curve of your face and neck for a smoother shave

## Super Lift&Cut Action



The dual blade system built into our electric shaver lifts hairs to cut comfortably below skin level for a closer shave

## Fully washable shaver

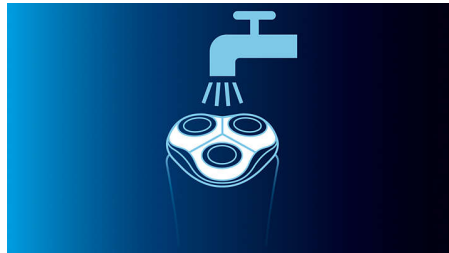

Fully washable electric shaver with QuickRinse system rinses clean in less time

## Shaving Performance

**Contour following:** Dynamic contour response  
**Shaving system:** Super Lift&Cut

## Accessories

**Maintenance:** Cleaning brush, Protective cap

## Ease of use

**Cleaning:** Fully washable shaver, Quick rinse hair chamber

**Shaving time:** Corded operation

## Design

**Handle:** Easy grip

**Color:** Arrol blue

**Finishing:** Hi gloss plastic front shell

## Power

**Automatic voltage:** 100-240 V

**Stand-by power:** < 0.2 W

**Max power consumption:** 5.4 W

## Service

**Replacement head:** HQ8 has been replaced by SH50, Replace every 2 yrs with HQ8

**2-year guarantee**

