



Philips Norelco Shaver
series 9000 SensoTouch
Shaving unit

Discontinued
Buy SH70 instead

RQ12/62

RQ12 has been replaced by SH70

Change heads every 12 months for best results

Within one year your shaver heads cut 4.5 million hairs on your face. Replace the shaver heads and get back peak performance

Easy to use

- Reset your shaver after replacing shaving heads
- Easy to replace shaving heads
- Reset your shaver to new

Compatibility

- Replacement shaving unit for SensoTouch 3D shavers

Single pass, precise shave

- Perfectly guides hairs for a close shave with V-Track blades
- Heads flex in 8 different directions for a superb result
- Lifts hairs to cut comfortably close

PHILIPS
NORELCO

Shaving unit
Discontinued Buy SH70 instead

RQ12/62

Highlights

Compatible with SensoTouch 3D



RQ12 shaving unit is compatible with SensoTouch 3D (12__X) and Arcitec (10__X) shavers.

V-Track Precision Blades

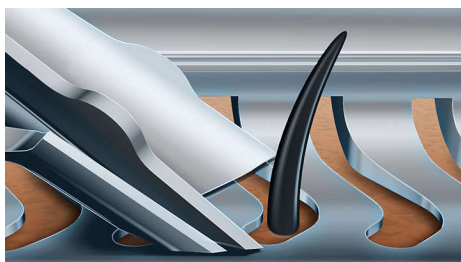

The patented V-Track Precision Blades gently position each hair in the best cutting angle, even hairs that are flat or different lengths. This allows you to cut 30% closer in less strokes leaving your skin in great condition.

8-direction ContourDetectHeads

Follow every contour of your face and neck with 8-directional ContourDetect heads. You'll catch 20% more hairs with every pass. Resulting in an extremely close, smooth shave.

Super Lift & Cut Action



Shave closer with the dual-blade Super Lift & Cut action. The first blade raises each hair while the second blade comfortably cuts below skin level, for really smooth results.

Simple replacement

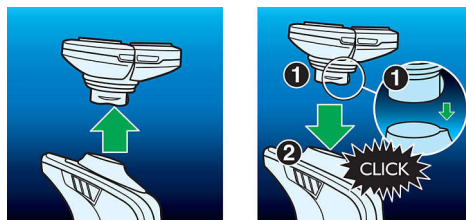

Easily renew your shaving unit using our click off, click on system.

How to reset your shaver

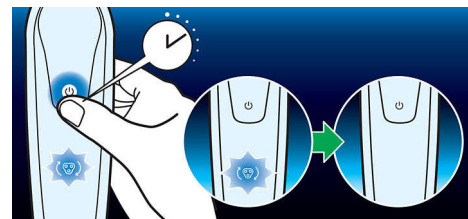

The latest Philips shavers have an inbuilt replacement reminder which will indicate you when to replace shaving heads. After replacing shaving heads, you can reset replacement trigger by pressing the on/off button for more than 5 seconds. Otherwise, replacement trigger will turn off automatically after 9 successive shaves.

Reset your shaver to new



To get back to 100% performance, replace your shaving heads every 12 months.

Specifications

Shaving heads

- Fits product type: Shaver series 8000 (12__X), Arcitec (10__X)
- Upgraded shaving heads: RQ12 has been replaced by SH70
- Important: If SH70 is also out of stock, unfortunately, there is no replacement available. SH71 is not

compatible with SensoTouch (RQ12xx) or Arcitec shavers (RQ10xx).

Accessories

- Included in pack: Retaining ring holder, Protective cap



Issue date 2023-09-21

Version: 15.15.1

UPC: 0 75020 04603 1

© 2023 Koninklijke Philips N.V.
All Rights reserved.

Specifications are subject to change without notice.
Trademarks are the property of Koninklijke Philips N.V.
or their respective owners.

www.philips.com