

# PHILIPS

## NORELCO

wet and dry electric  
razor

DualPrecision heads

SmartPivot heads

AT880/44



## Smart pivot, shaves closer

Aquatec adds power to your morning with more minutes per charge, fully washable heads and DualPrecision heads that give you a cleaner shave. The Aquatec seal ensures a comfortable dry shave and a refreshing wet shave.

### Easy to use

- Up to 50 shaving minutes, 1-hour charge
- For easy cleaning, and wet and dry use
- Perfect for trimming your sideburns and moustache

### Close shaving performance

- Patented Super Lift & Cut blade raises hairs to cut closer
- Effectively shave long hairs and short stubble

### Comfort Contour Following

- Heads Pivot and Flex to follow every curve for comfort

### Skin friendly

- Aquatec: refreshing wet shave with foam or an easy dry shave
- Glides smoothly over the curves of your face
- Low- friction SkinGlide for an extra smooth shave

# Highlights

## (Patented) Super Lift & Cut



The first blade raises each hair while the second blade comfortably cuts it below skin level, for a really smooth result.

## Aquatec wet and dry



The Aquatec seal on the Philips electric shaver makes it 100% waterproof. Use it in the shower with your favourite shaving gel or foam for extra skin comfort. Naturally you can also shave dry for convenience

## Cordless use only



An efficient, powerful lithium-ion battery gives you more shaves per charge. Charge it for an hour and you'll have up to 50 minutes of shaving time – that's around 17 shaves. Charge it for 3 minutes and you'll have enough power for one shave.

## DualPrecision heads

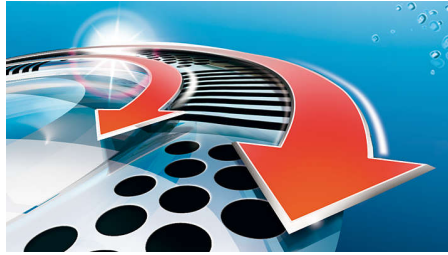

DualPrecision heads comfortably shave both long hairs and short stubble. 1. Slots cut long hairs. 2. Holes cut stubble.

## Pivoting and Flexing Heads



Flexing heads stay in close contact with your skin, while the pivoting neck adds an extra dimension of movement – all giving you a close, fast and comfortable shave.

## Pop-up trimmer

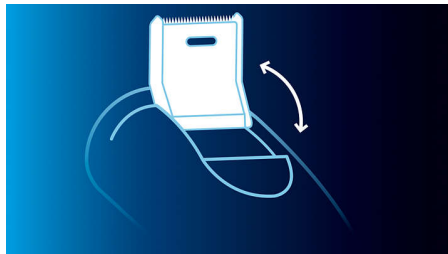

Complete your look by using the Pop-up trimmer. Perfect for maintaining a moustache and trimming sideburns.

## Skin protection system

Rounded low-friction heads adjust to the contours of your face to limit skin irritation.

## SkinGlide system

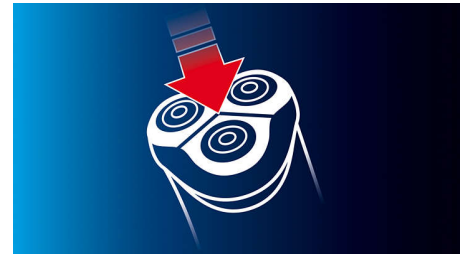

The low-friction SkinGlide shaving surface slides smoothly along your skin for a close, easy shave.

## Water-resistant



For easy cleaning, and wet and dry use

# Specifications

## Shaving Performance

**Contour following:** Dynamic contour response, SmartPivot

**Shaving system:** Super Lift and Cut, DualPrecision heads

**Styling:** Integrated pop-up trimmer

## Accessories

**Stand:** Charging stand

**Maintenance:** Cleaning brush, Protective cap

**Travel pouch**

## Ease of use

**Display:** 1 LED indication, Battery full indication, Battery low indication, Charging indication, Quick charge indication

**Shaving time:** Up to 21 days

**Shaving minutes:** 60+

## Service

**Replacement head:** HQ8 has been replaced by SH50, Replace every 2 yrs with SH50 (these have replaced HQ8)

