

PHILIPS

Dry electric shaver

Shaver series 3000

Super Lift and Cut

Flexing heads

PT715



A really close shave

The new Philips PowerTouch system adds power to your morning. Now with more minutes, full washability and proven Super Lift&Cut shaving performance, PowerTouch ensures that you are always ready to quickly finish your morning routine.

A comfortable and close end result

- Super Lift & Cut system for a comfortably close shave
- Dynamic contour response adjusts to curves in the face and neck

The fastest way through your morning routine

- Corded operation for constant power
- Washable shaver with QuickRinse system

Highlights

Efficient Power System

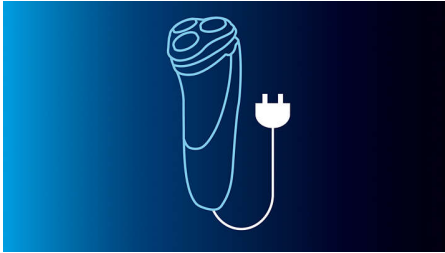

Corded operation for a reliable shave that you can always count on

Super Lift&Cut Action



The dual-blade system built into our electric shaver lifts hairs to cut comfortably below skin level for a closer shave

Dynamic contour response

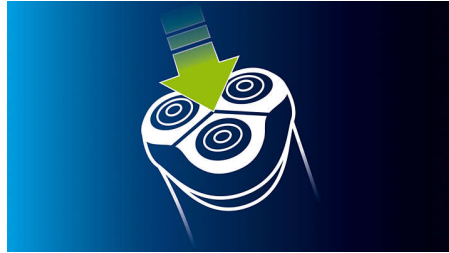

The shaver automatically adjusts to every curve of your face and neck for a smoother shave

Fully washable shaver

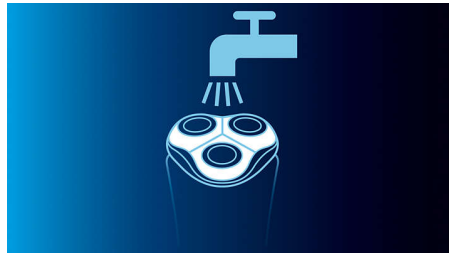

Fully washable electric shaver with QuickRinse system rinses clean in less time

Specifications

Shaving Performance

Contour following: Dynamic contour response
Shaving system: Super Lift and Cut

Accessories

Maintenance: Cleaning brush, Protective cap

Ease of use

Cleaning: Fully washable shaver, Quick rinse hair chamber

Shaving time: Corded operation

Design

Colour: Noble blue

Finishing: Hi gloss plastic front shell

Handle: Easy grip

Power

Automatic voltage: 100-240 V

Stand-by power: < 0.2 W

Max power consumption: 5.4 W

Service

Replacement head: HQ8 has been replaced by SH50, Replace every 2 yrs with SH50 (these have replaced HQ8)

2 year guarantee

