

Philips Norelco Shaver
series 9000
Replacement shaving heads

SkinProtect Blades
Fits S9000 (S9xxx)

SH91/52



Reset your shaver to new

Change heads every 2 years for 100% performance

Within one year, your shaver heads cut 4.5 million hairs on your face. Replace your shaver heads and get back to 100% performance.

Easy to use

- Reset your shaver very simply
- Replace the shaver heads and get back to 100% performance

Compatibility

- Compatible with S9000

Powerful shaver, gentle on skin

- Powerful, yet gentle performance with fewer passes

PHILIPS
NORELCO

Specifications

Shaving heads

- Fits product type: Shaver series 9000 (S9xxx)

- Shaving heads per packaging: 3

SH91/52

Highlights

Compatible with S9000

SH91 replacement heads are compatible with all Shavers Series 9000 (S9xxx). They are not compatible with the Series 9000 Prestige, which use SH98 replacement heads instead.

Simple replacement

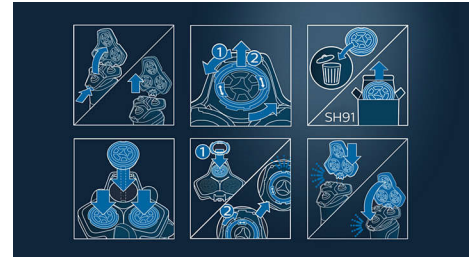

1. Press the release buttons and detach the shaving head holder.
2. Turn the retaining rings counterclockwise and remove them.
3. Remove old shaving heads and insert replacement (notches should fit exactly onto the projections).
4. Place retaining rings back and turn them clockwise until you hear a click.
5. Insert the shaving holder back and close.

Reset your shaver to new

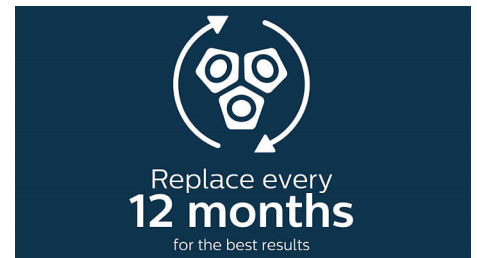

Replace the shaver heads and get back to 100% performance.

SkinProtect blades



With up to 90,000 cutting actions per minute, the SkinProtect blades deliver a close shave with fewer passes* for more comfortable skin. The 45 high-performance blades are self-sharpening for a consistent shave every time.



Issue date 2022-09-08

Version: 7.7.1

EAN: 00 07502 00987 40

© 2022 Koninklijke Philips N.V.
All Rights reserved.

Specifications are subject to change without notice.
Trademarks are the property of Koninklijke Philips N.V.
or their respective owners.

www.philips.com

* High quality Swedish steel that does not corrode