

PHILIPS

PQ217

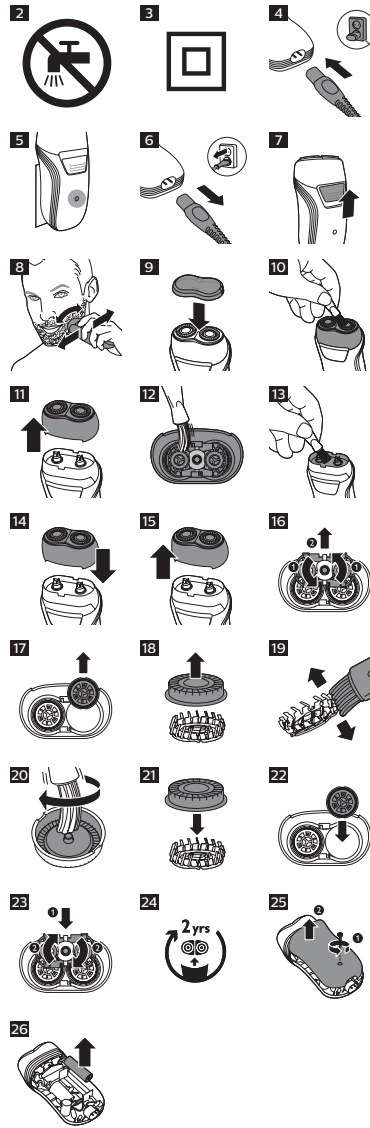
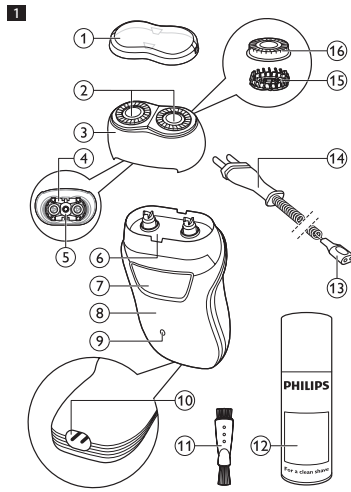

ENGLISH

Introduction

Congratulations on your purchase and welcome to Philips! To fully benefit from the support that Philips offers, register your product at www.philips.com/welcome.

General description (Fig. 1)

- 1 Protection cap
- 2 Shaving heads
- 3 Shaving unit
- 4 Retaining frame
- 5 Central spring of retaining frame
- 6 Hair chamber
- 7 On/off slide
- 8 Front panel
- 9 Charging light
- 10 Socket for small plug
- 11 Cleaning brush
- 12 Philips Cleaning Spray (Optional)
- 13 Small plug
- 14 Mains cord with plug
- 15 Cutter
- 16 Guard

Important safety information

Read this important information carefully before you use the appliance and its accessories and save it for future reference. The accessories supplied may vary for different products.

Danger

- Keep the appliance and the mains cord dry (Fig. 2).

Warning

- This symbol means that the appliance is double-insulated (Fig. 3).
- This appliance can be used by children aged from 8 years and above and persons with reduced physical, sensory or mental capabilities or lack of experience and knowledge if they have been given supervision or instruction concerning use of the appliance in a safe way and understand the hazards involved. Children shall not play with the appliance. Cleaning and user maintenance shall not be made by children without supervision.
- Always check the appliance before you use it. Do not use the appliance if it is damaged, as this may cause injury. Always replace a damaged part with one of the original type.

www.philips.com



>75% recycled paper
>75% 循环再造纸

4222.002.5451.3



Caution

- Only use this appliance for its intended purpose as shown in the user manual.
- For hygienic reasons, the appliance should only be used by one person.
- Never use compressed air, scouring pads, abrasive cleaning agents or aggressive liquids such as petrol or acetone to clean the appliance.

Electromagnetic fields (EMF)

This Philips appliance complies with all applicable standards and regulations regarding exposure to electromagnetic fields.

Charging

Make sure the shaver is switched off when you start to charge it.

When you charge the shaver for the first time or after a long period of disuse, let it charge continuously for 12 hours. Charging normally takes approx. 8 hours. Charge the appliance when the motor stops or starts running slower.

Do not leave the appliance connected to the mains for more than 24 hours.

- 1 Put the small plug in the shaver (Fig. 4).
- 2 Put the plug in the wall socket.
 - ▶ The charging light goes on to indicate that the appliance is charging (Fig. 5).
- 3 Remove the plug from the wall socket and pull the small plug out of the shaver when the battery is fully charged (Fig. 6).

Note: The shaver does not run from the mains. When the battery is empty, you have to recharge the battery before you can use the shaver again.

Note: The light of the shaver does not change color and does not go out when the shaver is fully charged.

Cordless shaving time

A fully charged shaver has a cordless shaving time of approximately 30 minutes.

Using the appliance

The shaver cannot be used directly from the mains.

- 1 Remove the protection cap.
- 2 Push the on/off slide upwards to switch on the shaver (Fig. 7).
- 3 Move the shaving heads over your skin. Make both straight and circular movements (Fig. 8).

Note: Shave on a dry face only. Do not use the shaver in combination with gel, foam or water.

Note: Your skin may need 2 or 3 weeks to get accustomed to the Philips shaving system.

- 4 Push the on/off slide downwards to switch off the shaver.
- 5 Clean the shaver after every shave (see chapter 'Cleaning and maintenance').
- 6 Put the protection cap on the shaver to prevent damage and to avoid dirt accumulation in the shaving heads (Fig. 9).

Cleaning and maintenance

Never use scouring pads, abrasive cleaning agents or aggressive liquids such as petrol or acetone to clean the appliance.

Clean the shaver after every shave to guarantee better shaving performance. For the best cleaning result, we advise you to use Philips Cleaning Spray. Ask your Philips dealer for information.

After every shave: shaving unit and hair chamber

- 1 Switch off the shaver, remove the plug from the wall socket and pull the small plug out of the shaver.
- 2 Clean the top of the appliance with the cleaning brush supplied (Fig. 10).
- 3 Pull the shaving unit straight up off the shaver (Fig. 11).
- 4 Clean the inside of the shaving unit with the cleaning brush (Fig. 12).
- 5 Clean the hair chamber with the cleaning brush (Fig. 13).
- 6 Put the shaving unit back onto the shaver (Fig. 14).

Every two months: shaving heads

Note: Do not use cleaning agents or alcohol to clean the shaving heads. Only use Philips Cleaning Spray.

- 1 Switch off the shaver, remove the plug from the wall socket and pull the small plug out of the shaver.
- 2 Pull the shaving unit straight up off the shaver (Fig. 15).
- 3 To remove the retaining frame, turn the central spring clockwise (1). Then lift the retaining frame out of the shaving unit (2) (Fig. 16).
- 4 Lift the shaving heads out of the shaving unit. Remove and clean one shaving head at a time. Each shaving head consists of a cutter and a guard (Fig. 17).

Note: Do not clean more than one cutter and guard at a time, since they are all matching sets. If you accidentally mix up the cutters and guards, it may take several weeks before optimal shaving performance is restored.

- 5 Remove the guard from the cutter (Fig. 18).
- 6 Clean the cutter with the short-bristled side of the cleaning brush. Brush carefully in the direction of the arrows (Fig. 19).
- 7 Clean the guard with the long-bristled side of the cleaning brush (Fig. 20).
- 8 Put the cutter back into the guard after cleaning (Fig. 21).
- 9 Put the shaving heads back into the shaving unit (Fig. 22).
- 10 Put the retaining frame back into the shaving unit (1), and turn the central spring anti clockwise (2) (Fig. 23).
- 11 Put the shaving unit back onto the shaver (Fig. 14).

Storage

Keep the appliance dry. Use and store the appliance at a temperature between 5°C and 35°C.

- 1 Switch off the shaver.
- 2 Put the protection cap on the shaver after use to prevent damage and to avoid dirt accumulation in the shaving heads (Fig. 10).

Replacement

Replace the shaving heads every two years for optimal shaving results. Replace damaged or worn shaving heads with Philips shaving heads only (HQ4 for China or HQ56 for the rest of the world). For instructions on how to remove the shaving heads, see chapter 'Cleaning and maintenance', section 'Every two months: shaving heads'.

Accessories

To retain the top performance of your shaver, make sure you clean it regularly and replace its shaving heads at the recommended time.

Shaving heads

- We advise you to replace your shaving heads every two years. Always replace them with Philips shaving heads only (HQ4 for China or HQ56 for the rest of the world) (Fig. 24).

Cleaning

- Use Philips Cleaning Spray to clean the shaving heads thoroughly.

Recycling

- Do not throw away the product with the normal household waste at the end of its life, but hand it in at an official collection point for recycling. By doing this, you help to preserve the environment.
- This product contains a built-in rechargeable battery which shall not be disposed of with normal household waste. Please take your product to an official collection point or a Philips service center to have a professional remove the rechargeable battery.
- Follow your country's rules for the separate collection of electrical and electronic products and rechargeable batteries. Correct disposal helps prevent negative consequences for the environment and human health.

Removing the rechargeable battery

Only remove the rechargeable battery when you discard the shaver. Before you remove the battery, make sure that the shaver is disconnected from the wall socket and that the battery is completely empty

Take any necessary safety precautions when you handle tools to open the shaver and when you dispose of the rechargeable battery.

- 1 Remove the plug from the wall socket and pull the small plug out of the shaver.
- 2 Let the shaver run until it stops, undo the screw on the back of the shaver (1) and lift the back panel off the shaver (2) (Fig. 25).
- 3 Remove the rechargeable battery (Fig. 26)

Do not connect the shaver to the mains again after you have removed the battery.

Warranty and support

If you need information or support, please visit www.philips.com/support or read the international warranty leaflet.

Warranty restrictions

The shaving heads (cutters and guards) are not covered by the terms of the international warranty because they are subject to wear.

■ Troubleshooting

This chapter summarises the most common problems you could encounter with the appliance. If you are unable to solve the problem with the information below, contact the Consumer Care Centre in your country.

Problem	Possible cause	Solution
---------	----------------	----------

The shaver does not shave as well as it used to do.	The shaving heads are dirty. You have not cleaned the shaver well enough or you have not cleaned it for a long time.	Clean the shaver thoroughly before you continue shaving. See chapter 'Cleaning and maintenance'.
---	--	--

	Long hairs obstruct the shaving heads.	Clean the cutters and guards with the cleaning brush supplied. See chapter 'Cleaning and maintenance', section 'Every two months: shaving heads'.
--	--	---

	The shaving heads are damaged or worn.	Replace the shaving heads. See chapter 'Replacement'.
--	--	---

The shaver does not work when I push the on/off slide upwards.	The battery is empty.	Recharge the battery. See chapter 'Charging'.
--	-----------------------	---

My skin is irritated after shaving.	Your skin needs time to get used to the Philips shaving system.	Skin irritation during the first 2-3 weeks of use is possible. After this period, the skin irritation usually disappears.
-------------------------------------	---	---

Problem	Possible cause	Solution
The rotation speed of the shaving heads is lower than usual.	Too much dirt has collected in the shaving heads.	Clean the shaving heads. See chapter 'Cleaning and maintenance'.

	The battery is empty	Recharge the battery. See chapter 'Charging'.
--	----------------------	---

The appliance makes a strange noise.	Too much dirt has collected in the shaving heads.	Clean the shaving heads. After cleaning, lubricate the central point on the inside of the guards with Philips Cleaning Spray. See chapter 'Cleaning and maintenance'.
--------------------------------------	---	---

	The shaving heads are damaged or worn.	Replace the shaving heads. See chapter 'Replacement'.
--	--	---

■ 简体中文

■ 簡介

恭喜您購買本產品並歡迎加入飛利浦！請於 www.philips.com/welcome 註冊您的產品，以善用飛利浦提供的支援。

■ 一般說明 (圖 1)

- 1 保護蓋
- 2 電鬚刀刀頭
- 3 電鬚刀組
- 4 固定架
- 5 固定架的中央彈簧
- 6 毛髮收集室
- 7 開/關 (On/Off) 滑動開關
- 8 正面護板
- 9 充電指示燈
- 10 小插頭插座
- 11 清潔刷
- 12 飛利浦噴霧清潔劑 (選購)
- 13 小插頭
- 14 電源線附插頭
- 15 刀具
- 16 刀網

■ 重要安全資訊

使用本產品與其配件前，請先仔細閱讀此重要資訊，並保留說明以供日後參考。提供的配件可能隨產品而異。

危險

- 請保持產品本身及電源線乾燥 (圖 2)。
- 此符號表示：禁止於自來水 (圖 2) 下清潔。

警告

- 此符號代表產品為雙重絕緣 (圖 3)。
- 本產品可供 8 歲以上兒童、身體官能或心智能力退化者，或是經驗與使用知識缺乏者使用，但需有人從旁監督或指示如何安全使用本產品，且使用者需了解使用本產品的潛在危險。請勿讓小孩把玩本產品。若無人監督，請勿讓兒童進行清潔和使用者維護。
- 使用前請務必檢查本產品。若產品受損請勿使用，以免受傷。零件如有受損，請務必以原型號更換之。

警告

- 本產品僅限用於本使用手冊所述之相關用途。
- 為保衛生起見，請勿多人共用本產品。
- 絕對不可使用壓縮空氣、鋼絲絨、磨蝕性的清潔劑或侵蝕性的液體 (例如汽油或丙酮) 清潔本產品。

電磁波 (EMF)

本 Philips 產品符合所有電磁場暴露的相關適用標準和法規。

■ 充電

開始充電之前，務必將電鬚刀的電源關閉。

當您首次為電鬚刀充電時，或長期未使用後，請讓本產品連續充電 12 小時。一般正常充電約需 8 小時。當馬達停止運轉或運轉開始緩慢時，請為產品充電。

不要讓電鬚刀連續連接電源插座超過 24 小時。

- 1 將小插頭插上電鬚刀。(圖 4)
- 2 將插頭插入電源插座。
 - ▶ 充電指示燈亮起，表示產品正在進行充電。(圖 5)
- 3 電池完全充滿後，將插頭從牆上插座拔出，並將小插頭從電鬚刀上拔出。(圖 6)

注意：電鬚刀無法插電運轉。電池耗盡時，您必須先讓電池充電，才能再度使用電鬚刀。

注意：電鬚刀充飽電力後，電鬚刀指示燈不會變色，也不會熄滅。

■ 無線刮鬚時間

電池充滿的電鬚刀可不插電刮鬚約 30 分鐘。

■ 使用本產品

電鬚刀無法直接插電使用。

- 1 卸下保護蓋。
- 2 將 On/Off 開關往上推，即可開啟電鬚刀電源。(圖 7)
- 3 將電鬚刀刀頭在皮膚上移動，請同時用直線及畫圓的方式來移動。(圖 8)

注意：僅可乾刮。使用電鬚刀時，請勿搭配凝露、泡沫或水。

注意：您的皮膚可能需要 2 到 3 週的時間才能完全適應飛利浦電鬚刀系統。

- 4 將 On/Off 開關往下推，即可關閉電鬚刀電源。
- 5 每次刮鬚後，請清潔本電鬚刀 (請參閱「清潔與維護」單元)。
- 6 為電鬚刀蓋上保護蓋以防損壞，並避免污垢累積在刀頭中。(圖 9)

■ 清潔與維護

絕對不可使用鋼絲絨、磨蝕性的清潔劑或侵蝕性的液體 (例如汽油或丙酮) 清潔本產品。

在每次刮鬚之後清潔電鬚刀，以保障更好的刮鬚效果。為達最好的清潔效果，建議您使用飛利浦噴霧清潔劑。請向您的飛利浦經銷商洽詢相關資訊。

每次刮鬚後：電鬚刀組與鬚渣室

- 1 關閉電鬚刀，從牆上插座拔離插頭，並將小插頭拔離電鬚刀。
- 2 使用隨附的清潔刷清潔產品上方。(圖 10)
- 3 從電鬚刀中垂直抽出電鬚刀組。(圖 11)
- 4 使用隨附的清潔刷清潔電鬚刀組內部。(圖 12)
- 5 使用清潔刷清潔毛髮收集室。(圖 13)
- 6 將電鬚刀組裝回電鬚刀上。(圖 14)
每兩個月：電鬚刀刀頭

注意：請勿使用清潔劑或酒精清潔電鬚刀刀頭，務必使用飛利浦噴霧清潔劑。

- 1 關閉電鬚刀，從牆上插座拔離插頭，並將小插頭拔離電鬚刀。
- 2 從電鬚刀中垂直抽出電鬚刀組。(圖 15)
- 3 若要移除固定架，請以順時針方向轉動中央彈簧 (1)。然後從電鬚刀組中拿出固定架 (2)。(圖 16)
- 4 將電鬚刀刀頭從電鬚刀組中拿出，一次取下並清洗一個刀頭。每個電鬚刀刀頭都是由刀具和刀網組成。(圖 17)

注意：因為刀具及刀網是成對的一組，請勿一次清潔超過一組。如果您不小心將刀具及刀網混在一起，可能要花幾週的時間才能恢復最理想的刮鬚效果。

- 5 取下刀具的刀網。(圖 18)
- 6 請使用清潔刷的短毛側來清潔刀具。請依箭頭方向小心刷動。(圖 19)
- 7 請使用清潔刷的長毛側來清潔刀網。(圖 20)
- 8 清潔後，將刀具放回刀網中。(圖 21)
- 9 將電鬚刀刀頭裝回電鬚刀組。(圖 22)
- 10 將固定架裝回電鬚刀組 (1)，並以逆時針方向轉動中央彈簧 (2)。(圖 23)
- 11 將電鬚刀組裝回電鬚刀上。(圖 14)

收納

請保持本產品乾燥。

請於 5° C 到 35° C 間使用並存放本產品。

- 1 請先關閉電鬚刀電源。
- 2 使用後請為電鬚刀蓋上保護蓋以防損壞，並避免污垢累積在刀頭中。(圖 9)

更換

每隔兩年更換一次電鬚刀刀頭，以確保維持最佳的刮鬚效果。
損壞或用舊的刀頭限以飛利浦電鬚刀刀頭替換 (中國為 HQ4，其他國家為 HQ56)。
有關如何取下電鬚刀刀頭的說明，請參閱「清潔與維護」單元之「每兩個月：電鬚刀刀頭」章節。

配件

若要維持電鬚刀的最佳效能，請務必定期清潔電鬚刀，並於建議的時間更換電鬚刀刀頭。

電鬚刀刀頭

- 建議您每兩年即更換電鬚刀刀頭。限以飛利浦電鬚刀刀頭替換 (中國為 HQ4，其他國家為 HQ56)。(圖 24)

清潔

- 使用飛利浦噴霧清潔劑徹底清潔電鬚刀刀頭。

單元 Unit	限制物質及其化學符號					
	鉛 (Pb)	汞 (Hg)	鎘 (Cd)	六價鉻 (Cr ^{VI})	多環芳烴 (PBB)	多環二噁英 (PBDE)
電源板 PCB	-	○	○	○	○	○
刀頭 Electrical contact pins 電源供應器 Supply unit	○	○	○	○	○	○
金屬零件 Internal metal parts	○	○	○	○	○	○

備註 1：* 超出 0.1 wt % 及 * 超出 0.01 wt % 係指限制物質之百分比含量超出百分比含量基準。
備註 2：○ 係指該項限制物質之百分比含量未超出百分比含量基準。
備註 3：- 係指該項限制物質為豁免項目。

回收

- 本產品使用壽命結束時請勿與一般家庭廢棄物一併丟棄。請將該產品放置於政府指定的回收站，此舉能為環保盡一份心力。
- 本產品包含內建充電式電池，不得與一般家用廢棄物一併丟棄。請將產品攜至政府指定的回收站或飛利浦服務中心，由專業人員取出充電式電池。
- 請按照您所在國家/地區的規定，分類與回收電子電器產品及充電式電池。正確處理廢棄物有助避免對環境和人類健康的負面影響。

取出充電電池

請僅在棄置電鬚刀前取出充電式電池。取出電池前，請確認電鬚刀已從牆上插座拔出，且電池電力已完全耗盡。

使用工具打開電鬚刀或棄置充電式電池時，請採取任何必要的安全預防措施。

- 1 將插頭自電源插座拔出，並將小插頭從電鬚刀拔下。
- 2 讓電鬚刀持續運轉直到完全停止，轉開電鬚刀背面的螺絲 (1)，然後打開電鬚刀的背面模板 (2)。(圖 25)

3 取出充電電池 (圖 26)

卸除電池後，請勿再次將電鬚刀連接至電源。

保固與支援

如需資訊或支援，請造訪：
www.philips.com/support，或參閱全球保固說明書。

保固限制

電鬚刀刀頭 (刀具和刀網) 由於其耗損性，因此不在全球保固範圍內。

故障排除

本說明概述您使用本產品時最常遇到的問題。如果您無法利用以下資訊解決您遇到的問題，請聯絡您所在國家/地區的客戶服務中心。

問題	可能原因	解決方法
電鬚刀不像平常一樣運作。	電鬚刀刀頭不潔。 電鬚刀清潔不夠徹底或是太久沒有清潔。	在您繼續刮鬚之前，請徹底清潔電鬚刀。請參閱「清潔與維護」單元。
長鬚鬚卡住電鬚刀刀頭。		請使用隨附的毛刷清潔刀具及刀網。請參閱「清潔與維護」單元之「每兩個月：電鬚刀刀頭」小節。
將 on/off 開關往上推，但電鬚刀不動。	電池電量完全耗盡。	為電池充電。請參閱「充電」單元。
刮鬚之後，皮膚感到刺痛。	您的皮膚需要一些時間才能適應飛利浦電鬚刀系統。	開始使用的第 2 到 3 週，皮膚可能有過敏現象。過了這段時間，皮膚過敏的症狀通常會消失。
刀頭的旋轉速度比平常緩慢。	過多污垢累積在刀頭中。	請清潔電鬚刀刀頭。請參閱「清潔與維護」單元。

問題	可能原因	解決方法
產品發出奇怪的噪音。	過多污垢累積在刀頭中。	請清潔電鬚刀刀頭。清潔後，請使用飛利浦噴霧清潔劑潤滑刀網內側的中心點。請參閱「清潔與維護」單元。
電鬚刀刀頭毀壞或磨損。		更換電鬚刀刀頭。請參閱「更換」單元。