



Philips PowerTouch Plus
dry electric shaver with
Pop-up trimmer

DualPrecision blades

Pivoting heads



PT870

A closer, cleaner shave

The new Philips PowerTouch system adds power to your morning. Now with more minutes, full washability and proven DualPrecision shaving performance, PowerTouch ensures that you are always ready to quickly finish your morning routine.

The fastest way through your morning routine

- 50+ minutes of cordless shaving, 1 hour charge
- Washable shaver with QuickRinse system

A comfortable and close end result

- Super Lift & Cut system for a comfortably close shave
- Dynamic contour response adjusts to curves in the face and neck
- DualPrecision cutting shaves even the shortest stubble
- SmartPivot maintains constant skin contact
- Pop-up trimmer perfect for sideburns and moustaches



PHILIPS
sense and simplicity

Highlights

Efficient Power System: 50+ min



50+ minutes of cordless power for 17 shaves. Fully charges in 1 hour so it is always ready when you are

Super Lift&Cut Action



The dual-blade system built into our electric shaver lifts hairs to cut comfortably below skin level for a closer shave

Dynamic contour response

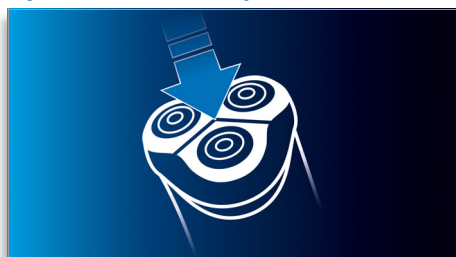

Automatically adjusts to every curve of your face and neck for a smoother shave

DualPrecision Cutting



DualPrecision shaving heads have slots to shave the normal hairs and holes to shave even the shortest stubble

Fully washable shaver

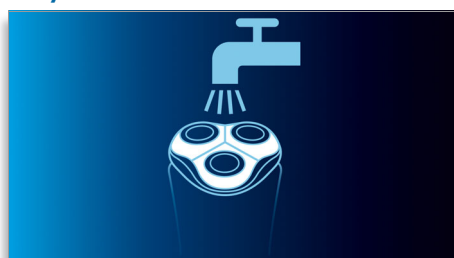

Fully washable shaver with QuickRinse system rinses clean in less time

SmartPivot



Constantly keeps the 3 shaving heads in close contact with your skin for a fast shave

Pop-up trimmer

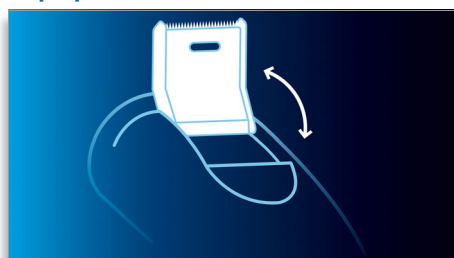

The full width, pop-up trimmer is perfect for grooming your sideburns and moustache

Specifications

Shaving Performance

- Shaving System: DualPrecision cutting, Super Lift&Cut
- Contour-following: SmartPivot, Dynamic contour response
- Styling: Integrated pop-up trimmer

Ease of use

- Shaving time: 50+ minutes
- Charging: Rechargeable, Cordless & corded operation, Quick charge 3 min for 1 shave
- Charging time: 1 hour
- Display: 2 LED indication, Charging indication, Battery low indication, Battery full indication, Quick charge indication
- Cleaning: Fully washable shaver, Quick rinse hair chamber

Design

- Handle: Easy grip, Ribbed rubber grip
- Finishing: Front Shell (lacquered), Lacquered deco ring, Mirror black display panel
- Colour: Dark metal inox

Accessories

- Maintenance: Cleaning brush, Protection cap

Power

- Battery type: Li-Ion
- Automatic voltage: 100-240 V
- Stand-by power: < 0.2 W
- Max power consumption: 5.4 W

Service

- 2-year guarantee
- Replacement head: Replace every 2 yrs with HQ8



Issue date 2012-02-25

Version: 7.1.2

© 2012 Koninklijke Philips Electronics N.V.
All Rights reserved.

Specifications are subject to change without notice.
Trademarks are the property of Koninklijke Philips Electronics N.V. or their respective owners.

www.philips.com