

PHILIPS

Shaving heads

Discontinued

Buy SH91 instead



SH90/70



Reset your shaver to new

Change heads every 2 years for the best results

Within two years your shaver heads cut 9 million hairs on your face. Replace the shaver heads and get back to 100% performance. Compatible with the Series 9000 Shaver.

Improved Version

- The easiest way to keep your shaver at its best

Easy to use

- Replace your shaving heads in just two steps
- Easy to replace heads
- Reset your shaver after replacing shaving heads
- Reset your shaver to new

Perfection in every pass

- Our best shaving system on 1–3-day beards

Highlights

Upgraded Solution



The upgraded solution makes maintaining your Philips Shaver easier than ever. This new format will allow you to install new shaving heads in just two steps, facilitating thorough cleaning of the shaver and optimising your daily shave.

Replacement reminder



The latest Philips shavers have an inbuilt replacement reminder in the form of a shaving unit symbol. This symbol will light up and indicate when to replace the shaving heads.

Simple replacement



1. Pull off the shaving head holder.
2. Replace the shaving heads with new ones.
3. Reattach the shaving head holder.
4. To reset the shaver, press and hold the on/off button for more than 5 seconds.

How to reset your shaver

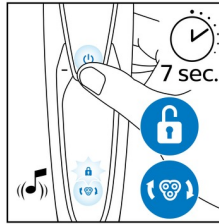

After replacing the shaving heads, you can reset the replacement reminder by pressing the on/off button for more than 7 seconds. Otherwise, the replacement trigger will turn off automatically after 9 successive shaves.

Reset your shaver to new



To get back to 100% performance, replace your shaving heads every 2 years.

V-Track Blade System PRO

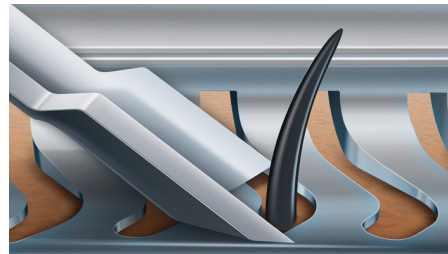

Get the perfect close shave. The V-Track Precision PRO Blades gently position each hair in the best cutting position, from 1-day to 3-day beards, including flat-lying hairs and hairs of different lengths. Cuts 30% closer* in fewer strokes, leaving your skin in great condition.

Specifications

Shaving heads

Fits product type: Shaver series 9000 (S9xxx)

