



Philips PowerTouch
dry electric shaver

Super Lift&Cut

Flexing heads

PowerTouch



PT710

A really close shave

The new Philips PowerTouch system adds power to your morning. Now with more minutes, full washability and proven Super Lift&Cut shaving performance, PowerTouch ensures that you are always ready to quickly finish your morning routine.

The fastest way through your morning routine

- Corded operation for constant power
- Washable shaver with QuickRinse system

A comfortable and close end result

- Super Lift & Cut system for a comfortably close shave
- Dynamic contour response adjusts to curves in the face and neck



PHILIPS
sense and simplicity

Dry electric shaver
Super Lift&Cut Flexing heads

Specifications

Shaving Performance

- Shaving System: Super Lift&Cut
- Contour-following: Dynamic contour response

Ease of use

- Shaving time: Corded operation
- Cleaning: Fully washable shaver, Quick rinse hair chamber

Design

- Handle: Easy grip
- Finishing: Hi gloss plastic front shell
- Colour: Arrol blue

Accessories

- Maintenance: Cleaning brush, Protection cap

Power

- Automatic voltage: 100-240 V
- Stand-by power: < 0.2 W
- Max power consumption: 5.4 W

Service

- 2-year guarantee
- Replacement head: Replace every 2 yrs with HQ8

PT710/17

Highlights

Efficient Power System

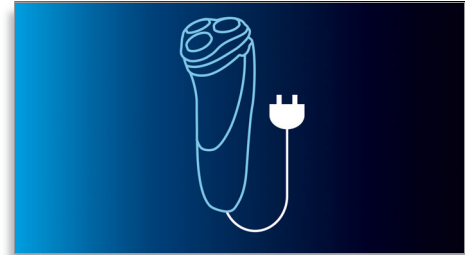

Corded operation for a reliable shave that you can always count on

Super Lift&Cut Action



The dual-blade system built into our electric shaver lifts hairs to cut comfortably below skin level for a closer shave

Dynamic contour response

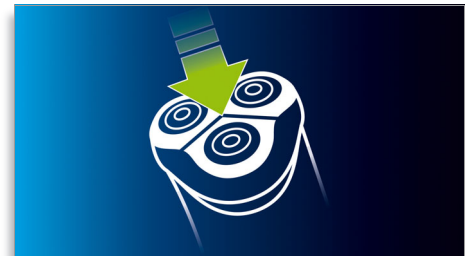

Automatically adjusts to every curve of your face and neck for a smoother shave

Fully washable shaver

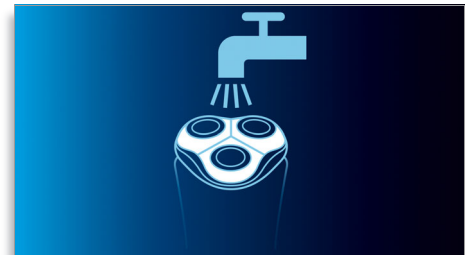

Fully washable shaver with QuickRinse system rinses clean in less time



Issue date 2011-12-29

Version: 5.2.2

© 2011 Koninklijke Philips Electronics N.V.
All Rights reserved.

Specifications are subject to change without notice.
Trademarks are the property of Koninklijke Philips
Electronics N.V. or their respective owners.

www.philips.com