

# IMPORTANT SAFETY INSTRUCTIONS

When using an electric appliance, basic safety precautions should always be followed, including the following:

Read all instructions before using this appliance.

## DANGER

To reduce the risk of electric shock:

1. Do not reach for a corded groomer that has fallen into water. Unplug immediately.
2. Power plug and the accessories connected to it are not for immersion or for use in shower.
3. Do not use an extension cord with this appliance.
4. Always unplug the groomer from the electrical outlet immediately after use, except when groomer is (re)charging.
5. Unplug and remove power supply cord from groomer before cleaning.

## WARNING

To reduce the risk of burns, fire, electric shock or injury to persons:

1. Close supervision is necessary when this appliance is used by, on, or near children or invalids.
2. Use this groomer for its intended household use as described in this manual. Do not use attachments not recommended by Philips Electronics North America Corporation.
3. Never operate this groomer if it has a damaged cord or plug, if it is not working properly, if it has been dropped, damaged, or dropped into water while plugged in. For assistance call 1-800-243-3050.
4. Keep the groomer, cord, charging plug and any attachments away from heated surfaces.
5. Never drop or insert any object into any opening.
6. Do not operate, charge, clean or plug in groomer outdoors or where aerosol (spray) products are being used or where oxygen is being administered.
7. Always check foils, cutters, cutting unit, combs and trimmers before using the groomer. Do not use the groomer if foils, cutters, cutting unit, combs or trimmers are damaged, as injury may occur.
8. Always attach plug to groomer first, then to outlet. To disconnect, turn groomer "OFF", then remove plug from outlet.
9. To prevent possible damage to the cord, do not wrap cord around the groomer.
10. Never put groomer in direct sunlight or store at a temperature above 140°F.
11. This groomer is for use on human hair only. Do not use this groomer for any other purpose.
12. Groomer is water-safe and can be rinsed under running tap water or used in the shower. Do not submerge groomer in water.
13. Only use the power plug and other accessories supplied with the appliance.

# SAVE THESE INSTRUCTIONS

**IMPORTANT: The power plug contains a transformer. Do not cut off the power plug to replace it with another plug as this will cause a hazardous condition.**

**IMPORTANT: YOUR GROOMER CONTAINS NICKEL METAL HYDRIDE RECHARGEABLE BATTERIES.**

See Battery Removal Instructions for battery disposal information.

## Features



- A Bodyroom Shaver
  - B Mini Foil Shaver
  - C Nose/Ear Hair Trimmer
  - D Precision Trimmer
  - E Full Size Metal Guard Trimmer
  - F Handle
  - G On/Off Button
  - H Turbo Button
  - I Turbo Status Indicator
  - J Battery Status Indicator
  - K Storage Pouch
  - L Small Appliance Plug
  - M Adapter
  - N Cleaning Brush
  - O Body Trimming Comb
  - P Beard and Moustache Comb
  - Q Hair Clipping Comb
- Full 2-Year Warranty  
45-Day Money-Back Guarantee

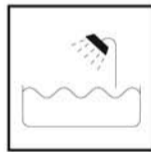

This symbol indicates that the Groomer can be used in the bath or shower.

## Registration

Congratulations on your purchase and welcome to Philips Norelco!

To fully benefit from the support that Philips Norelco offers, register your product at [www.norelco.com/register](http://www.norelco.com/register)

## Put It To The Test

Like many new products, your Philips Norelco Multigroom Pro Grooming Kit may take a little getting used to. If you are using an electric Groomer for the first time, or if you've been using a different brand, take the time to acquaint yourself with your new Grooming Kit.

Your Multigroom Pro Grooming Kit features head to toe styling with a Bodyroom shaver and powerful battery combined with all the attachments to make trimming facial hairs or hair clipping goof proof.

Throw your scissors away and put your new Multigroom Pro Grooming Kit to the test. We guarantee precise, professional results or Philips Norelco will refund you the full purchase price as long as the request is received within 45 days of purchase.

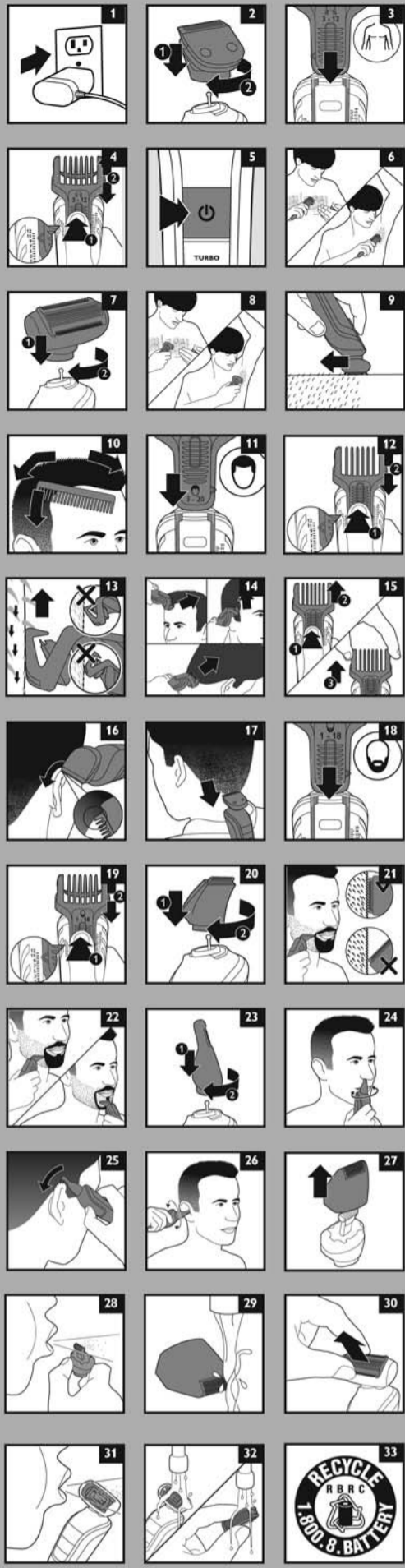

## To Charge/Recharge

- ▶ Fully charge Groomer before using for the first time or after non-use for a long period of time.
- ▶ Charging, recharging or using Groomer at temperatures below 40°F or higher than 95°F adversely affects lifespan of the battery.
- ▶ If the Groomer is subjected to a major change in temperature, pressure or humidity, let the Groomer acclimatize for 30 minutes before using.

- 1 Be certain Groomer is OFF.
- 2 Connect small plug to Groomer and plug the adapter into any 120V AC outlet (fig. 1). Use only the cord provided.
- ▶ An adaptor plug may be necessary for power cord usage in some foreign countries. Use an attachment plug adaptor of the proper configuration for the power outlet.
- 3 It will take approximately 1 hour to fully charge the Groomer for a cordless trimming time of up to 50 minutes.
- 4 The Battery Status Indicator will blink green to indicate the Groomer is charging.
- 5 If the battery runs low (approximately 10 minutes of grooming time left) the Battery Status Indicator will light up orange indicating the Groomer needs to be (re) charged.
- 6 Disconnect the cord and unplug from electrical outlet.





## Assistance

For assistance visit our website:

[www.philips.com/support](http://www.philips.com/support)  
or call toll free: 1-800-243-3050

Online information is available 24 hours a day,  
7 days a week.

## Battery Removal

- ▶ This Philips Norelco Groomer contains a rechargeable Nickel Metal Hydride batteries, which must be disposed of properly (fig. 33).
  - ▶ Batteries may only be removed when Groomer is to be discarded.
  - ▶ For assistance, visit our website: [www.philips.com/support](http://www.philips.com/support) or call toll free: 1-800-243-3050.
- 1 Unplug electrical cord from outlet and Groomer before dismantling Groomer.
  - 2 Allow the Groomer to run until the batteries are completely empty/depleted. Turn Groomer off.
  - 3 Remove any comb and/or attachment from Groomer.
  - 4 Check if there are any screws in the back or front of the appliance. If so, remove them.
  - 5 Remove the back and/or front panel of the appliance with a screwdriver. If necessary, also remove additional screws and/or parts until you see the printed circuit board with the rechargeable batteries.
  - 6 If necessary, cut the wires to separate the printed circuit board and the rechargeable batteries from the appliance.
  - 7 Do not attempt to replace batteries. Insulate battery ends by covering with tape and or place battery in a small plastic bag. Discard Groomer.
  - 8 Contact your local town or city officials for battery disposal information or call 1-800-8-BATTERY or [www.rbrc.com](http://www.rbrc.com) for drop-off locations.

## Full Two-Year Warranty

Philips Electronics North America Corporation warrants each new Philips Norelco product, Model QG3380 (except cutters, combs and foils) against defects in materials or workmanship for a period of two years from the date of purchase, and agrees to repair or replace any defective product without charge.

**IMPORTANT:** This warranty does not cover damage resulting from accident, misuse or abuse, lack of reasonable care, the affixing of any attachment not provided with the product or loss of parts or subjecting the product to any but the specific voltage.\* Use of unauthorized replacement parts will void this warranty.

**PHILIPS ELECTRONICS NORTH AMERICA CORPORATION WILL NOT PAY FOR WARRANTY SERVICE PERFORMED BY A NON-AUTHORIZED REPAIR SERVICE AND WILL NOT REIMBURSE THE CONSUMER FOR DAMAGE RESULTING FROM WARRANTY SERVICE PERFORMED BY A NON-AUTHORIZED REPAIR SERVICE.**

**NO RESPONSIBILITY IS ASSUMED FOR ANY SPECIAL, INCIDENTAL OR CONSEQUENTIAL DAMAGES.**

In order to obtain warranty service, simply go to [www.philips.com/norelco](http://www.philips.com/norelco) or call 1-800-243-3050 for assistance. It is suggested that for your protection you return shipments of product by insured mail, insurance prepaid. Damage occurring during shipment is not covered by this warranty. **NOTE:** No other warranty, written or oral, is authorized by Philips Electronics North America Corporation. This warranty gives you specific legal rights, and you may also have other rights which vary from state to state. Some states do not allow the exclusion or limitation of incidental or consequential damages, so the above exclusion and limitations may not apply to you.

\*Read enclosed instructions carefully.

Manufactured for:  
Philips Consumer Lifestyle  
A Division of Philips Electronics North America Corporation  
P.O. Box 10313, Stamford, CT 06904

 This symbol on the product's nameplate means it is listed by Underwriters' Laboratories, Inc.

Norelco is a Registered Trademark of Philips Electronics North America Corporation.

PHILIPS is a Registered Trademark of Koninklijke Philips Electronics N.V.

© 2012 Philips Electronics North America Corporation. All Rights Reserved.

PHILIPS

 **NORELCO**

Multigroom  
Pro



QG3380  
Rechargeable Cordless  
Electric Groomer



Always here to help you



4222 002 8322 1

PHILIPS

 **NORELCO**

**45-DAY MONEY-  
BACK GUARANTEE**

If you are not fully satisfied with your Philips Norelco Groomer send the product back and we'll refund you the full purchase price.

**The Groomer must be shipped prepaid by insured mail, insurance prepaid, have the original sales receipt, indicating purchase price and date of purchase, and the money-back guarantee return authorization form enclosed. We cannot be responsible for lost mail.**

**The Groomer must be postmarked no later than 45 days after the date of purchase. Philips Norelco reserves the right to verify the purchase price of the product and limit refunds not to exceed suggested retail price.**

**To obtain money-back guarantee return authorization form, call 1-800-243-3050 for assistance.**

Delivery of refund check will occur 6-8 weeks AFTER receipt of returned product.