

Register your product and get support at
www.philips.com/welcome

HP4666/15
HP4666/20



EN

User manual

PHILIPS

1

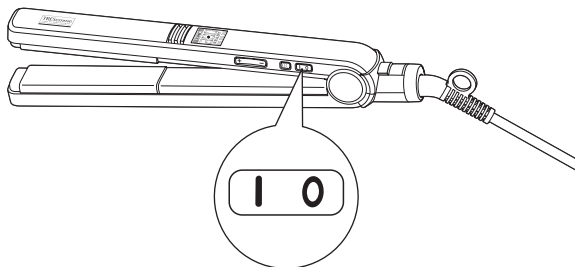

2

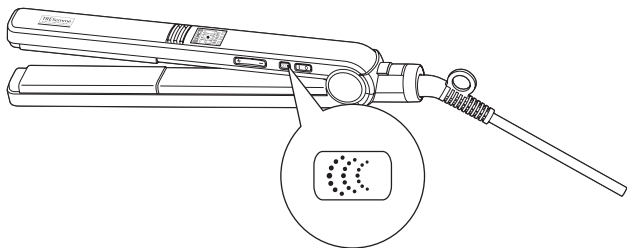

3

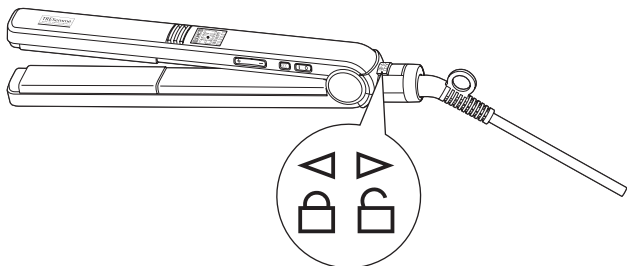

1 Important

Read this user manual carefully before you use the appliance and save it for future reference.

Warning

- Do not use this appliance near water. Do not use this appliance near bathtubs, showers, basins or other vessels containing water.
- When you use the appliance in a bathroom, unplug it after use. The proximity of water presents a risk, even when the appliance is switched off.
- During use, care should be taken to ensure that the supply cord does not come into contact with water or drape in the sink.
- Check if the voltage indicated on the appliance corresponds to the local mains voltage before you connect the appliance.
- Check the condition of the mains cord regularly. Do not use the appliance if the plug, the mains cord or the appliance itself is damaged.
- If the mains cord is damaged, you must have it replaced by Philips, a service centre authorised by Philips or similarly qualified persons in order to avoid a hazard.
- This appliance is not intended for use by persons (including children) with reduced physical, sensory or mental capabilities, or lack of experience and knowledge, unless they have been given supervision or instruction concerning use of the appliance by a person responsible for their safety.
- Children should be supervised to ensure that they do not play with the appliance.
- Keep the appliance away from non-heat-resistant surfaces and never cover the appliance with anything (e.g. a towel or clothing) when it is hot.
- Keep the appliance away from flammable items.
- Never leave the appliance unattended when it is connected to the mains.
- **Polarized plug:** This appliance has a polarized plug (one blade is wider than the other). As a safety feature, this plug fits in a polarized outlet only one way. If the plug does not fit fully in the outlet, reverse the plug. If it still does not fit, contact a qualified electrician. Do not attempt to defeat this safety feature.



Caution

- For additional protection, we advise you to install a residual current device (RCD) in the electrical circuit that supplies the bathroom. This RCD must have a rated residual operating current not higher than 30mA. Ask your installer for advice.
- The straightening plates and the plastic parts near the plates reach a high temperature quickly. Prevent the hot surfaces of the appliance from coming into contact with your skin.
- The maximum temperature occurs just after heating up. The actual temperature during use may be lower.
- Always unplug the appliance after use.
- For safety reasons, the appliance automatically switches off after having been on for 1 hour.
- Wait until the appliance has cooled down before you store it.
- Always switch off the appliance before you put it down, even if it is only for a moment.
- Do not leave the plates in your hair for more than a few seconds at a time as this may cause damage to your hair.
- Do not wind the mains cord round the appliance.
- Only use the appliance on dry hair.
- Do not use the appliance on artificial hair.

- Do not use the appliance for any other purpose than described in this manual.
- Keep the straightening plates clean and free of dust, dirt and styling products such as mousse, spray and gel. Dust, dirt and styling products may cause damage to the nano-diamond ceramic coated plates.
- The plates have a nano-diamond ceramic coating. This coating slowly wears away over time. This does not affect the performance of the appliance.
- If you use the appliance on colour-treated hair, the straightening plates may stain.
- Always let the appliance cool down before you store it.

Electromagnetic fields (EMF)

This appliance complies with all standards regarding electromagnetic fields (EMF). If handled properly and according to the instructions in this user manual, the appliance is safe to use based on scientific evidence available today.

2 Introduction

Congratulations on your purchase, and welcome to Philips! To fully benefit from the support that Philips offers, register your product at www.philips.com/welcome.



This new Philips SalonStraight Sonic straightener provides great results in less time. The professional styling temperature combined with ultrasmooth nano-diamond ceramic coated plates gives you perfect long-lasting straight results. The sonic vibrations spread the hairs evenly, giving you faster straightening results and perfect gliding. The adjustable temperature allows you to personalize the straightener to obtain optimal results to suit your hair type.

3 Straighten your hair

Straighteners are powerful styling tools and must always be used with care.

As with all straighteners that reach salon-high temperatures, do not use the appliance frequently to avoid damage to the hair. If you use the straightener incorrectly or at the wrong temperature setting you could overheat your hair or even burn it. Always make sure you select a temperature setting that is suitable for your hair type. Always select a low setting when you use the straightener for the first time.

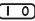
Hair Type	Temperature Setting
Coarse, curly, hard-to-straighten	Mid to High (170 °C and above)
Fine, medium-textured or softly waved	Low to Mid (160 °C and below)
Pale, blonde, bleached or colour-treated	Low (Below 160 °C)

- 1 Connect the mains plug to a mains socket.
- 2 Press and hold the  button (Fig. 1) until the light on the display is on.
 - ↳ The default temperature setting is displayed.
 - ↳ The SONIC indication turns on.
- 3 Press the  button to select a suitable temperature setting for your hair.
 - To lock the straightening plates, slide the switch downwards (Fig. 3).
 - ↳ If you lock the plates with the locking slide, the straightener heats up more quickly.
 - ↳ When the straightener heats up to the selected temperature setting, the READY indication turns on.
 - ↳ The remaining usage time of the straightener is displayed.
- 4 Comb your hair and take a section that is not wider than 2 inches for straightening.

- To unlock the straightening plates, slide the switch upwards.
- 5 Place it between the straightening plates and press the handles together:
↳ The sonic vibration starts.
 - 6 Slide the straightener down the length of the hair in a single motion (max. 5 seconds) from root to end.
 - 7 After 20 seconds, repeat step 6 until you achieve the desired look.
 - 8 To straighten the rest of your hair, repeat steps 4 to 7.

SONIC Vibration

The appliance is equipped with sonic vibration. When you switch on the appliance, the word 'SONIC' appears on the display. The vibration does not start when you switch on the appliance or when you activate the sonic vibration mode, but when you press the straightening plates together:

To activate and deactivate the sonic vibration mode, use the sonic vibration button  (Fig 2).

Note: The sonic vibration does not work when the straightening plates are locked. If the plates are locked, move the locking slide backwards to unlock the plates.

Note: When the sonic vibration is on, the plates make a rattling sound when they are only slightly in contact. This does not affect the performance of the appliance.

- To switch sonic vibration off, press the  button until the SONIC indication turns off.
- To resume sonic vibration, press the  button again.

4 Cleaning

Never immerse the appliance in water or any other liquid, nor rinse it under the tap.

- 1 Switch off the appliance and unplug it.
- 2 Let the appliance cool down completely on a heat-resistant surface.
- 3 Clean the appliance with a damp cloth.

5 Storage

Never wind the mains cord round the appliance

- 1 Switch off the appliance and unplug it.
- 2 Let the appliance cool down completely on a heat-resistant surface.
- 3 Store the appliance in a safe and dry place.
 - You can also hang it with the hanging loop.

6 Troubleshooting

This chapter summarises the most common problems you could encounter with the appliance. If problems arise with your hairdryer and you cannot solve them with the information below, please contact the nearest Philips service centre or the Philips Consumer Care Centre in your country.

The appliance does not work at all.

- Make sure that the mains socket is live.
- Make sure that the mains voltage indicated on the appliance corresponds to the local mains voltage.
- Ensure that you switch on the appliance.
- If the appliance automatically switches off, switch on the appliance again.

- If the mains cord is damaged, you must have it replaced by Philips, a service centre authorised by Philips or similarly qualified persons in order to avoid a hazard.

The sonic vibration does not work.

- Make sure that the straightening plates are pressed together.
- Press the sonic vibration button to activate the sonic vibration mode.
- Push the locking slide backwards to unlock the straightening plates.

7 Guarantee and service

If you need information or if you have a problem, please visit the Philips website at www.philips.com or contact the Philips Customer Care Centre in your country (you find its phone number in the worldwide guarantee leaflet).

FULL TWO-YEAR WARRANTY

Philips Electronics North America Corporation warrants each new Philips product, model HP4666/15/20 (except cord), against defects in materials or workmanship for a period of two years from the date of purchase, and agrees to repair or replace any defective product without charge. **IMPORTANT:** This warranty does not cover damage resulting from accident, misuse or abuse, lack of reasonable care, the affixing of any attachment not provided with the product or loss of parts or subjecting the product to any but the specified voltage.

PHILIPS ELECTRONICS NORTH AMERICA CORPORATION WILL NOT PAY FOR WARRANTY SERVICE PERFORMED BY A NON-AUTHORIZED REPAIR SERVICE AND WILL NOT REIMBURSE THE CONSUMER FOR DAMAGE RESULTING FROM WARRANTY SERVICE PERFORMED BY A NON-AUTHORIZED REPAIR SERVICE. NO RESPONSIBILITY IS ASSUMED FOR ANY SPECIAL, INCIDENTAL OR NON-CONSEQUENTIAL DAMAGES.

In order to obtain warranty service, simply go to www.philips.com or call 1-800-243-7884 for assistance. It is suggested that for your protection you return shipments of product by insured mail, insurance prepaid. Damage occurring during shipment is not covered by this warranty.

NOTE: No other warranty, written or oral, is authorized by Philips Electronics North America Corporation. This warranty gives you specific legal rights, and you may also have other rights that vary from state to state. Some states do not allow the exclusion or limitation of incidental or consequential damages, so the above exclusion and limitations may not apply to you.

Manufactured for:

Philips Domestic Appliances and Personal Care Company
A Division of Philips Electronics North America Corporation
1600 Summer Street - 5th floor Stamford, CT 06905-999



This symbol on the product's nameplate means it is listed by Underwriter's Laboratories, Inc.

PHILIPS and Philips Shield are Registered Trademarks of Koninklijke Philips Electronics NV.
©2009 Philips Electronics North America Corporation.
All rights reserved.

PHILIPS

45 - DAY MONEY-BACK GUARANTEE

If you are not fully satisfied with your Philips appliance, send the product back and we'll refund you the full purchase price.

The appliance must be shipped prepaid by insured mail, insurance prepaid, and have the original sales receipt, indicating purchase price and the date of purchase, enclosed. We cannot be responsible for lost mail.

The appliance must be postmarked no later than 45 days from the date of purchase. Philips reserves the right to verify the purchase price of the appliance and limit refunds not to exceed suggested retail price.

To obtain money-back guarantee return authorization form, call 1-800-243-7884 for assistance.



© 2009 Koninklijke Philips Electronics N.V.

All rights reserved.

3140 035 20091



100% recycled paper
100% papier recyclé