

PHILIPS **NORELCO**



S738/82

**Rechargeable Cordless
Shave Toolkit**

BC

Always here to help you

Register your product and get support at
www.norelco.com/register

Questions?
Contact
Philips
Norelco

Congratulations on your purchase and welcome to Philips Norelco!

To fully benefit from the support that Philips Norelco offers, register your product at www.norelco.com/register

IMPORTANT SAFETY INSTRUCTIONS

When using an electric appliance, basic precautions should always be followed, including the following:

Read all instructions before using this appliance.

DANGER

To reduce the risk of electric shock:

1. Do not reach for a corded appliance that has fallen into water. Unplug immediately.
2. Power plug is not for immersion or for use in shower.
3. Do not use an extension cord with this appliance.
4. Always unplug this appliance from the electrical outlet immediately after use, except when appliance is (re)charging.
5. Unplug and remove power supply cord from appliance before cleaning.

WARNING

To reduce the risk of burns, fire, electric shock, or injury to persons:

1. Close supervision is necessary when this appliance is used by, on, or near children or invalids.
2. Use this appliance for its intended household use as described in this manual. Do not use attachments not recommended by Philips Electronics North America Corporation.
3. Never operate this appliance if it has a damaged cord or charging plug, if it is not working properly, if it has been dropped or damaged, or dropped into water while plugged in. For assistance call 1-800-243-3050.
4. Keep the appliance, cord, charging plug and any attachments away from heated surfaces.

5. Never drop or insert any object into any opening.
6. Do not use the adapter in or near a power outlet that contains an electric air freshener to prevent damage to the adapter.
7. Do not charge or plug in appliance outdoors or operate where aerosol (spray) products are being used or where oxygen is being administered.
8. Do not use this appliance with a damaged or broken comb, as facial injury may occur. Always check foil, cutters and trimmer before using. Do not use appliance if foil, cutters or trimmers are damaged as injury may occur.
9. Always attach plug to appliance first, then plug into outlet. Be certain plug is inserted firmly into appliance up to mark indicated on plug. To disconnect, remove charging plug from outlet.
10. Never put the appliance in direct sunlight or store at a temperature above 140°F (60°C).
11. Keep the cord dry at all times. Do not handle with wet hands.
12. Only use the cord provided. To prevent possible damage to the cord, do not wrap cord around the appliance.
13. Only use the power plug and other accessories supplied with the appliance.

SAVE THESE INSTRUCTIONS

IMPORTANT: The power plug contains a transformer. Do not cut off the power plug to replace it with another plug, as this will cause a hazardous condition.

PHILIPS



45 - DAY MONEY-BACK GUARANTEE

To enjoy the closest and most comfortable shave from your new Philips Norelco appliance, the appliance should be used exclusively for 3 weeks. This allows your hair and skin enough time to adapt to the Philips Norelco Shaving System. If, after that period of time, you are not fully satisfied with your Philips Norelco appliance, send the product back along with dated sales receipt and we'll refund you the full purchase price. **The appliance must be shipped prepaid by insured mail, insurance prepaid, have the original sales receipt, indicating purchase price, the date of purchase, and the money-back guarantee return authorization form enclosed. We cannot be responsible for lost mail.** The appliance must be postmarked no later than 45 days from the date of purchase. Philips Norelco reserves the right to verify the purchase price of the appliance and limit refunds not to exceed suggested retail price.

To obtain money-back guarantee return authorization form, call 1-800-243-3050 for assistance. Delivery of refund check will occur 6-8 weeks AFTER receipt of refund product.

Table of Contents

Features	8-9
Introduction	10
Before First Use	10
Charging/(Re)Charging	10-11
Quick Charge	11
Skin Adaptation Period	11
Shaving	12-14
Beard Styling.....	14-16
Body Grooming.....	16-18
Cleaning.....	19-22
Replacing the Shaving Unit Razor Heads	22-23
Replacing the Bodygroom Foil	23
Storage.....	24
Assistance	24
Disposal.....	24
Accessories	25
Warranty.....	27

FEATURES

- A Protective cap
- B Shaving unit
- C Shaving unit release buttons
- D Shaving attachment
- E On/off button
- F Display
- G Adapter
- H Small plug
- I Hair length selector
- J Beard Styler attachment
- K Beard Styler comb
- L Bodygroom attachment
- M Bodygroom trimmer comb 1 (1/8 in./3mm)
- N Bodygroom trimmer comb 2 (3/16 in./5mm)
- O Bodygroom trimmer comb 3 (9/32 in./7mm)
- P Shaving head holder
- Q Comb
- R Cutter
- S Retaining ring
- T Pouch (not shown)

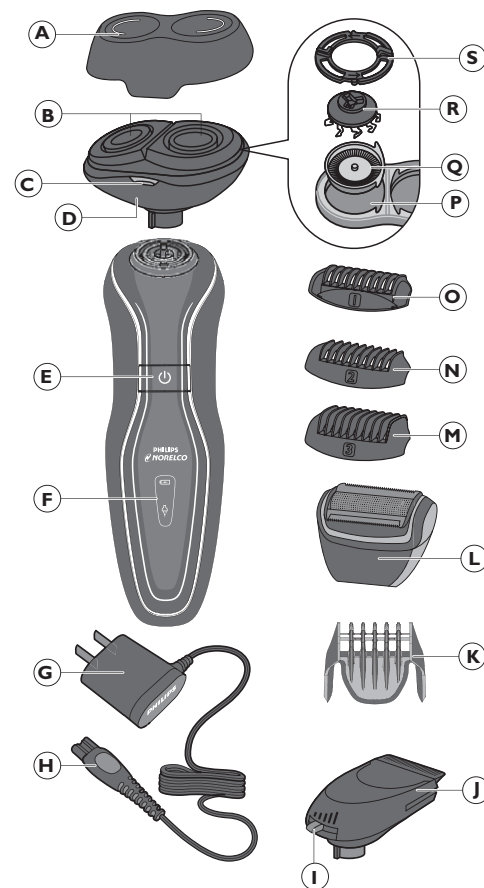

INTRODUCTION

This tool does it all, now so can you. The heads click on and off, so you can switch from facial to body grooming without breaking your shaving stride. And, if this wasn't versatile enough, use the styler head for impressively even stubble and beard trimming.

BEFORE FIRST USE

Important

- Before putting on or taking off any parts or performing any cleaning, maintenance or storage, be sure to turn appliance off, unplug from outlet and remove power cord from appliance.

CHARGING/(RE) CHARGING

- Charging or (re)charging at temperatures below 40°F (4°C) or higher than 95°F (35°C) adversely affects lifetime of batteries.
- Do not charge razor in a pouch.

1 Connect the small plug directly to the appliance and connect the charging plug into any 100V to 240V AC outlet. Use only the power cord provided.

- An adapter plug may be necessary for charging plug usage in some foreign countries. Use an attachment plug adapter of the proper configuration for the power outlet. The charging plug will automatically convert to work on 100V to 240V AC systems.
- During charging the battery symbol blinks green.

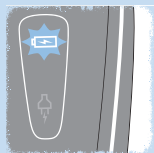

2 Charging and (re)charging requires 1 full hour for a cordless shaving time of up to 40 minutes.

Note: First time charging or charging after a long period of non-use requires 90 minutes of charge time.

- When the battery is fully charged, the battery symbol lights up green continuously. After approximately 30 minutes, the light goes out.
- When the battery is almost empty, the plug symbol blinks orange.

Tip: Depending on your shaving/styling behavior and beard type, the operating time may vary over time.

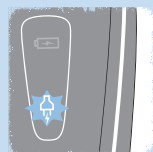
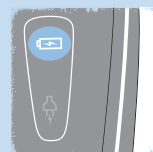

QUICK CHARGE

The quick charge is indicated by the green battery symbol and orange plug symbol blinking alternately. When the battery symbol no longer blinks orange after approximately 5 minutes, the appliance contains enough energy for a touch up.

SKIN ADAPTATION PERIOD

- At first you may not get as close a shave as you expect, or your face may even become slightly irritated. This is normal since your beard and skin will need time to adjust. Invest 3 weeks with regular shaves and you'll soon experience the full potential of your new razor.
- Stick with it! If you alternate shaving methods during the adjustment period, it may make it more difficult to adapt.

SHAVING

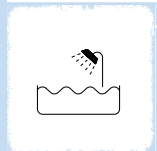

- This symbol on the appliance indicates that the appliance can be used in both the bath and shower.
- Use this appliance for its intended household use as described in this manual.



- Only use the shaving attachment to shave facial hair.

Tip: You can shave wet with shaving cream or gel or dry for convenience and quick touch-ups between shaves. Shaving with a clean face gives best results.

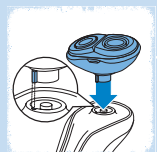

- 1 Attach shaving unit to appliance. Do not twist.

Dry Shaving

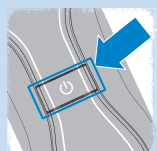

- 1 Turn appliance ON.



- 2 Gently press the shaving unit to skin. Move shaving unit using both straight and circular movements.
- 3 Turn appliance OFF.
- 4 Clean shaving unit after each shave (see 'Cleaning').

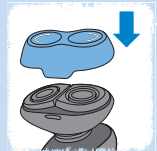

- 5 Put Protective cap on appliance.

Wet Shaving



- 1 Splash warm water on your face.



- 2 Apply shaving cream or gel to your skin.



- 3 Rinse shaving unit under water.



- 4 Turn appliance ON.

- 5 Gently press razor to skin. Move the razor in circular movements.

Tip: Rinsing the shaving unit with water before and during shaving ensures the razor heads glide smoothly over your skin, while removing residual shaving foam/gel. Gently press razor to skin for optimal results. Stretching your skin can help prevent skin irritation.

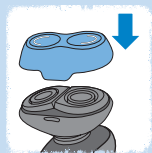

- 6** Turn appliance OFF.
- 7** Dry your face with a soft cloth.
- 8** Clean heads after each shave (see 'Cleaning').
- 9** Put Protective cap on appliance.

BEARD STYLING



- Only use the beard styler attachment to style facial hair.
- Always comb beard and/or moustache with a fine comb before trimming.



- 1** Pull the shaving attachment straight off the appliance. Do not twist.

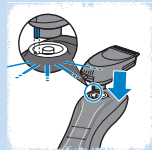

- 2** Attach beard styler to appliance.

Styling Tips

- To prevent trimming your beard and moustache too short, make sure your facial hair is dry.
- Always trim in front of a good size mirror with plenty of light. You can also try using a magnifying mirror or a 3-way mirror.
- Start trimming near one ear and trim down to your chin. Then repeat the same on your other side. This will help maintain an even trimming balance on your face.

Using Beard Styler with Comb

- Use the comb when trimming your beard.
- The length settings on the beard styler attachment correspond to the remaining hair length of your beard after cutting.
- Choose any setting between 3/64-11/64 in. (1-4.5mm).
- If you are new to trimming, use the maximum setting (11/64 in./4.5mm) to prevent accidentally trimming hairs too short.



- 1** Press the length selector (1) and push left or right (2) to select desired hair length setting.

- 2** Turn appliance ON.



- 3** Style your beard as desired always making sure the front of the comb is in full contact with the skin and move the appliance against the direction of hair growth.

Note: If cut hairs accumulate in the comb, turn the appliance off, remove comb and blow and/or shake hair out of the comb.

Tip: Try different trimming positions (i.e. upwards, downwards or across) since all hairs do not grow in the same direction. Practice for best results.

- 4** Turn appliance OFF.
- 5** Clean Beard Styler and comb after each use (see 'Cleaning').

Using Beard Styler without the Comb

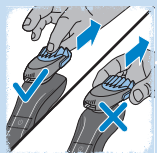

- Use the beard styler attachment without the comb to contour or cut shapes in your beard hair.

1 Remove the Beard Styler comb.

2 Turn appliance ON.

3 Contour your beard as desired.

Be careful, the styler cuts hairs very close to the skin, at a length of 3/64 in./1mm.

4 Turn appliance OFF.

5 Clean Beard Styler after each use (see 'Cleaning').



BODY GROOMING



- Only use the Bodygroom attachment to groom or trim body hair below the neckline. Do not use it to shave or trim facial or scalp hair.

Note: Before using, check foil, cutters, trimmers and combs for wear or damage. If they show signs of wear or damage, do not use. Replace immediately (see section 'Replacing the Bodygroom Foil')

1 Pull the shaving attachment straight off the appliance. Do not twist.

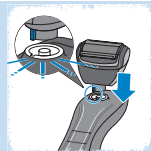

2 Attach the Bodygroom attachment. Press down firmly.

Trimming with the trimming comb

- The comb size (1,2 or 3) is indicated on the back of the comb.
- The comb size corresponds to the remaining hair length after trimming: comb 1 (1/8 in./3mm), comb 2 (3/16 in./5mm), comb 3 (9/32 in./7mm).

Note: If hair is longer than 13/32 in./ 10mm, trim first with comb 1 (1/8 in./3mm) to make grooming easier.

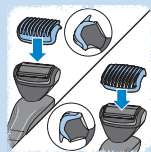

- 1** Snap the desired comb onto the appliance making sure the teeth of the comb point in the direction you will move the appliance.
- When you move the appliance towards you, the teeth must point towards you.
 - When you move the appliance away from you, the teeth must point away from you.

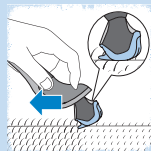

2 Turn the appliance ON.

3 Move the appliance against the direction of hair growth.

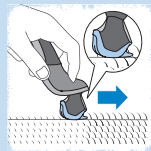

4 Make sure the flat part of the trimming comb is always in full contact with the skin.

5 Trim desired hair below the neckline.

- 6 Turn appliance OFF.
- 7 Clean the Bodygroom attachment after each use (see 'Cleaning').

Grooming

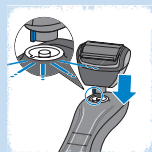

- 1 Place the bodygroom attachment on the appliance.
- 2 Turn the appliance ON.
- 3 Move the appliance against the direction of hair growth.
- 4 Make sure the bodygroomer is always in full contact with the skin.
- 5 Groom desired body parts below the neckline.
- 6 Turn appliance OFF.
- 7 Clean the bodygroom attachment after each use (see 'Cleaning').

Trimming and Grooming Tips

- For best trimming results, skin and hair should be clean and dry.
- For best body grooming results, use in the shower or bath. Apply shaving cream or gel to skin for easy gliding.
- Do not move the appliance too fast. Make smooth and gentle movements.
- Do not press too hard. Pressing too hard may cause skin irritation.
- Stretching your skin with your free hand makes the hairs stand upright and can help prevent skin irritation.

CLEANING

- Do not use abrasive cleaning agents, scourers or aggressive liquids such as gasoline to clean the appliance and attachments.
- Be careful with hot water: Always test water first so as not to burn or scald hands.
- While rinsing the appliance, water may drip out of the base of the appliance. This is normal. Simply hold appliance upright for 10-15 seconds.

Cleaning the Shaving Unit

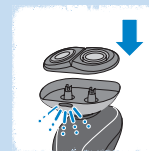
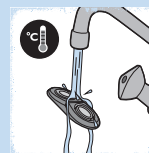
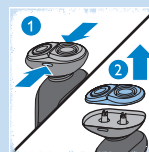

- 1 Rinse the shaving unit under hot water for a couple of minutes.
 - 2 Press the shaving unit release buttons (1) and pull shaving unit off the shaving attachment (2).
 - 3 Rinse the shaving unit for 30 seconds under hot water.
 - 4 Carefully shake off excess water and let the shaving unit air dry thoroughly.
- Never dry the shaving unit with a towel or tissue as damage may occur to the shaving heads.
- 5 Reattach the shaving unit to the shaving attachment.

Note: You can also clean the shaving attachment and shaving unit with the supplied brush.

Extra-thorough Cleaning Method



- 1** Press the shaving unit release buttons (1) and pull shaving unit off the shaving attachment (2).

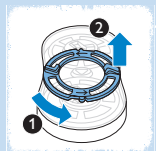

- 2** Unlock the retaining ring by turning it in the direction of the arrows (1) on the retaining ring and lift the retaining ring out of the shaving head holder (2).

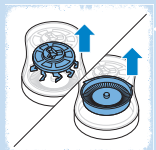

- 3** Remove the cutter and comb and separate the cutter from the comb.

Tip: Do not clean more than one cutter and comb at a time as they are matching sets. If you accidentally put a cutter in the wrong comb, it may take several weeks before optimal shaving performance is restored.

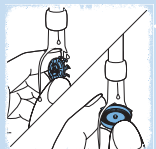

- 4** Clean the inside and outside of both the cutter and comb with the supplied brush.

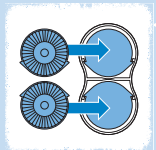

- 5** Place the comb in the shaving head holder making sure the two wings fit exactly in the recesses of the shaving head holder.

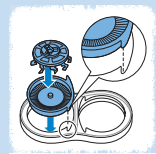

- 6** Place the cutter into the shaving head holder with the cutter legs pointing down.

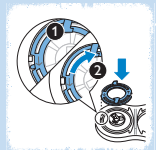

- 7** Reattach the retaining ring (1) by turning it the opposite direction of the arrows on the retaining ring (2).

Make sure the four wings of the retaining ring are located exactly under the recesses of the shaving head holder.

- 8** Reattach the shaving unit to the shaving attachment. If it does not close smoothly, check that the shaving heads and retaining rings are positioned properly.

Cleaning the Bodygroom Attachment

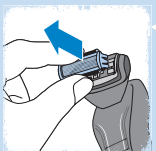

- 1** If a trimming comb is attached to the appliance, remove it.

- 2** Pull the bodygroom foil off the attachment.

Do not apply pressure to foil. Do not touch foil with hard objects as this may dent or damage foil or cutters. If damage occurs, replace damaged parts.

- 3** Rinse the bodygroom attachment, foil and combs under hot water.

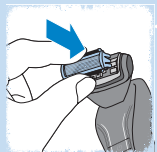

- 4 Shake off excess water and allow to air dry thoroughly.
- 5 Place bodygroom foil back on the attachment.

Cleaning the Beard Styler Attachment

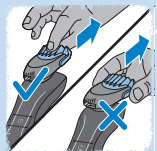

- 1 Remove the beard styler comb.



- 2 Rinse the beard styler attachment and comb under hot water.
- 3 Shake off excess water and allow to air dry thoroughly.

Tip: Lubricate the trimmer teeth with one drop of mineral oil every 6 months.

This shaver has no other user-serviceable parts.
For assistance call 1-800-243-3050.

REPLACING THE SHAVING UNIT RAZOR HEADS

- Replace the Shaving Unit razor heads every 12 months for optimal results.
- Replace with SH30 Philips Norelco razor heads only

- 1 Follow steps 1-4 under 'Extra-thorough Cleaning Method' section.

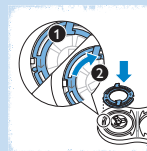

- 2 Remove the shaving heads and place new ones in the shaving head holder making sure the two wings of the shaving heads fit exactly into the recesses.
- 3 Reattach the retaining ring (1) by turning it the opposite direction of the arrows on the retaining ring (2).
Make sure the four wings of the retaining ring are located exactly under the recesses of the shaving head holder.
- 4 Reattach the shaving unit to the shaving attachment. If it does not close smoothly, check that the shaving heads and retaining rings are positioned properly.

REPLACING THE BODYGROOM FOIL

- Replace the Bodygroom foil every 12 months for optimal results.
- Replace with BG2000 Philips Norelco Bodygroom Replacement foil.

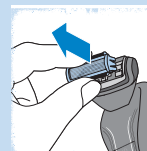

- 1 Pull the bodygroom foil off the attachment.

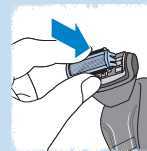

- 2 Place the new foil on the attachment and snap into place.
The foil is a precision part. Handle with care.

STORAGE

- Store appliance in a safe, dry location where it will not be crushed, banged, or subject to damage.
- Do not wrap the power cord around the appliance.
- Put the protective cap on the shaving attachment.

ASSISTANCE

- For assistance, visit our website: www.philips.com/support or call toll free 1-800-243-3050
- Online information is available 24 hours a day, 7 days a week.

DISPOSAL

- This Philips Norelco appliance contains a rechargeable Nickel Metal Hydride Battery.
- Contact your local town or city officials for battery disposal information or call 1-800-8-BATTERY or www.rbrc.com for battery drop-off locations
- For assistance, visit our website, www.philips.com/support or call toll free: 1-800-243-3050.

ACCESSORIES

- **Replacement Shaving Heads**
Model SH30 – For maximum shaving performance, replace your Philips Norelco shaver heads every 12 months.
- **Replacement Bodygroom Foil**
Model BG2000 – Philips Norelco Replacement Foil
- Philips Norelco Accessories may be purchased at a store near you, or on our website www.philips.com/store

FULL TWO YEAR WARRANTY

Philips Electronics North America Corporation warrants each new Philips Norelco Product, Model S738/82 (except cutters, combs and foil) against defects in materials or workmanship for a period of two years from the date of purchase, and agrees to repair or replace any defective product without charge.

IMPORTANT: This warranty does not cover damage resulting from accident, misuse or abuse, lack of reasonable care, the affixing of any attachment not provided with the product or loss of parts or subjecting the product to any but the specified voltage.*

NO RESPONSIBILITY IS ASSUMED FOR ANY SPECIAL, INCIDENTAL OR CONSEQUENTIAL DAMAGES.

In order to obtain warranty service, simply go to www.philips.com/norelco or call 1-800-243-3050 for assistance. It is suggested that for your protection you return shipments of product by insured mail, insurance prepaid. Damage occurring during shipment is not covered by this warranty.

NOTE: No other warranty, written or oral, is authorized by Philips Electronics North America Corporation.

This warranty gives you specific legal rights, and you may also have other rights which vary from state to state. Some states do not allow the exclusion or limitation of incidental or consequential damages, so the above exclusion and limitations may not apply to you.

* Read enclosed instructions carefully.

Manufactured for:

Philips Consumer Lifestyle

A Division of Philips Electronics North America Corporation

P.O.Box 10313, Stamford, CT 06904



This symbol on the product's nameplate means it is listed by Underwriters' Laboratories, Inc.

Norelco and Tripleheader are Registered Trademarks of Philips Electronics North America Corporation.

PHILIPS is a Registered Trademark of Koninklijke Philips N.V.

© 2015 Philips Electronics North America Corporation. All Rights Reserved.