

PHILIPS

PHILIPS

产品 : 飞利浦胡须造型器  
型号 : NT9141  
额定电压 : 1.5 V ==  
额定输入功率: 1 W  
生产日期 : 请见产品本体  
产地 : 中国广东广州

飞利浦(中国)投资有限公司  
上海市天目西路218号1602-1605  
全国顾客服务热线: 4008 800 008

本产品根据国标 GB4706.1-2005, GB4706.9-2008制造

请妥善保管本使用说明书  
发行日期: 08/01/2014



2

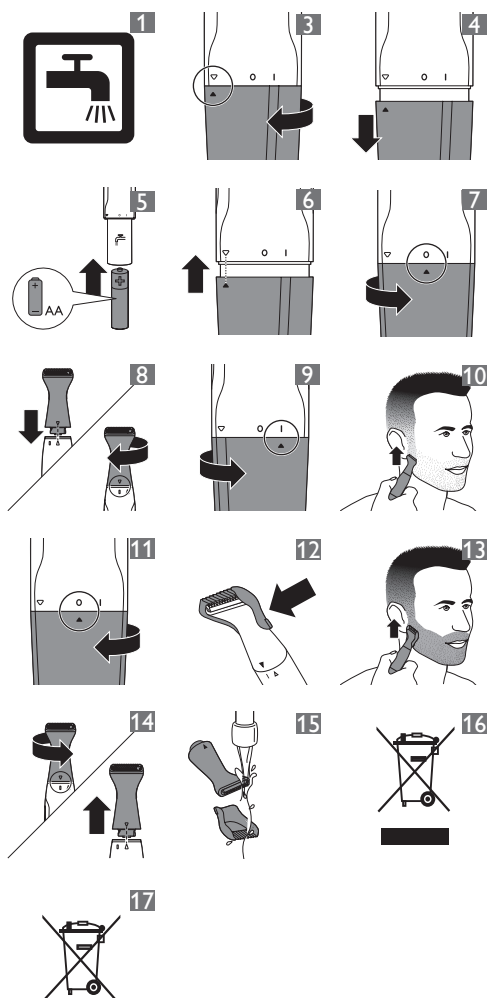
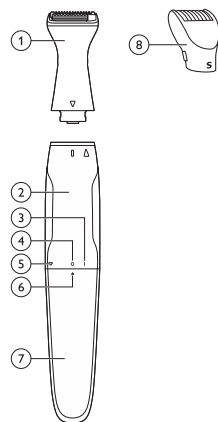

## ENGLISH

### Introduction

Congratulations on your purchase and welcome to Philips! To fully benefit from the support that Philips offers, register your product at [www.philips.com/welcome](http://www.philips.com/welcome).

### Important

Read this user manual carefully before you use the appliance and save it for future reference.

### Warning

- This appliance can be used by children aged from 8 years and above and by persons with reduced physical, sensory or mental capabilities or lack of experience and knowledge if they have been given supervision or instruction concerning use of the appliance in a safe way and if they understand the hazards involved. Children shall not play with the appliance. Cleaning and user maintenance shall not be made by children without supervision.

### Caution

- Always check the appliance before you use it. Do not use the appliance if any of its parts is damaged or broken, as this may cause injury.
- Only use this appliance for its intended purpose as shown in the user manual.
- If the appliance is subjected to a major change in temperature, pressure or humidity, let the appliance acclimatise for 30 minutes before you use it.
- For hygienic reasons, the appliance should only be used by one person.
- Be careful with hot water when you clean the appliance and the comb. Always check if the water is not too hot, to prevent your hands from getting burnt.
- Never use compressed air, scouring pads, abrasive cleaning agents or aggressive liquids such as petrol or acetone to clean the appliance.
- Only operate the appliance on one non-rechargeable 1.5V R6 AA battery.
- Use and store the appliance at a temperature between 15°C and 35°C.
- Do not expose the appliance to direct sunlight.
- Remove the battery from the appliance if you are not going to use it for some time.

### Compliance with standards

- This Philips appliance complies with all applicable standards and regulations regarding exposure to electromagnetic fields (EMF).

- This appliance complies with the internationally approved IEC safety regulations and can be safely cleaned under the tap (Fig. 1).

### General description (Fig. 2)

- 1 Precision trimming head
- 2 Handle
- 3 'On' indication
- 4 'Off' indication
- 5 'Open' indication
- 6 Setting indicator
- 7 Battery compartment cover
- 8 Short precision trimming comb (S)

### Preparing for use

#### Placing the batteries

- 1 To remove the battery compartment cover, turn it clockwise until the setting indicator points to the 'open' indication. (Fig. 3)
- 2 Pull the battery compartment cover off the handle (Fig. 4).
- 3 Put the battery in the battery compartment (Fig. 5).  
Make sure the + and - poles of the battery point in the right direction.  
*Note: The appliance runs on one R6 AA 1.5-volt battery (included). Preferably use Philips alkaline batteries. A new AA alkaline battery has an operating time of up to 2 hours.*
- 4 Slide the battery compartment cover back onto the handle. (Fig. 6)
- 5 Turn the battery compartment cover anticlockwise until the setting indicator points to the 'off' indication. (Fig. 7)

#### To avoid damage due to battery leakage:

- do not expose the appliance to direct sunlight.
- do not expose the appliance to temperatures higher than 35°C.
- remove the battery if you are not going to use the appliance for a month or more.
- do not leave an empty battery in the appliance.

### Using the appliance

When you trim your beard for the first time, be careful and test the appliance on a small part of your arm or leg. Do not move the trimmer too fast. Make smooth and gentle movements.

**If any irritation or allergic reaction occurs, discontinue use immediately. Do not use the appliance on sensitive or irritated skin.**

## Trimming with the precision trimming head

With the precision trimming head without precision trimming comb, you can trim hairs to a length of 1mm, the so-called 'stubble look'.

- Put the precision trimming head on the appliance. Align the locking indicator with the 'unlocked' indication (black upward arrowhead) and put the attachment on the handle. Then turn the attachment clockwise until the locking indicator points to the 'locked' indication (I) (Fig. 8).
- Switch on the appliance. Turn the battery compartment cover from the 'off' position (0) to the 'on' position (I) (Fig. 9).
- Touch the hairs lightly with the precision trimming head and move it against the direction of hair growth. (Fig. 10)

*Note: You can use the precision trimming head with the trimmer teeth pointing towards the skin. You can also use it with the flat part touching the skin and the teeth pointing in the direction in which you move the appliance.*

- To switch off the appliance, turn the battery compartment to the 'off' indication (0) (Fig. 11).

## Trimming with the precision trimming comb

With the precision trimming head with precision trimming comb, you can trim hairs to a length of 4mm.

- Put the precision trimming comb on the precision trimming head and push it until it locks into place ('click'). (Fig. 12)
- Switch on the appliance. Turn the battery compartment cover from the 'off' position (0) to the 'on' position (I) (Fig. 9).
- Move the appliance slowly and with light pressure against the direction of hair growth. (Fig. 13)

*Note: To make trimming easier, stretch the skin with your free hand during trimming.*

*Note: Make sure that the flat part of the comb always touches the skin to obtain an even result.*

*Note: Do not press the appliance with the comb onto the skin too hard. This may cause the appliance to trim the hairs shorter than the length indicated on the comb.*

*Note: In areas where the hair grows in different directions, move the appliance upwards, downwards and sideways.*

- Regularly remove cut hairs from the comb. If a lot of hairs have accumulated in the comb, detach the comb from the appliance and blow and/or shake the hairs out of it.
- To switch off the appliance, turn the battery compartment to the 'off' indication (0) (Fig. 11).
- To detach the comb, put your finger under the bottom edge of the comb and pull it off the appliance.

## Cleaning

Clean the appliance immediately after use and when a lot of hair or dirt has accumulated on the cutting elements.

Never use compressed air, scouring pads, abrasive cleaning agents or aggressive liquids such as petrol or acetone to clean the appliance.

Do not tap on the cutting element.

Do not use any sharp objects to clean the cutting element.

- Switch off the appliance.
- To detach the precision trimming head turn it anticlockwise until the locking indicator points to the 'unlocked' indication (black upward arrowhead). Then pull the precision trimming head off the handle (Fig. 14).
- Rinse the precision trimming head and the precision trimming comb with lukewarm water (Fig. 15).
- Let all parts dry completely before you use the appliance again.

## Ordering accessories

To buy accessories or spare parts, visit [www.shop.philips.com/service](http://www.shop.philips.com/service) or go to your Philips dealer. You can also contact the Philips Consumer Care Centre in your country (see worldwide guarantee leaflet for contact details).

## Environment

- Do not throw away the appliance with the normal household waste at the end of its life, but hand it in at an official collection point for recycling. By doing this, you help to preserve the environment (Fig. 16).

- Batteries contain substances that may pollute the environment. Remove the battery when it is empty or when you discard the appliance. Do not throw away the battery with the normal household waste, but hand it in at an official collection point (Fig. 17).

## Guarantee and support

If you need information or support, please visit the Philips website at [www.philips.com/support](http://www.philips.com/support) or read the worldwide guarantee leaflet.

## Guarantee restrictions

Cutting units are not covered by the terms of the international guarantee because they are subject to wear.

## Troubleshooting

This chapter summarises the most common problems you could encounter with the appliance. If you are unable to solve the problem with the information below, visit [www.philips.com/support](http://www.philips.com/support) for a list of frequently asked questions or contact the Consumer Care Centre in your country.

Problem	Cause	Solution
The appliance does not work as well as it should.	Hairs may be stuck in the precision trimming head.	Clean the precision trimming head (see chapter 'Cleaning').
The appliance pulls at the hairs.	You move the appliance too fast.	Do not move the appliance too fast.
	The disposable battery is empty.	Insert a new battery.
The appliance works, but the result is uneven.	You press the appliance onto the skin too hard.	Do not press the appliance onto the skin too hard, as this may cause the hair length after trimming to be shorter than the indicated hair lengths.

Problem	Cause	Solution
	The precision trimming comb is not in full contact with the skin.	When you use the comb, always make sure it is fully in contact with the skin.

Always move the appliance against the direction of hair growth. As not all hairs grow in the same direction, this means that you have to move the appliance up, down and sideways.

The appliance does not work.	The disposable battery is empty or has been inserted incorrectly.	Replace the battery or insert it correctly.
------------------------------	---	---

## 简体中文

### 简介

感谢您的惠顾，欢迎光临飞利浦！为了您能充分享受飞利浦提供的支持，请在 [www.philips.com/welcome](http://www.philips.com/welcome) 上注册您的产品。

### 注意事项

使用本产品之前，请仔细阅读本产品使用说明书，并妥善保管以备日后参考。

### 警告

- 本产品适合由 8 岁或以上年龄的儿童以及肢体不健全、感觉或精神上有障碍或缺乏相关经验和知识的人士使用，但前提是有人对他们使用本产品进行监督或指导，以确保他们安全使用，并且让他们明白相关的危害。不要让儿童在无人监督的情况下进行清洁和保养。不得让儿童玩耍本产品。不要让儿童在无人监督的情况下进行清洁和保养。

### 注意

- 使用前，请务必检查产品。一旦产品的任何部件损坏或损毁，请勿再使用产品，否则可能对人体造成伤害。

- 只能将本产品用于用户手册中所示的原定用途。
- 如果产品的使用温度、气压或湿度方面改变较大，应在使用之前让产品适应 30 分钟。
- 出于卫生的目的，本产品只能供一个人使用。
- 清洁产品和修剪梳时要小心使用热水。切记先检查水温是否过高，以防手被烫伤。
- 切勿使用压缩气体、钢丝绒、研磨性清洁剂或腐蚀性液体（例如汽油或丙酮）来清洁产品。
- 产品仅使用 1 节 1.5 伏 R6 AA 一次性电池。
- 必须在 15 摄氏度至 35 摄氏度之间的温度下使用和存放本产品。
- 切勿将产品直接曝晒于阳光下。
- 如果在一段时期内不使用本产品，请从产品中取出电池。

### 符合标准

- 本飞利浦产品符合所有有关暴露于电磁场 (EMF) 的适用标准和法规。
- 本产品符合国际认可的 IEC 安全标准，符号注释：适合用在打开的水龙头下进行清洗。(图 1)

### 基本说明 (图 2)

- 1 精细修剪刀头
- 2 手柄
- 3 “开”指示
- 4 “关”指示
- 5 “打开”指示
- 6 设置指示灯
- 7 电池仓盖
- 8 短精细修剪梳 (S)

### 使用准备

#### 安装电池

- 1** 要卸下电池仓盖，请将其顺时针旋转，直至设置指示符号指向“开”指示。(图 3)
- 2** 将电池仓盖抽离手柄。(图 4)
- 3** 将电池放入电池仓中。(图 5)  
确保电池的 + 和 - 极方向正确。

注意：本产品使用一节 R6 AA 1.5 伏电池（随附）。最好使用飞利浦碱性电池。一节新的 AA 碱性电池最多可工作 2 个小时。

- 4** 将电池仓盖滑回手柄。(图 6)
- 5** 逆时针旋转电池盒盖，直至设置指示符号指向“关”指示。(图 7)

为了防止因电池漏液而引起的损坏：

- 切勿将产品直接曝晒于阳光下。
- 切勿将产品暴露在温度高于 35 摄氏度的环境中。
- 如果您超过一个月不使用本产品，请卸掉电池。
- 切勿将电量耗尽的电池留在本产品中。

### 使用本产品

首次修剪胡须时，请先在手臂或腿上的小部位上小心试用。修剪器不要移动太快。确保轻柔流畅地移动。

如果出现刺激或过敏反应，请立即中断使用。不要在敏感的或容易受刺激的皮肤上使用本产品。

#### 使用精细修剪刀头修剪

借助不带精细修剪梳的精细修剪刀头，您可将毛发修剪至 1 毫米长，即所谓的“胡茬造型”。

- 1** 将精细修剪刀头安装在产品上。请将锁定标记与“解锁”指示（黑色上箭头）对齐，将附件安装在手柄上。然后，顺时针旋转附件，直至锁定标记指向“锁定”指示 (I)。(图 8)
- 2** 打开产品。将电池仓盖从“关”位置 (O) 转至“开”位置 (I)。(图 9)
- 3** 用精细修剪刀头轻轻触碰毛发，逆着毛发生长的方向移动。(图 10)

注意：使用精细修剪刀头时，您可以将修剪器齿朝向皮肤。您也可以将其扁平部分接触皮肤，将齿朝向您移动产品的方向。

- 4** 要关闭本产品，请将电池仓转至“关”指示 (O)。(图 11)

#### 使用精细修剪梳修剪

使用带有精细修剪梳的精细修剪刀头，您可以将毛发修剪至 4 毫米长。

- 1** 将精细修剪梳安装在精细修剪刀头上并推动，直至其锁定到位（可听到“咔哒”一声）。(图 12)
- 2** 打开产品。将电池仓盖从“关”位置 (O) 转至“开”位置 (I)。(图 9)
- 3** 逆着毛发生长的方向缓慢移动产品，轻轻施加压力。(图 13)

注意：为了让修剪更轻松，请在修剪过程中用另外一只空着的手拉紧您的皮肤。

注意：确保修剪梳的扁平部分始终接触皮肤，以获得均匀的修剪效果。

注意：请不要将带修剪梳的产品过于用力地按在皮肤上，因为这样可能会导致产品修剪的毛发长度比修剪梳上的长度指示要短。

注意：在毛发朝着不同方向生长的地方，请向上、向下、向两侧移动产品。

- 4** 定期清除修剪梳上的残留毛发。如果修剪梳中积聚了很多毛发，将其从产品上卸下，将毛发吹出和/或甩出。
- 5** 要关闭本产品，请将电池仓转至“关”指示 (O)。(图 11)
- 6** 要拆卸修剪梳，请将手指放在修剪梳底边下方，将其从产品中拉出。

### 清洁

使用之后，以及在修剪部件上积聚了太多毛发或污垢的时候，请立即清洁本产品。

切勿使用压缩气体、钢丝绒、研磨性清洁剂或腐蚀性液体（例如汽油或丙酮）来清洁产品。

切勿触碰修剪部件。

不可使用任何尖利的物体来清洁修剪部件。

- 1** 关闭产品。
- 2** 要拆卸精细修剪刀头，请将其逆时针旋转，直至锁定指示指向“解锁”指示（黑色上箭头）。然后将精细修剪刀头从手柄中拉出。(图 14)
- 3** 用温水冲洗精细修剪刀头和精细修剪梳。(图 15)
- 4** 再次使用产品之前，让所有部分完全干燥。

### 订购附件

要购买附件和备件，请访问 [www.shop.philips.com/service](http://www.shop.philips.com/service) 或联系您的飞利浦经销商。您也可以联系您所在国家/地区的飞利浦客户服务中心（联系详情，请参阅全球保修卡）。

### 环保

- 弃置产品时，请不要将其与一般生活垃圾堆放在一起；应将其交给官方指定的回收点。这样做有利于环保。(图 16)
- 电池包含可能污染环境的物质。当电池电量耗尽或丢弃本产品时请取出电池。请勿将电池与普通家庭垃圾一同丢弃，而应将其送到官方的回收点。(图 17)

### 保修和支持

如果您需要信息或支持，请访问飞利浦网站 [www.philips.com/support](http://www.philips.com/support) 或阅读全球保修卡。

### 保修条款

修剪部件不在国际保修条款的涵盖范围之内，因为修剪部件属于易磨损物品。

### 故障种类和处理方法

本章归纳了使用本产品时最常见的一些问题。如果您无法根据以下信息解决问题，请访问 [www.philips.com/support](http://www.philips.com/support) 查阅常见问题列表，或联系您所在国家/地区的客户服务中心。

问题	原因	解决方法
产品无法正常工作。	精细修剪刀头中可能有毛发。	清洁精细修剪刀头（参阅“清洁”一章）。
产品拉拔毛发。	产品移动过快。	移动本产品时速度不要太快。
	一次性电池的电量已耗尽。	插入新电池。
产品可以工作但修剪不齐。	您将产品过于用力地按在皮肤上了。	请勿将产品过于用力地按在皮肤上，这样可能会导致修剪后的毛发长度比所指示的短。
	精细修剪梳未完全接触皮肤。	使用修剪梳时，请务必确保其与皮肤完全接触。
		始终逆着毛发生长的方向移动产品。由于并非所有头发都朝一个方向生长，这意味着您必须朝上下及两侧方向移动产品。
产品不能工作。	一次性电池的电量已耗尽或安装不正确。	更换电池或正确安装。