

PHILIPS

NORELCO

BT5210



BC



>75% recycled paper
>75% papier recyclé

Manufactured for: Philips Personal Health
a division of Philips North America LLC
P.O. Box 10313, Stamford, CT 06904, USA

 This symbol on the product's nameplate means it is listed by Underwriters' Laboratories, Inc.

Norelco is a registered trademark of Philips North America LLC.

PHILIPS and Philips shield are registered trademarks of Koninklijke Philips N.V.

©2019 Philips North America LLC. All rights reserved.

4222.002.8596.3 (5/8/2019)

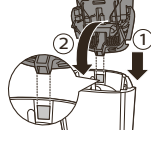
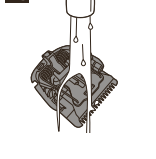
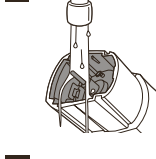
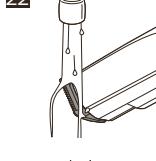
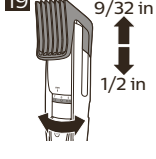
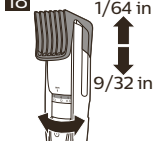
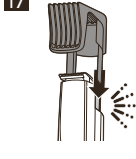
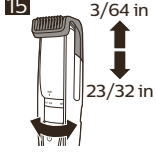
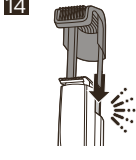
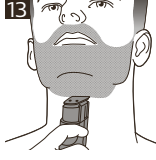
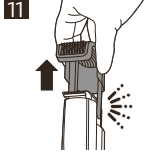
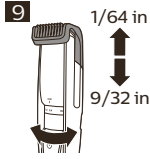
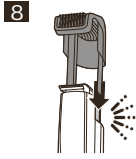
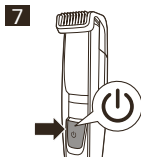
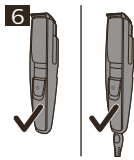
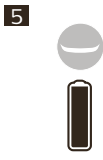
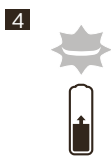
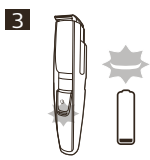
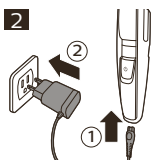

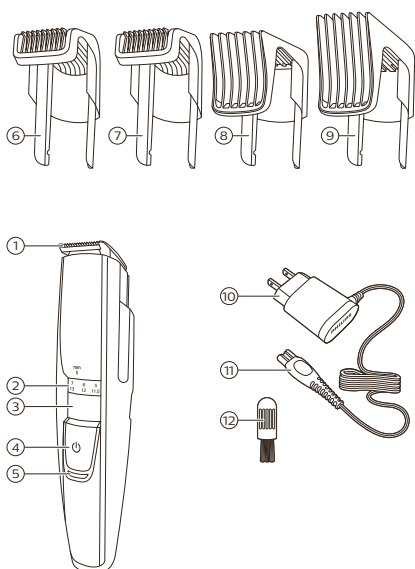

English

IMPORTANT SAFETY INSTRUCTIONS

When using an electric product, basic precautions should always be followed, including the following:

Read all instructions before using this product.

DANGER

To reduce the risk of electric shock:

- Do not reach for a corded product that has fallen into water. Unplug immediately from the power outlet.
- Use product only in dry condition. Do not use while bathing or in a shower.
- Do not place or store the product where it can fall or be pulled into a tub or sink. Do not place or drop the product into water or other liquid.
- Except when charging, always unplug this product from the power outlet immediately after use.
- Remove power cord from power outlet and product before cleaning.

WARNING

To reduce the risk of burns, fire, electric shock, or injury to persons:

- Close supervision is required when this product is used by, on, or near children, or persons with limited physical, sensory, or mental capabilities or invalids.
- Use this product only for its intended household use as described in this manual. Do not use attachments not recommended by Philips North America LLC.
- Never operate this product if it has a damaged power cord, if it is not working properly, after it has been dropped or damaged, or after the product or power cord has been dropped into water. For assistance call 1-800-243-3050.
- Keep the power cord away from heated surfaces.
- Never drop or insert any object into any opening.
- Do not use the power cord in or near a power outlet that contains an electric air freshener to prevent damage to the power cord.
- Do not use product outdoors or operate where aerosol (spray) products are being used or where oxygen is being administered.
- Always check cutters, cutting unit and guards before using the product. Do not use the product if cutters, cutting unit or guards are damaged, as injury may occur.
- Always attach power cord to product first, then to power outlet. To disconnect, set all controls to 'off' position. Then remove power cord from power outlet.
- Plug power cord directly into power outlet. Do not use an extension cord.
- Unplug power cord before plugging in or unplugging the product.

- Only use the power cord and other accessories supplied with the product.
- Do not attempt to open the product to remove or replace the built-in rechargeable battery.
- The batteries used in this product may present a fire or chemical burn hazard if mistreated. Do not disassemble, heat above 100 °C (212 °F) or incinerate.

IMPORTANT: The power plug contains a transformer. Do not cut off the power plug to replace it with another plug as this will cause a hazardous condition.

SAVE THESE INSTRUCTIONS

Introduction

Congratulations on your purchase and welcome to Philips Norelco!

To fully benefit from the support that Philips Norelco offers, register your product at **www.norelco.com/register**.

General description (Fig. 1)

- 1 Trimming head
- 2 Two-level length settings
- 3 Zoom wheel
- 4 On/off button
- 5 Battery charge indicator
- 6 Beard and stubble guard (1/64-9/32 in, 0.4-7 mm)
- 7 Body guard (3/64-23/32 in, 1-18 mm)
- 8 Short hair guard (1/64-9/32 in, 0.4-7 mm)
- 9 Long hair guard (9/32-1/2 in, 7-13 mm)
- 10 Power plug
- 11 Small plug
- 12 Cleaning brush

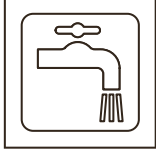

This symbol indicates that the product can be rinsed under running tap water.

Charging

Charge the product before first use and when the display indicates that the battery is almost empty.

Charging takes approx. 1 hour.

After 1 hour of charging the product has a cordless operating time of up to 70 minutes.

- Charging or using the product at temperatures below 40 °F (4.5 °C) or higher than 95 °F (35 °C) adversely affects the lifespan of the battery.
 - If the product is subjected to a major change in temperature, pressure or humidity, let the product acclimatize for 30 minutes before using.
- 1 Make sure the product is switched off.
 - 2 Put the small plug in the product and put the power plug in the wall outlet (Fig. 2).
 - After approximately 5 minutes the battery has enough energy for one cordless trimming session.
 - 3 After charging, remove the power plug from the wall outlet and pull the small plug out of the product.

Note: An adapter plug may be necessary for cord usage in some foreign countries. Use an attachment plug adapter of the proper configuration for power outlet.

When the product is fully charged, it has a cordless operating time of up to 70 minutes.

Battery status indications

- When the battery is almost empty, the battery charge indicator flashes orange (Fig. 3).
- When the product is charging, the battery charge indicator flashes white (Fig. 4).
- When the product is fully charged, the battery charge indicator lights up white continuously (Fig. 5).

Note: After approx. 30 minutes, the light goes out automatically.

Using the product

Note: This product can be used without cord or when it is connected to the power outlet (Fig. 6).

- Use this product for its intended household use as described in this manual.
- For hygienic reasons, the product should only be used by one person.

Switching the product on and off

Press the on/off button once to switch the product on or off (Fig. 7).

Beard trimming

- If you are trimming for the first time, be careful. Do not move the product too fast. Make smooth and gentle movements.
- When you trim for the first time, start at the highest length setting to familiarize yourself with the product.
- Trimming facial hair is easier when skin and hair are dry.
- Always comb the beard and/or moustache with a fine comb before you start trimming

Trimming with guard

- 1 Make sure the product is switched off.
- 2 Slide the guard into the guiding grooves on both sides of the product ('click') (Fig. 8).
- 3 Turn the zoom wheel to select the desired length setting (Fig. 9). The selected length setting is shown on the front of the product.
 - You can select a length from 1/64 in to 9/32 in (0.4 mm to 7 mm).
- 4 Switch on the product.
- 5 To trim most effectively, move the product against the hair growth direction. Make sure that the surface of the guard always stays in contact with the skin (Fig. 10).

Note: Since hairs do not all grow in the same direction, you may want to try different trimming positions (i.e. upwards, downwards, or across). Practice is best for optimum results.

- If cut hairs have accumulated in the guard during use, switch off the product, remove the guard and blow and/or shake the hair out of the guard.
- 6 Switch off and clean the product after each use (see 'Cleaning').

Trimming without guard

If you trim without guard, your hair is cut off close to the skin. You can use the trimming head without guard to:

- Define your hair line
 - Trim the nape of the neck
 - Remove single unwanted hairs
- 1 Make sure the product is switched off.
 - 2 Remove the guard by pulling it off the product (Fig. 11).
 - Never pull at the flexible top of the guard. always pull at the sides.
 - 3 Switch on the product.
 - 4 Make well-controlled movements. Touch the hair lightly with the trimmer.
 - For a comfortable trim close to your skin, place the flat side of the trimming head against your skin and make strokes in the desired direction (Fig. 12).
 - For contouring hold the trimming head perpendicular to the skin and move the trimming head upwards or downwards with gentle pressure (Fig. 13).
 - 5 Switch off and clean the product after each use (see 'Cleaning').

Body trimming with the body guard

You can use the body guard to trim hairs below the neckline.

- Make sure that the product is fully charged before you start trimming.
 - Make sure hair is clean and dry, as wet hair tends to stick to the body.
 - Take your time and do not move the product too fast. Make smooth and gentle movements.
 - Be careful when you trim sensitive areas.
 - Always use the body guard when you trim sensitive areas.
- 1 Slide the body guards into the guiding grooves on both sides of the product ('click') (Fig. 14).
 - 2 Turn the zoom wheel to select the desired length setting (Fig. 15).

The body comb cuts hair to a length of 3/64-23/32 in (1-18 mm).

Note: Make sure you set the length setting to 1/8 in. (3 mm) or longer when you trim sensitive areas.

- 3 The setting selected is shown on the front of the product and is equal to the hair length that remains after trimming.

- If you are trimming for the first time, start by using the guard at the maximum trimming length setting (23/32 in, 18 mm) to prevent accidentally trimming hairs too short. As you become familiar with the settings, turn the zoom wheel to set to desired trimming length. The zoom wheel will click into position at each setting.
- 4 Switch on the product.
 - 5 To trim most effectively, stretch the skin with your free hand and move the product against the hair growth direction (Fig. 16). Make sure that the surface of the guard always stays in contact with the skin.
- Note: Since hairs do not all grow in the same direction, you may want to try different trimming positions (i.e. upwards, downwards, or across). Practice is best for optimum results.
- When you use the appliance on your armpits, raise your arm and put your hand on the back of your head to stretch the skin.
 - If cut hairs have accumulated in the guard during use, switch off the product, remove the guard and blow and/or shake the hair out of the guard.
- 6 Switch off and clean the product after each use (see 'Cleaning').

Hair clipping

- For best results, use the product on clean, dry hair. Do not use it on freshly washed hair.
 - Before you start clipping, comb the hair in the direction of hair growth.
 - When you clip hair for the first time, start at the highest length setting to familiarize yourself with the product.
 - To achieve optimal clipping results, always move the product slowly through the hair against the direction of hair growth.
- 1 Make sure the product is turned off.
 - 2 Slide one of the hair guards into the guiding grooves on both sides of the product (click) (Fig. 17).
 - 3 Turn the zoom wheel to select the desired length setting. The length setting selected is shown on the front of the product.
 - Short hair guard: select a length from the red indications at the top, ranging from 1/64 in to 9/32 in (0.4 mm to 7 mm) (Fig. 18).
 - Long hair guard: select a length from the silver indications at the top, ranging from 9/32 in to 1/2 in (7 mm to 13 mm) (Fig. 19).
 - 4 Switch on the product.
 - 5 Move the product slowly through the hair, making sure that the surface of the guard stays in contact with the skin (Fig. 20).
 - If cut hairs have accumulated in the guard during use, switch off the product, remove the guard and blow and/or shake the hair out of the guard.
 - 6 Switch off and clean the product after each use (see 'Cleaning').

Tip: Write down the settings you have used to create a certain hairstyle as a reminder for future clipping sessions.

Cleaning

Never use compressed air, scouring pads, abrasive cleaning agents or aggressive liquids such as gasoline or acetone to clean the product.

Clean the product and attachments after each use.

- 1 Switch off the product and disconnect it from the power outlet.
- 2 Wipe the handle of the product with a dry cloth.
- 3 Remove the guard and clean it with the cleaning brush and/or rinse it under the tap (Fig. 21).
- 4 Clean the trimming head with the cleaning brush and/or rinse it under the tap (Fig. 22).

- 5 Carefully shake off excess water and let all parts air dry completely.

Never dry the trimmer teeth with a towel or tissue, as this may damage the trimmer teeth.

- 6 After cleaning, reattach the guard to the product.

Every 3 months: cleaning trimming head connector

- 1 Switch off the product and disconnect it from the power outlet.
- 2 Remove the guard (Fig. 11).
- 3 Pull the trimming head off the product (Fig. 23).
- 4 Clean the trimming head connector and hair chamber with the cleaning brush and/or rinse it under the tap (Fig. 24).
- 5 Clean the inside of the trimming head with the cleaning brush and/or rinse it under the tap (Fig. 25).
- 6 Carefully shake off excess water and let all parts air dry completely.
- 7 Press the trimming head back onto the product, making sure that the projection on the back of the trimming head fits exactly onto the notch in the hair chamber (Fig. 26).

This product has no other user-serviceable parts. For assistance call 1-800-243-3050.

Storage

- Be sure the product is switched off. Remove the cord from the outlet and the product before storing it in a safe, dry location where it will not be crushed, banged, or subject to damage.
- Do not wrap cord around the product when storing.
- Store cord and other accessories in a safe location where these will not be cut or damaged.
- Do not place or store the product where it can fall or be pulled into a tub or sink, water or other liquid while plugged in.

Assistance

For assistance, visit our website:

www.philips.com/support or call toll free

1-800-243-3050.

Online information is available 24 hours a day, 7 days a week.

Disposal

- This product contains a rechargeable lithium-ion battery which must be disposed of properly.
- Contact your local town or city officials for battery disposal information. You can also call 1-800-822-8837 or visit **www.call2recycle.org** for battery drop-off locations (Fig. 27).
- For assistance, visit our website **www.philips.com/support** or call 1-800-243-3050 toll free.
- Your product is designed and manufactured with high quality materials and components, which can be recycled and reused. For recycling information, please contact your local waste management facilities or visit **www.recycle.philips.com**.

Full Two-Year Warranty

Philips North America LLC warrants this new product (except cutters and guards) against defects in materials or workmanship for a period of two years from the date of purchase, and agrees to repair or replace any defective product without charge.

IMPORTANT: This warranty does not cover damage resulting from accident, misuse or abuse, lack of reasonable care, the affixing of any attachment not provided with the product or loss of parts or subjecting the product to any but the specified voltage or batteries.*

NO RESPONSIBILITY IS ASSUMED FOR ANY SPECIAL, INCIDENTAL OR CONSEQUENTIAL DAMAGES.

In order to obtain warranty service, simply go to **www.philips.com/support** for assistance. It is suggested that for your protection you return shipments of product by insured mail, insurance prepaid. Damage occurring during shipment is not covered by this warranty.

NOTE: No other warranty, written or oral, is authorized by Philips North America LLC.

This warranty gives you specific legal rights, and you may also have other rights which vary from state to state. Some states do not allow the exclusion or limitation of incidental or consequential damages, so the above exclusion and limitations may not apply to you.

*Read enclosed instructions carefully.

45-DAY MONEY-BACK GUARANTEE

If you are not fully satisfied with your product send the product back and we'll refund you the full purchase price.

The product must be shipped prepaid by insured mail, insurance prepaid, have the original sales receipt, indicating purchase price and date of purchase, and the money-back guarantee return authorization form enclosed.

We cannot be responsible for lost mail.

The product must be postmarked no later than 45 days after the date of purchase. Philips reserves the right to verify the purchase price of the product and limit refunds not to exceed suggested retail price.

To obtain money-back guarantee return authorization form, call 1-800-243-3050 for assistance.

Delivery of refund check will occur 6–8 weeks after receipt of returned product.