

PHILIPS

S5589, S5588,
S5587, S5586,
S5585, S5584,
S5583, S5582,
S5581, S5579

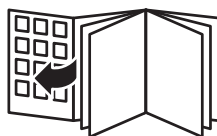

www.philips.com/support/ifu



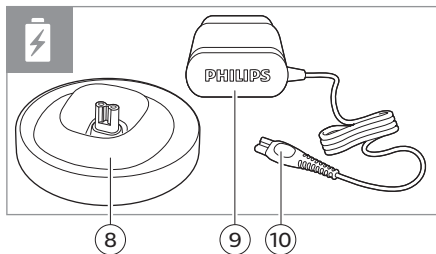
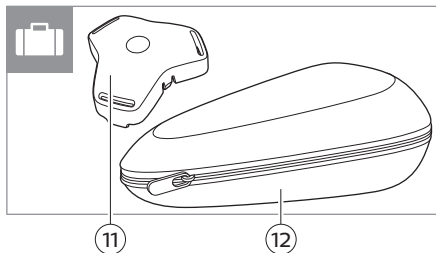
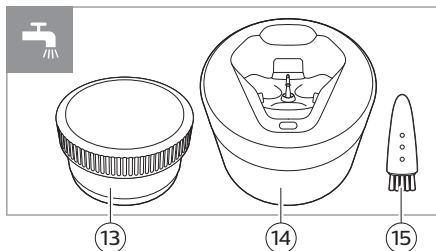
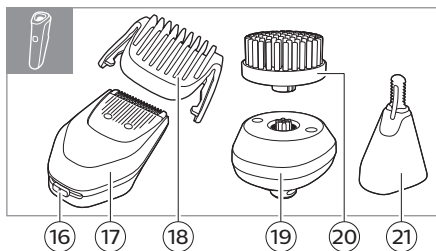
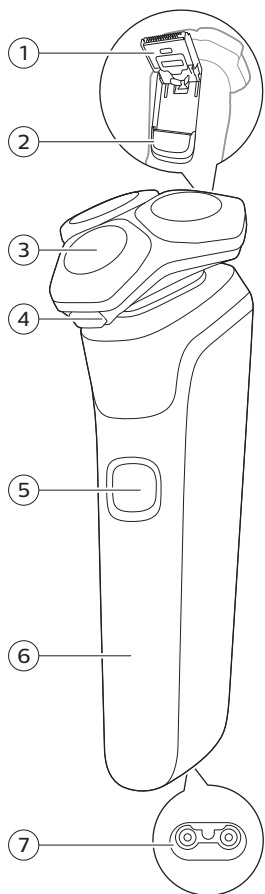

English 6
简体中文 31

Contents

Introduction	6
General description	7
What do the icons on my appliance handle mean?	8
What does the icon on my Quick Clean Pod mean?	9
How do I charge my appliance?	9
Charging with the supply unit	10
Charging in the charging stand (specific models only)	10
'Unplug for use' symbol	11
How do I use my appliance and the attachments?	11
Shaving	12
How do I clean my appliance and the attachments?	18
Cleaning the shaver under the tap	18
Thorough cleaning	19
Cleaning the pop-up trimmer	20
Cleaning the click-on attachments	21
How do I use the Quick Clean Pod?	22
Preparing the Quick Clean Pod for use	22
Using the Quick Clean Pod	23
Replacing the Quick Clean Pod Cartridge	24
How do I replace the shaving heads?	25
Replacing the shaving heads	25
Support	27
Ordering accessories	27
Troubleshooting	28
Shaver	28
Philips Quick Clean Pod	29

Introduction





Congratulations on your purchase and welcome to Philips! To fully benefit from the support that Philips offers, register your product at **www.philips.com/welcome** or via the app.





General description

- 1 Pop-up trimmer
- 2 Trimmer release slide
- 3 Shaving unit
- 4 Shaving unit release button
- 5 On/off button
- 6 Handle
- 7 Socket for small plug
- 8 Charging stand
- 9 Supply unit
- 10 Small plug
- 11 Protection cap
- 12 Pouch
- 13 Philips Quick Clean Pod cartridge
- 14 Quick Clean Pod
- 15 Cleaning brush
- 16 Length settings
- 17 Click-on beard styler attachment
- 18 Comb for beard styler attachment
- 19 Attachment holder
- 20 Click-on cleansing brush attachment
- 21 Click-on nose trimmer attachment

Note: The accessories supplied may vary for different products. The box shows the accessories that have been supplied with your appliance.

What do the icons on my appliance handle mean?

Icon	Behavior	Meaning
	Flashing slowly when you remove the shaver from the Quick Clean Pod during the cleaning programa	The cleaning program was interrupted. If you put the shaver back into the Quick Clean Pod within four seconds, the cleaning program resumes automatically.
	Flashing	Clean the shaver in the Quick Clean Pod (see 'How do I use the Quick Clean Pod?'). Clean the attachments under the tap (see 'How do I clean my appliance and the attachments?').
	Lights up continuously	The cleaning program is in progress.
	Flashing quickly when you remove the shaver from the Quick Clean Pod or press the on/off button during the cleaning program	The cleaning program was stopped. If you wish to continue, you need to restart the cleaning cycle by putting the shaver into the Quick Clean Pod and pressing the on/off button.
	Flashing when you press the on/off button	The travel lock is activated (see 'Storage and travel').

Icon	Behavior	Meaning
	Lights up when you pick up the appliance	The number of bars lit up show the remaining battery charge.
	Bottom light flashing orange	The battery is almost empty (see 'How do I charge my appliance?').
	Lights flashing in sequence	The appliance is charging.
	Lights up continuously	The appliance is fully charged.
	Flashing	The appliance must be disconnected from the wall socket before you can switch it on (see 'How do I charge my appliance?').

What does the icon on my Quick Clean Pod mean?

Icon	Behavior	Meaning
	Becomes visible on the Quick Clean Pod	The Quick Clean Pod Cartridge needs to be replaced (see 'How do I use the Quick Clean Pod?').

How do I charge my appliance?

Charge the appliance before you use it for the first time and when the bottom light of the battery status indicator flashes orange, indicating that the battery is almost empty.

Charging takes approx. 1 hour.

Quick Charge: After approx. 5 minutes of charging, the battery contains enough energy for one shave. When the appliance is fully charged it has a cordless operating time of up to 60 minutes.

Note: You cannot use the appliance while it is charging.

Charging with the supply unit

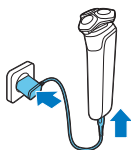

- 1 Make sure that the appliance is switched off.
- 2 Insert the small plug into the appliance and put the supply unit in the wall socket.
 - While the appliance is in quick charge mode, the lights of the battery status indicator light up one after the other. After approximately 5 minutes, the bottom light of the battery status indicator flashes. The battery now contains enough energy for one shave.
 - While the appliance charges, first the bottom light of the battery status indicator flashes and then lights up continuously. Next the second light flashes and then lights up continuously, and so on until the appliance is fully charged.
 - When the appliance is fully charged, all three battery indicator lights light up continuously. After approx. 30 minutes, the light goes out automatically.
- 3 After charging, remove the supply unit from the wall socket and pull the small plug out of the appliance.

Charging in the charging stand (specific models only)

- 1 Make sure the appliance is switched off.

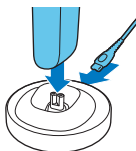

- 2 Put the small plug in the charging stand and put the supply unit in the wall socket.
- 3 Place the appliance in the charging stand.

Specific models only: The light ring on the bottom of the charging stand lights up and rotates quickly.

- After approximately 5 minutes, the light ring rotates slower. The battery now contains enough energy for one shave.
 - As the appliance continues to charge, the light ring becomes brighter and rotates slower.
 - When the appliance is fully charged, the light ring lights up fully and stops rotating.
- 4 After charging, remove the supply unit from the wall socket and pull the small plug out of the charging stand.

'Unplug for use' symbol



The 'unplug for use' symbol flashes to remind you to disconnect the appliance from the wall socket and remove the small plug from the appliance before you switch it on.

How do I use my appliance and the attachments?

Warning: Always check the appliance and all accessories before use. Do not use the appliance or any accessory if it is damaged, as this may cause injury. Always replace a damaged part with one of the original type.

Note: This appliance is waterproof. It is suitable for use in the bath or shower and for cleaning under

the tap. For safety reasons, the appliance can therefore only be used without cord.

Shaving

You can use this appliance either wet or dry, or even under the shower. For a wet shave, apply some water and shaving foam or gel to your skin and rinse the shaving heads under the tap with warm water before following the steps below.

- 1 Switch on the appliance.
- 2 Move the shaving heads over your skin in circular movements to catch all hairs growing in different directions. Make sure each shaving head is fully in contact with the skin. Exert gentle pressure for a close, comfortable shave.

Note: Do not press too hard, as this can cause skin irritation.

Note: If you are shaving with gel or foam, rinse the shaving unit regularly during your shave to ensure that it continues to glide smoothly over your skin.

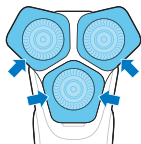

- 3 Use the narrow sides of the shaving unit to shave in hard-to-reach areas such as along your jawline and under your nose.
- 4 Switch off and clean the appliance after each use.

Note: Make sure you rinse all foam or shaving gel off the appliance.

Skin adaptation period

Your first shaves may not bring you the result you expect and your skin may even become slightly irritated. This is normal. Your skin and beard need time to adapt to any new shaving system. To allow your skin to adapt to this new appliance, we advise you to shave regularly (at least 3 times a week) and exclusively with this appliance for a period of 3 weeks.

Cleaning reminder

When you switch off the appliance, the cleaning reminder flashes to remind you to clean the appliance.

- Clean the appliance and attachments after each use to prevent clogging and damage (see 'How do I clean my appliance and the attachments?').
- Clean the shaving heads thoroughly once a month or when the appliance does not shave as well as it used to (see 'Thorough cleaning').



Trimming

You can use the trimmer to groom your sideburns and moustache.

- 1 Push the trimmer release slide downwards to open the trimmer.
- 2 Switch on the appliance.

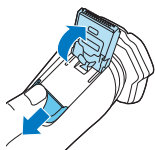



- 3 Hold the trimmer perpendicular to the skin and move the appliance downwards while you exert gentle pressure.
- 4 You can also use the trimmer under your nose.
- 5 Switch off the appliance and clean the trimmer after each use to prevent clogging and damage (see 'How do I clean my appliance and the attachments?').
- 6 Close the trimmer.

Using the click-on attachments

Note: The accessories supplied may vary for different products. The box shows the accessories that have been supplied with your product.

Using the beard styler attachment with comb

You can use the beard styler attachment with the comb attached to style your beard at one fixed setting or at different length settings. You can also use it to pre-trim any long hairs before shaving for a more comfortable shave.

The hair length settings on the beard styler attachment correspond to the remaining hair length after cutting and range from 1 to 5 mm.



- 1 Twist the shaving head or other attachment to remove it from the handle and press the beard styler attachment onto the handle.



- 2 Slide the comb straight into the guiding grooves on both sides of the beard styler attachment.



- 3 Press the length selector and then push it to the left or right to select the desired hair length setting.
- 4 Switch on the appliance.

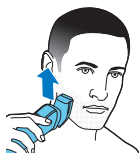

- 5 Move the appliance upwards while you exert gentle pressure. Make sure the front of the comb is in full contact with the skin.
- 6 Switch off the appliance and clean the attachment after use.

Using the beard styler attachment without comb

You can use the beard styler attachment without the comb to contour your beard, moustache, sideburns or neckline to a length of 0.5 mm.

You can use the beard styler attachment with the comb attached to style your beard at one fixed setting or at different length settings. You can also use it to pre-trim any long hairs before shaving for a more comfortable shave.

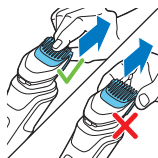

- 1 Pull the comb off the beard styler attachment.

Note: Grab the comb in the center to pull it off the beard styler attachment. Do not pull at the sides of the comb.

- 2 Switch on the appliance.



- 3 Hold the beard styler attachment perpendicular to the skin and move the appliance downwards while you exert gentle pressure.
- 4 Switch off the appliance and clean the attachment after use.

Using the nose/ear trimmer attachment

You can use the nose/ear trimmer attachment to trim your nose and/or ear hair.

Trimming nose hair

Make sure both the nose/ear trimmer attachment and nasal passages are clean before trimming.



- 1 Twist the shaving head or other attachment to remove it from the handle and press the nose/ear hair trimmer onto the handle.
- 2 Switch on the appliance.
- 3 Carefully insert the trimming head into one of your nostrils.

Do not insert the attachment more than 0.5 cm into your nostrils.



- 4 Slowly move the trimming head around inside each nostril, making sure the side of the tip is held firmly against the skin. This reduces the tickling effect that can occur.
- 5 Switch off the appliance and clean the attachment after use.

Dried nasal mucus can block the cutting element, preventing the appliance from switching on. If the cutting element is blocked, clean the attachment (see 'How do I clean my appliance and the attachments?').

Trimming ear hair

Make sure your outer ear channels are clean and free from wax.

- 1 Switch on the appliance.

- 2 Slowly move the trimming head along the rim of the ear to remove hairs that stick out beyond the rim.
- 3 Carefully insert the trimming head into the outer ear channel.

Do not insert the trimming head more than 0.5 cm into your ear channel, as this could damage the eardrum.



- 4 Slowly turn the trimming head around to remove all unwanted hairs from your outer ear channel.
- 5 Switch off the appliance and clean the attachment after use.

Storage and travel

Note: We advise you to let the appliance and its attachments dry before you store them for the next use.



- Put the protection cap (if supplied) on the shaver to protect it from dirt accumulation.
- Store the appliance in the pouch (if supplied).
- Alternatively, store the appliance on the charging stand (if supplied) or in the Philips Quick Clean Pod (if supplied).

Travel lock

You can lock the shaver when you are going to travel to prevent it from switching on accidentally.

Press the on/off button for 3 seconds to use the travel lock mode.

When the travel lock is activated, the travel lock symbol flashes.

Press the on/off button for 3 seconds.

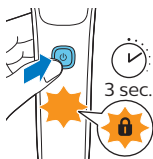



Once the travel lock is deactivated, the appliance switches on automatically.

Note: The shaver unlocks automatically when it is connected to a wall socket.

How do I clean my appliance and the attachments?

Clean the appliance and the attachments after each use for optimal performance.

Cleaning the shaver under the tap

Clean the shaver after each use to prevent clogging and damage.

Never dry the shaving unit with a towel or tissue, as this may damage the shaving heads.

While rinsing the shaving unit, water may drip out of the base of the shaver. This is a normal occurrence.



- 1 Switch on the shaver.
- 2 Rinse the shaving unit under a warm tap.



- 3 Switch off the shaver. Press the release button to open the shaving unit.



- 4 Rinse the hair chamber under a warm tap.



- 5 Rinse the shaving head holder under a warm tap.
6 Carefully shake off excess water and let the shaving head holder air-dry completely.



- 7 Close the shaving unit.

Thorough cleaning

We advise you to clean the shaving heads thoroughly once a month or when the shaver does not shave as well as it used to.

- 1 Make sure that the appliance is switched off and disconnected from the wall socket.
- 2 Press the release buttons on the shaving unit and pull the shaving head holder off the shaving unit.





- 3 Rinse the hair chamber and shaving head holder under the tap.
- 4 Remove the shaving heads. For detailed instructions, see 'How do I replace the shaving heads?.'

Note: Do not clean more than one cutter and guard at a time, since they are all matching sets. If you accidentally put a cutter in the wrong shaving guard, it may take several weeks before optimal shaving performance is restored.

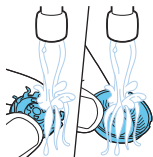

- 5 Clean the cutter and guard under the tap.
- 6 Shake off excess water.
- 7 Put the shaving heads back into the shaving unit. For detailed instructions, see 'How do I replace the shaving heads?.'

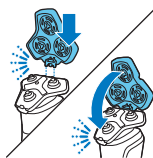

- 8 Insert the hinge of the shaving head holder into the slot in the top of the shaving unit and close the shaving unit.

Cleaning the pop-up trimmer

Clean the trimmer after each use to prevent clogging and damage.

Never dry the trimmer teeth with a towel or tissue, as this may damage the trimmer teeth.

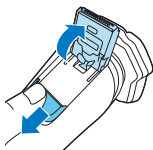

- 1 Make sure that the appliance is switched off and disconnected from the wall socket.
- 2 Push the trimmer release slide down to open the pop-up trimmer.

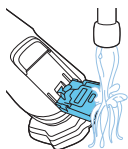

- 3 Switch on the appliance and rinse the pop-up trimmer with warm water.
- 4 After cleaning, switch off the appliance.
- 5 Carefully shake off excess water and let the pop-up trimmer air dry.
- 6 Close the trimmer.

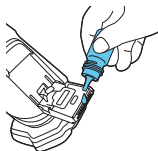

Tip: For optimal performance, lubricate the teeth of the pop-up trimmer with a drop of mineral oil every six months (oil not included).

Cleaning the click-on attachments

Never dry the trimmer or beard styler attachments with a towel or tissue, as this may damage the trimming teeth.

The accessories supplied may vary for different products. The box shows the accessories that have been supplied with your product.

Clean the click-on attachments after each use for optimal performance.

- 1 Make sure that the appliance is switched off.
- 2 Twist the attachment to remove it from the handle.

Pull the cleansing brush head straight off of the attachment holder.



- 3 Clean the parts thoroughly with warm water. Use soap only on the cleansing brush attachment.

Tip: If rinsing the nose/ear trimmer attachment under the tap is not sufficient, press the attachment onto handle and immerse the trimming head in a glass with warm water for a few minutes. Then switch on the appliance and rinse it under the tap.

- 4 Carefully shake off excess water from the beard styler, combs and nose/ear trimmer attachments and let them air dry completely.

Dry the cleansing brush attachment with a towel.

Never dry the cutting unit with a towel or tissue, as this may damage the trimming teeth.

Tip: For optimal performance, lubricate the teeth of the beard styler attachment with a drop of sewing machine oil regularly.

How do I use the Quick Clean Pod?

Preparing the Quick Clean Pod for use

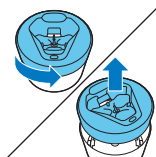

- 1 Twist and remove the top of the Quick Clean Pod.

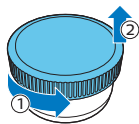

- 2 Twist the lid off of the Quick Clean Pod Cartridge.

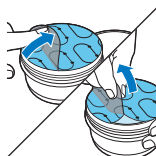

- 3 Lift the tab on the seal and pull it by the corner to remove the seal from the Quick Clean Pod Cartridge.

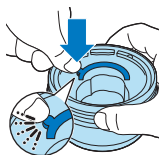

- 4 Press the small circular piece on the handle of the Quick Clean Pod Cartridge to break the snap hook on the handle.

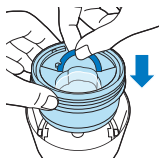

- 5 Place the Quick Clean Pod Cartridge into the Quick Clean Pod.

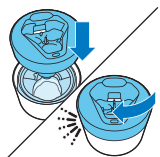

- 6 Put the top of the Quick Clean Pod back onto the base and turn it clockwise until you hear a click.



Do not tilt the Quick Clean Pod to prevent leakage.

Using the Quick Clean Pod

Note: If you use the shaver with shaving foam, shaving gel or pre-shave products, thoroughly rinse the shaving heads before you use the Quick Clean Pod (see 'How do I clean my appliance and the attachments?').

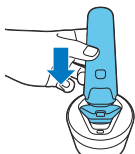

Always shake excess water off the shaver before you place it in the Quick Clean Pod.

- 1 Place the shaver upside down into the Quick Clean Pod. The shaver automatically detects that it is in the Quick Clean Pod.
- 2 Switch on the shaver to start the cleaning program.

Each cleaning program takes approximately one minute. During the cleaning program the cleaning symbol lights up continuously and the blue icon pulses.

The shaver handle vibrates twice quickly when the cleaning program is finished.

- 3 Let the shaver air-dry completely in the Quick Clean Pod before storing it.

Replacing the Quick Clean Pod Cartridge

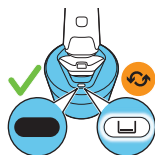

Replace the Quick Clean Pod Cartridge immediately when the cartridge replacement icon on the Quick Clean Pod becomes visible or follow the table below.

Frequency of use	Cycles	When to replace the Quick Clean Pod Cartridge
Every day	About 30	Every month
A few times per week	About 20	Every 2 months
Every week	About 13	Every 3 months
Every month	About 3	Every 3 months

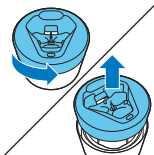

- 1 Twist and remove the top of the Quick Clean Pod.

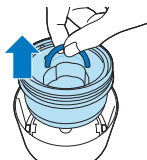

- 2 Lift the Quick Clean Pod Cartridge out of the Quick Clean Pod by the handle.



- 3 Pour any remaining fluid down a drain and recycle the empty cartridge in accordance with local waste regulations.



- 4 Place a new Quick Clean Pod Cartridge into the Quick Clean Pod (see 'Preparing the Quick Clean Pod for use').

Scan the QR code to the left or visit www.philips.com/cleaning-cartridge to order replacement Quick Clean Pod Cartridges.

How do I replace the shaving heads?

For maximum shaving performance, we advise you to replace the shaving heads every two years.

Replace damaged shaving heads immediately.

Always replace the shaving heads with original Philips shaving heads (see 'Ordering accessories').

Replacing the shaving heads

- 1 Switch off the shaver.

26 English



- 2** Press the release buttons on the shaving unit and pull the shaving head holder off the shaving unit.

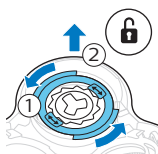

- 3** Turn the retaining rings anticlockwise and remove them. Place them aside in a safe place.

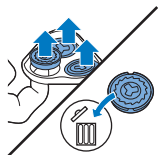

- 4** Remove the shaving heads from the shaving head holder.
Discard the used shaving heads immediately to avoid mixing them with the new shaving heads.

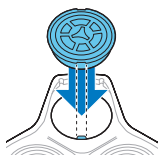

- 5** Place new shaving heads in the holder.

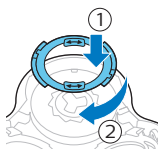

- 6** Place the retaining rings back onto the shaving heads and turn them clockwise to reattach the retaining ring.

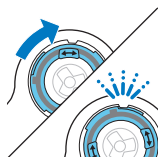

- Each retaining ring has two recesses that fit exactly into the projections of the shaving head holder. Turn the ring clockwise until you hear a click to indicate that the ring is fixed.

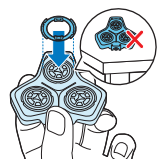

Note: Hold the shaving head holder in your hand when you reinsert the shaving heads and reattach the retaining rings. Do not place the shaving head holder on a surface, as this may cause damage to the shaving heads.

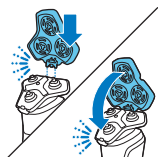

- 7 Insert the hinge of the shaving head holder into the slot in the top of the shaving unit and close the shaving unit.

Support

Ordering accessories

To buy accessories or spare parts, visit **www.philips.com/parts-and-accessories** or go to your Philips dealer. You can also contact the Philips Consumer Care Center in your country (see the international warranty leaflet for contact details).

The following accessories and spare parts are available:

- SH71 replacement Philips shaving heads
- CC12 Philips Quick Clean Pod Cartridge 2-pack
- CC13 Philips Quick Clean Pod Cartridge 3-pack
- CC16 Philips Quick Clean Pod Cartridge 6-pack

Note: The availability of the accessories may differ by country.

Troubleshooting

This chapter summarizes the most common problems you could encounter with the appliance. If you are unable to solve the problem with the information below, visit www.philips.com/support for a list of frequently asked questions or contact the Consumer Care Center in your country.

Shaver

Problem	Possible cause	Solution
The appliance does not work when I press the on/off button.	The appliance is still attached to the wall socket. For safety reasons, the appliance can only be used without cord.	Unplug the appliance and press the on/off button to switch on the appliance.
	The rechargeable battery is empty.	Recharge the battery.
	The travel lock is activated.	Press the on/off button for 3 seconds to deactivate the travel lock.
	The shaving unit is soiled or damaged to such an extent that the motor cannot run.	Clean the shaving heads thoroughly or replace them.
The appliance does not shave as well as it used to.	The shaving heads are damaged or worn.	Replace the shaving heads.
	Hairs or dirt obstruct the shaving heads.	Clean the shaving heads thoroughly.

Problem	Possible cause	Solution
Water is leaking from the bottom of the appliance.	During cleaning, water may collect between the inner body and the outer shell of the appliance.	This is normal and not dangerous because all electronics are enclosed in a sealed power unit inside the appliance.

Philips Quick Clean Pod

Problem	Possible cause	Solution
My shaver isn't clean after using the Philips Quick Clean Pod.	You removed the shaver before the cleaning program was finished.	Leave the shaver in the Philips Quick Clean Pod for the full cleaning program. Each cleaning program takes approximately 1 minute. The cleaning icon goes out when the cleaning program is finished.
	The Philips Quick Clean Pod Cartridge needs to be replaced.	Replace the Philips Quick Clean Pod Cartridge.
	The Philips Quick Clean Pod is tilted.	Place the Philips Quick Clean Pod on a flat surface.
My Philips Quick Clean Pod does not switch on.	The Philips Quick Clean Pod is powered by the motor of the shaver.	Place the shaver into the Philips Quick Clean Pod. Switch on the shaver.
	The shaver is connected to the wall socket.	Disconnect the shaver from the supply unit.
	The shaver battery is empty.	Charge the shaver before using the Philips Quick Clean Pod.

30 English

My Philips Quick Clean Pod is overflowing.

You regularly use the Philips Quick Clean Pod after rinsing the shaver but not shaking off excess water.

Shake off excess water after rinsing the shaving heads each time before putting the shaver into the Philips Quick Clean Pod.

You shaved with shaving gel or foam and did not rinse the shaver before using the Philips Quick Clean Pod.

Rinse the shaving heads thoroughly before using the Philips Quick Clean Pod (see 'Using the Quick Clean Pod').

目录

说明	32
基本说明	32
产品手柄上的图标是什么意思？	33
快速清洗器上的图标是什么意思？	34
如何为产品充电？	35
使用电源部件充电	35
在充电座上充电（仅限于特定型号）	36
“拔出插头即可使用”符号	37
如何使用产品和附件？	37
剃须	37
如何清洁产品和附件？	43
在水龙头下冲洗剃须刀	44
彻底清洁	45
清洁弹出式修剪器	46
清洁卡入式附件	47
如何使用快速清洗器？	48
准备使用快速清洗器	48
使用快速清洗器	49
更换快速清洗器滤芯	50
如何更换剃须刀头？	51
更换剃须刀头	51
支持	53
订购配件	53
故障种类和处理方法	54

32 简体中文

剃须刀_____	54
飞利浦快速清洗器_____	55

说明

感谢您的惠顾，欢迎使用飞利浦产品！为了让您能充分享受飞利浦提供的支持，请在 www.philips.com/welcome 上或通过应用程序注册您的产品。

基本说明

- 1 修发器
- 2 修发器释放滑块
- 3 剃须刀头部件
- 4 剃须刀头部件释放按钮
- 5 开/关按钮
- 6 手柄
- 7 小插头插座
- 8 充电底座
- 9 电源部件
- 10 小插头
- 11 保护盖
- 12 旅行盒
- 13 飞利浦快速清洗器滤芯
- 14 快速清洗器
- 15 清洁刷
- 16 长度设定
- 17 卡入式胡须造型器附件
- 18 适用于胡须造型器附件的修剪梳
- 19 附件支架

20 卡入式洁面刷附件

21 卡入式鼻毛修剪器附件

注意： 随附的附件可能因产品而异。包装盒上会显示随附于您产品的附件。

产品手柄上的图标是什么意思？

图标	行为	含义
	清洁程序运行期间将剃须刀从快速清洗器中取出时缓慢闪烁a	清洁程序被中断。如果您在四秒钟之内将剃须刀放回到快速清洗器中，清洁程序将自动恢复。
	闪烁	在快速清洗器中清洁剃须刀 (请参见 '如何使用快速清洗器?')。在水龙头 (请参见 '如何清洁产品和附件?')下清洁附件。
	持续亮起	清洁程序正在进行中。
	从快速清洗器中取出剃须刀或在清洁程序运行期间按开/关按钮时快速闪烁	清洁程序已停止。如果要继续，需要重新启动清洁周期，具体做法是将剃须刀放入快速清洗器中，然后按开/关按钮。

34 简体中文

图标	行为	含义
	在按下开/关按钮时闪烁	旅行锁已激活 (请参见 '存放和携带')。
	拿起产品时亮起	亮起的指示条的数量代表剩余的电池电量。
	底部指示灯呈橙色闪烁	电池电量几乎耗尽 (请参见 '如何为产品充电?')。
	指示灯依次闪烁	产品正在充电。
	持续亮起	产品已充满电。
	闪烁	在打开产品之前应先断开其与电源插座的连接 (请参见 '如何为产品充电?')。

快速清洗器上的图标是什么意思？

图标	行为	含义
	显示在快速清洗器上	快速清洗器滤芯需要更换 (请参见 '如何使用快速清洗器?')。

如何为产品充电？

首次使用本产品之前，以及当电池状态指示灯的底灯呈橙色闪烁（指示电池电量几乎耗尽）时，请为本产品充电。

充电约需 1 小时。

快速充电：充电大约 5 分钟后，电池含有的电量足以完成一次剃须。

产品充满电后，可在不接电源的情况下工作长达 60 分钟。

注意：不能在充电时使用本产品。

使用电源部件充电

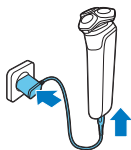

- 1 确保产品已关闭。
- 2 将充电插头插入产品，然后将电源部件插入电源插座。
 - 当产品处于快速充电模式时，电池状态指示灯的各个灯会依次亮起。大约 5 分钟后，电池状态指示灯的底灯将闪烁。电池现在所含的电量足以完成一次剃须。
 - 产品充电时，电池状态指示灯的底灯先是闪烁，然后持续亮起。接下来，第二个指示灯闪烁，之后持续亮起，以此类推，直至本产品充满电。

- 产品充满电后，所有三个电池指示灯都会持续亮起。指示灯将大约 30 分钟后自动熄灭。
- 3 充电之后，从电源插座上拔下电源部件，并从本产品上拔下小插头。

在充电座上充电（仅限于特定型号）

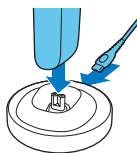

- 1 确保产品电源已关闭。
- 2 将小插头插入充电座，然后将电源部件插入电源插座
- 3 将产品存置于充电座中。

仅限于特定型号： 充电座底部的光环亮起并快速旋转。

- 大约 5 分钟后，光环旋转速度变慢。电池现在所含的电量足以完成一次剃须。
 - 随着产品继续充电，光环变得更亮，旋转速度更慢。
 - 产品充满电后，光环将完全亮起并停止旋转。
- 4 充电之后，从电源插座上拔下电源部件，并从充电底座上拔下小插头。

“拔出插头即可使用”符号



“不要接电源使用”指示灯闪烁，提醒您应该先断开产品与电源插座的连接，并从本产品上拔下小插头后才能打开它。

如何使用产品和附件？

警告： 使用前务必检查产品和所有配件。如果产品或任何配件损坏，请勿继续使用，否则可能会造成人身伤害。请务必用原装型号更换损坏的部件。

注意： 该产品具有防水性能。适合在沐浴或淋浴时使用，也可以放在水龙头下清洗。出于安全原因，该产品在使用时不能连接电线。

剃须

您可以在干湿两种状态下使用本产品，甚至可以在淋浴时使用它。若要进行湿剃，请先用水润湿皮肤，在皮肤上涂抹剃须泡沫或啫喱，并在水龙头下用温水冲洗剃须刀头，然后执行以下步骤。

- 1 启动产品。
- 2 让剃须刀头在您的皮肤上作迂回运动，以刮剃向不同方向生长的所有须发。轻轻按压，以获取舒适贴面的剃须感受。



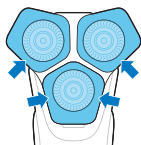

注意：不要用力按压剃须刀，这样可能会导致皮肤受刺激。

注意：如果要用**啫喱**或泡沫剃须，请在剃须期间定期冲洗剃须刀头部件，确保其能够继续在您的皮肤上顺畅滑动。

- 3 使用剃须刀头的窄面剃除难以触及部位的毛发，例如下颌和鼻子下方。
- 4 每次使用后，请关闭并清洁本产品。

注意：确保冲洗干净本产品上的所有泡沫或剃须**啫喱**。

皮肤适应期

前几次剃须可能不会带给您预期效果，并且您的皮肤可能会受到轻度刺激。这是正常的。您的皮肤和胡须需要时间适应任何新的剃须系统。为了让您的皮肤适应这款新产品，我们建议您在 3 周时间内定期（至少每周 3 次）仅使用本产品剃须。

清洁提醒



关闭产品时，清洗提示符号闪烁，提醒您需要清洁产品。

- 每次使用后都要清洁产品和附件，以防止堵塞和损坏 (请参见 '如何清洁产品和附件?')。
- 请每个月彻底清洁一次剃须刀头，或在产品剃须效果不如之前 (请参见 '彻底清洁') 好时进行清洁。

修剪

您可使用修剪器修剪鬓角和须髥。

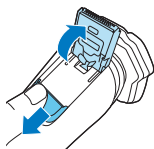

- 1 向下推修剪器释放滑块可打开修剪器。
- 2 启动产品。



- 3 将修剪器垂直放在皮肤上，向下移动产品，同时轻轻按压。
- 4 您还可以使用修剪器剃除鼻子下方毛发。
- 5 每次使用后，请关闭本产品并清洁修剪器，以防止堵塞和损坏 (请参见 '如何清洁产品和附件?')。
- 6 关闭修剪器。

使用卡入式附件

注意：随附的附件可能因产品而异。包装盒上会显示随附于您产品的附件。

使用带修剪梳的胡须造型器附件

您可以使用带修剪梳的胡须造型器附件以固定设置（或者使用不同的长度设置）修整胡须。您也可以在剃须前用其预先修剪较长须发，以实现更舒适的剃须体验。

胡须造型器附件的须发长度设置对应修剪后剩余的须发长度，范围为 1 到 5 毫米。



- 1 旋转剃须刀头或其他附件，将其从手柄上卸下，然后将胡须造型器附件按在手柄上。



- 2 将修剪梳直接滑入胡须造型器附件两侧的导槽中。

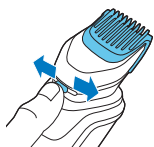

- 3 按下长度选择器，然后将其向左或向右推动以选择所需的须发长度设置。
- 4 启动产品。

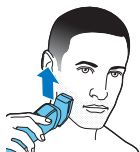

5 向上移动产品，同时轻轻按压。确保修剪梳的正面与皮肤完全接触。

6 使用后，请关闭本产品并清洁附件。

使用不带修剪梳的胡须造型器附件

您可以使用不带修剪梳的胡须造型器附件将胡须、须髥、鬓角或颈部轮廓修整至 0.5 毫米的长度。

您可以使用带修剪梳的胡须造型器附件以固定设置（或者使用不同的长度设置）修整胡须。您也可以在剃须前用其预先修剪较长须发，以实现更舒适的剃须体验。

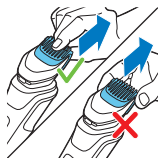

1 将修剪梳抽离胡须造型器附件。

注意：抓住修剪梳的中间位置，将其抽离胡须造型器附件。不要拉拔修剪梳的侧面。

2 启动产品。

3 将胡须造型器附件垂直放在皮肤上，向下移动产品，同时轻轻按压。

4 使用后，请关闭本产品并清洁附件。

使用鼻毛/耳毛修剪器附件

您可以使用鼻毛/耳毛修剪器附件修剪鼻毛和/或耳毛。

修剪鼻毛

修剪之前，请确保鼻毛/耳毛修剪器附件和鼻腔清洁无异物。





- 1 旋转剃须刀头或其他附件，将其从手柄上卸下，然后将鼻毛/耳毛修剪器附件按在手柄上。

- 2 启动产品。

- 3 将修剪刀头小心地插入一个鼻孔。

附件插入鼻孔的深度不得超过 0.5 厘米。



- 4 在每个鼻孔内部缓缓地移动修剪刀头，确保尖端的一侧紧贴在皮肤上。这将减少可能出现的瘙痒。

- 5 使用后，请关闭本产品并清洁附件。

干鼻屎会阻塞修剪部件，因而阻止产品正常打开。如果修剪部件被阻塞，请清洁附件 (请参见 '如何清洁产品和附件?')。

修剪耳毛

确保耳朵外耳道清洁，没有耳垢。

- 1 启动产品。

- 2 缓缓地沿着耳缘移动修剪刀头，以剃掉凸出耳缘的毛发。

- 3 将修剪刀头小心地插入外耳道。

修剪刀头插入耳道的深度不能超过 0.5 厘米，否则可能损伤鼓膜。



- 4 缓缓地转动修剪刀头，以剃掉外耳道中所有多余的毛发。

- 5 使用后，请关闭本产品并清洁附件。

存放和携带

注意：我们建议您将本产品及其配件晾干后再存放，以备下次使用。

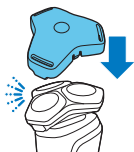

- 盖上剃须刀保护盖（若随附），以防积聚灰尘。
- 将产品存放在软袋中（如有提供）。
- 或者，将本产品存放在充电座（若随附）上或飞利浦快速清洗器（若随附）中。

旅行锁

您在旅行时，可以锁住剃须刀，以防止电源意外开启。

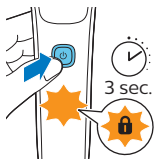

按住开/关按钮 3 秒钟以进入旅行锁模式。

旅行锁启用后，旅行锁符号将闪烁。

按开/关按钮 3 秒钟。

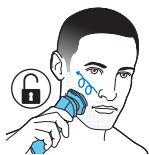

旅行锁被禁用后，产品自动打开。

注意：当连接到电源插座时，剃须刀会自动解锁。

如何清洁产品和附件？

为获得出色性能，请在每次使用后都清洁本产品和附件。

44 简体中文

在水龙头下冲洗剃须刀

每次使用后都要清洁剃须刀，以防止堵塞和损坏。

请勿使用毛巾或纸巾擦拭剃须刀头部件，否则可能会损坏剃须刀头。

冲洗剃须刀头部件时，水可能会从剃须刀底座中滴出。这属于正常现象。



- 1 打开剃须刀。
- 2 用温水冲洗剃须刀头部件。



- 3 关闭剃须刀。按下释放按钮，打开剃须刀头部件。



- 4 在温水龙头下冲洗胡茬储藏室。



- 5 用温水冲洗剃须刀头支架。
- 6 小心地甩掉多余水分并彻底晾干剃须刀头支架。



彻底清洁

7 关闭剃须刀头部件。

我们建议您每个月彻底清洁一次剃须刀头，或在剃须效果没有以前好时进行清洁。

1 确保产品已关闭并且已与电源插座断开连接。

2 按剃须刀头部件上的释放钮并将剃须刀头支架从剃须刀头部件中抽离。



3 在水龙头下冲洗胡茬储藏室和剃须刀头支架。

4 取下剃须刀头。有关详细说明，请参阅“如何更换剃须刀头？”。



注意： 不要同时清洁多组刀片和网罩，因为它们都是相互匹配的。如果不小心将刀片装到了错误的网罩上，则需要数周时间才能恢复产品的出色剃须性能。

46 简体中文

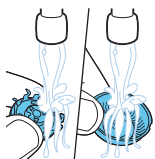

- 5 在水龙头下清洁刀片和网罩。
- 6 甩掉多余的水分。
- 7 将剃须刀头重新放入剃须刀头部件。
有关详细说明，请参阅“如何更换剃须刀头？”。
- 8 将剃须刀头支架的铰链卡入剃须刀头部件顶部的槽内，并合上剃须刀头部件。

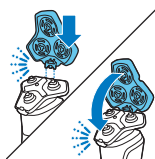

清洁弹出式修剪器

每次使用后都要清洁修剪器，以防止堵塞和损坏。

切勿用毛巾或纸巾擦干修剪器齿，否则可能会损坏修剪器齿。

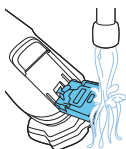
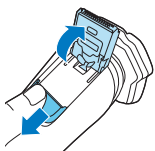

- 1 确保产品已关闭并且已与电源插座断开连接。
- 2 向下推修剪器释放滑块可打开弹出式修剪器。
- 3 启动本产品，用温水冲洗弹出式修剪器。
- 4 清洁完成后，关闭产品。
- 5 小心地甩干多余的水，然后将弹出式修剪器晾干。
- 6 关闭修剪器。

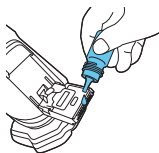

提示：为达到最佳效果，请每六个月用一滴矿物油润滑一次弹出式修剪器齿（油未随附）。

清洁卡入式附件

切勿用毛巾或纸巾擦干修剪器或胡须造型器附件，可能会损坏修剪齿。

随附的附件可能因产品而异。包装盒上会显示随附于您产品的附件。

为达到最佳效果，请在每次使用后都清洁卡入式附件。

- 1 确保产品已关闭。
- 2 旋转附件，将其从手柄上卸下。
将洁面刷头竖直抽离附件支架。
- 3 用温水彻底清洗部件。请仅在洁面刷附件上使用肥皂。



提示：如果在水龙头下冲洗鼻毛/耳毛修剪器附件无法充分清洁，请将此附件按在手柄上，然后将修剪刀头浸入盛有温水的玻璃杯中几分钟。然后启动产品，并在水龙头下冲洗。

- 4 小心地甩掉胡须造型器、修剪梳和鼻毛/耳毛修剪器附件上多余的水，并使其完全晾干。

用毛巾擦干洁面刷附件。

切勿用毛巾或纸巾擦拭修剪部件，否则可能会损坏修剪齿。

提示：为达到最佳效果，请定期用一滴缝纫机油润滑胡须造型器附件齿部。

如何使用快速清洗器？

准备使用快速清洗器

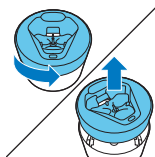

- 1 旋转并取下快速清洗器的顶部。

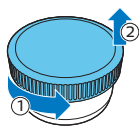

- 2 拧开快速清洗器滤芯盖。

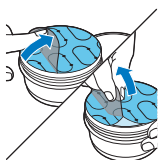

- 3 提起密封圈上的卡舌并拉动一角，以从快速清洗器滤芯上取下密封圈。

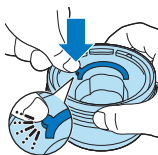

- 4 按下快速清洗器滤芯手柄上的小圆片，以脱开手柄上的卡扣。

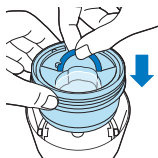

- 5 将快速清洗器滤芯放入快速清洗器。

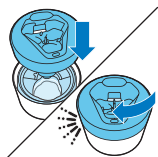

- 6 将快速清洗器的顶部放回基座，然后顺时针旋转直到听到“咔哒”声。



切勿倾斜快速清洗器，以防溢漏。

使用快速清洗器

注意：如果您在剃须时使用了剃须泡沫、剃须啫喱或剃须前用品，请在使用快速清洗器前彻底冲洗剃须刀头（请参见‘如何清洁产品和附件？’）。

将剃须刀放入快速清洗器之前，务必确保甩掉剃须刀上多余的水份。

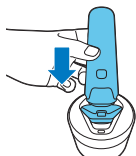

- 1 将剃须刀倒置放入快速清洗器中。剃须刀会自动检测其是否位于快速清洗器中。
- 2 打开剃须刀，启动清洁程序。

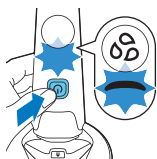

每个清洁程序大约需要一分钟。在清洁程序运行期间，清洁符号会持续亮起，且蓝色图标会闪烁。

清洁程序结束后，剃须刀手柄会快速振动两次。

- 待剃须刀在快速清洗器中完全晾干后再存放。

更换快速清洗器滤芯

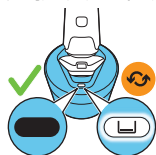

当快速清洗器上显示滤芯更换图标时，请立即更换快速清洗器滤芯，或遵循下表进行更换。

使用频率	周期数	何时更换快速清洗器滤芯
每天	大约 30 个	每月
每周几次	大约 20 个	每 2 个月
每周	大约 13 个	每 3 个月
每月	大约 3 个	每 3 个月

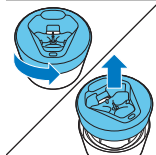

- 旋转并取下快速清洗器的顶部。

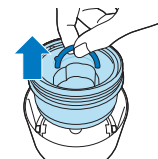

- 2 握住手柄将快速清洗器滤芯从快速清洗器中取出。



- 3 将滤芯中的所有剩余液体倒入排水管道，并按照当地废物管理条例回收空的滤芯。



- 4 将新的快速清洗器滤芯放入快速清洗器 (请参见 '准备使用快速清洗器')。
扫描左侧二维码或访问
www.philips.com/cleaning-cartridge
订购快速清洗器滤芯替换件。

如何更换剃须刀头？

为获得更好剃须效果，建议每两年更换一次剃须刀头。

立即更换损坏的剃须刀头。务必使用原装飞利浦剃须刀头 (请参见 '订购配件') 进行更换。

更换剃须刀头

- 1 关闭剃须刀。

52 简体中文



- 2 按剃须刀头部件上的释放钮并将剃须刀头支架从剃须刀头部件中抽离。

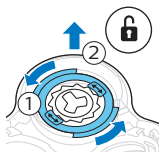

- 3 逆时针旋转固定环并将其取下。将其存放在安全的地方。

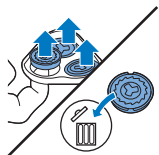

- 4 从剃须刀头支架上卸下剃须刀头。
直接丢弃用过的剃须刀头，以免与新的剃须刀头混淆。

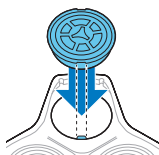

- 5 将新的剃须刀头放在支架中。

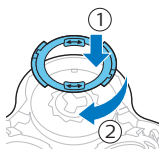

- 6 将固定环放回剃须刀头上，然后顺时针旋转以重新安装固定环。

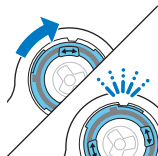

- 每个固定环均具有两个凹槽，正好能够装入剃须刀头支架的凸缘上。顺时针旋转固定环，直至听到“咔哒”一声，表明固定环已就位。

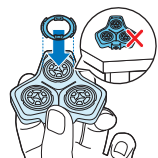

注意：当您重新插入剃须刀头并重新安装固定环时，请将剃须刀头支架握在手中。切勿将剃须刀头支架放在平面上，否则可能会损坏剃须刀头。

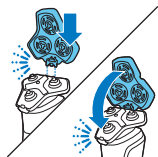

- 7 将剃须刀头支架的铰链卡入剃须刀头部件顶部的槽内，并合上剃须刀头部件。

支持 订购配件

如需购买附件或备件，请访问 www.philips.com/parts-and-accessories 或联系您的飞利浦经销商。您还可以联系所在国家/地区的飞利浦客户服务中心（请参阅保修卡了解详细联系信息）。

可选配以下附件和备件：

- SH71 飞利浦替换剃须刀头
- CC12 飞利浦快速清洗器滤芯（2 件装）
- CC13 飞利浦快速清洗器滤芯（3 件装）

- CC16 飞利浦快速清洗器滤芯（6 件装）

注意： 配件可用性可能因国家/地区而异。

故障种类和处理方法

本章归纳了使用本产品时最常见的一些问题。如果您无法根据以下信息解决问题，请访问 www.philips.com/support 查阅常见问题列表，或联系您所在国家/地区的客户服务中心。

剃须刀

问题	可能的原因	解决方法
按下开/关按钮时，产品不工作。	本产品仍然连接着电源插座。出于安全原因，本产品在使用时不能连接电线。	拔掉产品插头并按开/关按钮打开产品。
	充电电池的电量已耗尽。	给电池充电。
	旅行锁已被激活。	按住开/关按钮 3 秒钟以禁用旅行锁。
	剃须刀头部件被污染或损坏，导致马达无法运行。	彻底清洁剃须刀头或将其更换。

问题	可能的原因	解决方法
产品的剃须效果没有以前好。	剃须刀头已损坏或磨损。	更换剃须刀头。
	毛发或污垢堵塞了剃须刀头。	彻底清洁剃须刀头。
水从产品底部漏出。	在清洁过程中，水可能聚集在产品的机身内部与外壳之间。	这是正常现象，而且没有危险，因为所有电子元件都封闭在产品内部的密封电源部件中。

飞利浦快速清洗器

问题	可能的原因	解决方法
使用飞利浦快速清洗器后，剃须刀依旧不干净。	您在清洁程序结束前卸下剃须刀。	请将剃须刀放在飞利浦快速清洗器中以完成整个清洁程序。每个清洁程序大约需要 1 分钟。清洁程序结束后，清洁图标熄灭。
	需要更换飞利浦快速清洗器滤芯。	更换飞利浦快速清洗器滤芯。
	飞利浦快速清洗器倾斜。	将飞利浦快速清洗器置于平面上。

56 简体中文

飞利浦快速清洗器无法启动。	飞利浦快速清洗器由剃须刀的马达驱动。	将剃须刀放入飞利浦快速清洗器中。打开剃须刀。
	剃须刀连接了电源插座。	断开剃须刀与电源部件的连接。
	剃须刀电池电量耗尽。	在使用飞利浦快速清洗器前，请给剃须刀充电。
飞利浦快速清洗器溢水。	经常在冲洗剃须刀后但未甩掉多余水分时使用飞利浦快速清洗器。	每次冲洗剃须刀头后都要甩掉多余的水分，然后再将剃须刀放入飞利浦快速清洗器中。
	您在用剃须啫喱或剃须泡沫剃须后，并未冲洗剃须刀，就使用飞利浦快速清洗器。	使用飞利浦快速清洗器之前，请彻底冲洗剃须刀头 (请参见 '使用快速清洗器')。

— |

| —

— |

| —

— |

| —

— |

| —

© 2020 Koninklijke Philips N.V.

All rights reserved

4222.002.5610.1 (31/7/2020)



>75 % recycled paper
>75 % papier recyclé