

Always here to help you / 始终如一地为您提供帮助

Register your product and get support at / 请登录以下网址并得到相应的帮助
www.philips.com/welcome

AT800



PHILIPS



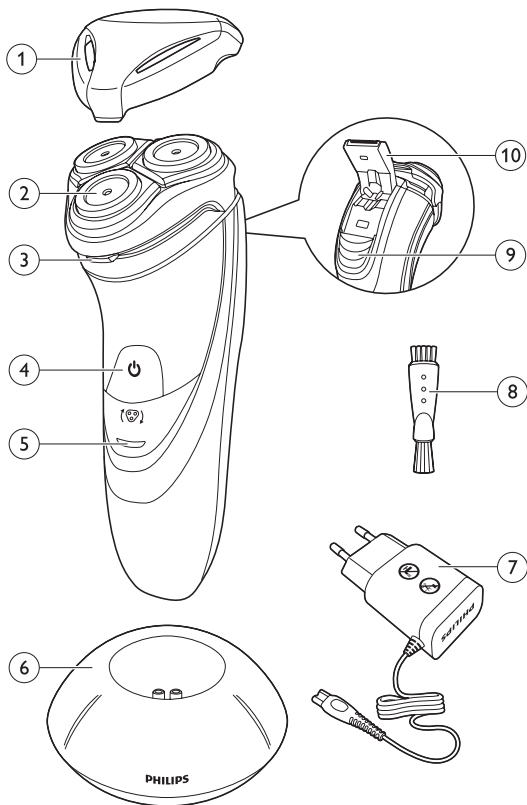

ENGLISH 6

简体中文 21

Introduction

Congratulations on your purchase and welcome to Philips! To fully benefit from the support that Philips offers, register your product at www.philips.com/welcome.

Please read this user manual, as it contains information about the wonderful features of this shaver as well as some tips to make shaving easier and more enjoyable.

General description (Fig. 1)

- 1 Protection cap
- 2 Shaving unit
- 3 Shaving unit release button
- 4 Shaver on/off button
- 5 Charging light
- 6 Charging stand
- 7 Adapter
- 8 Cleaning brush
- 9 Trimmer release slide
- 10 Trimmer

Important safety information

Read this important information carefully before you use the appliance and its accessories and save it for future reference. The accessories supplied may vary for different products.

Danger

- Keep the adapter dry.
- This symbol means: Forbidden to clean under a running tap.



Warning

- The adapter contains a transformer. Do not cut off the adapter to replace it with another plug, as this causes a hazardous situation.
- This appliance is not intended for use by persons (including children) with reduced physical, sensory or mental capabilities, or lack of experience and knowledge, unless they have been given supervision or instruction concerning use of the appliance by a person responsible for their safety.
- Children should be supervised to ensure that they do not play with the appliance.
- Always unplug the shaver before you clean it under the tap.
- Always check the appliance before you use it. Do not use the appliance if it is damaged, as this may cause injury. Always replace a damaged part with one of the original type.

Caution

- Never use water hotter than 80°C to rinse the shaver.
- Only use this appliance for its intended purpose as shown in the user manual.
- For hygienic reasons, the appliance should only be used by one person.
- Never use compressed air, scouring pads, abrasive cleaning agents or aggressive liquids such as petrol or acetone to clean the appliance.
- Water may drip from the socket at the bottom of the shaver when you rinse it. This is normal and not dangerous because all electronics are enclosed in a sealed power unit inside the shaver.

Electromagnetic fields (EMF)

- This Philips appliance complies with all applicable standards and regulations regarding exposure to electromagnetic fields.



General

- This symbol means: Suitable to be used in the shower.
- This shaver is waterproof. It is suitable for use in the bath or shower and for cleaning under the tap. For safety reasons, the shaver can therefore only be used without cord.
- The appliance is suitable for mains voltages ranging from 100 to 240 volts.
- The adapter transforms 100-240 volts to a safe low voltage of less than 24 volts.

Charging

Note: *The shaver cannot be used directly from the mains.*

It takes approx. 1 hour to fully charge the shaver.

When you charge the shaver for the first time or after a long period of disuse, let it charge until the charging light lights up continuously.

A fully charged shaver provides up to 50 minutes of shaving time.

The shaving time may be less than 50 minutes as a result of your shaving behaviour, your cleaning habits or your beard type.

Charge indications

Battery low

- When the battery is almost empty (when there are only 5 or fewer shaving minutes left), the charging light starts to flash orange.
- When you switch off the shaver, the charging light continues to flash orange for a few seconds.

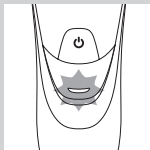

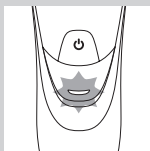

Quick charging

- When you start charging the empty battery, the charging light alternately flashes orange and green. After approx. 3 minutes the charging light continues to flash green. The shaver now contains enough energy for a 5-minute shave.

Charging

- When the shaver is charging, the charging light flashes green.

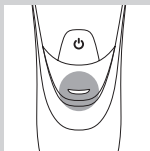

Battery fully charged

- When the battery is fully charged, the charging light lights up green continuously.

Note: After approx. 30 minutes, the charging light goes out to save energy.

Charging with the adapter

- 1 Put the small plug in the shaver.
 - 2 Put the adapter in the wall socket.
- ▶ The charging light shows the charging status of the shaver (see section 'Charge indications' in this chapter).

Charging in the charging stand

- 1 Put the small plug in the charging stand.
- 2 Put the adapter in the wall socket.
- 3 Place the shaver in the charging stand.

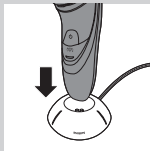

Using the shaver

Note: The shaver cannot be used directly from the mains. This shaver can be used in the bath or shower. It can therefore not be used directly from the mains for safety reasons.

Shaving tips and tricks

- This shaver is suitable for both wet and dry use. Use the shaver with shaving gel or foam for extra skin comfort, or use the shaver dry for extra convenience.

Note: We advise you to use the shaver with shaving gel or foam when you use it for a wet shave. Do not use thick shaving cream or shaving oil with this shaver.

- For optimal shaving results, make circular movements during use.
- The shaver is waterproof and can be used in the bath or shower.
- Your skin may need 2 or 3 weeks to get accustomed to the Philips shaving system.

Wet shaving

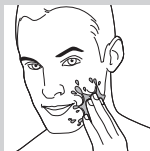

- 1** Apply some water to your skin.

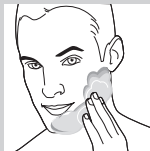

- 2** Apply shaving foam or shaving gel to your skin.
- 3** Rinse the shaving unit under the tap to ensure that the shaving unit glides smoothly over your skin.



- 4** Press the on/off button once to switch on the shaver.
- 5** Move the shaving heads in circular movements over your skin.

Note: Rinse the shaver under the tap regularly to ensure that it continues to glide smoothly over your skin.

- 6** After shaving, press the on/off button once to switch off the shaver and dry your face.
- 7** Clean the shaver (see chapter 'Cleaning and maintenance').

Note: Make sure you rinse all foam or shaving gel off the shaver.

Dry shaving

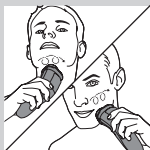

- 1** Press the on/off button once to switch on the shaver.
- 2** Move the shaving heads in circular movements over your skin.
- 3** After shaving, press the on/off button once to switch off the shaver.
- 4** Clean the shaver (see chapter 'Cleaning and maintenance').

Trimming

You can use the trimmer to groom your sideburns and moustache.



- 1** Push the trimmer slide downwards to open the trimmer.

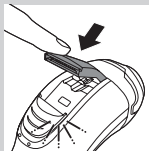

- 2** Press the on/off button once to switch on the shaver.
- ▶ You can now start trimming.
- 3** After trimming, press the on/off button once to switch off the shaver.
- 4** Clean the trimmer (see chapter 'Cleaning and maintenance').
- 5** Close the trimmer ('click').

Cleaning and maintenance

Remove the detachable cord from the handheld part before cleaning this part in water.

Never use compressed air, scouring pads, abrasive cleaning agents or aggressive liquids such as petrol or acetone to clean the appliance.

- Clean the shaver after every shave for optimal shaving performance.
- Regular cleaning guarantees better shaving performance.
- For the best cleaning results, we advise you to use the Philips Cleaning spray (HQ110).
- Be careful with hot water. Always check if the water is not too hot, to prevent your hands from getting burnt.

Note: Water may leak from the socket at the bottom of the shaver when you rinse it. This is normal and not dangerous because all electronics are enclosed in a sealed power unit inside the shaver.

Cleaning the shaving unit under the tap



- 1** Switch off the shaver and disconnect it from the mains.
- 2** Press the release button to open the shaving unit.
- 3** Rinse the shaving unit and hair chamber under a hot tap for 30 seconds.

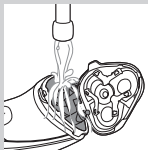

Be careful with hot water. Always check if the water is not too hot, to prevent your hands from getting burnt.

- Rinse the hair chamber and the inside of the shaving unit.
- Rinse the outside of the shaving unit.



- 4** Close the shaving unit and shake off excess water.

Be careful not to hit the shaving unit against anything while shaking off excess water.

Never dry the shaving unit and the hair chamber with a towel or tissue, as this may damage the shaving unit.

- 5** Open the shaving unit again and leave it open to let the shaver dry completely.

Cleaning the shaving unit with the cleaning brush



- 1** Switch off the shaver and disconnect it from the mains.
- 2** Press the release button to open the shaving unit.

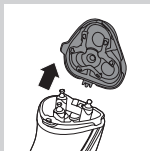

3 Pull the shaving unit off the shaver.

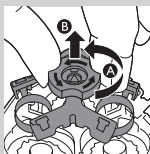

4 Turn the lock anticlockwise (A) and remove the retaining frame (B).

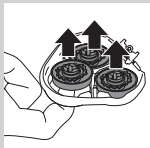

5 Remove and clean one shaving head at a time. Each shaving head consists of a cutter and a guard.

Note: Do not clean more than one cutter and guard at a time, since they are all matching sets. If you accidentally mix up the cutters and guards, it may take several weeks before optimal shaving performance is restored.

- Remove the cutter from the shaving guard and clean it with the brush.
- Clean the inside and outside of the shaving guard with the brush.

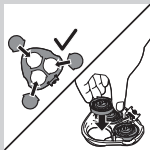
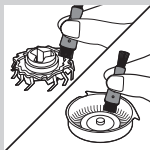

6 Put the shaving heads back into the shaving unit.

Make sure that the projections of the shaving heads fit exactly into the recesses.

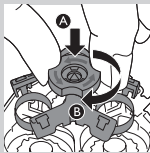

- 7** Put the retaining frame back into the shaving unit (A) and turn the lock clockwise (B).

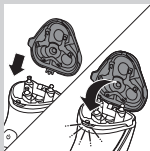

- 8** Insert the lug of the shaving unit into the slot in the top of the shaver. Then close the shaving unit.

Note: If the shaving unit does not close smoothly, check if you have inserted the shaving heads properly and if the retaining frame is locked.

Cleaning the trimmer with the cleaning brush (AT890 only)

Clean the trimmer every time you have used it.

- 1** Switch off the shaver and disconnect it from the mains.



- 2** Push the trimmer slide downwards to open the trimmer.

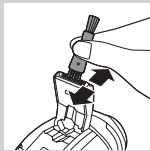

- 3** Clean the trimmer with the short-bristled side of the cleaning brush. Brush up and down along the trimmer teeth.

- 4** Close the trimmer ('click').

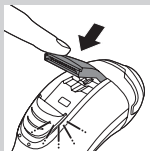

Tip: For optimal trimming performance, lubricate the trimmer teeth with a drop of sewing machine oil every six months.

Storage

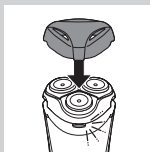

- Put the protection cap on the shaver to prevent damage.

Replacement

For maximum shaving performance, we advise you to replace the shaving heads every two years.

Replacement reminder

The shaving head symbol will light up to indicate that the shaving heads need to be replaced.

Replace damaged shaving heads right away.

Only replace the shaving heads with original HQ8 Philips Shaving Heads.



- 1** The shaving head symbol lights up orange continuously.
- 2** Switch off the shaver. Disconnect the shaver from the mains, remove it from the Jet Clean System or remove it from the charging stand.
- 3** Press the release button to open the shaving unit.

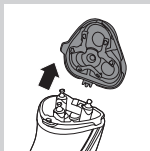
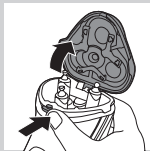

- 4** Pull the shaving unit off the shaver.

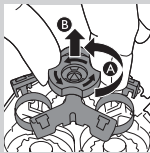

- 5** Turn the lock anticlockwise (A) and remove the retaining frame (B).

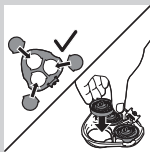

- 6** Remove the shaving heads and place new ones in the shaving unit.

Note: Make sure that the projections of the shaving heads fit exactly into the recesses.

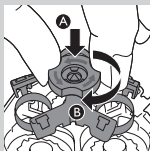

- 7** Put the retaining frame back into the shaving unit (A) and turn the lock clockwise (B).

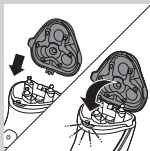

- 8** Insert the lug of the new shaving unit into the slot in the top of the shaver. Then close the shaving unit.

Note: If the shaving unit does not close smoothly, check if you have inserted the shaving heads properly and if the retaining frame is locked.

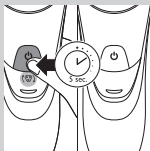

- 9** Press and hold the on/off button for 5 seconds to reset the replacement reminder on the shaver. The orange light goes out.

Ordering accessories

To buy accessories or spare parts, visit **www.shop.philips.com/service** or go to your Philips dealer. You can also contact the Philips Consumer Care Centre in your country (see the worldwide guarantee leaflet for contact details). To retain the top performance of your shaver, make sure you clean it regularly and replace its shaving heads at the recommended time.

Shaving heads

- We advise you to replace your shaving heads every two years. Always replace them with HQ8 Philips Shaving Heads.

Cleaning

- Use Cleaning spray (HQ110) to clean the shaving heads thoroughly.



Recycling

Do not throw away the appliance with the normal household waste at the end of its life, but hand it in at an official collection point for recycling. By doing this, you help to preserve the environment.

Removing the rechargeable shaver battery

Only remove the rechargeable battery when you discard the shaver. Make sure the rechargeable battery is completely empty when you remove it.

- 1** Disconnect the shaver from the mains.
- 2** Let the shaver operate until it stops.
- 3** Undo the screws in the back of the shaver and in the hair chamber.
- 4** Remove the front panel and the back panel.

5 Bend the 6 hooks aside and take out the power unit.

Be careful, the hooks are sharp.

6 Remove the battery.

Be careful, the battery strips are sharp.

Do not connect the shaver to the mains again after you have removed the rechargeable battery.

Guarantee and support

If you need information or support, please visit **www.philips.com/support** or read the separate worldwide guarantee leaflet.

Troubleshooting

This chapter summarises the most common problems you could encounter with the appliance. If you are unable to solve the problem with the information below, visit **www.philips.com/support** for a list of frequently asked questions or contact the Consumer Care Centre in your country.

Problem	Possible cause	Solution
The shaver does not shave as well as it used to.	The shaving heads are damaged or worn.	Replace the shaving heads (see chapter 'Replacement').
	Foam or gel residues clog up the shaving heads.	Rinse the shaving unit under a hot tap (see chapter 'Cleaning and maintenance').

Problem	Possible cause	Solution
	Long hairs obstruct the shaving heads.	Clean the shaving heads one by one (see chapter 'Cleaning and maintenance').
	You have not inserted the shaving heads properly.	Make sure that the projections of the shaving heads fit exactly into the recesses (see chapter 'Cleaning and maintenance').
The shaver does not work when I press the on/off button.	The rechargeable battery is empty.	Recharge the battery (see chapter 'Charging').
	The temperature of the shaver is too high. In this case, the shaver does not work.	As soon as the temperature of the shaver has dropped sufficiently, you can switch on the shaver again.
The shaver does not work, although it is connected to the mains.	If the shaver does not work when you press the on/off button, the battery is empty.	This shaver is not designed to be used directly from the mains, so you should recharge the battery (see chapter 'Charging').

简介

感谢您的惠顾，欢迎光临飞利浦！为了您能充分享受飞利浦提供的支持，请在 www.philips.com/welcome 上注册您的产品。

请阅读本用户手册，手册包含有关此剃须刀各种功能的信息以及一些使用技巧，让您的剃须体验更轻松更舒适。

基本说明 (图 1)

- 1 保护盖
- 2 剃毛刀头部件
- 3 剃须刀头部件释放按钮
- 4 剃须刀开/关按钮
- 5 充电指示灯
- 6 充电座
- 7 适配器
- 8 清洁刷
- 9 修发器释放滑块
- 10 修发器

重要安全信息

使用产品及其附件之前，请仔细阅读本重要信息，并妥善保管以供日后参考。随附的附件可能因产品而异。

危险

- 保持适配器干燥。
- 警告符号注释：禁止用在打开的水龙头下进行清洗。



警告

- 电源适配器内含有一个变压器。切勿自行更换插头，否则将导致严重后果。
- 产品不打算由有肢体、感官或精神能力缺陷或缺少使用经验和知识的人（包括儿童）使用，除非有负责他们安全的人对他们进行与产品使用有关的监督或指导。
- 请照看好儿童，本产品不能用于玩耍。
- 在自来水龙头下清洗剃须刀之前，务必拔掉其电源插头。
- 使用前，请务必检查产品。如果产品已经损坏，请勿再使用，否则可能对人体造成伤害。务必用原装型号更换损坏的部件。

警告

- 切勿使用温度高于 80° C 的热水冲洗剃须刀。
- 只能将本产品用于用户手册中所示的原定用途。
- 出于卫生的目的，本产品只能供一个人使用。
- 切勿使用压缩气体、钢丝绒、研磨性清洁剂或腐蚀性液体（例如汽油或丙酮）来清洁产品。

- 冲洗产品时，水可能从剃须刀底部的插口滴出。这是正常的，而且没有危险，因为所有的电子线路都密封在剃须刀内的一个密封壳内。

电磁场 (EMF)

- 本飞利浦产品符合所有有关暴露于电磁场的适用标准和法规。

概述

- 此符号表示：适合在淋浴中使用。
- 本剃须刀采用防水设计。其可在沐浴或淋浴时使用，也可以在水龙头下清洗。出于安全考虑，剃须刀只能在不接电源的情况下使用。
- 本产品适合在 100 - 240 伏的电源电压下工作。
- 电源适配器可将 100-240 伏的电压转换为 24 伏以下的安全低电压。



充电

注意：剃须刀不能连在电源上直接使用。

此剃须刀充满电需要大约 1 小时。

如果是第一次为剃须刀充电，或是长时间未使用后充电，应让其连续充电，直到充电指示灯持续亮起。

充满电的剃须刀可提供长达 50 分钟的剃须时间。剃须时间可能会因剃须操作、清洁习惯或胡须类型的差异而少于 50 分钟。

充电指示

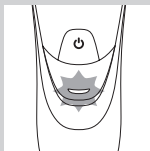

电池电量不足

- 当电池电量快要耗尽时（仅剩 5 分钟或更少的剃须时间），指电指示灯将开始闪烁橙色。
- 关闭剃须刀时，充电指示灯将持续闪烁橙色几秒钟。

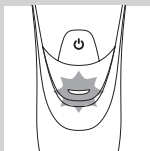

快速充电

- 开始为电量耗尽的电池充电时，充电指示灯会交替闪烁橙色和绿色。大约 3 分钟之后，充电指示灯会继续闪烁绿色。此时，剃须刀包含的电量足以完成 5 分钟剃须。

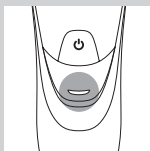

充电

- 剃须刀在充电时，充电指示灯闪烁绿色。

电池已完全充满

- 电池充满电时，充电指示灯将持续亮起绿灯。

注意：大约 30 分钟后，充电指示灯熄灭以节省能源。

使用适配器充电

- 1** 将小插头插入剃须刀。
- 2** 将电源适配器插入电源插座。
 - ▶ 充电指示灯显示剃须刀的状态（见本章中的“充电指示”一节）。

在充电座内充电

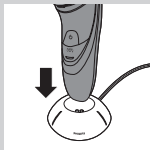

- 1** 将小插头插入充电座。
- 2** 将电源适配器插入电源插座。
- 3** 将剃须刀插接在充电座中。

使用剃须刀

注意：这款剃须刀不能直接连在电源上使用。这款剃须刀可在沐浴或淋浴过程中使用。因此，出于安全原因，其不能直接连在电源上使用。

剃须提示和诀窍

- 这款剃须刀适合干湿两用。可使用剃须啫喱或泡沫湿剃，令皮肤倍感舒爽；或采用干式剃须，更为方便。

注意：建议在湿剃时使用剃须啫喱或泡沫。请勿使用浓稠的剃毛乳液或剃毛油。

- 为获得最佳的剃须效果，请在使用时作迂回运动。
- 该剃须刀采用防水设计，可在沐浴或淋浴时使用。
- 您的皮肤可能需要 2 到 3 周才能适应飞利浦剃须系统。

湿剃

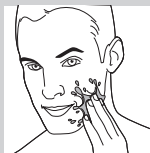

- 1** 用水润湿一下皮肤。

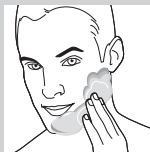

- 2** 在皮肤上涂上剃须泡沫或剃须啫喱。
- 3** 在水龙头上冲洗一下剃须刀头部件，确保剃须刀头部件可以在您的皮肤上顺畅滑动。
- 4** 按一下开/关按钮以启动剃须刀。



5 将剃须刀头在您的皮肤上作迂回运动。

注意：在水龙头下定期冲洗剃须刀，确保其能够继续在您的皮肤上顺畅滑动。

6 剃须后，按一下开/关按钮关闭剃须刀电源并把脸擦干。

7 清洁剃须刀（见“清洁和保养”一章）。

注意：确保冲洗干净剃须刀上的泡沫或剃须啫喱。
干电式剃须刀



1 按一下开/关按钮以启动剃须刀。

2 将剃须刀头在您的皮肤上作迂回运动。

3 剃须后，按一下开/关按钮关闭剃须刀电源。

4 清洁剃须刀（见“清洁和保养”一章）。

修发

您可使用修剪器修剪鬓角和小胡子。

1 向下推修剪器的滑动开关可打开修剪器。

2 按一下开/关按钮以启动剃须刀。

▶ 现在可以开始修剪了。

3 修剪后，按一下开/关按钮关闭剃须刀电源。

4 清洁修剪器（见“清洁和保养”一章）。

5 关闭修剪器（可听到“咔哒”一声）。

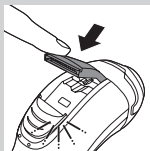
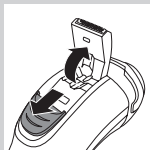

清洁和保养

将手持部分与电源线分开后，才能在水中清洗手持部分。

切勿使用压缩气体、钢丝绒、研磨性清洁剂或腐蚀性液体（例如汽油或丙酮）来清洁产品。

- 每次剃须后清洁剃须刀，以获得最佳的剃须性能。
- 为保证更好的剃须效果，剃须刀必须定期清洗。
- 为了获得最佳的清洁效果，建议您使用飞利浦清洁喷雾剂 (HQ110)。
- 使用热水时一定要小心。切记先检查水温是否太高，以防烫手。

注意：冲洗产品时，水可能从剃须刀底部的插口漏出。这是正常的，而且没有危险，因为所有的电子线路都密封在剃须刀内的一个密封壳内。

在水龙头下冲洗剃须刀头部件

1 关闭剃须刀电源，将其插头从插座上拔下。

2 按下释放按钮，打开剃须刀头部件。

3 在热水龙头下将剃须刀头部件和胡茬储藏室冲洗 30 秒。

使用热水时一定要小心。切记先检查水温是否太高，以防烫手。

- 冲洗胡茬储藏室和剃须刀头部件内部。

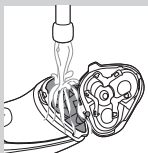



- 冲洗剃须刀头部件外侧。

4 关闭剃须刀头部件并甩掉多余的水份。

甩掉多余的水份时，小心不要使剃须刀头部件敲到任何东西。

不要用毛巾或纸巾来擦干剃须刀头部件和胡茬储藏室，因为这样可能会损坏剃须刀头部件。

5 再次打开剃须刀头部件，使它保持打开状态，使其完全晾干。

用随附的刷子清洁剃须刀头部件



1 关闭剃须刀电源，将其插头从插座上拔下。

2 按下释放按钮，打开剃须刀头部件。

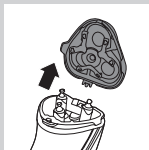

3 将剃须刀头部件拉出剃须刀。

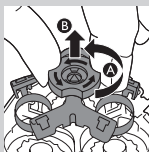

4 逆时针转动锁定装置 (A)，取下固定架 (B)。

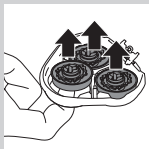

- 5** 一次取下并清洁一个剃须刀头。每个剃须刀头包含一组刀片和网罩。

注意：不要同时清洁多组刀片和网罩，因为它们都是相互匹配的。如果不小心将刀片和网罩弄混，则需要数周时间才能恢复产品的最佳剃须性能。

- 从网罩取下刀片并用清洁刷进行清洁。
- 用清洁刷里里外外清洁网罩。

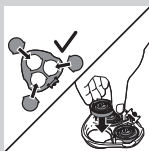
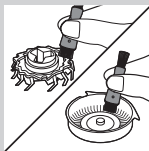

- 6** 将剃须刀头重新放入剃须刀头部件。

确保剃须刀头凸起部位正好插入凹陷部位。

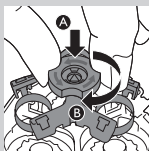

- 7** 将固定架放回剃须刀头部件 (A)，顺时针转动锁定装置 (B)。

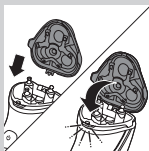

- 8** 将剃须刀头部件的凸缘插入剃须刀顶部的槽内。然后关闭剃须刀头部件。

注意：如果剃须刀头部件关闭不畅，请检查剃须刀头插入是否正确，固定架是否被锁住。

使用清洁刷清洁修发器（仅限于 AT890）

每次使用后都要清洁修剪器。

- 1** 关闭剃须刀电源，将其插头从插座上拔下。
- 2** 向下推修剪器的滑动开关可打开修剪器。
- 3** 使用清洁刷的短毛一侧清洁修剪器。沿着修剪器齿上下刷净。
- 4** 关闭修发器（可听到“咔哒”一声）。

提示：为获得最佳修剪性能，请每隔六个月用一滴缝纫机油润滑修剪器齿。

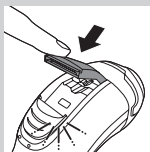
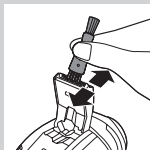

存储

- 盖上剃须刀保护盖，以防受损。

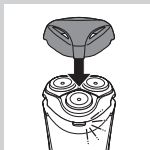

更换

为获得最佳剃须效果，建议每两年更换一次剃须刀头。

更换提醒

剃须刀头符号会亮起，指示需要更换剃须刀头。应立即更换损坏的剃须刀头。只能用原装 HQ8 飞利浦剃须刀头进行更换。

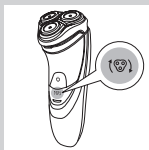

1 剃须刀头符号会呈橙色持续亮起。



2 关闭剃须刀。断开剃须刀电源并将其从高效能清洁系统或充电座中取下。

3 按下释放按钮，打开剃须刀头部件。

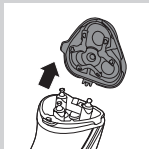

4 将剃须刀头部件拉出剃须刀。

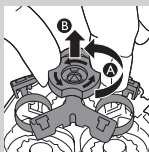

5 逆时针转动锁定装置 (A)，取下固定架 (B)。

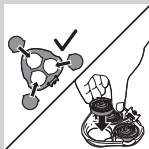

6 取下剃须刀头，在剃须刀头部件上装上新刀头。
注意：确保剃须刀头凸起部位正好插入凹陷部位。

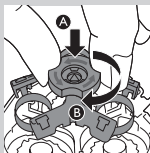

- 7** 将固定架放回剃须刀头部件 (A)，并顺时针转动锁定装置 (B)。

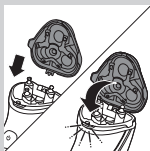

- 8** 将新剃须刀头部件的凸缘插入剃须刀顶部的槽内。然后关闭剃须刀头部件。

注意：如果剃须刀头部件关闭不畅，请检查剃须刀头插入是否正确，固定架是否被锁住。

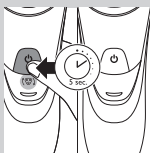

- 9** 按住开/关按钮 5 秒钟可重置剃须刀更换提醒。橙色指示灯会熄灭。

订购附件

要购买附件和备件，请访问 www.shop.philips.com/service 或 请联系飞利浦经销商。您也可以联系您所在国家/地区的飞利浦客户服务中心

（联系详情，请参阅全球保修卡）。

为了保持剃须刀的最佳性能，请确保定期清洁并在推荐的时间更换剃须刀头。

剃须刀头

- 建议您每两年更换一次剃须刀头。务必使用飞利浦 HQ8 剃须刀头进行更换。

清洁

- 使用清洁喷雾剂 (HQ110) 彻底清洁剃须刀头。



回收

弃置产品时，请不要将其与一般生活垃圾扔在一起，应将其交给指定的回收中心，这样做有利于环保。

卸下剃须刀的充电电池

只有在丢弃剃须刀时才可取下充电电池。
请确保在取下充电电池时电量已完全耗尽。

- 1** 切断剃须刀电源。
- 2** 让剃须刀运行至停转。
- 3** 拧下剃须刀背面和胡茬储藏室内的螺钉。
- 4** 拆下前面板和后面板。
- 5** 将 6 个钩子向外掰，取出电源部件。

注意，钩子非常锋利。

- 6** 取出电池。

注意，电池带非常锋利。

取出充电电池之后，不要再将剃须刀与电源相连。

保修和支持

如果您需要信息或支持，请访问 www.philips.com/support 或阅读单独的全球保修卡。

故障种类和处理方法

本章归纳了使用本产品时最常见的一些问题。如果您无法根据以下信息解决问题，请访问 www.philips.com/support 查阅常见问题列表，或联系您所在国家/地区的客户服务中心。

问题	可能的原因	解决方法
剃须刀的剃须效果没有以前好。	剃须刀头已损坏或磨损。	更换剃须刀头（见“更换”一章）。
	剃须泡沫或剃须啫喱堵塞了剃须刀头。	在热水龙头下冲洗剃须刀头部件（见“清洁和保养”一章）。
	过长的胡须堵塞了剃须刀头。	逐一清洁剃须刀头（见“清洁和保养”一章）。
	您没有正确插入剃须刀头。	确保剃须刀头凸起部位正好插入凹陷部位（见“清洁和保养”一章）。
按下开/关按钮时，剃须刀不工作。	充电电池的电量已耗尽。	给电池充电（见“充电”一章）。
	剃须刀的温度过高。此时，剃须刀无法工作。	一旦剃须刀降到足够低的温度，便可重新打开剃须刀。
尽管已接上电源，但剃须刀不工作。	如果按开/关按钮时剃须刀不工作，则可能是电池的电量已耗尽。	这款剃须刀不可直接插电使用，请在充电后使用（见“充电”一章）。

PHILIPS

产品 : 飞利浦电动剃须刀
型号 : AT800
额定电压 : 220V~
额定频率 : 50Hz
额定输入功率 : 9 W
生产日期 : 请见产品本体
产地 : 中国广东珠海



珠海经济特区飞利浦家庭电器有限公司
中国珠海市三灶镇琴石工业区
全国顾客服务热线: 4008 800 008

本产品根据国标 GB4706.1-2005, GB4706.9-2008制造

保留备用

发行日期 : 10/02/2015



www.philips.com



100% recycled paper
100% 循环再造纸

4222.002.5755.1