

Register your product and get support at
www.philips.com/welcome

HP4887, HP4886



PHILIPS



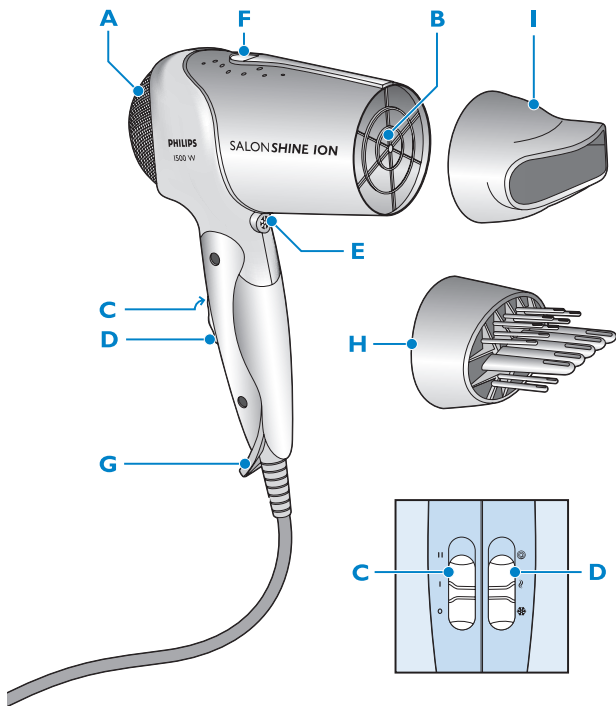

ENGLISH 6

简体中文 12

Introduction

Congratulations on your purchase and welcome to Philips! To fully benefit from the support that Philips offers, register your product at www.philips.com/welcome.

The Philips SalonShine Ion hairdryer has been specially designed to meet your personal needs, allowing you to dry your hair at a constant caring temperature, for healthy, shiny, frizz-free hair. The ioniser inside emits negatively charged ions that surround your hair. Negative ions reduce the build-up of static electricity and help to keep your hair in good condition, making it shiny, smooth and frizz-free.

General description (Fig. 1)

- A** Air inlet grille
- B** Air outlet grille
- C** Airflow slide switch
 - O = off
 - I = gentle airflow especially intended for styling
 - II = strong airflow for quick drying
- D** Temperature slide switch
 - ☉ = Quick-Dry setting
 - ☼ = Thermoprotect setting
 - ❄ = Cool Care setting
- E** Cool shot button
- F** Ion button with ion indicator light
- G** Hanging loop
- H** Comb diffuser (HP4887 only)
- I** Concentrator

Important

Read this user manual carefully before you use the appliance and save it for future reference.

Danger

- Keep the appliance away from water (Fig. 2). Do not use it near or over water contained in baths, washbasins, sinks etc. When you use

the appliance in a bathroom, unplug it after use. The proximity of water presents a risk, even when the appliance is switched off.

- Do not insert metal objects into the air grilles to avoid electric shock.

Warning

- Check if the voltage indicated on the appliance corresponds to the local mains voltage before you connect the appliance.
- Check the condition of the mains cord regularly. Do not use the appliance if the plug, the mains cord or the appliance itself is damaged.
- If the mains cord is damaged, you must have it replaced by Philips, a service centre authorised by Philips or similarly qualified persons in order to avoid a hazard.
- This appliance is not intended for use by persons (including children) with reduced physical, sensory or mental capabilities, or lack of experience and knowledge, unless they have been given supervision or instruction concerning use of the appliance by a person responsible for their safety.
- Children should be supervised to ensure that they do not play with the appliance.

Caution

- For additional protection, we advise you to install a residual current device (RCD) in the electrical circuit that supplies the bathroom. This RCD must have a rated residual operating current not higher than 30mA. Ask your installer for advice.
- Never block the air grilles.
- If the appliance overheats, it switches off automatically. Unplug the appliance and let it cool down for a few minutes. Before you switch the appliance back on, check the grilles to make sure they are not blocked by fluff, hair, etc.
- Always switch off the appliance before you put it down, even if it is only for a moment.
- Do not use the appliance on artificial hair.
- Do not use the appliance for any other purpose than intended.
- Always unplug the appliance after use.
- Do not wind the mains cord round the appliance.

- Never use any accessories or parts from other manufacturers or that Philips does not specifically recommend. If you use such accessories or parts, your guarantee becomes invalid.
- You may notice a characteristic odour when you use this hairdryer. This is caused by the ions that are generated and it is not harmful to the human body.

Electromagnetic fields (EMF)

This Philips appliance complies with all standards regarding electromagnetic fields (EMF). If handled properly and according to the instructions in this user manual, the appliance is safe to use based on scientific evidence available today.

Using the appliance

Drying

- 1 Put the plug in the wall socket.**
- 2 Set the airflow slide switch to the desired setting to switch on the appliance (Fig. 3).**
 - Set the airflow slide switch to setting II for ultra-quick drying.
 - Set the airflow slide switch to setting I for drying short hair or styling your hair.
- 3 Set the temperature slide switch to the Quick-Dry, Thermoprotect or Cool Care setting.**

Quick-Dry setting ☉

- The Quick-Dry setting dries shower-wet hair very quickly and safely. (Fig. 4)

It is recommended to use the Quick-Dry setting only briefly to avoid dehydrating your hair.

Thermoprotect setting ☿

- The Thermoprotect setting quickly and gently dries the hair at a constant, caring temperature of 57°C. (Fig. 5)

Cool Care setting ❄️

- The Cool Care setting dries your hair with care and helps to seal in shine (Fig. 6).
- 4** To dry your hair, make brushing movements with the hairdryer at a small distance from the hair (Fig. 7).
- 5** When you have finished drying, press the cool shot button for a cool airflow. This closes the cuticles and adds shine to the hair (Fig. 8).
- 6** Set the airflow slide switch to **O** to switch off the appliance.

Ion function

The ion function provides additional shine and reduces frizz and static electricity. It is particularly suitable for dry and almost-dry hair.

- 1** Press the ion button to switch on the ion function.
- ▶ The ion indicator light goes on to indicate that the ion function has been activated.

Attachments

Concentrator

The concentrator directs the airflow straight at the brush or comb with which you are styling your hair.

- 1** To connect the concentrator, simply snap it onto the appliance (Fig. 9).
- 2** To disconnect the concentrator, pull it off the appliance.

Comb diffuser (HP4887 only)

The comb diffuser has been specially developed to gently dry and style both straight and curly or wavy hair.

The comb diffuser emits a gentle airflow and allows you to give your style volume, bounce and additional shine.

- 1** To connect the comb diffuser, simply snap it onto the appliance (Fig. 10).
- 2** To disconnect the comb diffuser, pull it off the appliance.

Cleaning

Never immerse the appliance in water or any other liquid, nor rinse it under the tap.

- 1 Switch off the appliance and unplug it.
- 2 Clean the appliance with a dry cloth.
- 3 Remove any attachment from the appliance before you clean the attachment.
- 4 Clean the attachments with a moist cloth or rinse them under the tap.
- 5 Dry the attachments before you use or store them.

Storage

Do not wind the mains cord round the appliance.

- 1 Switch off the appliance and unplug it.
- 2 Put the appliance in a safe place and let it cool down.
- 3 You can store the appliance by hanging it from its hanging loop (Fig. 11).

Environment

- Do not throw away the appliance with the normal household waste at the end of its life, but hand it in at an official collection point for recycling. By doing this, you help to preserve the environment (Fig. 12).

Guarantee & service

If you need service or information or if you have a problem, please visit the Philips website at **www.philips.com** or contact the Philips Consumer Care Centre in your country (you find its phone number in the worldwide guarantee leaflet). If there is no Consumer Care Centre in your country, go to your local Philips dealer.

Troubleshooting

This chapter summarises the most common problems you could encounter with the appliance. If you are unable to solve the problem with the information below, contact the Consumer Care Centre in your country.

Problem	Possible cause	Solution
The appliance does not work.	There is a power failure or the socket to which the appliance is connected is not live.	Check if the power supply works. If it does, plug in another appliance to check whether the socket is live.
	The appliance has overheated and switched itself off.	Before you switch on the appliance again, check the grilles to make sure they are not blocked by fluff, hair, etc.
	The appliance is not suitable for the voltage to which it is connected.	Make sure that the voltage indicated on the appliance corresponds to the local mains voltage.
	The mains cord is damaged	If the mains cord is damaged, you must have it replaced by Philips, a service centre authorised by Philips or similarly qualified persons in order to avoid a hazard.

产品简介

感谢您的惠顾，欢迎光临飞利浦！为了您能充分享受飞利浦提供的支持，请注册您的产品，网址为 www.philips.com/welcome。飞利浦 SalonShine 负离子恒温护发电吹风经特别设计，旨在满足您的个人需求，让您能够以恒定的护发温度吹干头发，令秀发更加健康亮泽、顺滑无比。吹风机内部的负离子发生器可产生负离子，围绕您的秀发，让您的秀发得到全方位呵护。负离子能减少静电，为您的头发提供极佳的环境，使头发亮泽、润滑、柔顺。

一般说明 (图 1)

- A** 空气入口
- B** 出风口
- C** 气流滑动开关
 - O = 关闭
 - I = 柔和气流，特别适合定型
 - II = 强风，适合快速吹干
- D** 温度滑动开关
 - ☉ = 快速干发设置
 - ☼ = 过热保护设置
 - ❄ = 冷风护理设置
- E** 护发冷风喷出钮
- F** 带负离子指示灯的负离子按钮
- G** 挂环
- H** 扩散型柔风嘴（仅限 HP4887）
- I** 集风嘴

注意事项

使用产品之前，请仔细阅读本使用说明书，并妥善保管以备日后参考。

危险

- 请不要让本产品与水接触 (图 2)。不要在盛水的浴池、洗脸盆或其它容器内或附近使用。如在浴室中使用，应在使用完毕后拔下插头。即使产品开关断开后，接近水仍存在危险。
- 切勿将金属物体插入风口，以免触电。

警告

- 在将产品连接电源之前，请先检查产品所标电压与当地的供电电压是否相符。
- 定期检查电源线的情况。如果插头、电源线或产品本身已损坏，请勿再使用本产品。
- 如果电源软线损坏，为避免危险，必须由制造厂或其维修部或类似的专职人员来更换。
- 本产品不打算由肢体不健全、感觉或精神上有障碍或缺乏相关经验和知识的人（包括儿童）使用，除非有负责他们安全的人对他们使用本产品进行监督或指导。
- 应照看好儿童，确保他们不玩耍这些产品。

注意

- 有关其它保护措施，建议在浴室的电路中安装一个漏电保护器(RCD)。RCD必须具有不超过30mA 的额定漏电动作电流。有关建议，请咨询安装人员。

14 简体中文

- 切勿阻塞电吹风风口。
- 如果产品过热，它将自动关闭电源。拔下产品电源并让其冷却几分钟。再次打开产品电源前，请检查空气入口，确保没有绒毛、头发等杂物将其堵塞。
- 即使只将产品放下片刻，也应始终将其电源关闭。
- 请勿对假发使用本产品。
- 请勿将本产品用于原定用途之外的任何其它用途。
- 使用后务必拔下产品的插头。
- 切勿将电源线缠绕在产品上。
- 切勿使用其它制造商生产的或未经飞利浦特别推荐的附件或部件。如果您使用了此类附件或部件，则本产品的保修将会失效。
- 使用此电吹风时，可能会闻到特殊的气味，这是所产生的负离子的气味，对人体无害。

电磁场 (EMF)

这款飞利浦产品符合关于电磁场 (EMF) 的相关标准。据目前的科学证明，如果正确使用并按照本用户手册中的说明进行操作，本产品是安全的。

使用本产品

吹干

- 1 将插头插入插座。

- 2** 将风速滑动开关设定为所需设置，从而打开产品电源。(图 3)
- 将风速滑动开关设为 II 档以进行快速干发。
 - 将风速滑动开关设为 I 档以吹干短发或制作发型。

- 3** 将温度滑动开关设为快速干发、热保护或冷风护理设置。

快速干发设置 ☉

- 快速干发设置可快速安全地吹干淋湿的头发。(图 4)
- 建议您仅使用短时间的快速干发设置，以免头发脱水。

过热保护设置 ☹

- 使用过热保护设置可在恒定的 57° C 护发温度下快速柔和地吹干头发。(图 5)

冷风护理设置 ❄

- 使用冷风护理设置可在吹干头发的同时呵护您的秀发，并锁住头发光泽。(图 6)

- 4** 若要吹干头发，可以握住电吹风，在头发附近来回移动。(图 7)

- 5** 完成干发过程后，按冷风喷出钮可喷出冷风。这样可以收紧头发表层，为秀发增添光泽。(图 8)

- 6** 将风速滑动开关设定在 O 的位置，从而关闭产品电源。

负离子功能

负离子功能可减少头发毛躁和静电，令秀发倍加亮泽。它特别适合已干或即将干的头发。

- 1** 按负离子按钮打开负离子功能。
- ▶ 负离子指示灯亮起表示负离子功能已激活。

附件

集风嘴

集风嘴可以将气流直接引导到您用于塑造发型的发梳上。

- 1** 要连接集风嘴，只需将其扣合到产品上。(图 9)
- 2** 将集风嘴从产品上拔出即可取下。

16 简体中文

扩散型柔风嘴（仅限 HP4887）

扩散型柔风嘴经特别设计，适用于轻柔地吹干和制作直发、卷发或波浪形发型。

扩散型柔风嘴可吹出轻柔暖风，让您做出丰盈有弹性且倍加亮泽的发型。

- 1 要连接梳形扩散风嘴，只需将其扣合到产品上。(图 10)
- 2 将梳形扩散风嘴从产品上拔出即可取下。

清洁

不要将本产品浸入水中，也不要在水龙头下冲洗。

- 1 关闭产品并拔下电源插头。
- 2 必须用干布清洁产品。
- 3 清洁任何附件之前，应将其从产品上卸下。
- 4 附件可用湿布清洁或在水龙头下冲洗。
- 5 在使用或存放之前先将附件擦干。

存放

切勿将电源线缠绕在产品上。

- 1 关闭产品并拔下电源插头。
- 2 将产品放在安全的地方，让其冷却。
- 3 本产品可以用挂环挂起存放。(图 11)

环境

- 弃置产品时，请不要将其与一般生活垃圾堆放在一起；应将其交给官方指定的回收中心。这样做有利于环保。(图 12)

保修与服务

如果您需要服务或信息，或如果您有任何疑问，请访问飞利浦网站：www.philips.com。也可与您所在地的飞利浦顾客服务中心联系（可从全球保修卡中找到电话号码）。如果您的所在地没有飞利浦客户服务中心，可与当地的飞利浦经销商联系。

故障种类和处理方法

本章归纳了使用本产品时最可能遇到的问题。如果您无法根据下面的信息解决问题，请与贵国（地区）的飞利浦客户服务中心联系。

问题	可能的原因	解决方法
产品不能工作。	电源存在故障，或产品所连接的插座没有通电。	检查供电是否正常。如果可以正常供电，请将另一台产品插入插座，检查插座是否已损坏。
	产品过热，已自行关闭电源。	再次打开产品电源之前，请检查出风口，确保没有被绒毛、头发等杂物堵塞。
	产品的额定电压与其连接的电源电压不符。	确保产品上标示的电压与当地的电源电压相符。
	电源线损坏	如果电源软线损坏，为避免危险，必须由制造厂或其维修部或类似的专职人员来更换。

此规格只适用于中国

PHILIPS

/00

产品 : 飞利浦电吹风
 型号 : HP 4886
 额定电压 : 220V~
 额定频率 : 50Hz
 额定输入功率: 1400W
 产地 : 中国
 生产日期 : 请见产品手柄

珠海经济特区飞利浦家庭电器有限公司
 珠海市三灶镇琴石工业区 邮编:519040
 电话: (0756) 7621898
 全国顾客免费服务热线: 4008 800 008

本产品根据GB4706.1-1998及GB4706.15-2003,
 GB4343.1-2003及GB17625.1-2003制造

请妥善保管本使用说明书
 发行日期: 2008/09/16

此规格只适用于中国

PHILIPS

/00

产品 : 飞利浦电吹风
 型号 : HP 4887
 额定电压 : 220V~
 额定频率 : 50Hz
 额定输入功率: 1500W
 产地 : 中国
 生产日期 : 请见产品手柄

珠海经济特区飞利浦家庭电器有限公司
 珠海市三灶镇琴石工业区 邮编:519040
 电话: (0756) 7621898
 全国顾客免费服务热线: 4008 800 008

本产品根据GB4706.1-1998及GB4706.15-2003,
 GB4343.1-2003及GB17625.1-2003制造

请妥善保管本使用说明书
 发行日期: 2008/09/16

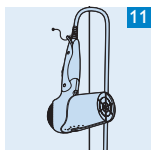
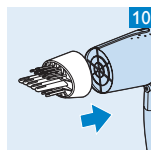
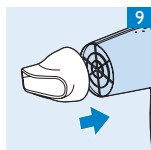
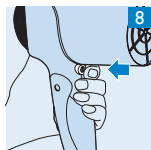
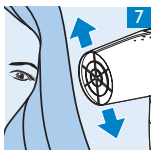
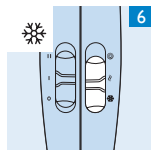
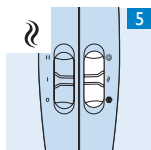
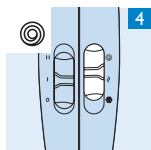
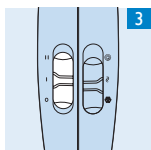



www.philips.com



100% recycled paper
100% papier recyclé

4222.002.6380.2