

- After charging, remove the supply unit from the wall socket and pull the small plug out of the appliance.

Optimising the lifetime of the rechargeable battery

When you have charged the appliance for the first time, we advise you to use it until the battery is completely empty. Continue to use the appliance until the motor almost stops operating during a session. Then recharge the battery. Follow this procedure at least twice a year.

Using the appliance

The hair length settings are indicated in millimeters, the comb cuts the hair to a length of 1mm to 23mm. The settings correspond to the remaining hair length after trimming.

Warning: Be careful when you trim for the first time. Do not move the trimmer too fast. Make smooth and gentle movements.

Tip: Start trimming at a high length setting and reduce the length setting gradually until you have reached the desired hair length.

Trimming with comb

- Attach the trimming comb to the appliance (Fig. 6).
 - Slide the length setting adjustment slider to the desired length setting (Fig. 7).
- Note: When you trim for the first time, start at the highest length setting to familiarise yourself with the appliance.
- Switch on the appliance (Fig. 8).
 - Move the appliance slowly and with light pressure against the direction of hair growth (Fig. 9).

Note: Make sure that the flat part of the comb always stays in contact with the skin to obtain an even result (Fig. 10).

Trimming with the kids comb

- Attach the kids comb to the appliance (Fig. 11).
- Slide the length setting adjustment slider to the desired length setting (Fig. 12).

Note: When you trim for the first time, start at the highest length setting to familiarize yourself with the appliance.

- Switch on the appliance (Fig. 8).
- Move the appliance slowly and with light pressure against the direction of hair growth (Fig. 13).

Note: Make sure that the flat part of the comb always stays in contact with the skin to obtain an even result (Fig. 10).

Using the thinning comb

Use the thinning comb to thin out your hair.

- Attach the thinning comb to the appliance (Fig. 14).
- Switch on the appliance (Fig. 8).
- Move the comb from the root to the hair end to create a layered effect (Fig. 15).

Trimming without comb

Use the trimmer without the trimming comb to trim hair close to the skin (0.5 mm) or to contour the neckline and sideburns.

Caution: Be careful when you trim without comb because the cutting unit removes every hair it touches.

- Pull the comb off the appliance (Fig. 16).
- Switch on the appliance (Fig. 8).
- Touch the hair lightly with the trimmer. Make well-controlled movements (Fig. 17).

Cleaning

Warning: Never use scouring pads, abrasive cleaning agents or aggressive liquids such as petrol or acetone to clean the appliance.

Warning: Never immerse the appliance in water, or rinse it under the tap.

Note: Only the cutting element and the comb can be cleaned with water.

- Make sure that the appliance is switched off and disconnected from the mains.
- Wipe the housing of the appliance with a dry cloth.
- Remove the comb. Clean it with the cleaning brush and rinse with water (Fig. 18).
- Press the release button. The cutting unit comes off the appliance (Fig. 19).
- Clean the cutting unit with the cleaning brush or rinse it under the tap (Fig. 20).
- Clean the inside of the appliance with the cleaning brush (Fig. 21).
- Shake off excess water. To reattach the cutting unit, insert the lug of the cutting unit into the guiding slot.
- Insert the lug of the cutting unit into the guiding slot and push the cutting unit back onto the appliance (Fig. 22).

Replacement

Only replace a worn or damaged cutting unit with an original Philips cutting unit, available from authorised Philips service centre.

- Press the release button. The cutting unit comes off the appliance (Fig. 19).
- Insert the lug of the new cutting unit into the guiding slot and push the cutting unit onto the appliance (Fig. 22).

Ordering accessories

To buy accessories or spare parts, visit www.shop.philips.com/service or go to your Philips dealer. You can also contact the Philips Consumer Care Center in your country (see the international warranty leaflet for contact details).

Recycling

- Do not throw away the product with the normal household waste at the end of its life, but hand it in at an official collection point for recycling. By doing this, you help to preserve the environment.
- This product contains a built-in rechargeable

battery shall not be disposed of with normal household waste. Please take your product to an official collection point or a Philips service center to have a professional remove the rechargeable battery.

- Follow your country's rules for the separate collection of electrical and electronic products and rechargeable batteries. Correct disposal helps prevent negative consequences for the environment and human health.

Removing the rechargeable battery

Only remove the rechargeable battery when you discard the product. Before you remove the battery, make sure that the product is disconnected from the wall socket and that the battery is completely empty.

Take any necessary safety precautions when you handle tools to open the product and when you dispose of the rechargeable battery.

The battery must be removed from the appliance before it is scrapped.

Removing the rechargeable battery

- Disconnect the appliance from the mains and let the appliance operate until the motor stops.
- Remove the length adjustment slider with a flathead screwdriver (Fig. 23).
- Press the release button. The cutting unit comes off the appliance (Fig. 24).
- Insert a flathead screwdriver into the slots between the front and back panel. Tilt the handle of the screwdriver to separate the front and back panel (Fig. 25).
- Continue this step along the edge of the front panel to separate the front panel from the back panel (Fig. 26).
- Use a flathead screwdriver to unscrew the screws next to the length adjustment slider (Fig. 27).
- Pull the inner body from the back panel (Fig. 28).
- Pull the circuit board from the inner body (Fig. 29).
- Cut the wires to separate the circuit board from the inner body (Fig. 30).
- Cut the connectors from the batteries and remove the batteries (Fig. 31).

Danger: Do not connect the appliance to the mains again after you have opened it.

Warranty and support

If you need information or support, please visit www.philips.com/support or read the international warranty leaflet.

Troubleshooting

This chapter summarizes the most common problems you could encounter with the appliance. If you are unable to solve the problem with the information below, visit www.philips.com/support for a list of frequently asked questions or contact the Consumer Care Center in your country.

Problem	Possible cause	Solution
The appliance produces an uneven cutting result.	The comb does not touch the skin when you move the appliance through the hair.	Make sure the comb is always fully in contact with the skin when you move the appliance through the hair.
	You only move the appliance in one direction.	Because not all hairs grow in the same direction, move the appliance in different directions (upwards, downwards and across).
	The setting of the comb has changed during trimming.	Check the setting of the comb. If you push the appliance too hard onto the scalp, you may accidentally change the setting of the comb.
	The comb is not assembled correctly.	Detach the comb and reattach it.
	The cutting performance decreases when the cutting unit and the comb are dirty.	Clean the cutting unit and the comb (see 'Cleaning').
The appliance does not work when I switch it on.	The rechargeable battery is empty.	Charge the appliance. Make sure that the small plug is inserted into the appliance properly and the adapter is connected to the wall socket properly.

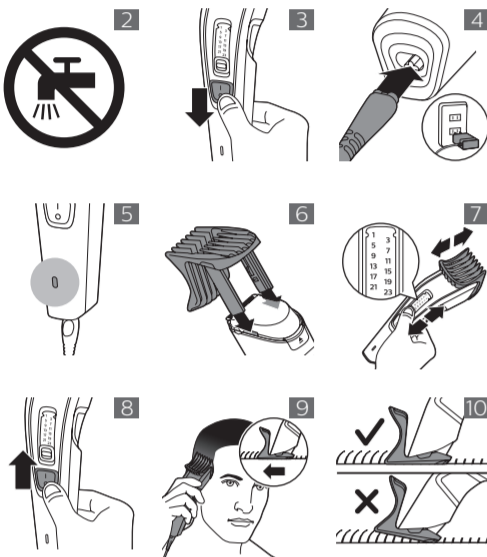

Introduction

Congratulations on your purchase and welcome to Philips! To fully benefit from the support that Philips offers, register your product at www.philips.com/welcome

General description (Fig. 1)

- Trimming comb 1-23mm
- Kids comb 1-23mm
- Thinning comb
- Cutting unit
- Length setting adjustment slider
- On/off button
- Charging light
- Supply unit
- Small plug
- Brush

Important safety information

Read this important information carefully before you use the appliance and save it for future reference.

Danger

- Keep the supply unit dry (Fig. 2).

Warning

- To charge the battery, only use the detachable supply unit (HQ8505) provided with the appliance.
- The supply unit contains a transformer. Do not cut off the supply unit to replace it with another plug, as this causes a hazardous situation.
- This appliance can be used by children aged from 8 years and above and persons with reduced physical, sensory or mental capabilities or lack of experience and knowledge if they have been given supervision or instruction concerning use of the appliance in a safe way and understand the hazards involved. Children shall not play with the appliance. Cleaning and user maintenance shall not be made by children without supervision.
- Always check the appliance before you use it. Do not use the appliance if it is damaged, as this may cause injury. Always replace a damaged part with one of the original type.
- Do not open the appliance to replace the rechargeable battery.

Caution

- This appliance is not washable. Never immerse the appliance in water and do not rinse it under the tap (Fig. 2).
- Only use this appliance for its intended purpose as shown in the user manual.
- For hygienic reasons, the appliance should only be used by one person.
- Never use compressed air, scouring pads, abrasive cleaning agents or aggressive liquids such as petrol or acetone to clean the appliance.
- Do not use the supply unit in or near wall sockets that contain an electric air freshener to prevent irreparable damage to the supply unit.

Electromagnetic fields (EMF)

This Philips appliance complies with all applicable standards and regulations regarding exposure to electromagnetic fields.

General

- The supply unit is suitable for mains voltages ranging from 100 to 240 volts.
- The supply unit transforms 100-240 volts to a safe low voltage of less than 24 volts.

Charging

Charge the appliance fully before you use it for the first time or if you have not used it for a long time. It takes approximately 8 hours to fully charge the appliance.

When the appliance is fully charged, the appliance has a cordless operating time of up to 75 minutes.

Note: After charging the appliance once fully for the first time, you can also use the appliance directly from the mains. Simply connect the appliance to the mains.

Charging with the supply unit

- Make sure the appliance is switched off (Fig. 3).
- Insert the small plug into the appliance (Fig. 4).
- Put the supply unit in the wall socket.
- When the appliance is charging, the charging light lights up continuously (Fig. 5).

