

**PHILIPS**

**NORELCO**

QP2510



BC

Manufactured for: Philips Personal Health  
a division of Philips North America LLC  
P.O. Box 10313, Stamford, CT 06904, USA



This symbol on the product's nameplate means it is listed by Underwriters' Laboratories, Inc.

Norelco is a registered trademark of Philips North America LLC.

PHILIPS and Philips shield are registered trademarks of Koninklijke Philips N.V.

©2019 Philips North America LLC. All rights reserved.

4222.002.9247.1 (8/8/2019)



>75 % recycled paper  
>75 % papier recyclé

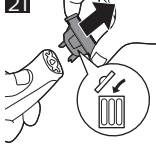
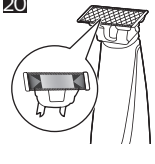
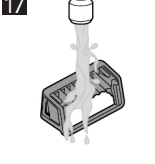
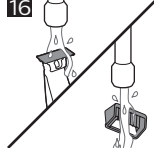
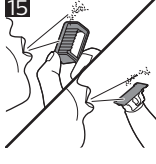
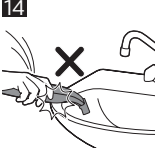
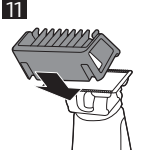
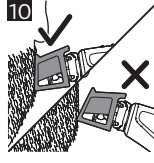
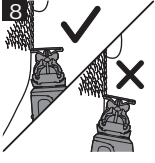
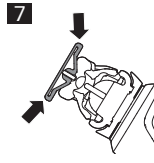
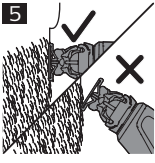
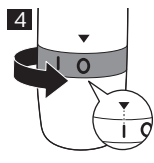
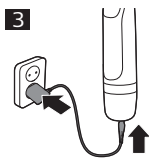

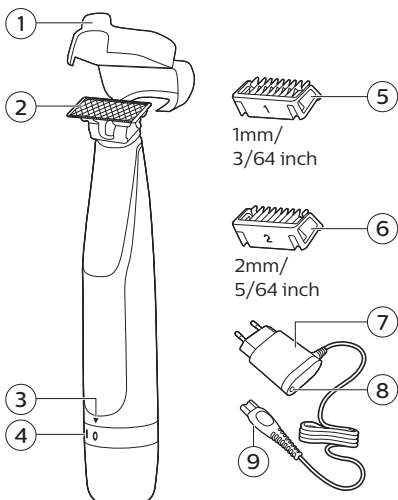
**1**

English

## IMPORTANT SAFETY INSTRUCTIONS

When using an electric product, basic precautions should always be followed, including the following:

**Read all instructions before using this product.**

### DANGER

**To reduce the risk of electric shock:**

- Do not reach for a corded product that has fallen into water. Unplug immediately from the power outlet.
- Keep the power cord dry.
- Do not place or store the product where it can fall or be pulled into a tub or sink. Do not place or drop the product into water or other liquid.
- Except when charging, always unplug this product from the power outlet immediately after use.
- Remove power cord from power outlet and product before cleaning.

### WARNING

**To reduce the risk of burns, fire, electric shock, or injury to persons:**

- Close supervision is required when this product is used by, on, or near children, or persons with limited physical, sensory, or mental capabilities or invalids.
- Use this product only for its intended household use as described in this manual. Do not use attachments not recommended by Philips North America LLC.
- Never operate this product if it has a damaged power cord, if it is not working properly, after it has been dropped or damaged, or after the product or power cord has been dropped into water. For assistance call 1-800-243-3050.
- Keep the power cord away from heated surfaces.
- Never drop or insert any object into any opening.
- Do not use the power cord in or near a power outlet that contains an electric air freshener to prevent damage to the power cord.
- Do not use product outdoors or operate where aerosol (spray) products are being used or where oxygen is being administered.
- Always check cutters, cutting unit and guards before using the product. Do not use the product if cutters, cutting unit or guards are damaged, as injury may occur.
- Always attach power cord to product first, then to power outlet. To disconnect, set all controls to 'off' position. Then remove power cord from power outlet.
- Plug power cord directly into power outlet. Do not use an extension cord.
- Unplug power cord before plugging in or unplugging the product.

- Only use the power cord and other accessories supplied with the product.
- Do not attempt to open the product to remove or replace the built-in rechargeable battery.

**IMPORTANT:** The power plug contains a transformer. Do not cut off the power plug to replace it with another plug as this will cause a hazardous condition.

## SAVE THESE INSTRUCTIONS

### Introduction

Congratulations on your purchase and welcome to Philips Norelco!

To fully benefit from the support that Philips Norelco offers, register your product at [www.philips.com/register](http://www.philips.com/register).

### General description (Fig. 1)

- 1 Protective cap
- 2 Blade
- 3 Setting indicator
- 4 On/off indicator
- 5 Click-on stubble comb 1 mm (3/64in.)
- 6 Click-on stubble comb 2 mm (5/64in.)
- 7 Power plug
- 8 Battery charge indicator
- 9 Small plug



This symbol indicates that the product can be used in the bath or shower.

### Charging

Charging takes approx. 8 hours. Charge the product before first use and when the product starts working more slowly.

- Charging or using the product at temperatures below 40°F (4,5°C) or higher than 95°F (35°C) adversely affects the lifespan of the battery.
- If the product is subjected to a major change in temperature, pressure or humidity, let the product acclimatize for 30 minutes before use.

Note: This appliance can only be used without cord (Fig. 2).

### Charging with the power cord

- 1 Make sure the product is switched off.
- 2 Insert the small plug into the product and put the power plug in any 120V AC outlet (Fig. 3).
- 3 After charging, remove the power plug from the wall outlet and pull the small plug out of the product.

### Operating time

When the product is fully charged, it has a cordless operating time of up to 30 minutes.

Note: An adapter plug may be necessary for cord usage in some foreign countries. Use an attachment plug adapter of the proper configuration for power outlet.

### Using the product

Note: This product is for cordless use (Fig. 2).

- Use this product for its intended household use as described in this manual.
- For hygienic reasons, the product should only be used by one person.
- Trimming is easier when the skin and hair are dry.
- Use the product to trim, edge or shave facial hair (beard, mustache and sideburns).
- Trim with the trimming comb to obtain a certain length and edge to create perfect edges and sharp lines.
- Take your time when you first start to use the product. You have to practice with the product.

**This product is not intended for shaving, edging or trimming hairs on lower body parts or scalp hair.**

### Switching the product on and off

- 1 To switch on the product, turn the setting indicator to the 'on' indication' (I) (Fig. 4).
- 2 To switch off the product, turn the setting indicator to the 'off' indication' (O).

## Shaving

**Warning: Before you use the product, always check the blade for damage or wear. If the blade is damaged or worn, do not use the product, as injury may occur. Replace a damaged blade before use (see 'Replacement').**

### Shaving tips and tricks

- Make sure that the blade is in full contact with the skin by placing it flat on the skin (Fig. 5).
- For the best result, move the product against the grain (Fig. 6).
- Make long strokes while pressing lightly.
- You can use the product dry or wet with gel or foam. You can even use the product in the shower.
- Shaving a clean beard and face gives the best results.

### Edging

- Use both edges of the blade to create sharp lines and perfect edges.
  - Hold the product in such a way that the blade is perpendicular to the skin and one of its edges touches the skin. This allows more precise detailing of sideburns and the area around the mouth and nose.
- 1 To create sharp edges and lines, you can use either edge of the blade (Fig. 7).
  - 2 Switch on the product.
  - 3 Place the edge of the blade perpendicular onto the skin (Fig. 8).
  - 4 Make straight strokes while applying gentle pressure (Fig. 9).
  - 5 Switch off and clean the product after each use (see 'Cleaning').

### Trimming with comb

The click-on stubble combs allow you to trim hair to different lengths. This product comes with 2 click-on stubble combs: 2mm (5/64in.) and 1mm (3/64in.). Start with the 2mm comb to acquire practice with this product. The indication on each comb corresponds to the remaining hair length in millimeters.

- Always make sure that the tips of the click-on stubble comb point in the direction in which you move the product.
  - Make sure that the flat part of the comb is always in full contact with the skin to obtain an even trimming result (Fig. 10).
  - Since all hairs do not grow in the same direction, you may want to try different trimming positions (i.e. upwards, downwards, or across). Practice is best for optimal results.
  - Trimming is easier when the skin and hair are dry.
- 1 Place the comb onto the blade, with the teeth of the comb pointing upwards (Fig. 11).

Note: For best results, always trim in the direction of the teeth of the comb.

- 2 Switch on the product.
- 3 Place the comb onto the skin and move the product upwards slowly, against the grain (Fig. 12).
- 4 Switch off and clean the product after each use (see 'Cleaning').
- 5 To remove the comb, hold it on both sides and pull it off the blade (Fig. 13).

### Cleaning

Clean the product after every use.

**Never use scouring pads, abrasive cleaning agents or aggressive liquids such as gasoline or acetone to clean the product.**

**Do not tap the product or blade against a surface to remove hairs and water as this may cause damage to the product and blade (Fig. 14). If the blade is damaged, replace immediately.**

**Never dry the blade with a towel or tissue, as this may cause damage.**

### Cleaning the product

- 1 Switch the product off.
- 2 Pull the comb off the blade.
- 3 Blow off any hairs that have accumulated on the blade and/or combs (Fig. 15).
- 4 Switch on the product for approx. 15 seconds while rinsing the blade with lukewarm water (Fig. 16).

- 5 Rinse the combs for approx. 15 seconds with lukewarm water (Fig. 17).
- 6 Carefully shake off excess water and let all parts air dry completely.

Note: The blade is fragile. Handle it carefully. Replace the blade immediately if it is damaged.

## Storage

Always attach the protective cap on the blade to protect the blade from damage during traveling or storage.

Make sure the product and attachments are completely dry before you store them for the next use.

- 1 Place the protective cap onto the edge of the blade (Fig. 18).
- 2 Close the protective cap (Fig. 19).
  - Be sure the product is turned off. Remove cord from outlet and the product before storing it in a safe, dry location where it will not be crushed, banged, or subject to damage.
  - Do not wrap cord around the product when storing.
  - Store cord and other accessories in a safe location where these will not be cut or damaged.
  - Do not place or store the product where it can fall or be pulled into a tub or sink, water or other liquid while plugged in.

## Replacement

### Blade wear indicator

For optimal cutting and gliding performance, replace the blade every 4 months or when it no longer provides the shaving or trimming results you expect. This advice is based on two full shaves a week and actual results may vary.

The blade is equipped with a blade wear indicator. A green bar will gradually appear on the blade as you use it (Fig. 20). When it is highly visible, it is recommended to replace your blade for the best OneBlade experience. Always replace with an original Philips Norelco blade (see 'Accessories').

Depending on your usage behavior, the exact lifetime of the blade could be longer or shorter. Similar to a manual blade, the blade becomes blunt over time, which results in increased hair pulling and reduced cutting performance.

### Replacing the blade

- 1 Hold the blade on its sides and pull upwards off the product to remove the blade and prevent it from flying away (Fig. 21).
- 2 Hold the new blade on its sides and press it onto the handle ('click') (Fig. 22).

Note: When you hear a click the new blade is placed correctly and ready for use.

This product has no other user-serviceable parts. For assistance call 1-800-243-3050.

## Accessories

Replacement parts and accessories may be purchased at a store near you or on our website [www.philips.com/store](http://www.philips.com/store).

The following accessories are available:

- Model QP210 Philips Norelco Replacement Blade, 1-Pack
- Model QP220 Philips Norelco Replacement Blade, 2-Pack
- Model QP230 Philips Norelco Replacement Blade, 3-Pack

## Assistance

For assistance, visit our website:

[www.philips.com/support](http://www.philips.com/support) or call toll free 1-800-243-3050.

Online information is available 24 hours a day, 7 days a week.

## Disposal

- This product contains a rechargeable nickel metal hydride battery which must be disposed of properly (Fig. 23).
- The built-in battery should not be disposed of with normal household waste
- Contact your local town or city officials for battery disposal information. You can also call 1-800-822-8837 or visit [www.call2recycle.org](http://www.call2recycle.org) for battery drop-off locations.

- For assistance, visit our website [www.philips.com/support](http://www.philips.com/support) or call 1-800-243-3050 toll free.
- Your product is designed and manufactured with high quality materials and components, which can be recycled and reused. For recycling information, please contact your local waste management facilities or visit [www.recycle.philips.com](http://www.recycle.philips.com)

### **Full Two-Year Warranty**

Philips North America LLC warrants this new product (except blade) against defects in materials or workmanship for a period of two years from the date of purchase, and agrees to repair or replace any defective product without charge.

**IMPORTANT:** This warranty does not cover damage resulting from accident, misuse or abuse, lack of reasonable care, the affixing of any attachment not provided with the product or loss of parts or subjecting the product to any but the specified voltage or batteries.\*

### **NO RESPONSIBILITY IS ASSUMED FOR ANY SPECIAL, INCIDENTAL OR CONSEQUENTIAL DAMAGES.**

In order to obtain warranty service, simply go to [www.philips.com/support](http://www.philips.com/support) for assistance. It is suggested that for your protection you return shipments of product by insured mail, insurance prepaid. Damage occurring during shipment is not covered by this warranty.

NOTE: No other warranty, written or oral, is authorized by Philips North America LLC.

This warranty gives you specific legal rights, and you may also have other rights which vary from state to state. Some states do not allow the exclusion or limitation of incidental or consequential damages, so the above exclusion and limitations may not apply to you.

\*Read enclosed instructions carefully.

### **45-DAY MONEY-BACK GUARANTEE**

If you are not fully satisfied with your product send the product back and we'll refund you the full purchase price.

**The product must be shipped prepaid by insured mail, insurance prepaid, have the original sales receipt, indicating purchase price and date of purchase, and the money-back guarantee return authorization form enclosed.**

**We cannot be responsible for lost mail.**

The product must be postmarked no later than 45 days after the date of purchase. Philips reserves the right to verify the purchase price of the product and limit refunds not to exceed suggested retail price.

**To obtain the money-back guarantee service, please go to [www.PhilipsMoneyBack.com](http://www.PhilipsMoneyBack.com) and follow the simple 3-step process.**

**Delivery of refund check will occur 6-8 weeks after receipt of returned product.**