

### Trimming with the unique 'stubble look' setting

- 1 To create a 'stubble look', trim with the beard trimming comb set to setting 1 (Fig. 6).

### Trimming without comb

Use the trimmer without beard trimming comb to trim full beards and single hairs.

Be careful when you trim without comb because the cutting element removes every hair it touches.

- 1 Pull the beard trimming comb off the appliance (Fig. 7).
- 2 Switch on the appliance.
- 3 Make well-controlled movements. Touch the hair lightly with the trimmer (Fig. 8).

### Cleaning

Never use scouring pads, abrasive cleaning agents or aggressive liquids such as alcohol, petrol or acetone to clean the appliance.

- 1 Make sure the appliance is switched off and disconnected from the mains.
  - 2 Wipe the housing of the appliance with a dry cloth.
- Never immerse the appliance in water or rinse it under the tap.
- 3 Remove the trimming comb and clean it with the brush.
  - 4 Remove the cutting unit by pushing against the teeth of the cutting unit. Clean it with the brush (Fig. 9).
  - 5 To reattach the cutting unit, insert the lug of the cutting unit into the guiding slot. Push the cutting unit back onto the appliance ('click') (Fig. 10).

### Replacement

Only replace a worn or damaged cutting unit with an original Philips cutting unit, available from authorised Philips service centres.

- 1 Remove the old cutting unit by pushing against the teeth of the cutting unit (Fig. 9).
- 2 Insert the lug of the new cutting unit into the guiding slot (Fig. 10).
- 3 Push the cutting unit back onto the appliance ('click') (Fig. 11).

### Environment

- Do not throw away the appliance with the normal household waste at the end of its life, but hand it in at an official collection point for recycling. By doing this, you help to preserve the environment (Fig. 12).

### Guarantee and support

If you need service or support, please visit [www.philips.com/support](http://www.philips.com/support) or read the separate worldwide guarantee leaflet.

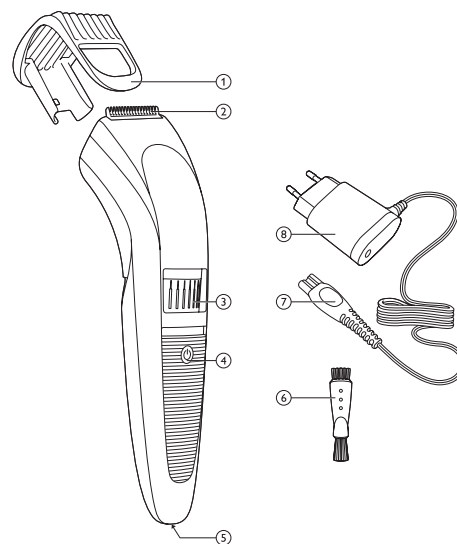

1

Register your product and get support at  
[www.philips.com/welcome](http://www.philips.com/welcome)

BT3200



PHILIPS

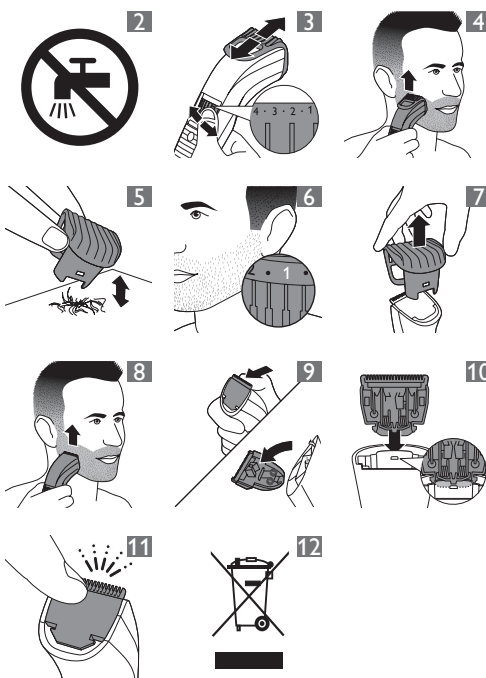

[www.philips.com](http://www.philips.com)

100% recycled paper  
100% papier recyclé

4222.002.8472.1

## ENGLISH

### Introduction

Congratulations on your purchase and welcome to Philips! To fully benefit from the support that Philips offers, register your product at [www.philips.com/welcome](http://www.philips.com/welcome).

### General description (Fig. 1)

- 1 Trimming comb
- 2 Cutting unit
- 3 Precision Zoom Lock™ adjustment ring
- 4 On/off slide
- 5 Socket for appliance plug
- 6 Brush
- 7 Appliance plug
- 8 Adapter with charging light

### Important

Read this user manual carefully before you use the appliance and save it for future reference.

#### Danger

- Keep the appliance and the adapter dry (Fig. 2).

#### Warning

- The adapter contains a transformer. Do not cut off the adapter to replace it with another plug, as this causes a hazardous situation.
- This appliance is not intended for use by persons (including children) with reduced physical, sensory or mental capabilities, or lack of experience and knowledge, unless they have been given supervision or instruction concerning use of the appliance by a person responsible for their safety.
- Children should be supervised to ensure that they do not play with the appliance.

#### Caution

- This appliance is not washable. Never immerse the appliance in water; nor rinse it under the tap. (Fig. 2)
- Always check the appliance before you use it. Do not use the appliance, adapter or any other part if it is damaged, as this may cause injury. Always replace a damaged adapter or part with one of the original type.
- Never use compressed air; scouring pads, abrasive cleaning agents or aggressive liquids such as petrol or acetone to clean the appliance.

#### Electromagnetic fields (EMF)

This Philips appliance complies with all applicable standards and regulations regarding exposure to electromagnetic fields.

#### General

- The adapter is equipped with an automatic voltage selector and is suitable for mains voltages ranging from 100 to 240 volts.
- The adapter transforms 100-240 volts to a safe low voltage of less than 24 volts.
- Maximum noise level: Lc = 75dB(A)

### Using the appliance

**Note:** The appliance is not rechargeable and can only be used from the mains.

Always comb the beard and/or moustache with a fine comb before you start trimming.

**When you trim for the first time, be careful. Do not move the trimmer too fast. Make smooth and gentle movements.**

#### Trimming with comb

- 1 Turn the Precision Zoom Lock™ adjustment ring to the desired setting. The selected setting is the setting in the centre of the adjustment ring. (Fig. 3)

See the table below for an overview of the settings and the resulting hair lengths.

Setting	Resulting hair length	Setting	Resulting hair length
1	1 mm	6	6mm
2	2 mm	7	7mm
3	3 mm	8	8mm
4	4 mm	9	9mm
5	5 mm	10	10mm

**Note:** When you trim for the first time, start at the highest setting (10) to familiarise yourself with the appliance.

- 2 Put the appliance plug in the appliance and put the adapter in the wall socket.
- 3 Press the on/off slide upwards to switch on the appliance.
- 4 To trim most effectively, move the trimmer against the hair growth direction. Make sure the surface of the comb always stays in contact with the skin (Fig. 4).
- 5 If a lot of hair has accumulated in the beard trimming comb, remove the comb and blow and/or shake the hair out of it. The selected setting does not change when you do this (Fig. 5).

