

PHILIPS

QT4000

QT4001

QT4003

QT4009





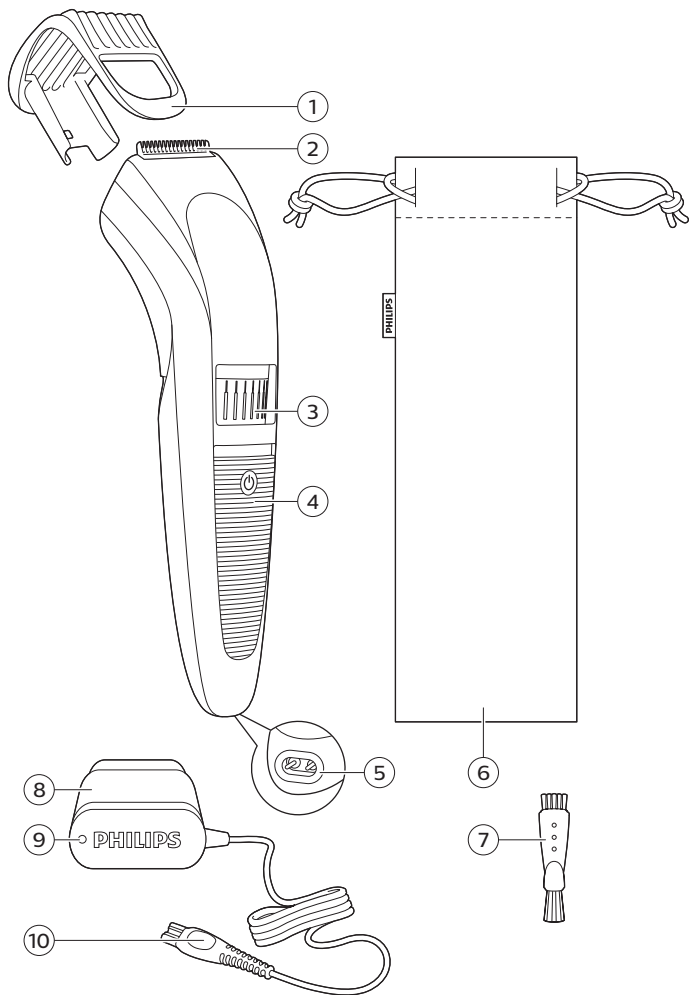

English 6

Introduction

Congratulations on your purchase and welcome to Philips! To fully benefit from the support that Philips offers, register your product at www.philips.com/welcome.

General description (Fig. 1)

- 1 Trimming comb
- 2 Cutting unit
- 3 Precision Zoom Lock™ adjustment ring
- 4 On/off slide
- 5 Socket for small plug
- 6 Pouch (QT4009 only)
- 7 Cleaning brush
- 8 Supply unit
- 9 Charging light
- 10 Small plug

Important safety information

Read this important information carefully before you use the appliance and its accessories and save it for future reference. The accessories supplied may vary for different products.

Danger



- Keep the supply unit dry.

Warning

- To charge the battery, only use the detachable supply unit (HQ8505) provided with the appliance.

- The supply unit contains a transformer. Do not cut off the supply unit to replace it with another plug, as this causes a hazardous situation.
- This appliance can be used by children aged from 8 years and above and persons with reduced physical, sensory or mental capabilities or lack of experience and knowledge if they have been given supervision or instruction concerning use of the appliance in a safe way and understand the hazards involved. Children shall not play with the appliance. Cleaning and user maintenance shall not be made by children without supervision.
- Always check the appliance before you use it. Do not use the appliance if it is damaged, as this may cause injury. Always replace a damaged part with one of the original type.
- This appliance contains batteries that are non-replaceable.
- Do not open the appliance to replace the rechargeable battery.

Caution



- This appliance is not washable. Never immerse the appliance in water and do not rinse it under the tap.
- Only use this appliance for its intended purpose as shown in the user manual.
- For hygienic reasons, the appliance should only be used by one person.

8 English

- Never use compressed air, scouring pads, abrasive cleaning agents or aggressive liquids such as petrol or acetone to clean the appliance.
- Do not use the supply unit in or near wall sockets that contain an electric air freshener to prevent irreparable damage to the supply unit.

Electromagnetic fields (EMF)

This Philips appliance complies with all applicable standards and regulations regarding exposure to electromagnetic fields.

General

- The supply unit is suitable for mains voltages ranging from 100 to 240 volts.
- The supply unit transforms 100-240 volts to a safe low voltage of less than 24 volts.

Charging

Charge the appliance fully before you use it for the first time and after a long period of disuse.

Charging takes approx. as follows: 10 hours (QT4000, QT4001 only), 8 hours (QT4003 only) or 1 hour (QT4009 only). When the appliance is fully charged, the appliance has a cordless operating time of up to: 35 minutes (QT4003 only), 45 minutes (QT4000, QT4001 only) or 60 minutes (QT4009 only).

Note: This appliance can only be used without cord. Make sure the appliance is charged before use.

- 1 Make sure the appliance is switched off.

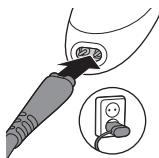

- 2 Insert the small plug into the appliance.
- 3 Put the supply unit in the wall socket.
 - The charging light on the supply unit lights up green to indicate that the appliance is charging.

Note: The charging light on the supply unit does not change color and does not go out when the appliance is fully charged.

- 4 After charging, remove the supply unit from the wall socket and pull the small plug out of the appliance.

Optimizing the lifetime of the rechargeable battery

When you have charged the appliance for the first time, we advise you to use it until the battery is completely empty. Continue to use the appliance until the motor almost stops running during a session. Then recharge the battery. Follow this procedure at least twice a year.

Using the appliance

Always comb the beard and/or moustache with a fine comb before you start trimming.

Be careful when you trim for the first time. Do not move the trimmer too fast. Make smooth and gentle movements.

Switching the appliance on and off

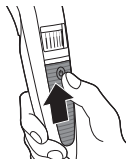

- 1 To switch on the appliance, slide the on/off button up.

10 English

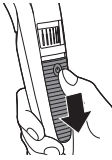

- 2 To switch off the appliance, slide the on/off button down.

Trimming with comb

The length settings on the Precision Zoom Lock™ adjustment ring correspond to the remaining hair length after trimming. For example, setting 2 equals a hair length of 2mm. QT4000, QT4001: length settings ranging from 1 to 10 with 1mm steps, QT4003, QT4009: length settings ranging from 0.5 to 10 with 0.5mm steps.

Note: When you trim for the first time, start at the highest length setting to familiarize yourself with the appliance.

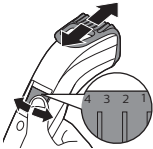

- 1 Slide the beard trimming comb straight into the guiding groove of the appliance.
- 2 Turn the Precision Zoom Lock™ adjustment ring to the desired setting. The selected setting is the setting in the center of the adjustment ring.
- 3 Switch on the appliance.
- 4 To trim most effectively, move the appliance against the hair growth direction. Make sure that the surface of the comb always stays in contact with the skin.

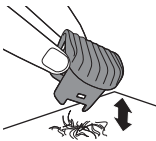

- 5 Regularly remove cut hair from the comb. If a lot of hair has accumulated in the comb, remove it from the product and blow and/or shake out the hairs. The selected setting does not change when you do this.

Trimming at the unique 'stubble look' setting



- 1 To create a 'stubble look', trim with the beard trimming comb set to setting 1.

Trimming without comb

Use the trimmer without beard trimming comb to trim full beards and single hairs.

Be careful when you trim without a comb because the cutting unit removes every hair it touches.



- 1 Pull the beard trimming comb straight off the appliance.
- 2 Switch on the appliance.



- 3 Make well-controlled movements. Touch the hair lightly with the trimmer.

Cleaning

Caution: Never use scouring pads, abrasive cleaning agents or aggressive liquids such as petrol or acetone to clean the appliance.

- 1 Switch off the appliance and make sure it is disconnected from the wall socket.
- 2 Wipe the housing of the appliance with a dry cloth.

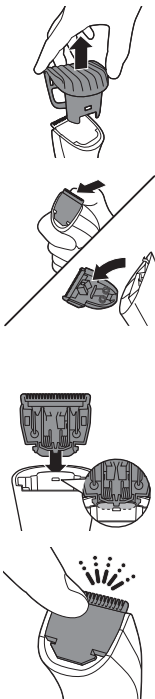

Caution: Never immerse the appliance in water, or rinse it under the tap.

- 3 Remove the comb and clean it with the cleaning brush.
 - 4 Remove the cutting unit by pushing against the teeth of the cutting unit and clean it with the brush or rinse it under the tap.
- Only the cutting unit can be rinsed under the tap**
- 5 Carefully shake off excess water and let air dry completely.
 - 6 Insert the lug of the cutting unit into the guiding slot and push the cutting unit back onto the appliance.

Storage (QT4009 only)

- 1 Store the appliance in the pouch supplied.

Note: Make sure the appliance is dry before you store it in the pouch.

Replacement

Replace damaged parts immediately. Always replace the cutting unit with the original Philips cutting unit.

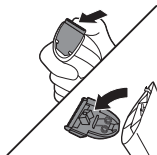

- 1 Push the teeth of cutting unit upwards and pull the cutting unit off the appliance.
- 2 Remove the used cutting unit.

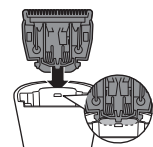

- 3 Insert the lug of the new cutting unit into the guiding slot and push the cutting unit onto the appliance ('click').



Ordering accessories

To buy accessories or spare parts, visit www.philips.com/parts-and-accessories or go to your Philips dealer. You can also contact the Philips Consumer Care Center in your country (see the international warranty leaflet for contact details).

Recycling

- Do not throw away the product with the normal household waste at the end of its life, but hand it in at an official collection point for recycling. By doing this, you help to preserve the environment.
- This product contains a built-in rechargeable battery which shall not be disposed of with normal household waste. Please take your product to an official collection point or a Philips service center to have a professional remove the rechargeable battery.
- Follow your country's rules for the separate collection of electrical and electronic products and rechargeable batteries. Correct disposal helps prevent negative consequences for the environment and human health.

Removing the rechargeable battery

Only remove the rechargeable battery when you discard the appliance. Before you remove the battery, make sure that the appliance is disconnected from the wall socket and that the battery is completely empty.

Take any necessary safety precautions when you handle tools to open the appliance and when you dispose of the rechargeable battery.

- 1 Disconnect the appliance from the wall socket and let the appliance run until the motor stops.

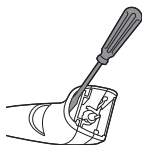

- 2 Insert a screwdriver in the hair chamber to separate the housing part.

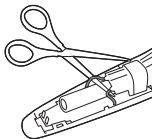

- 3 Cut the wires close to the battery with a pair of household scissors.
- 4 Remove the rechargeable battery.

Warranty and support

If you need information or support, please visit www.philips.com/support or read the international warranty leaflet.

— |

| —

— |

| —

— |

| —

— |

| —

— |

| —

— |

| —

© 2019 Koninklijke Philips N.V.

All rights reserved

8888.989.2590.1 (12/8/2019)



>75 % recycled paper
>75 % papier recyclé