

Always here to help you / 始终如一地为您提供帮助

Register your product and get support at / 请登录以下网址并得到相应的帮助
www.philips.com/welcome



PT927CC
PT927
PT878
PT877



User manual / 用户手册

PHILIPS

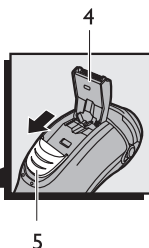
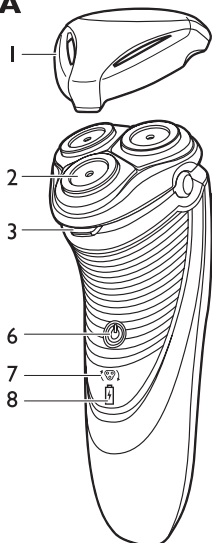
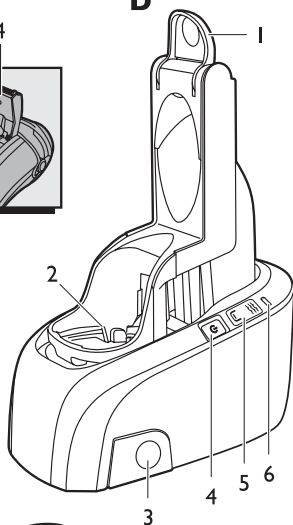
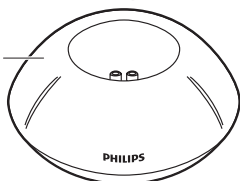
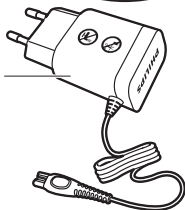
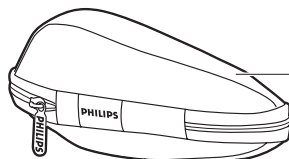

A**D****B****C****E****F****G**

ENGLISH 6

简体中文 30

Introduction

Congratulations on your purchase and welcome to Philips! To fully benefit from the support that Philips offers, register your product at www.philips.com/welcome.

Please read this user manual, as it contains information about the wonderful features of this shaver as well as some tips to make shaving easier and more enjoyable.

General description (Fig. 1)

- A Shaver
 - 1 Protection cap
 - 2 Shaving unit
 - 3 Shaving unit release button
 - 4 Trimmer
 - 5 Trimmer release slide
 - 6 Shaver on/off button
 - 7 Shaving head symbol
 - 8 Battery symbol
- B Charging stand (PT927 only)
- C Adapter
- D Jet Clean System (PT927CC only)
 - 1 Locking lever
 - 2 Shaver holder
 - 3 Cleaning chamber release button
 - 4 Jet Clean System on/off button
 - 5 Cleaning symbol and 'fluid low' symbol
 - 6 Battery symbol
- E Jet Clean solution (HQ200) (PT927CC only)
- F Cleaning brush
- G Storage pouch (PT927CC/PT927 only)

Important



Read this user manual carefully before you use the shaver, the Jet Clean System and the charging stand. Save the user manual for future reference.

Danger

- Keep the adapter dry.

Warning

- The adapter contains a transformer. Do not cut off the adapter to replace it with another plug, as this causes a hazardous situation.
- The shaver and the Jet Clean System (PT927CC) are not intended for use by persons (including children) with reduced physical, sensory or mental capabilities, or lack of experience and knowledge, unless they have been given supervision or instruction concerning use of these appliances by a person responsible for their safety.
- Children should be supervised to ensure that they do not play with the shaver and the Jet Clean System (PT927CC).
- Always unplug the shaver before you clean it under the tap.



Caution

- Never immerse the shaver in water.
- Never immerse the Jet Clean System (PT927CC) or the charging stand (PT927) in water nor rinse it under the tap.
- Do not use the shaver in the bath or in the shower.
- Never use water hotter than 80°C to rinse the shaver.
- Be careful with hot water. Always check if the water is not too hot, to prevent your hands from getting burnt.



- The shaver, the Jet Clean System (PT927CC), the charging stand (PT927) and the other accessories are not dishwasher-proof.
- Water may leak from the socket at the bottom of the shaver when you rinse it. This is normal and not dangerous because all electronics are enclosed in a sealed power unit inside the shaver.
- Do not use the shaver, Jet Clean System (PT927CC), adapter, charging stand (PT927) or any other part if it is damaged, as this may cause injury. Always replace a damaged adapter, charging stand or part with one of the original type.
- Use, charge and store the shaver and the Jet Clean System (PT927CC) at a temperature between 10°C and 35°C.
- Always place and use the shaver and the Jet Clean System (PT927CC) on a surface that is fluid-resistant.
- Only use the adapter, charging stand (PT927) and accessories supplied.
- Always put the protection cap on the shaver to prevent damage and to avoid dirt accumulation in the shaving heads.

Jet Clean (PT927CC only)

- Only use the Jet Clean System with the original Jet Clean solution (HQ200).
- Always place the Jet Clean System on a stable, level and horizontal surface to prevent leakage.
- The Jet Clean System thoroughly cleans but does not disinfect your shaver, therefore do not share the shaver with others.
- If the shaver and the Jet Clean System are subjected to a major change in temperature, pressure or humidity, let them acclimatise for 30 minutes before you use them.



- Empty the cleaning chamber of the Jet Clean System and clean the cleaning chamber thoroughly by rinsing it with hot tap water every 15 days.
- When the Jet Clean System is ready for use, do not move it to prevent leakage.

Compliance with standards

- The shaver complies with the internationally approved IEC safety regulations and can be safely cleaned under the tap.
- The shaver and the Jet Clean System comply with all standards regarding electromagnetic fields (EMF). If handled properly and according to the instructions in this user manual, they are safe to use based on scientific evidence available today.

General

- The appliance is equipped with an automatic voltage selector and is suitable for mains voltages ranging from 100 to 240 volts.
- The adapter transforms 100-240 volts to a safe low voltage of less than 24 volts.

Charging

It takes approx. 1 hour to fully charge the shaver. When you charge the shaver for the first time or after a long period of disuse, let it charge until the white battery lights up continuously.

A fully charged shaver provides up to 50 (PT878/PT877) or 60 (PT927CC/PT927) shaving minutes. The shaving time may be less than 50 (PT878/PT877) or 60 (PT927CC/PT927) shaving minutes as a result of your shaving behaviour, your cleaning habits or your beard type.

Charge indications

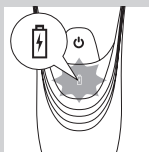

Battery low

- When the battery is almost empty (when there are only 5 or fewer shaving minutes left), the battery symbol starts to flash orange.
- When you switch off the shaver, the battery symbol continues to flash orange for a few seconds.

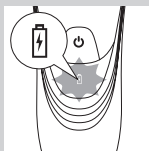

Quick charging

- When you start charging the empty battery, the battery symbol flashes white and orange.

Note: When the battery symbol flashes white and orange towards only white, you can have a quick shave of three minutes.

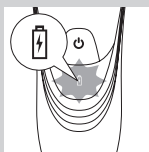

Charging

- When the shaver is charging, the battery symbol flashes white.

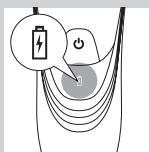

Battery fully charged

- When the battery is fully charged, the battery symbol lights up white continuously.

Note: After approx. 30 minutes, the battery symbol goes out to save energy.

Charging with the adapter

Do not charge the shaver in a closed pouch.

- 1** Put the small plug in the shaver.
 - 2** Put the adapter in the wall socket.
- The battery symbol shows the charging status of the shaver (see section 'Charge indications' in this chapter).

Charging in the charging stand (PT927 only)

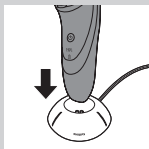

- 1** Put the small plug in the charging stand.
 - 2** Put the adapter in the wall socket.
 - 3** Place the shaver in the charging stand.
- ▶ The battery symbol shows the charging status of the shaver (see section 'Charge indications' in this chapter).

Charging in the Jet Clean System (PT927CC only)

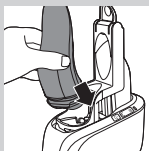

- 1** Put the small plug in the Jet Clean System.
- 2** Put the adapter in the wall socket.
- 3** Place the shaver without protection cap upside down in the shaver holder.

Note: The shaver cannot be placed in the Jet Clean System when the protection cap is on the shaving unit.

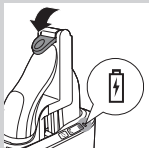

- 4** Push down the locking lever completely to lock the shaver into place.
- ▶ The battery symbol on the Jet Clean System flashes to indicate that the shaver is being charged.

Note: When the Jet Clean System is performing the cleaning program, the battery symbol is out.

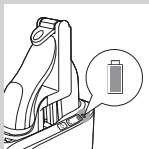

- ▶ When the battery is fully charged, the battery symbol on the Jet Clean System lights up continuously.

Note: After approx. 30 minutes, the battery symbol goes out to save energy.

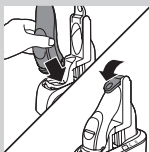

- 5** To remove the shaver from the Jet Clean System, move the locking lever upwards until it does not go any further and remove the shaver.

Using the shaver

Note: You can also use the appliance directly from the mains. Simply connect the shaver to the mains.

Shaving



- 1** Press the on/off button once to switch on the shaver.
- 2** Move the shaving heads over your skin. Make circular movements.
 - Your skin may need 2 or 3 weeks to get accustomed to the Philips shaving system.
- 3** Press the on/off button once to switch off the shaver.
- 4** Clean the shaver (see chapter 'Cleaning and maintenance').

Trimming

You can use the trimmer to groom your sideburns and moustache.

- 1** Press the on/off button once to switch on the shaver.

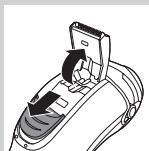

2 Push the trimmer slide downwards to open the trimmer.

► You can now start trimming.

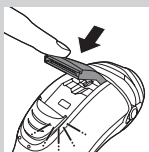

3 After trimming, close the trimmer and switch off the shaver.

4 Clean the trimmer (see chapter 'Cleaning and Maintenance').

Cleaning and maintenance

Never use compressed air, scouring pads, abrasive cleaning agents or aggressive liquids such as petrol or acetone to clean the shaver, the charging stand (PT927) and the Jet Clean System (PT927CC).

- The best and most hygienic way to clean the shaver is in the Jet Clean System (PT927CC). You can also rinse the shaver under the tap or clean it with the cleaning brush supplied.
- Clean the shaver after every shave for optimal shaving performance.
- Regular cleaning guarantees better shaving performance.
- For the best cleaning results, we advise you to use the Philips Cleaning spray (HQ110) and the Jet Clean solution (HQ200)(PT927CC).
- Be careful with hot water. Always check if the water is not too hot, to prevent your hands from getting burnt.

Note: Water may leak from the socket at the bottom of the shaver when you rinse it. This is normal and not dangerous because all electronics are enclosed in a sealed power unit inside the shaver.

Cleaning the shaving unit under the tap

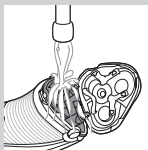

- 1** Switch off the shaver and disconnect it from the mains.
- 2** Press the release button to open the shaving unit.
- 3** Rinse the shaving unit and hair chamber under a hot tap for 30 seconds.

Be careful with hot water. Always check if the water is not too hot, to prevent your hands from getting burnt.

- Rinse the hair chamber and the inside of the shaving unit.
- Rinse the outside of the shaving unit.

- 4** Close the shaving unit and shake off excess water.

Be careful not to hit the shaving unit against anything while shaking off excess water.

Never dry the shaving unit and the hair chamber with a towel or tissue, as this may damage the shaving heads and the coupling spindles.

- 5** Open the shaving unit again and leave it open to let the shaver dry completely.

Cleaning the shaving unit with the cleaning brush



- 1** Switch off the shaver and disconnect it from the mains.

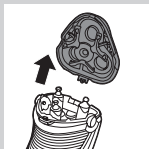

- 2** Press the release button to open the shaving unit.

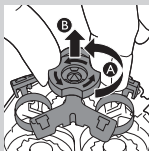

- 3** Pull the shaving unit off the shaver.

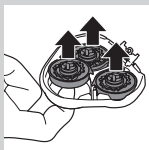

- 4** Turn the lock anticlockwise (A) and remove the retaining frame (B).

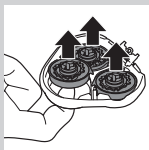

- 5** Remove and clean one shaving head at a time. Each shaving head consists of a cutter and a guard.

Note: Do not clean more than one cutter and guard at a time, since they are all matching sets. If you accidentally mix up the cutters and guards, it may take several weeks before optimal shaving performance is restored.

- Remove the cutter from the shaving guard and clean it with the brush.

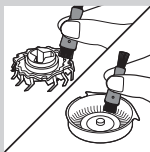

- Clean the inside and outside of the shaving guard with the brush.

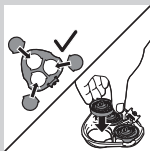

- 6** Put the shaving heads back into the shaving unit.

Note: Make sure that the projections of the shaving heads fit exactly into the recesses.

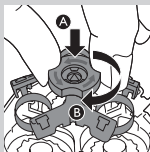

- 7** Put the retaining frame back into the shaving unit (A) and turn the lock clockwise (B).

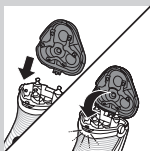

- 8** Insert the lug of the shaving unit into the slot in the top of the shaver. Then close the shaving unit.

Note: If the shaving unit does not close smoothly, check if you have inserted the shaving heads properly and if the retaining frame is locked.

Cleaning the shaving unit in the Jet Clean System (PT927CC only)

The Jet Clean System cleans the shaving unit.

Preparing the Jet Clean System for use

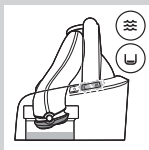

Note: Fill the cleaning chamber before first use and when the 'fluid low' symbol flashes to indicate that the fluid level is too low. When the fluid level drops below the minimum level, the cleaning symbol and the 'fluid low' symbol start to flash and the shaver holder returns to its starting position

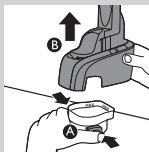

- 1 Simultaneously press the release buttons on both sides of the cleaning chamber (A). Then lift the Jet Clean System off the cleaning chamber (B).

► The cleaning chamber remains behind.



- 2 Unscrew the cap from the bottle with Jet Clean solution (HQ200) and remove the airtight seal.

- 3 Fill the cleaning chamber with Jet Clean solution (HQ200) up to the MAX indication.

Note: Make sure the cleaning chamber is always filled above the MIN indication.

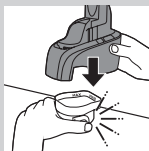

- 4 Place the Jet Clean System back onto the cleaning chamber ('click').

Make sure that the release buttons snap back into place.

When the cleaning chamber is filled with Jet Clean solution, do not move it to prevent leakage.

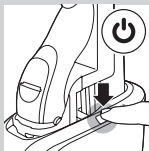
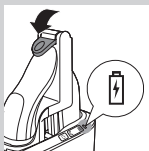

5 Put the small plug in the Jet Clean System and put the adapter in the wall socket.

► The shaver holder automatically moves to its highest position.

The Jet Clean System is now ready for use.

Using the Jet Clean System

1 Place the shaver without protection cap upside down in the shaver holder. Push down the locking lever completely to lock the shaver into place.

► The battery symbol on the Jet Clean System goes on to indicate that the shaver is being charged.

Note: The shaver cannot be placed in the Jet Clean System when the protection cap is on the shaving unit.

2 Press the on/off button on the Jet Clean System to start the cleaning program.

► The battery symbol on the Jet Clean System goes out.

► During the cleaning program, the cleaning symbol starts to flash and the shaver is automatically lowered into the cleaning fluid.

► The shaver automatically switches on and off several times and moves up and down.

► The cleaning symbol flashes throughout the cleaning program, which takes approx. 8 minutes.

► After the cleaning program, the battery symbol on the Jet Clean System goes on to indicate that the shaver is being charged.

Note: If you press the on/off button of the Jet Clean System during the cleaning program, the program aborts and resets. In this case, the cleaning stops flashing and the shaver holder returns to its starting position. The shaver may still be wet and dirty, because the cleaning program has not been finished.

Note: If you remove the adapter from the wall socket during the cleaning program, the program aborts. The shaver holder remains in its current position. When you put the adapter back into the wall socket, the shaver holder moves to its highest position.

Note: When the fluid level drops below the minimum level, the cleaning symbol and the 'fluid low' symbol start to flash with intervals and the shaver holder returns to its starting position

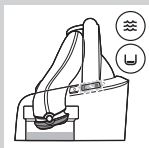

Cleaning the Jet Clean System

Empty the cleaning chamber and clean it thoroughly by rinsing it with hot tap water every 15 days if you use the Jet Clean System daily. Otherwise empty and clean the cleaning chamber at least once a month.

- 1** Clean the outside of the Jet Clean System with a moist cloth.

Never immerse the Jet Clean System in water, nor rinse it under the tap.

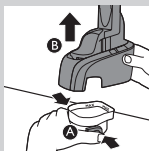

- 2** Simultaneously press the release buttons on both sides of the Jet Clean System (1). Then lift the Jet Clean System off the cleaning chamber (2).
 - The cleaning chamber remains behind.



- 3** Pour any remaining cleaning fluid out of the cleaning chamber.

You can simply pour the cleaning fluid down the sink, this is not harmful to the environment.

- 4** Rinse the cleaning chamber under a hot tap.

Be careful with hot water. Always check if the water is not too hot, to prevent your hands from getting burnt.

The cleaning chamber is not dishwasher-proof.



- 5** Fill the cleaning chamber with Jet Clean solution (HQ200) up to the MAX indication.

Note: Make sure the cleaning chamber is always filled above the MIN indication.

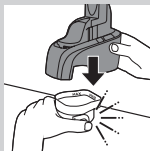

- 6** Place the Jet Clean System back onto the cleaning chamber ('click').

Make sure that the release buttons snap back into place.

Cleaning the trimmer with the cleaning brush

Clean the trimmer every time you have used it.

- 1** Switch off the shaver and disconnect it from the mains.
- 2** Push the trimmer slide downwards to open the trimmer.

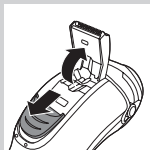

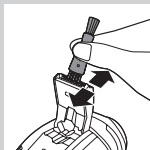

3 Clean the trimmer with the short-bristled side of the cleaning brush. Brush up and down along the trimmer teeth.

4 Close the trimmer ('click').

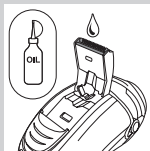

Tip: For optimal trimming performance, lubricate the trimmer teeth with a drop of sewing machine oil every six months.

Storage

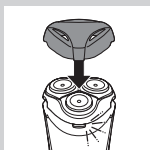

There are several ways to store the shaver or to take it with you when you travel:

- Put the protection cap on the shaver after use to prevent damage and to avoid dirt accumulation in the shaving heads.
- PT927CC/PT927: Store the shaver in the pouch supplied.
- PT927: Store the shaver in the charging stand.
- PT927CC: Put the shaver in the Jet Clean System. Make sure the protection cap is not on the shaving unit.

Note PT927CC: If you do not want the shaver to charge while it is stored in the Jet Clean System, just leave the locking lever in upright position

Replacement

For maximum shaving performance, we advise you to replace the shaving heads every two years.

Replacement reminder

The shaving head symbol will light up to indicate that the shaving heads need to be replaced. Replace damaged shaving heads right away.

Only replace the shaving heads with original HQ9 (PT927, PT927CC) or HQ8 (PT878/PT877) Philips Shaving Heads.

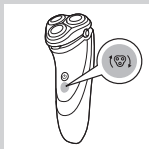

- 1** The shaving head symbol lights up orange continuously.
- 2** Switch off the shaver. Disconnect the shaver from the mains, remove it from the Jet Clean System or remove it from the charging stand.



- 3** Press the release button to open the shaving unit.
- 4** Pull the shaving unit off the shaver.

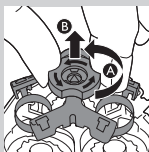

- 5** Turn the lock anticlockwise (A) and remove the retaining frame (B).

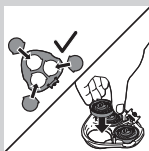

- 6** Remove the shaving heads and place new ones in the shaving unit.

Note: Make sure that the projections of the shaving heads fit exactly into the recesses.

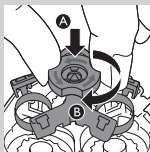

- 7** Put the retaining frame back into the shaving unit (A) and turn the lock clockwise (B).

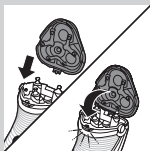

- 8** Insert the lug of the new shaving unit into the slot in the top of the shaver. Then close the shaving unit.

Note: If the shaving unit does not close smoothly, check if you have inserted the shaving heads properly and if the retaining frame is locked.

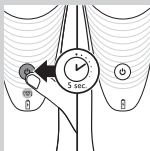

- 9** Press and hold the on/off button for 5 seconds to reset the replacement reminder on the shaver. The orange light goes out.

Ordering accessories

To buy accessories or spare parts, visit **www.shop.philips.com/service** or go to your Philips dealer. You can also contact the Philips Consumer Care Centre in your country (see the worldwide guarantee leaflet for contact details). To retain the top performance of your shaver, make sure you clean it regularly and replace its shaving heads at the recommended time.



Shaving heads

- We advise you to replace your shaving heads every two years. Always replace them with HQ9 (PT927CC/PT927) or HQ8 (PT878/PT877) Philips Shaving Heads.

Cleaning

- Use Jet Clean solution (HQ200) for regular cleaning of the shaving heads.
- Use Cleaning spray (HQ110) to clean the shaving heads thoroughly.

Environment



- Do not throw away the shaver and the Jet Clean System (specific types only) with the normal household waste at the end of its life, but hand it in at an official collection point for recycling. By doing this, you help to preserve the environment.



- The built-in rechargeable shaver battery contains substances that may pollute the environment. Always remove the battery before you discard or hand in the shaver at an official collection point. Dispose of the battery at an official collection point for batteries. If you have trouble removing the battery, you can also take the appliance to a Philips service centre. The staff of this centre will remove the battery for you and will dispose of it in an environmentally safe way.

Removing the rechargeable shaver battery

Only remove the rechargeable battery when you discard the shaver. Make sure the rechargeable battery is completely empty when you remove it.

- 1** Disconnect the shaver from the mains, remove it from the Jet Clean System or remove it from the charging stand.
- 2** Let the shaver operate until it stops.
- 3** Undo the screws in the back of the shaver and in the hair chamber.
- 4** Remove the front panel and the back panel.
- 5** Bend the 6 hooks aside and take out the power unit.

Be careful, the hooks are sharp.

- 6** Remove the battery.

Be careful, the battery strips are sharp.

Do not put the shaver back into the plugged-in Jet Clean System or charging stand after you have removed the rechargeable battery.

Do not connect the shaver to the mains again after you have removed the rechargeable battery.

Guarantee and support

If you need information or support, please visit **www.philips.com/support** or read the separate worldwide guarantee leaflet.

Guarantee restrictions

The shaving heads (cutters and guards) are not covered by the terms of the international guarantee because they are subject to wear.

Troubleshooting

This chapter summarises the most common problems you could encounter with the appliance. If you are unable to solve the problem with the information below, contact the Consumer Care Centre in your country.

Problem	Possible cause	Solution
The shaver does not shave as well as it used to.	The Jet Clean System (PT927CC only) has not cleaned the shaver properly because the cleaning fluid in the cleaning chamber is soiled or the cleaning fluid level is too low.	Clean the shaver thoroughly before you continue shaving. If necessary, clean and refill the cleaning chamber (see chapter 'Cleaning and maintenance').
	The shaving heads are damaged or worn.	Replace the shaving heads (see chapter 'Replacement').
	Long hairs obstruct the shaving heads.	Clean the shaving heads one by one (see section 'Cleaning the shaving unit with the cleaning brush' in chapter 'Cleaning and maintenance').
	You have not inserted the shaving heads properly.	Make sure that the projections of the shaving heads fit exactly into the recesses (see section 'Cleaning the shaving unit with the cleaning brush').

Problem	Possible cause	Solution
The shaver does not work when I press the on/off button.	The rechargeable battery is empty.	Recharge the battery (see chapter 'Charging') or connect the shaver to the mains.
	The temperature of the shaver is too high. In this case, the shaver does not work.	As soon as the temperature of the shaver has dropped sufficiently, you can switch on the shaver again.
PT927CC: The shaver is not entirely clean after I clean it in the Jet Clean System.	The cleaning fluid in the cleaning chamber is soiled.	Empty and rinse the cleaning chamber (see section 'Cleaning the shaving unit in the Jet Clean System' in chapter 'Cleaning and maintenance').
	The cleaning fluid level is too low. If the fluid volume in the cleaning chamber drops below the minimum level during the cleaning program, the program aborts. The cleaning symbol and the 'fluid low' symbol flash at intervals and the holder returns to its starting position.	Refill the cleaning chamber with cleaning fluid up to the MAX level (see section 'Cleaning the shaving unit in the Jet Clean System' in chapter 'Cleaning and maintenance').

Problem	Possible cause	Solution
	You have used another cleaning fluid than the original Philips cleaning fluid.	Only use Jet Clean solution HQ200.
	You have not closed the locking lever of the Jet Clean System properly, or you have not placed the shaver in the Jet Clean Shaver properly. In these cases the Jet Clean System starts to operate, but the cleaning program is not performed properly.	Place the shaver without protection cap in the Jet Clean System properly. Close the locking lever properly.
PT927CC: The Jet Clean System does not work when I press the on/off button.	The Jet Clean System is not connected to the mains.	Put the small plug in the Jet Clean System and put the adapter in the wall socket.

Problem	Possible cause	Solution
Water leaks from the shaver after cleaning.	This is normal and not dangerous.	During rinsing some water may collect between the power unit and the housing. After rinsing this water flows out through the socket. The power unit is completely watertight so water cannot reach the electronic parts of the shaver. Your shaver continues to be absolutely safe.

简介

感谢您的惠顾，欢迎光临飞利浦！
 为了您能充分享受飞利浦提供的支持，请在
www.philips.com/welcome 上注册您的产品。
 请阅读本用户手册，手册包含有关此剃须刀各
 种功能的信息以及一些使用技巧，让您的剃须
 体验更轻松更舒适。

基本说明 (图 1)

- A 剃须刀
 - 1 保护盖
 - 2 剃毛刀头部件
 - 3 剃须刀头部件释放按钮
 - 4 修发器
 - 5 修发器释放滑块
 - 6 剃须刀开/关按钮
 - 7 剃须刀头符号
 - 8 电池符号
- B 充电座（仅限于 PT927）
- C 适配器
- D Jet Clean 高效能清洁系统
（仅限于 PT927CC）
 - 1 锁定杆
 - 2 剃须刀支架
 - 3 清洗仓释放按钮
 - 4 Jet Clean 高效能清洁系统开/关按钮
 - 5 清洁符号和“液量低”符号
 - 6 电池符号
- E Jet clean 高效能清洁液 (HQ200)
（仅限于 PT927CC）
- F 清洁刷
- G 存储袋（仅限于 PT927CC/PT927）

注意事项

使用剃须刀、Jet Clean 高效能清洁系统和充电座之前，请仔细阅读本用户手册。妥善保管用户手册，以供日后参考。



危险

- 保持适配器干燥。
- 警告符号注释：禁止用在打开的水龙头下进行清洗。

警告

- 电源适配器内含有一个变压器。切勿自行更换插头，否则将导致严重后果。
- 剃须刀和 Jet Clean 高效能清洁系统 (PT927CC) 不适合由肢体不健全、感官或精神上有障碍或缺乏相关经验和知识的人（包括儿童）使用，除非有负责他们安全的人员对他们使用这些产品进行监督或指导。
- 应照看好儿童，确保他们不会玩耍剃须刀和 Jet Clean 高效能清洁系统 (PT927CC)。
- 在自来水龙头下清洗剃须刀之前，务必拔掉其电源插头。



注意

- 切勿将剃须刀浸入水中。
- 切勿将 Jet Clean 高效能清洁系统 (PT927CC) 或充电座 (PT927) 浸入水中，也不要在水龙头下冲洗。
- 切勿在洗澡或淋浴时使用剃须刀。
- 切勿使用温度高于 80°C 的热水冲洗剃须刀。
- 使用热水时一定要小心。切记先检查水温是否太高，以防烫手。
- 剃须刀、Jet Clean 高效能清洁系统 (PT927CC)、充电座 (PT927) 及其他附件均不能用洗碗机清洗。



- 冲洗产品时，水可能从剃须刀底部的插口漏出。这是正常的，而且没有危险，因为所有的电子线路都密封在剃须刀内的一个密封壳内。
- 如果剃须刀、Jet Clean 高效能清洁系统 (PT927CC)、适配器、充电座 (PT927) 或任何其他部件损坏，请勿再使用，否则可能对人体造成伤害。务必用原始型号更换损坏的适配器、充电座或任何其他部件。
- 必须在 10° C 至 35° C 之间的温度下使用、存放及为剃须刀和 Jet Clean 高效能清洁系统 (PT927CC) 充电。
- 一定要在抗有机溶剂腐蚀的表面上放置和使用剃须刀和 Jet Clean 高效能清洁系统 (PT927CC)。
- 只能使用随附的适配器、充电座 (PT927) 和附件。
- 务必盖上剃须刀保护盖，以防止损坏剃须刀头并避免其内积聚灰尘。

Jet Clean 高效能清洁系统 (仅限于 PT927CC)

- Jet Clean 高效能清洁系统只能使用原装 Jet clean 高效能清洁液 (HQ200)。
- Jet Clean 高效能清洁系统必须放在稳定、平坦的水平表面上，以防漏液。
- Jet Clean 高效能清洁系统能彻底清洗您的剃须刀，但不能消毒；因此切勿与他人共用剃须刀。
- 如果剃须刀和 Jet Clean 高效能清洁系统在温度、压力或湿度方面发生重大改变，请使其适应 30 分钟后再使用。
- 请将 Jet Clean 高效能清洁系统的清洗仓倒空，并每隔 15 天通过在热水龙头下冲洗进行彻底清洗。
- 当 Jet Clean 高效能清洁系统准备就绪时，切勿移动以防溢漏。



符合标准

- 此剃须刀符合国际认可的 IEC 安全标准，可放心在自来水下清洗。
- 符号注释：适合用在打开的水龙头下进行清洗。
- 此剃须刀和 Jet Clean 高效能清洁系统符合关于电磁场 (EMF) 的所有相关标准。据目前的科学证明，如果正确使用并按照本用户手册中的说明进行操作，它们是安全的。

概述

- 本产品配有一个自动电压选择器，适合 100 至 240 伏范围内的电源电压。
- 电源适配器可将 100-240 伏的电压转换为 24 伏以下的安全低电压。

充电

此剃须刀充满电需要大约 1 小时。

如果是第一次为剃须刀充电，或是长时间未使用后充电，应让其连续充电，直到白色电池符号持续亮起。

充满电的剃须刀可提供长达 50 (PT878/PT877) 或 60 (PT927CC/PT927) 分钟的剃须时间。

剃须时间可能会因剃须行为、清洁习惯或胡须类型的差异而少于 50 (PT878/PT877) 或 60 (PT927CC/PT927) 分钟。

充电指示

电池电量不足

- 当电池电量即将耗尽时（仅剩 5 分钟或更少的剃须时间），电池符号将开始呈橙色闪烁。
- 关闭剃须刀时，电池符号将持续呈橙色闪烁几秒钟。

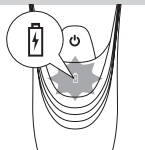

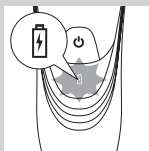

快速充电

- 开始为电量耗尽的电池充电时，电池符号将呈白色和橙色闪烁。

注意：当电池符号由呈白色和橙色闪烁变为仅呈白色闪烁时，您可以获得 3 分钟的快速剃须时间。

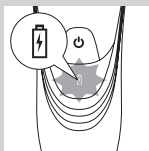

充电

- 当剃须刀正在充电时，电池符号将呈白色闪烁。

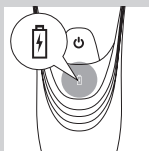

电池已完全充满

- 电池充满电后，电池符号将呈白色持续亮起。

注意：大约 30 分钟后，电池符号熄灭以节省能源。

使用适配器充电

不要将剃须刀放在软袋里充电。

1 将小插头插入剃须刀。

2 将电源适配器插入电源插座。

▶ 电池符号指示剃须刀的充电状态（见本章中的“充电指示”一节）。

在充电座上充电（仅限于 PT927）

1 将小插头插入充电座。

2 将电源适配器插入电源插座。

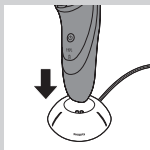

- 3** 将剃须刀插接在充电座中。
- ▶ 电池符号指示剃须刀的充电状态（见本章中的“充电指示”一节）。

在 Jet Clean 高效能清洁系统中充电 (仅限于 PT927CC)

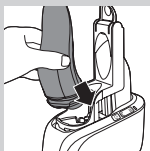

- 1** 将小插头插入 Jet Clean 高效能清洁系统。
- 2** 将电源适配器插入电源插座。
- 3** 将不带保护盖的剃须刀倒置放在剃须刀支架上。

注意：剃须刀头部件上安装了保护盖时，剃须刀将无法放入 Jet Clean 高效能清洁系统内。

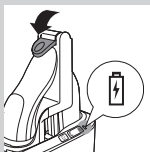

- 4** 完全推下锁定杆以将剃须刀锁定到位。
- ▶ Jet Clean 高效能清洁系统上的电池符号将闪烁，表示剃须刀正在充电。

注意：当 Jet Clean 高效能清洁系统执行清洗程序时，电池符号将熄灭。

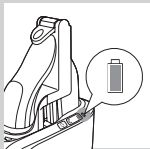

- ▶ 电池充满电时，Jet Clean 高效能清洁系统上的电池符号将持续亮起。

注意：大约 30 分钟后，电池符号熄灭以节省能源。

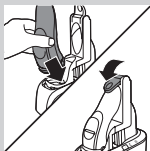

- 5** 要从 Jet Clean 高效能清洁系统中取出剃须刀：将锁定杆向上移，直到不能移动为止，然后取下剃须刀。

使用剃须刀

注意：您也可以直接插电使用本产品。
只需将剃须刀接到电源即可。

剃须

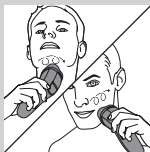

- 1** 按一下开/关按钮以启动剃须刀。
- 2** 将剃须刀头在皮肤上移动。作迂回运动。
- 您的皮肤可能需要 2 到 3 周才能适应飞利浦剃须系统。
- 3** 按一下开/关按钮关闭剃须刀电源。
- 4** 清洁剃须刀（见“清洁和保养”一章）。

修发

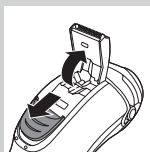

您可使用修剪器修剪鬓角和小胡子。

- 1** 按一下开/关按钮以启动剃须刀。
- 2** 向下推修剪器的滑动开关可打开修剪器。
▶ 现在可以开始修剪了。
- 3** 修剪后请关闭修发器，然后关闭剃须刀。
- 4** 清洁修剪器（见“清洁和保养”一章）。

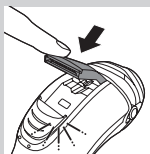

清洁和保养

切勿使用压缩气体、钢丝绒、研磨性清洁剂或腐蚀性液体（例如汽油或丙酮）来清洁剃须刀、充电座 (PT927) 和 Jet Clean 高效能清洁系统 (PT927CC)。

- 在 Jet Clean 高效能清洁系统 (PT927CC) 中清洁剃须刀是最有效、最卫生的方法。您还可以在水龙头下冲洗剃须刀或用随附的清洁刷进行清洁。
- 每次剃须后清洁剃须刀，以获得最佳的剃须性能。
- 为保证更好的剃须效果，剃须刀必须定期清洗。
- 为了获得最佳的效果，建议您使用飞利浦清洁喷雾剂 (HQ110) 和 Jet clean 高效能清洁液 (HQ200)(PT927CC)。
- 使用热水时一定要小心。切记先检查水温是否太高，以防烫手。

注意：冲洗产品时，水可能从剃须刀底部的插口漏出。这是正常的，而且没有危险，因为所有的电子线路都密封在剃须刀内的一个密封壳内。

在水龙头下冲洗剃须刀头部件



- 1** 关闭剃须刀电源，将其插头从插座上拔下。
- 2** 按下释放按钮，打开剃须刀头部件。
- 3** 在热水龙头下将剃须刀头部件和胡茬储藏室冲洗 30 秒。

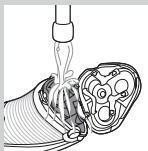

使用热水时一定要小心。切记先检查水温是否太高，以防烫手。

- 冲洗胡茬储藏室和剃须刀头部件内部。



- 冲洗剃须刀头部件外侧。

4 关闭剃须刀头部件并甩掉多余的水份。

甩掉多余的水份时，小心不要使剃须刀头部件敲到任何东西。

不要用毛巾或纸巾来擦干剃须刀头部件和胡茬储藏室，因为这样可能会损坏剃须刀头和连结轴。

5 再次打开剃须刀头部件，使它保持打开状态，使其完全晾干。

用随附的刷子清洁剃须刀头部件



1 关闭剃须刀电源，将其插头从插座上拔下。

2 按下释放按钮，打开剃须刀头部件。

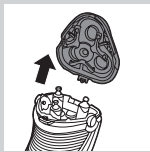

3 将剃须刀头部件拉出剃须刀。

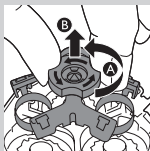

4 逆时针转动锁定装置 (A)，取下固定架 (B)。

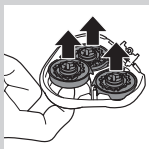

- 5** 一次取下并清洁一个剃须刀头。每个剃须刀头包含一组刀片和网罩。

注意： 不要同时清洁多组刀片和网罩，因为它们都是相互匹配的。如果不小心将刀片和网罩弄混，则需要数周时间才能恢复产品的最佳剃须性能。

- 从网罩取下刀片并用清洁刷进行清洁。
- 用清洁刷里里外外清洁网罩。

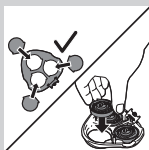
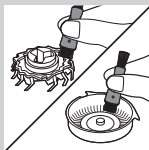

- 6** 将剃须刀头重新放入剃须刀头部件。

注意： 确保剃须刀头凸起部位正好插入凹陷部位。

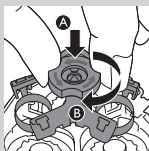

- 7** 将固定架放回剃须刀头部件 (A)，顺时针转动锁定装置 (B)。

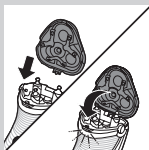

- 8** 将剃须刀头部件的凸缘插入剃须刀顶部的槽内。然后关闭剃须刀头部件。

注意： 如果剃须刀头部件关闭不畅，请检查剃须刀头插入是否正确，固定架是否被锁住。

在 Jet Clean 高效能清洁系统中清洁剃须刀头部件 (仅限于 PT927CC)

Jet Clean 高效能清洁系统可清洁剃须刀头部件。

Jet Clean 高效能清洁系统使用准备

注意：首次使用之前请注满清洗仓，如果“液量低”符号闪烁，则表示液量水位太低。当液量水位低于最低水位时，清洗符号和“液量低”符号将开始间歇性闪烁，剃须刀支架将返回起始位置

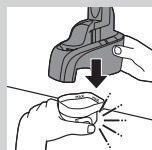
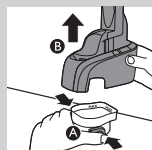
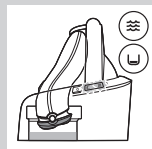

1 同时按下清洗仓两侧的释放钮 (A)。然后将 Jet Clean 高效能清洁系统从清洗仓上提起 (B)。

留下清洗仓。

2 拧开 Jet Clean 高效能清洁液 (HQ200) 的瓶盖，取下密封。

3 给清洗仓注入 Jet Clean 高效能清洁液 (HQ200)，直至最高水位标示 (MAX)。

注意：确保清洗仓内的清洁液始终装到 MIN 标记以上。

4 将 Jet Clean 高效能清洁系统重新放在清洗仓上（可听到“咔哒”一声）。

确保释放钮弹回到位。

当清洗仓装满 Jet Clean 高效能清洁液后，切勿移动以防溢漏。

5 将小插头插入 Jet Clean 高效能清洁系统，然后将电源适配器插入电源插座。

剃须刀支架将自动移至最高位置。

Jet Clean 高效能清洁系统现在可以使用。

使用 Jet Clean 高效能清洁系统

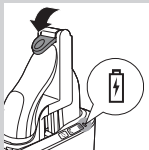

- 1** 将不带保护盖的剃须刀倒置放在剃须刀支架上。完全推下锁定杆以将剃须刀锁定到位。
- ▶ Jet Clean 高效能清洁系统上的电池符号将亮起，表示剃须刀正在充电。

注意：剃须刀头部件上安装了保护盖时，剃须刀将无法放入 Jet Clean 高效能清洁系统内。

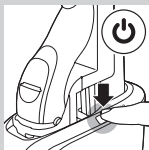

- 2** 按 Jet Clean 高效能清洁系统上的开/关按钮以启动清洁程序。
- ▶ Jet Clean 高效能清洁系统上的电池符号将消失。



- ▶ 在清洗程序运行期间，清洗符号将开始闪烁，剃须刀将自动降到清洁液中。
- ▶ 剃须刀将开关数次，并会向上和向下移动。
- ▶ 清洗符号在整个清洗程序中不断闪烁，这需要大约 8 分钟时间。
- ▶ 执行清洗程序后，Jet Clean 高效能清洁系统上的电池符号将出现，表示剃须刀正在充电。

注意：如果在清洗程序运行期间按 Jet Clean 高效能清洁系统的开/关按钮，则程序将中断并重置。此时，清洗符号将停止闪烁，剃须刀支架将返回起始位置。剃须刀可能仍然潮湿并且很脏，因为清洗程序尚未完成。

注意：如果在清洗程序运行期间将适配器从插座中拔出，则程序将中断。剃须刀支架将保持在当前位置不变。当您将适配器重新插入插座时，剃须刀支架将继续移动至最高位置。

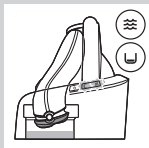

注意：当液量水位低于最低水位时，清洗符号和“液量低”符号将开始间歇性闪烁，剃须刀支架将返回起始位置

清洁 Jet Clean 高效能清洁系统

如果您每天使用 Jet Clean 高效能清洁系统，请每 15 天倒空清洗仓一次，并用热水彻底冲洗。否则至少每个月倒空并冲洗清洗仓一次。

- 1 可用湿布清洁 Jet Clean 高效能清洁系统的外表面。

切勿将 Jet Clean 高效能清洁系统浸入水中，也不要
在自来水龙头下冲洗。

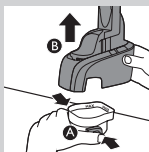

- 2 同时按下 Jet Clean 高效能清洁系统两侧的释放钮 (1)。然后将 Jet Clean 高效能清洁系统从清洗仓上提起 (2)。

留下清洗仓。



- 3 将清洗仓中残余的清洁剂倒出。
只需将清洁液倒入水槽，这不会对环境造成危害。

- 4 在热水龙头下冲洗清洗仓。

使用热水时一定要小心。切记先检查水温是否
太高，以防烫手。

清洗仓不可在洗碗机中清洗。



- 5 给清洗仓注入 Jet Clean 高效能清洁液 (HQ200)，直到最大 (MAX) 标示位置。

注意：确保清洗仓内的清洁液始终装到 MIN 标记以上。

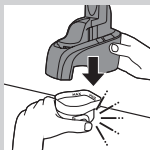

- 6** 将 Jet Clean 高效能清洁系统 重新放在清洗仓上（可听到“咔哒”一声）。确保释放钮弹回到位。

使用清洁刷清洁修剪器

每次使用后都要清洁修剪器。

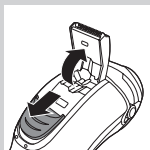

- 1** 关闭剃须刀电源，将其插头从插座上拔下。
2 向下推修剪器的滑动开关可打开修剪器。

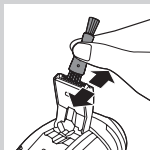

- 3** 使用清洁刷的短毛一侧清洁修剪器。沿着修剪器齿上下刷净。
4 关闭修发器（可听到“咔哒”一声）。

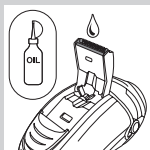

提示：为获得最佳修剪性能，请每隔六个月用一滴缝纫机油润滑修剪器齿。

存储

存放或随身携带剃须刀有几种方法：

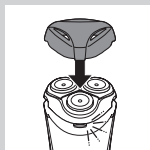

- 使用后请盖上剃须刀保护盖，以防止损坏剃须刀头并避免其内积聚灰尘。
- PT927CC/PT927：将剃须刀存放在随附的收纳袋中。
- PT927：将剃须刀存放在充电座上。
- PT927CC：将剃须刀放入 Jet Clean 高效能清洁系统中。确保保护盖没有盖在剃须刀头部件上。

注意（适用于 PT927CC）： 如果您不希望剃须刀储藏在 Jet Clean 高效能清洁系统中时充电，只需保持锁定杆处于直立位置

更换

为获得最佳剃须效果，建议每两年更换一次剃须刀头。

更换提醒

剃须刀头符号会亮起，指示需要更换剃须刀头。应立即更换损坏的剃须刀头。

仅可使用原装飞利浦 HQ9（PT927、PT927CC）或 HQ8（PT878、PT877）剃须刀头进行更换。

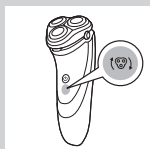

1 剃须刀头符号会呈橙色持续亮起。

2 关闭剃须刀。断开剃须刀电源并将其从 Jet Clean 高效能清洁系统或充电座中取下。

3 按下释放按钮，打开剃须刀头部件。

4 将剃须刀头部件拉出剃须刀。



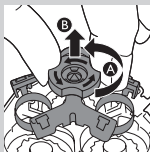

- 5** 逆时针转动锁定装置 (A)，取下固定架 (B)。

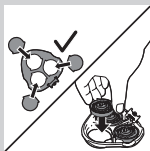

- 6** 取下剃须刀头，在剃须刀头部件上装上新刀头。

注意：确保剃须刀头凸起部位正好插入凹陷部位。

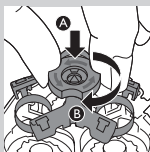

- 7** 将固定架放回剃须刀头部件 (A)，顺时针转动锁定装置 (B)。

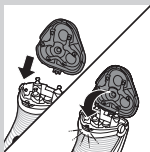

- 8** 将新剃须刀头部件的凸缘插入剃须刀顶部的槽内。然后关闭剃须刀头部件。

注意：如果剃须刀头部件关闭不畅，请检查剃须刀头插入是否正确，固定架是否被锁住。

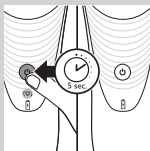

- 9** 按住开/关按钮 5 秒钟可重置剃须刀更换提醒。橙色指示灯会熄灭。

订购附件

要购买附件和备件，请访问 www.shop.philips.com/service 或 请联系飞利浦经销商。您也可以联系您所在国家/地区的飞利浦客户服务中心（联系详情，请参阅全球保修卡）。

为了保持剃须刀的最佳性能，请确保定期清洁并在推荐的时间更换剃须刀头。

剃须刀头

- 建议您每两年更换一次剃须刀头。务必使用飞利浦 HQ9 (PT927CC/PT927) 或 HQ8 (PT878/PT877) 剃须刀头进行更换。

清洁

- 使用 Jet clean 高效能清洁液 (HQ200) 定期清洁剃须刀头。
- 使用清洁喷雾剂 (HQ110) 彻底清洁剃须刀头。



环保



- 弃置剃须刀和 Jet Clean 高效能清洁系统（仅限于特定型号）时，请不要将其与一般生活垃圾堆放在一起；应将其交给官方指定的回收中心。这样做有利于环保。



- 内置充电电池含有可能会污染环境的物质。丢弃剃须刀时，一定要将电池取出，或将剃须刀送到官方指定的回收站。到官方指定的电池回收站处理电池。如果您在取出电池时遇到问题，您也可以将剃须刀送至飞利浦维修中心。维修中心的员工会帮您取出电池，并以环保的方式处理它。

卸下剃须刀的充电电池

只有在丢弃剃须刀时才可取下充电电池。
请确保在取下充电电池时电量已完全耗尽。

1 断开剃须刀电源并将其从 Jet Clean 高效能清洁系统或充电座中取下。

2 让剃须刀运行至停转。

3 拧下剃须刀背面和胡茬储藏室内的螺钉。

4 拆下前面板和后面板。

5 将 6 个钩子向外掰，取出电源部件。

注意，钩子非常锋利。

6 取出电池。

注意，电池带非常锋利。

在取出充电电池之后，请勿将剃须刀重新放入插入式 Jet Clean 高效能清洁系统或充电座中。

取出充电电池之后，不要再将剃须刀与电源相连。

保修和支持

如果您需要信息或支持，请访问 www.philips.com/support 或阅读单独的全球保修卡。

保修条款

由于剃须刀头（刀片和网罩）属于易磨损物品，因此不在国际保修条款的涵盖范围之列。

故障种类和处理方法

本章归纳了使用本产品时最可能遇到的问题。如果您无法根据下面的信息解决问题，请联系您所在国家/地区的飞利浦客户服务中心。

问题	可能的原因	解决方法
剃须刀的剃须效果没有以前好。	由于清洗仓内的清洁剂可能受到污染或清洁剂水位太低，Jet Clean 高效能清洁系统（仅限于 PT927CC）可能无法正常清洗剃须刀。	在继续剃须之前，请先彻底清洁剃须刀。如有必要，请清洁清洗仓并为其重新注入清洁剂（见“清洁和保养”一章）。
	剃须刀头已损坏或磨损。	更换剃须刀头（见“更换”一章）。
	过长的胡须堵塞了剃须刀头。	逐个清洁剃须刀头（见“清洁和保养”一章中的“使用清洁刷清洁剃须刀头部件”部分内容）。
	您没有正确插入剃须刀头。	确保剃须刀头凸起部位正好插入凹陷部位（见“使用清洁刷清洁剃须刀头部件”部分）。
按下开/关按钮时，剃须刀不工作。	充电电池的电量已耗尽。	为电池充电（见“充电”一章）或将剃须刀接到电源。
	剃须刀的温度过高。此时，剃须刀无法工作。	一旦剃须刀降到足够低的温度，便可重新打开剃须刀。

问题	可能的原因	解决方法
PT927CC: 剃须刀放在 Jet Clean 高效能清洁系统中清洁之后依然没有完全干净。	清洗仓内的清洁剂可能被污染。	将清洗仓倒空并用水冲洗（见“清洁和保养”一章中的“在 Jet Clean 高效能清洁系统中清洁剃须刀头部件”部分）。
	清洁剂水位过低。如果在清洗程序运行期间清洗仓中的液体容量降到了最低水位以下，程序将中断。清洗符号和“液量低”符号将开始间歇性闪烁，支架将恢复至最初的位置。	给清洗仓重新注入清洁剂，直至最大水位 (MAX)（见“清洁和保养”一章中的“在 Jet Clean 高效能清洁系统中清洁剃须刀头部件”部分）。
	您使用了其他清洁剂，而不是原装飞利浦清洁剂。	只能使用 Jet clean 高效能清洁液 HQ200。
	您没有正确关闭 Jet Clean 高效能清洁系统的锁定杆，或没有将剃须刀正确放入 Jet Clean 高效能清洁系统中。在这些情况下，Jet Clean 高效能清洁系统开始运行，但并非正确执行清洗程序。	将不带保护盖的剃须刀正确放入 Jet Clean 高效能清洁系统中。正确关闭锁定杆。

问题	可能的原因	解决方法
PT927CC: 按下开/关按钮时, Jet Clean 高效能清洁系统不工作。	Jet Clean 高效能清洁系统未通电。	将小插头插入 Jet Clean 高效能清洁系统, 然后将电源适配器插入电源插座。
清洁后, 有水从剃须刀漏出。	这是正常的, 没有危险。	在冲洗期间, 电源部件和外壳之间会留有一些水。冲洗后, 水从插孔中流出。电源部件是完全防水的, 所以水不会进入剃须刀的电子部件。您的剃须刀是绝对安全的。

PHILIPS

产品 : 飞利浦电动剃须刀
 型号 : PT927, PT927CC, PT877
 额定电压 : 220V~
 额定频率 : 50Hz
 额定输入功率: 9 W
 生产日期 : 请见产品本体
 产地 : 中国广东珠海



珠海经济特区飞利浦家庭电器有限公司
 中国珠海市三灶镇琴石工业区
 全国顾客服务热线: 4008 800 008

本产品根据国标 GB4706.1-2005, GB4706.9-2008
 制造

PHILIPS

产品 : 飞利浦电动剃须刀
 型号 : PT927CC, PT927, PT878, PT877
 额定电压 : 220V~
 额定频率 : 50Hz
 额定输入功率: 7.5 W
 生产日期 : 请见产品本体
 产地 : 中国广东珠海



珠海经济特区飞利浦家庭电器有限公司
 中国珠海市三灶镇琴石工业区
 全国顾客服务热线: 4008 800 008

本产品根据国标 GB4706.1-2005, GB4706.9-2008
 制造

请妥善保管本使用说明书

发行日期: 02/10/2013



www.philips.com



100% recycled paper
100% papier recyclé
100% 循环再造纸

4222.002.5563.1