

IMPORTANT SAFETY INSTRUCTIONS

When using an electric appliance, basic safety precautions should always be followed, including the following:

Read all instructions before using this appliance.

DANGER

To reduce the risk of electric shock:

1. Do not reach for a corded groomer that has fallen into water. Unplug immediately.
2. Power plug and the accessories connected to it are not for immersion or for use in shower.
3. Do not use an extension cord with this appliance.
4. Always unplug the groomer from the electrical outlet immediately after use, except when groomer is (re)charging.
5. Unplug and remove power supply cord from groomer before cleaning.
6. The batteries used in this device may present a fire or chemical burn hazard if mistreated. Do not disassemble, heat above 100°C (212°F) or incinerate.

WARNING

To reduce the risk of burns, fire, electric shock or injury to persons:

1. Close supervision is necessary when this appliance is used by, on, or near children or invalids.
2. Use this groomer for its intended household use as described in this manual. Do not use attachments not recommended by Philips Electronics North America Corporation.
3. Never operate this groomer if it has a damaged cord or plug, if it is not working properly, if it has been dropped, damaged, or dropped into water while plugged in. For assistance call 1-800-243-3050.
4. Keep the groomer, cord, charging plug and any attachments away from heated surfaces.
5. Never drop or insert any object into any opening.
6. Do not use the adapter in or near a power outlet that contains an electric air freshener to prevent damage to the adapter.
7. Do not operate, charge, clean or plug in groomer outdoors or where aerosol (spray) products are being used or where oxygen is being administered.
8. Always check foil, cutters, cutting unit, combs and trimmers before using the groomer. Do not use the groomer if foil, cutters, cutting unit, combs or trimmers are damaged, as injury may occur.
9. Always attach plug to groomer first, then to outlet. To disconnect, turn groomer "OFF", then remove plug from outlet.
10. To prevent possible damage to the cord, do not wrap cord around the groomer.
11. Never put groomer in direct sunlight or store at a temperature above 140°F (60°C).
12. This groomer is for use on human hair only. Do not use this groomer for any other purpose.
13. Groomer is water-safe and can be rinsed under running tap water or used in the shower. Do not submerge groomer in water.
14. Only use the power plug and other accessories supplied with the appliance.

SAVE THESE INSTRUCTIONS

IMPORTANT: The power plug contains a transformer. Do not cut off the power plug to replace it with another plug as this will cause a hazardous condition.

Features

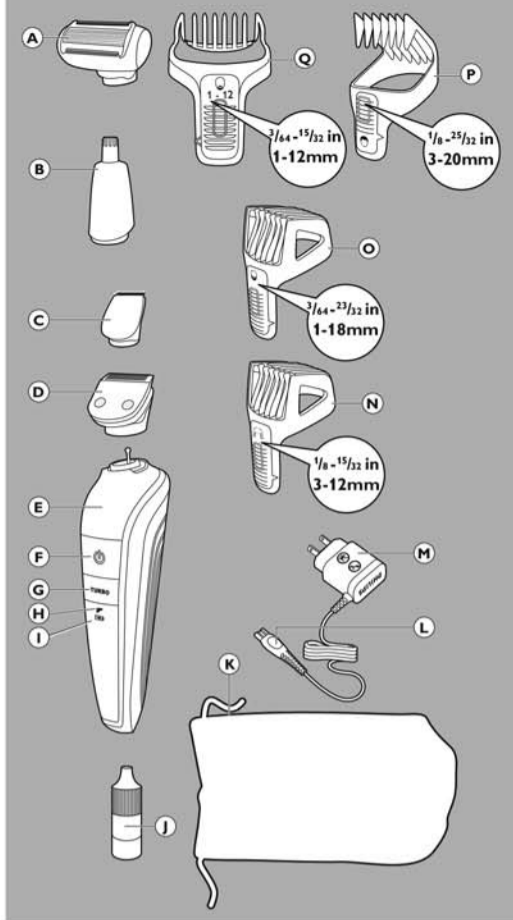

- A Bodygroom Shaver
 - B Nose Trimmer
 - C Precision Trimmer
 - D Full Size Metal Guard Trimmer
 - E Handle
 - F On/Off Button
 - G Turbo Button
 - H Turbo Status Indicator
 - I Battery Status Indicator
 - J Oil
 - K Storage Pouch
 - L Small Appliance Plug
 - M Adapter
 - N Body Comb
 - O Beard Comb
 - P Hair Comb
 - Q Stubble Comb
- Full 2-Year Warranty
45-Day Money-Back Guarantee

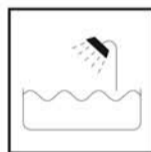

This symbol indicates that the Groomer can be used in the bath or shower.

Registration

Congratulations on your purchase and welcome to Philips Norelco!

To fully benefit from the support that Philips Norelco offers, register your product at www.norelco.com/register

Put It To The Test

Like many new products, your Philips Norelco Multigroom Pro Grooming Kit may take a little getting used to. If you are using an electric Groomer for the first time, or if you've been using a different brand, take the time to acquaint yourself with your new Grooming Kit.

Your Multigroom Pro Grooming Kit features head to toe styling with a Bodygroom shaver and powerful battery combined with all the attachments to make trimming facial hairs or hair clipping goof proof.

Throw your scissors away and put your new Multigroom Pro Grooming Kit to the test. We guarantee precise, professional results or Philips Norelco will refund you the full purchase price as long as the request is received within 45 days of purchase.

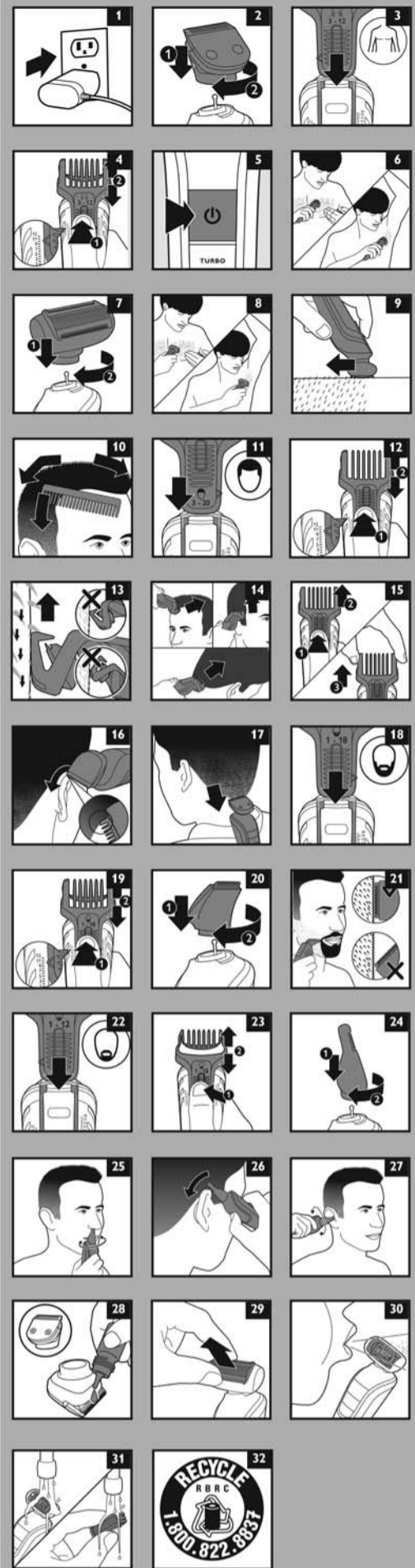

To Charge/Recharge

- ▶ Fully charge Groomer before using for the first time or after non-use for a long period of time.
- ▶ Charging, recharging or using Groomer at temperatures below 40°F (4,5°F) or higher than 95°F (35°F) adversely affects lifespan of the battery.
- ▶ If the Groomer is subjected to a major change in temperature, pressure or humidity, let the Groomer acclimatize for 30 minutes before using.

- 1 Be certain Groomer is OFF.
- 2 Connect small plug to Groomer and plug the adapter into any 120V AC outlet (fig. 1). Use only the cord provided.
 - ▶ An adaptor plug may be necessary for power cord usage in some foreign countries. Use an attachment plug adaptor of the proper configuration for the power outlet.
- 3 It will take approximately 1 hour to fully charge the Groomer for a cordless trimming time of up to 60 minutes.
- 4 The Battery Status Indicator will blink white to indicate the Groomer is charging.
- 5 If the battery runs low (approximately 10 minutes of grooming time left) the Battery Status Indicator will light up orange indicating the Groomer needs to be (re)charged.

NOTE: You can also quick charge the Groomer. A 5-minute charge will give you approximately 5 minutes of cordless grooming time.

- 6 Disconnect the cord and unplug from electrical outlet.

Turbo Power

- Simply press the Turbo Button for a turbo power boost for fast results and the Turbo indicator will light up blue. The memory function will remember the last used setting.

Body Trimming

- Use this Groomer for its intended household use as described in this manual.
- Before using, check foil, cutters and trimmers for wear or damage. If foil, cutters or trimmers show signs of wear or damage, do not use Groomer as injury may occur. Do not use Groomer until foil, cutters or trimmers have been replaced.
- Make sure that the Groomer is fully charged before you start trimming.
- Make sure hair is clean and dry as wet hair tends to stick to the body.

Take your time and do not move the Groomer too fast. Make smooth and gentle movements.

- 1 Charge according to directions. Unplug groomer from outlet and remove cord.
- 2 Press ON/OFF button ON to begin trimming.
- 3 If the charge runs low, the battery status indicator will light up orange.
- 4 Connect appliance plug to Groomer. A quick charge for 5 minutes gives you 5 minutes of trimming time.

Body Trimming with Body Comb

- Always use the body comb when trimming sensitive areas.

- 1 Put the trimmer on the Groomer handle (1) and turn clockwise (2) (fig. 2).
- 2 Slide the body comb into the guiding grooves on both sides of the handle (fig. 3).
- 3 Press the Hair Length Setting Selector (1) and slide the comb to the desired setting (2) (fig. 4).

The body comb cuts hair to a length of 1/8 - 15/32 in / 3-12mm.

- 4 The setting selected is shown on the back of the Groomer.

- If you are trimming for the first time, start by using the comb at the maximum trimming length setting (15/32 in/12mm) to prevent accidentally trimming hairs too short. As you become familiar with the settings, adjust Hair Length Setting Selector to desired trimming length. Selector will 'click' into position at each setting.

- 5 Turn the Groomer ON (fig. 5).

- 6 To trim in the most effective way, move the Groomer slowly against the direction of hair growth (fig. 6). Make sure the surface of the comb always stays in contact with the skin.

NOTE: Since all hairs do not grow in the same direction, you may want to try different trimming positions (i.e., upwards, downwards, or across). Practice is best for optimum results.

- If a lot of hair has accumulated in the comb, remove the comb and blow and/or shake the hair out of the comb.
- REMEMBER: You must reset the hair length setting selector back to your desired setting every time you replace the comb on the appliance.
- The length setting is equal to the hair length that will remain after trimming.

- 7 Turn off Groomer (fig. 5). Rinse the comb clean after each use.

Body Shaving with Bodygroom Shaver

- Do not use this Groomer to shave facial or scalp hair. The Groomer should only be used on skin below the neckline.
- When shaving sensitive areas, you may feel some discomfort, irritation or reddening of the skin. This is normal as your skin needs time to adjust to shaving.
- If your hair is longer than 13/32 in/10 mm, trim hair with the body comb first for optimum shaving results.
- For dry use, be certain your skin is clean and dry before using the Groomer.
- For wet use, you may prepare your skin with lathered soap or shaving foam before using the Groomer.
- Do not use the shaver if foil or cutters are damaged or broken as injury may occur.

- Make sure the shaving foil is in complete contact with your skin for the closest shave and minimum foil wear.
- Pressing too hard may cause skin irritation.
- Practice is best for optimum results.

- 1 Put the Bodygroom Shaver on the Groomer handle (1) and turn clockwise (2) (fig. 7).

- 2 Turn the Groomer ON (fig. 5).

- 3 Stretch your skin taut with your free hand and gently press Groomer to skin and move it slowly and smoothly, making sure the shaving foil is in full contact with the skin (fig. 8). Do not press too hard. Too much pressure can distort the foil and cause skin irritation.

TIP: Stretching your skin can help hairs stand upright and minimize the chance of skin irritation.

- 4 Always move the Groomer against the direction of hair growth (fig. 9).

- 5 Turn OFF Groomer (fig. 5). Clean the body shaver after each use.

Hair Clipping

- Make sure that the appliance is fully charged before you start clipping hair.
- Before you start clipping, make sure that the head of the person whose hair you are cutting is at the same level as your chest so that all parts of his/her head are clearly visible and within easy reach.
- Make sure the hair is clean and dry.
- Before you begin, comb the hair in the direction of growth (fig. 10).
- To achieve optimal clipping results, always move the appliance slowly through the hair against the direction of hair growth.

Clipping with hair comb

- 1 Put the trimmer on Groomer handle (1) and turn clockwise (2) (fig. 2).

- 2 Slide the hair comb into the guiding grooves on both sides of Groomer handle (fig. 11).

- 3 Press the Hair Length Setting Selector (1) and slide the comb to the desired setting (2) (fig. 12).

The hair comb cuts hair to a length of 1/8 in - 25/32 in / 3-20mm.

- 4 The setting selected is shown on the back of the Groomer.

When you are clipping for the first time, start at the maximum clipping length setting (25/32 in/20mm) to familiarize yourself with the appliance and prevent accidentally trimming hairs too short. As you become familiar with the settings, adjust the Hair Length Setting Selector to desired trimming length. Selector will 'click' into position at each setting.

- 5 Turn the Groomer ON (fig. 5).

- 6 Make sure that the flat part of the comb is always in full contact with the scalp to obtain an even result (fig. 13).

- 7 Move the appliance slowly over the crown from different directions to achieve an even result (fig. 14).

- 8 Always move the appliance against the direction of hair growth. Press lightly.

- 9 Make overlapping passes over the head to ensure that all hair that should be cut has been cut.

- 10 Turn the Groomer off and remove the hair comb often to blow and/or shake out hair that has accumulated.

- REMEMBER: You must reset the hair length selector back to your desired setting every time you replace the hair comb on the appliance.

TIP: Write down the settings you have used to create a certain hairstyle as a reminder for future clipping sessions.

Contouring without the hair comb

- Use the Groomer without a comb to clip hair very close to the skin (3/64 in./1mm) or to contour the neckline and area around the ears.

- 1 Remove the hair comb by pressing the Hair Length Setting Selector (1) and slide the comb upwards (2). Pull comb off Groomer (fig. 15).

Be careful when you are clipping without a comb attachment as when the Clipper is turned on it will remove every hair it touches.

- 2 To contour the hairline around the ears, comb the hair ends over the ears.

- 3 Tilt the Groomer in such a way that only one edge of the cutter blades touches the hair ends when you shape the contours around the ears (fig. 16).

Be careful not to trim too much. The hairline should be close to the ear.

- 4 To contour the nape of the neck or sideburns, turn the Groomer and make downward strokes (fig. 17).

- 5 Move the Groomer slowly and smoothly following the natural hairline.

Trimming your Beard & Moustache with Beard Comb

- 1 Put the trimmer on Groomer handle (1) and turn clockwise (2) (fig. 2).

- 2 Slide the beard comb into the guiding grooves on both sides of the handle (fig. 18).

- 3 Press the Hair Length Setting Selector (1) and slide the comb to the desired setting (2) (fig. 19).

The beard comb cuts hair to a length of 3/64 - 23/32 in / 1-18mm.

- If you are trimming for the first time, start by using the comb at the maximum trimming length setting (23/32 in/18mm) to prevent accidentally trimming hairs too short. As you become familiar with the settings, adjust Hair Length Setting Selector to desired trimming length. Selector will 'click' into position at each setting.

- 4 Turn the Groomer ON (fig. 5).

- 5 To trim in the most effective way, move the Groomer against the direction of hair growth. Make sure the surface of the comb always stays in contact with the skin.

NOTE: Since all hairs do not grow in the same direction, you may want to try different trimming positions (i.e., upwards, downwards, or across). Practice is best for optimum results.

- If a lot of hair has accumulated in the comb, remove the comb and blow and/or shake the hair out of the comb.

- REMEMBER: You must reset the hair length selector back to your desired setting every time you replace the comb on the appliance.
- The remaining hair length corresponds with the smallest distance between the cutting blade and the spot where the comb is in contact with the skin.

Beard Trimming Without Beard Comb

Remove comb if you are:

- Defining hair lines
- Trimming nape of neck
- Removing single, unwanted hairs

- 1 Be certain the Groomer is in the OFF position.

- 2 Remove the comb by pressing the Hair Length Setting Selector (1) and slide the comb upwards (2). Pull comb off Groomer.

- 3 Turn the Groomer ON (fig. 5).

- 4 Make well-controlled movements. Touch the hair/skin lightly with the Groomer.

Styling/Contouring with Precision Trimmer

- Use the precision trimmer to cut shapes in beard hair or scalp hair.
- Be careful when using the precision trimmer as it removes every hair it touches.

- 1 Put the precision trimmer on the Groomer handle (1) and turn clockwise (2) (fig. 20).

- 2 Make careful and controlled movements with the precision trimmer.

- 3 For best results, move the precision trimmer against the direction of hair growth making sure it is in full contact with the skin (fig. 21).

Stubble Trimming With Stubble Comb

- Use the stubble comb to trim your stubble to different lengths.
- The stubble comb cuts hair to a length of 3/64 - 15/32 in. (1-12 mm).

- 1 Put the trimmer on Groomer handle (1) and turn clockwise (2) (Fig. 2).

- 2 Slide the stubble comb into the guiding grooves, on both sides of Groomer handle (Fig. 22).
- 3 Press the Hair Length Setting Selector (1) and slide the comb to the desired setting (2) (Fig. 23).
- 4 Turn the Groomer ON (Fig. 5).
- 5 To trim the most effective way, move the Groomer against the direction of hair growth. Do not move the Groomer too fast. Make smooth and gentle movements and make sure the surface of the detail comb always stays in contact with the skin.

Grooming Nose/Ear Hair

- 1 Be certain the Groomer is in the OFF position.
- 2 Remove the trimmer by turning counter-clockwise and pulling it off the Groomer handle.
- 3 Put the nose trimmer on the Groomer handle (1) and turn clockwise (2) (fig. 24).

Trimming Nose Hair

- ▶ Make sure nasal passages are clean.

- 1 Put the nose trimmer on the Groomer handle (1) and turn clockwise (2) (fig. 24).
- 2 Turn the Groomer ON and insert the tip of the attachment into one nostril (fig. 25).

CAUTION: Do Not insert the tip more than 3/16 in./5mm into your nostril.

- 3 Slowly move the tip in and out while turning it around at the same time in order to remove unwanted hair. For best results, make sure the side of the tip is firm against skin. This will reduce the tickling effect that can occur during trimming of nose hair.
- 4 Turn off Groomer. Rinse attachment clean after each use.

Trimming Ear Hair

- ▶ Clean outer area of ear and ear canal. Make sure it is free of wax.
- ▶ Nose trimmer should be on the Groomer.

- 1 Turn the Groomer ON and move the tip softly around the edge of ear to remove hairs extending beyond the outer ear (fig. 26).
- 2 Carefully insert the tip into outer ear canal (fig. 27).

CAUTION: Do not insert the tip further than 3/16 in./5mm into the ear as this could cause damage to the eardrum.

- 3 Turn off Groomer. Rinse attachment clean after each use.

Cleaning

- ▶ Clean the attachments after each use.
- ▶ Always switch Groomer OFF, unplug and remove power supply cord from Groomer before cleaning.
- ▶ Do not use compressed air, abrasive cleaning agents, scourers or liquids such as alcohol, benzene, bleach or acetone to clean the Groomer and attachments.
- ▶ Never clean, replace or remove Groomer attachments with motor ON.
- ▶ Do not apply pressure to cutters.
- ▶ Do not touch cutters with hard objects as this may damage them.

During Use:

- ▶ If cut hairs have accumulated in the comb area, remove hairs by shaking or blowing. Remember to adjust the trimming length back to your selected setting when you replace the comb on Groomer.

After Each Use:

- 1 Make sure the Groomer is switched OFF and disconnected from the electrical outlet.
- 2 Remove any comb or attachment.
- 3 Blow and/or shake out any hair that may have accumulated in the comb or attachment.
- 4 Rinse combs, attachments and appliance under warm tap water.
- 5 Shake excess water from combs and attachments and allow to air dry thoroughly.
- 6 Place the attachment back on the Groomer handle.

For optimal trimming performance, lubricate the full metal guard trimmer teeth with a few drops of the oil supplied every three months (fig. 28).

Cleaning the Body Shaver

- 1 Pull the shaving unit out of the body shaver (fig. 29).
- 2 Blow and/or shake out any hair that may have accumulated inside the body shaver (fig. 30).
- 3 Clean the body shaver and shaving unit under warm tap water (fig. 31).
 - ▶ The shaving foil is very delicate and should not be handled.
 - ▶ If foil becomes damaged, do not continue using the body shaver. Do not apply pressure to shaving foil.

- 4 Shake excess water from body shaver and shaving unit and allow to air dry thoroughly. Do not use a towel to dry the shaving unit as damage could occur.

Replacing the Bodygroom Shaver Shaving Foil Head

- ▶ If the shaving unit is worn or damaged, do not continue using the Bodygroom shaver. Replace the shaving unit immediately.
- ▶ It is recommended that you replace your shaving unit once a year.
- ▶ A worn or damaged shaving unit should only be replaced with an original Philips Norelco shaving foil, model BG2000, which is available on the Philips Norelco website, www.philips.com/support or call 1-800-243-3050 for assistance.
- ▶ The foil is a precision part. Handle with care.

- 1 Always switch Groomer OFF and remove Groomer plug from outlet before replacing shaving unit.
- 2 Remove the shaving unit head by pulling it off the appliance.
- 3 Place the new shaving unit head on the Groomer by snapping it into place. You will hear a "click".

After replacing the shaving unit head, check that the shaving head is firmly attached before using Groomer.

This Groomer has no other user-serviceable parts. For assistance call 1-800-243-3050.

Storage

- ▶ Be sure Groomer is turned OFF. Remove cord from outlet and Groomer before storing in a safe, dry location where it will not be crushed, banded, or subject to damage.
- ▶ Store the Groomer and attachments in the pouch to prevent damage.
- ▶ Do not wrap cord around Groomer when storing.
- ▶ Store cord in a safe location where it will not be cut or damaged.
- ▶ Do not place or store Groomer where it can fall or be pulled into a tub or sink, water or other liquid while plugged in.

Assistance

For assistance visit our website:

www.philips.com/support or call toll free: 1-800-243-3050

Online information is available 24 hours a day, 7 days a week.

Disposal

- ▶ This Philips Norelco Groomer contains a rechargeable Lithium-Ion battery, which must be disposed of properly (fig. 32).
- ▶ Contact your local town or city officials for batteries disposal information or call 1-800-8-BATTERY or www.rbrc.com for drop-off locations.
- ▶ For assistance, visit our website: www.philips.com/support or call toll free: 1-800-243-3050.

PHILIPS

NORELCO

Multigroom



QG3390

Rechargeable Cordless Electric Groomer

BC

Always here to help you

Register your product and get support at www.norelco.com/register



4222 002 8646 1

Full Two-Year Warranty

Philips Electronics North America Corporation warrants each new Philips Norelco product, Model QG3390 (except cutters, combs and foil) against defects in materials or workmanship for a period of two years from the date of purchase, and agrees to repair or replace any defective product without charge.

IMPORTANT: This warranty does not cover damage resulting from accident, misuse or abuse, lack of reasonable care, the affixing of any attachment not provided with the product or loss of parts or subjecting the product to any but the specific voltage. *** NO RESPONSIBILITY IS ASSUMED FOR ANY SPECIAL, INCIDENTAL OR CONSEQUENTIAL DAMAGES.** In order to obtain warranty service, simply go to www.philips.com/norelco or call 1-800-243-3050 for assistance. It is suggested that for your protection you return shipments of product by insured mail, insurance prepaid. Damage occurring during shipment is not covered by this warranty. **NOTE:** No other warranty, written or oral, is authorized by Philips Electronics North America Corporation. This warranty gives you specific legal rights, and you may also have other rights which vary from state to state. Some states do not allow the exclusion or limitation of incidental or consequential damages, so the above exclusion and limitations may not apply to you. *Read enclosed instructions carefully.

Manufactured for:
Philips Consumer Lifestyle
A Division of Philips Electronics North America Corporation
P.O. Box 10313, Stamford, CT 06904

This symbol on the product's nameplate means it is listed by Underwriters' Laboratories, Inc.

Norelco is a Registered Trademark of Philips Electronics North America Corporation.

PHILIPS is a Registered Trademark of Koninklijke Philips N.V.

© 2015 Philips Electronics North America Corporation. All Rights Reserved.

PHILIPS

NORELCO

45-DAY MONEY-BACK GUARANTEE

If you are not fully satisfied with your Philips Norelco Groomer send the product back and we'll refund you the full purchase price.

The Groomer must be shipped prepaid by insured mail, insurance prepaid, have the original sales receipt, indicating purchase price and date of purchase, and the money-back guarantee return authorization form enclosed. We cannot be responsible for lost mail.

The Groomer must be postmarked no later than 45 days after the date of purchase. Philips Norelco reserves the right to verify the purchase price of the product and limit refunds not to exceed suggested retail price.

To obtain money-back guarantee return authorization form, call 1-800-243-3050 for assistance.

Delivery of refund check will occur 6-8 weeks AFTER receipt of returned product.