

HP4722

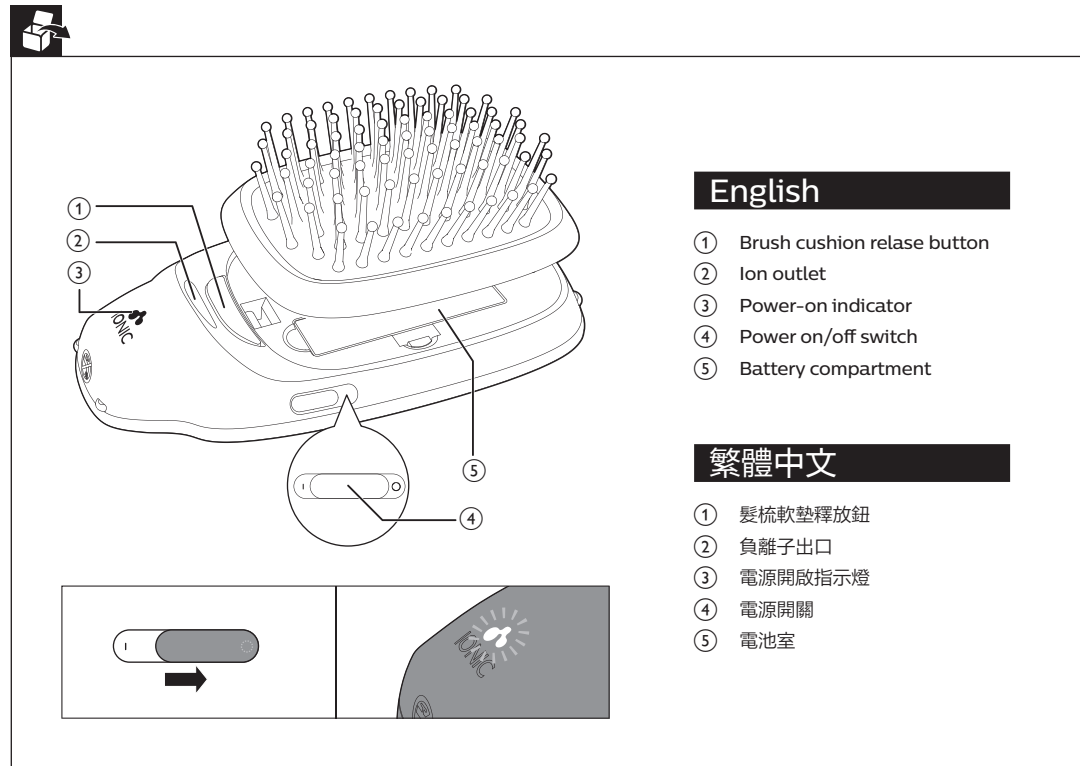

EN User manual ZH-HK 使用手冊

PHILIPS



English

- ① Brush cushion release button
- ② Ion outlet
- ③ Power-on indicator
- ④ Power on/off switch
- ⑤ Battery compartment

繁體中文

- ① 髮梳軟墊釋放鈕
- ② 負離子出口
- ③ 電源開啟指示燈
- ④ 電源開關
- ⑤ 電池室

English

Congratulations on your purchase, and welcome to Philips!
 To fully benefit from the support that Philips offers, register your product at www.philips.com/welcome.

1 Important

Read this user manual carefully before you use the appliance and keep it for future reference.

- **WARNING:** Do not use this appliance near water.
- Never immerse the brush body in water or any other liquid, nor rinse it under the tap.
- Always switch off the appliance after use.
- This appliance can be used by children aged from 8 years and above and persons with reduced physical, sensory or mental capabilities or lack of experience and knowledge

if they have been given supervision or instruction concerning use of the appliance in a safe way and understand the hazards involved.

- Children shall not play with the appliance. Cleaning and user maintenance shall not be made by children without supervision.
- Always return the appliance to a service centre authorized by Philips for examination or repair. Repair by unqualified people could result in an extremely hazardous situation for the user.
- Never use any accessories or parts from other manufacturers or that Philips does not specifically recommend. If you use such accessories or

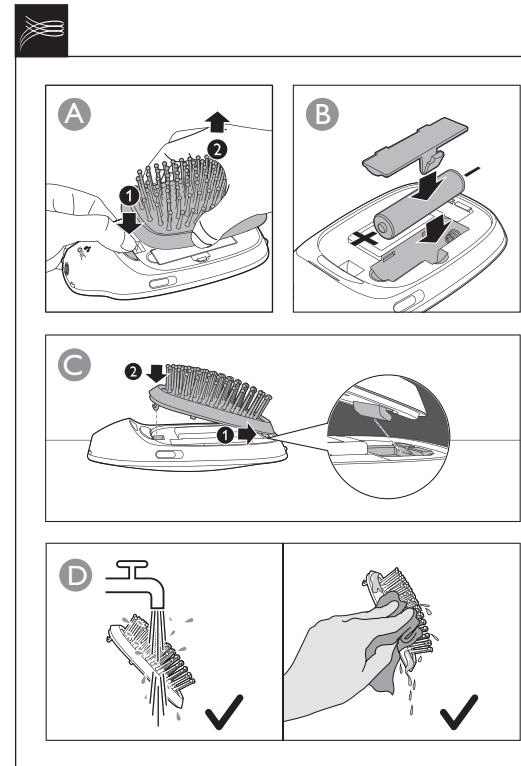

parts, your guarantee becomes invalid.

- Only use this product for its intended purpose and follow the general and battery safety instructions as described in this user manual. Any misuse can cause electric shock, burns, fire and other unexpected hazards or injuries.
- Do not use the appliance on artificial hair.
- Never block the ion outlet.
- Do not insert metal objects into the ion outlet to avoid unexpected dangers.
- Do not use this ion brush together with hairdryer for styling purpose.

- Never rinse the brush body under tap water.
- Do not expose the brush under sunlight for long period of time. The ultraviolet ray may lead to aging in the brush, which the product can break easily.
- Use and store the appliance at a temperature between 15 °C and 35 °C.
- Only operate the appliance with one 1.5V AAA alkaline battery.
- Open battery compartment in order to install or remove the battery.
- The bypack battery is not rechargeable. Non-rechargeable batteries are not to be recharged.
- The rechargeable battery must be removed out of the appliance before being charged.
- Insert batteries with the + and - poles pointing in the direction indicated in the battery compartment or holder.
- Exhausted batteries are to be removed from the appliance and safely disposed of.
- If the appliance is to be stored unused for a long period, the batteries should be removed.
- The supply terminals are not to be short-circuited.
- Do not burn products and their batteries and do not expose them to direct sunlight or to high temperatures (e.g. in hot cars or near hot stoves). Batteries may explode if overheated.

- If the product becomes abnormally hot or gives off an abnormal smell, stop using it and contact your local Philips dealer.
- Do not place products and their batteries in microwave ovens or on induction cookers.
- To prevent batteries from heating up or releasing toxic or hazardous substances, do not disassemble, modify, pierce, damage or short-circuit batteries.
- If batteries are damaged or leaking, avoid contact with the skin or eye. If this occurs, immediately rinse well with water and seek medical care.
- When you handle batteries, make sure that your hands, the product and the batteries are dry.
- To avoid accidental short-circuiting of batteries after removal, do not let battery terminals come into contact with metal object (e.g. coins, hairpins, rings). Do not wrap batteries in aluminium foil. Tape battery terminals or put batteries in a plastic bag before you discard them.

Electromagnetic fields (EMF)

This Philips appliance complies with all applicable standards and regulations regarding exposure to electromagnetic fields.

Recycling

This symbol means that this product shall not be disposed of with normal household waste (2012/19/EU). This symbol means that this product contains disposable batteries which shall not be disposed of with normal household waste (2006/66/EC).



Follow your country's rules for the separate collection of electrical and electronic products and batteries. Correct disposal helps prevent negative consequences for the environment and human health.

Removing disposable batteries

To remove disposable batteries, see the instructions for placing and/or removing batteries in the user manual.

Note

- Make sure the brush cushion is completely dried before re-attaching to the brush body.
- Never use corrosive liquid to clean the brush cushion as it may cause damage to the product. It is recommended to use household cleanser to clean the brush cushion if needed.
- You may hear a sizzling sound. It's common because it is caused by the ion generator.

Tips & Tricks

- 1 The ionic brush performs better when the hair is slightly wet.
- 2 If you wish to use the brush after washing your hair, dry your hair until 70% dry. Do not over dry your hair because it may affect the result.
- 3 Comb your hair slowly and repeatedly from the root until your hair is smooth. The time to comb varies according to your hair type and length.
- 4 It is not easy to observe the effect if:
 - you have short or natural curly hair.
 - your hair is easy to curl.
 - your hair condition is too dry or damaged.
 - you have straightening perm within 3 to 4 months.
 - you have some short newly grown hair.
- 5 Apply leave in hair conditioner to your hair after brushing for best result.

2 Guarantee and service

If you need information e.g. about replacement of an attachment or if you have a problem, please visit the Philips website at www.philips.com/support or contact the Philips Customer Care Centre in your country (you find its phone number in the worldwide guarantee leaflet). If there is no Consumer Care Centre in your country, go to your local Philips dealer.

The bristle has a guarantee period of 3 months. If needed, you may purchase a separate bristle from Philips service center.

繁體中文

感謝您購買本產品。歡迎來到飛利浦的世界！請至 www.philips.com/welcome 註冊您的產品，以獲得飛利浦提供的完整支援。

1 重要事項

使用產品前，請先仔細閱讀本使用手冊，並保留說明以供日後參考。

- **警告：**請勿在靠近水源的地方使用本產品。
- 請勿將髮梳浸入水中或任何液體中，亦不要放在水龍頭下沖洗。
- 使用後請關閉裝置。
- 此產品可供八歲及以上兒童，體能、感官或心智能力低下人士，或缺乏知識及經驗人士使用，前提是該等人士已就使用本產品給予監督或有關安全使用本產品的指導，並明白本產品的使用所涉及的危險。
- 請勿讓孩童將本產品當成玩具。兒童不應於沒有監督情況下對產品進行清潔及維護。
- 請務必將產品送回 Philips 認可的服務中心以進行檢查或維修。如由不合格人士進行維修，可能會對用戶造成極端危險的情況。
- 請勿使用任何其他廠商製造或非 Philips 特別建議使用的配件或零件。如使用該等配件或零件，您的保養將會失效。
- 本產品僅用於既定用途，使用時請遵循用戶手冊中的通用及電池安全說明。任何錯誤使用都可能引致電擊、灼傷、火災，以及其他可能遭受的危險或傷害。
- 請勿在人造假髮上使用本產品。
- 請勿遮蓋離子開口。
- 請勿將金屬物件插入離子開口，以確保安全。
- 請勿將此負離子髮梳與電風筒作為造型用途一同使用。
- 請勿將髮梳放置在水龍頭下清洗。

- 請勿長時間將髮梳放置在陽光下直曬。紫外線可能會導致髮梳老化，令髮梳容易破裂。
- 使用及存放本產品的合適溫度為 15°C 到 35°C 之間。
- 本產品僅使用一個 1.5V AAA 鹼性電池。
- 打開電池盒，以安裝或拆卸電池。
- 隨產品附上的電池不可充電。
- 一次性使用電池不可充電。
- 可充電電池在充電前必須從產品中取出。
- 根據電池盒或放置架上正 (+) 負 (-) 極指示的方向，將電池插入。
- 請將沒電的電池從產品中取出，並妥善丟棄電池，確保安全。
- 如果長時間不使用本產品，請將電池取出。
- 供電終端不得短路。
- 請勿燃燒產品及其電池，也不要將產品直接曝曬在陽光或暴露在過高溫度下（如在悶熱的汽車或靠近火爐的地方）。電池過熱可能會導致爆炸。
- 如本產品出現過熱或發出異味，請停止使用，並聯絡當地的 Philips 代理商。
- 請勿將產品及其電池放置在微波爐或電磁爐中。
- 為防止電池發熱或釋放有毒及有害物質，請勿拆卸、改裝、刺破、損毀，或引起電池短路。
- 如電池損毀或洩漏，請避免接觸皮膚及眼睛。如發生這種情況，請立刻用水徹底沖洗並就醫。
- 處理電池時，請確保您的手、產品以及電池乾爽。

- 為避免取出電池後引起意外短路，請勿讓電池終端接觸金屬物件（如硬幣、髮夾、戒指）。請勿使用錫紙包裹電池。棄置電池前，請用膠帶封住電池終端或將電池放置在膠袋裏。

電磁場 (EMF)

本飛利浦產品符合所有電磁場暴露的相關適用標準和法規。

回收

此符號表示本產品不得與一般家用廢棄物一併丟棄 (2012/19/EU)。此符號表示本產品所含拋棄式電池不得與一般家用廢棄物一併丟棄 (2006/66/EC)。

請遵循您所在國家/地區對電氣與電子產品及電池的分類收集規定。正確處理廢棄產品有助於避免對環境和人類健康帶來負面影響。

取出拋棄式電池

若要取出拋棄式電池，請參閱使用手冊中裝上及/或取出電池的相關指示。



備註

- 請確定髮梳軟墊已完全乾燥後，再將其重新裝回梳子本體。
- 請勿以腐蝕性液體清潔髮梳軟墊，否則可能會造成產品損壞。如有需要，建議您使用家用清潔劑清潔髮梳軟墊。
- 您可能聽見嘶嘶聲。這是負離子產生器所發出的正常聲音。

秘訣和技巧

- 1 在頭髮微濕時使用負離子梳效果更佳。
- 2 若要在洗髮後使用此梳，請將頭髮吹至七成乾。頭髮不要吹得太乾，不然可能會影響效果。
- 3 從髮根反覆慢慢梳理頭髮，直到頭髮變得柔順。梳理時間依髮質和髮長而異。
- 4 如有下列情況，效果可能不明顯：
 - 您是短髮或有自然捲。
 - 您的頭髮容易捲曲。
 - 您的頭髮太乾或為受損髮質。
 - 您最近 3 到 4 個月內剛做離子燙。
 - 您有一些剛長出來的短髮。
- 5 為達到最佳效果，梳理後可在頭髮上塗抹免沖洗護髮乳。

2 保固與服務

若您需要相關資訊 (如配件更換) 或有任何問題，請瀏覽飛利浦網站 www.philips.com/support，或聯絡您當地的飛利浦客戶服務中心 (您可以在全球保證書上找到聯絡電話)。若所在國家/地區沒有客戶服務中心，請洽詢當地的飛利浦經銷商。

刷毛保固期為 3 個月。如有需要，您可向飛利浦服務中心另行添購刷毛。



Question?
Contact
Philips

Always there to help you

Visit us at <https://www.philips.co.in/>
Contact at: 1860 180 1111, 1800 102 2929
Or customer care.india@philips.com

PHILIPS

Warranty card

Serial No.:

Dealer's Name: _____

Dealer's Stamp: _____

Customer's Name and Address: _____

Model No. _____

Bill No. _____ Amount: _____

Date of Purchase _____ Dealer Signature _____

Warranty and Service

For any information or problem, contact your local Philips dealer or authorized service center. For a list of authorized Philips service centers visit: www.philips.com or contact our consumer care at 1800 102 2929 (Toll free) or 1860 180 1111 (standard call rates apply)

All consumables and parts susceptible to normal wear and tear are not covered under warranty.

Warranty Card

This apparatus is covered under warranty against any defect due to defective material or workmanship for TWO YEARS from the date of purchase. Should a defect develop during the period of warranty, PHILIPS INDIA LTD. undertakes to repair the apparatus FREE OF CHARGE at any of the Philips authorized Service Centres.

The warranty is not valid in case:

1. Apparatus is not used according to user manual.
2. Defects caused by improper or reckless use.
3. Repairs done by persons other than Philips Authorized service centre.
4. Modifications of any nature made in the apparatus.
5. Tampered serial number.
6. Incomplete warranty card after purchase.
7. Product if used for commercial purpose (i.e. other than domestic use).
8. Usage of parts not recommended by Philips or those made by other manufacturers.

PHILIPS INDIA LIMITED,
3rd FLOOR, TOWER A, DLF IT PARK, 08 BLOCK AF,
MAJOR ARTERIAL ROAD, NEW TOWN (RAJARHAT),
KOLKATA-700156, WEST BENGAL