

**PHILIPS**

**NORELCO**

Tripleheader shaver

S6540



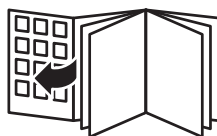

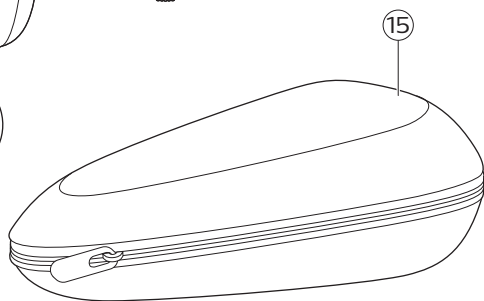
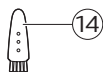
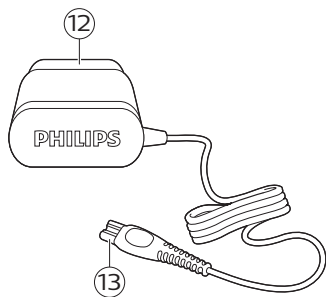
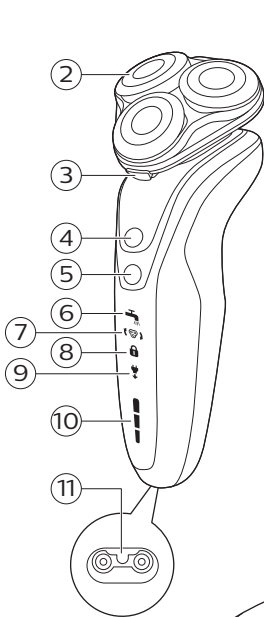
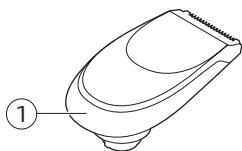



## English 6

# IMPORTANT SAFETY INSTRUCTIONS

When using an electric product, basic precautions should always be followed, including the following:

**Read all instructions before using this product.**

## DANGER

**To reduce the risk of electric shock:**

- Do not reach for a corded product that has fallen into water. Unplug immediately from the power outlet.
- Keep the power cord dry.
- Do not place or store the product where it can fall or be pulled into a tub or sink. Do not place or drop the product into water or other liquid.
- Except when charging, always unplug this product from the power outlet immediately after use.
- Remove power cord from power outlet and product before cleaning.

## WARNING

**To reduce the risk of burns, fire, electric shock, or injury to persons:**

- Close supervision is required when this product is used by, on, or near children, or persons with limited physical, sensory, or mental capabilities or invalids.
- Use this product only for its intended household use as described in this manual. Do not use attachments not recommended by Philips North America LLC.

- Never operate this product if it has a damaged power cord, if it is not working properly, after it has been dropped or damaged, or after the product or power cord has been dropped into water. For assistance call 1-800-243-3050.
- Keep the power cord away from heated surfaces.
- Never drop or insert any object into any opening.
- Do not use the power cord in or near a power outlet that contains an electric air freshener to prevent damage to the power cord.
- Do not use product outdoors or operate where aerosol (spray) products are being used or where oxygen is being administered.
- Always check cutters, cutting unit and guards before using the product. Do not use the product if cutters, cutting unit or guards are damaged, as injury may occur.
- Always attach power cord to product first, then to power outlet. To disconnect, set all controls to 'off' position. Then remove power cord from power outlet.
- Plug power cord directly into power outlet. Do not use an extension cord.
- Unplug power cord before plugging in or unplugging the product.
- Only use the power cord and other accessories supplied with the product.
- Do not attempt to open the product to remove or replace the built-in rechargeable battery.
- The batteries used in this product may present a fire or chemical burn hazard if mistreated. Do not disassemble, heat above 100 °C (212 °F) or incinerate.

**IMPORTANT:** The power plug contains a transformer. Do not cut off the power plug to replace it with another plug as this will cause a hazardous condition.

# SAVE THESE INSTRUCTIONS

## Contents

IMPORTANT SAFETY INSTRUCTIONS_____	6
General description_____	8
Introduction_____	9
The display_____	9
Charging_____	12
Using the shaver_____	13
Using click-on attachments_____	17
Travel lock_____	18
Cleaning and maintenance_____	19
Replacement_____	23
Storage_____	24
Accessories_____	24
Assistance_____	25
Disposal_____	25
Full Two-Year Warranty_____	25
45-DAY MONEY-BACK GUARANTEE_____	27

## General description

- 1 Click-on precision trimmer attachment
- 2 Shaving unit with hair chamber
- 3 Shaving head holder release button
- 4 On/off button
- 5 Turbo+ button
- 6 Cleaning reminder
- 7 Replacement reminder
- 8 Travel lock symbol
- 9 'Unplug for use' reminder



- 10 Battery charge indicator
- 11 Socket for small plug
- 12 Power plug
- 13 Cleaning brush
- 14 Travel case

## Introduction

Congratulations on your purchase and welcome to Philips Norelco!

To fully benefit from the support that Philips Norelco offers, register your product at **[www.philips.com/register](http://www.philips.com/register)**.

## The display

### Battery charge indicator

**Quick charge:** When the battery is empty and you connect the shaver to a power outlet, the lights of the battery charge indicator light up white one after the other repeatedly. When the battery contains enough energy for one shave, the bottom light of the battery charge indicator flashes white slowly.

As charging continues, each light blinks and then lights continuously indicating to what level the battery has been charged.

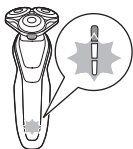

### Battery fully charged

**Note:** This shaver can only be used without cord.

## 10 English

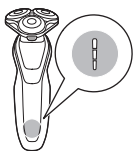

When the battery is fully charged, all lights of the battery charge indicator light up white continuously.

**Note:** When you press the on/off button during or after charging, the 'unplug for use' symbol lights up to indicate that the shaver is still connected to the power outlet.

**Note:** When the battery is full, the display switches off automatically after 30 minutes.

### Battery low



When the battery is almost empty, the bottom light of the battery charge indicator flashes orange.

### Remaining battery charge

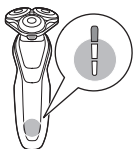

The remaining battery capacity is indicated by the lights of the battery charge indicator that light up continuously.

### 'Unplug for use' reminder



The 'unplug for use' reminder flashes to remind you to disconnect the shaver from the power outlet before you can switch it on.

## Cleaning reminder



Clean the shaver after every use for optimal performance (see 'Cleaning and maintenance'). When you switch off the shaver, the cleaning reminder flashes to remind you to clean the shaver. .

## Travel lock



When you are going to travel, you can lock the shaver to prevent it from accidentally switching on.

## Replacing shaving heads



For maximum shaving performance, replace the shaving heads every year. The shaver is equipped with a replacement reminder, which flashes to indicate you have to replace the shaving heads.

**Note:** After replacing the shaving heads, you can reset the replacement reminder by pressing the on/off button for 7 seconds. If you do not reset the replacement reminder, the shaver resets automatically after 9 shaves.

## Turbo+ setting

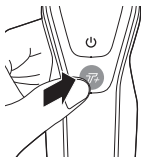

This setting allows you to shave through dense parts of the beard. The Turbo+ button lights up continuously to indicate that the setting is activated.

## Charging

- Charging or using the product at temperatures below 40 °F (4.5 °C) or higher than 95 °F (35 °C) adversely affects the lifespan of the battery.
- Do not charge the shaver in a pouch or travel case.
- The power plug transforms 100-240V AC to less than 24V DC.

Charge the shaver before you use it for the first time and when the display indicates that the battery is almost empty.

Charging takes approx. 1 hour. A fully charged shaver has a shaving time of up to 60 minutes.

**Note:** You cannot use the shaver while it is charging.

### Quick charge

After approx. 5 minutes of charging, the battery contains enough energy for one shave. The bottom light of the battery charge indicator flashes white slowly when the quick charge is finished.

### Charging with the power cord



- 1 Make sure that the shaver is switched off.
- 2 Put the small plug in the shaver and connect the power plug to any 100V to 240V AC outlet. Use only the power cord provided.

The display of the shaver indicates that the shaver is charging.

- 3 After charging, remove the power plug from the wall outlet and pull the small plug out of the shaver.

Note: An adapter plug may be necessary for cord usage in some foreign countries. Use an attachment plug adapter of the proper configuration for the power outlet.

## Using the shaver

**Always check the shaver and all accessories before use. Do not use the shaver or any accessory if it is damaged, as this may cause injury. Always replace a damaged part with one of the original type.**



This symbol indicates that the shaver can be used in the bath or shower.

- Use this shaver for its intended household use as described in this manual.
- For hygienic reasons, the shaver should only be used by one person.

Note: This shaver is waterproof. It is suitable for use in the bath or shower and for cleaning under the tap. For safety reasons, the shaver can only be used without cord.

## 21-Day adaptation process

- 21 Day Trial and Conversion Process. It is a fact that your skin and beard need time to adjust to a new grooming system.

- Use your new shaver exclusively for 3 weeks to fully enjoy the closeness of a Philips Norelco shave.
- At first you may not get as close a shave as you expect, or your face may even become slightly irritated. This is normal since your beard and skin will need time to adjust. Invest 3 weeks and you'll soon experience the full joy of your new shaver.
- Stick with it! If you alternate shaving methods during the adjustment period, it may make it more difficult to adapt to the Philips Norelco shaving system.
- If you are still not convinced after 21 days, Philips Norelco will refund you the full purchase price as long as the request is received within 45 days of purchase.

### Switching the shaver on and off

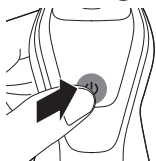

- 1 To switch the shaver on or off, press the on/off button once.

The display lights up for a few seconds to show the remaining battery charge.

### Shaving

- For the best results on skin comfort, pre-trim your beard if you have not shaved for 3 days or longer.

#### Dry shaving

- 1 Switch on the shaver.



- 2 Move the shaving heads over your skin in circular movements to catch all hairs growing in different directions. Make sure each shaving head is fully in contact with the skin. Exert gentle pressure for a close, comfortable shave.

Note: Do not press too hard, as this can cause skin irritation.

- 3 Switch off and clean the shaver after each use.

The display lights up for a few seconds to show the battery charge.

### **Wet shaving**

For a more refreshing shave, you can also use this shaver on a wet face with shaving foam or shaving gel.



- 1 Apply some water to your skin.



- 2 Apply shaving foam or shaving gel to your skin.

## 16 English



- 3 Rinse the shaving unit under the tap to ensure that the shaving unit glides smoothly over your skin.
- 4 Switch on the shaver.



- 5 Move the shaving heads over your skin in circular movements to catch all hairs growing in different directions. Make sure each shaving head is fully in contact with the skin. Exert gentle pressure for a close, comfortable shave.

**Note:** Do not press too hard, this can cause skin irritation.

**Note:** Rinse the shaving unit regularly to ensure that it continues to glide smoothly over your skin.

- 6 Dry your face.
- 7 Switch off the shaver and clean it after each use.

**Note:** Make sure that you rinse all foam or shaving gel off the shaver.

### Turbo+ setting

- 1 Switch on the shaver.
- 2 Press the Turbo+ button once if you want to shave areas with dense hair.

**Note:** The Turbo+ button lights up continuously to indicate that the setting is activated.

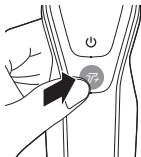



- 3 Stretch your skin with your free hand so blades can lift and cut hairs. Gently press shaver to skin so the floating heads can follow the contours of your face.

Do not press too hard as too much pressure can cause shaving heads to pinch the skin.

- 4 Switch off the Turbo+ setting by pressing the Turbo+ button once.

## Using click-on attachments

### Removing or attaching the click-on attachment

- 1 Make sure the shaver is switched off.
- 2 Pull the attachment straight off the shaver.



Note: Do not twist the attachment while you pull it off the shaver.

- 3 Insert the lug of the attachment into the slot in the top of the shaver. Then press down the attachment to attach it to the shaver ('click').



### Using the precision trimmer attachment

You can use the precision trimmer to touch up your beard, sideburns and moustache.

- 1 Attach the trimmer to the shaver ('click').
- 2 Switch on the shaver.





- 3 Hold the trimmer perpendicular to the skin and move it downwards while exerting gentle pressure.
- 4 Switch off and clean the trimmer after use.

Note: Trimming is easier when the skin and hair are dry.

## Travel lock

You can lock the shaver when you are going to travel to prevent it from switching on accidentally.

### Activating the travel lock

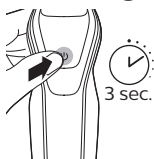

- 1 Press the on/off button for 3 seconds to use the travel lock mode.



While you activate the travel lock, the indicator on the display lights up briefly. When the travel lock is activated, the travel lock symbol flashes.

### Deactivating the travel lock

- 1 Press the on/off button for 3 seconds. While you deactivate the travel lock, the indicator on the display lights up briefly. When the travel lock is deactivated, the travel lock symbol flashes and goes out. The shaver switches on and is now ready for use again.



Note: The shaver unlocks automatically when it is connected to a power outlet.

## Cleaning and maintenance

**Regular cleaning guarantees better shaving results.**

**Never clean, remove or replace the shaving unit while the shaver is switched on.**

**Do not touch shaving heads with hard objects as this may dent or damage the precision-made slotted combs.**

**Do not use abrasives, scourers or aggressive liquids such as gasoline or acetone to clean the shaver.**

### Cleaning the shaver under the tap

Clean the shaver after every use for optimal performance (see 'Cleaning and maintenance').

**Be careful with hot water. Always check if the water is not too hot, to prevent burning your hands.**

**Never dry the shaving unit with a towel or tissue, as this may damage the shaving heads.**

**While rinsing the shaving unit, water may drip out of the base of the shaver. This is a normal occurrence.**

- 1 Switch on the appliance.



- 2** Rinse the shaving unit under a warm tap.



- 3** Switch off the appliance. Press the release button to open the shaving unit.



- 4** Rinse the hair chamber under the tap.

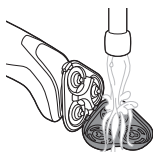

- 5** Rinse the shaving head holder under a warm tap.
- 6** Carefully shake off excess water and let the shaving head holder air-dry completely.



- 7** Close the shaving head holder ('click').

## Thorough cleaning

We advise you to clean the shaving heads thoroughly once a month or when the shaver does not shave as well as it used to.

- 1 Switch off the shaver.
- 2 Pull the shaving head holder off the bottom part of the shaving unit.
- 3 Rinse the hair chamber and shaving head holder under the tap.

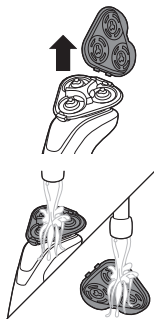

- 4 Turn the retaining ring counterclockwise and lift it off the shaving head.

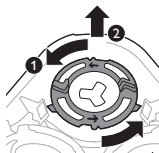

Repeat this process for the other retaining rings. Place them aside in a safe place.

- 5 Remove the shaving heads from the shaving head holder. Each shaving head consists of a cutter and guard.

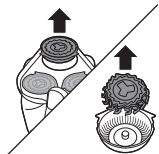

**Note:** Do not clean more than one cutter and guard at a time, since they are all matching sets. If you accidentally put a cutter in the wrong shaving guard, it may take several weeks before optimal shaving performance is restored.

## 22 English

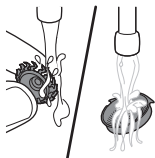

- 6 Clean the cutter and guard under the tap.
- 7 Shake off excess water.
- 8 Put the cutter back into the guard.

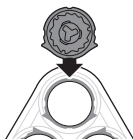

- 9 Place the shaving heads in the shaving head holder.



- 10 Place the retaining ring on the shaving head.

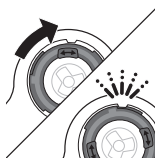

- 11 Turn the ring clockwise until it clicks to indicate that the ring is fixed.
- 12 Attach the shaving head holder to the bottom part of the shaving unit ('click').

## Cleaning the precision trimmer attachment

**Never dry the trimmer with a towel or tissue, as this may damage the trimming teeth.**

Clean the trimmer after each use.

- 1 Switch on the shaver.

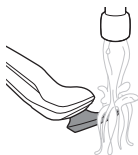

- 2 Rinse the trimmer under a warm tap.
- 3 After cleaning, switch off the shaver.
- 4 Carefully shake off excess water and let the trimmer air dry completely.
- 5 For optimal performance, lubricate the teeth of the trimmer with a drop of mineral oil every six months.

## Replacement

### Replacing the shaving heads

For maximum shaving performance, replace the shaving heads once a year. Replace damaged shaving heads immediately.

Always replace the shaving heads with original Philips Norelco shaving heads (see 'Accessories').



### Replacement reminder

The replacement reminder indicates that the shaving heads need to be replaced. The replacement reminder lights up when you switch off the shaver.

- 1 To replace the shaving heads, remove the shaving heads from the shaving head holder one by one. See 'Thorough cleaning' for the instructions on how to remove the retaining rings and shaving heads.
- 2 To reset the replacement reminder, press and hold the on/off button for approx. 7 seconds.



This product has no other user-serviceable parts. For assistance call 1-800-243-3050.

## Storage



Store the shaver in the travel case.

**Note:** Always let the shaver dry completely before you store it in the travel case.

- Be sure the product is switched off. Remove the power cord from power outlet and the product before storing it in a safe, dry location where it will not be crushed, banged, or subject to damage.
- Do not wrap cord around the product when storing.
- Store cord and other accessories in a safe location where these will not be cut or damaged.
- Do not place or store the product where it can fall or be pulled into a tub or sink, water or other liquid while plugged in.

## Accessories



Replacement parts and accessories may be purchased at a store near you or on our website **[www.philips.com/store](http://www.philips.com/store)**.

The following accessories are available:

- SH50 Philips Norelco shaving heads
- RQ111 Philips Norelco SmartClick beard styler



## Assistance

For assistance, visit our website:

**[www.philips.com/support](http://www.philips.com/support)** or call toll free  
1-800-243-3050.

Online information is available 24 hours a day,  
7 days a week.

## Disposal



- This product contains a rechargeable lithium-ion battery which must be disposed of properly.
- Contact your local town or city officials for battery disposal information. You can also call 1-800-822-8837 or visit **[www.call2recycle.org](http://www.call2recycle.org)** for battery drop-off locations.
- For assistance, visit our website **[www.philips.com/support](http://www.philips.com/support)** or call 1-800-243-3050 toll free.
- Your product is designed and manufactured with high quality materials and components, which can be recycled and reused. For recycling information, please contact your local waste management facilities or visit **[www.recycle.philips.com](http://www.recycle.philips.com)**.

## Full Two-Year Warranty

Philips North America LLC warrants this new product (except cutters and combs) against defects in materials or workmanship for a period of two years from the date of purchase,

and agrees to repair or replace any defective product without charge.

**IMPORTANT:** This warranty does not cover damage resulting from accident, misuse or abuse, lack of reasonable care, the affixing of any attachment not provided with the product or loss of parts or subjecting the product to any but the specified voltage or batteries.\*

**NO RESPONSIBILITY IS ASSUMED FOR ANY SPECIAL, INCIDENTAL OR CONSEQUENTIAL DAMAGES.**

In order to obtain warranty service, simply go to **www.philips.com/support** for assistance. It is suggested that for your protection you return shipments of product by insured mail, insurance prepaid. Damage occurring during shipment is not covered by this warranty.

NOTE: No other warranty, written or oral, is authorized by Philips Personal Health, a division of Philips North America LLC.

This warranty gives you specific legal rights, and you may also have other rights which vary from state to state. Some states do not allow the exclusion or limitation of incidental or consequential damages, so the above exclusion and limitations may not apply to you.

\*Read enclosed instructions carefully.

## 45-DAY MONEY-BACK GUARANTEE

To enjoy the closest and most comfortable shave from your new Philips Norelco Men's Shaver, the shaver should be used exclusively for 3 weeks. This allows your hair and skin enough time to adapt to the Philips Norelco Shaving System. If, after that period of time, you are not fully satisfied with your Philips Norelco Men's Shaver, send the product back along with dated sales receipt and we'll refund you the full purchase price.

**The product must be shipped prepaid by insured mail, insurance prepaid, have the original sales receipt, indicating purchase price and date of purchase, and the money-back guarantee return authorization form enclosed.**

**We cannot be responsible for lost mail.**

The product must be postmarked no later than 45 days after the date of purchase. Philips reserves the right to verify the purchase price of the product and limit refunds not to exceed suggested retail price.

**To obtain money-back guarantee service, please go to [www.PhilipsMoneyBack.com](http://www.PhilipsMoneyBack.com).**

**Delivery of refund check will occur 6–8 weeks after receipt of returned product.**

— |

| —

— |

| —

— |

| —

— |

| —

— |

| —

— |

| —



Manufactured for:  
Philips Personal Health  
a division of Philips North America LLC  
P.O. Box 10313, Stamford, CT 06904

---



This symbol on the product's nameplate means it is listed  
by Underwriters' Laboratories, Inc.

---

Norelco and Tripleheader are registered trademarks of Philips  
North America LLC.

PHILIPS and Philips shield are registered trademarks of  
Koninklijke Philips N.V.

©2020 Philips North America LLC. All rights reserved.

3000.053.1653.1 (5/13/2020)



>75 % recycled paper  
>75 % papier recyclé