

PHILIPS

DiamondClean
Smart



PHILIPS
sonicare



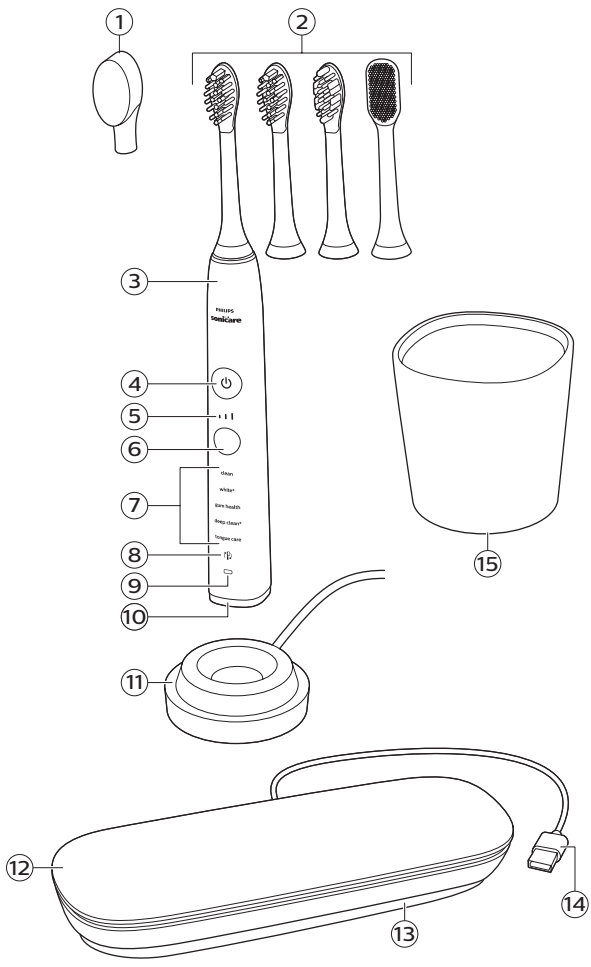



English 6

IMPORTANT SAFEGUARDS

Warning: READ ALL INSTRUCTIONS BEFORE USE

When using electrical products, especially when children are present, basic safety precautions should always be followed, including the following:

DANGERS

To reduce the risk of electrocution:

- 1 Always place and store the charger at a safe distance from water.
- 2 Do not reach for a product that has fallen into water. Unplug immediately.
- 3 Never use a charger with a damaged cord or plug.

WARNINGS

To reduce the risk of burns, electrocution, fire or physical injury:

- 1 Do not use attachments other than those recommended by the manufacturer.
- 2 Do not plug into an outlet with a voltage other than specified on the bottom of the product. This product is designed to operate within a range of 100 to 240 volts. Voltage converters do not warrant voltage compatibility.
- 3 Never force the plug into an outlet; if the plug does not easily fit into the outlet, discontinue use.
- 4 Discontinue use if the product appears damaged in any way (brush head, handle or charger, etc.).

- 5 The mains cord cannot be replaced. If the mains cord is damaged, discard the charger.
- 6 Keep the cord away from heated surfaces.
- 7 Do not use the base charger outdoors or near heated surfaces.
- 8 This product contains no user-serviceable parts. Refer to 'Warranty and support' if the product no longer works properly or needs repair.
- 9 Use this product only for its intended use as described in this document or as recommended by your dental professional.
- 10 This product is not intended for use by persons (including children) with reduced physical, sensory, or mental capabilities, or lack of experience and knowledge, unless they have been given supervision or instruction concerning use of the appliance by a person responsible for their safety.
- 11 Children should be supervised to ensure that they do not play with the product.
- 12 Philips Sonicare is a personal care device and is not intended for use on multiple patients in a dental office or institution.
- 13 Use UL Listed computer, USB Hub or USB duplex receptacle when charging the toothbrush handle in the travel case.
- 14 When using a computer to recharge the toothbrush handle, the computer should be located away from sources of water (i.e. sink or tub) so as to avoid electrical shock.
- 15 In order to effectively charge your Philips Sonicare do not place your charger base on a magnetic metal surface.

- 16 The product is not intended to be repaired by service personnel in case of failure or component defect (unit can be thrown away).
- 17 For connection to a supply not in the U.S.A., use a charger of the proper configuration for the power outlet.
- 18 Use this product only for its intended use as described in this manual. Do not use attachments not recommended by the manufacturer.

MEDICAL WARNINGS

- 1 Consult your dental professional before you use this product if you have had oral or gum surgery in the previous 2 months.
- 2 Contact your dental professional if excessive bleeding occurs after using this product or bleeding continues to occur after 1 week of use.
- 3 Discontinue use of this product and contact a physician/dentist if discomfort or pain is experienced.
- 4 This product complies with the safety standards for electromagnetic devices. If you have a pacemaker or other implanted device, contact your physician or the device manufacturer prior to use.
- 5 Consult your physician if you have other medical concerns.

Electromagnetic fields (EMF)

This Philips device complies with all applicable standards and regulations regarding exposure to electromagnetic fields.

SAVE THESE INSTRUCTIONS

Radio Equipment Directive

- Radio Equipment in this product operates between 2402 – 2480 MHz
- Maximum RF power transmitted by the Radio Equipment is +3 dBm

Introduction

Congratulations on your purchase and welcome to Philips! To fully benefit from the support that Philips offers, register your product at **www.philips.com/welcome** or via the Philips Sonicare app.

Your Philips Sonicare (Fig. 1)

- 1 Hygienic travel cap
- 2 Brush heads
- 3 Handle
- 4 Power on/off button
- 5 Intensity light
- 6 Mode/intensity button
- 7 Mode light
- 8 Brush head replacement reminder light
- 9 Battery indication
- 10 Light ring
- 11 Charging base
- 12 Travel case
- 13 Cord storage compartment
- 14 USB cord (integrated)
- 15 Charging glass

Note: The content of the box may vary based on the model purchased.

Brush heads



Your Philips Sonicare comes with a range of brush heads which are designed to deliver superior results for your oral care needs.

The number and type of brush heads might change according to the toothbrush type you purchased.

- 1 Premium Plaque Control brush head
- 2 Premium Gum Care brush head
- 3 Premium White brush head
- 4 Tongue Care+ brush head (specific types only)

Smart brush head recognition

Premium Plaque Control, Premium Gum Care, Premium White and Tongue Care+ brush heads are enabled with smart brush head recognition technology.

A micro-chip inside the brush head communicates with the toothbrush handle. So when you attach a brush head, the handle automatically recognizes the brush head and selects the recommended mode and intensity level to optimize your brushing performance.

Thanks to this feature the toothbrush also tracks your usage and gives a personalized reminder when you need to replace your brush head for the best oral care results.

Brushing modes

Your power toothbrush is equipped with 5 different modes to accommodate all your oral care needs (some models come with 4 brushing modes only). The following modes are available:

Clean mode

Clean is a 2-minute mode, recommended to be used with intensity level 3. It gives you a thorough and complete clean and is recommended to be used with the Premium Plaque Control brush head. In order to reach optimal results, follow the instructions below.



- 1 Begin brushing the upper right teeth (segment 1) and brush for 20 seconds, on both the outer and inner surfaces, before you move to the upper front teeth (segment 2). Continue doing this for segments 3 to 6 to ensure even brushing in all 6 segments of the mouth. You will hear a beep after each 20-second interval, to indicate that you should move to the next segment.

White+ mode

White+ is a 2-minute 40-seconds mode, recommended to be used with intensity level 3 and the Premium White brush head. In order to reach optimal results, follow the instructions below.



- 1 Begin brushing the upper right teeth (segment 1) and brush for 20 seconds before you move to the upper front teeth (segment 2). Continue doing this for segments 3 to 6 to ensure even brushing in all 6 sections of the mouth.
- 2 After completing all 6 of these segments, the toothbrush switches to polishing mode automatically.

12 English

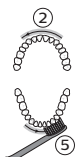

- 3 To polish your teeth, brush the outer surface of your upper teeth for 20 seconds (segment 2) and then brush the outer surface of your lower teeth for 20 seconds (segment 5). The polishing motion used in this part of the mode will feel and sound different from the first two minutes of the mode.

Gum Health mode

Gum Health is a 3-minute 20-seconds mode, recommended to be used with intensity level 3 and the Premium Gum Care brush head. In order to reach optimal results, follow the instructions below:



- 1 Begin brushing the upper right teeth (segment 1) and brush for 20 seconds, on both the outer and inner surfaces, before you move to the upper front teeth (segment 2). Continue doing this for section 3 to 6 to ensure even brushing in all 6 segments of the mouth.
- 2 Next, to take optimal care for your gums, brush the outer and inner surfaces of your upper right back teeth for 20 seconds (segment 1), then brush the outer and inner surfaces of your upper left back teeth for 20 seconds (segment 3).



Continue brushing the outer and inner surfaces of your lower right back teeth for 20 seconds (segment 4), followed by another 20 seconds on the outer and inner surfaces of your lower left back teeth (segment 6). The brushing motion used in this part of the mode will feel and sound different from the first two minutes of the mode.

DeepClean+ mode

DeepClean+ mode length depends on whether or not the handle is connected to the app. In connected mode DeepClean+ runs for two minutes and provides BrushPacer feedback every 20 seconds. In non-connected mode DeepClean+ runs for three minutes and provides BrushPacer feedback every 30 seconds. In order to reach optimal results, follow the instructions below when brushing non-connected.



- Begin brushing in the upper right teeth (segment 1) and brush for 30 seconds, on both the outer and inner surfaces, before you move to the upper front teeth (segment 2). Continue doing this for segments 3 to 6 to ensure even brushing in all 6 segments of the mouth.

Tongue Care mode (specific types only)

Tongue Care is a 20-second mode, recommended to be used with intensity level 1 and the Tongue Care+ brush head. In order to reach optimal results, follow the instructions below:

14 English

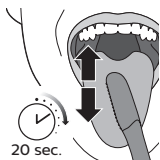

- 1 Wet the micro bristles and brush your tongue with a back and forth motion. Clean as far back as comfortable.
- 2 Rinse your mouth and repeat the procedure two more times.

Based on the brush head you attach, the mode will be selected automatically. If you want to adjust the mode or intensity manually, you can do this by using the mode/intensity button. Press the mode/intensity button before brushing to change the mode, and press it while brushing to adjust the intensity level. Your selection will be remembered next time you attached the same brush head. If you want to go back to the initial recommended settings for your brush head, manually change it to the recommended setting described above.

Note: When the Philips Sonicare is used in clinical studies, it must be used at high intensity in the Clean mode, in White+ mode, in GumHealth mode, or in unconnected DeepClean+ mode to achieve the efficacy in plaque removal, stain removal, gum health or superiority (respectively).

Intensity settings

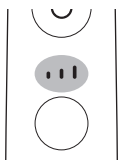

Your power toothbrush gives you the option to choose between 3 different intensity levels: low, medium and high. Based on the brush head you attach, the intensity will be selected automatically. If you wish to change to a different intensity, you can do so by pressing the mode/intensity button while brushing. For optimal results it is recommended to use the automatically selected intensity. The intensity cannot be changed as long as the handle is powered off or paused.

Using your Philips Sonicare

Brushing instructions



- 1 Attach your desired brush head (see 'Brush heads'). Align the brush head so the bristles point in the same direction as the front of the handle.

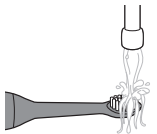

- 2 Wet the bristles.



- 3 Apply a small amount of toothpaste on the bristles.

16 English

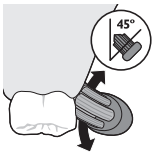

- 4 Place the toothbrush bristles against the teeth at a slight angle (45 degrees), pressing firmly to make the bristles reach the gumline or slightly beneath the gumline. A change in vibration (and a slight change in sound) and activation of the light ring alert you when you apply too much pressure while brushing.

Note: Keep the center of the brush in contact with the teeth at all times.

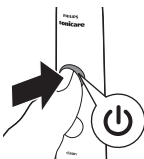

- 5 Press the power on/off button to switch on the Philips Sonicare.

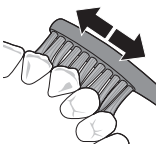

- 6 Apply light pressure to maximize Philips Sonicare's effectiveness. Brush your teeth with a small back and forth motion so the bristles reach between the teeth. Continue this motion throughout the brushing cycle.

Note: The bristles should flare slightly. Do not scrub.



- 7 To clean the inside surfaces of the front teeth, tilt the brush handle semi-upright and make several vertical overlapping brushing strokes on each tooth.

Your Philips Sonicare is safe to use on:

- Braces (brush heads wear out sooner when used on braces).
- Dental restorations (fillings, crowns, veneers).

Features and accessories

- a App
- b Pressure sensor
- c Brush head replacement reminder
- d BrushPacer
- e Easy-start
- f Travel case (specific types only)
- g Brush head holder (specific types only)

a. App

Your Philips Sonicare is Bluetooth enabled and allows you to achieve superior oral health care with the Philips Sonicare app.

Using the Philips Sonicare app will help you to improve your oral health care habits. It gives you real-time feedback while brushing, informs you if you missed any spots when brushing, tracks your brushing behavior over time and provides useful tips and tricks for your healthiest mouth ever. In order to fully benefit from your Philips Sonicare, we advise you to follow these steps:

Connecting your toothbrush

- 1 Download the Philips Sonicare app from the Apple App Store or Google Play Store.
- 2 Confirm Bluetooth is switched on on your mobile device before you open the app. Check the settings on your mobile device to switch on Bluetooth.
- 3 Open the Sonicare app.
- 4 To connect the toothbrush to the app, remove the handle from the charger and press the mode/intensity button.

- 5 Follow the Sonicare app instructions displayed on your mobile device. The app automatically connects with the toothbrush. If the toothbrush does not connect, follow the troubleshooting steps provided in the app.

Note: For optimal data capture, keep your mobile device close during brushing.

b. Pressure sensor

Your Philips Sonicare is equipped with an advanced sensor that measures the pressure you apply while brushing. If you apply too much pressure, the toothbrush will provide immediate feedback to indicate that you need to reduce the pressure. The feedback is given in two different ways:

- 1 You experience a change in vibration and therefore brushing sensation.
- 2 The pressure warning light of the light ring will light up purple.

If you receive a warning, reduce the pressure. The light will turn off and the brushing sensation will adjust to the original sensation.

Activating or deactivating the pressure sensor

- 1 Place the handle, with a brush head attached, in the plugged-in charger.
- 2 Pressure sensor is enabled by holding the mode/intensity button and by pressing the power button twice while on a charger. The handle will beep twice to confirm it is enabled.
- 3 Pressure sensor is disabled by holding the mode/intensity button and by pressing the power button twice while on a charger. The handle will beep once to confirm it is disabled.

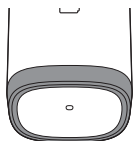

c. Brush head replacement reminder

tongue care



Your Philips Sonicare is equipped with a smart feature that tracks the wear of your brush head. Depending on the pressure you apply and the amount of time used, the brush head replacement reminder light reminds you to change your brush head. It is important to change your brush head in time in order to guarantee the best cleaning & care of your teeth.

When the amber brush head replacement light starts blinking, you should replace your brush head.

Activating or deactivating the brush head replacement reminder

- 1 Place the handle in the plugged-in charger.
- 2 Brush head replacement reminder is enabled by holding the mode/intensity button and by pressing the power button three times while on the charger. The handle will beep twice to confirm it is enabled.
- 3 Brush head replacement reminder is disabled by holding the mode/intensity button and by pressing the power button three times while on the charger. The handle will beep once to confirm it is disabled.

d. Brushpacer



The brushpacer is an interval timer that has a short beep and pause to remind you to brush the different sections of your mouth. Depending on the brushing mode you have selected (see 'Brushing modes'), the brushpacer beeps at different intervals during the brushing cycle.

e. Easy-start

The Easy-start feature gently increases the power over the first 14 brushings to help you get used to the brushing with the Philips Sonicare. The Easy-start feature works in all modes other than TongueCare+ mode. This Philips Sonicare model comes with the Easy-start feature deactivated.

Activating or deactivating the Easy-start feature

- 1 Place the handle in the plugged-in charger.
- 2 Easy-start is enabled by holding the mode/intensity button and by pressing the power button once while on the charger. The handle will beep twice to confirm it is enabled.
- 3 Easy start is disabled by holding the mode/intensity button and by pressing the power button once while on the charger. The handle will beep once to confirm it is disabled.

Note: Using the Easy-start feature beyond the initial ramp-up period is not recommended and reduces Philips Sonicare effectiveness in removing plaque.

Note: Each of the first 14 brushings must be at least 1 minute in length to properly move through the Easy-start ramp-up cycle.

Note: To achieve clinical efficacy, Easy-start needs to be deactivated.

f. Travel case (specific types only)

Your Philips Sonicare comes with a travel case to make traveling with your power toothbrush more convenient. It is designed to accommodate the power toothbrush handle and two brush heads. Some models come with a USB charging travel case which connects to your laptop via USB -this allows you to charge your Philips Sonicare when traveling. For information about charging your Philips Sonicare with the travel case, see 'Battery status and charging'.

Battery status and charging

Charging with glass (specific types only)

- 1 Plug the charging base into a wall socket.
- 2 Place the charging glass on top of the charging base and place the handle in the glass.

The charging indicator flashes white until your toothbrush is fully charged.

Charging with travel case (specific types only)

- 1 Place the handle in the charging travel case.
- 2 Connect the charging travel case to a UL 60950-1 and IEC 60950-1 Listed computer, laptop, USB hub, USB receptacle, or wall adapter. The USB cord is attached to the travel case and stored in the cord storage compartment.
- 3 The wall adapter shall have an output marked Class 2 or the limited power source (LPS) requirements and compatible with the electrical ratings marked on the travel case.
- 4 The battery indication flashes white until your toothbrush is fully charged.

Important: The wall adapter must be a safe extra low voltage source, compatible with the electrical ratings marked on the device.

Important: Only toothbrush models HX993W, HX993B, HX993P, HX993S, HX993L can be charged in the travel case. Other products and batteries are not compatible with the travel case.

Note: It takes at least 24 hours to fully charge your Philips Sonicare. You do not have to fully charge your handle before first use, as the handle is pre-charged for first use. However, it is recommended to fully charge it after first use.

Note: This charger is designed to properly charge only one handle at a time. This charger is not compatible with other models of Philips Sonicare.

Note: Do not place metallic objects in the travel case, as handle charging may be affected and may cause the charger to overheat.

Cleaning

Note: Do not clean the brush head, handle or travel case in the dishwasher.

Toothbrush handle

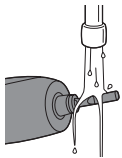

- 1 Remove the brush head and rinse the metal shaft area with warm water. Make sure you remove any residual toothpaste.

Caution: Do not push on the rubber seal on the metal shaft with sharp objects, as this may cause damage.

- 2 Wipe the entire surface of the handle with a damp cloth.

Note: Do not use isopropyl rubbing alcohol, vinegar or bleach to clean handle as this may cause discoloration.

Brush head

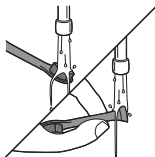

- 1 Rinse the brush head and bristles after each use.
- 2 Remove the brush head from the handle and rinse the brush head connection with warm water at least once a week.

Charger and travel case

- 1 Unplug the charger and travel case before you clean it.
- 2 Use a damp cloth to wipe the surface of the charger and travel case.

Glass

- 1 Clean the glass with water and some mild soap.
- 2 Dry the glass with a soft towel.

The glass is dishwasher-safe.

Storage

If you are not going to use your Philips Sonicare for an extended period of time, unplug the charger from the wall socket, clean it and store it in a cool and dry place away from direct sunlight.

Locating the model number

Look on the bottom of the Philips Sonicare toothbrush handle for the model number (HX992W, HX992B, HX992P, HX992S, HX992L, HX993W, HX993B, HX993P, HX993S, HX993L)

Disposal



This appliance contains a rechargeable battery which must be disposed of properly. Contact your local town or city officials for battery disposal information. You can also call 1-800-8-BATTERY or visit www.rbr.c.com for battery drop-off locations.

For assistance, visit our website www.philips.com/support or call 1-800-243-3050 toll free.

Removing the rechargeable battery

Warning: Only remove the rechargeable battery when you discard the appliance. Make sure the battery is completely empty when you remove it.

To remove the rechargeable battery, you need a towel or cloth, a hammer and a flat-head (standard) screwdriver. Observe basic safety precautions when you follow the procedure outlined below. Be sure to protect your eyes, hands, fingers, and the surface on which you work.

- 1 To deplete the rechargeable battery of any charge, remove the handle from the charger, turn on the Philips Sonicare and let it run until it stops. Repeat this step until you can no longer turn on the Philips Sonicare.



- 2 Remove and discard the brush head. Cover the entire handle with a towel or cloth.

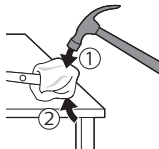

- 3 Hold the top of the handle with one hand and strike the handle housing 0.5 inch above the bottom end. Strike firmly with a hammer on all 4 sides to eject the end cap.

Note: You may have to hit on the end several times to break the internal snap connections.

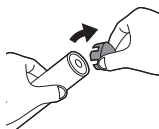

- 4 Remove the end cap from the toothbrush handle. If the end cap does not release easily from the housing, repeat step 3 until the end cap is released.

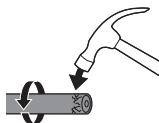

- 5 Holding the handle upside down, press the shaft down on a hard surface. If the internal components do not easily release from the housing, repeat step 3 until the internal components are released.

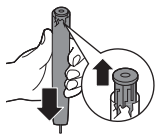

- 6 Remove the rubber battery cover.

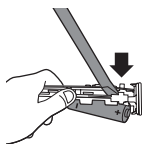

- 7 Wedge the screwdriver between the battery and the black frame at the bottom of the internal components. Then pry the screwdriver away from the battery to break the bottom of the black frame.

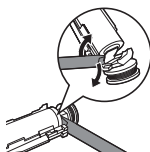

- 8 Insert the screwdriver between the bottom of the battery and the black frame to break the metal tab connecting the battery to the green printed circuit board. This will release the bottom end of the battery from the frame.

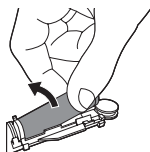

- 9 Grab the battery and pull it away from the internal components to break the second metal battery tab.

Caution: Be aware of the sharp edges of the battery tabs so as to avoid injury to your fingers.

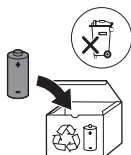

- 10 Cover the battery contacts with tape to prevent any electrical short from residual battery charge. The rechargeable battery can now be recycled and the rest of the product discarded appropriately.

FCC Compliance Statement

This device complies with Part 15 of the FCC Rules. Operation is subject to the following two conditions:

- 1 This device may not cause harmful interference, and
- 2 This device must accept any interference received, including interference that may cause undesired operation.

Changes or modifications not expressly approved by Philips Oral Healthcare could void the user's authority to operate the equipment.

Warranty and support

Philips warrants its products for two years after the date of purchase. Defects due to faulty materials and workmanship will be repaired or replaced at Philips' expense provided that convincing proof of purchase in the qualifying period is provided. Philips recommends use of genuine Sonicare brush heads for optimal performance. Use of other brush heads may damage your Sonicare toothbrush and limit your warranty protection. Contact our Consumer Care Center at 1-800-682-7664 (North America), outside North America contact your local Philips Consumer Care Center. Internet information: **www.sonicare.com** (North America) or **www.philips.com/support** (outside North America).

WARRANTY EXCLUSIONS

What is not covered under warranty:

- Brush heads.
- Damage caused by use of unauthorized replacement parts or unauthorized brush heads.
- Damage caused by misuse, abuse, neglect, alterations or unauthorized repair.
- Normal wear and tear, including chips, scratches, abrasions, discoloration or fading.

IMPLIED WARRANTIES

ANY IMPLIED WARRANTIES, INCLUDING IMPLIED WARRANTIES OF MERCHANTABILITY AND FITNESS FOR A PARTICULAR PURPOSE, SHALL BE LIMITED TO THE DURATION OF THE EXPRESS WARRANTIES SET FORTH ABOVE. IN SOME STATES LIMITATIONS ON DURATION OF IMPLIED WARRANTIES DO NOT APPLY.

LIMITATION OF REMEDIES

IN NO EVENT SHALL PHILIPS OR ANY OF ITS AFFILIATED OR SUBSIDIARY COMPANIES BE LIABLE FOR ANY SPECIAL, INCIDENTAL OR CONSEQUENTIAL DAMAGES BASED UPON BREACH OF WARRANTY, BREACH OF CONTRACT, NEGLIGENCE, TORT, OR ANY OTHER LEGAL THEORY. SUCH DAMAGES INCLUDE, WITHOUT LIMITATION, LOSS OF SAVINGS OR REVENUE; LOSS OF PROFIT; LOSS OF USE; THE CLAIMS OF THIRD PARTIES INCLUDING, WITHOUT LIMITATION, DENTISTS AND DENTAL HYGIENISTS; AND COST OF ANY SUBSTITUTE EQUIPMENT OR SERVICES. SOME STATES DO NOT ALLOW THE EXCLUSION OR LIMITATION OF INCIDENTAL OR CONSEQUENTIAL DAMAGES.





www.philips.com/Sonicare

©2017 Koninklijke Philips N.V. (KPNV). All rights reserved.
Philips and the Philips shield are trademarks of KPNV.
Sonicare and the Sonicare logo are trademarks
of Philips Oral Healthcare, LLC and/or KPNV.

©2017 Koninklijke Philips N.V. (KPNV). Tous droits réservés.
Philips et le blason Philips sont des marques de commerce de KPNV.
Sonicare et le logo Sonicare sont des marques de commerce
de Philips Oral Healthcare, LLC et (ou) KPNV.



>75% recycled paper
>75% papier recyclé

4235.021.1899.2