

PHILIPS

Quick Start Card

HF3505

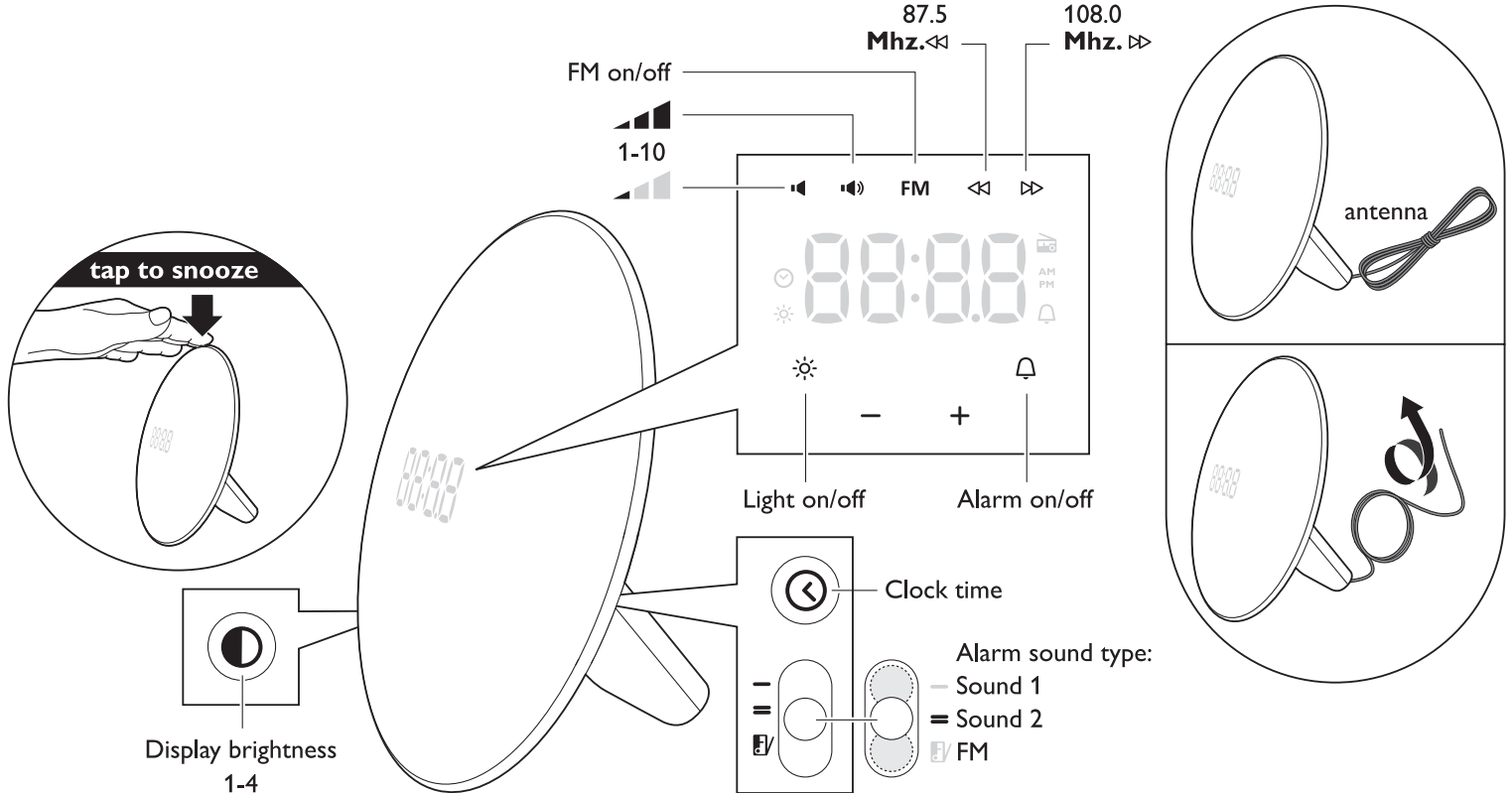

English	Dansk	Deutsch	Español	Suomi
Tap to snooze	Tryk for snooze	Kurz Drücken für Schlummerfunktion	Toque para retrasar la alarma	Torkkutila napauttamalla
Light on/off	Lys til/fra	Licht ein-/ausschalten	Encendido/apagado de la luz	Merkkivalo päällä/pois
Alarm on/off	Alarm til/fra	Wecker ein-/ausschalten	Encendido/apagado de la alarma	Hälytys on/ei
Antenna	Antenne	Antenne	Antena	Antenni
Display brightness	Skærmysstyrke	Anzeigehelligkeit	Brillo de la pantalla	Näytön kirkkaus
Clock time	Klokkeslæt	Uhrzeit	Hora del reloj	Kellonaika
Alarm sound type	Alarmlydtype	Weckton	Tipo de sonido de la alarma	Herätysäänen tyyppi

Français	Italiano	Nederlands	Norsk	Português
Appuyez pour répéter	Toccate per attivare lo snooze	Raak aan om te sluimeren	Trykk for å aktivere snooze	Tocar para repetir alarme
Lumière marche/arrêt	Luce accesa/spenta	Licht aan/uit	Lys av/på	Ligar/desligar a luz
Alarme marche/arrêt	Sveglia attiva/non attiva	Alarm aan/uit	Alarm av/på	Ligar/desligar o alarme
Antenne	Antenna	Antenne	Antenne	Antena
Luminosité de l'affichage	Luminosità display	Displayhelderheid	Visningsstyrke	Brilho do visor
Heure (horloge)	Ora	Kloktijd	Klokkeslett	Hora do relógio
Type de sonnerie d'alarme	Tipo di suono della sveglia	Type wekgeluid	Alarmlydtype	Tipo de som do alarme

Svenska	Русский
Tryck för att använda snooze-funktionen	Нажмите, чтобы отложить сигнал
Ljus på/av	Включить/выключить светильник
Larm på/av	Включить/выключить сигнал
Antenn	Антенна
Teckenfönstrets ljusstyrka	Яркость дисплея
Klocktid	Время на часах
Larmljudstyp	Тип сигнала будильника

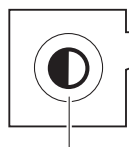
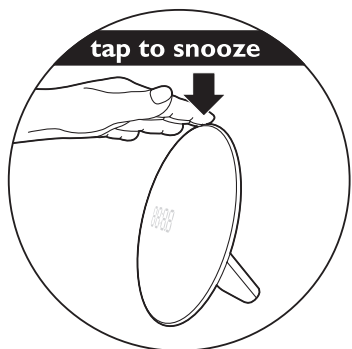

Display brightness
1-4

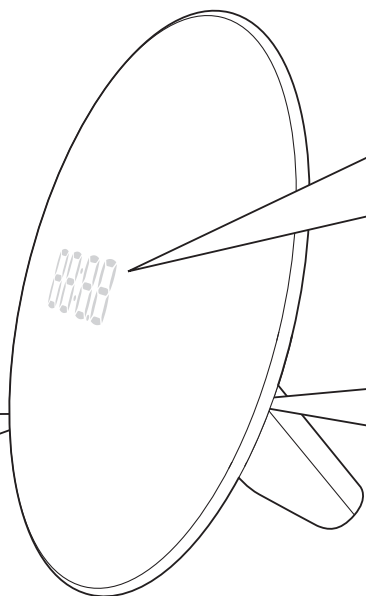

FM on/off
87.5 Mhz.<< 108.0 Mhz.>>

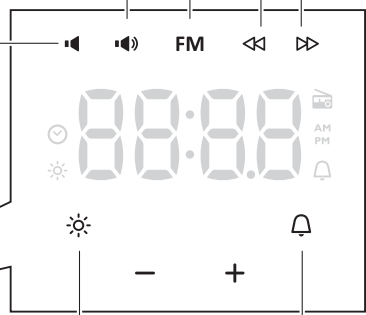

Light on/off

Alarm on/off

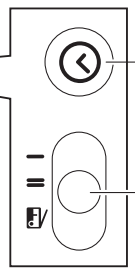

Clock time

Alarm sound type:

— Sound 1

= Sound 2

FM

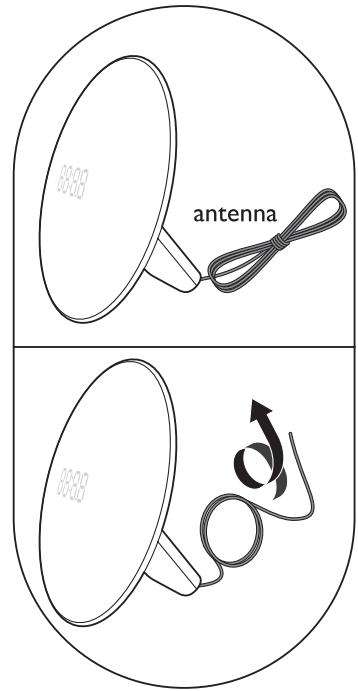

Clock time 

12h/24h AM PM

Alarm time 

Alarm on/off 

Alarm sounds 

Light 1-10 

