



L'OR

B A R I S T A



Before first use/ Antes de utilizarlo por primera vez/ Avant la première utilisation/ Før apparatet tages i brug/ Vor dem ersten Gebrauch/ Primo utilizzo/ Vóór het eerste gebruik/ Før bruk første gang/ Antes da primeira utilização/ Före första användningen

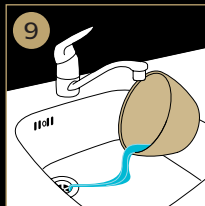
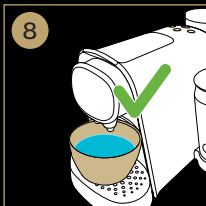
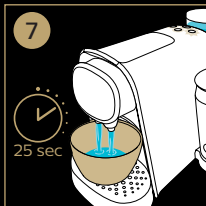
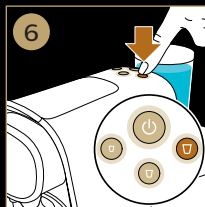
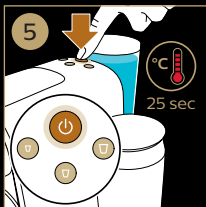
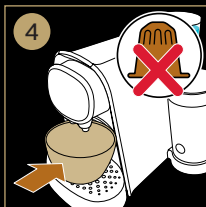
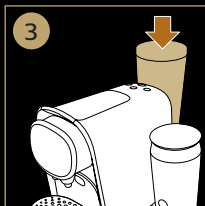
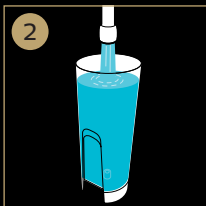
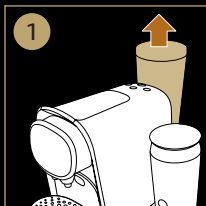



Prepare coffee/Preparar café/Préparer le café/Klargør kaffe/Kaffee zubereiten/Preparazione del caffè/Koffie bereiden/Forbered kaffe/Preparar café/Förbered kaffe

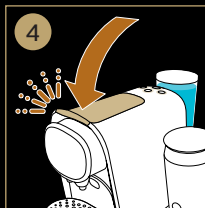
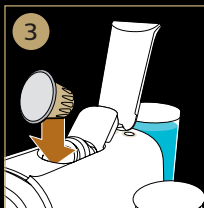
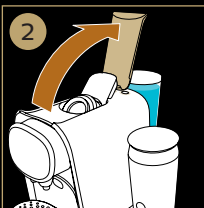
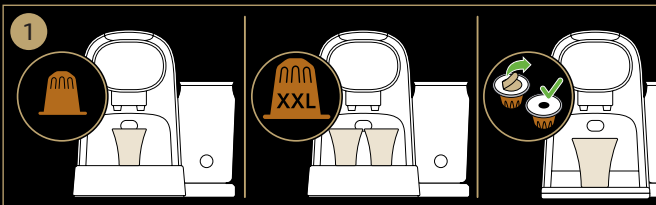

6a Espresso



6b Double espresso / Double shot of espresso



7a Lungo



7b Double lungo / Double shot of lungo

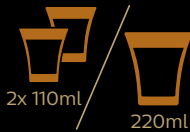
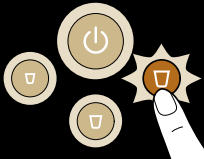

8

Grand Café Filtre



220ml



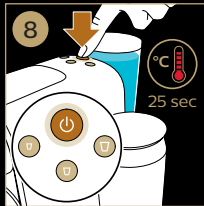
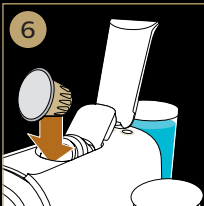
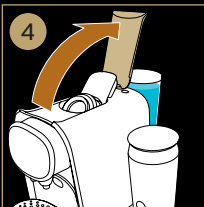
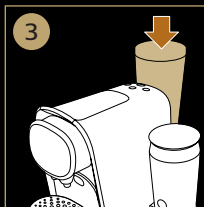
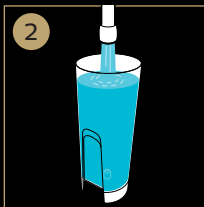
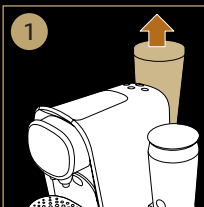

Drink personalization: program your drink volume/Personalización de bebida: ajuste la longitud de votre boisson/Personlig indstilling: Programmer mængden på din drik/Personalizzazione della bevanda: programma il volume della tua bevanda/Personaliseer mengden drikke/Personalização da bebida: memorize a quantidade da sua bebida/

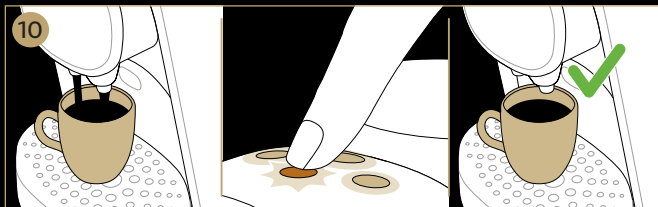
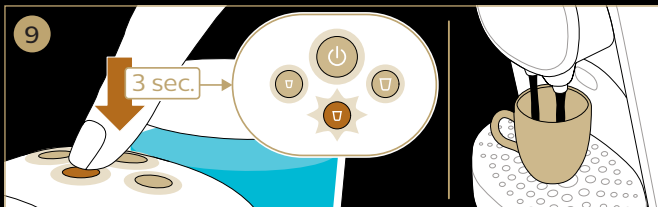

La cantidad de su bebida/Personalisation de votre boisson : choisissez

Personalisieren Sie Ihren Kaffee: Programmieren Sie die gewünschte Getränkemeenge/ je kaffie: programmer je gewenste koffievolumen/Personlige innstillinger: Programmer Personliga inställningar: Programera mängden för din dryck



	Standard padrão/estandar	Min.	Max.
Ristretto	25 ml	20 ml	40 ml
Espresso	40 ml	30 ml	50 ml
Lungo	110 ml	50 ml	135 ml

	Standard padrão/estandar	Min.	Max.
Ristretto	50 ml	40 ml	60 ml
Espresso	80 ml	60 ml	100 ml
Lungo	220 ml	100 ml	270 ml



**Prepare milk/Preparar leche/Préparer le lait/Klargør mælk/
Milch zubereiten/Preparazione del latte/Melk bereiden/
Forbered Melk/Preparar leite/Förbered mjölk**

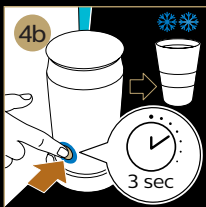
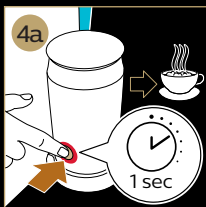
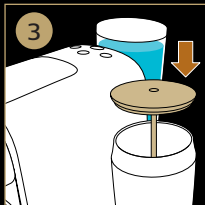
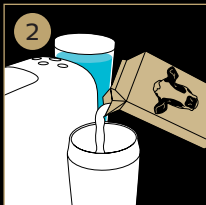
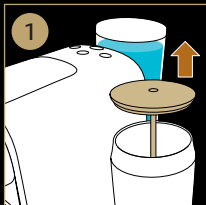

**Cleaning/Limpieza/Nettoyage/Rengøring/Reinigung/
Pulizia/Reinigen/Rengjøring/Limpeza/Rengöring**

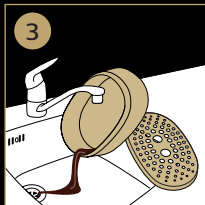
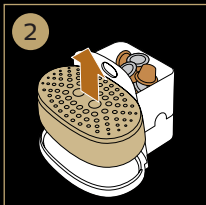
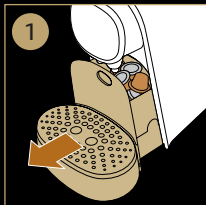

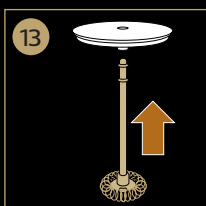
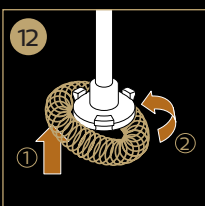
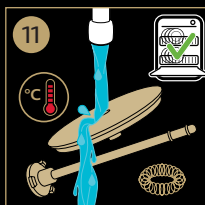
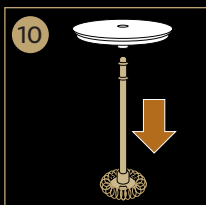
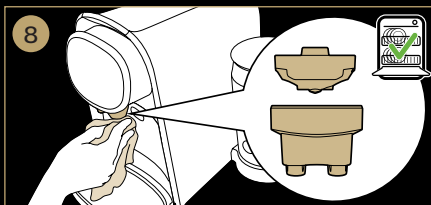
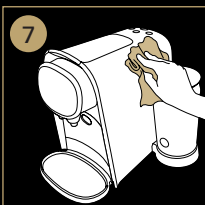
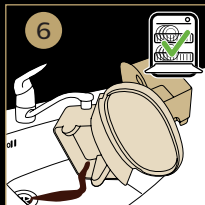
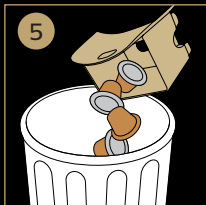
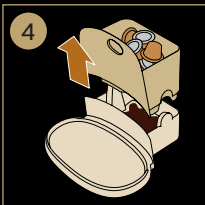



Descaling/Eliminación de los depósitos de cal/Détartrage/

Afkalkning/Entkalken/Rimozione del calcare/Ontkalken/

Avkalkning/Descalcificação/Avkalkning

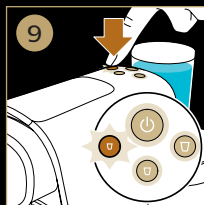
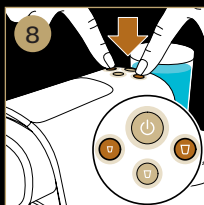
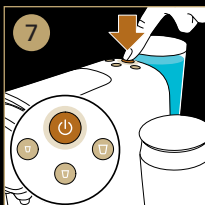
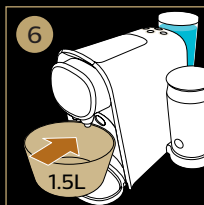
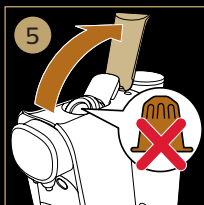
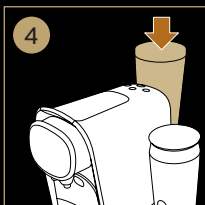
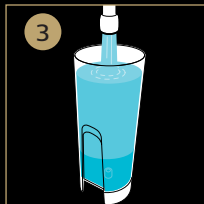
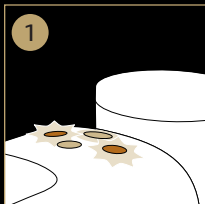

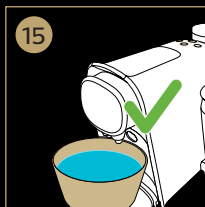
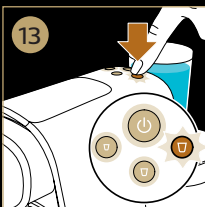
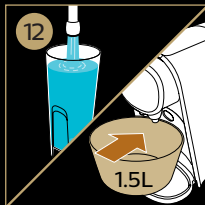
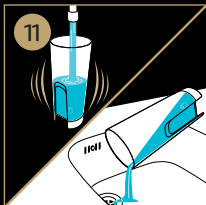
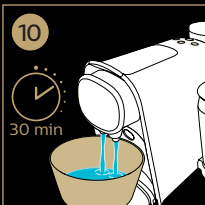

Support/Asistencia/Assistance/
Support/Unterstützung/Assistenza/
Ondersteuning/Støtte/Suporte/Hjälp



REV.01



422220007226



4222.200.0722.6