

# PHILIPS

# AVENT



## Sterilizer

Bottle Sterilizer & Dryer  
Premium



SCF293/01

## Sterilize, dry and store

Powerful steam sterilises, filtered air dries

Be ready for baby's next feed in 40 minutes. Bottle Sterilizer & Dryer Premium uses jets of filtered air to dry bottles before turning off. The sterilizer is quick and hygienic, killing 99.9% of germs\* for peace of mind at every feed.

### Easy to clean and assemble

- This sterilizer is quick and easy to clean

### Integrated drip tray

- Designed to reduce the chance of unpleasant odors

### Kills 99.9% of germs\*

- Say goodbye to harmful bacteria

### Sterilize and dry in 40 mins

- A full sterilizing and drying cycle lasts just 40 minutes

### Space saving design

- Roomy inside, compact outside

# Highlights

## Kills 99.9% of germs\*



Sterilizing is gentle, effective and chemical-free with Philips Avent. Every sterilizer uses the power of pure steam – nothing more, nothing less – to kill 99.9% of harmful germs\*.

## Sterilize and dry in 40 mins



It takes just 40 minutes to get bottles ready for your baby's next feed. After powerful steam-sterilizing, a focused jet of filtered air dries bottles and accessories, making them ready for instant use.

## Integrated drip tray



Our new drip tray protects the heating plate from milk droplets, reducing the chance of unpleasant odors.

## Sterilize, dry and store



Our premium electric sterilizer does more than clean bottles and kill germs – it dries and stores bottles and accessories, keeping them sterile for up to 24 hours.

## Space-saving design

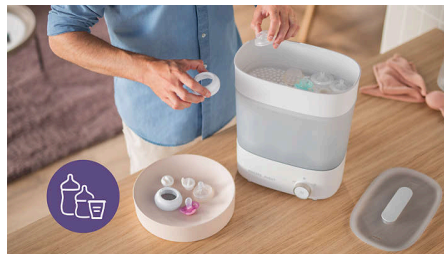

Our sterilizer is slender and yet still holds up to six Philips Avent baby bottles. It also fits all the other essentials, from teats and soothers to a manual breast pump.

## Easy to clean and assemble



Top to bottom, inside and out, the sterilizer is quick and easy to clean – even the heating plate. So you get more time to be with your little one.

# Specifications

## Technical specifications

Power consumption: 650 W

Voltage: 220-240V~ 50-60Hz, 220V~ 60Hz (Korea), 120-127V~ 60Hz (NAM), 110V~ 60Hz (Taiwan)

Safety Classification: Class 1

## Weight and dimensions

Dimensions: 304 x 191 x 378 mm

Weight: 2.4 kg

## Design specifications

Materials: Plastic (PP)

## Country of origin

Made in: China

## What is included

Tongs: 1 pcs

Electric steam sterilizer: 1 pcs

## Compatibility

Philips-Avent range compatible

## Development stages

Stage: 0 - 6 months

