

Register your product and get support at
www.philips.com/welcome

HU4901



User manual

PHILIPS

Contents

1	Important	4
	Safety	4
2	Your humidifier	5
	What's in the box	5
3	Get started	6
	Prepare for humidification	6
4	Use the humidifier	7
	Switch the humidifier on and off	7
	Refill the water	8
	Normal refill	8
	Refill without removing the water tank	9
	Easy refill	9
5	Clean your humidifier	10
	Clean the body of the humidifier	10
	Clean the water tank	10
6	Clean the humidification filter	11
	Rinse the humidification filter	11
	Descale the humidification filter	12
7	Replace the humidification filter	14
8	Troubleshooting	16
9	Guarantee and service	18
	Order parts or accessories	18
10	Notices	19
	Electromagnetic fields (EMF)	19
	Compliance with EMF	19
	Recycling	19

1 Important

Safety

Read this user manual carefully before you use the humidifier, and save it for future reference.



Danger

- Do not spray any flammable materials such as insecticides or fragrance around the humidifier.
- The water in the water tank is not suitable for drinking. Do not drink this water and do not use it to feed animals or to water plants. When you empty the water tank, pour the water down the drain.



Warning

- Check if the voltage indicated on the bottom of the humidifier corresponds to the local power voltage before you connect the humidifier.
- If the power cord is damaged, you must have it replaced by Philips, a service center authorized by Philips, or similarly qualified persons in order to avoid a hazard.
- Do not use the humidifier if the plug, the power cord, or the humidifier itself is damaged.
- This humidifier is not intended for use by persons (including children) with reduced physical sensory or mental capabilities, or lack of experience and knowledge, unless they have been given supervision or instruction concerning use of the humidifier by a person responsible for their safety.
- Children should be supervised to ensure that they do not play with the humidifier.
- Do not block the air inlet and outlet, e.g. by placing items on the air outlet or in front of the air inlet.



Caution

- If the power socket used to power the humidifier has poor connections, the plug of the humidifier becomes hot. Make sure that you plug the humidifier into a properly connected power socket.
- Always place and use the humidifier on a dry, stable, level, and horizontal surface.
- Do not place anything on top of the humidifier and do not sit on the humidifier.
- Make sure that the humidifier is well assembled/connected every time after you clean it or after you remove the upper cover and/or water tank for refilling. The humidifier must be properly assembled to deliver a good and safe performance.
- Only use the original Philips filter specially intended for this humidifier. Do not use any other filter.
- Avoid knocking against the humidifier (the air inlet and outlet in particular) with hard objects.
- Do not insert your fingers or objects into the air outlet or the air inlet to prevent physical injury or malfunctioning of the humidifier.
- Do not use this humidifier when you have used indoor smoke-type insect repellents or in places with oily residues, burning incense, or chemical fumes.
- Do not use the humidifier near gas appliances, heating devices or fireplaces.
- Always unplug the humidifier after use and before you clean it.



Caution

- Do not use the humidifier in a room with major temperature changes, as this may cause condensation inside the humidifier.
- When the humidifier is not used for a long time, bacteria may grow on the filters. Check the filters after a long period of disuse. If the filter is very dirty, replace it (see the chapter 'Replace the filter').
- The humidifier is only intended for household use under normal operating conditions.
- Clean the water tank every week to keep it clean.
- Only fill the water tank with cold tap water. Do not use ground water or hot water.
- Do not put any substance other than water in the water tank. Do not put fragrance in the water tank. Use only water (tap, purified, mineral, any sort of potable water).
- If you do not use the humidifier for a long time, clean the water tank and dry the humidification filter.
- If you need to move the humidifier, disconnect the humidifier from the power supply first. Then empty the water tank, and carry the humidifier horizontally.

2 Your humidifier

Congratulations on your purchase, and welcome to Philips!

To fully benefit from the support that Philips offers, register your product at www.Philips.com/welcome.

The Philips humidifier brings fresh, humidified air to your house for the health of your family. It offers you an advanced evaporation system for a perfect and comfortable humidification of the dry air in your home. It retains bacteria, calcium and other particles from the water. It delivers only pure humidified air in your home. No more dry air in the winter season or from the air conditioning.

We hope that you enjoy using this appliance as much as we enjoyed creating it.

Read this user manual carefully before you install and use the humidifier. Save it for future reference.

What's in the box

Check and identify the contents of your package:

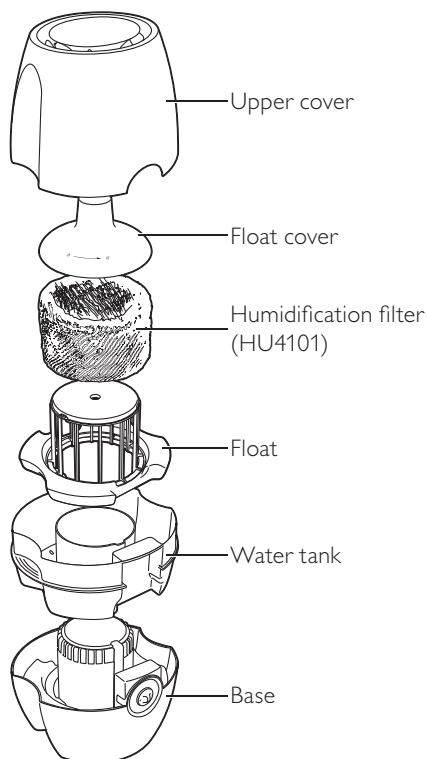

User manual



Quick start guide



Warranty

3 Get started

Prepare for humidification

- 1 Hold by both sides of the upper cover to lift it up.

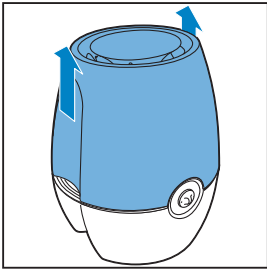

- 2 Fill the water tank with cold tap water until the water reaches the water indication level.

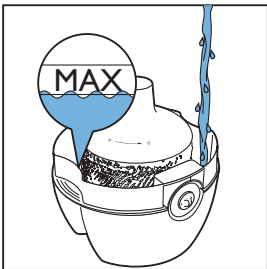

↳ The float begins to float.

- 3 Place the upper cover back onto the humidifier.

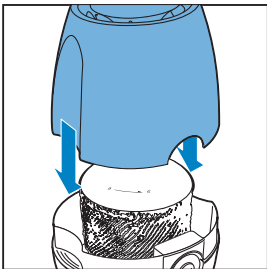

4 Use the humidifier

Switch the humidifier on and off

- 1 Plug the humidifier into the power supply.

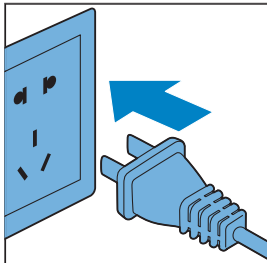

- 2 Shift the switch to the right.

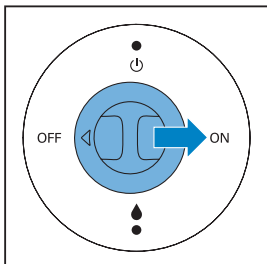

↳ The power light is on.

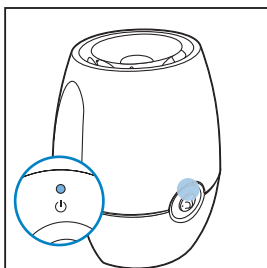

- ↳ The humidifier is on.
 ↳ The humidifier releases very fine invisible mist.

- 3 Shift the switch to the left.

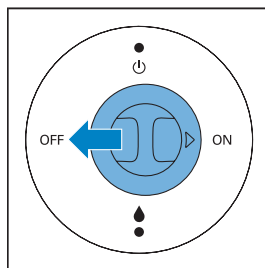

↳ The power light is off.

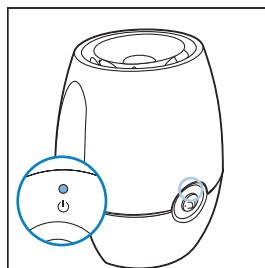

↳ The humidifier is off.

Note

- If the water tank is empty, the power light is off.
- It is normal that you cannot see the mist.

Refill the water

There are three ways to refill the water into the water tank: Normal refill, refill without removing the water tank and easy refill.

Normal refill

- 1 Remove upper cover by lifting it at both sides.

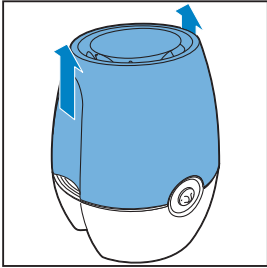

- 2 Remove the water tank from the humidifier base by lifting it at both sides

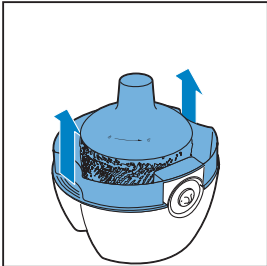

- 3 Fill the water tank with cold tap water until the water reaches the maximum water indication level.

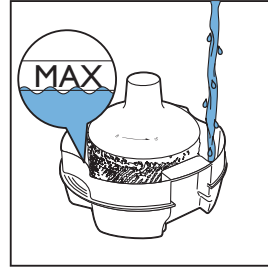

→ The float begins to float.

- 4 Place the water tank back on the humidifier base.

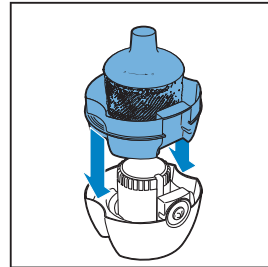

- 5 Place the upper cover back at the humidifier.

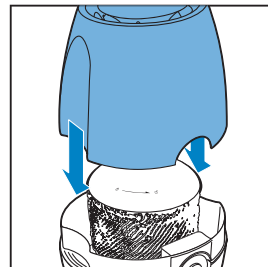

Refill without removing the water tank

- 1 Remove the upper cover.

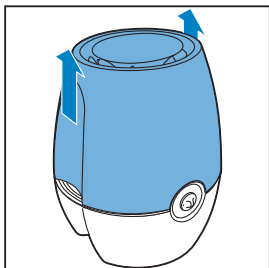

- 2 Fill a jar with water.
- 3 Pour it into the water tank until the water reaches the maximum water level indication .

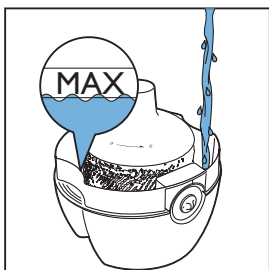

- 4 Put the upper cover back to the appliance.

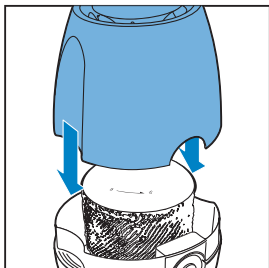

Easy refill

- 1 Fill a jar with water.
- 2 Pour the water to the water tank from the top central opening until the top of the float cover emerges and closes the opening completely.

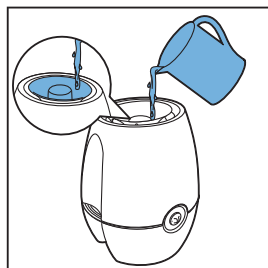

Tip

- If you see the water starts accumulating, this means the water tank is full. Stop pouring water.

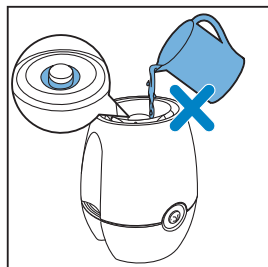

5 Clean your humidifier

Our Philips designers have created a best-in-class design for cleanability, empowering consumers to take control of the hygiene of their humidifiers in an easy way. Cleaning humidifiers inside and out – especially the water tank and the air outlet – has never been easier.



Note

- Always unplug the humidifier before you clean it.
- Never use abrasive, aggressive, or flammable cleaning agents such as bleach or alcohol to clean any part of the humidifier.

Clean the body of the humidifier

Regularly clean the inside and outside of the humidifier to prevent dust from collecting.

- 1 Wipe away dust with a soft dry cloth from the body of the humidifier.
- 2 Clean the air inlet and the air outlet with a soft dry cloth.

Clean the water tank

Clean the water tank every week to keep it hygienic.

- 1 Fill the water tank for 1/3 with water.
- 2 Add some mild washing-up liquid to the water in the water tank.
- 3 Clean the inside of the water tank with both hands.
- 4 Empty the water tank into a sink.

6 Clean the humidification filter

Rinse and descale the humidification filter every week to keep it hygienic.

Rinse the humidification filter

- 1 Switch off the humidifier and unplug it.

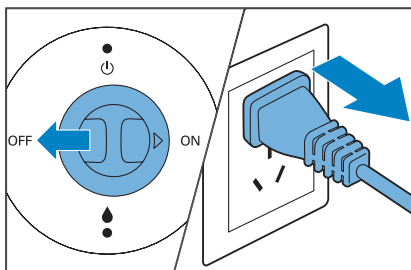

- 2 Remove the water tank from the humidifier.

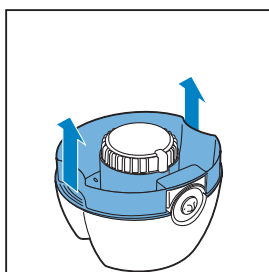

- 3 Turn the cover of the float counter clockwise to remove it.

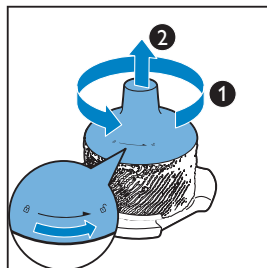

- 4 Remove the humidification filter from the float.

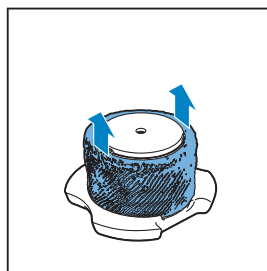

- 5 Rinse the humidification filter under a slowly running tap.

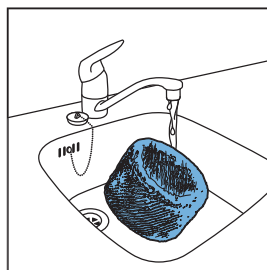

- 6 Wrap the humidification filter round the float.

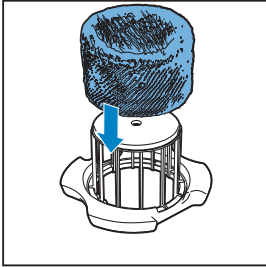

- 7 Turn the cover of the float clockwise to put it back in place.

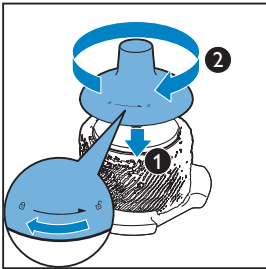

- 2 Remove the water tank from the humidifier.

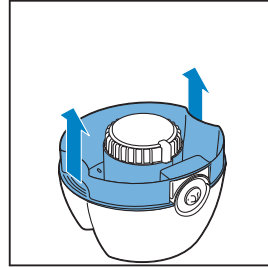

- 3 Turn the cover of the float counter clockwise to remove it.

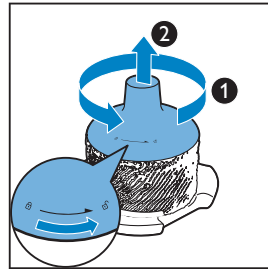

- 4 Remove the humidification filter from the float.

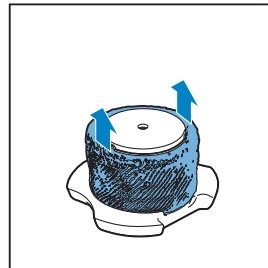

Descal the humidification filter

Note

- It is important to descale the humidifying filter to avoid scale build-up, which seriously affects the humidifying performance.

- 1 Switch off the humidifier and unplug it.

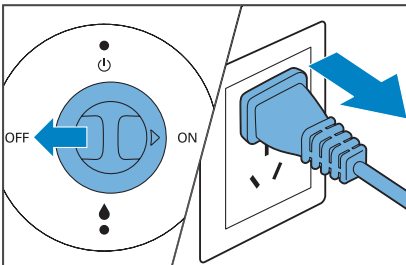

- 5 Mix white vinegar with an equal amount of tap water in a container that is large enough to soak the humidification filter in.

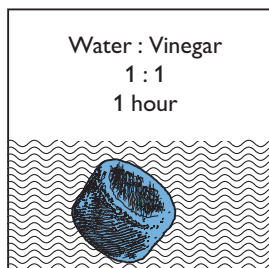

Note

- The white vinegar is composed with of 5% acetic acid.
- If there are white deposits (scale) on the filter, make sure that the side with the white deposits is immersed in the water.

- 6 Let the humidification filter soak in the solution for one hour.
- 7 Discard the water-vinegar solution.
- 8 Rinse the humidification filter under the tap to rinse away vinegar residues. During rinsing, turn the humidification filter so that both the front and back sides are rinsed.

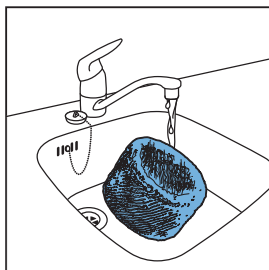

- 9 Let excess water drip off the humidification filter.

- 10 Put the humidification filter back onto the float.

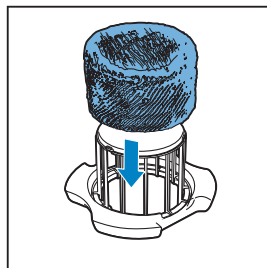

- 11 Turn the cover of the cover of the float clockwise to put it back in place.

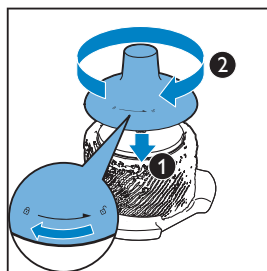

7 Replace the humidification filter

Replace the humidification filter at least once a year for optimal performance.



Note

- Use only Philips original humidification filter, **HU4101**.



Tip

- Register your product at www.Philips.com for further information on how to replace your filter.

- 1 Switch off the humidifier and unplug it.

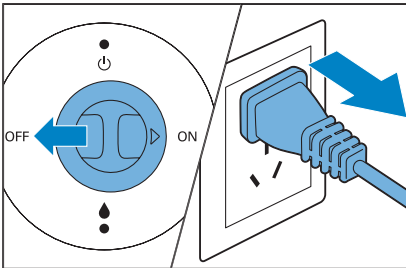

- 2 Remove the water tank from the appliance.

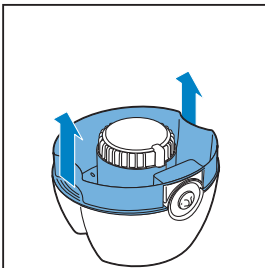

- 3 Turn the cover of the float counter clockwise to remove it.

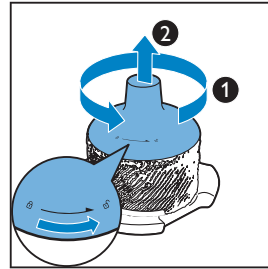

- 4 Remove the old humidification filter from the humidifier.

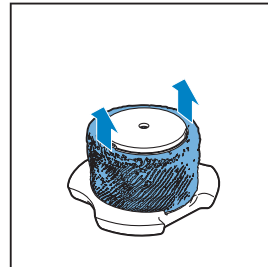

- 5 Remove the packaging material from the new humidification filter.

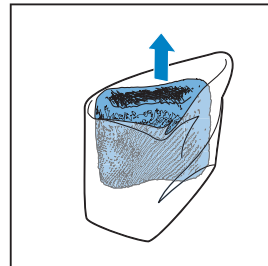

- 6 Wrap the new humidification filter around the float

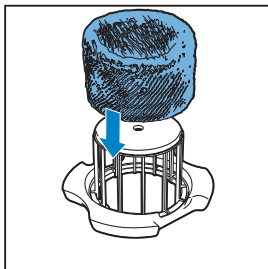

- 7 Turn the cover of the float clockwise to put it back in place.

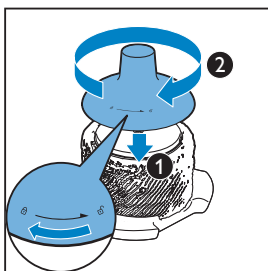

Tip

- You can easily find more information about how to replace the filter in our web page or by calling our Consumer Care Center.

8 Troubleshooting

This chapter summarizes the most common problems you could encounter with the humidifier. If you are unable to solve the problem with the information below, contact the Consumer Care Center in your country.

Problem	Possible solution
The humidifier does not work.	<ul style="list-style-type: none">• Make sure that there is power supply to the humidifier.• Make sure that the water tank is filled with water and placed properly onto the humidifier.
There is no air humidification.	<ul style="list-style-type: none">• Make sure that the water tank is filled with water and placed properly into the humidifier.• Your room might have too much ventilation. Please close doors and windows.• Your room size is too big. The recommended room size is 40m² for HU4901.
The water tank leaks.	<ul style="list-style-type: none">• Make sure that the humidifier is not overfilled with water.• Make sure that the humidifier is well assembled/connected every time after you clean it or after you remove the upper cover and/or water tank for refilling.• Make sure that water tank is placed properly. If the problem persists, contact the Consumer Care Center in your country.
There are some white deposits on the humidification filter.	The white deposits are called scale and they consist of minerals from the water. Scale on the humidification filter affects the humidifying performance. Therefore you have to descale the humidification filter regularly (See the chapter "Clean the humidification filter").
The filter turns yellowish after some time.	The yellow color is caused by scale and some dirt which is presented in the air. When the air passes through the humidification filter, the dirt and scale will stick to the filter and pure water is evaporated in to the air. Scale and dirt on the humidification filter affects the humidifying performance. Therefore you have to descale the humidification filter regularly (See the chapter "Clean the humidification filter").

Problem	Possible solution
There is unpleasant smell coming out from the humidifier.	<ul style="list-style-type: none">• Make sure that the water tank is filled with water.• Clean the humidification filter (see the chapter 'Clean the humidification filter').
No air comes out of the air outlet.	Plug the humidifier into the power supply and switch on.
I do not see visible mist coming out of the humidifier. Is it working?	When mist is very fine, it is invisible. This humidifier has a specially designed humidification filter that produces very fine mist. Therefore, you cannot see the mist.

9 Guarantee and service

If you need information or if you have a problem, please visit the Philips website at www.philips.com or contact the Philips Consumer Care Center in your country (you find its phone number in the worldwide guarantee leaflet). If there is no Consumer Care Centre in your country, go to your local Philips dealer.

Order parts or accessories

If you have to replace a part or want to purchase an additional part, go to your Philips dealer or visit www.philips.com/support. If you have problems obtaining the parts, please contact the Philips Consumer Care Center in your country (you will find its phone number in the worldwide guarantee leaflet).

10 Notices

Electromagnetic fields (EMF)

This Philips appliance complies with all standards regarding electromagnetic fields (EMF). If handled properly and according to the instructions in this user manual, the appliance is safe to use based on scientific evidence available today.

Compliance with EMF

Koninklijke Philips Electronics N.V. manufactures and sells many products targeted at consumers, which, like any electronic apparatus, in general have the ability to emit and receive electromagnetic signals.

One of Philips' leading Business Principles is to take all necessary health and safety measures for our products, to comply with all applicable legal requirements and to stay well within the EMF standards applicable at the time of producing the products.

Philips is committed to develop, produce and market products that cause no adverse health effects. Philips confirms that if its products are handled properly for their intended use, they are safe to use according to scientific evidence available today.

Philips plays an active role in the development of international EMF and safety standards, enabling Philips to anticipate further developments in standardization for early integration in its products.

Recycling



Your product is designed and manufactured with high quality materials and components, which can be recycled and reused. When you see the crossed-out wheel bin symbol attached to a product, it means the product is covered by the European Directive 2002/96/EC:



Never dispose of your product with other household waste. Please inform yourself about the local rules on the separate collection of electrical and electronic products. The correct disposal of your old product helps prevent potentially negative consequences on the environment and human health.

Environmental information

All unnecessary packaging has been omitted. We have tried to make the packaging easy to separate into three materials: cardboard (box), polystyrene foam (buffer) and polyethylene (bags, protective foam sheet.)

Your system consists of materials which can be recycled and reused if disassembled by a specialized company. Please observe the local regulations regarding the disposal of packaging materials, exhausted batteries and old equipment.

Specifications are subject to change without notice. Trademarks are the property of Koninklijke Philips Electronics N.V. or their respective owners. Philips reserves the right to change products at any time without being obliged to adjust earlier supplies accordingly.

