

Always there to help you

Register your product and get support from

www.philips.com/welcome



AC3252

AC3254

AC3256



User manual

PHILIPS



Contents

1 Important	4
Safety	4

2 Your air purifier	6
Product overview	6
Controls overview	7

3 Getting started	8
Install filter	8

4 Using the appliance	9
Understand the air quality light	9
Switch on and off	9
Change the fan speed	10
Set the timer	11
Set the child lock	12
Use the light on/off function	12

5 Cleaning	13
Cleaning schedule	13
Clean the body of the appliance	13
Clean the air quality sensors	13
Clean the pre-filter	14

6 Replacing the filter	16
Understand the healthy air protect lock	16
Replace the filter	16
Filter force reset	17
Filter type change	18

7 Troubleshooting	20
--------------------------	-----------

8 Guarantee and service	22
Order parts or accessories	22

9 Notices	22
Electromagnetic fields (EMF)	22
Recycling	22

1 Important

Safety

Read this user manual carefully before you use the appliance, and save it for future reference.

Danger

- Do not let water or any other liquid or flammable detergent enter the appliance to avoid electric shock and/or a fire hazard.
- Do not clean the appliance with water, any other liquid, or a (flammable) detergent to avoid electric shock and/or a fire hazard.
- Do not spray any flammable materials such as insecticides or fragrance around the appliance.

Warning

- Check if the voltage indicated on the appliance corresponds to the local power voltage before you connect the appliance.
- If the power cord is damaged, you must have it replaced by Philips, a service center authorized by Philips, or similarly qualified persons in order to avoid a hazard.
- Do not use the appliance if the plug, the power cord, or the appliance itself is damaged.
- This appliance can be used by children aged from 8 years and above and persons with reduced physical, sensory or mental capabilities or lack of experience and knowledge if they have been given supervision or instruction concerning use of the appliance in a safe way and understand the hazards involved. Child shall not

play with the appliance. Cleaning and maintenance shall not be made by children without supervision.

- Do not block the air inlet and outlet, e.g. by placing items on the air outlet or in front of the air inlet.
- Make sure that foreign objects do not fall into the appliance through the air outlet.

Caution

- This appliance is not a substitute for proper ventilation, regular vacuum cleaning, or use of an extractor hood or fan while cooking.
- If the power socket used to power the appliance has poor connections, the plug of the appliance becomes hot. Make sure that you plug the appliance into a properly connected power socket.
- Always place and use the appliance on a dry, stable, level, and horizontal surface.
- Leave at least 20cm free space behind and on both sides of the appliance and leave at least 30cm free space above the appliance.
- Do not place anything on top of the appliance.
- Do not sit or stand on the appliance. Sitting or standing on the appliance may lead to potential injury.
- Do not place the appliance directly below an air conditioner to prevent condensation from dripping onto the appliance.
- Make sure all filters are properly installed before you switch on the appliance.
- Only use the original Philips filters specially intended for this appliance. Do not use any other filters.
- Combustion of the filter may cause irreversible human hazard and/

or jeopardize other lives. Do not use the filter as fuel or for similar purpose.

- Avoid knocking against the appliance (the air inlet and outlet in particular) with hard objects.
- Always lift or move the appliance by the handle on top of the appliance.
- Do not insert your fingers or objects into the air outlet or the air inlet to prevent physical injury or malfunctioning of the appliance.
- Do not use this appliance when you have used indoor smoke-type insect repellents or in places with oily residues, burning incense, or chemical fumes.
- Do not use the appliance near gas appliances, heating devices or fireplaces.
- Always unplug the appliance after use and before cleaning or carrying out other maintenance.
- Do not use the appliance in a room with major temperature changes, as this may cause condensation inside the appliance.
- To prevent interference, place the appliance at least 2 meters away from electrical appliances that use airborne radio waves such as TVs, radios, and radio-controlled clocks.
- The appliance is only intended for household use under normal operating conditions.
- Do not use the appliance in wet surroundings or in surroundings with high ambient temperatures, such as the bathroom, toilet, or kitchen.
- The appliance does not remove carbon monoxide (CO) or radon (Rn). It cannot be used as a safety device in case of accidents

with combustion processes and hazardous chemicals.

- If you need to move the appliance, disconnect the appliance from the power supply first.
- When moving the appliance, do it slowly and do not push it rapidly.
- Do not move the appliance by pulling its power cord.

2 Your air purifier

Congratulations on your purchase, and welcome to Philips!

To fully benefit from the support that Philips offers, register your product at www.philips.com/welcome.

Product overview

- A Control panel
- B Air quality light
- C Air quality sensors
- D NanoProtect Pro S3 filter (FY3137)*
- E Pre-filter
- F Front panel

* Hereinafter referred to as "air purification filter".

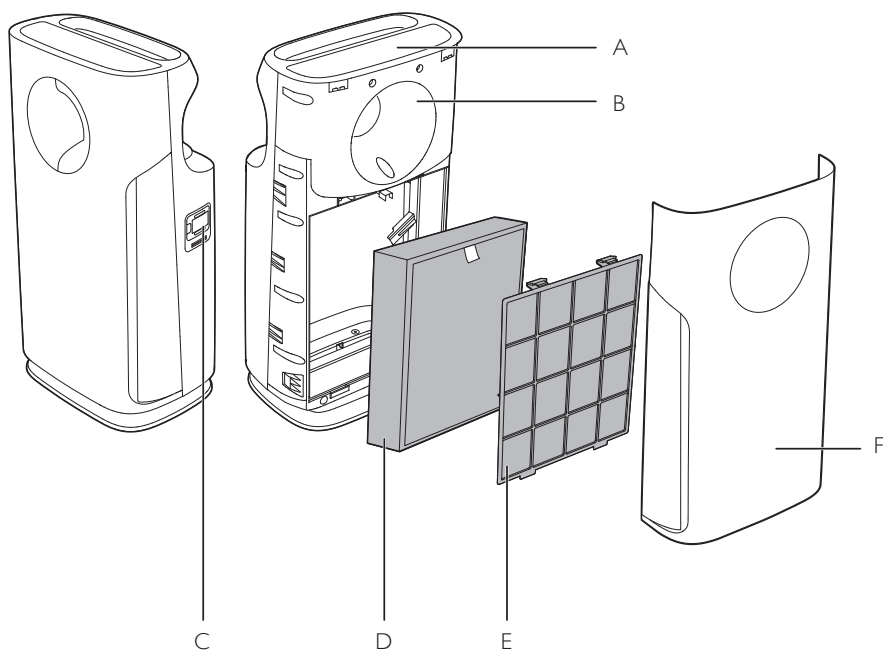

Controls overview

- G** On/Off button
- H** Child lock button
- I** Light on/off button
- J** Display screen
- K** Fan speed button
- L** Timer button
- M** Reset button

AC3252

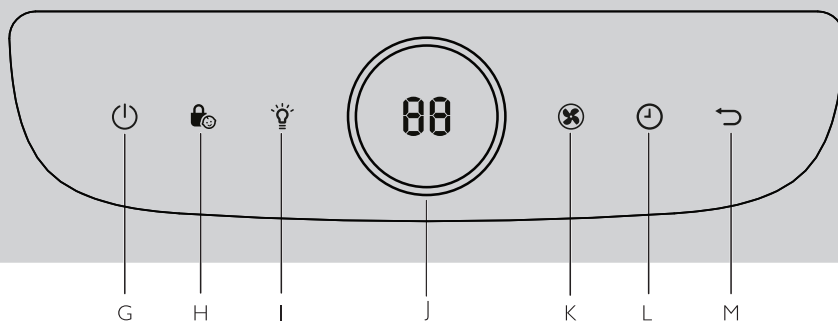

AC3254 AC3256

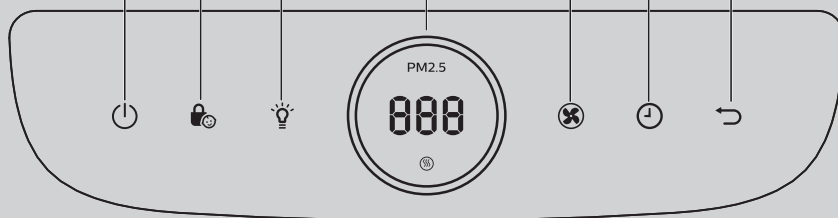

3 Getting started

Install filter

Before using the appliance, remove all packaging materials of the filter and place the filter into the appliance as described below.



Note

- Make sure that the side with the tag is pointing towards you.

- 1 Remove all packaging materials of the air purification filter.

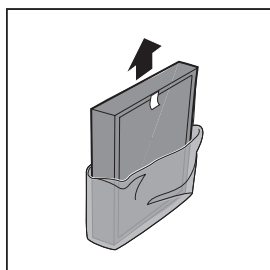

- 2 Pull the bottom part of the front panel to remove it from the appliance.

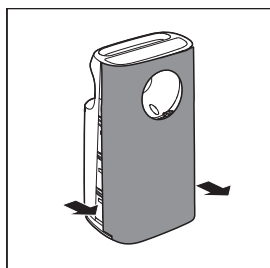

- 3 Press the two clips down and pull the pre-filter towards you.

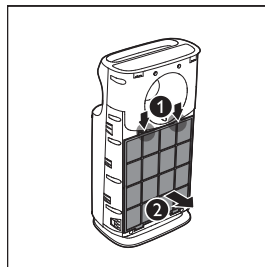

- 4 Put the unpacked air purification filter back into the appliance.

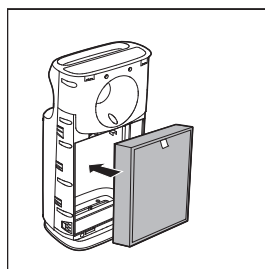

- 5 Put the pre-filter back into the appliance.

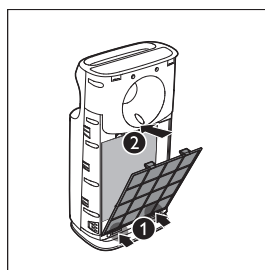

Note

- Make sure that the side with the two clips is pointing towards you, and that all hooks of the pre-filter are properly attached to the purifier.

- 6** To reattach the front panel, mount the panel onto the top of the appliance first (1). Then, gently push the panel against the body of the appliance (2).



4 Using the appliance

Understand the air quality light

Air quality light color	Air quality level
Blue	Good
Blue-violet	Fair
Red-purple	Unhealthy
Red	Very unhealthy

The air quality light automatically goes on when the appliance is switched on, and lights up all colors in sequence. In a short time the air quality sensors select the color that corresponds to the ambient air quality.

Switch on and off

- 1 Put the plug of the appliance in the power socket.
- 2 Touch  to switch on the appliance.
 - ➔ The appliance operates under the auto mode by default.

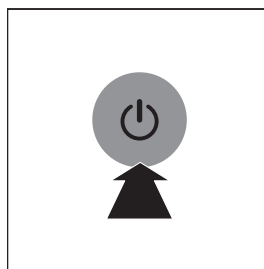

- ➔ After measuring the air quality for a short time, the air quality sensor automatically selects the color of the air quality light.
- ➔ For **AC3252**, the current fan speed displays on the screen.

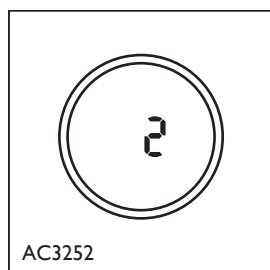

- ➔ For **AC3254** and **AC3256**, After measuring the particle matters in the air, the appliance will show the PM2.5 level on the screen.

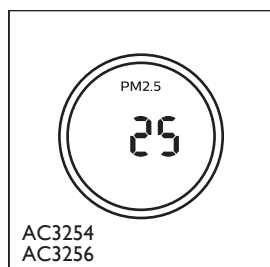

- 3** Touch and hold  for 3 seconds to switch off the appliance.

Note

- After the appliance is switched off by the on/off button , if the plug is still in the power socket, the appliance will operate under the previous settings when it is switched on again.

Change the fan speed

There are several fan speeds available. You can choose the auto mode, gas mode, speed **1**, **2**, **3**, **4** or **5**.

Auto (A)

In auto mode, the appliance selects the fan speed according to the ambient air quality.

- Touch the fan speed button  to select auto (A).

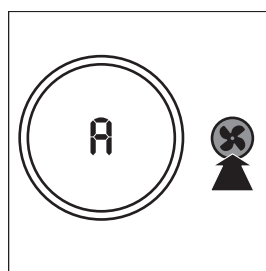

Gas mode (C)

Note

- The gas mode is only available for **AC3254** and **AC3256**.

In gas mode, the appliance is specially programmed to filter out harmful gases* optimally. You can select the gas mode to filter out harmful gases*.

- Touch the fan speed button  to select the gas mode (C).

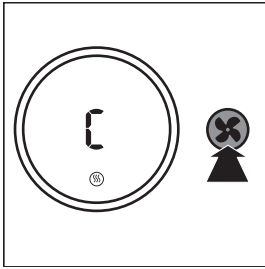

When the (🌀) icon lights up, it indicates that there is an increase of gas level in the air.

*Special Optimized Gas Mode for filtering out harmful gases (formaldehyde, Toulene, TVOC.)

Sleep mode

In sleep mode, the appliance operates quietly under speed 1. One minute into the sleep mode, the power and light on/off indicators are dimmed, and all the other lights are off.

- Touch the fan speed button (🌀) to select the sleep mode (speed 1).

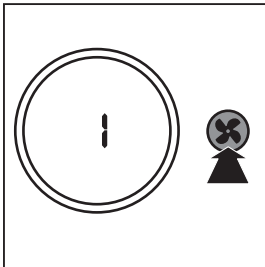

Manual

- Touch the fan speed button (🌀) repeatedly to select the fan speed you need.

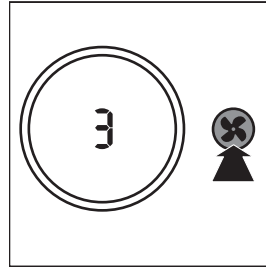

Set the timer

With the timer, you can let the appliance operate for a set number of hours. When the set time has elapsed, the appliance will automatically switch off.

- Touch the timer button (🕒) repeatedly to choose the number of hours you want the appliance to operate.

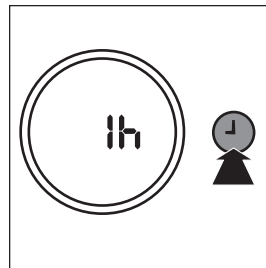



➞ For **AC3252**, the timer is available in **1, 4 or 8** hours. For **AC3254** and **AC3256**, the timer is available from **1 to 24** hours.

To deactivate the timer, touch the timer button (🕒) repeatedly until **0h** displays on the screen.

Set the child lock

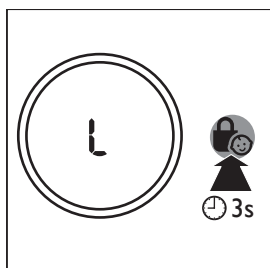
- 1 Touch and hold the child lock button  for 3 seconds to activate child lock.
 - ↳ "L" displays on the screen for 3 seconds.
 - ↳ When the child lock is on, all the other buttons are not responsive.



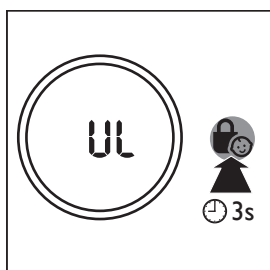

- 2 Touch and hold the child lock button  for 3 seconds again to deactivate child lock.
 - ↳ "UL" displays on the screen for 3 seconds.



Use the light on/off function

With the light on/off button, you can switch on or off the air quality light, the display screen and the function indicators if needed.

- 1 Touch the light on/off button  once, the air quality light will go out.
- 2 Touch the light on/off button  again, the display screen will go out for **AC3252**; for **AC3254** and **AC3256**, the display screen and the function indicators will go out. The power on/off  and light on/off  indicators will still be on, but the lights will be dimmed.
- 3 Touch the light on/off button  for the third time, all lights will be on again.

5 Cleaning



Note

- Always unplug the appliance before cleaning.
- Never immerse the appliance in water or any other liquid.
- Never use abrasive, aggressive, or flammable cleaning agents such as bleach or alcohol to clean any part of the appliance.
- Only the pre-filter is washable. The air purification filter is not washable nor vacuum cleanable.

Cleaning schedule

Frequency	Cleaning method
When necessary	Wipe the surface of the appliance with a soft dry cloth
When F0 displays on the screen	Clean the pre-filter
Every two months	Clean the air quality sensors

Clean the body of the appliance

Regularly clean the inside and outside of the appliance to prevent dust from collecting.

- 1 Wipe away dust with a soft dry cloth from the body of the appliance.
- 2 Clean the air outlet with a soft dry cloth.

Clean the air quality sensors

Clean the air quality sensors every 2 months for optimal functioning of the purifier. Clean them more frequently if you use the purifier in a dusty environment.



Note

- When the humidity level in the room is very high, it is possible that condensation develops on the air quality sensors. As a result, the air quality light may indicate that the air quality is bad even though it is good. In this case you have to clean the air quality sensors or use one of the manual speed settings.

- 1 Clean the air quality sensor inlet and outlet with a soft brush.

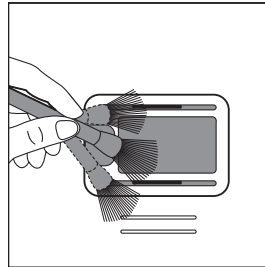

- 2 Remove the air quality sensor cover.

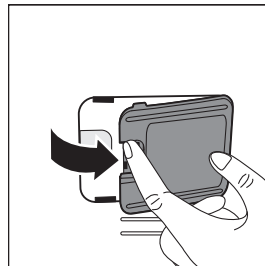

- 3** Clean the air quality sensors, the dust inlet and the dust outlet with a lightly moistened cotton swab.

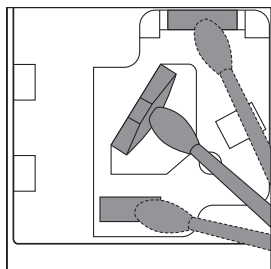

- 4** Dry them with a dry cotton swab.

- 5** Reattach the air quality sensor cover.

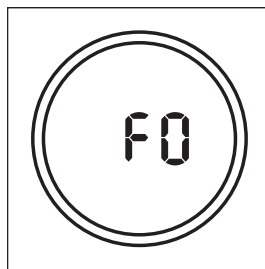
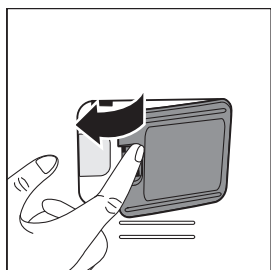

- 1** Pull the bottom part of the front panel to remove it from the appliance.

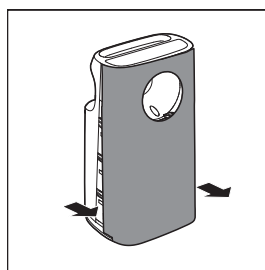

- 2** Press the two clips down and pull the pre-filter towards you.

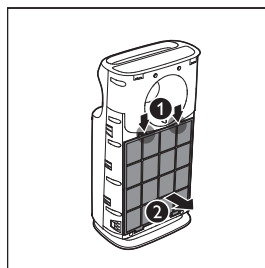

- 3** Wash the pre-filter under a running tap. If the pre-filter is very dirty, use a soft brush to brush away the dust.

Clean the pre-filter

Filter alert light status	Follow this
FO displays on the screen	Clean the pre-filter

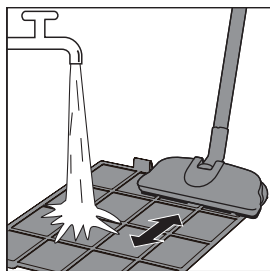

4 Air dry the pre-filter.

Note

- Make sure that the pre-filter is completely dry. If it is still wet, bacteria may multiply in it and shorten the lifetime of the pre-filter.

5 Put the pre-filter back into the appliance.

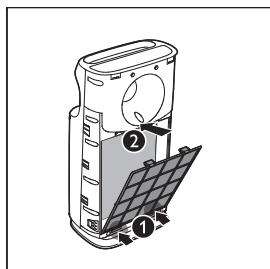

Note

- Make sure that the side with the two clips is pointing towards you, and that all hooks of the pre-filter are properly attached to the purifier.

6 To reattach the front panel, mount the panel onto the top of the appliance first (1). Then, gently push the panel against the body of the appliance (2)



7 Touch and hold the reset button for 3 seconds to reset the pre-filter cleaning time.

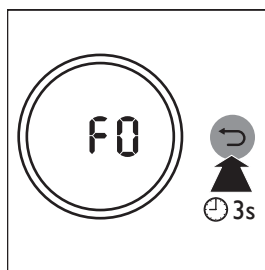

6 Replacing the filter

Understand the healthy air protect lock

This appliance is equipped with the healthy air protect lock to make sure that the air purification filter is in optimal condition when the appliance is operating. When the filter is almost expired, the filter code displays on the screen to indicate that you need to replace the filter.

If the filter is not replaced in 14 days, the appliance will stop operating and get locked.

Replace the filter



Note

- The air purification filter is not washable nor vacuum cleanable.

Filter alert light status	Follow this
A3 displays on the screen	Replace the NanoProtect Pro S3 filter

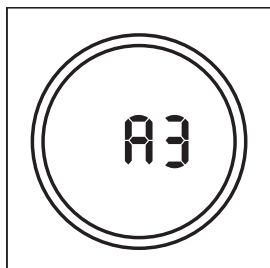

- 1 Take out the expired air purification filter and gently put it into the trash bin.

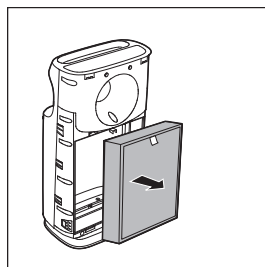

Note

- Do not touch the pleated filter surface, or smell the filter as it has collected pollutants from the air.

- 2 Remove all packaging material of the new filter.

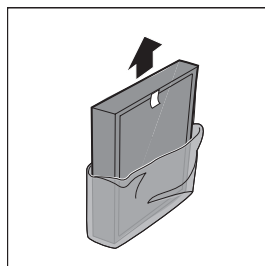

- 3 Place the unpacked filter back into the appliance.

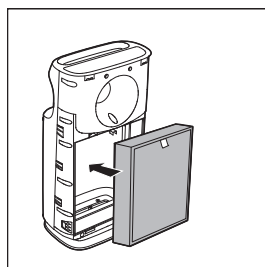

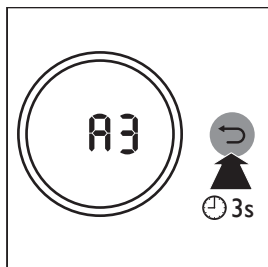

- 4 Touch and hold the reset button  for 3 seconds to reset the filter lifetime counter.





Note

- Cleanse your hands after changing the filter.

Filter force reset

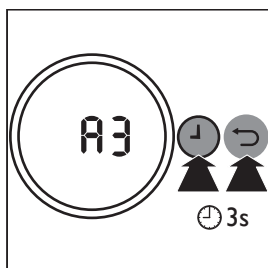
- 1 Touch  and  simultaneously for 3 seconds to enter the filter force reset mode.
- ↳ Filter code (A3) of the NanoProtect Pro S3 filter displays on the screen.



- 2 Touch and hold  for 3 seconds to force reset the lifetime of the NanoProtect Pro S3 filter.

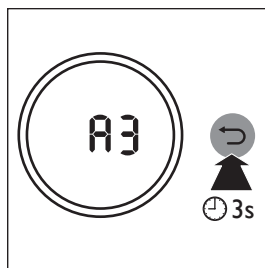

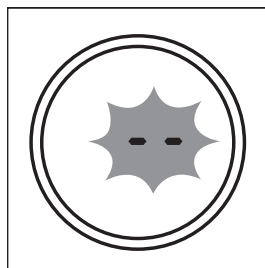

- 3  displays on the screen after the lifetime of the NanoProtect Pro S3 filter has been reset.



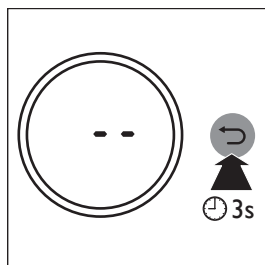

- 4 Touch and hold  for 3 seconds to confirm and exit the filter force reset mode.

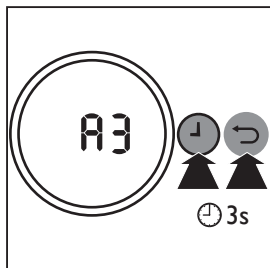

Filter type change

- 1 Touch  and  simultaneously for 3 seconds to enter the filter type change mode.



- 2 Touch  to select the filter code of the new filter you will use.

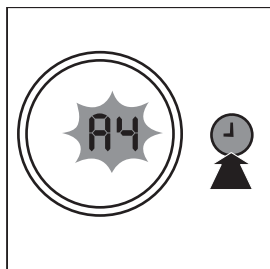

- 3 Touch and hold  for 3 seconds to confirm the filter code of the new filter.

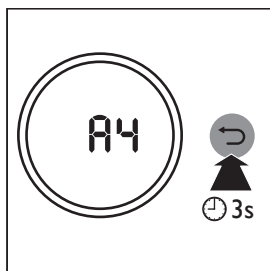



Note

- After you have selected the filter code of the new filter using the  button, if you do not touch any other buttons in 10 seconds, the appliance will automatically confirm the filter code of the new filter.

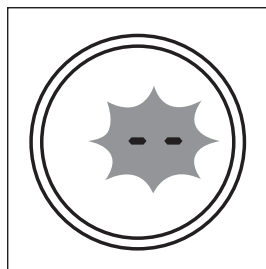
- 4  displays on the screen after the filter type has been changed.



- If you have a second filter to replace, touch  to select the filter code of the second filter, and then touch and hold  for 3 seconds to confirm and exit the filter type change mode.

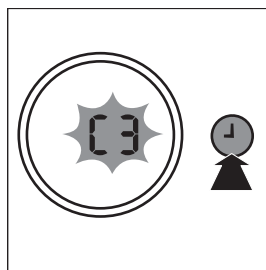

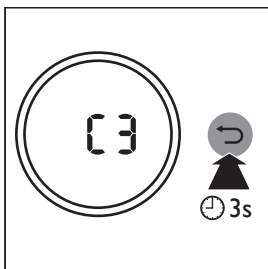

≡ Note

- After you have selected the filter code of the new filter using the ⌚ button, if you do not touch any other buttons in 10 seconds, the appliance will automatically confirm the filter code of the new filter.

↳ If you do not have a second filter to use in the appliance, touch and hold ↶ for 3 seconds to confirm and exit the filter type change mode.

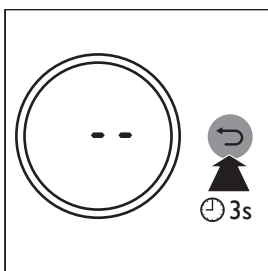



≡ Note

- Refer to the separate leaflet that comes with the filter for more information on different filter combinations for your choice.

7 Troubleshooting

This chapter summarizes the most common problems you could encounter with the appliance. If you are unable to solve the problem with the information below, contact the Consumer Care Center in your country.

Problem	Possible solution
The appliance does not work even though it is plugged in..	The filter replacement code has been displaying on the screen but you have not replaced the corresponding filter yet. The appliance will be locked if you keep using the expired filter. In this case, replace the filter and reset the filter lifetime counter.
The appliance does not work even though it is switched on.	<ul style="list-style-type: none">• The appliance is working but the buttons are not responsive. Check if the child lock is on.• The filter replacement code has been on continuously but you have not replaced the corresponding filter, and the appliance is now locked. In this case, replace the filter and reset the filter lifetime counter.
The airflow that comes out of the air outlet is significantly weaker than before.	<ul style="list-style-type: none">• The pre-filter is dirty. Clean the pre-filter (see chapter "Cleaning").
The air quality does not improve, even though the appliance has been operating for a long time.	<ul style="list-style-type: none">• One of the filters has not been placed in the appliance. Make sure that all filters are properly installed in the following order, starting with the innermost filter: 1) air purification filter; 2) pre-filter.• The air quality sensor is wet. The humidity level in your room is high and causes condensation. Make sure that the air quality sensor is clean and dry (see chapter "Cleaning").

Problem	Possible solution
The color of the air quality light always stays the same.	The air quality sensor is dirty. Clean the air quality sensor (see chapter "Cleaning").
The appliance produces a strange smell.	The first few times you use the appliance, it may produce a plastic smell. This is normal. However, if the appliance produces a burnt smell, contact your Philips dealer or an authorized Philips service centre. The appliance may also produce an unpleasant smell when the filter is dirty. In this case, clean or replace the filter concerned.
The appliance is extra loud.	If the appliance is too loud, you can change the fan speed to a lower fan speed level. When using the appliance in a bedroom at night, choose the sleep mode.
The appliance still indicates that I need to replace a filter, but I already did.	Perhaps you did not reset the filter lifetime counter. Plug in the appliance, touch  to switch on the appliance, and touch and hold the reset button  for 3 seconds.
Error code "Er" displays on the screen.	The hall sensor is not working properly. Remove and then reattach the front panel. If the error code "Er" still exists, contact the Consumer Care Center in your country.
Error codes "E1", "E2", "E3" or "E4" displays on the screen.	The appliance has malfunctions. Contact the Consumer Care Center in your country.

8 Guarantee and service

If you need information or if you have a problem, please visit the Philips website at

www.philips.com or contact the Philips Consumer Care Center in your country (you find its phone number in the worldwide guarantee leaflet). If there is no Consumer Care Centre in your country, go to your local Philips dealer.

Order parts or accessories

If you have to replace a part or want to purchase an additional part, go to your Philips dealer or visit www.philips.com/support.

If you have problems obtaining the parts, please contact the Philips Consumer Care Center in your country (you can find its phone number in the worldwide guarantee leaflet).

9 Notices

Electromagnetic fields (EMF)

This Philips appliance complies with all applicable standards and regulations regarding exposure to electromagnetic fields.

Compliance with EMF

Koninklijke Philips N.V. manufactures and sells many products targeted at consumers, which, like any electronic apparatus, in general have the ability to emit and receive electromagnetic signals.

One of Philips' leading Business Principles is to take all necessary health and safety measures for our products, to comply with all applicable legal requirements and to stay well within the EMF standards applicable at the time of producing the products.

Philips is committed to develop, produce and market products that cause no adverse health effects. Philips confirms that if its products are handled properly for their intended use, they are safe to use according to scientific evidence available today.

Philips plays an active role in the development of international EMF and safety standards, enabling Philips to anticipate further developments in standardization for early integration in its products.

Recycling

Do not throw away the product with the normal household waste at the end of its life, but hand it in at an official collection point for recycling. By doing this, you help to preserve the environment.



Specifications are subject to change without notice
© 2015 Koninklijke Philips N.V.
All rights reserved.

