

PHILIPS

hand mixer

with storage caddy

HR1457



PHILIPS

IMPORTANT SAFEGUARDS

When using electrical appliances, basic safety precautions should always be followed including the following:

Read all instructions before using.

1. To protect against electrical shock, do not immerse cord, plug or Mixer in water or other liquid. This may cause personal injury and/or damage to the Mixer.
2. Close supervision is necessary when any appliance is used by or near children or invalids.
3. Unplug from outlet when not in use, before putting on or taking off parts and before cleaning.
4. Avoid contacting moving parts.
5. Keep hands, hair, clothing, and handheld spatulas and other utensils away from beaters, whisks or dough hooks during operation to reduce the risk of injury to persons, and/or damage to the Mixer.
6. Do not operate this appliance with a damaged cord or plug, or after the appliance malfunctions, or has been damaged in any manner; return the mixer to the retail location where it was purchased for examination, repair, or adjustment.
7. Use this appliance only for its intended use as described in this manual. Do not use accessory attachments not recommended by Philips Electronics North America Corporation as they may cause fire, electrical shock or injury.
8. Do not use outdoors or operate where oxygen is being administered or in the presence of explosive and/or flammable fumes.
9. Do not let cord hang over edge of table or counter, or contact hot surfaces, including the stove.

10. This appliance is intended for household use ONLY; it is not for commercial or industrial use.
11. Any service of the Mixer should be performed by the retail location where it was purchased.
12. To disconnect the appliance, turn Power Control to "OFF" (O), then remove plug from electrical outlet.
13. Remove beaters, whisks or dough hooks from mixer before washing.
14. Do not abuse the cord. Never carry the Mixer by the cord or yank the cord to disconnect it from an outlet; instead, grasp the plug and pull to disconnect.
15. Do not place Mixer on or near a hot burner or in a heated oven.
16. Do not leave Mixer unattended while it is operating.

SAVE THESE INSTRUCTIONS

SPECIAL INSTRUCTIONS

Operating the Mixer and another appliance at the same time from the same electrical circuit could cause an electrical overload condition, which would blow the fuse or trip the circuit breaker.

SPECIAL POLARIZED PLUG INSTRUCTIONS

This Philips Mixer has a polarized plug (one blade is wider than the other). To reduce the risk of electric shock:

- Plug will fit into polarized outlet only one way.
- If plug does not properly fit outlet at first, reverse it.
- If plug still does not fit, contact a qualified electrician.

DO NOT ATTEMPT TO DEFEAT THIS SAFETY FEATURE

Table of Contents

Features	2
Using the Mixer	3
Accessory and Speed Guide	3-4
Cleaning	4
Storing the Mixer	4
For Assistance	4
Warranty	Back Cover

Features

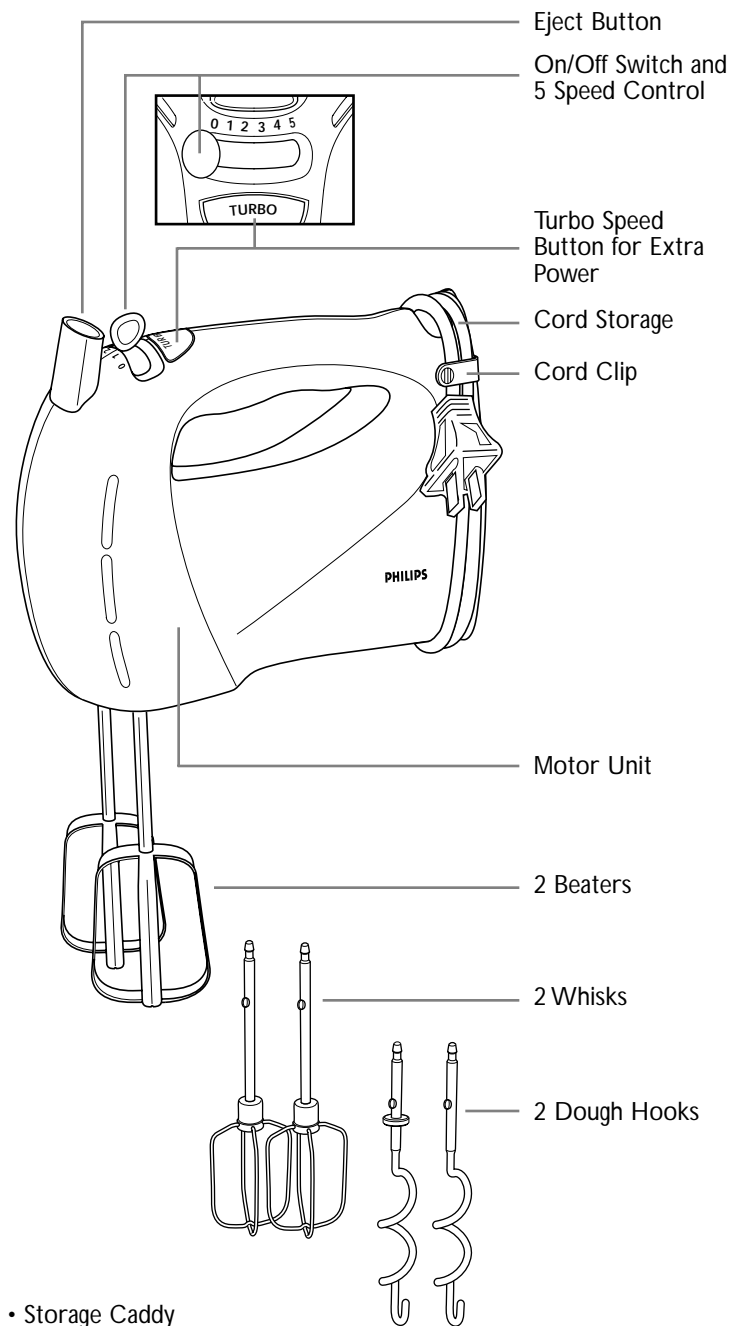

Using the Mixer

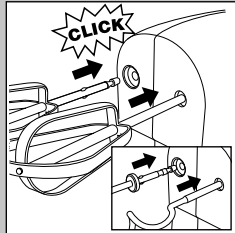

- 1** Be sure the Mixer is in OFF (0) position and unplugged before inserting or removing attachments.
- 2** Insert the beaters, whisks, or dough hooks into the Mixer. It may be necessary to turn the beaters, whisks, or dough hooks slightly while doing so.

NOTE: Insert the dough hook with the metal collar into the larger opening

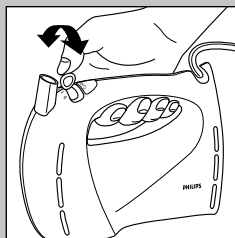

- 3** Plug the mixer into a 120V AC electrical outlet.

- 4** Place the ingredients in a bowl.

- 5** Lower the beaters, whisks, or dough hooks into the ingredients.

- 6** Switch the mixer on by turning Speed Control to the appropriate speed.

NOTE: For extra power, press the Turbo Speed Button and release it to return to the previously selected speed.

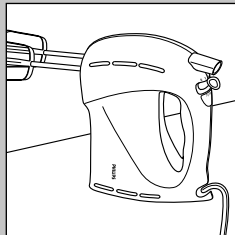

- 7** If you want to stop mixing temporarily, switch the Mixer off by turning Speed Control to "0" position and place it (with the whisks, beaters or dough hooks still attached) on its heel rest until you wish to continue.

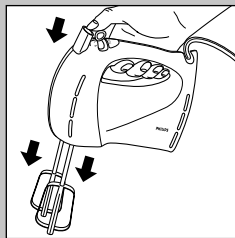

- 8** When you have finished mixing, turn Speed Control to "0" position and unplug cord from electrical outlet. To remove the beaters, whisks, or dough hooks, position the Mixer over a bowl or sink and press the Eject Button to release them.

Accessory and Speed Guide

Use the following guide for accessories and speed selections.

NOTE: Start mixing at the lowest speed and gradually increase as needed.

Accessory	Speed	Task
Beaters	1	To blend/fold in flour or dry ingredients with liquids for cookie doughs or batters
	2	To stir thin batters for waffles, pancakes, etc.
	3	To mix cake batters, eggs into batter, cream butter and sugar
	4	To beat whole eggs, frostings, light batters, thin sauce
	5	To whip cooked potatoes, turnips, squash
Whisks	5	To whip egg whites, cream, mayonnaise
Dough Hooks	5	To mix or blend yeast dough for max. 5 min.
	Turbo	Press this button for maximum power for heavy mixing jobs

Cleaning

Be sure the Speed Control is in the "0" position and the cord is unplugged before cleaning any part of the Mixer.

- 1** Press the Eject Button to release the beaters, whisks or dough hooks.
- 2** Clean the beaters, whisks, or kneading hooks in warm soapy water. They may also be cleaned in a dishwasher. Dry all parts thoroughly before storing.
- 3** **Do not immerse the Mixer in water or rinse it under the tap.** To remove stubborn spots, wipe surfaces with a cloth dampened in sudsy water or a mild, non-abrasive cleaner. Then wipe with a clean, damp cloth. Do not use abrasive cleansers on any part of the Mixer as they can damage the finish.

Storing the Mixer

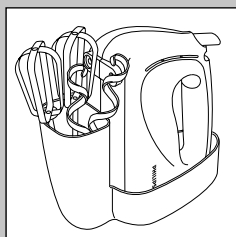

- 1** Avoid jerking the Power Cord or straining it at the plug connection. To store, loop cord around mixer and secure it with the Cord Clip.
- 2** Store the Mixer, beaters, whisks and dough hooks in the storage caddy.

For assistance

For assistance call toll free:

1-800-243-7884
or visit our website: www.philipsonline.com

FULL ONE YEAR WARRANTY

Philips Electronics North America Corporation warrants each new Philips product, model HR1457 (except cord), against defects in materials or workmanship for a period of one year from the date of purchase.

IMPORTANT: This warranty does not cover damage resulting from accident, misuse or abuse, lack of reasonable care, the affixing of any attachment not provided with the product or loss of parts or subjecting the product to any but the specified voltage.*

**PHILIPS ELECTRONICS NORTH AMERICA CORPORATION
WILL NOT PAY FOR UNAUTHORIZED SERVICE OF ANY
TYPE.**

**NO RESPONSIBILITY IS ASSUMED FOR ANY SPECIAL,
INCIDENTAL OR CONSEQUENTIAL DAMAGES.**

In order to address warranty issues, simply take or ship the product back to the retail location where it was purchased.

* Read enclosed instructions carefully.

Manufactured for:
Norelco Consumer Products Company
A Division of Philips Electronics North America Corporation
1010 Washington Blvd., Stamford, CT 06912-0015

For Assistance call 1-800-243-7884

MADE IN CHINA.



This symbol on the product's nameplate means
it is listed by Underwriters' Laboratories, Inc.

PHILIPS and Philips Shield are Registered Trademarks of Koninklijke
Philips Electronics N.V.

© 2000 Philips Electronics North America Corporation.
All Rights Reserved.

HR1457

4222.002.2310.1